

Electrical & Communications
Riser Cupboard - all
residential levels.



Check all dimensions and site conditions prior to commencement of any work, the purchase or ordering of any materials, fittings, plant, services or equipment and the preparation of shop drawings and/or the fabrication of any components.

All drawings to be read in conjunction with all architectural documents and all other consultants documents.

Do not scale drawings - refer to figured dimensions only. Any discrepancies shall immediately be referred to the architect for clarification.

All drawings may not be reproduced or distributed without prior permission from the architect.

Revision Summary:

NOT FOR CONSTRUCTION

05	29.08.14	For Coordination	ML	ML
04	26.08.14	For Coordination	ML	ML
03	12.08.14	For Coordination	ML	ML
02	29.07.14	For Coordination / Review	ML	ML
01	02.07.14	For Information	ML	ML
Revision	Date	Description	Initial	Checked

Site 68
Sydney Olympic Park

General Arrangement Plan
Level 04

Scale	1:100 @ A1, 1:200 @ A3
Drawn	Checked
Project No.	S11611
Status	DA
Plot Date	29/8/2014 6:15 PM
Plot File	\\lv-rfp-01\shared\SLV\projects\11600-11699\11611_ecove_s... ...spsite68\00_main\cad\plots\DA\DA02.04[01]x.dwg
Drawing No.	[Revision]

DA02.04[01]X

Melbourne 1 Nicholson Street
Melbourne VIC 3000 Australia
T 03 8664 6200 F 03 8664 6300
email melb@batessmart.com.au
http://www.batessmart.com.au

Sydney 43 Brisbane Street
Surry Hills NSW 2010 Australia
T 02 8354 5100 F 02 8354 5199
email syd@batessmart.com.au
http://www.batessmart.com.au

Bates Smart Architects Pty Ltd ABN 68 094 740 986

HARON ROBSON
lightmatters wattmatters avmatters
17 September 2014

BATESSMART

Electrical & Communications
Riser Cupboard - all
residential levels.



Check all dimensions and site conditions prior to commencement of any work, the purchase or ordering of any materials, fittings, plant, services or equipment and the preparation of shop drawings and/or the fabrication of any components.

All drawings to be read in conjunction with all architectural documents and all other consultants documents.

Do not scale drawings - refer to figured dimensions only. Any discrepancies shall immediately be referred to the architect for clarification.

All drawings may not be reproduced or distributed without prior permission from the architect.

Revision Summary:

NOT FOR CONSTRUCTION

Revision	Date	Description	Initial	Checked
01	29.08.14	For Information	ML	ML

Site 68
Sydney Olympic Park

General Arrangement Plan
Level 05-09

Scale	1:100 @ A1, 1:200 @ A3
Drawn	Checked
Project No.	S11611
Status	DA
Plot Date	29/8/2014 6:23 PM
Plot File	S:\11600-11699\s11611_escove_sopiste6800_main\cad\plots\DA... ... \DA02.05[01]x.dwg
Drawing No.	[Revision]

DA02.05[01]X

Melbourne 1 Nicholson Street
Melbourne VIC 3000 Australia
T 03 8664 6200 F 03 8664 6300
email melb@batessmart.com.au
http://www.batessmart.com.au

Sydney 43 Brisbane Street
Surry Hills NSW 2010 Australia
T 02 8354 5100 F 02 8354 5199
email syd@batessmart.com.au
http://www.batessmart.com.au

Bates Smart Architects Pty Ltd ABN 68 094 740 986

HARON ROBSON
lightmatters wattmatters avmatters

17 September 2014

BATESSMART

Electrical & Communications
Riser Cupboard - all
residential levels.

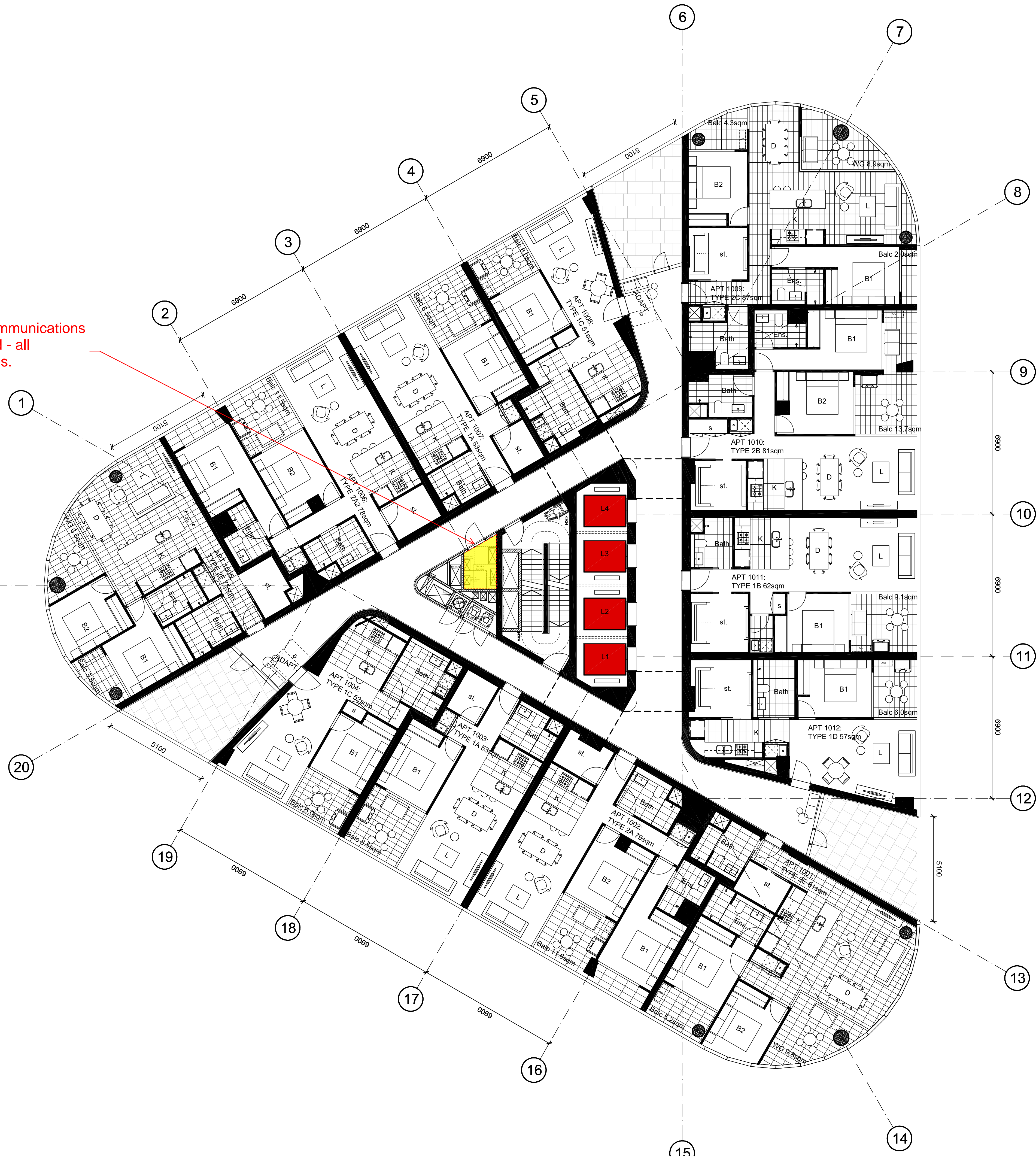

Check all dimensions and site conditions prior to commencement of any work, the purchase or ordering of any materials, fittings, plant, services or equipment and the preparation of shop drawings and/or the fabrication of any components.

All drawings to be read in conjunction with all architectural documents and all other consultants documents.

Do not scale drawings - refer to figured dimensions only. Any discrepancies shall immediately be referred to the architect for clarification.

All drawings may not be reproduced or distributed without prior permission from the architect.

Revision Summary:

NOT FOR CONSTRUCTION

05	29.08.14	For Coordination	ML	ML
04	26.08.14	For Coordination	ML	ML
03	12.08.14	For Coordination	ML	ML
02	29.07.14	For Coordination / Review	ML	ML
01	02.07.14	For Information	JC	MLS
Revision	Date	Description	Initial	Checked

Site 68
Sydney Olympic Park

General Arrangement Plan
Level 10

Scale	1:100 @ A1, 1:200 @A3
Drawn	Checked
Project No.	S11611
Status	DA
Plot Date	29/8/2014 6:15 PM
Plot File	S:\11600-11699\11611_escove_sopiste68\00_main\cad\plots\DA... ... \DA02.10[01]x.dwg
Drawing No.	[Revision]

DA02.10[01]X

Melbourne 1 Nicholson Street
Melbourne VIC 3000 Australia
T 03 8664 6200 F 03 8664 6300
email melb@batessmart.com.au
http://www.batessmart.com.au

Sydney 43 Brisbane Street
Surry Hills NSW 2010 Australia
T 02 8354 5100 F 02 8354 5199
email syd@batessmart.com.au
http://www.batessmart.com.au

Bates Smart Architects Pty Ltd ABN 68 094 740 986

HARON ROBSON
lightmatters wattmatters avmatters

17 September 2014

BATESSMART

Electrical & Communications
Riser Cupboard - all
residential levels.



Check all dimensions and site conditions prior to commencement of any work, the purchase or ordering of any materials, fittings, plant, services or equipment and the preparation of shop drawings and/or the fabrication of any components.

All drawings to be read in conjunction with all architectural documents and all other consultants documents.

Do not scale drawings - refer to figured dimensions only. Any discrepancies shall immediately be referred to the architect for clarification.

All drawings may not be reproduced or distributed without prior permission from the architect.

Revision Summary:

NOT FOR CONSTRUCTION

01	29.08.14	For Information	JC	MLS
Revision	Date	Description	Initial	Checked

Site 68
Sydney Olympic Park

General Arrangement Plan
Levels 11-15

Scale	1:100 @ A1, 1:200 @ A3
Drawn	Checked
Project No.	S11611
Status	DA
Plot Date	29/8/2014 6:23 PM
Plot File	S:\11600-11699\11611_escove_sopiste68\00_main\cad\plots\DA... ... \DA02.11[01]x.dwg
Drawing No.	[Revision]

DA02.11[01]X

Melbourne 1 Nicholson Street
Melbourne VIC 3000 Australia
T 03 8664 6200 F 03 8664 6300
email melb@batessmart.com.au
http://www.batessmart.com.au

Sydney 43 Brisbane Street
Surry Hills NSW 2010 Australia
T 02 8354 5100 F 02 8354 5199
email syd@batessmart.com.au
http://www.batessmart.com.au

Bates Smart Architects Pty Ltd ABN 68 094 740 986

HARON ROBSON
lightmatters wattmatters avmatters

17 September 2014

BATESSMART

Electrical & Communications
Riser Cupboard - all
residential levels.



Check all dimensions and site conditions prior to commencement of any work, the purchase or ordering of any materials, fittings, plant, services or equipment and the preparation of shop drawings and/or the fabrication of any components.

All drawings to be read in conjunction with all architectural documents and all other consultants documents.

Do not scale drawings - refer to figured dimensions only. Any discrepancies shall immediately be referred to the architect for clarification.

All drawings may not be reproduced or distributed without prior permission from the architect.

Revision Summary:

NOT FOR CONSTRUCTION

05	29.08.14	For Coordination	ML	ML
04	26.08.14	For Coordination	ML	ML
03	12.08.14	For Coordination	ML	ML
02	29.07.14	For Coordination / Review	ML	ML
01	02.07.14	For Information	JC	MLS
Revision	Date	Description	Initial	Checked

Site 68
Sydney Olympic Park

General Arrangement Plan
Level 16

Scale	1:100 @ A1, 1:200 @ A3
Drawn	Checked
Project No.	S11611
Status	DA
Plot Date	29/8/2014 6:15 PM
Plot File	S:\11600-11699\s11611_escove_sopiste6800_main\cad\plots\DA... ... \DA02.16[01]x.dwg
Drawing No.	[Revision]

DA02.16[01]X

Melbourne 1 Nicholson Street
Melbourne VIC 3000 Australia
T 03 8664 6200 F 03 8664 6300
email mel@batessmart.com.au
http://www.batessmart.com.au

Sydney 43 Brisbane Street
Surry Hills NSW 2010 Australia
T 02 8354 5100 F 02 8354 5199
email syd@batessmart.com.au
http://www.batessmart.com.au

Bates Smart Architects Pty Ltd ABN 68 094 740 986

HARON ROBSON
lightmatters wattmatters avmatters

17 September 2014

BATESSMART