

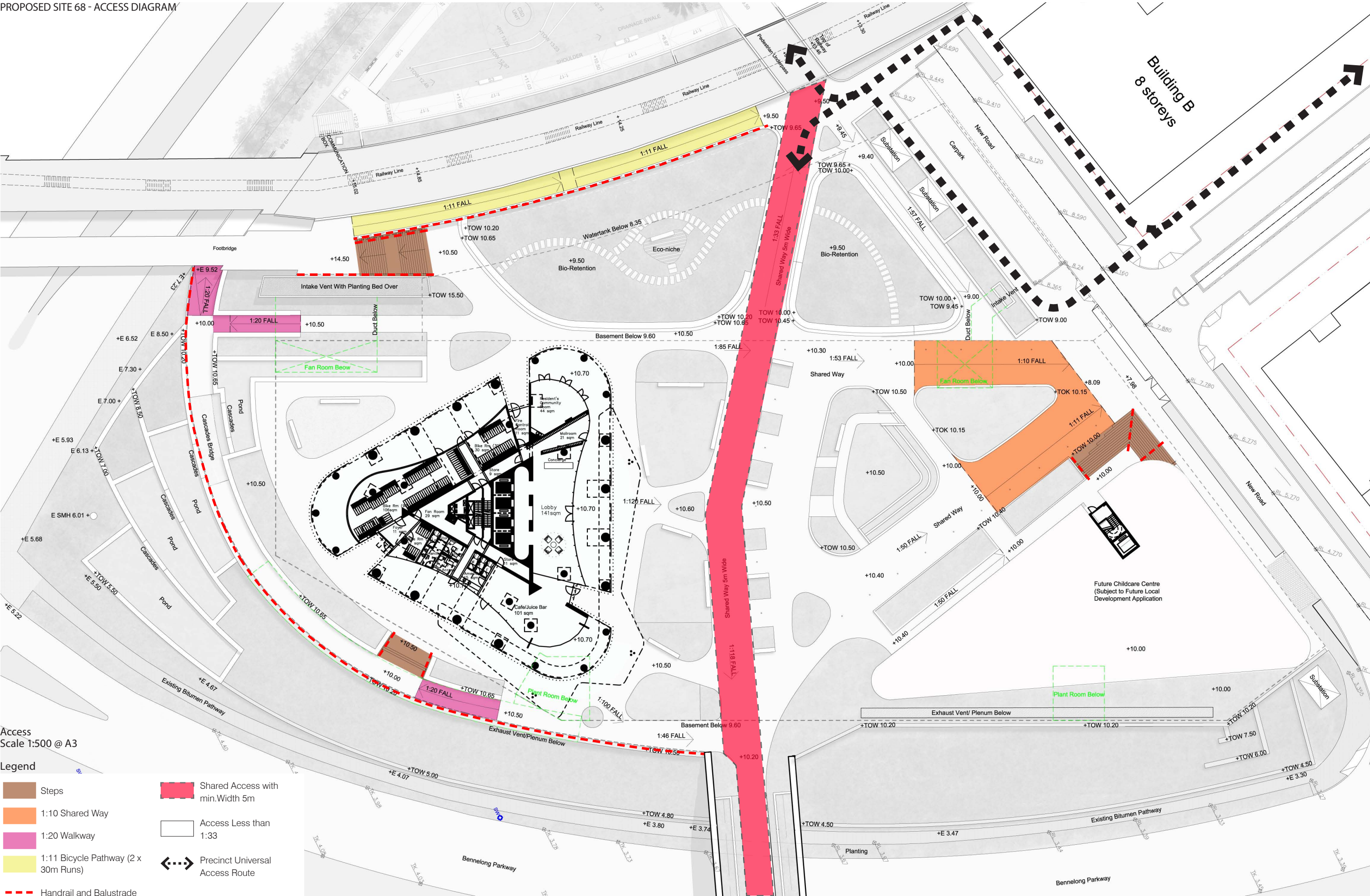

PICTURED  
View across Site 68, looking west towards proposed underpass



PROPOSED SITE 68 - ACCESS DIAGRAM



Access  
Scale 1:500 @ A3

Legend

- Steps
- 1:10 Shared Way
- 1:20 Walkway
- 1:11 Bicycle Pathway (2 x 30m Runs)
- Handrail and Balustrade
- Shared Access with min. Width 5m
- Access Less than 1:33
- Precinct Universal Access Route





**PROPOSED SITE 68 - PLANTING AREA AND SOIL DEPTH DIAGRAM**

**Planting Area and Soil Depth**  
Scale 1:500 @ A3

**Legend**

- Bioretention 1200sqm
- Lawn and Planting on structure(Basement and Watertank) with 1493sqm + 61sqm on Vent, 900mm-1150mm Soil Depth
- Planting and Lawn off structure 3264sqm

The diagram illustrates the proposed site layout, including the building footprint, water tank, and various planting areas. Key features include:

- Building Footprint:** Central structure with rooms like Lobby, Cafe/Juice Bar, Store, and various rooms.
- Water Tank:** Large circular structure with an eco-niche.
- Bio-Retention Ponds:** Several ponds of varying sizes, including a large one labeled "Bio-Retention" and others labeled "Bio-Retention 1200sqm".
- Planting Areas:** Extensive green spaces, including lawns and planting areas, with specific soil depth requirements indicated.
- Infrastructure:** Railway line, footbridge, and various roads (New Road, Bennelong Parkway).
- Future Childcare Centre:** Located to the east of the main site.

### Legend

- |  |
|--|
| Bioretention 1200sqm   |
| Lawn and Planting on structure(Basement and Watertank) with 1493sqm + 61sqm on Vent, 900mm-1150mm Soil Depth |
| Planting and Lawn off structure 3264sqm  |



PROPOSED SITE 68 - CARPARK VENTILATION DIAGRAM

