



01 3D VIEW October 0700



02 3D VIEW October 0800



03 3D VIEW October 0900

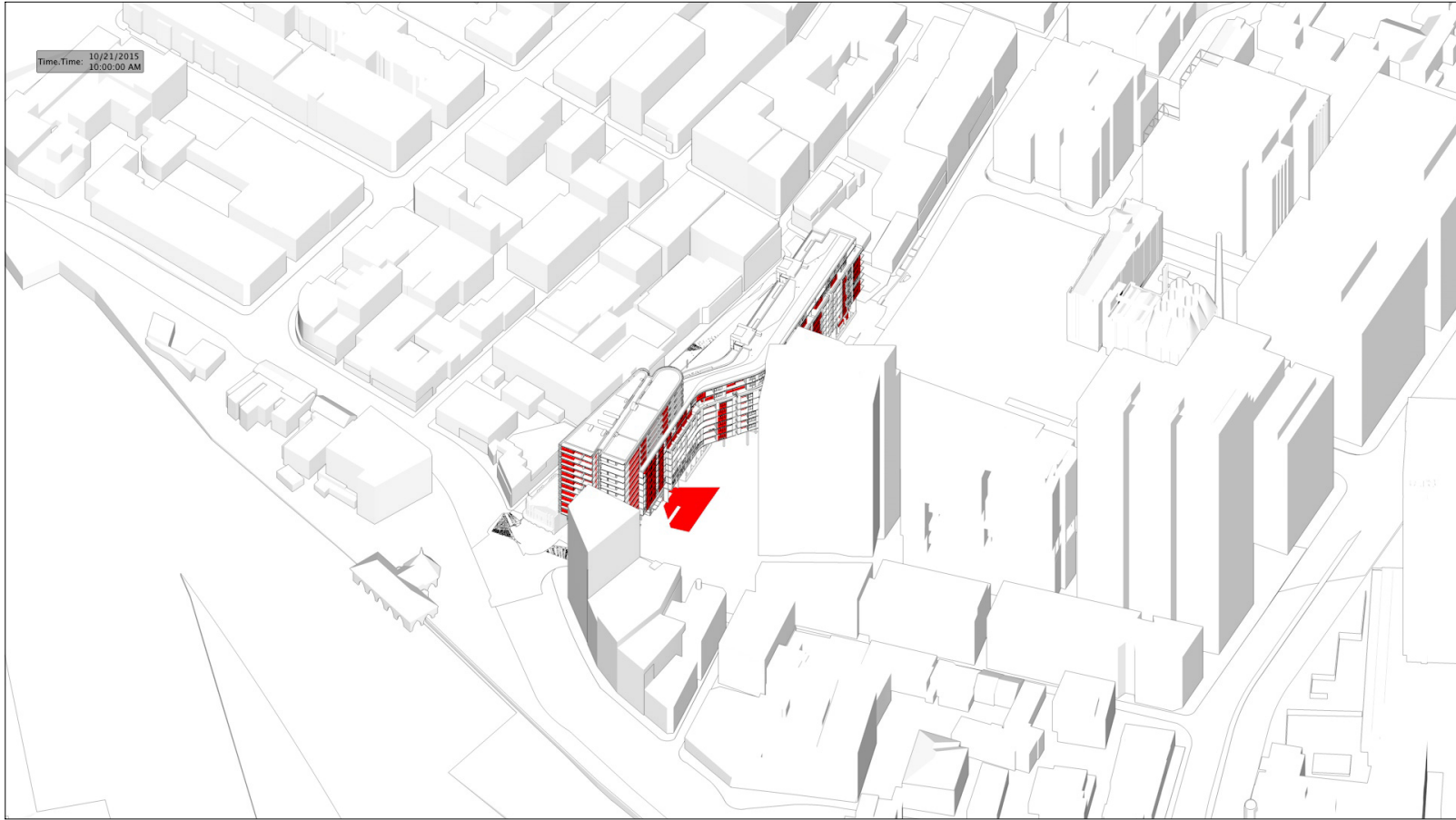

04 3D VIEW October 1000

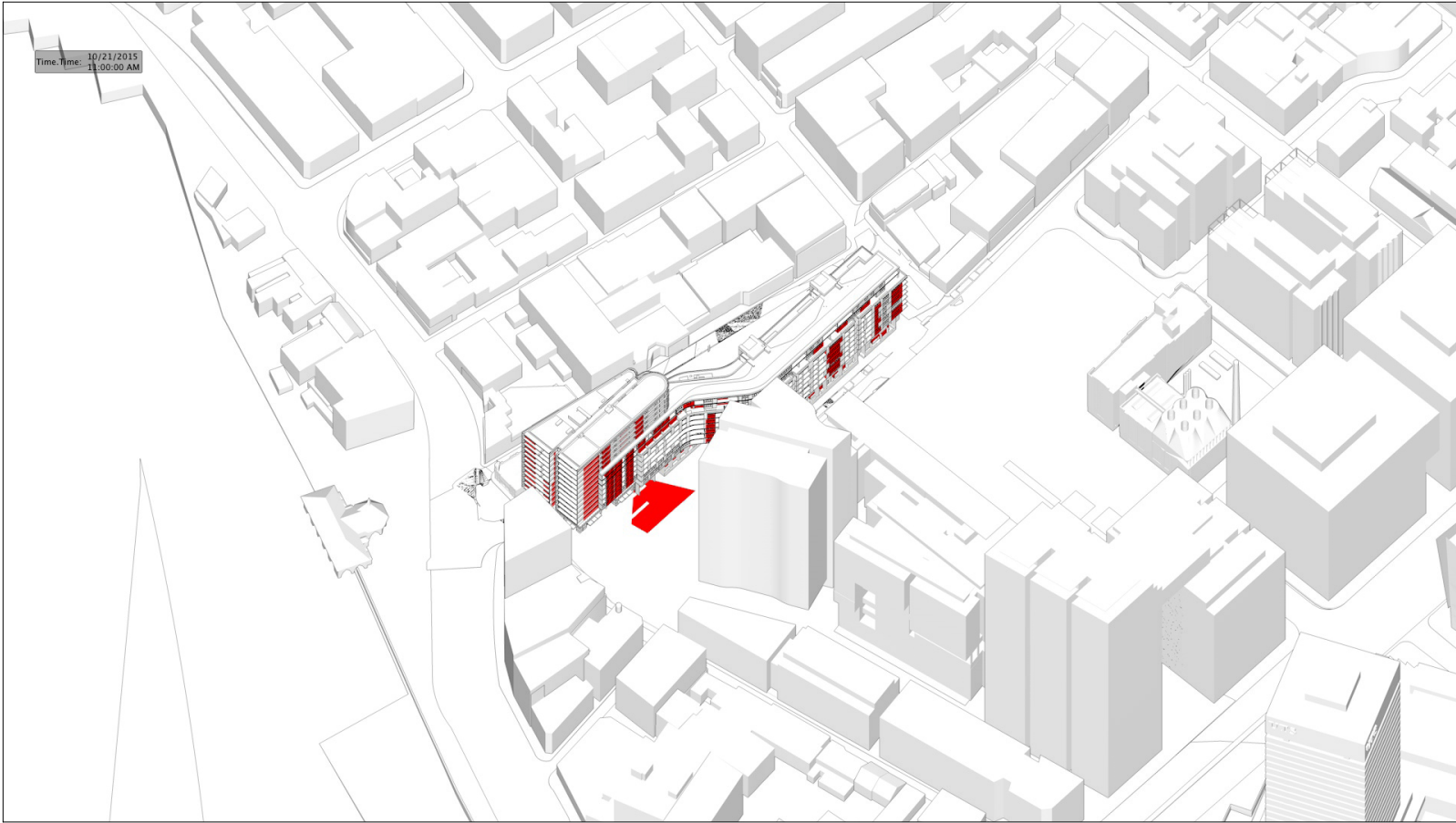

05 3D VIEW October 1100



06 3D VIEW October 1200



07 3D VIEW October 1300

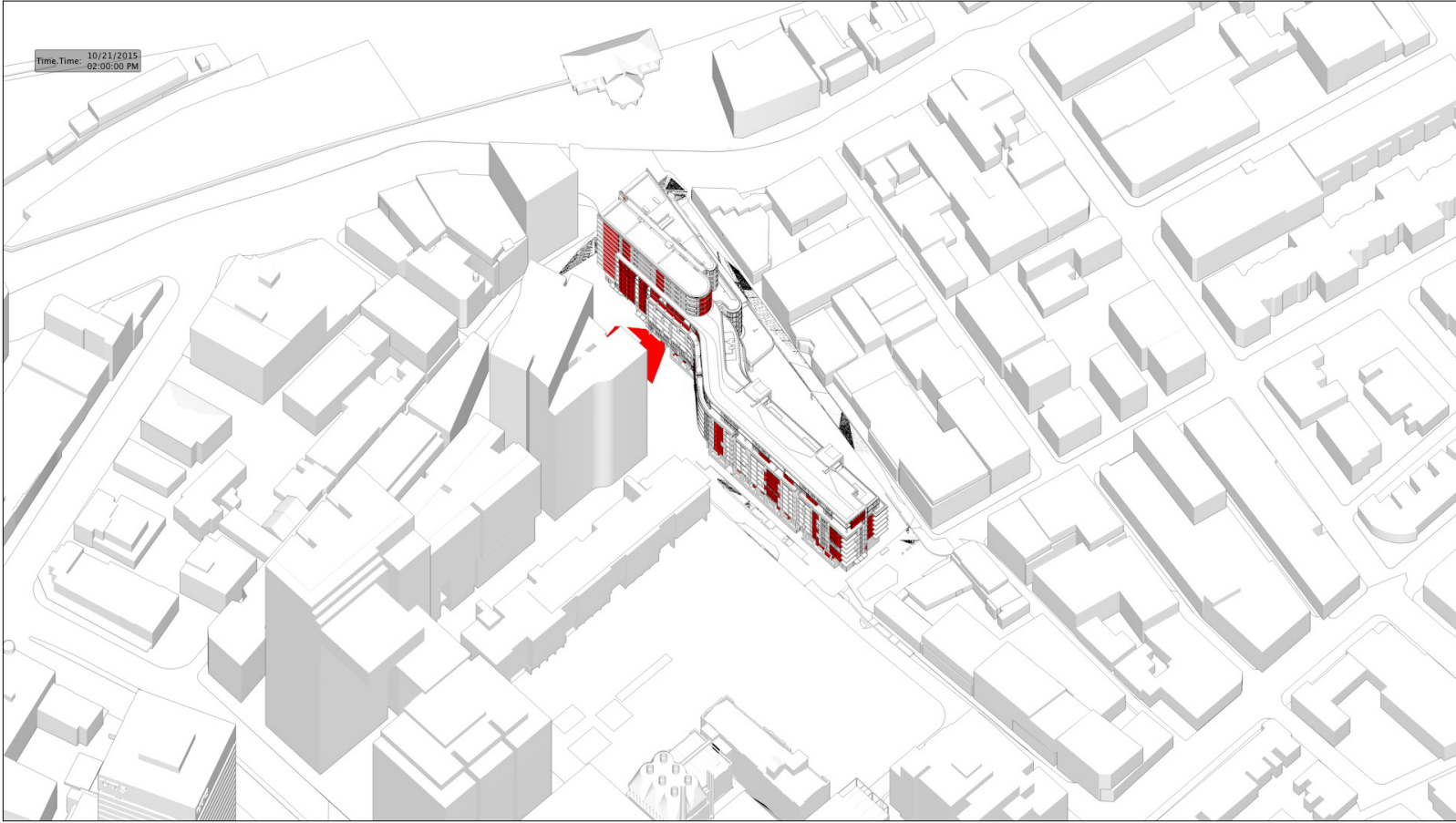

08 3D VIEW October 1400



09 3D VIEW October 1500

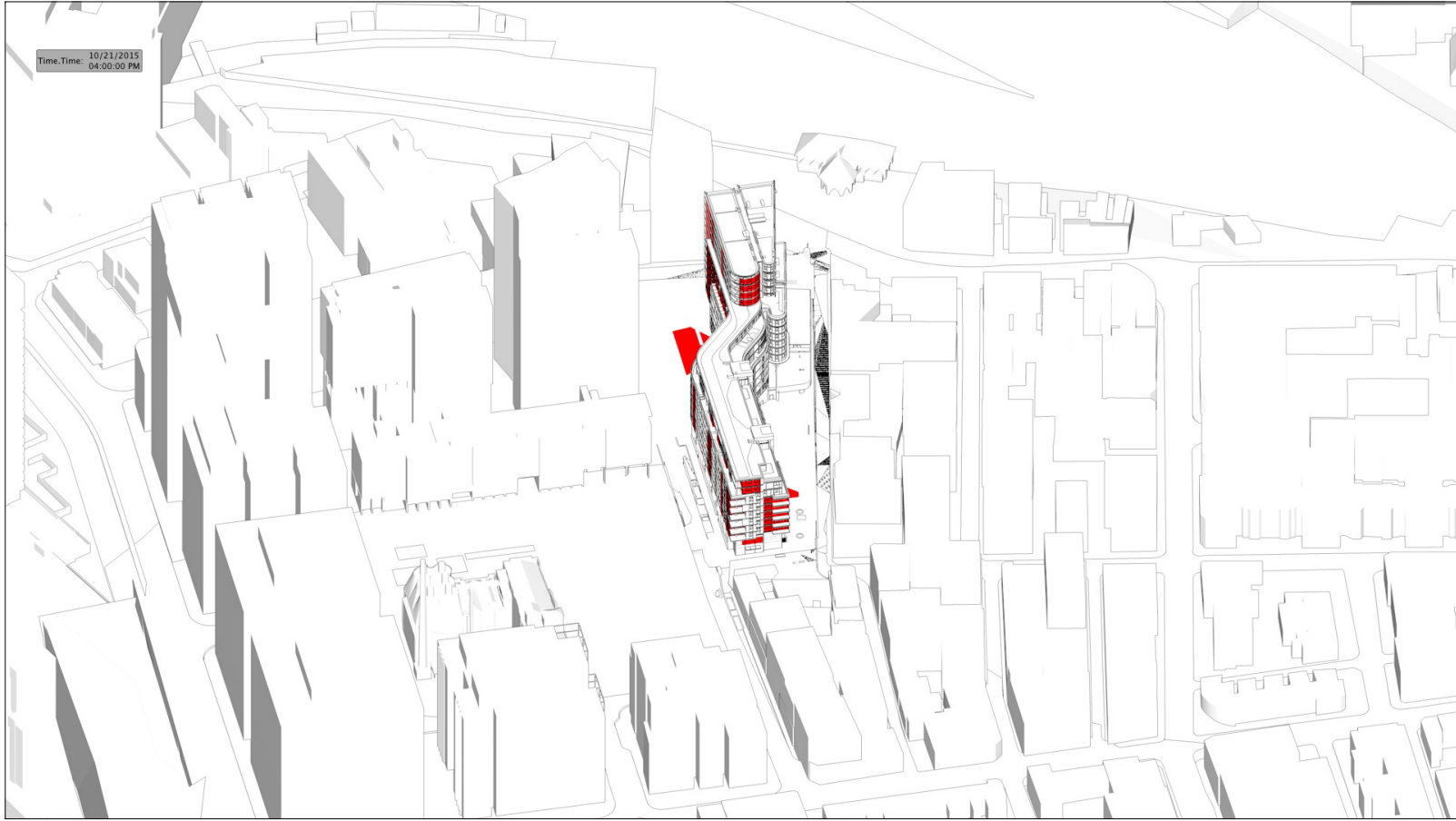

10 3D VIEW October 1600



11 3D VIEW October 1700



12 3D VIEW October 1800

- GENERAL NOTES
- ALL DIMENSIONS AND EXISTING CONDITIONS SHALL BE CHECKED AND VERIFIED BY THE CONTRACTOR BEFORE PROCEEDING WITH THE WORK
  - ALL LEVELS RELATIVE TO AUSTRALIAN HEIGHT DATUM
  - DO NOT SCALE DRAWINGS: USE FIGURED DIMENSIONS ONLY

LEGEND

S	STUDIO
1B	1 BED
1BM	1 BED + MEDIA NOOK
1BS	1 BED + STUDY
2B	2 BED
2BM	2 BED + MEDIA NOOK
2BS	2 BED + STUDY
2BK	2 BED DUAL KEY
2BT	2 BED 2 STOREY TERRACE
3B	3 BED
3BM	3 BED + MEDIA NOOK
3BS	3 BED + STUDY
3BK	3 BED DUAL KEY
	RETAIL + NON-RESIDENTIAL
	CHILDCARE
	EXTERNAL AREA
	COURTYARD/BALCONY/WINTER-GARDEN

- 2 HOURS OF SUNLIGHT ACCESS
- NATURAL VENTILATION (NV)
- WIDE FRONTAGE NATURALLY VENTILATED
- ASSISTED VENTILATION
- SOUTH FACING APARTMENT
- ADAPTABLE APARTMENT
- LOBBY DUCTED VENTILATION
- APARTMENT ASSIST VENT BLADE
- ASSISTED VENTILATION
- GOOD VENTILATION
- NATURAL VENTILATION
- LOBBY CROSS VENTILATION

- FAC01 Anodised aluminium Curtain Wall System with integrated operable windows (allow for euro style multifunction hardware) clip-on custom profiled extrusions
- FAC02 Anodised aluminium Window Wall System with integrated operable windows (allow for euro style multifunction hardware) and door systems (allow for 50/50 split between sliding and bi-fold functionality). Fenestration to facade system being anodised aluminium operable bi-fold perforated sunshade screens (allow for floor to floor coverage)
- FAC03 Anodised aluminium Window Wall System with integrated operable windows (allow for euro style multifunction hardware) and door systems (allow for 50/50 split between sliding and bi-fold functionality). Fenestration to facade system being anodised aluminium operable bi-fold perforated sunshade screens (allow for floor to floor coverage)
- FAC04 Anodised aluminium sliding sunshade screen battens panels with battens at typically 100mm CC, 50mm SHS profile to framing and battens
- FAC05 Anodised aluminium sliding sunshade screen battens panels with battens at typically 100mm CC, 50mm SHS profile to framing and battens
- FAC06 Anodised aluminium Window Wall System with integrated operable windows (allow for euro style multifunction hardware) and door systems (allow for 50/50 split between sliding and bi-fold functionality). Profiled timber battens using "clip-on" fixing as noted in elevation.
- FAC07 Anodised aluminium Window Wall System with integrated operable windows (allow for panel lift type e.g. "Reclina") and door systems (allow for full height panel functionality). Fenestration to facade system being profiled timber battens using "clip-on" fixing as noted in elevation.
- FAC08 Full height timber batten screens
- FAC09 Brick Type 1 colour (earthly rust). Bowral pressed or similar. Final selection as per materials board
- FAC10 Rendered Masonry with integrated anodised aluminium window systems
- FAC11 Bekustrade. Frameless glazing with powder coated firm plate aluminium portal framing. Glazing is not captured all round
- FAC12 Profiled anodised aluminium vertical battens using "clip-on" fixing as noted in elevation.
- BD1 Stainless steel Bollard
- BYR1 Stainless steel Bicycle Rail
- DG1 Decomposed Granite Gravel
- DG2 Decorative Gravel
- HR2 Stainless steel Handrail
- LP1 Lighting strip
- P1 Paving Type 1 City of Sydney Precast Paving
- P2 Paving Type 2 Precast Concrete Paving with Granite stone inlay
- P3 Paving Type 3 Granite Setts (to parking bays)
- P4 Paving Type 4 Exposed Aggregate Concrete path
- P5 Paving Type 5 Precast paving for traffic areas
- P6 Paving Type 6 Brick Paving
- PTT Proposed Service Pits
- RW1 Brick base with a Timber capping Retaining wall
- RW2 Brick base with a Precast concrete capping Retaining wall
- RW3 Insitu concrete Retaining wall
- RW4 Heritage Interpretation wall
- ST1 Corten Steel Edging
- TD1 Timber Bench Seats
- TD2 Timber Composite vertical batten screen
- TD3 Timber Decking

01	24/10/2014	ISSUED FOR SSDA APPROVAL	FJMT
REV.	DATE	DESCRIPTION	BY

CLIENT

Fraser's Broadway

**FRASERS PROPERTY**

Suite 11, Lumiere Commercial,  
Level 12, 101 Bathurst Street,  
Sydney NSW, 2000, Australia

ARCHITECT

**fjmt**

francis-jones morehen thorp

NOMINATED ARCHITECT: RICHARD FRANCIS-JONES (REG NO 5301)

SYDNEY

Level 5, 70 King Street  
Sydney NSW 2000 Australia  
T +61 2 9251 7077  
F +61 2 9251 7072  
E [fjmt@fjmt.com.au](mailto:fjmt@fjmt.com.au)  
W [www.fjmt.com.au](http://www.fjmt.com.au)

PROJECT

Central Park Block 11  
O'Connor Street, Chippendale  
Sydney  
Fraser's Broadway

TITLE

ENVIRONMENTAL ANALYSIS  
Apartment Solar Access Analysis - October 21

SCALE	DRAWN	FJMT	PROJECT CODE
DATE	24/10/2014	APPROVED	SB
SHEET NO.	SSDA-11-712	REVISION	01

Issued for Approval