

KEY

- Darling Square (DS) Boundary
- NW Plot DA Boundary
- Scope of this S96

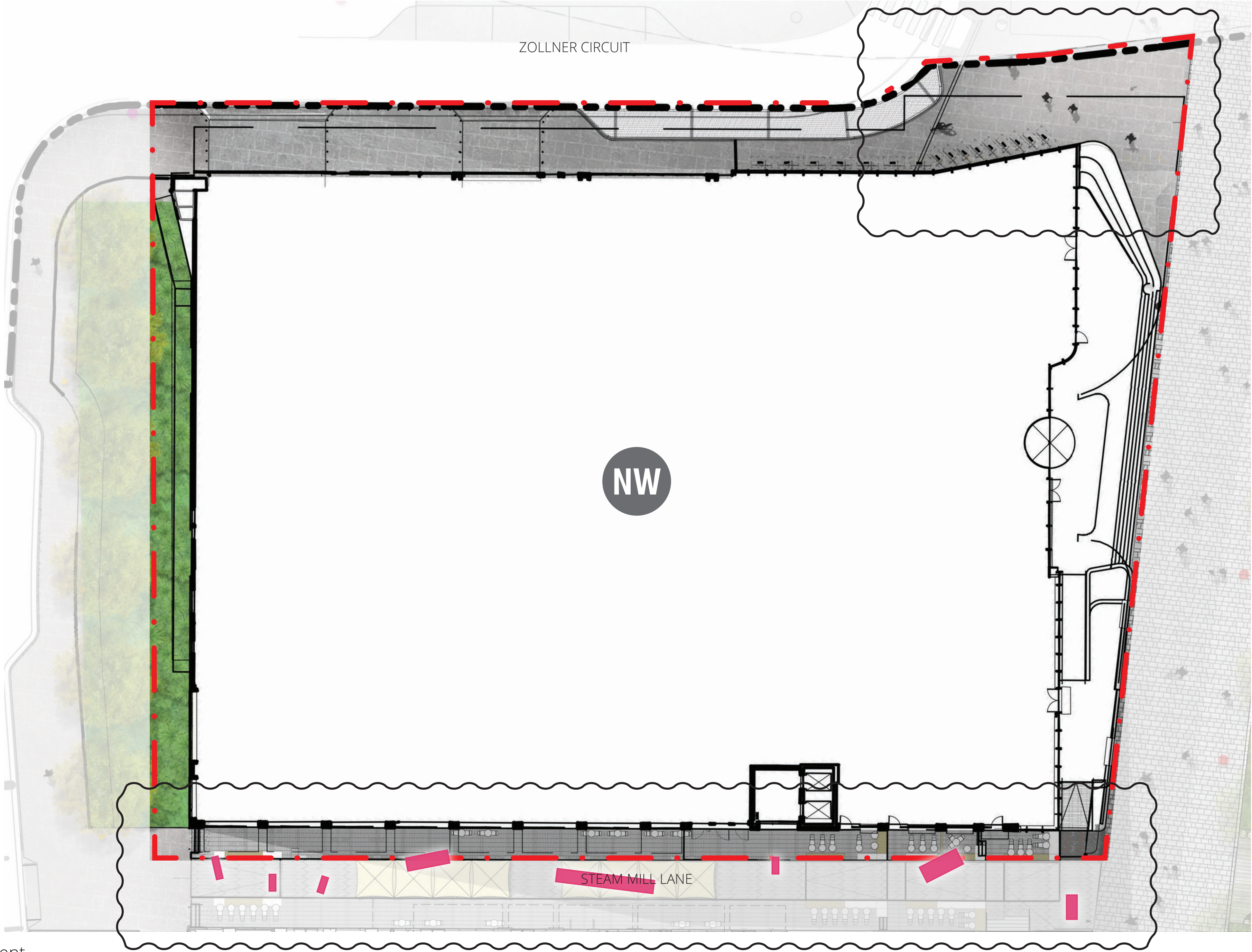

DRAWING LIST

Number	Title
14076-SSDA5-S96-(A)-001	Drawing List
14076-SSDA5-S96-(A)-201	General Arrangement
14076-SSDA5-S96-(A)-211	Planting Plan
14076-SSDA5-S96-(A)-212	Urban Elements Plan
14076-SSDA5-S96-(A)-010	General Arrangement Plan - Steam Mill Lane
14076-SSDA5-S96-(A)-011	Cross Sections - Steam Mill Lane
14076-SSDA5-S96-(A)-012	Perspective Views - Steam Mill Lane

KEY

- Darling Square (DS) Boundary
- NW Plot DA Boundary
- Scope of this S96

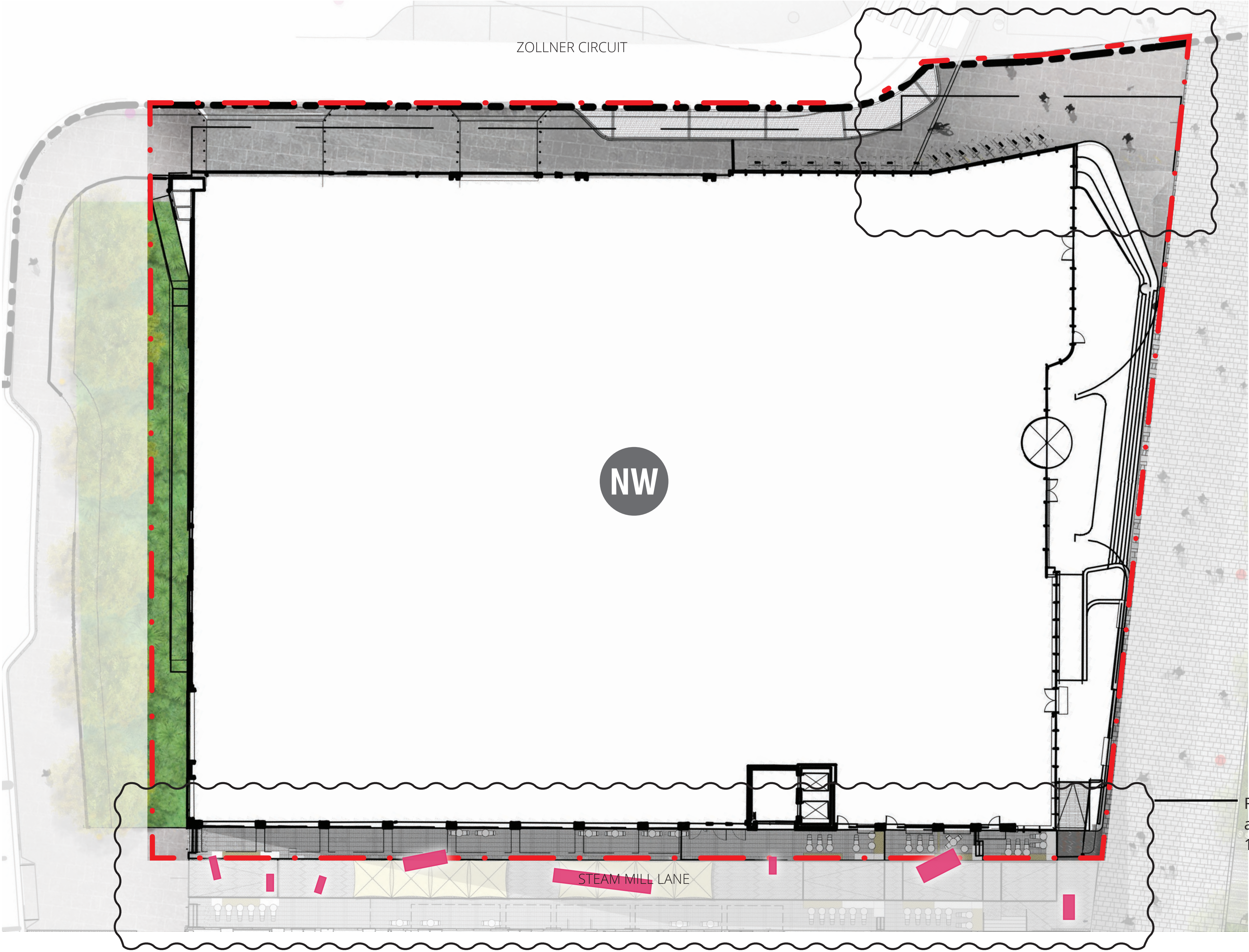

Refer to detailed general
arrangement plan.
14076-SSDA4-S96-010

KEY

- Darling Square (DS) Boundary
- NW Plot DA Boundary
- Scope of this S96

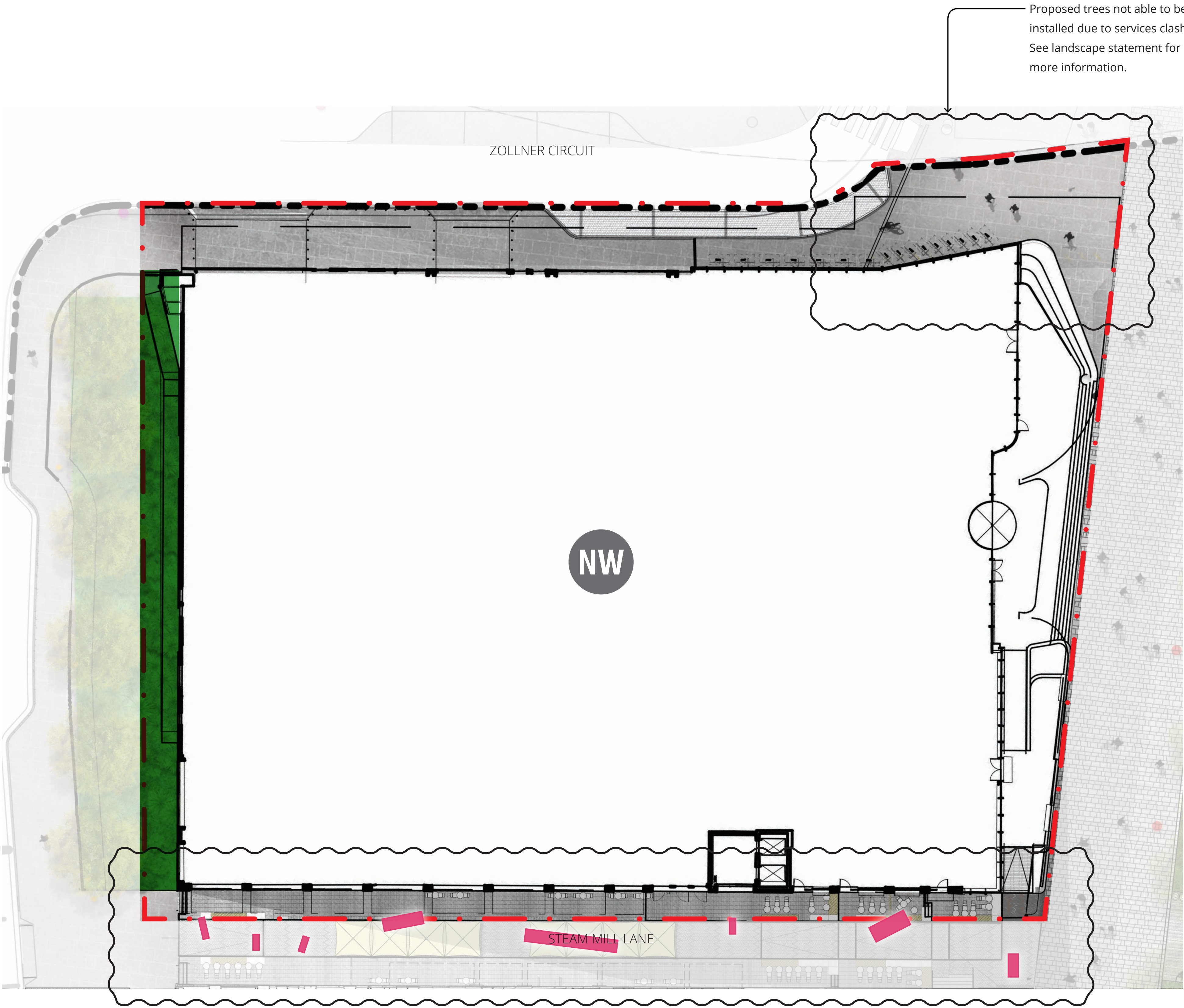

Darling Drive - Bio Fitratio Swale



Juncus usitatus

Carex apressa



Lomandra tanika



Isolepis nodosa



KEY

- Darling Square (DS) Boundary
- NW Plot DA Boundary
- Scope of this S96

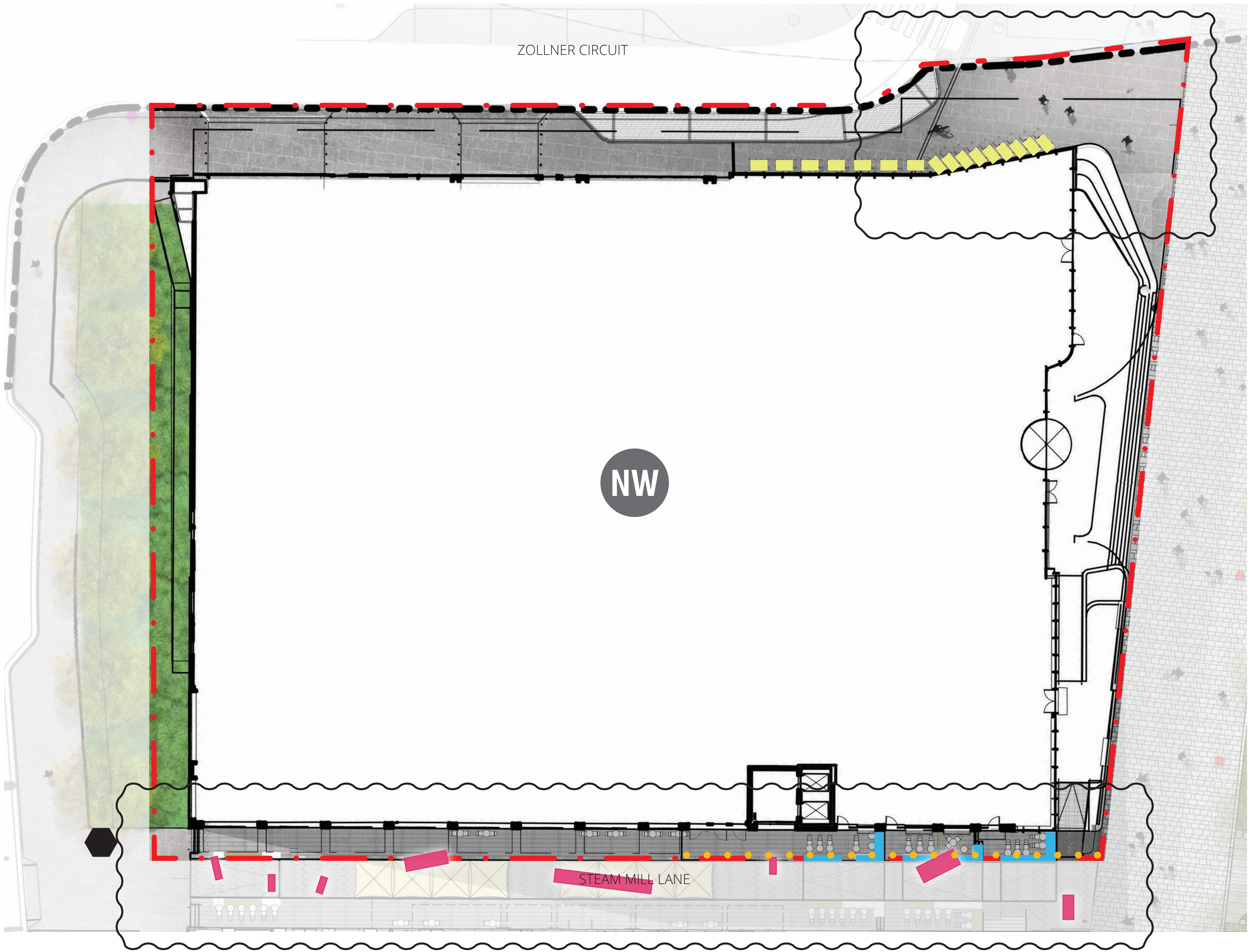

Bike Rail

Material - Stainless steel
CHS
Location - Theatre Drive
Colour - Stainless Steel
Number - 32 Parks (16
hoops)



Under Awning code Lighting

Material - under awning
lights
Location - Dickson's Lane
Fixing- Waterproof



Lighting - Steam Mill Lane

Material - Catenary
mounted artwork with
integrated lighting

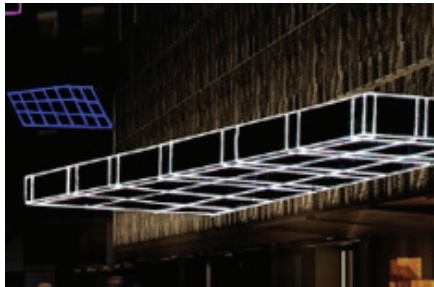

Custom Furniture - Steam Mill Lane

Material - Precast
concrete (class 2) and
hardwood timber

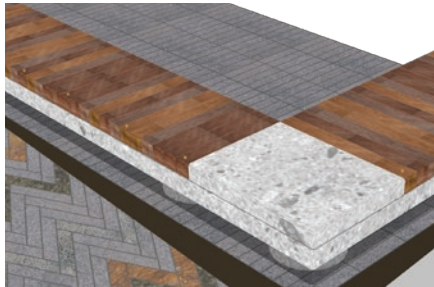

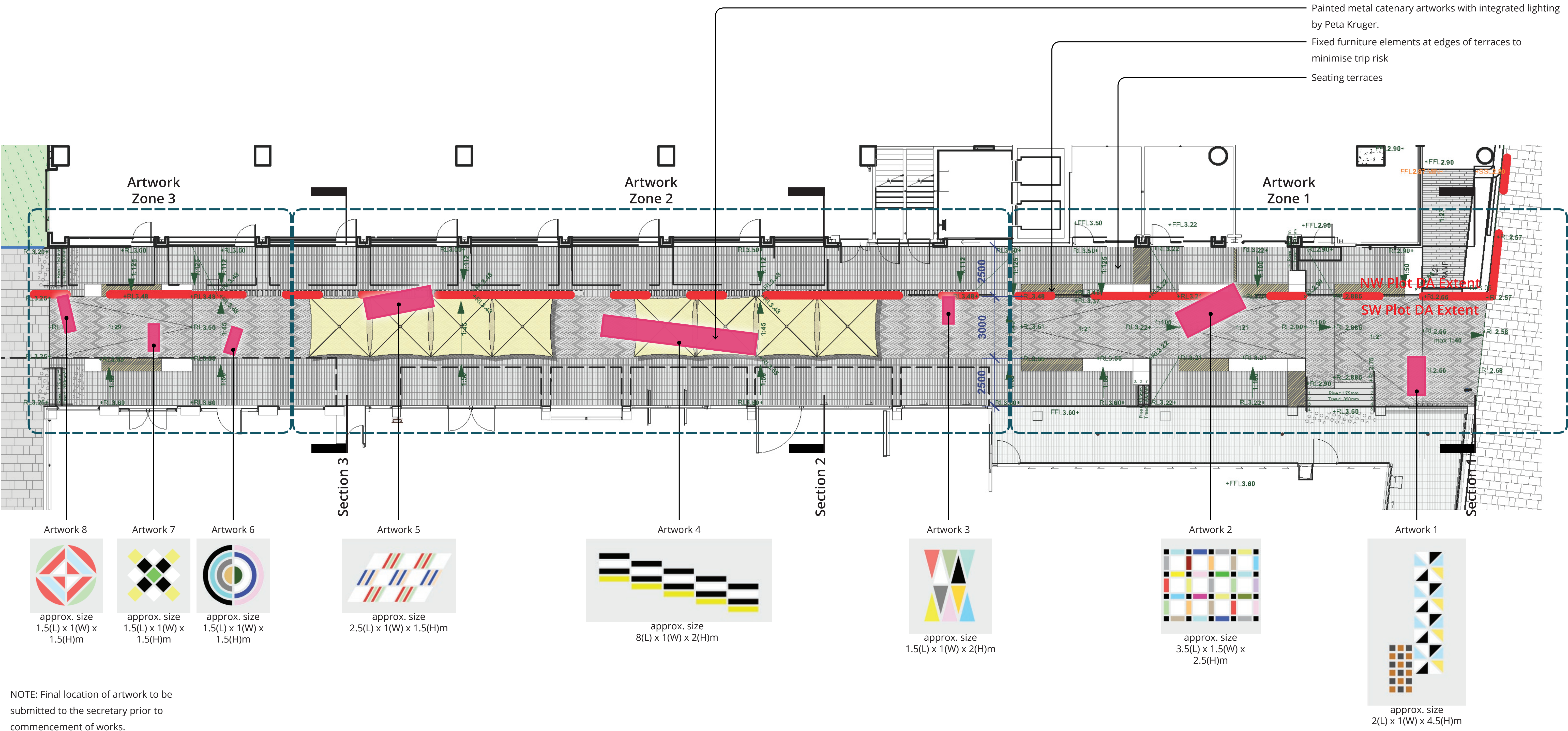

--- SW Plot DA Boundary

NOTE: This drawing supercedes drawing 6 on L302 (dated 27.01.2014)

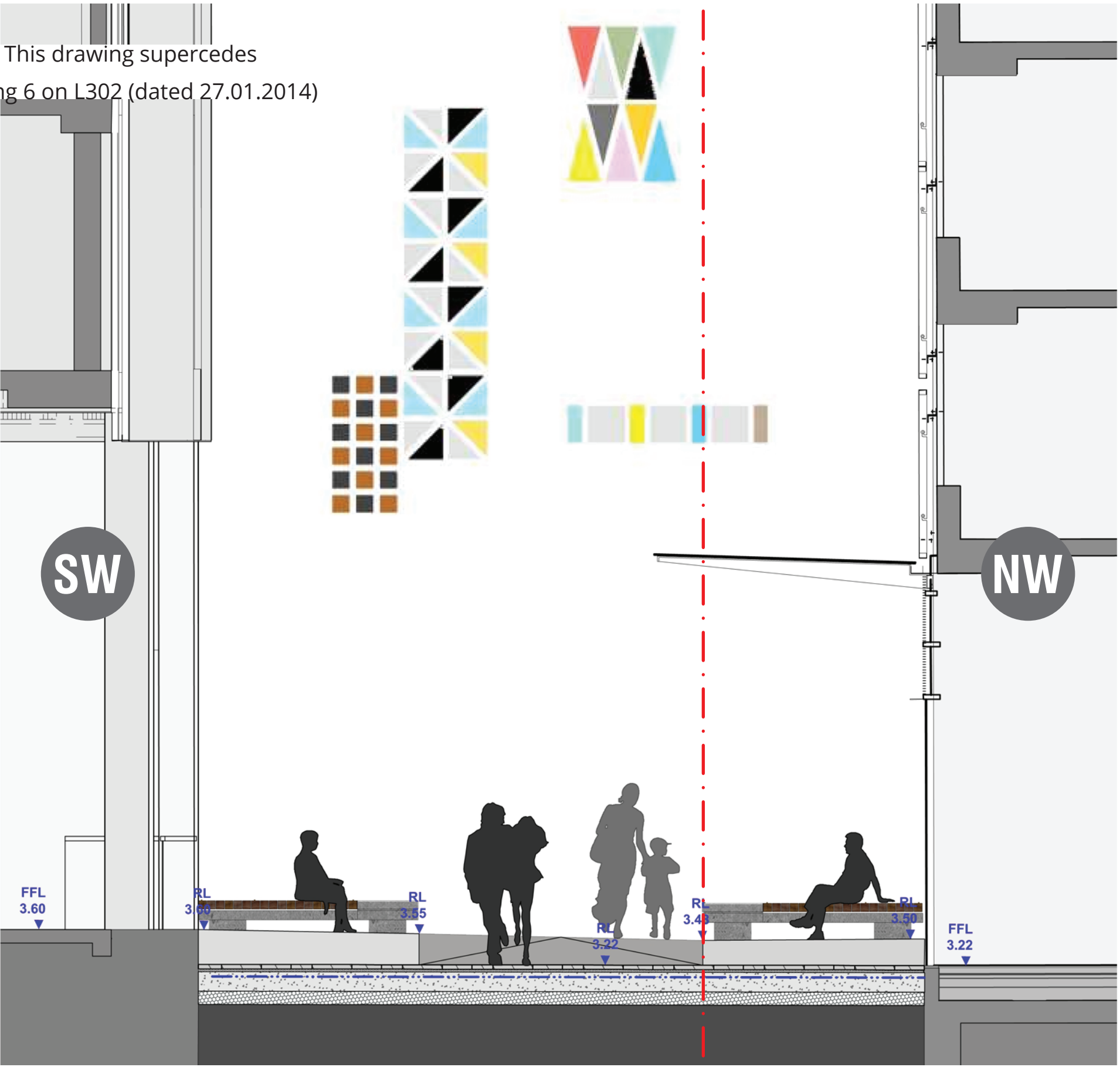

SECTION 1 (ZONE 1) - DAY VIEW

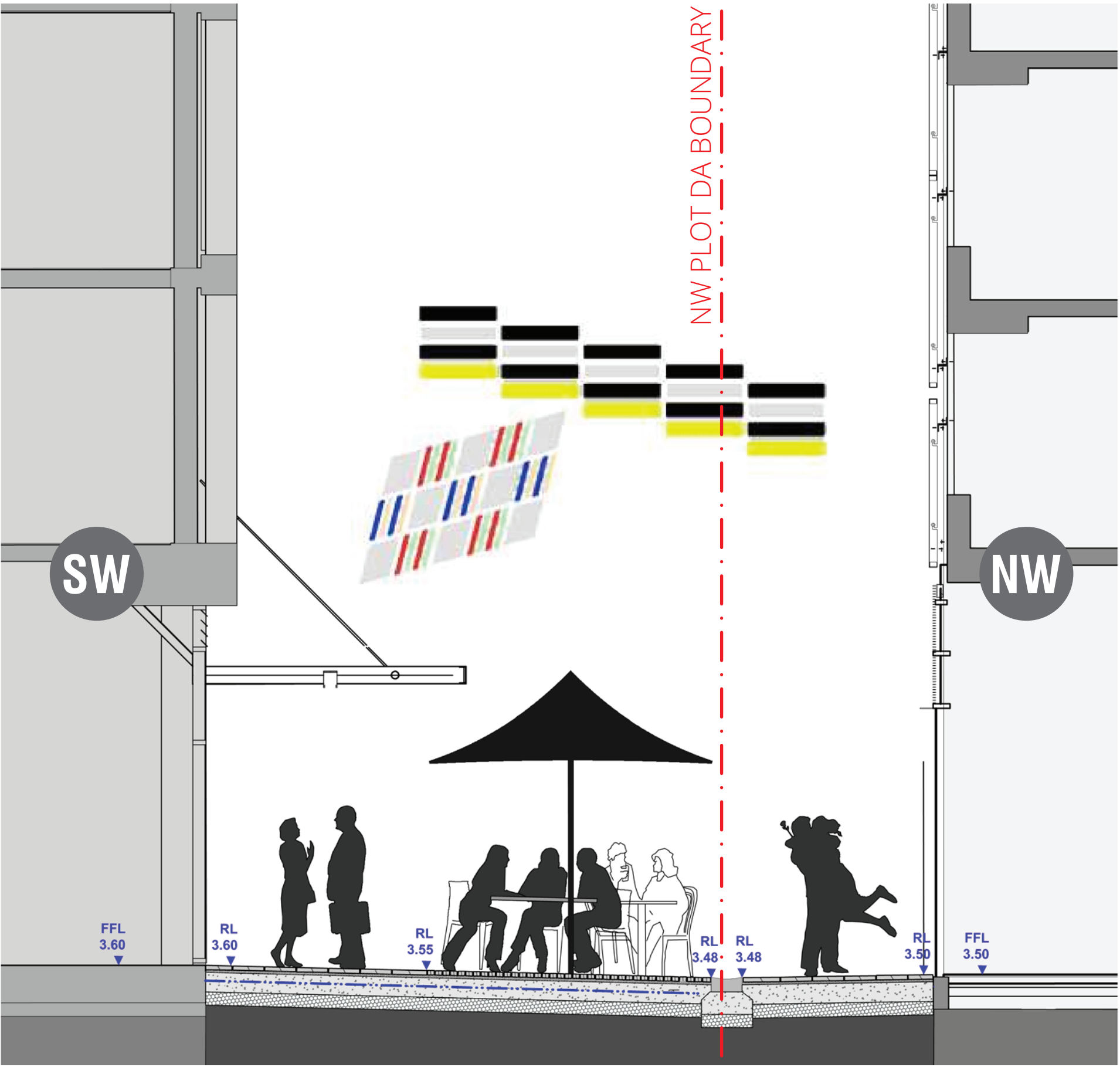

SECTION 2 (ZONE 2) - DAY VIEW

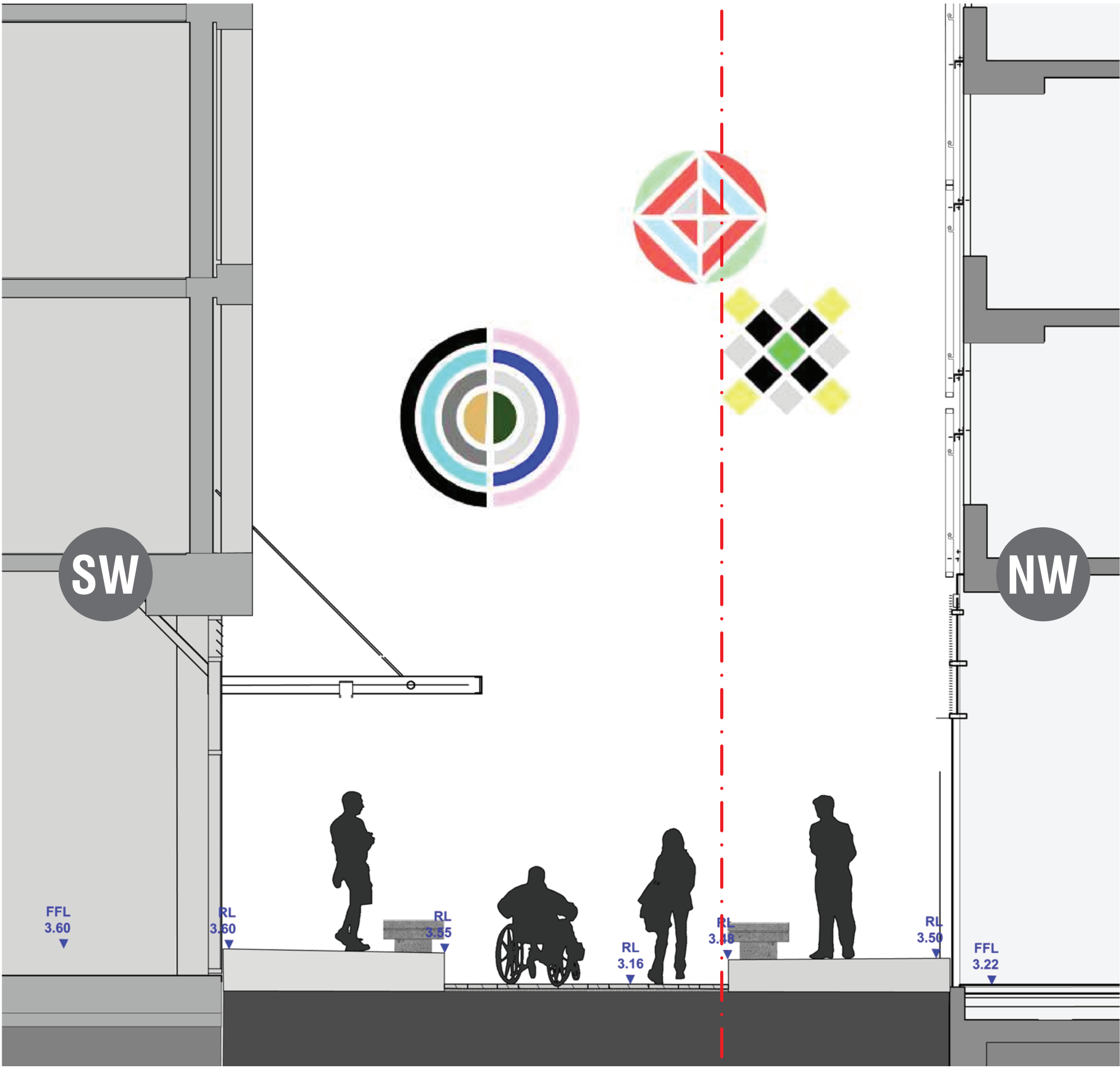

SECTION 3 (ZONE 3) - DAY VIEW

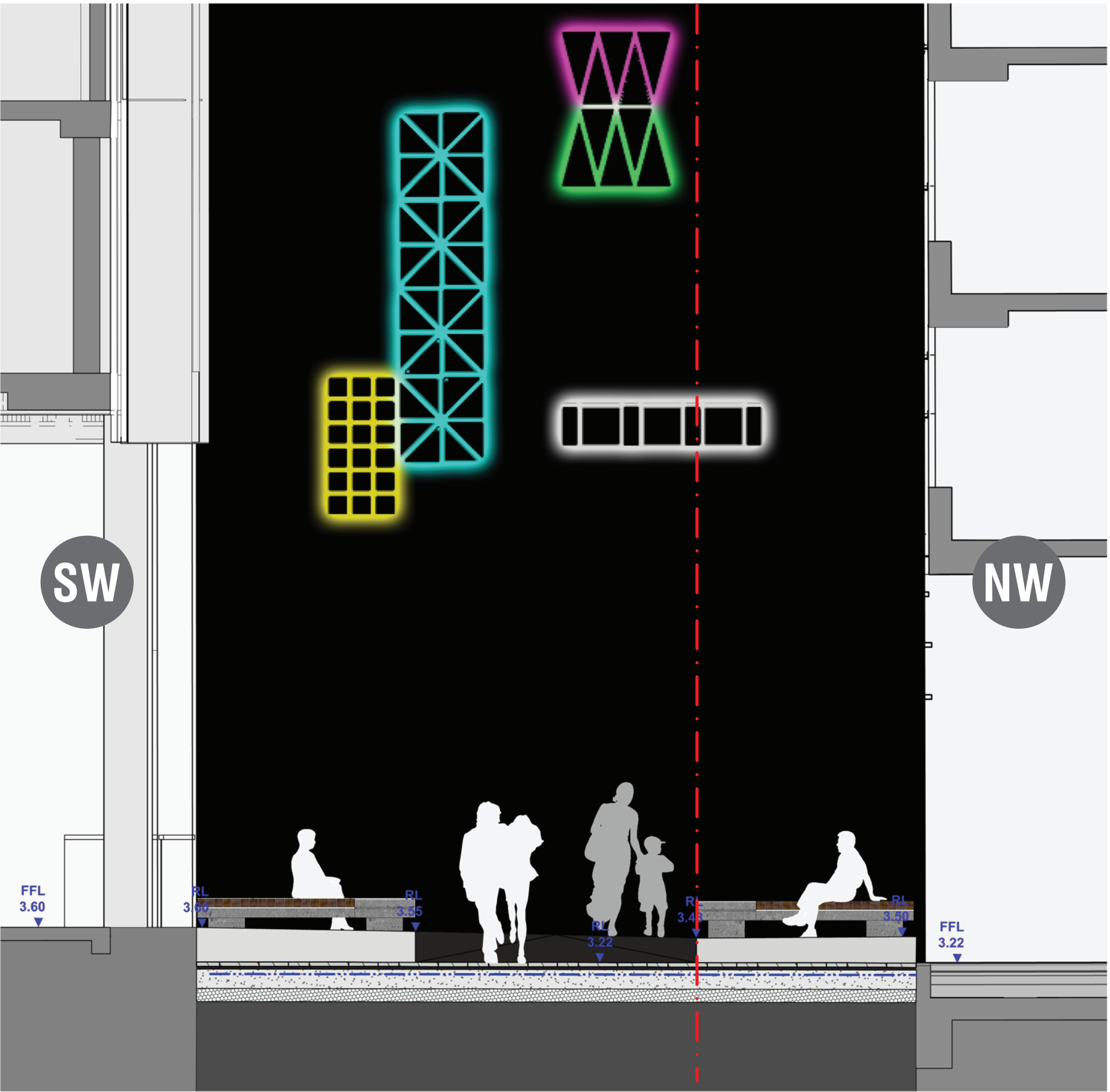

SECTION 1 (ZONE 1) - NIGHT VIEW

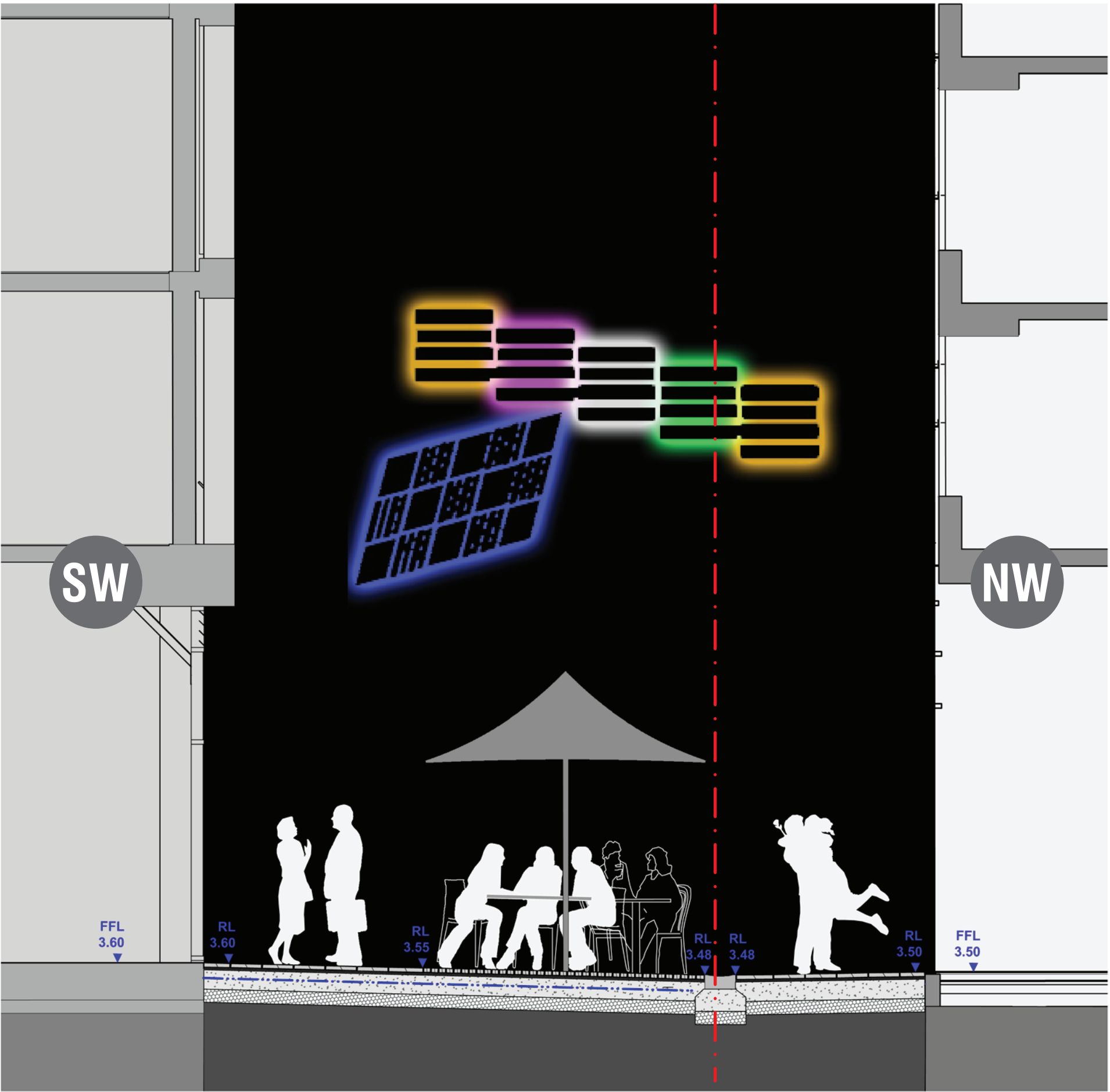

SECTION 2 (ZONE 2) - NIGHT VIEW

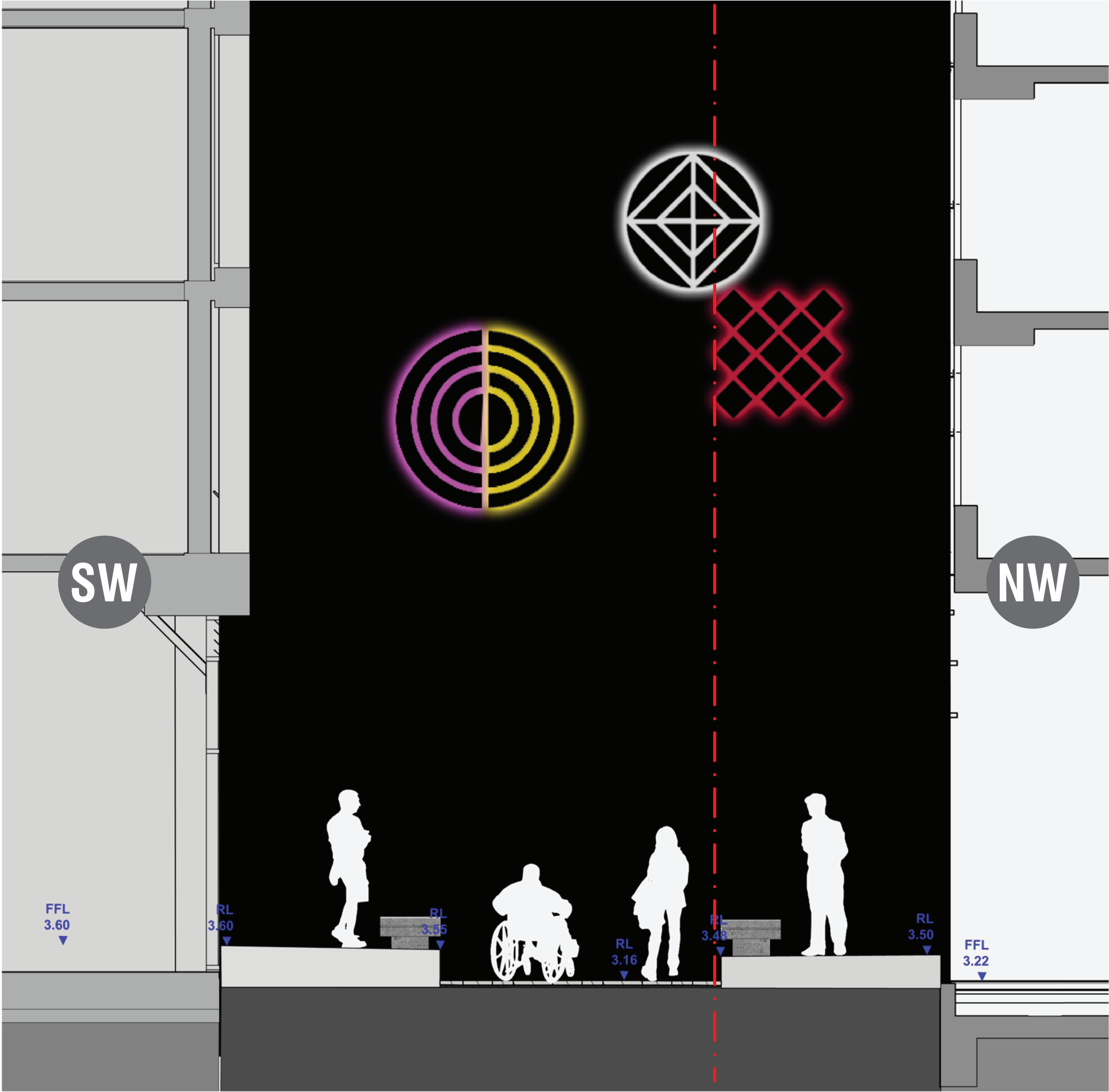

SECTION 3 (ZONE 3) - NIGHT VIEW

Darling Square, NW Plot

ASPECT Studios™

Client: Lendlease Haymarket



Drawn: LN
Checked: LP

Scale: 1:50 @ A1
Date: May 2017

0 1 2 3 4m



Dwg no.: 14076-SSDA4-S96-011
Rev: E

CROSS SECTIONS - STEAM MILL LANE ARTWORK BY PETA KRUGER



PERSPECTIVE VIEW - DAY VIEW

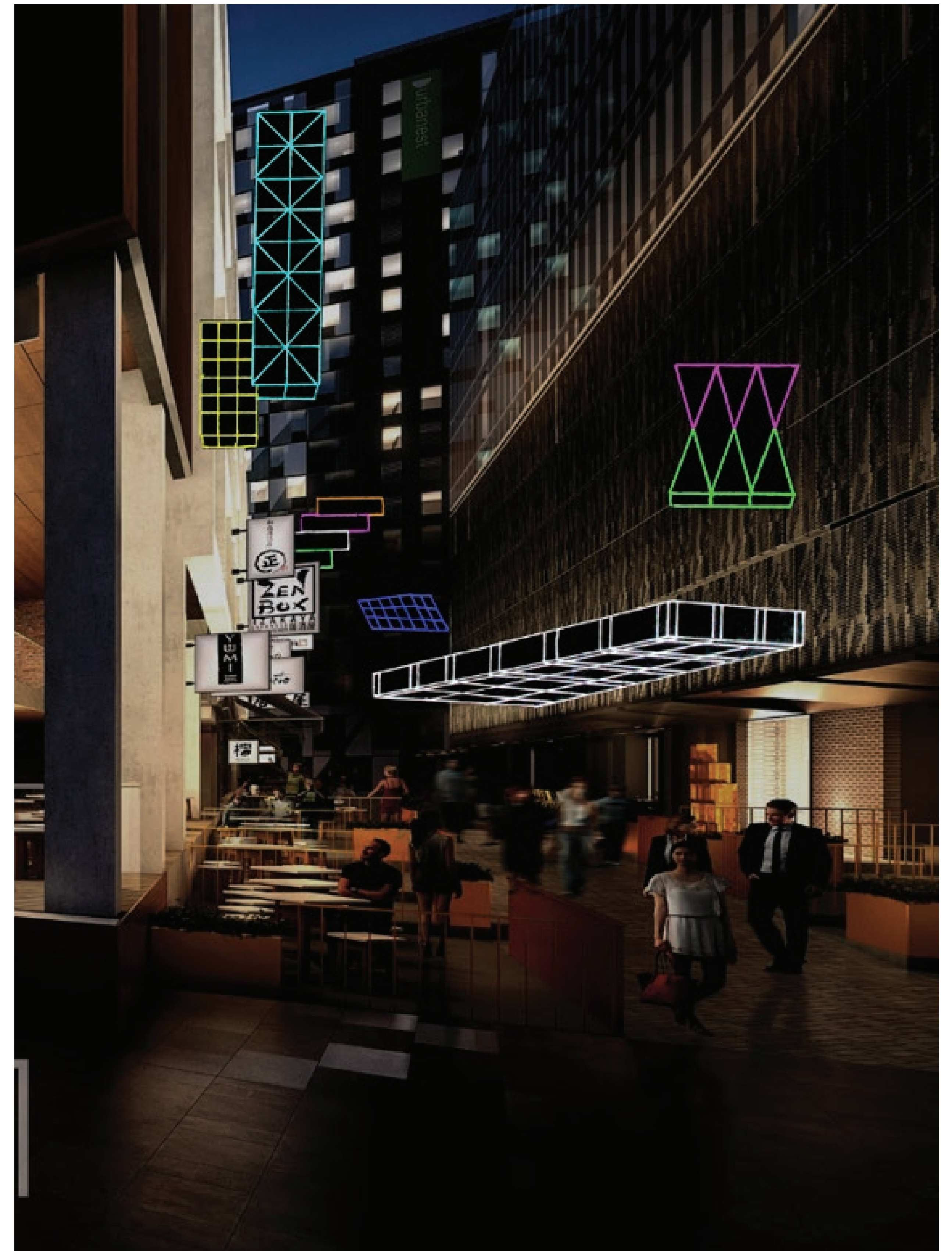

PERSPECTIVE VIEW - NIGHT VIEW

Darling Square, NW Plot

ASPECT Studios™

Client: **Lendlease Haymarket**



Drawn: **LN**
Checked: **LP**

Scale: **1:100 @ A1**
Date: **May 2017**



Dwg no.: **14076-SSDA4-S96-012**
Rev: **E**

PERSPECTIVE VIEWS - STEAM MILL LANE (ARTWORK BY PETA KRUGER)