



Figure 5.4.4.2 Hay St Concept Image

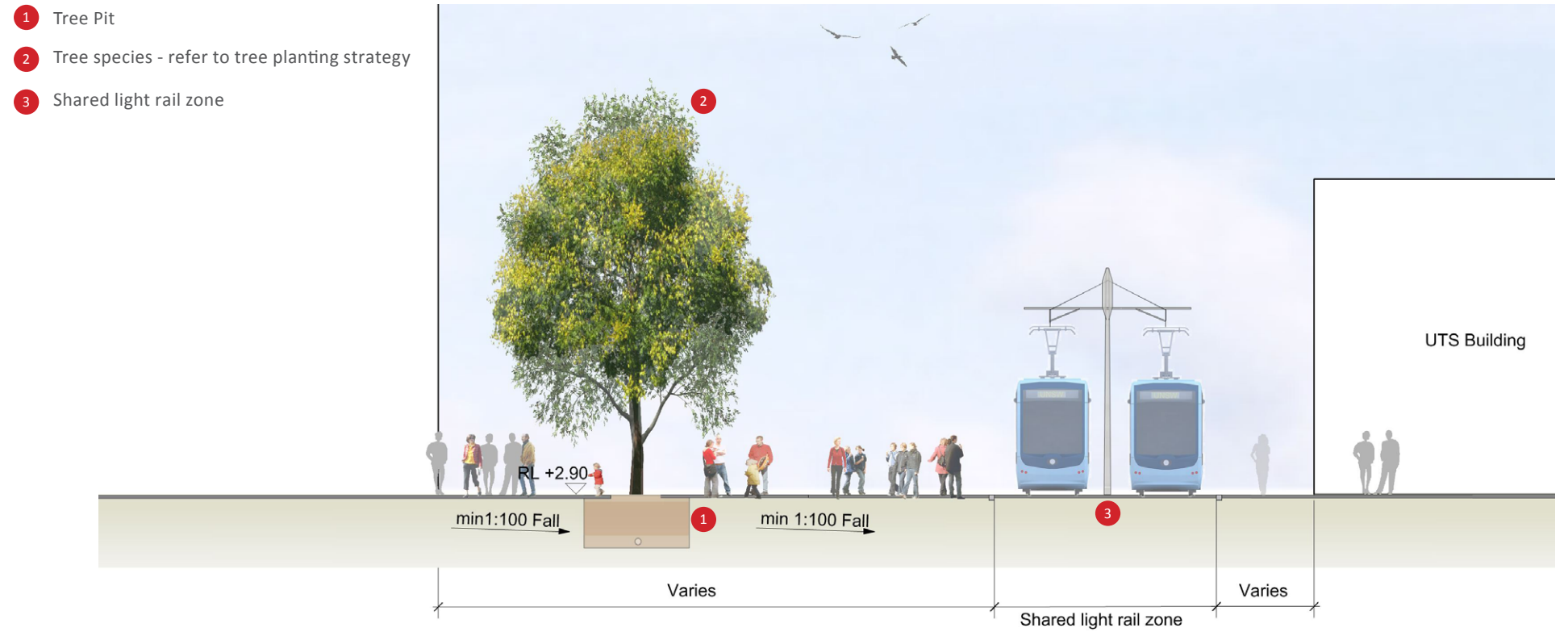
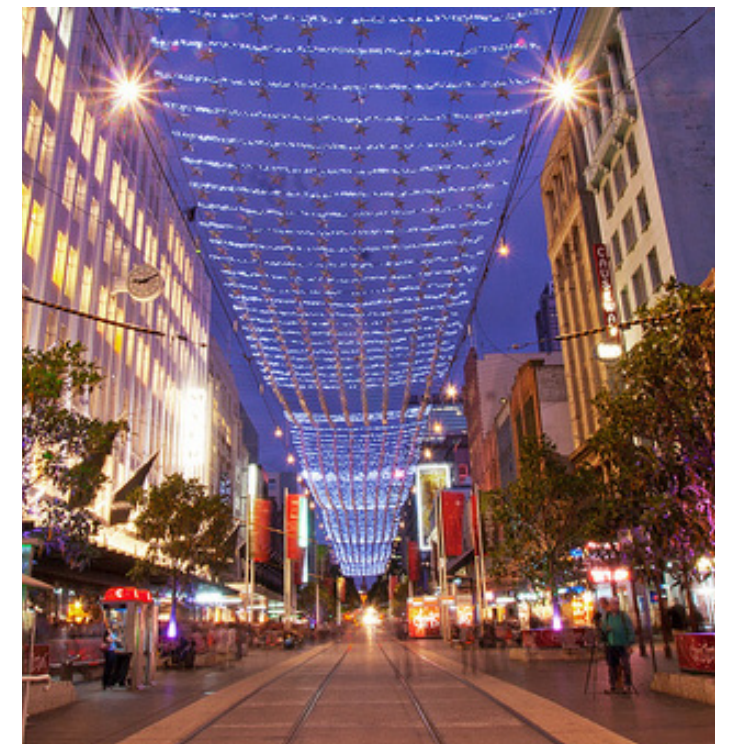

Figure 5.4.4.3 Section 4 A through Hay St and the LRT corridor



Bern, Switzerland. Source -

Subtle variations in stone paving provides enough clarity for users to safely share this street



Bourke St Mall, Melbourne. Source -

Catenary cables fixed to heritage facades in Melbourne's main retail street. An integrated lighting display illuminates the space at night.



Legible shared environments. Source - New Road, Landscape Projects and Gehl Architects

A simple material palette and clutter free spaces help to achieve a robust and active shared space.

5.4.5 MACARTHUR PLACE

Situated at the south western corner of The Haymarket precinct, Macarthur Place will be a secondary square associated with the proposed student accommodation along Darling Drive and a space for cyclists to park, away from the main Haymarket retail zone. This space provides a visual termination point to The Goods Line which will be utilised as the main entry to the Haymarket precinct from the west and south.

Access from Harris Street and the Powerhouse Museum will be improved through an upgrade of the existing overhead walkway from Harris Street. It is proposed as part of this DA the walkway be terminated at its junction with the Goods Line and a new lift and stair access installed. Access from the walkway will be directly onto the paved pedestrian link of the Goods Line. From here, pedestrians will achieve an elevated view over Macarthur Place and beyond to the Haymarket precinct. This is important in improving the legibility of site access and wayfinding from the west and the south. The proposed steps and ramp of The Goods Line (subject to a separate proposal) will bring pedestrians to the signalised crossing on Darling Drive and access to Hay Street.

Macarthur Place will provide open space and gathering opportunities for students, with seating and tables for their use, a simple restful palette of materials such as decomposed granite will be combined with planters and a grove of trees to create a more park like environment than the urban fabric of Haymarket Square.

Bike racks and seating will provide cyclists the opportunity to rest or park their bikes outside of the busier precinct environment.

Planting will be used as a buffer and barrier to the Light Rail which runs around the south western edge of Macarthur Place.

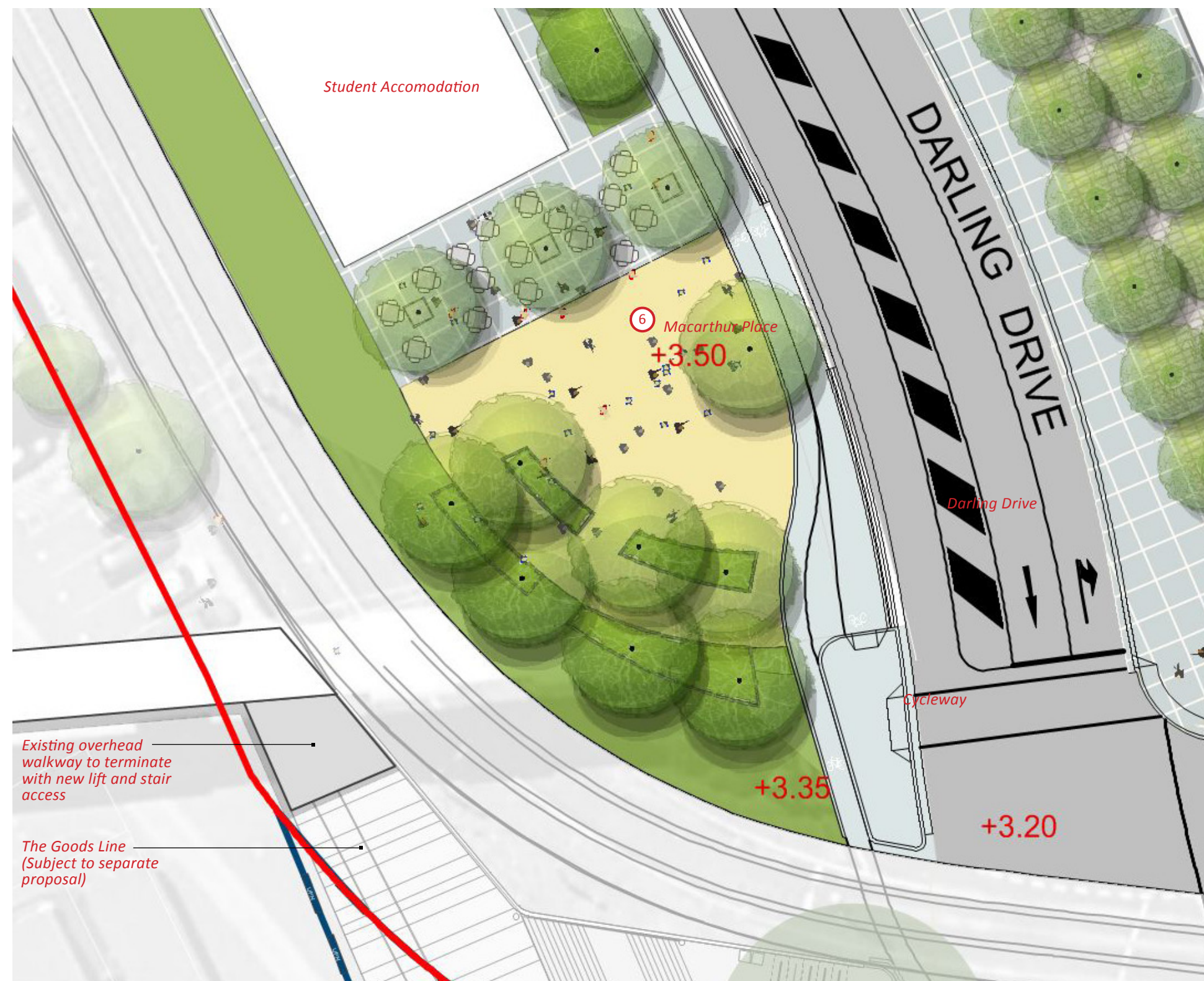

⑥ Macarthur Place character zone

Figure 5.4.5.1 Macarthur Place Public Domain Plan

Macarthur Place will be a calm, yet visually interesting space, designed as a temporary gathering space for cyclists, pedestrians, locals and visitors as well as an important external relaxation and recreation space for students. CPTED principles of lighting, ownership and surveillance will be key to create a space that is strongly connected with the students, safe for them to use and well looked after.



Decomposed granite and paving



Decomposed granite and paving



Integral seating within planter

6.0 PUBLIC DOMAIN STRATEGY

6.1 MATERIALS

Materials across the site will reflect the hierarchy of public domain space within The Haymarket precinct. The palette of materials will be restrained, robust and of high quality. The spaces as defined by the built form and the activity generated therein will be knitted together by the surface materiality.

The Boulevard, square and laneways will require a paving material that is not only of high quality appearance but also hard wearing, easy to clean, trafficable where necessary and that facilitates fine grain detailing.

Natural stone or similar will be used to pave these spaces as it meets the above named criteria, and allows for subtle variation in size, format, tone and texture across the various spaces whilst maintaining a consistency in quality and durability.

The Boulevard will be paved in large format high quality pavers in keeping with other Sydney civic spaces of this nature such as Martin Place and Pitt Street Mall. The Boulevard will be paved consistently the length of the site.

The Square and the laneways will be paved in high quality paving, in light tonal colours, utilising a variety of textures and smaller unit sizes in order to generate a more intimate and local character to these spaces.

Areas defined as local squares such as Macarthur Place will be softer in their materiality in order to create a less civic appearance and to appeal to people in a different way. Decomposed granite and raw materials will provide textural interest in walls, seats and surface materials. Timber decking may be utilised to create a softer edge to the north east corner of the square, wrapping around to define the edge of the existing Pumphouse plaza paved in red brick.

The perimeter pavement spaces to the east of Darling Drive and Hay Street are themselves important spaces for movement and for drawing people into the heart of the precinct, but are seen as secondary to the Square and Boulevard in terms of material hierarchy.

Figure 6.1.1 illustrates the strategy for paving across the precinct

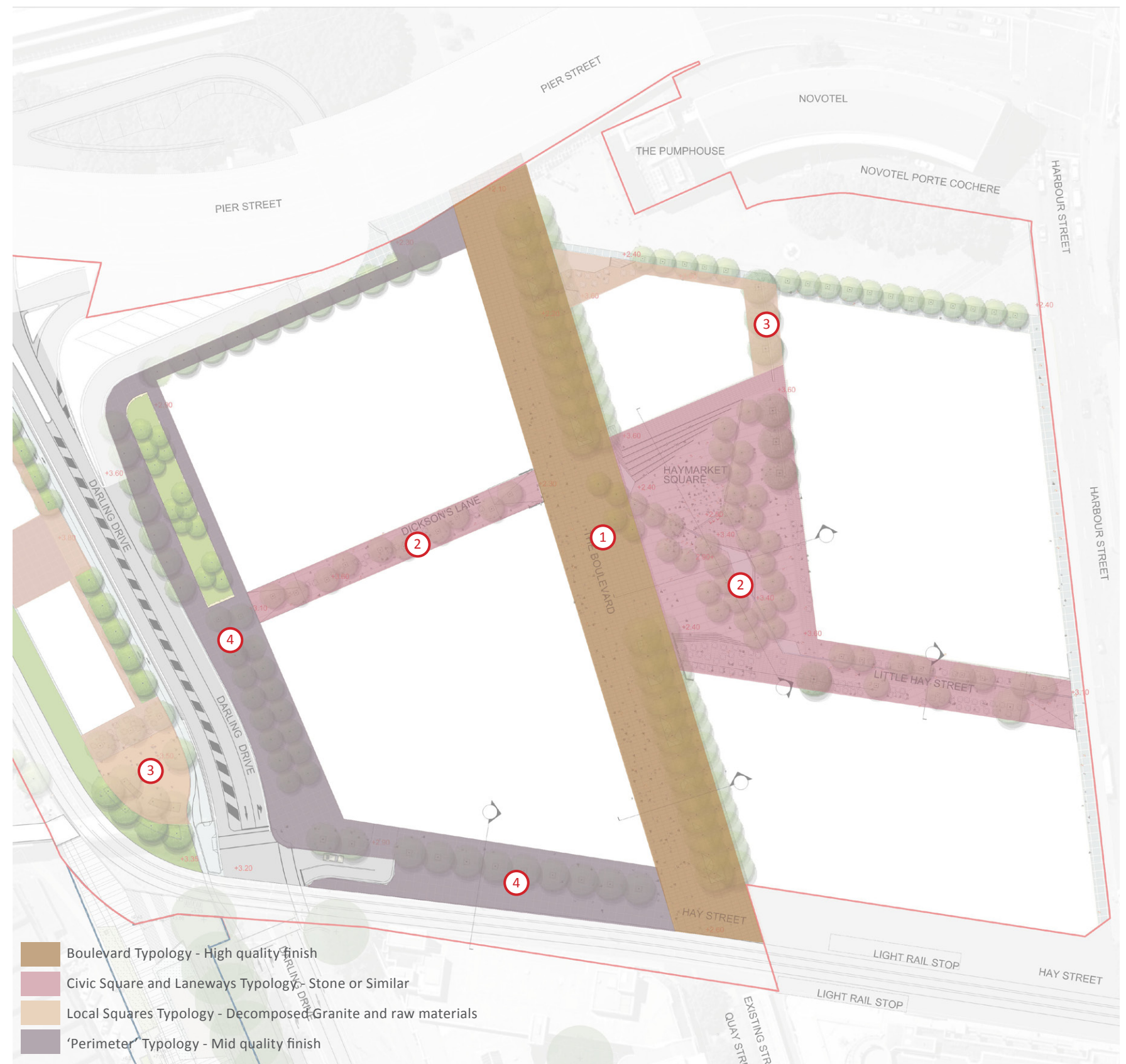

Figure 6.1.1 Haymarket Materials Strategy Diagram