

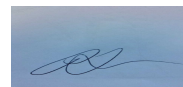

PLAN KEY:

- SIGNAGE CONFORMING TO AS1742.3 AND T.C.A.W.S
- CONSTRUCTION VEHICLE
- DEVELOPMENT SITE
- TRAFFIC DIRECTION
- CONSTRUCTION ROUTE
- LIFTING, WORK AND EXCAVATION ZONES TO BE BOUNDED BY TEMPORARY SAFETY FENCE.
- ADVANCE WARNING TRUCK SYMBOL TO BE PLACED 50M IN ADVANCE OF DRIVEWAYS, INTERSECTIONS IN USE FOR HAULAGE THROUGHOUT SITE.
- CAUTION TRUCKS CROSSING**
ADVANCE WARNING SIGNAGE TO BE PLACED 10 METRES IN ADVANCE OF TRUCK CROSSING NOMINATED PEDESTRIANS ROUTES FOR CONSTRUCTION PERSONNEL.

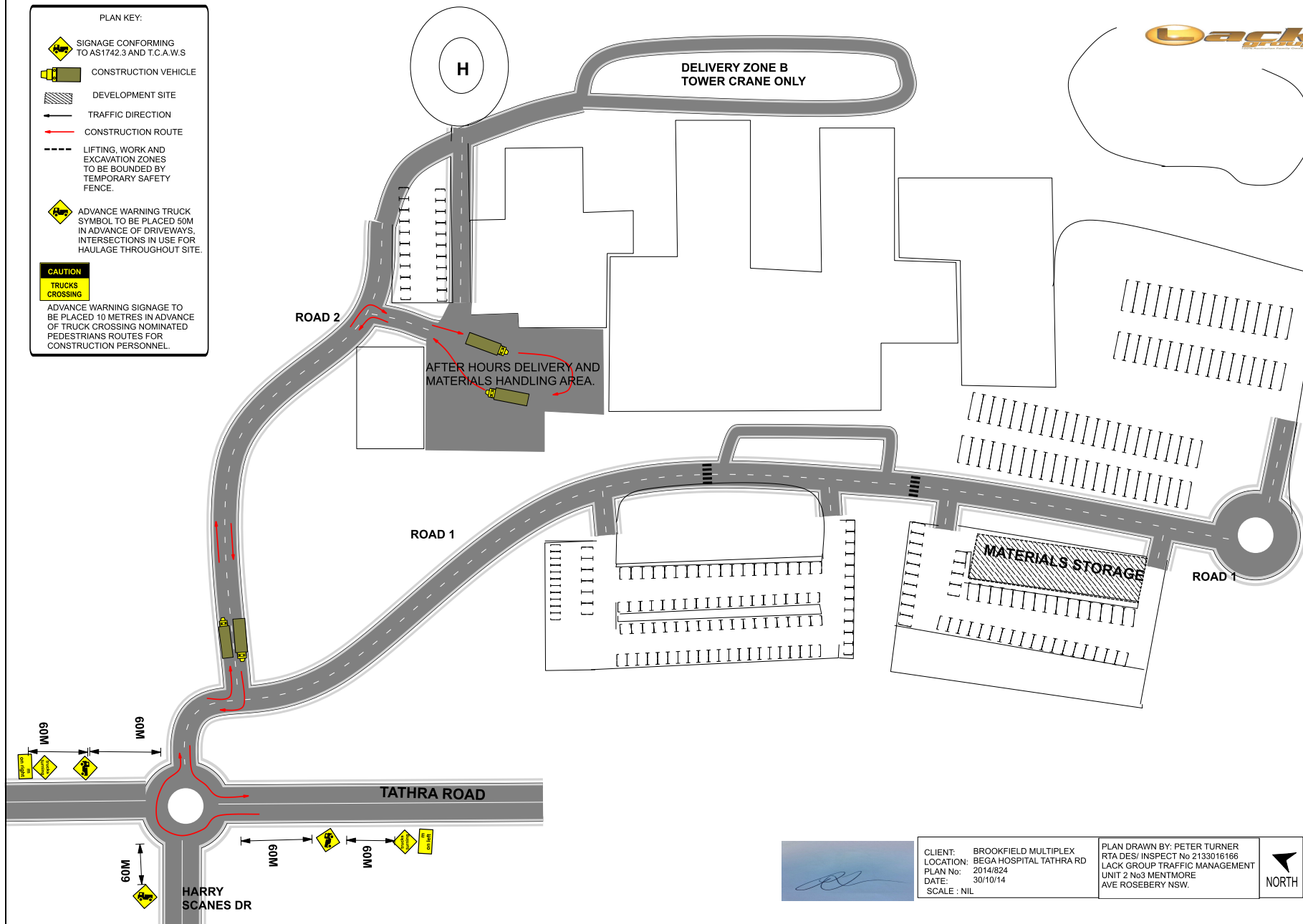

CLIENT: BROOKFIELD MULTIPLEX
 LOCATION: BEGA HOSPITAL TATHRA RD
 PLAN No: 2014/824
 DATE: 30/10/14
 SCALE: NIL

PLAN DRAWN BY: PETER TURNER
 RTA DES/ INSPECT No 2133016166
 LACK GROUP TRAFFIC MANAGEMENT
 UNIT 2 No3 MENTMORE
 AVE ROSEBERY NSW.

