

INSTALLATION

1. EXCAVATE A TRENCH 200mm DEEP.
2. DRIVE POSTS 500-700mm INTO GROUND AT A MAXIMUM SPACING OF 3.0m CENTRES.
3. PLACE AND FIX SUPPORT MESH (F52) TO POST.
4. LAY BIDIM GEOFABRIC (SF 2000) AGAINST THE SUPPORT MESH AND FIX BY TIE WIRE, STAPLES OR HOG RINGS.
5. PLACE BIDIM IN TRENCH AND BACKFILL WITH SOIL.

NOTE:
POSITION OF SEDIMENT FENCE AS DIRECTED BY SUPERINTENDENT. FENCE TO REMAIN IN PLACE UNTIL EXCAVATION IS BELOW FOOTPATH LEVEL. PROVIDE 2m x 2m TURFED AREA ON DOWNSTREAM SIDE OF FENCE AT SURCHARGE OPENINGS.

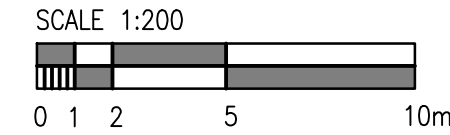
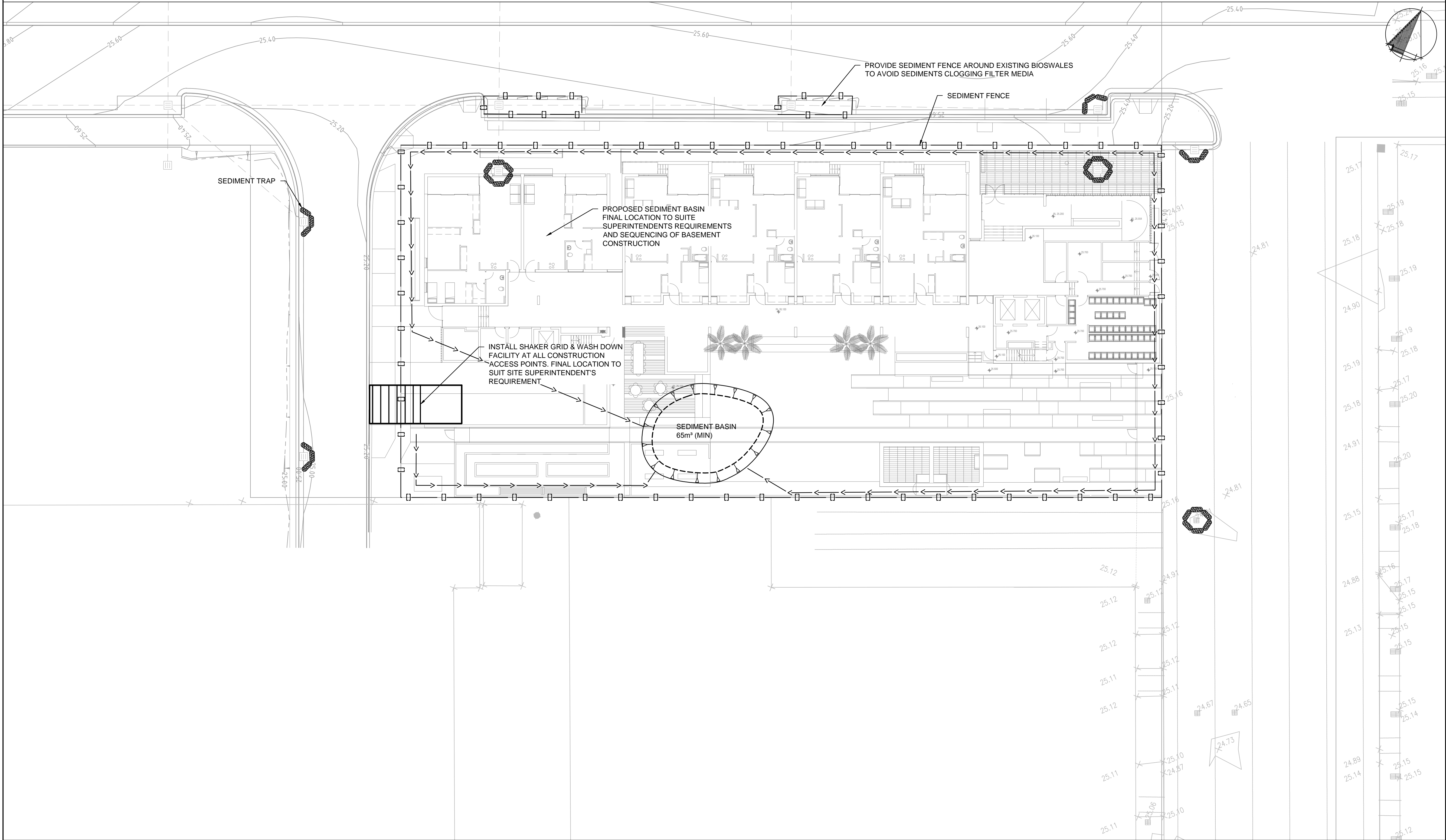
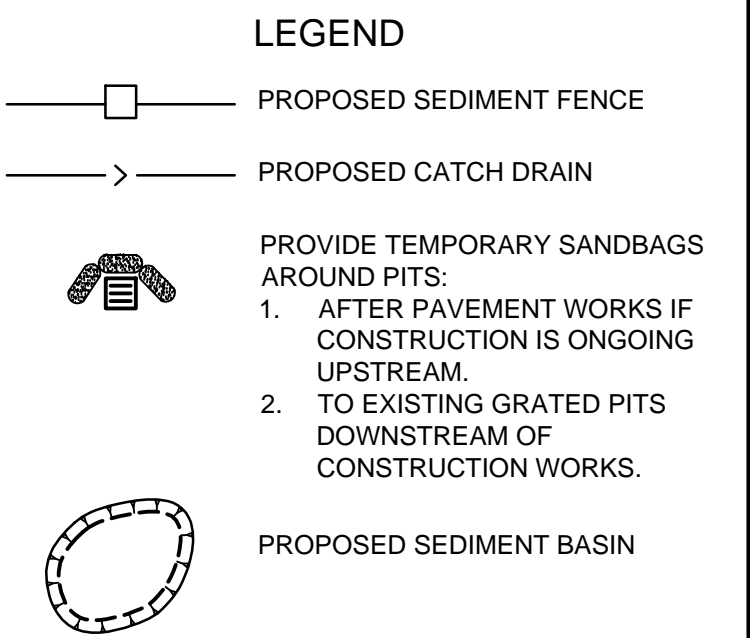
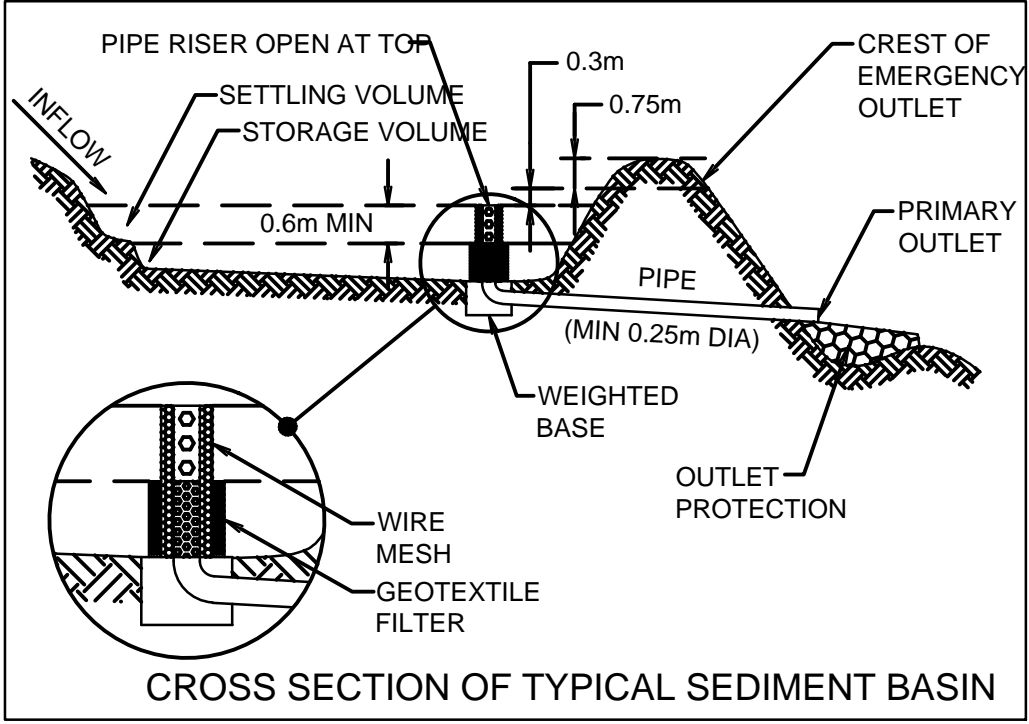
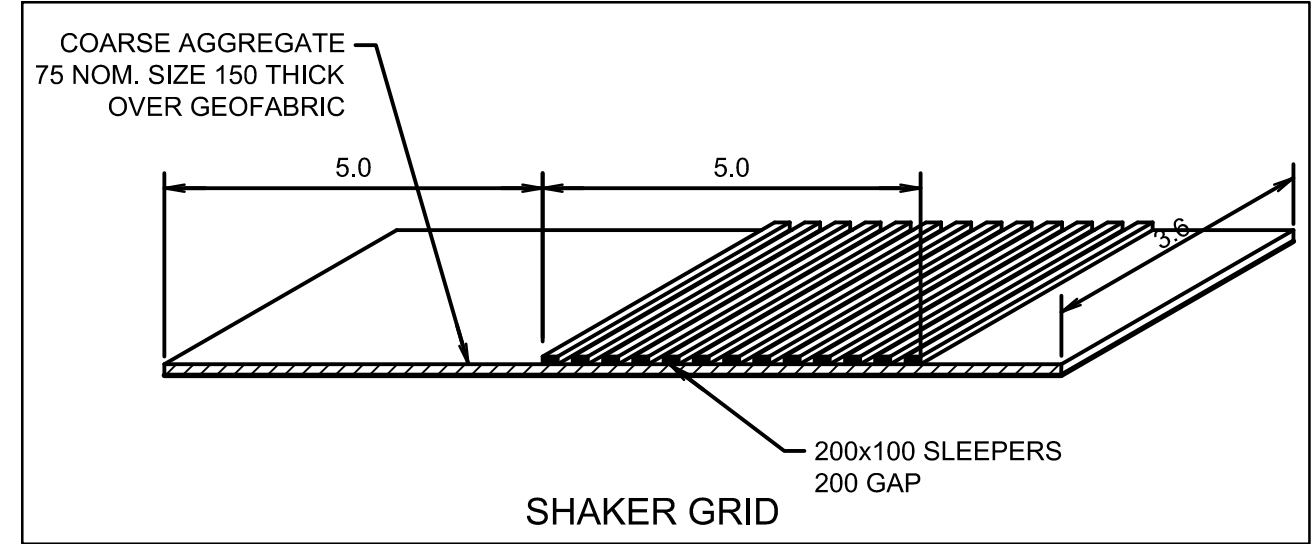
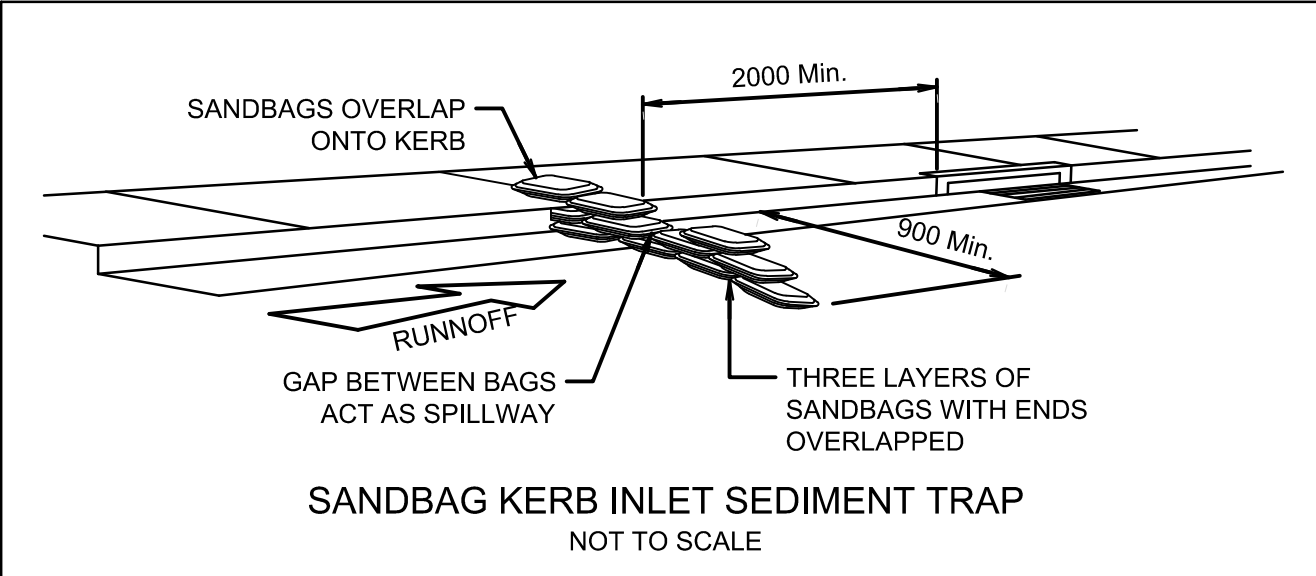

02	22.03.13	FOR APPROVAL	DB	IH
01	05.03.13	FOR INFORMATION	DB	IH

rev	date	description	drn	ch'k
-----	------	-------------	-----	------

enstruct group pty ltd
Level 4, 2 Glen Street
Milsons Point NSW 2061
Australia
Telephone (02) 8904 1444
Facsimile (02) 8904 1555
http: // www.enstruct.com.au



project
NORTH EVELEIGH
AFFORDABLE HOUSING
PROJECT

drawing title
EROSION AND SEDIMENT CONTROL

status
FOR APPROVAL

scale at A1 1:200	drawn by DB	checked IH	date 04/03/13
----------------------	----------------	---------------	------------------

project no. 4554	drawing no. 4554-C-800	rev. 02
---------------------	---------------------------	------------