

SYDNEY EXHIBITION FACILITIES @ GLEBE ISLAND

SYDNEY, NSW

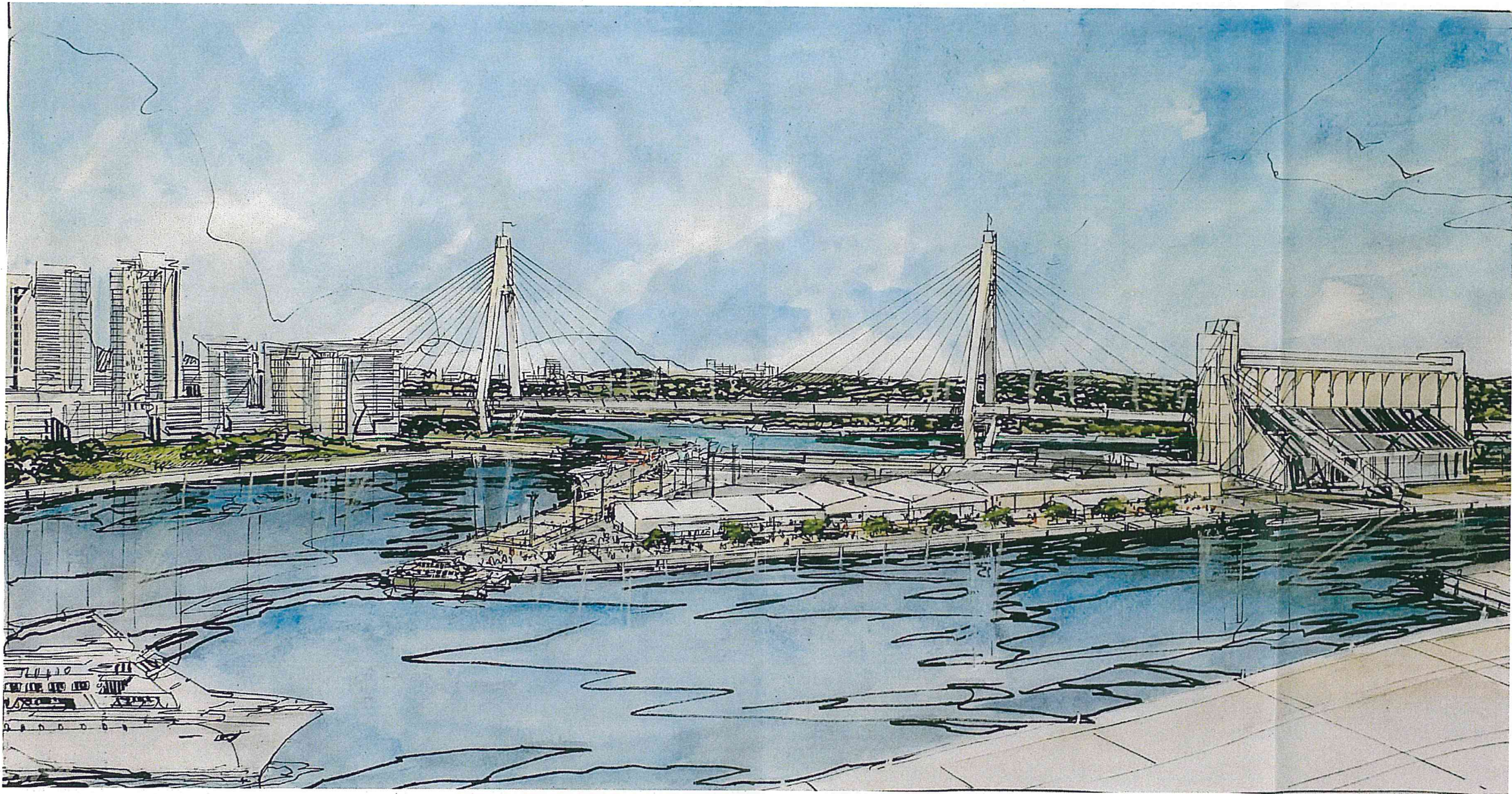

insw Infrastructure
New South Wales

DRAWING NUMBER	REVISION	DRAWING NAME
A1000	D	LOCATION PLAN
A1001	D	SITE ANALYSIS PLAN
A1002	D	SITE PLAN
A2200	E	FLOOR PLAN
A2700	D	CAR PARK A LAYOUT PLAN
A2701	D	CAR PARK B & C LAYOUT PLAN
A2702	D	CAR PARK D & E LAYOUT PLAN
A3000	C	ELEVATIONS
A3100	C	SECTIONS
A4500	E	TRAVEL STRATEGY PLAN
A8000	C	LANDSCAPE PLAN
A9000	A	OVERLAY PLAN

**WOODS
BAGOT.** AUSTRALIA
ASIA
MIDDLE EAST
EUROPE
NORTH AMERICA

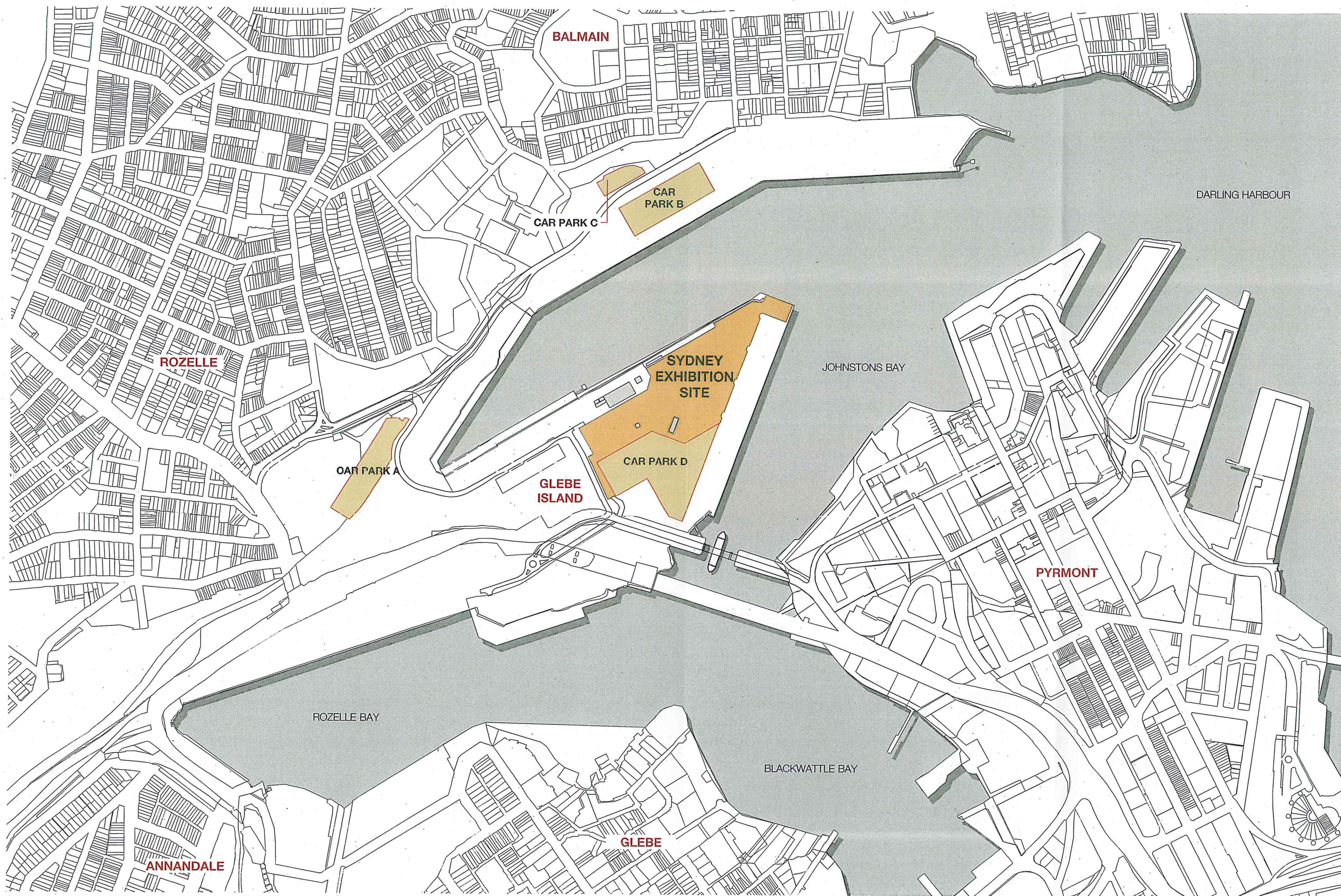



LEGEND

- A PROPOSED CAR PARK A
- B PROPOSED CAR PARK B
- C PROPOSED CAR PARK C
- D PROPOSED CAR PARK D
- E PROPOSED SYDNEY EXHIBITION CENTRE EXPANSION HALL SLAB
- F PROPOSED SYDNEY EXHIBITION CENTRE HALLS
- G PROPOSED NEW FERRY TERMINAL



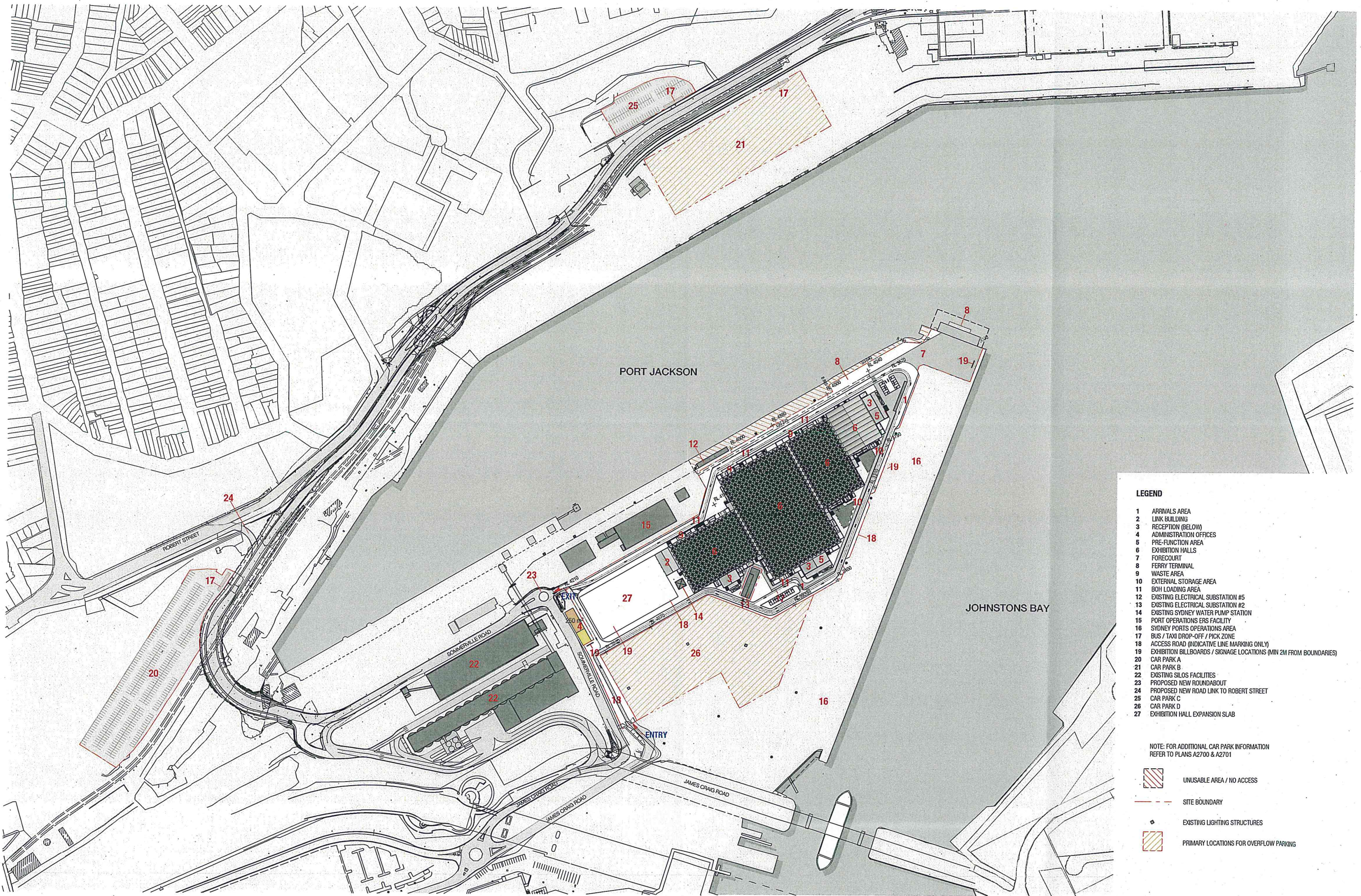

- 1 SYDNEY CBD (TOWN HALL) 4.4 KM
- 2 ROZELLE BAY TRAIN STATION 1.4 KM
- 3 GLEBE BICENTENIAL PARK 1.7 KM
- 4 JUBILEE PARK GLEBE 1.9 KM
- 5 GLEBE POINT ROAD BUSINESS PRECINCT 3.3 KM
- 6 BALMAIN HOSPITAL 3.1 KM
- 7 DARLING STREET BUSINESS PRECINCT BALMAIN 3 KM
- 8 BALMAIN EAST FERRY 3.9 KM
- 9 JOHN STREET SQUARE PYRMONT 2.8 KM
- 10 SYDNEY CASINO 4 KM
- 11 PIRRAMA PARK PYRMONT 3.3 KM
- 12 SYDNEY SECONDARY COLLEGE - BALMAIN CAMPUS 2.4 KM
- 13 SYDNEY SUPERYATCH MARINA 400m
- 14 WHITE BAY POWER STATION 1.3 KM
- 15 SYDNEY UNIVERSITY COLLEGE OF ARTS 3.1 KM
- 16 OVERSEAS PASSENGER TERMINAL 2.6 KM
- 17 SYDNEY PORTS EMERGENCY RESPONSE SERVICES 100m
- 18 EXISTING SILOS FACILITIES 500m
- 19 COCKLE BAY 3.5 KM
- 20 OLD GLEBE ISLAND BRIDGE 300m
- 21 SYDNEY PORTS OPERATIONS AREA

- NOISE
- WIND DIRECTION
- SITE BOUNDARY
- EXISTING LIGHTING STRUCTURES
- VIEWS
- SYDNEY PORTS OPERATION AREAS
- UNUSABLE AREA / NO ACCESS



- LEGEND**
- 1 ARRIVALS AREA
 - 2 LINK BUILDING
 - 3 RECEPTION (BELOW)
 - 4 ADMINISTRATION OFFICES
 - 5 PRE-FUNCTION AREA
 - 6 EXHIBITION HALLS
 - 7 FORECOURT
 - 8 FERRY TERMINAL
 - 9 WASTE AREA
 - 10 EXTERNAL STORAGE AREA
 - 11 BOH LOADING AREA
 - 12 EXISTING ELECTRICAL SUBSTATION #5
 - 13 EXISTING ELECTRICAL SUBSTATION #2
 - 14 EXISTING SYDNEY WATER PUMP STATION
 - 15 PORT OPERATIONS ERS FACILITY
 - 16 SYDNEY PORTS OPERATIONS AREA
 - 17 BUS / TAXI DROP-OFF / PICK-UP ZONE
 - 18 ACCESS ROAD (INDICATIVE LINE MARKING ONLY)
 - 19 EXHIBITION BILLBOARDS / SIGNAGE LOCATIONS (MIN 2M FROM BOUNDARIES)
 - 20 CAR PARK A
 - 21 CAR PARK B
 - 22 EXISTING SILOS FACILITIES
 - 23 PROPOSED NEW ROUNDABOUT
 - 24 PROPOSED NEW ROAD LINK TO ROBERT STREET
 - 25 CAR PARK C
 - 26 CAR PARK D
 - 27 EXHIBITION HALL EXPANSION SLAB

NOTE: FOR ADDITIONAL CAR PARK INFORMATION
REFER TO PLANS A2700 & A2701

-  UNUSABLE AREA / NO ACCESS
-  SITE BOUNDARY
-  EXISTING LIGHTING STRUCTURES
-  PRIMARY LOCATIONS FOR OVERFLOW PARKING

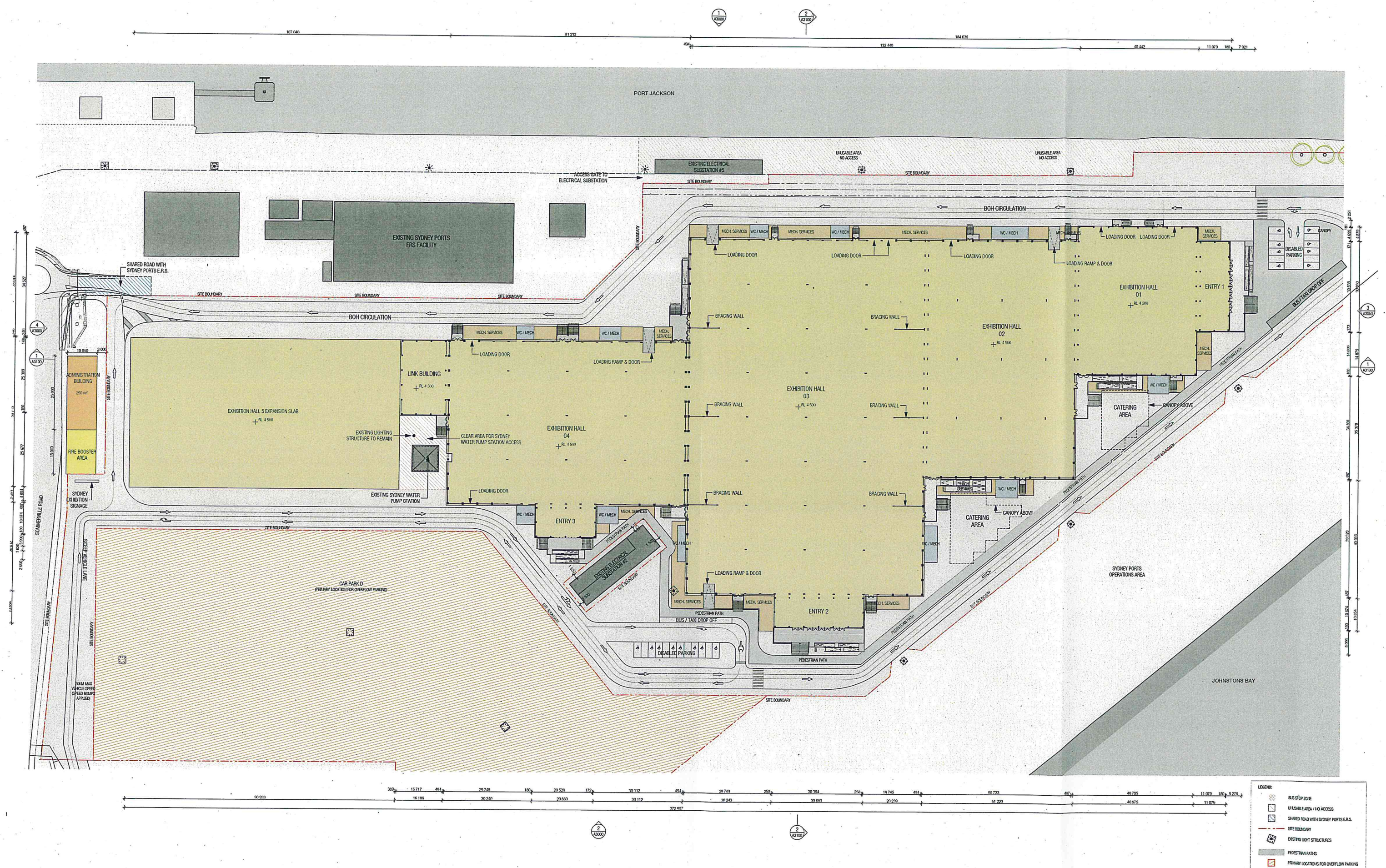

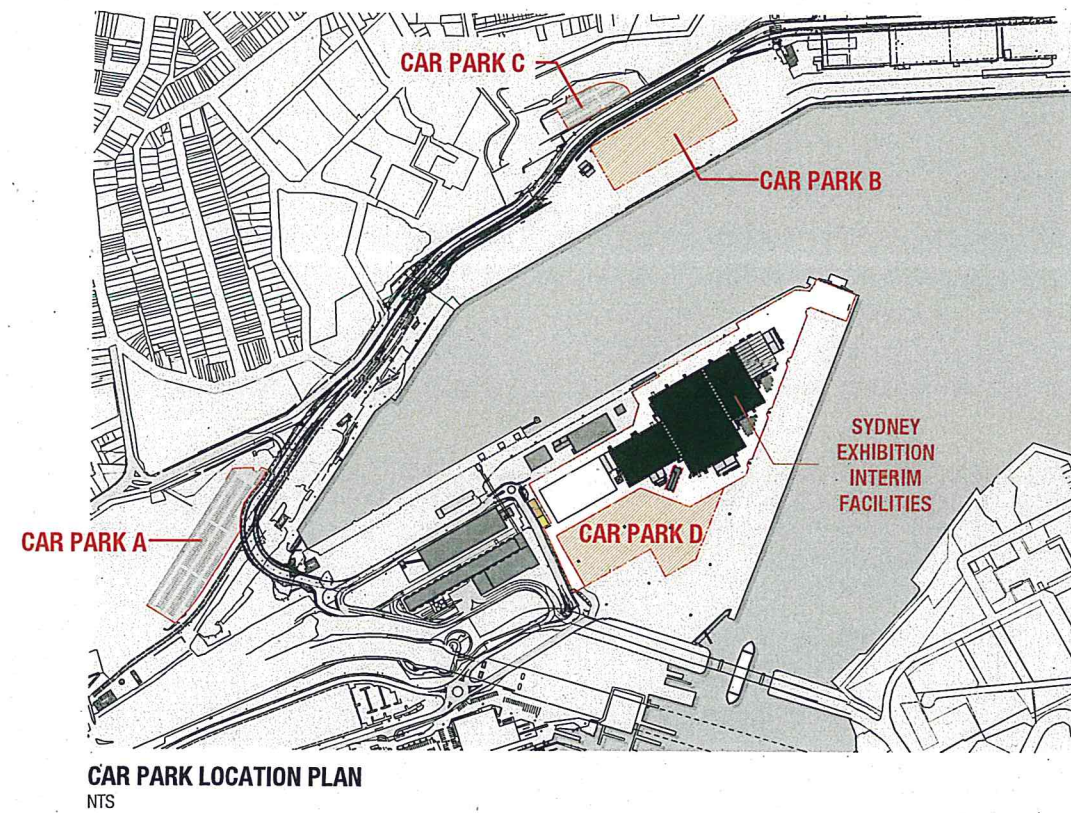

CAR PARK A
SCALE 1:1000

NOTE:
THIS DRAWING IS FOR INFORMATION ONLY. DO NOT SCALE FROM DRAWING.
THE CARPARK LAYOUTS SHOWN AND THE DESCRIBED NUMBER OF CAR SPACES ARE ONLY APPROXIMATE AND ARE SUBJECT TO CHANGE.
SITE SURVEY INFORMATION HAS NOT BEEN PROVIDED TO ACCURATELY INDICATE EXTENT OF BOUNDARIES DETERMINING THE TOTAL NUMBER OF CAR SPACES. TRAFFIC CONSULTANT AND SITE SURVEY INFORMATION NOT CO-ORDINATED.
ALL CARPARKS MUST COMPLY WITH AUSTRALIAN STANDARDS AS 2890 AND PROVIDE DDA COMPLIANT CAR SPACES IN ACCORDANCE WITH BCA D3.5.

LEGEND	
1	SHUTTLE BUS PICK-UP & DROP-OFF ZONE
2	PROPOSED NEW ROAD
3	DDA CAR SPACES
	PRIMARY LOCATIONS FOR OVERFLOW PARKING

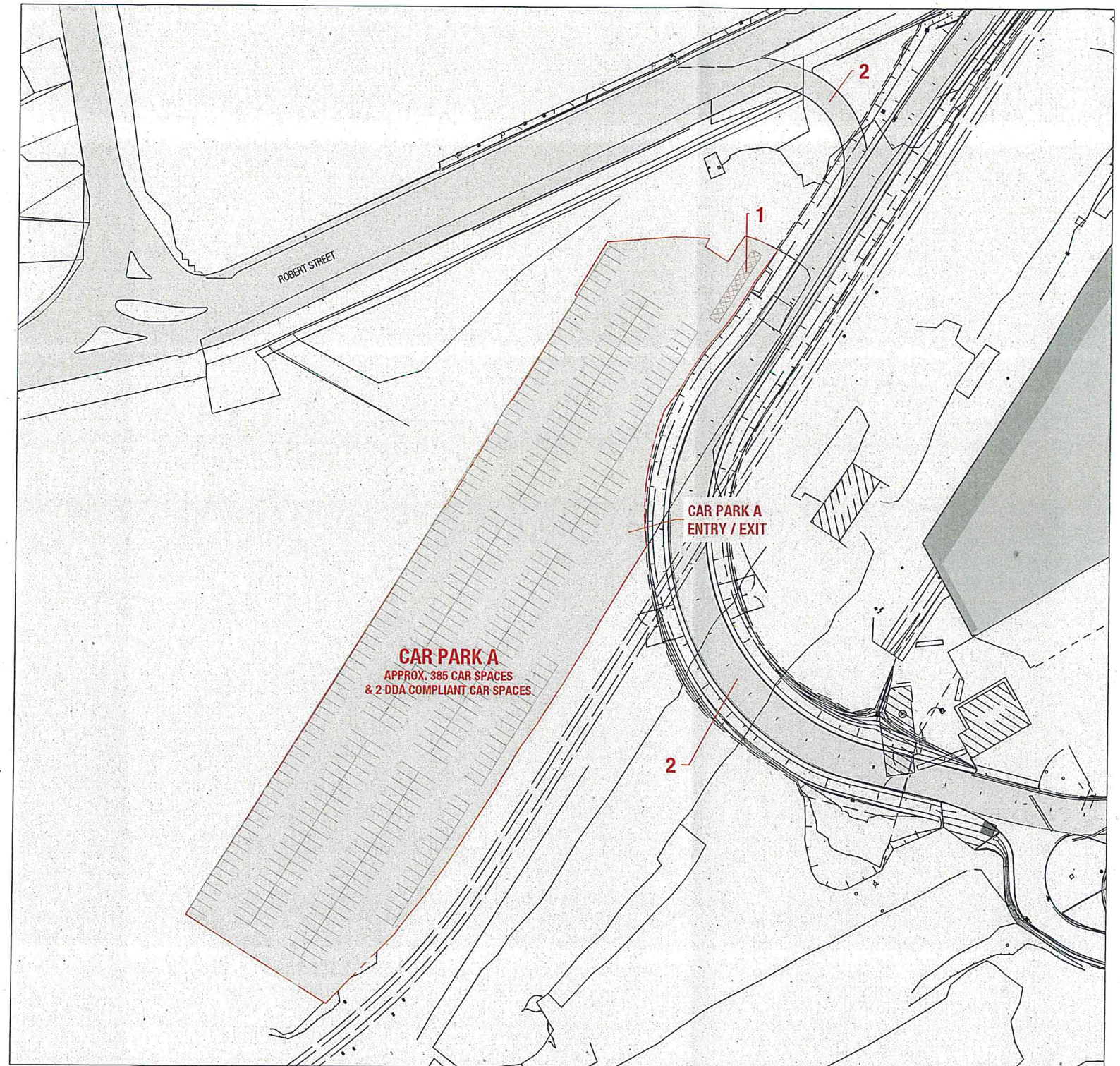

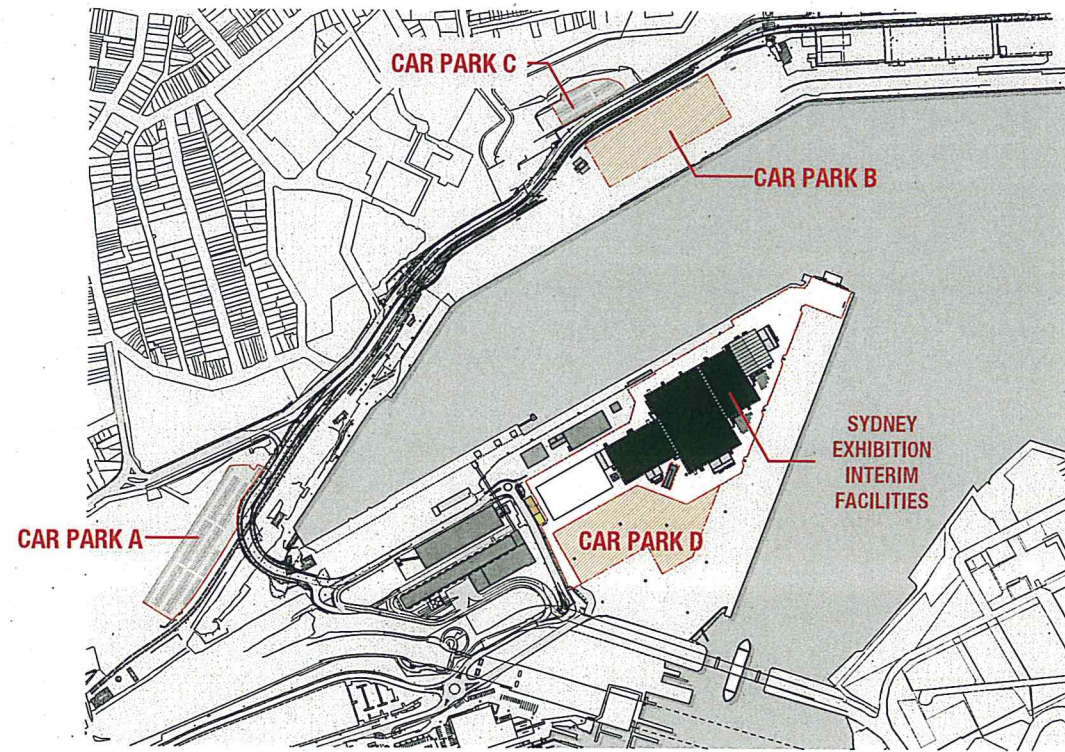

CAR PARK LOCATION PLAN
NTS

NOTE:
THIS DRAWING IS FOR INFORMATION ONLY. DO NOT SCALE FROM DRAWING.
THE CARPARK LAYOUTS SHOWN AND THE DESCRIBED NUMBER OF CAR SPACES ARE ONLY APPROXIMATE AND ARE SUBJECT TO CHANGE.
SITE SURVEY INFORMATION HAS NOT BEEN PROVIDED TO ACCURATELY INDICATE EXTENT OF BOUNDARIES DETERMINING THE TOTAL NUMBER OF CAR SPACES. TRAFFIC CONSULTANT AND SITE SURVEY INFORMATION NOT CO-ORDINATED.
ALL CARPARKS MUST COMPLY WITH AUSTRALIAN STANDARDS AS 2890 AND PROVIDE DDA COMPLIANT CAR SPACES IN ACCORDANCE WITH BCA D3.5.

LEGEND	
1	SHUTTLE BUS PICK-UP & DROP-OFF ZONE
2	PROPOSED NEW ROAD
3	DDA CAR SPACES
	PRIMARY LOCATIONS FOR OVERFLOW PARKING

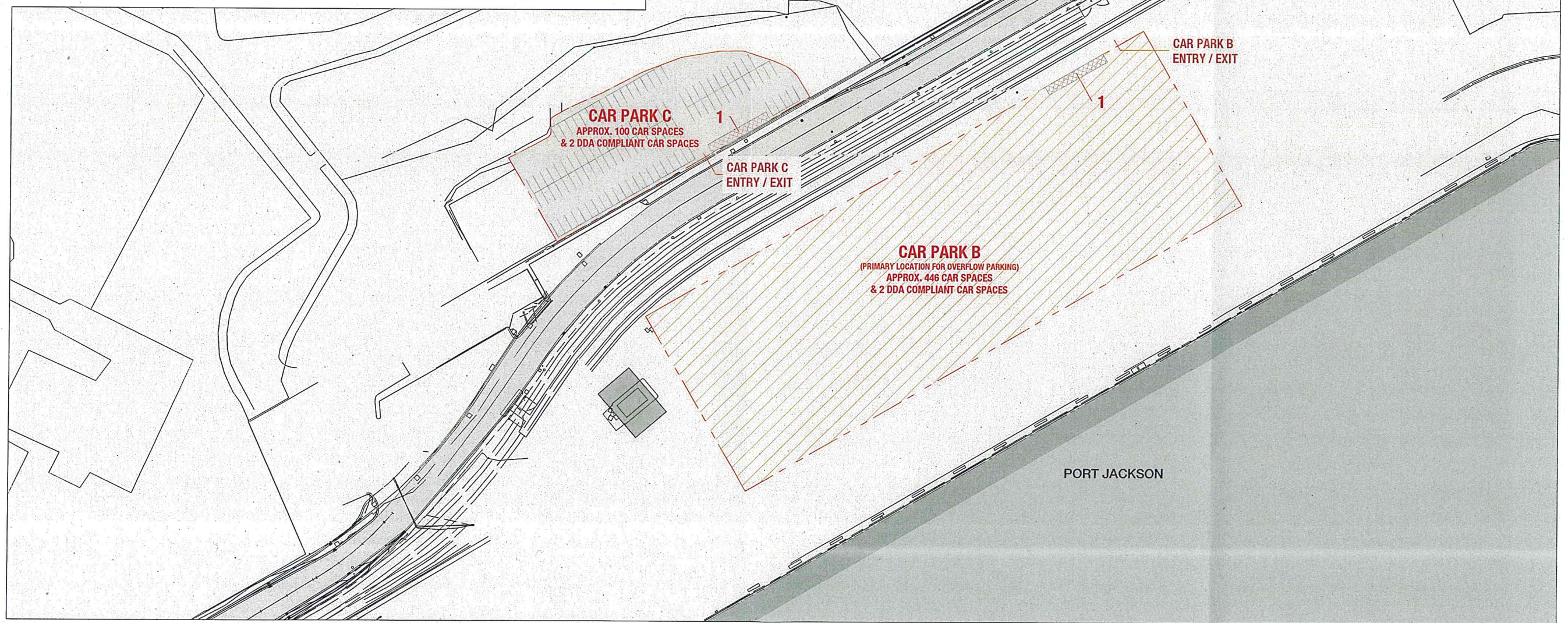

CAR PARK B & C
SCALE 1:1000

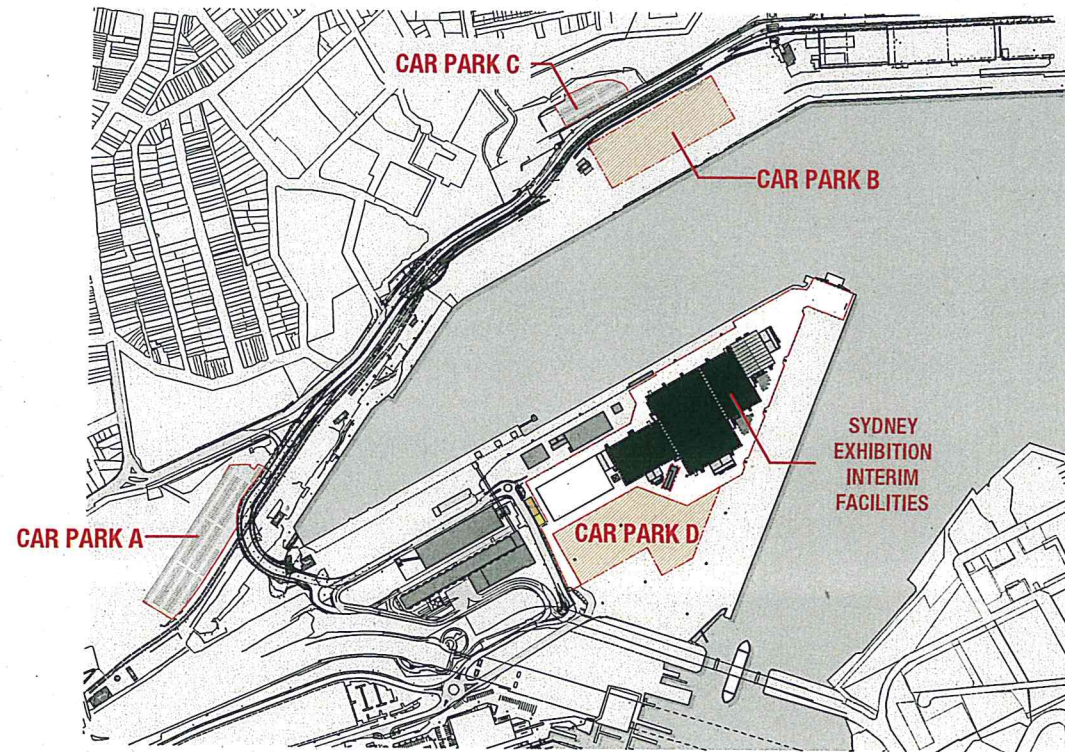

CAR PARK LOCATION PLAN
NTS

NOTE:
THIS DRAWING IS FOR INFORMATION ONLY. DO NOT SCALE FROM DRAWING.
THE CARPARK LAYOUTS SHOWN AND THE DESCRIBED NUMBER OF CAR SPACES ARE ONLY APPROXIMATE AND ARE SUBJECT TO CHANGE.
SITE SURVEY INFORMATION HAS NOT BEEN PROVIDED TO ACCURATELY INDICATE EXTENT OF BOUNDARIES DETERMINING THE TOTAL NUMBER OF CAR SPACES. TRAFFIC CONSULTANT AND SITE SURVEY INFORMATION NOT CO-ORDINATED.
ALL CARPARKS MUST COMPLY WITH AUSTRALIAN STANDARDS AS 2890 AND PROVIDE DDA COMPLIANT CAR SPACES IN ACCORDANCE WITH BCA D3.5.

LEGEND

- 1 SHUTTLE BUS PICK-UP & DROP-OFF ZONE
- 2 PROPOSED NEW ROAD
- 3 DDA CAR SPACES
- PRIMARY LOCATIONS FOR OVERFLOW PARKING

CAR PARK D & E
SCALE 1:1000

