

schedule of areas - ground floor							
	stage 1	stage 3	stage 5	stage 6	stage 2	stage 4	total
site area	7,043 sqm				7,165 sqm		14,208 sqm
gross floor area	689 sqm	403 sqm	265 sqm	977 sqm		76 sqm	2,410 sqm
outdoor space and circulation		2,259 sqm			5,176 sqm		7,435 sqm
landscaped area	1,129 sqm				1,789 sqm		2,918 sqm

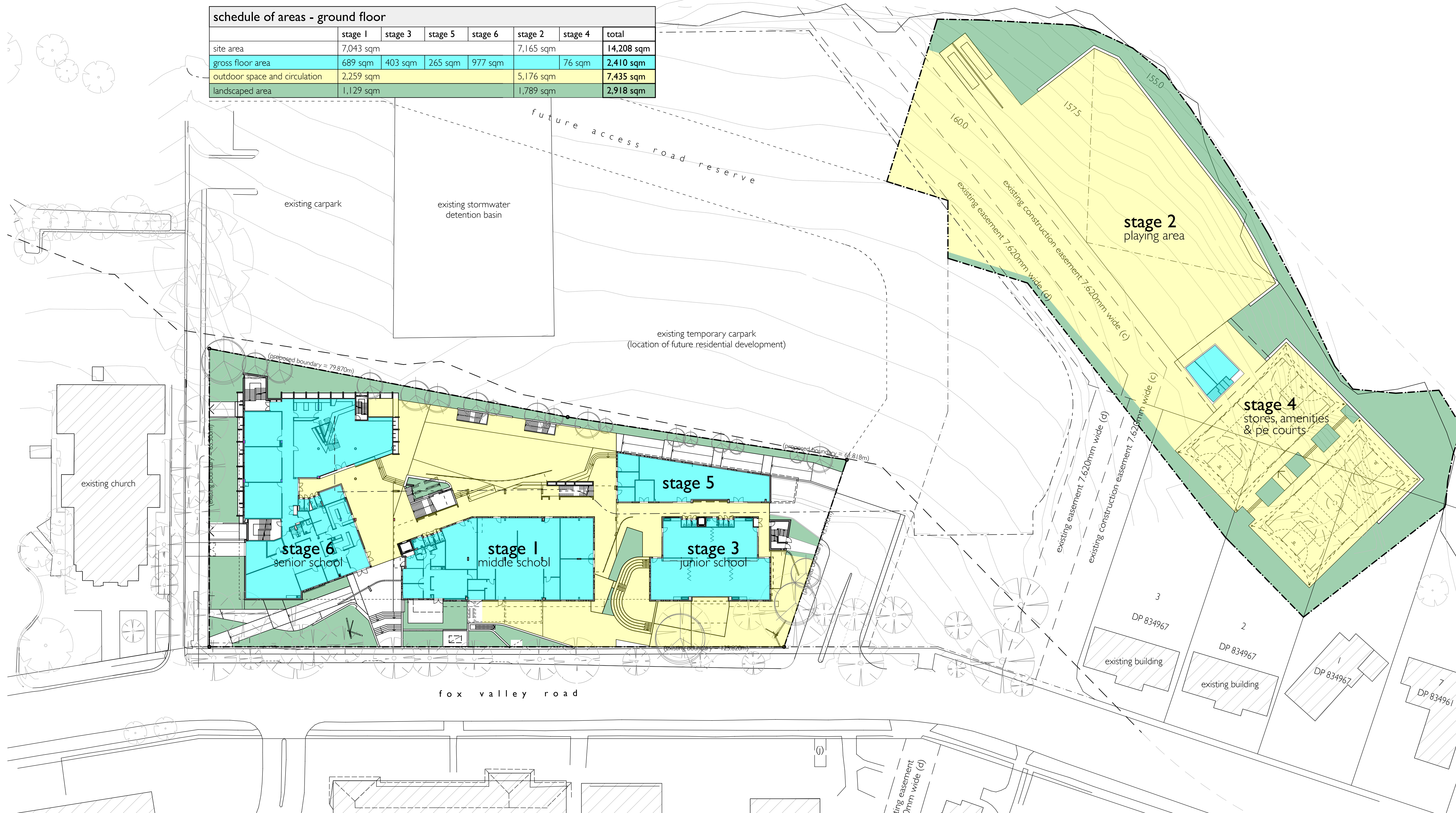

3 - staging revised / re-issue for state significant development application	06/02/2018
2 - re-issue for state significant development application	05/12/2017
1 - issue for state significant development application	27/03/2017
amendment	da

note: all dimensions are to be verified on site and any discrepancies referred to the architect for determination. figured dimensions are to take precedence over scaled dimensions.

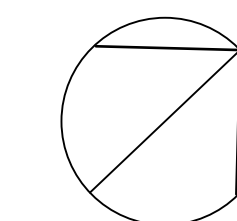

drawn	mn/dmb
checked	dmb
plot date	11/02/15
scale	1:400 @ A

**wahroonga adventist school**  
fox valley road, wahroonga  
for  
seventh day adventist,  
greater sydney conference

development statistics - sheet 2

job number	dwg. no. / issue & amendment
1318.10	DA08 /3

| stanton | dahl architects

18 - 20 Oxford Street  
Epping NSW 2121  
Ph 61 2 8876 5300  
Fx 61 2 9868 2624  
design@stantondahl.com  
www.stantondahl.com.au

copyright 2011 stanton dah

