

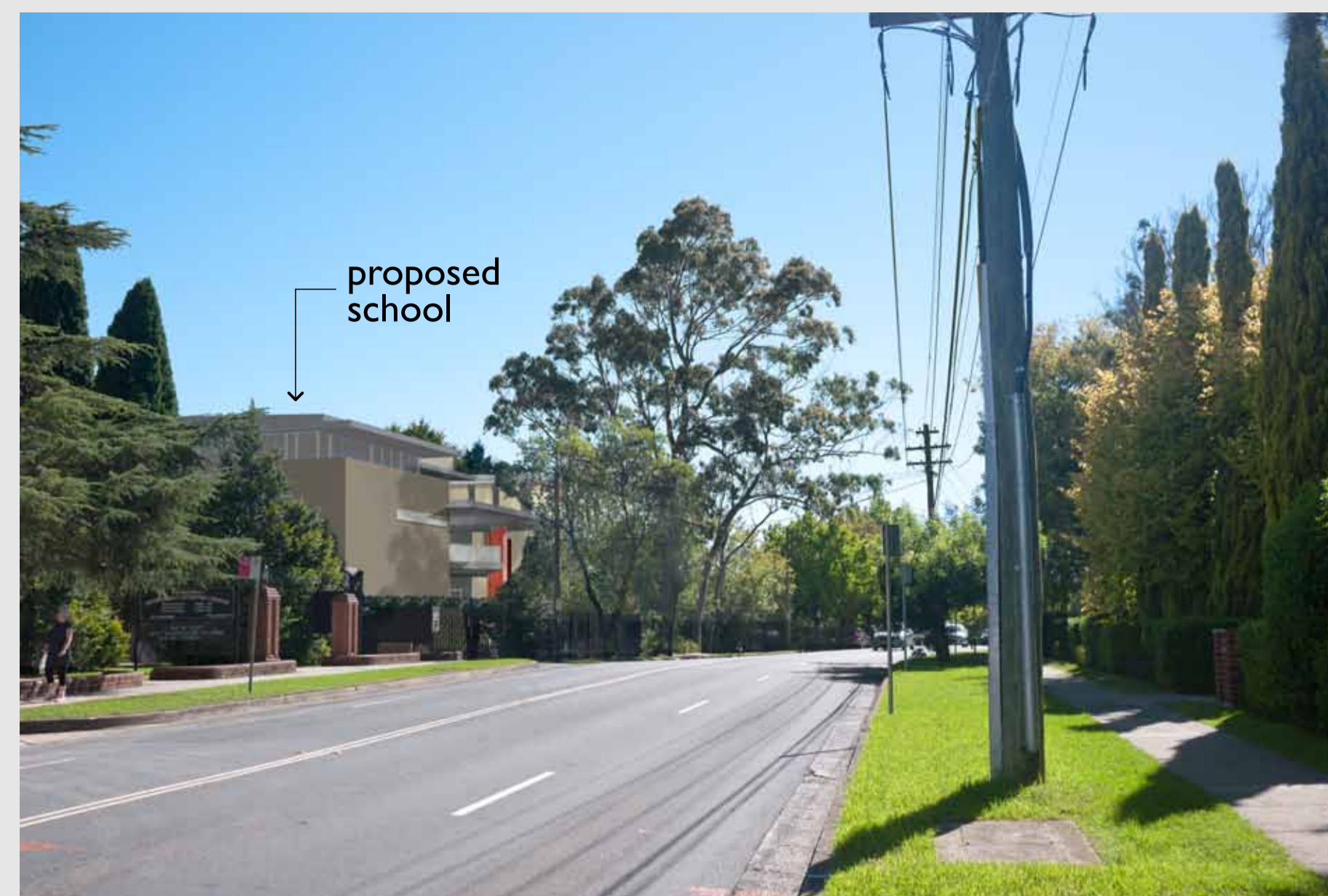

view a north along Fox Valley Road



view b north along Fox Valley Road



view c south along Fox Valley Road

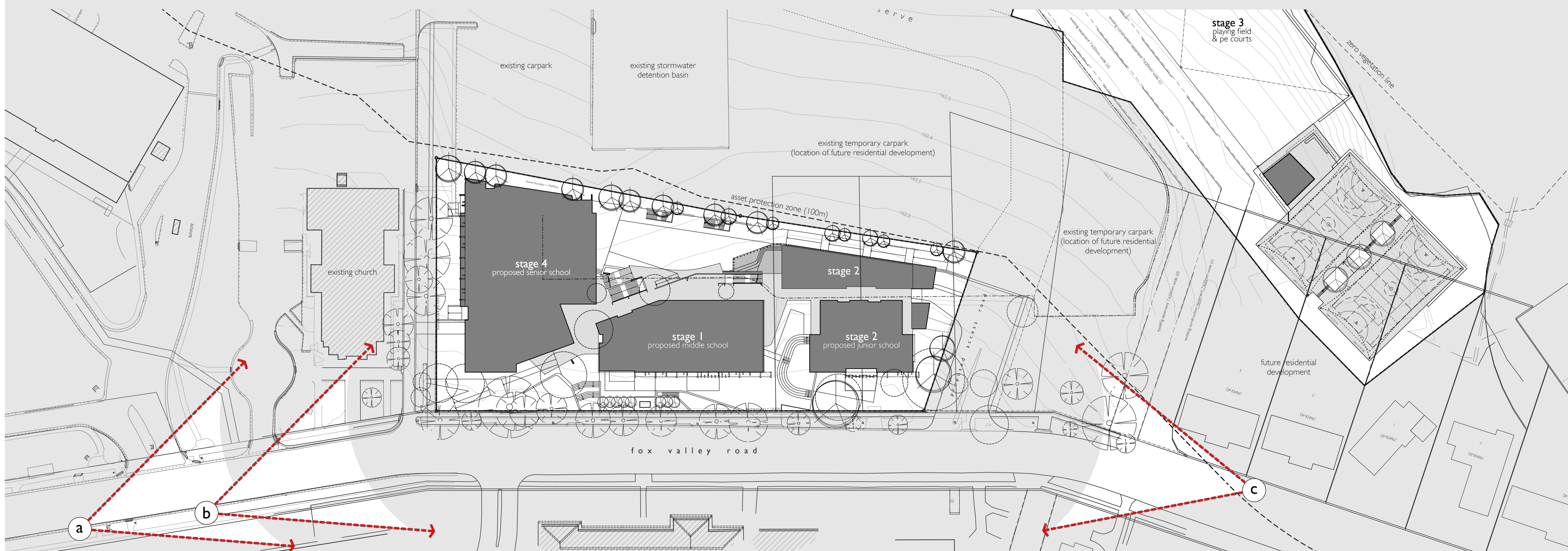

01 view analysis  
 1:500

2 - re-issue for state significant development application	05/12/13
1 - issue for state significant development application	27/03/13
amendment	date
note: all dimensions are to be verified on site and any discrepancies referred to the architect for determination. figured dimensions are to take precedence over scaled dimensions.	

drawn	al
checked	dmb
plot date	4/12/13
scale	1:500 @ A1

wahroonga adventist school  
 fox valley road, wahroonga  
 for seventh day adventist,  
 greater sydney conference

view analysis  
 job number 1318.10  
 dwg. no. / issue & amendment DA41 / 2

stanton dahl architects

18 - 20 Oxford Street  
 Epping NSW 2121  
 Ph 61 2 8876 5300  
 Fx 61 2 9868 2624  
 design@stantondahl.com.au  
 www.stantondahl.com.au



copyright 2011 stanton dahl