



FRASERS PROPERTY

EASTERN CREEK QUARTER

ROOTY HILL ROAD SOUTH, ROOTY HILL . NSW 2766

ACOUSTIC / VISUAL SCREEN

+

ACTIVATION TO ROOTY HILL ROAD SOUTH

3 JULY 2017
CONCEPT DESIGN





CABLE PLACE

A



B



CAWARRA ST

C

EXISTING STREETScape

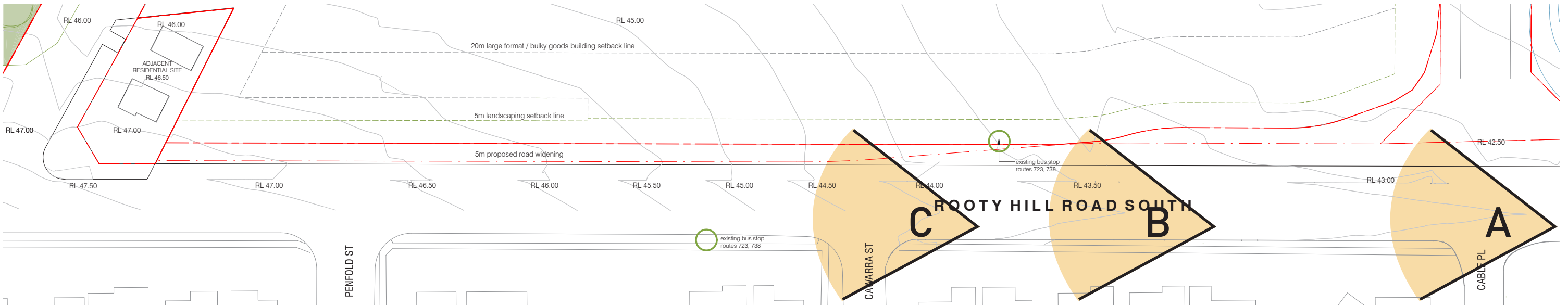

EXISTING PLAN



D



E



F

EXISTING STREETScape

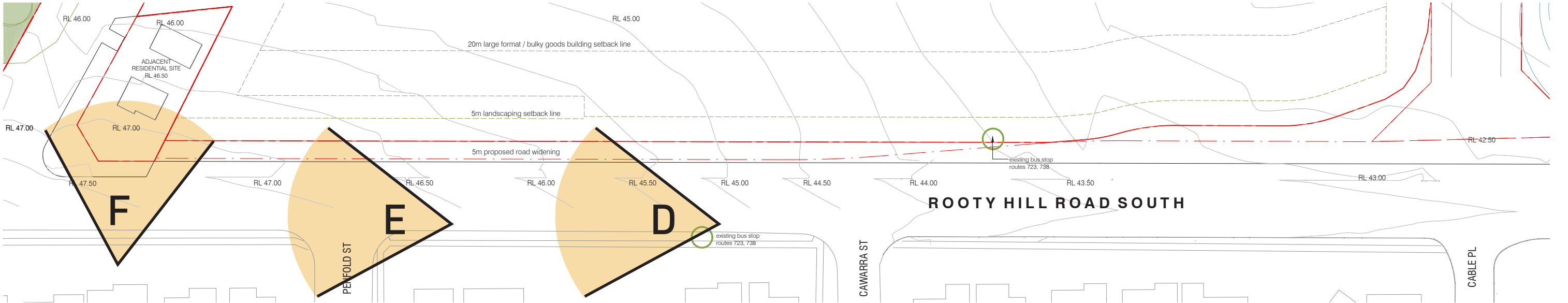

EXISTING PLAN

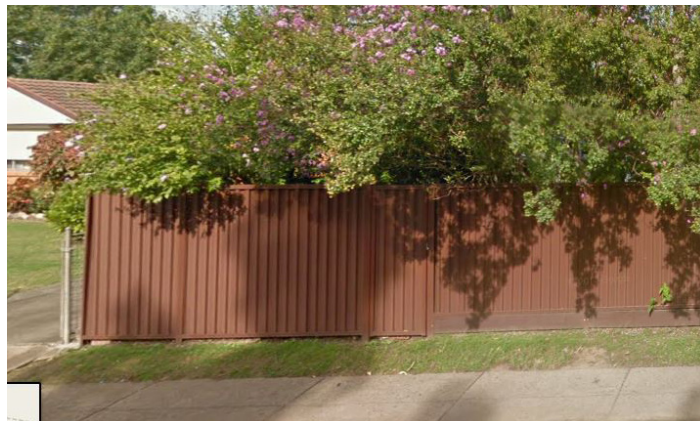
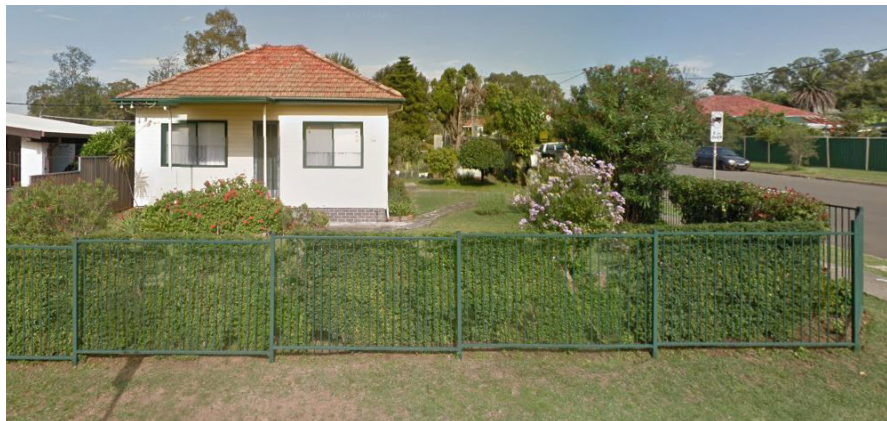
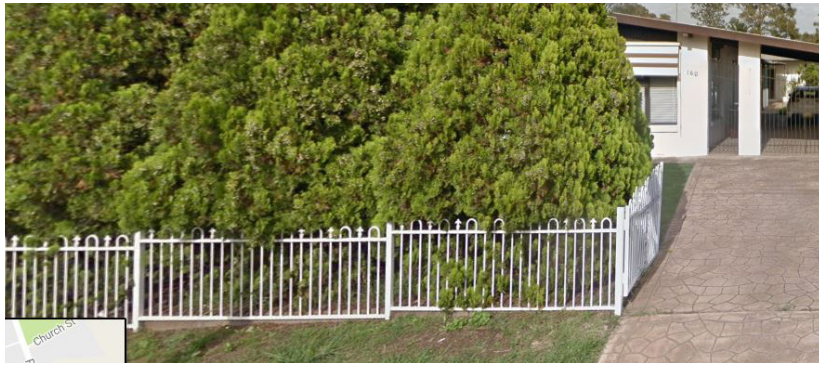

CONTEXTUAL FENCING STYLES ALONG ROOTY HILL ROAD SOUTH

- ANALYSIS:
- height varies between 1m to 1.8m along streetscape
 - materials vary between painted metal picket, timber, perforated, timber slats, blockwork
 - heavy vegetation as extra screening



RAMMED EARTH



PORT PHILIP WINERY



GABION WALL - STONE

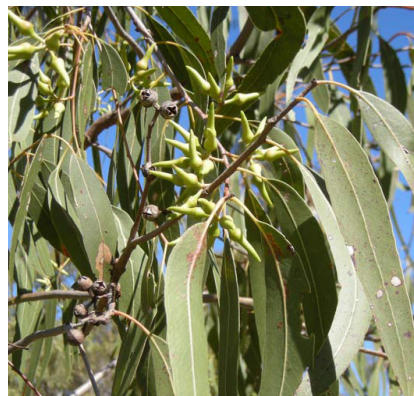

NATIVE FLORA - WESTERN SYDNEY PARKLANDS



GRAPHIC CONCRETE



RECYCLED TIMBER PANELLING



RAMMED EARTH



EASTERN CREEK QUARTER

"A place to be proud of where people feel completely comfortable"

POTENTIAL MATERIALS PALETTE INSPIRATION

PROJECT
2015-088
DATE
03.07.2017

DRAWING NO.
SK24.5
DRAWN BY
TL/PL

MEL
SYD
PER
1800 422 533 i2c.com.au





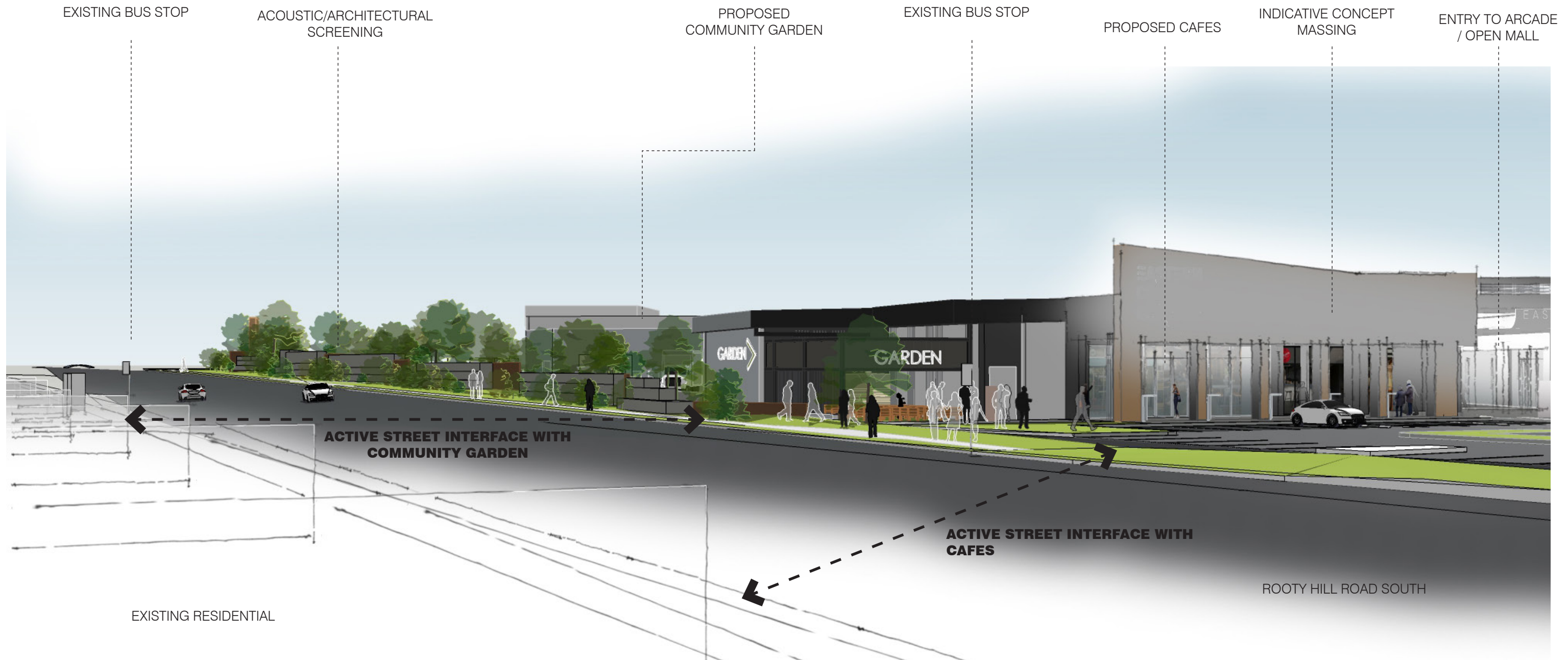

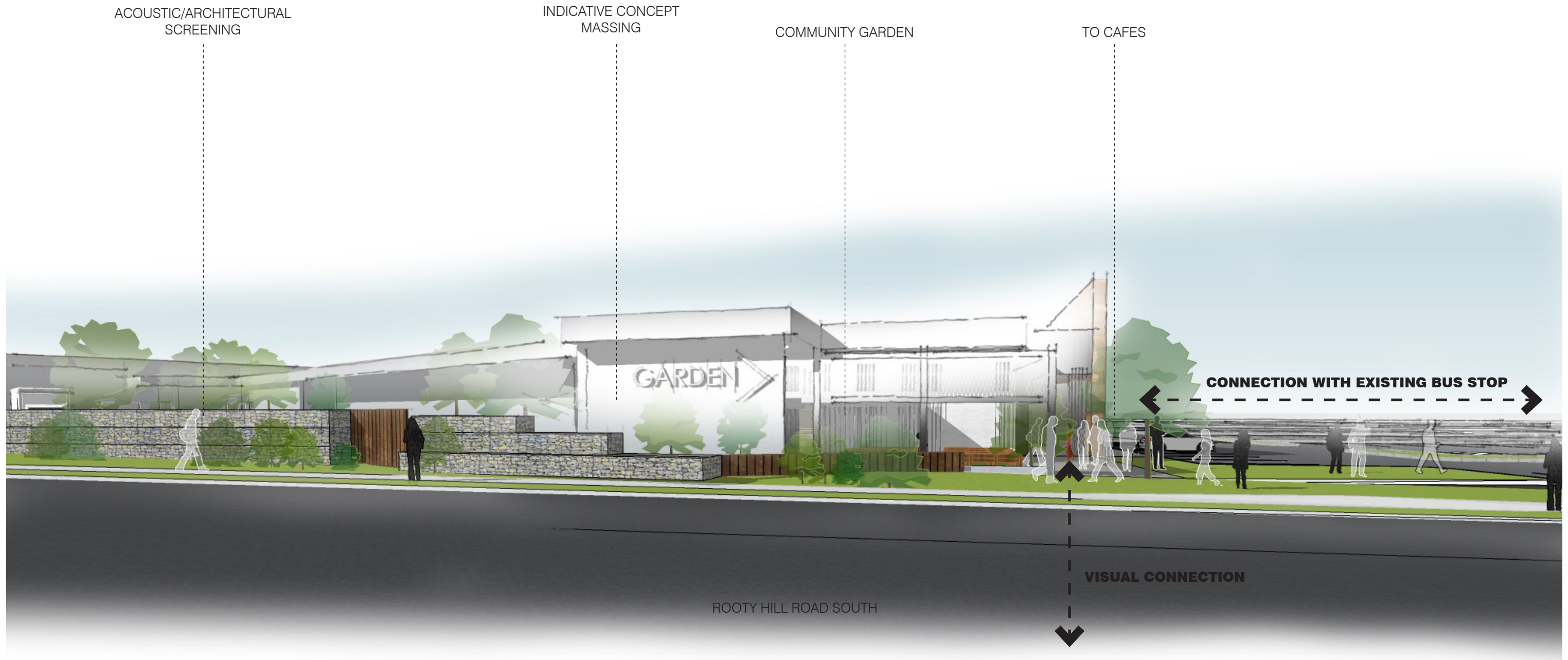

VIEW FROM ACROSS THE ROAD



VIEW FROM ACROSS THE ROAD

ACOUSTIC/ARCHITECTURAL
SCREENING

VEGETATION AND LANDSCAPING

EXISTING RESIDENTIAL



VIEW LOOKING SOUTH



EASTERN CREEK QUARTER

*"A place to be proud of where people feel
completely comfortable"*

PROPOSED VISUAL SCREEN
CONCEPT DESIGN

PROJECT
2015-088
DATE
03.07.2017

DRAWING NO.
SK24.10
DRAWN BY
TL/PL

MEL
SYD
PER
1800 422 533 i2c.COM.AU



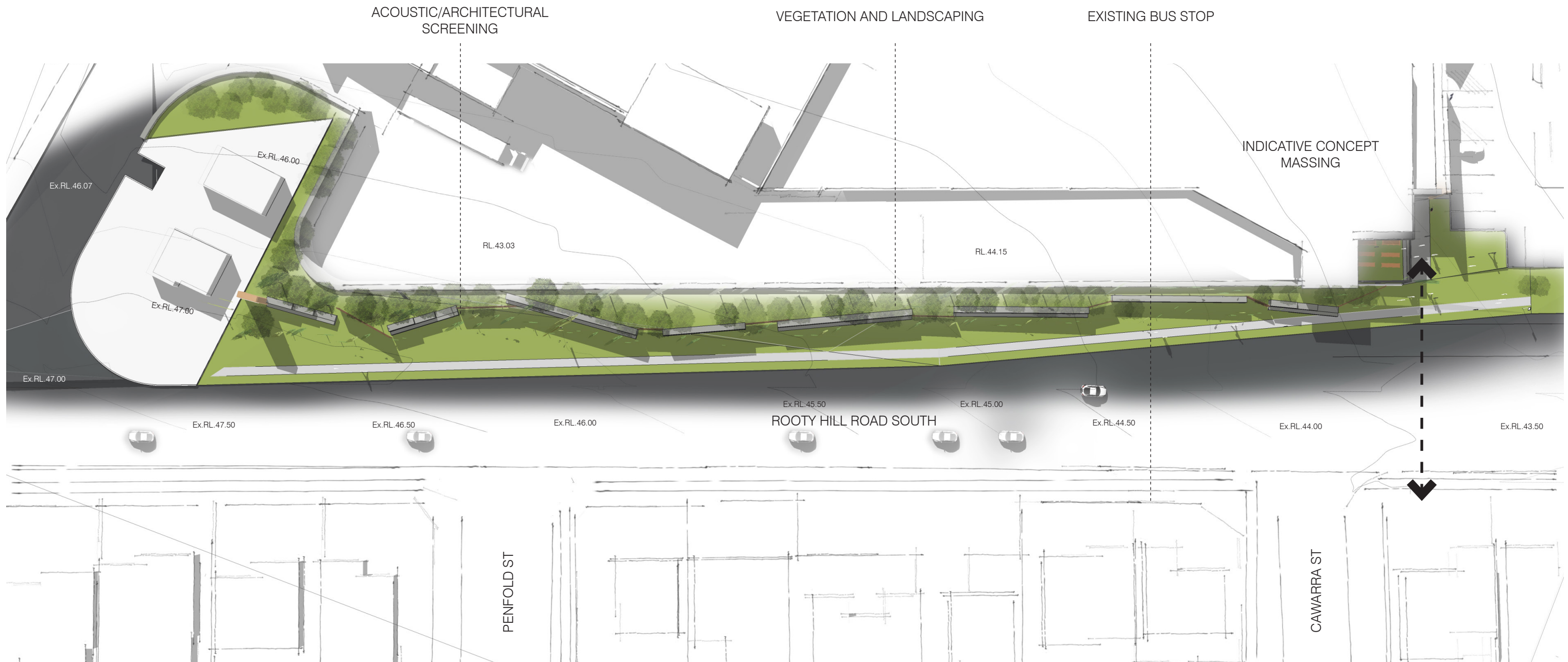

CONCEPTUAL AERIAL VIEW OF SCREENING ARTICULATION TO ROOTY HILL ROAD SOUTH

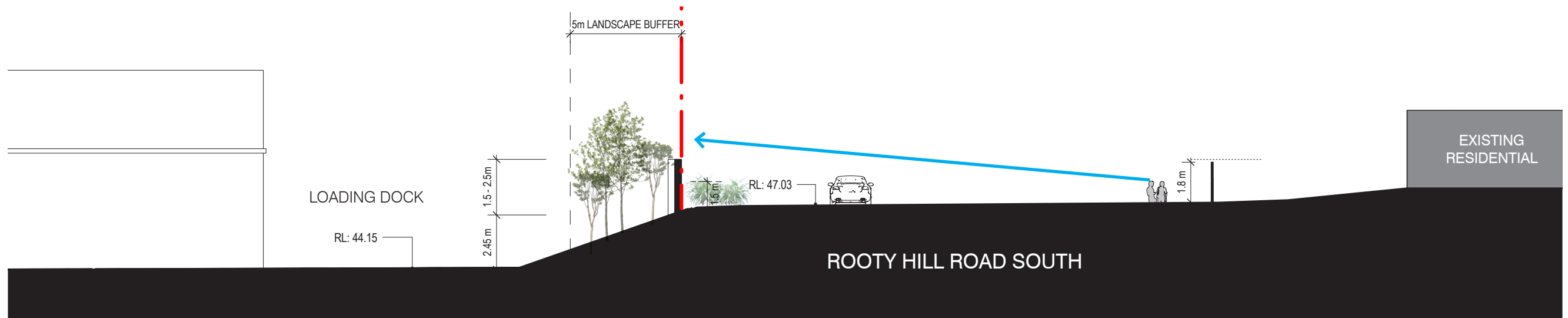

SECTION 1

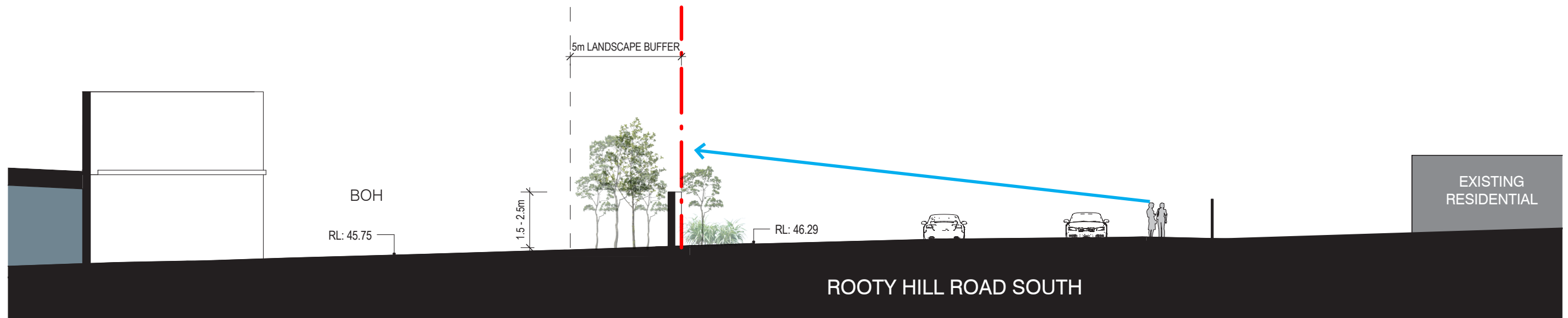

SECTION 2

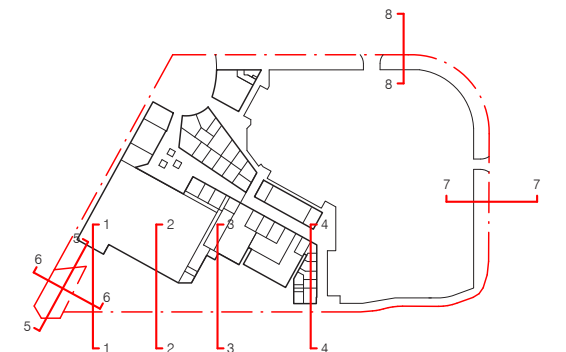

EASTERN CREEK QUARTER

"A place to be proud of where people feel completely comfortable"

SECTIONS
CONCEPT DESIGN

PROJECT
2015-088
DATE
03.07.2017

DRAWING NO.
SK24.12
DRAWN BY
TL/PL

MEL
SYD
PER
1800 422 533 i2c.com.au



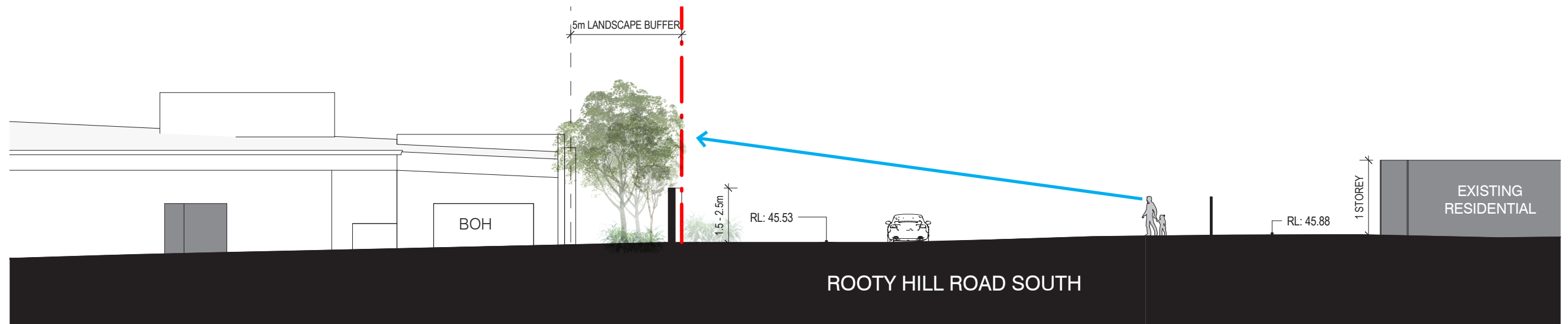

SECTION 3

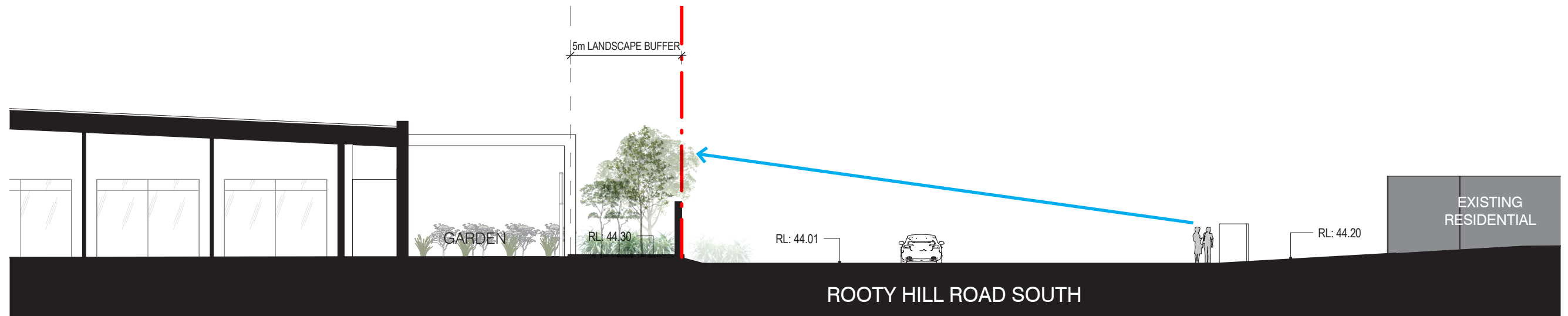

SECTION 4

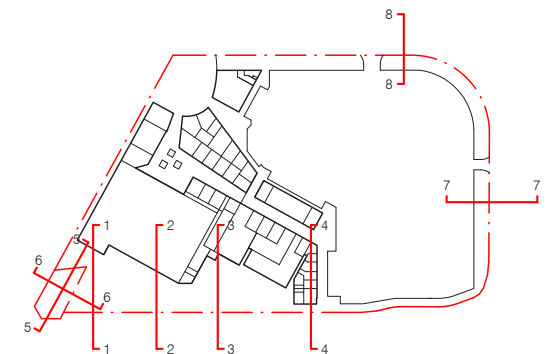

EASTERN CREEK QUARTER

"A place to be proud of where people feel completely comfortable"

SECTIONS
CONCEPT DESIGN

PROJECT
2015-088
DATE
03.07.2017

DRAWING NO.
SK24.13
DRAWN BY
TL/PL

MEL
SYD
PER
1800 422 533 i2c.COM.AU



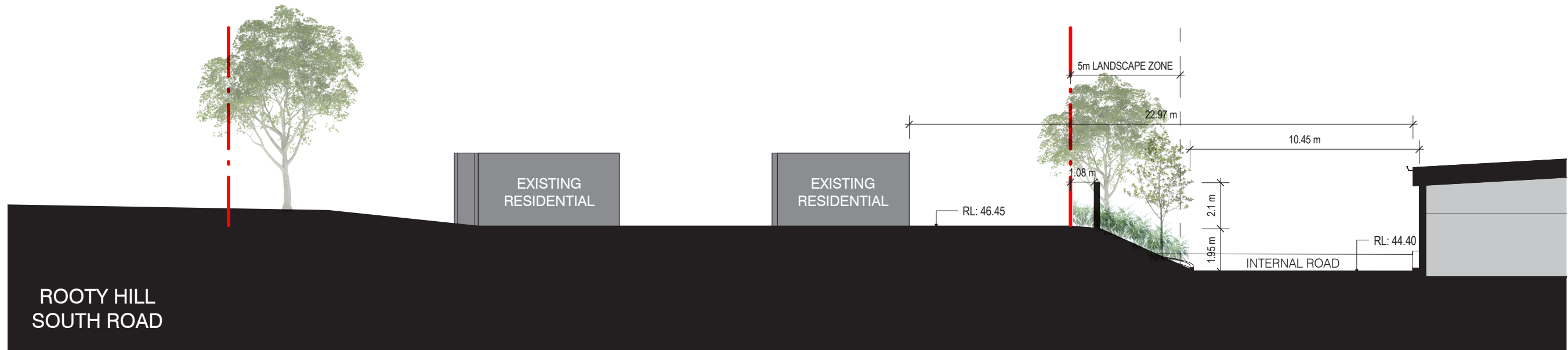

SECTION 5

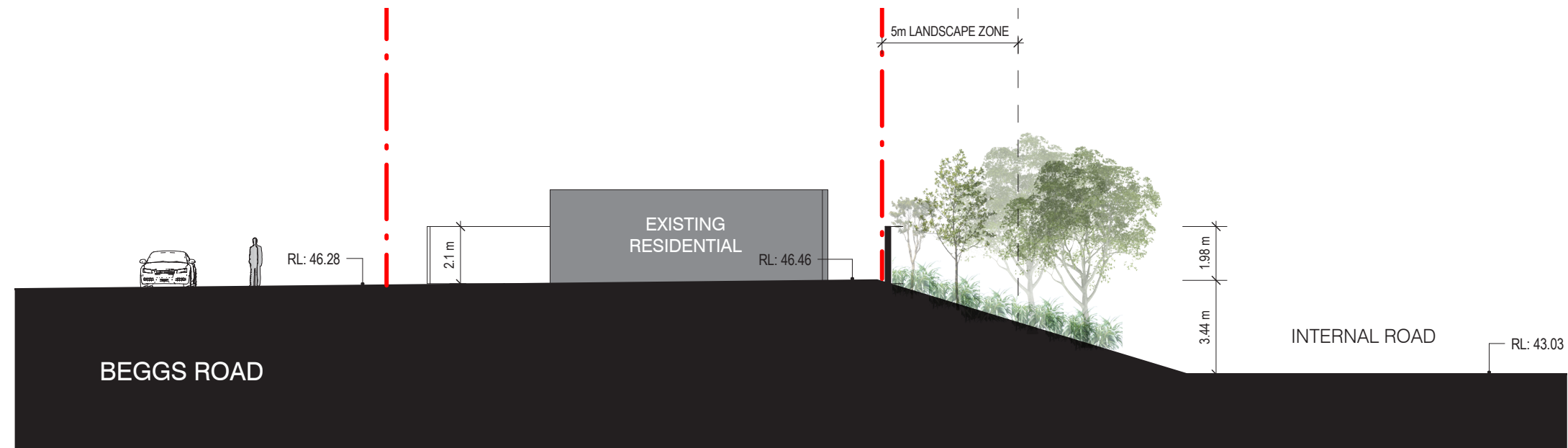

SECTION 6

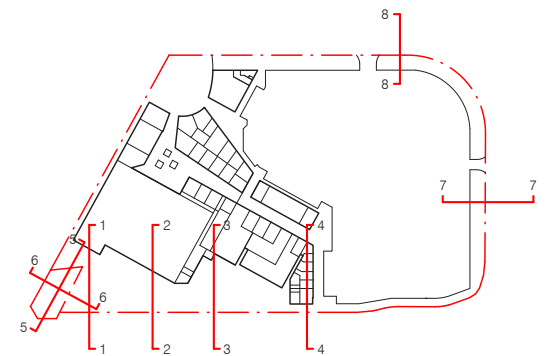

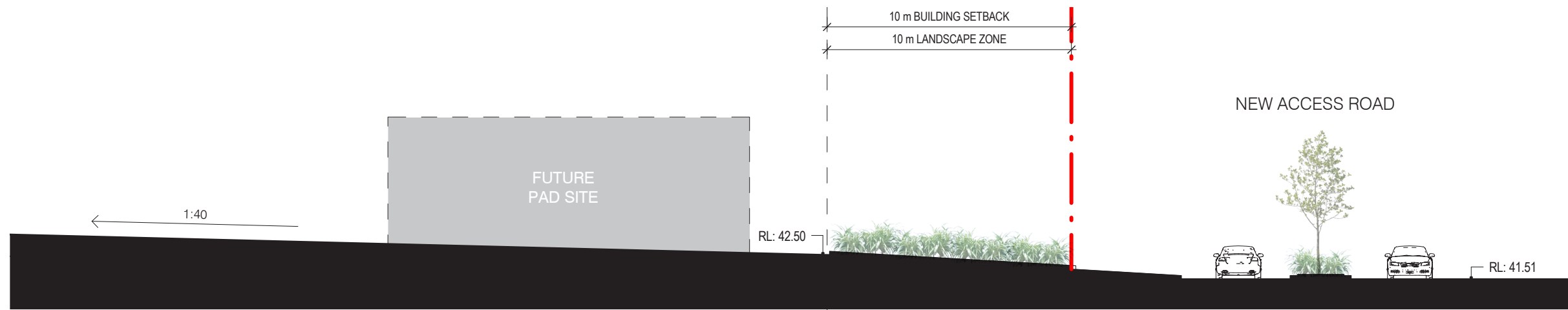

SECTION 7

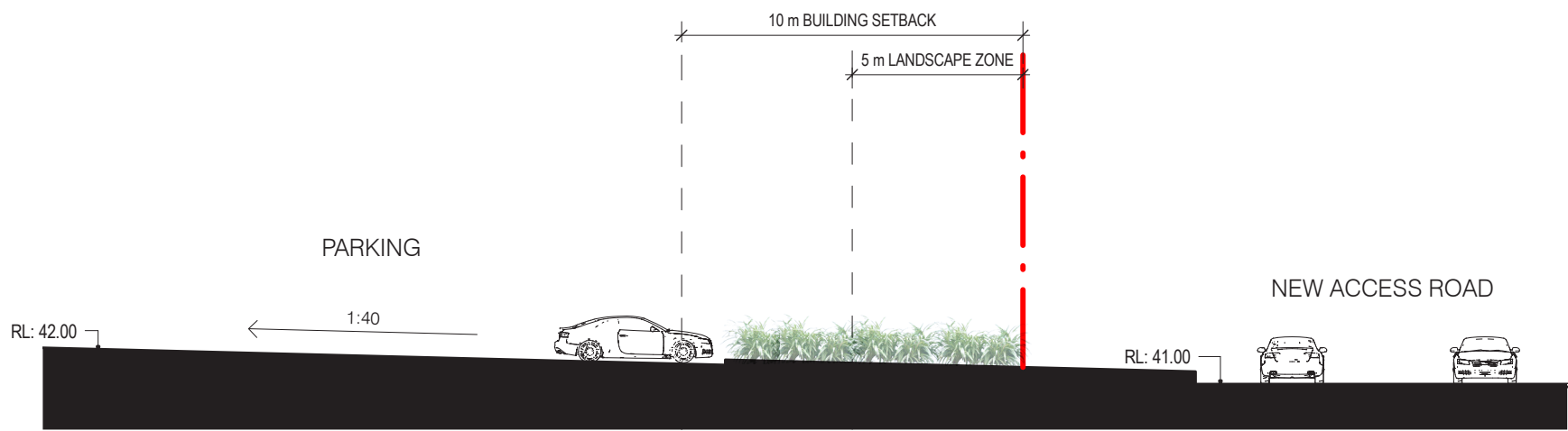

SECTION 8

