

Disclaimer: Robert Bird Group Pty Ltd (RBG) and its related entities (RBG) do not warrant the accuracy, currency or completeness of any information or data they supply or transfer by electronic means. You are responsible for verifying that any information or data supplied or transferred by electronic means matches the information or data on the corresponding PDF or 'hard' version issued by RBG. You are responsible for ensuring that any information or data supplied or transferred by electronic means is not used for any purpose other than that for which it was intended. You are responsible for ensuring that any information or data supplied or transferred by electronic means is not used for any purpose other than that for which it was intended. You are responsible for ensuring that any information or data supplied or transferred by electronic means is not used for any purpose other than that for which it was intended.

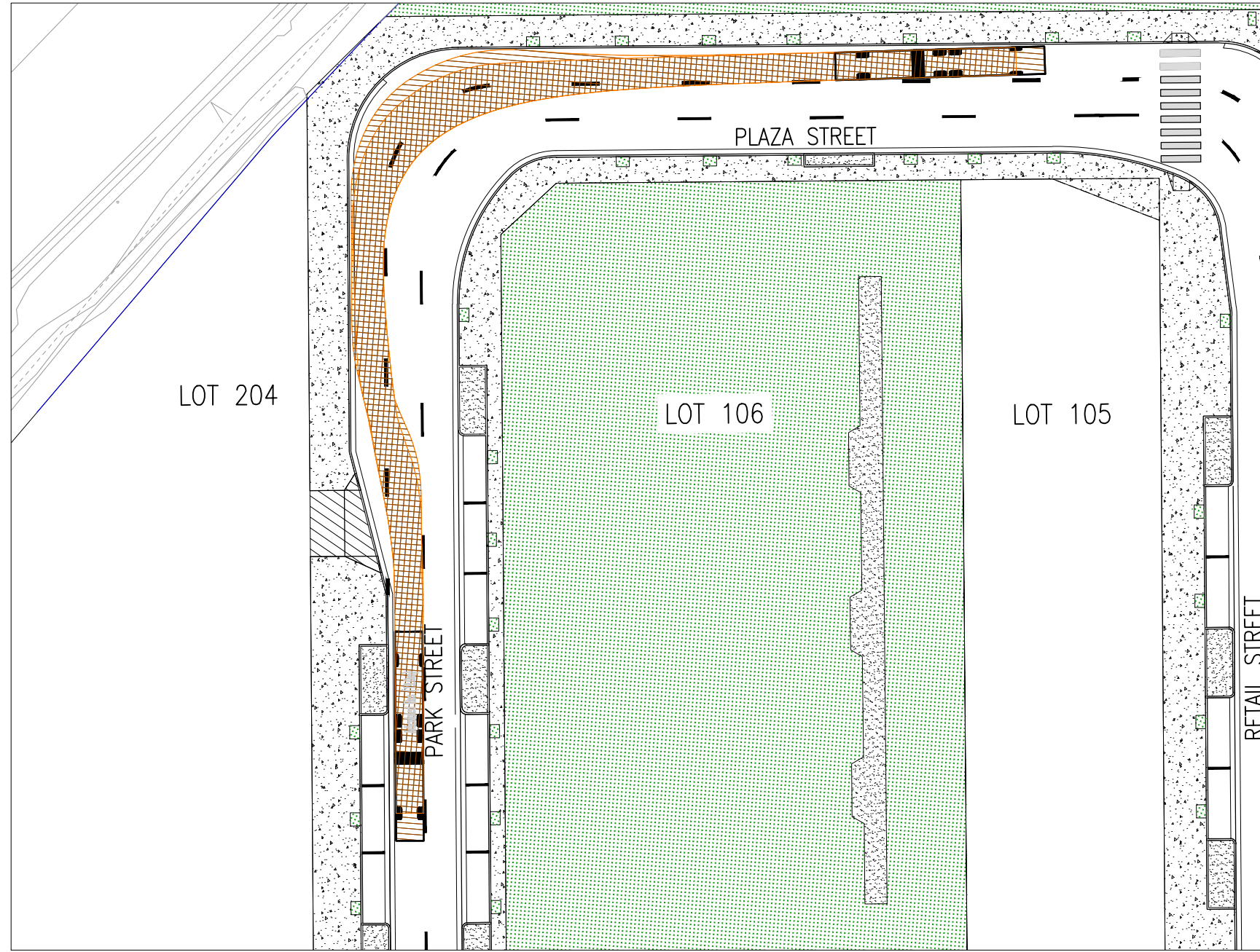

VEHICLE SWEEP PATHS – VIEW 12
PARK AND PLAZA STREET BEND

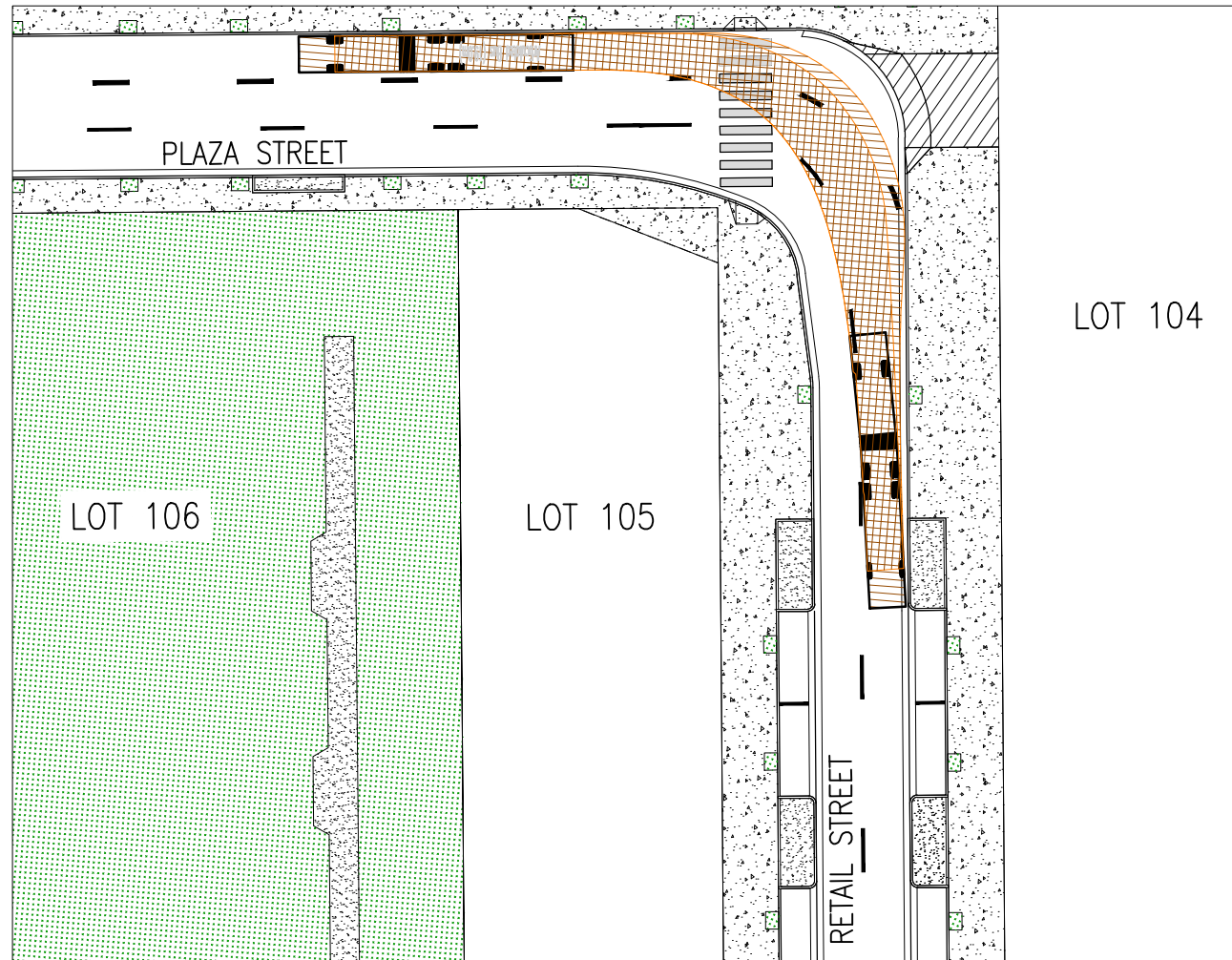

VEHICLE SWEEP PATHS – VIEW 13
PLAZA AND RETAIL STREET BEND

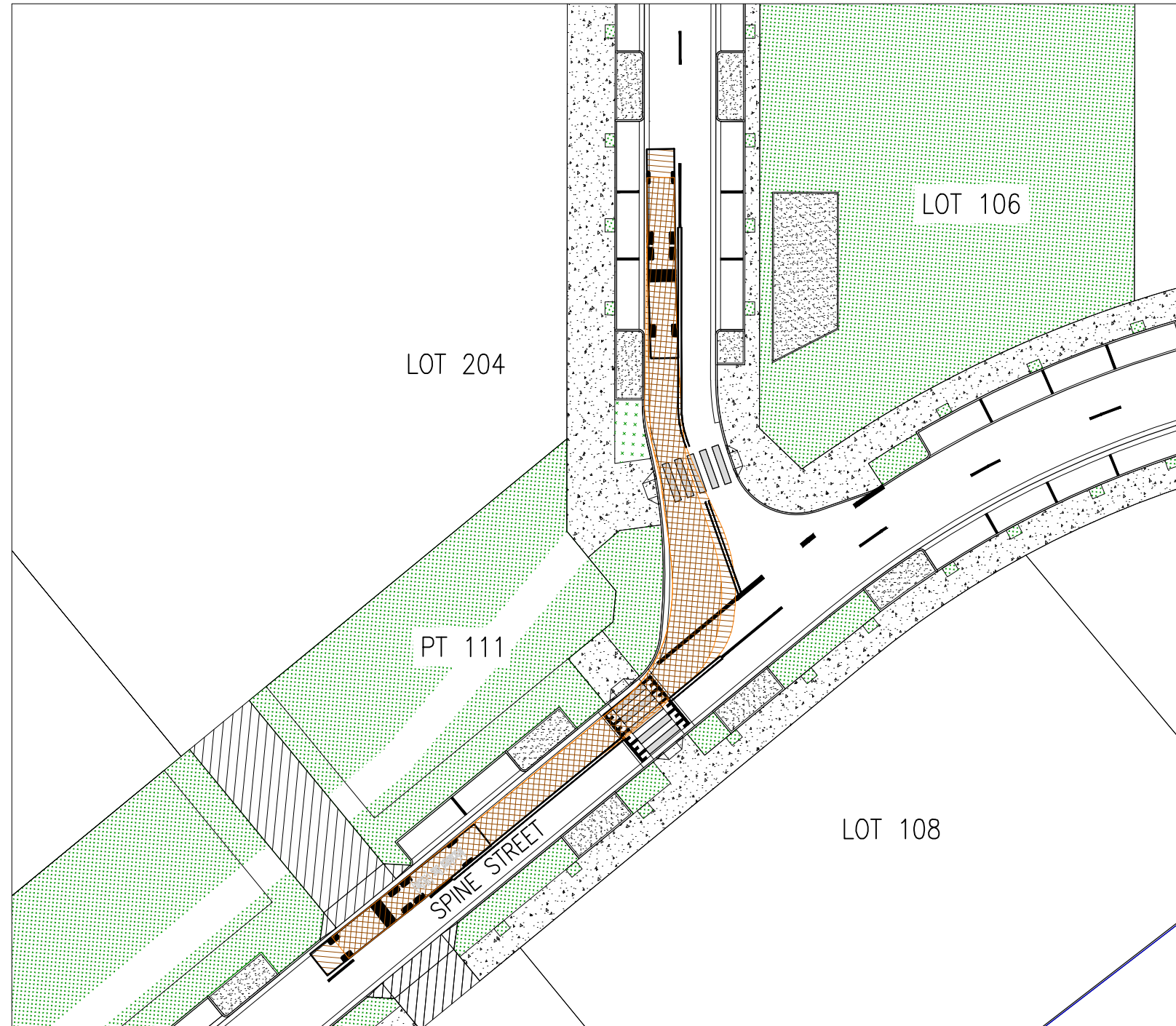

VEHICLE SWEEP PATHS – VIEW 16
SPINE STREET INTERSECTION WITH PARK STREET

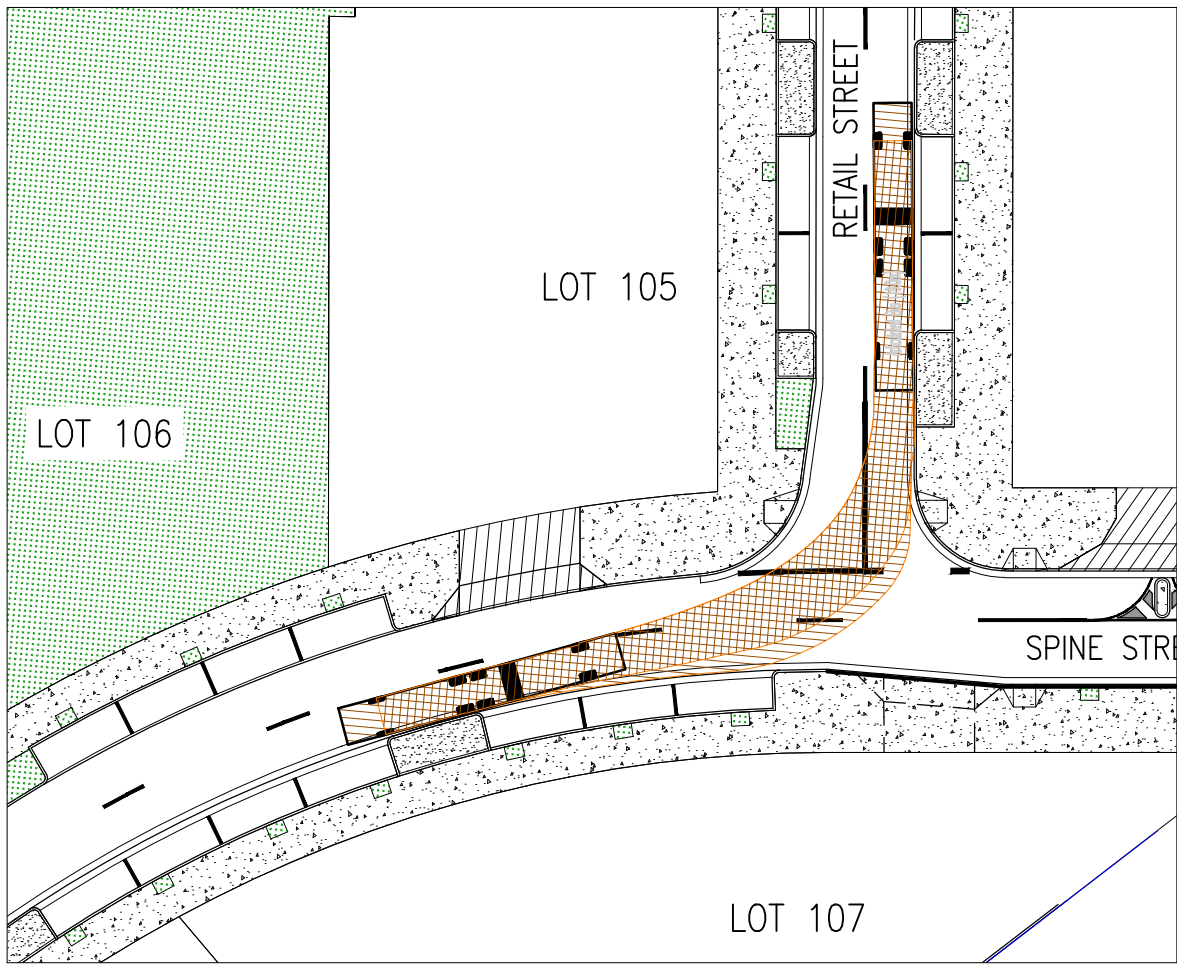

VEHICLE SWEEP PATHS – VIEW 17
SPINE STREET INTERSECTION WITH RETAIL STREET

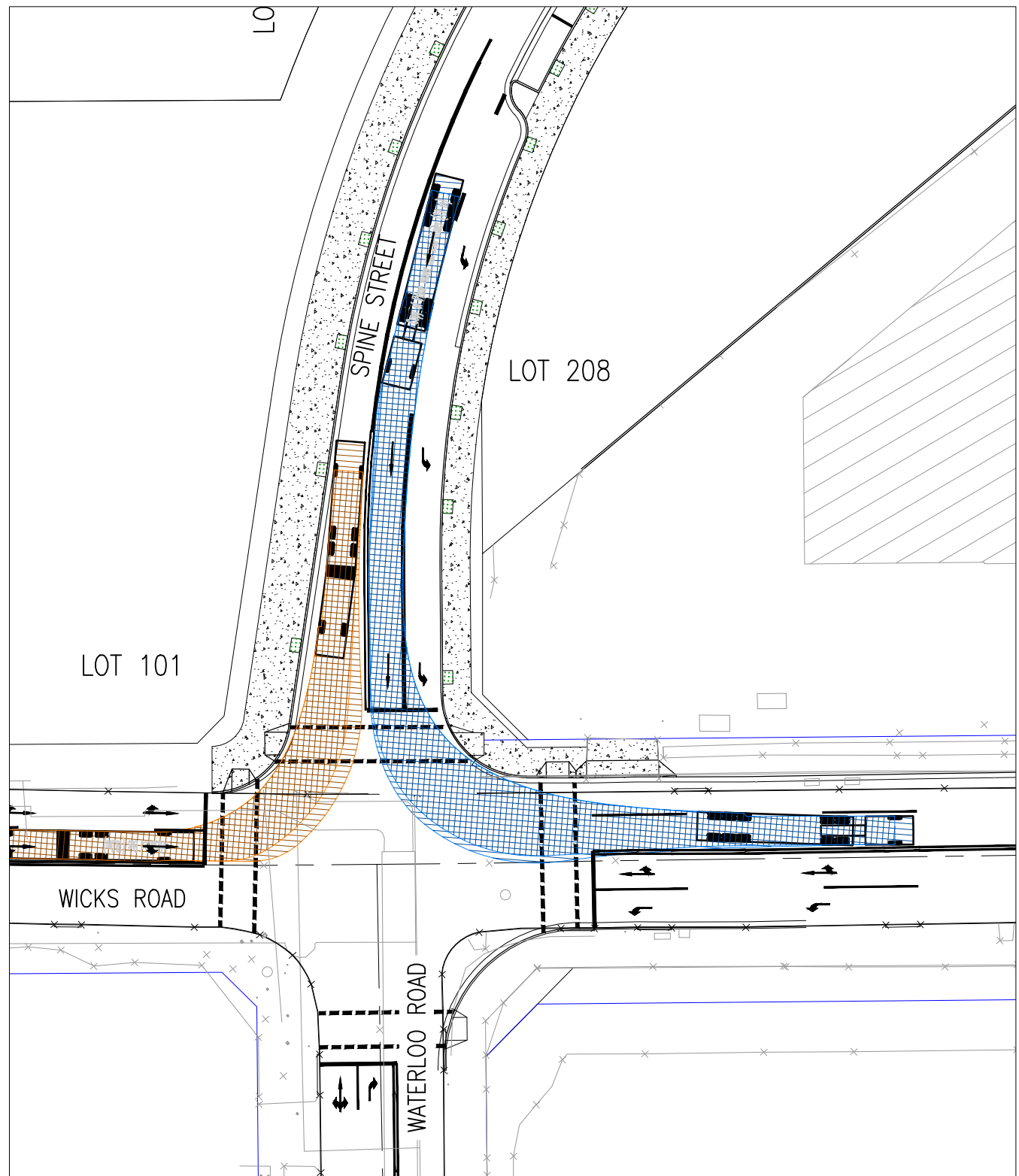

VEHICLE SWEEP PATHS – VIEW 14
WICKS WATERLOO AND SPINE STREET INTERSECTION

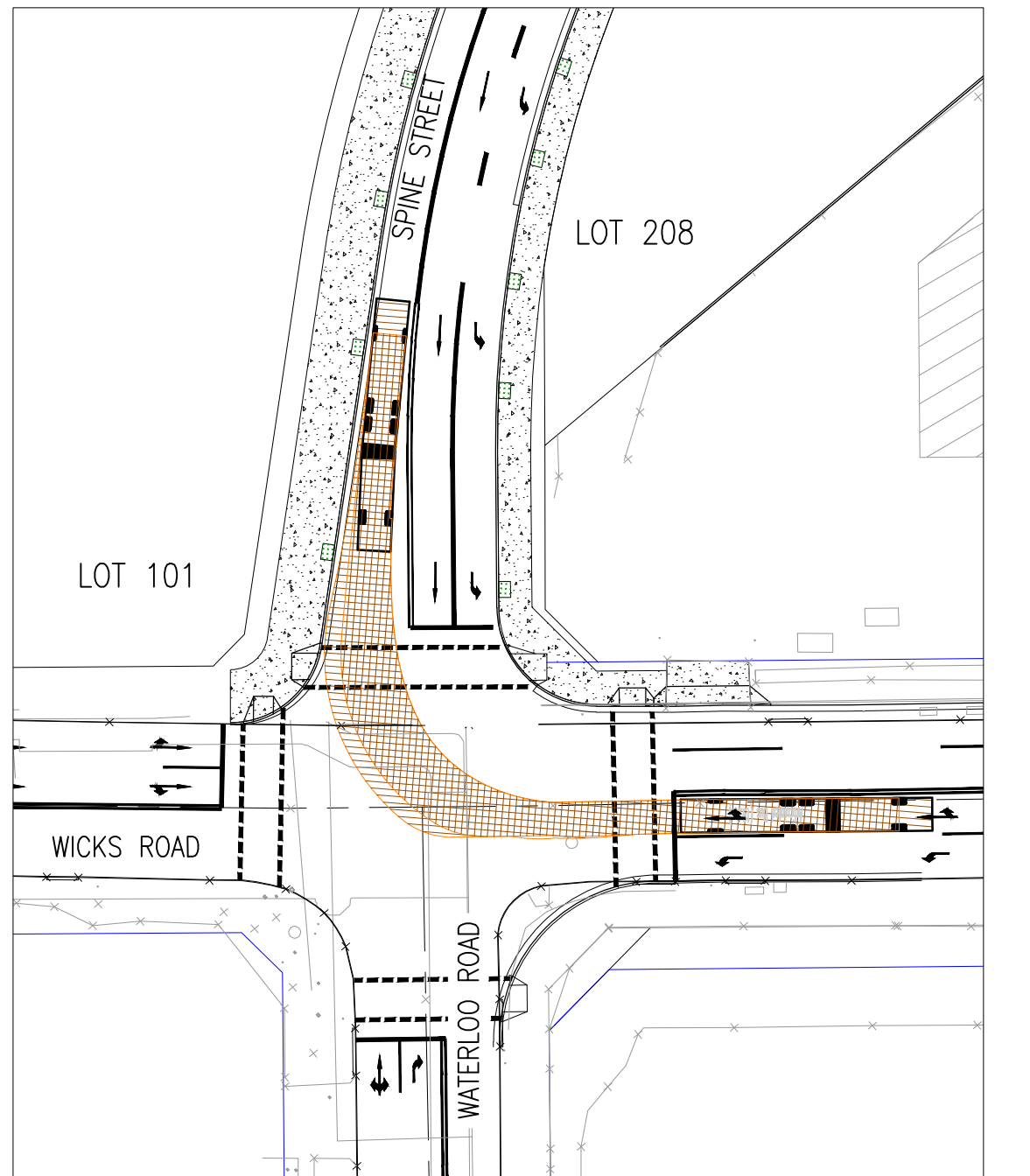

VEHICLE SWEEP PATHS – VIEW 15
WICKS WATERLOO AND SPINE STREET INTERSECTION

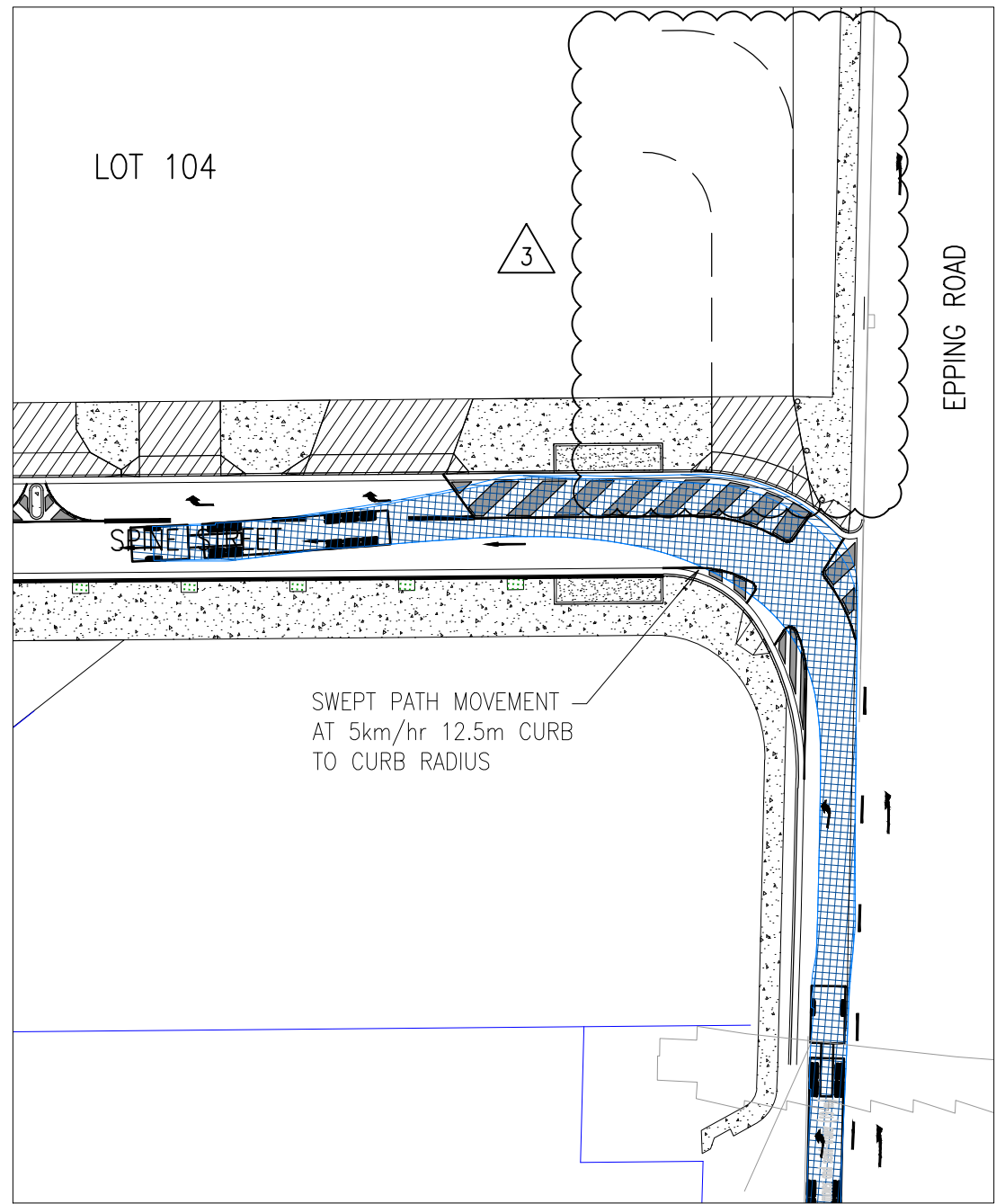

VEHICLE SWEEP PATHS – VIEW 18
EPPING ROAD SLIP LANE AND INTERSECTION WITH SPINE STREET

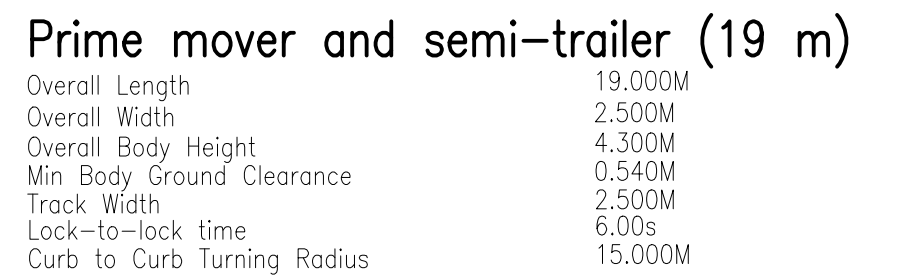
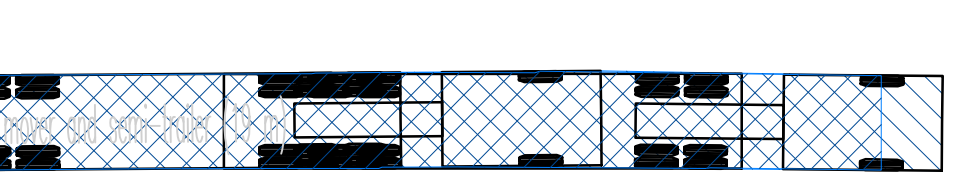
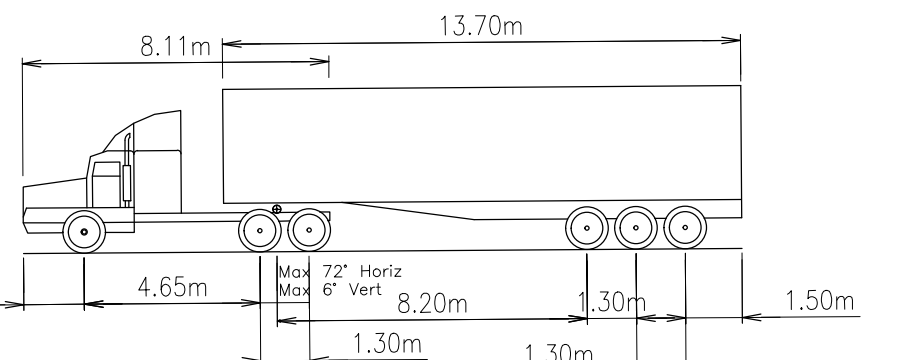
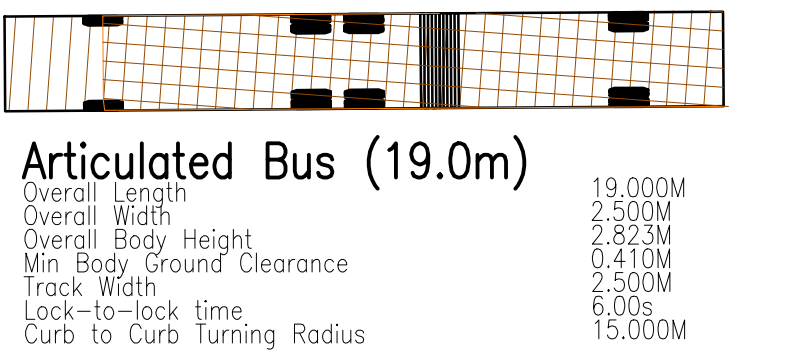
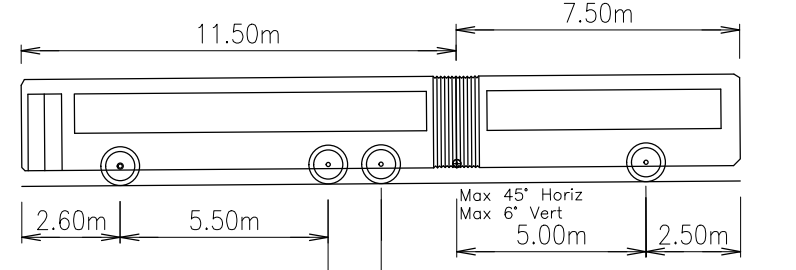

**PRINT DRAWING
IN COLOUR**



Unless agreed otherwise by Robert Bird Group Pty Ltd (RBG) and its related entities (RBG) do not warrant the accuracy, currency or completeness of any information or data they supply or transfer by electronic means. You are responsible for verifying that any information or data supplied or transferred by electronic means matches the information or data on the corresponding PDF or 'hard' version issued by RBG. You are responsible for ensuring that any information or data supplied or transferred by electronic means is not used for any purpose other than that for which it was intended. You are responsible for ensuring that any information or data supplied or transferred by electronic means is not used for any purpose other than that for which it was intended. You are responsible for ensuring that any information or data supplied or transferred by electronic means is not used for any purpose other than that for which it was intended.

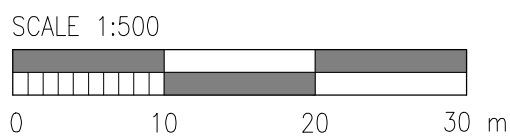

Rev.	Revision Description	By.	App.	Date	Rev.	Revision Description	By.	App.	Date
1	DRAFT SUBMISSION FOR SSDA	LAR	CR	16.05.2014					
2	UPDATED SUBMISSION FOR SSDA	LAR	CR	28.10.2014					
3	UPDATED SUBMISSION FOR SSDA	LAR	CR	04.02.2015					

Structural, Civil & Construction
Engineering Consultant



Robert Bird Group

SYDNEY OFFICE:
Robert Bird Group Pty Ltd
PO Box 838, Australia Square,
Sydney NSW 1215
Level 5
9 Castlereagh St, Sydney NSW
Ph. (02) 8246 3200
Fax. (02) 8246 3201
ACN: 010 580 248
Web Site: www.robertbird.com

Client



Title
SWEEP PATH ANALYSIS PLAN
SHEET 3 OF 3

Project
NORTH RYDE STATION PRECINCT,
M2 SITE, S.S.D.A.

NOT FOR CONSTRUCTION

Date 04.02.2015	Designer L.RUSSELL	Design Checker C.ROPE
Scale at A1 AS SHOWN	Drawn S.MANANDHAR	Principal/Project Owner R.LUCAS
Job Number 13656 B	Drawing Number C-0-3-42	Revision 3