

Aspect Industrial Estate - Lot 1 (On Lot Works)

Mamre Road, Kemps Creek

Landscape Package

Drawing Schedule

Drawing Number	Drawing Title	Scale
S1-1_000	Landscape Coversheet	N/A
S1-1_101	Landscape Plan - Lot 1	1:250
S1-1_102	Landscape Plan - Lot 1	1:250
S1-1_103	Landscape Plan - Lot 1	1:250
S1-1_501	Landscape Details	As Shown

Indicative Plant Schedule

Breakout Spaces			
Botanic Name	Common Name	Mature Size (h x w) (m)	
TREES			
<i>Lagerstroemia 'Natchez'</i>	Crepe Myrtle	8 x 6	
<i>Nyssa sylvatica</i>	Tupelo	12 x 6	
<i>Pistacia chinensis</i>	Chinese Pistachio	8 x 4	
<i>Pyrus calleryana 'Capital'</i>	Capital Ornamental Pear	11 x 3	
<i>Pyrus calleryana 'Chanticleer'</i>	Capital Ornamental Pear	11 x 6	
SHRUBS & ACCENTS			
<i>Acmena smithii</i> var. minor	Lilly Pilly	2 x 2	
<i>Alternanthera dentata 'Little Ruby'</i>		.15 x .6	
<i>Callistemon 'Endeavour'</i>	Bottlebrush	2x3	
<i>Callistemon 'Little John'</i>	Dwarf Bottle Brush	1 x 1	
<i>Loropetalum 'Purple Pixie'</i>		.5 x 1.2	
<i>Melaleuca linariifolia 'Claret Tops'</i>	Honey Myrtle	1 x 1	
<i>Phormium tenax 'Purpureum'</i>	Bronze Flax	1.5 x 1	
<i>Pittosporum 'Miss Muffet'</i>	Miss Muffet Pittosporum	1 x 1	
<i>Rhaphiolepis 'Oriental Pearl'</i>		1 X 1	
<i>Westringia fruticosa</i>	Coastal Roosemary	2 x 2	
<i>Viburnum odoratissimum</i>	Sweet Viburnum	1.5 x 1	
GRASSES AND GROUNDCOVERS			
<i>Carpobrotus glaucescens</i>	Pigface	.15 x 1	
<i>Dichondra repens</i>	Kidney Weed		
<i>Gazania tomentosa</i>	Silver Gazania	.15 x 1	
<i>Dietes grandiflora</i>	Wild Iris	.4 x .6	
<i>Liriope 'Evergreen Giant'</i>		.8 x .8	
<i>Liriope 'Just Right'</i>	Liriope	.4 x .4	
<i>Lomandra longifolia</i>	Matt Rush	1 x 1	
<i>Myoporum parvifolium</i>	Creeping Boobialla	.3 x 2	
<i>Poa 'Kingsdale'</i>	Tussock Grass	.3 x .6	
<i>Pennisetum 'Nafrai'</i>	Swamp Foxtail Grass	.6 x .6	
<i>Trachelospermum jasminoides</i>	Star Jasmine	0.3 x 0.3	
Frontage			
Botanic Name	Common Name	Mature Size (h x w) (m)	
TREES			
<i>Corymbia maculata</i>	Spotted Gum	30 x 8	
<i>Eucalyptus eugenioides</i>	Thin leaved stringybark	20 x 8	
<i>Melaleuca styphelioides</i>	Prickly Leaved Paperbark	8 x 6	
SHRUBS & ACCENTS			
<i>Acmena smithii</i> var. minor	Lilly Pilly	2 x 2	
<i>Callistemon 'Endeavour'</i>	Bottlebrush	2x3	
<i>Callistemon 'Little John'</i>	Dwarf Bottle Brush	1 x 1	
<i>Dodonaea viscosa subsp. cuneata</i>	Wedge-leaf Hop-bush		
<i>Melaleuca linariifolia 'Claret Tops'</i>	Honey Myrtle	1 x 1	
<i>Phormium tenax 'Purpureum'</i>	Bronze Flax	1.5 x 1	
<i>Westringia fruticosa</i>	Coastal Roosemary	2 x 2	
GRASSES AND GROUNDCOVERS			
<i>Carpobrotus glaucescens</i>	Pigface	.15 x 1	
<i>Gazania tomentosa</i>	Silver Gazania	.15 x 1	
<i>Hardenbergia violacea</i>	Purple Coral Pea		
<i>Lomandra longifolia</i>	Matt Rush	1 x 1	
<i>Myoporum parvifolium</i>	Creeping Boobialla	.3 x 2	
<i>Poa 'Kingsdale'</i>	Tussock Grass	.3 x .6	
<i>Pennisetum 'Nafrai'</i>	Swamp Foxtail Grass	.6 x .6	
<i>Trachelospermum jasminoides</i>	Star Jasmine	0.3 x 0.3	

* (Green) Indicates species from endemic vegetation community

NOT FOR CONSTRUCTION

© 2019 Site Image (NSW) Pty Ltd. ABN 44 801 262 380 as agent for Site Image NSW Partnership. All rights reserved. This drawing is copyright and shall not be reproduced or copied in any form or by any means (graphic, electronic or mechanical including photocopy) without the written permission of Site Image (NSW) Pty Ltd. Any license, expressed or implied, to use this document for any purpose what so ever is restricted to the terms of the written agreement between Site Image (NSW) Pty Ltd and the instructing party.

The contractor shall check and verify all work on site (including work by others) before commencing the landscape installation. Any discrepancies are to be reported to the Project Manager or Landscape Architect prior to commencing work. Do not scale this drawing. Any required dimensions not shown shall be referred to the Landscape Architect for confirmation.

G	Architectural Coordination	JW	NM	15.10.2020
F	Revised For Comment	LM	NM	01.10.2020
E	Revised For Comment	JW	NM	21.05.2020
D	Revised For Comment	JW	NM	13.05.2020
C	Architectural Coordination	JW	NM	29.04.2020
B	Architectural & Civil Updates	JD	NM	24.02.2020
A	Preliminary	JD	NM	07.11.2019
Issue	Revision Description	Drawn	Check	Date

LEGEND

Key Plan:

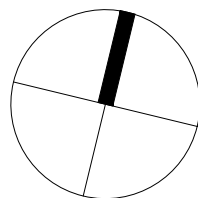

S I T E I M A G E



Landscape Architects

Level 1, 3-5 Baptist Street
Redfern NSW 2016
Australia

Tel: (61 2) 8332 5600
Fax: (61 2) 9698 2677
www.siteimage.com.au

Client:
Mirvac

Project:
Aspect Industrial Estate
Mamre Rd
Kemps Creek

Drawing Name:
Cover Sheet
Lot 1

Scale:
Job Number:
SS19-4178

SSDA

Drawing Number:
S1-1_000
Issue:
G

Swale and Riparian refer to stage 1 infrastructure works

Swale and Riparian refer to stage 1 infrastructure works

For continuation refer S1-1_101 Inset A

Access Road 2

For continuation refer S1-1_102

NOT FOR CONSTRUCTION

© 2019 Site Image (NSW) Pty Ltd ABN 44 801 262 380 as agent for Site Image NSW Partnership. All rights reserved. This drawing is copyright and shall not be reproduced or copied in any form or by any means (graphic, electronic or mechanical including photocopy) without the written permission of Site Image (NSW) Pty Ltd. Any license, expressed or implied, to use this document for any purpose what so ever is restricted to the terms of the written agreement between Site Image (NSW) Pty Ltd and the instructing party.

The contractor shall check and verify all work on site (including work by others) before commencing the landscape installation. Any discrepancies are to be reported to the Project Manager or Landscape Architect prior to commencing work. Do not scale this drawing. Any required dimensions not shown shall be referred to the Landscape Architect for confirmation.

G	Architectural Coordination	JW	NM	15.10.2020
F	Revised For Comment	LM	NM	01.10.2020
E	Revised For Comment	JW	NM	21.05.2020
D	Revised For Comment	JW	NM	13.05.2020
C	Architectural Coordination	JW	NM	29.04.2020
B	Architectural & Civil Updates	JD	NM	24.02.2020
A	Preliminary	JD	NM	07.11.2019
Issue	Revision Description	Drawn	Check	Date

LEGEND

	Extent of Works
	Property Boundary
	Proposed Tree
	Refer to Plant Schedule
	Groundcover Planting
	Refer to Plant Schedule

	Proposed Shrubs
	Refer to Plant Schedule
	Security Fence
	Decorative Gravel

	Hard Edging
	Turf
	Spray Grass

Key Plan:

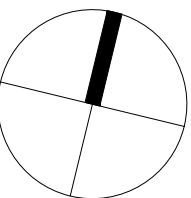
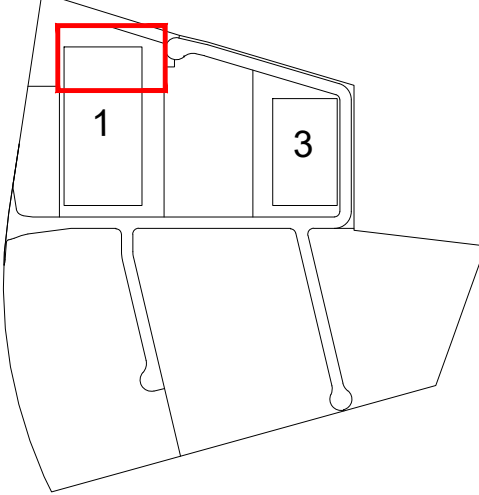

SITE IMAGE

Landscape Architects
Level 1, 3-5 Baptist Street
Redfern NSW 2016
Australia
Tel: (61 2) 8332 5600
Fax: (61 2) 9698 2677
www.siteimage.com.au

Client:
Mirvac

Project:
Aspect Industrial Estate
Mamre Rd
Kemps Creek

Drawing Name:
Landscape Plan
Lot 1

Scale: 1:250 @ A1
Job Number:
SS19-4178

SSDA

Drawing Number:
S1-1_101

Issue:
G

For continuation refer S1-1_101

For continuation refer S1-1_103

NOT FOR CONSTRUCTION

© 2019 Site Image (NSW) Pty Ltd ABN 44 801 262 380 as agent for Site Image NSW Partnership. All rights reserved. This drawing is copyright and shall not be reproduced or copied in any form or by any means (graphic, electronic or mechanical including photocopy) without the written permission of Site Image (NSW) Pty Ltd. Any license, expressed or implied, to use this document for any purpose what so ever is restricted to the terms of the written agreement between Site Image (NSW) Pty Ltd and the instructing party.

The contractor shall check and verify all work on site (including work by others) before commencing the landscape installation. Any discrepancies are to be reported to the Project Manager or Landscape Architect prior to commencing work. Do not scale this drawing. Any required dimensions not shown shall be referred to the Landscape Architect for confirmation.

G	Architectural Coordination	JW	NM	15.10.2020
F	Revised For Comment	LM	NM	01.10.2020
E	Revised For Comment	JW	NM	21.05.2020
D	Revised For Comment	JW	NM	13.05.2020
C	Architectural Coordination	JW	NM	29.04.2020
B	Architectural & Civil Updates	JD	NM	24.02.2020
A	Preliminary	JD	NM	07.11.2019
Issue	Revision Description	Drawn	Check	Date

LEGEND

- Extent of Works
- Property Boundary
- Proposed Tree
- Refer to Plant Schedule
- Groundcover Planting
- Refer to Plant Schedule

- Proposed Shrubs
- Refer to Plant Schedule
- Security Fence
- Decorative Gravel

- Hard Edging
- Turf
- Spray Grass

Key Plan:

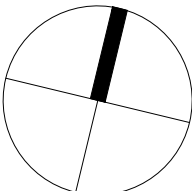
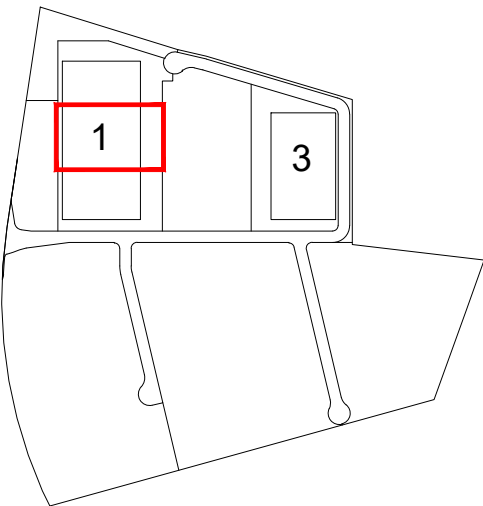

SITE IMAGE
Landscape Architects
Level 1, 3-5 Baptist Street
Redfern NSW 2016
Australia
Tel: (61 2) 8332 5600
Fax: (61 2) 9698 2877
www.siteimage.com.au

Client:
Mirvac

Project:
Aspect Industrial Estate
Mamre Rd
Kemps Creek

Drawing Name:
Landscape Plan
Lot 1

Scale: 1:250 @ A1
Job Number:
SS19-4178

SSDA
0 1 2 4 6 10m
Drawing Number:

S1-1_102 G

For continuation refer S1-1_102

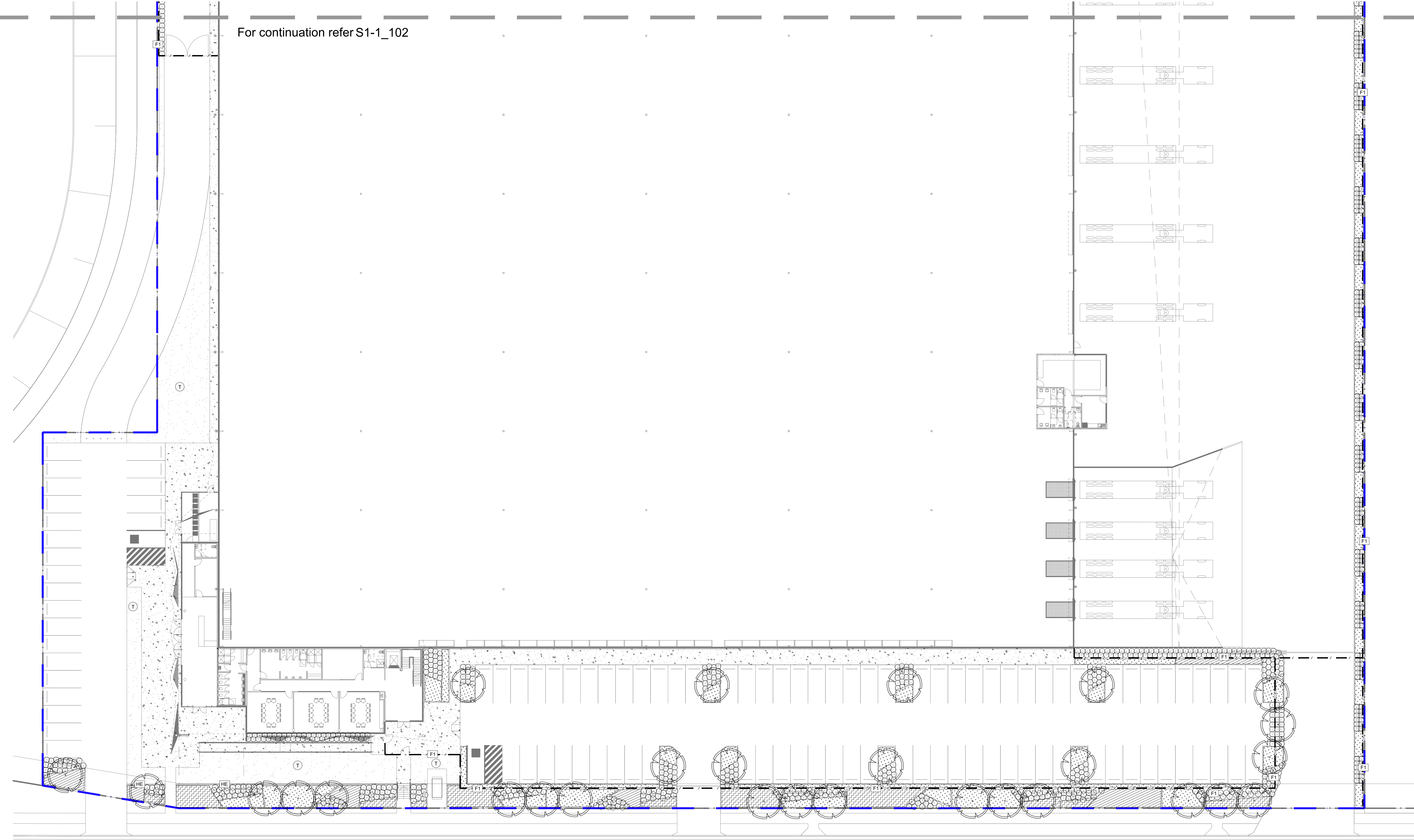

Access Road 1

NOT FOR CONSTRUCTION

© 2019 Site Image (NSW) Pty Ltd ABN 44 801 262 380 as agent for Site Image NSW Partnership. All rights reserved. This drawing is copyright and shall not be reproduced or copied in any form or by any means (graphic, electronic or mechanical including photocopy) without the written permission of Site Image (NSW) Pty Ltd. Any license, expressed or implied, to use this document for any purpose what so ever is restricted to the terms of the written agreement between Site Image (NSW) Pty Ltd and the instructing party.

The contractor shall check and verify all work on site (including work by others) before commencing the landscape installation. Any discrepancies are to be reported to the Project Manager or Landscape Architect prior to commencing work. Do not scale this drawing. Any required dimensions not shown shall be referred to the Landscape Architect for confirmation.

G	Architectural Coordination	JW	NM	15.10.2020
F	Revised For Comment	LM	NM	01.10.2020
E	Revised For Comment	JW	NM	21.05.2020
D	Revised For Comment	JW	NM	13.05.2020
C	Architectural Coordination	JW	NM	29.04.2020
B	Architectural & Civil Updates	JD	NM	24.02.2020
A	Preliminary	JD	NM	07.11.2019
Issue	Revision Description	Drawn	Check	Date

LEGEND	
	Extent of Works
	Property Boundary
	Proposed Tree Refer to Plant Schedule
	Groundcover Planting Refer to Plant Schedule

	Proposed Shrubs Refer to Plant Schedule
	Security Fence
	Decorative Gravel

	Hard Edging
	Turf
	Spray Grass

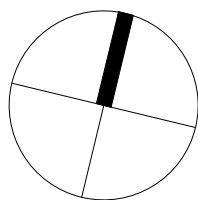
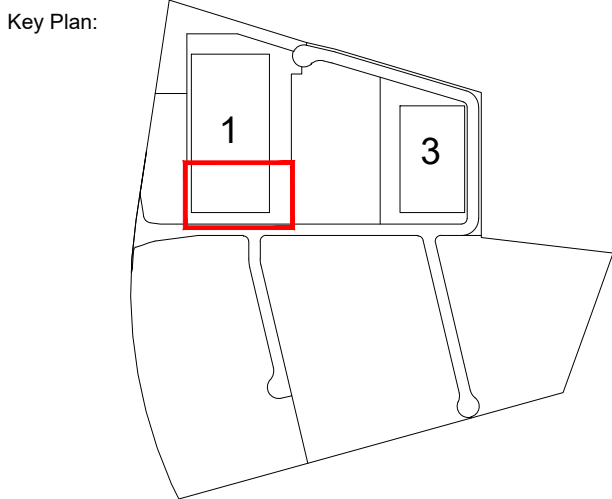

SITE IMAGE
Landscape Architects
Level 1, 3-5 Baptist Street
Redfern NSW 2016
Australia
Tel: (61 2) 8332 5600
Fax: (61 2) 9698 2877
www.siteimage.com.au

Client:
Mirvac

Project:
**Aspect Industrial Estate
Mamre Rd
Kemps Creek**

Drawing Name:
**Landscape Plan
Lot 1**

Scale: 1:250 @ A1
Job Number:
SS19-4178

SSDA
0 1 2 4 6 10m
Drawing Number:
S1-1_103

Issue:

G

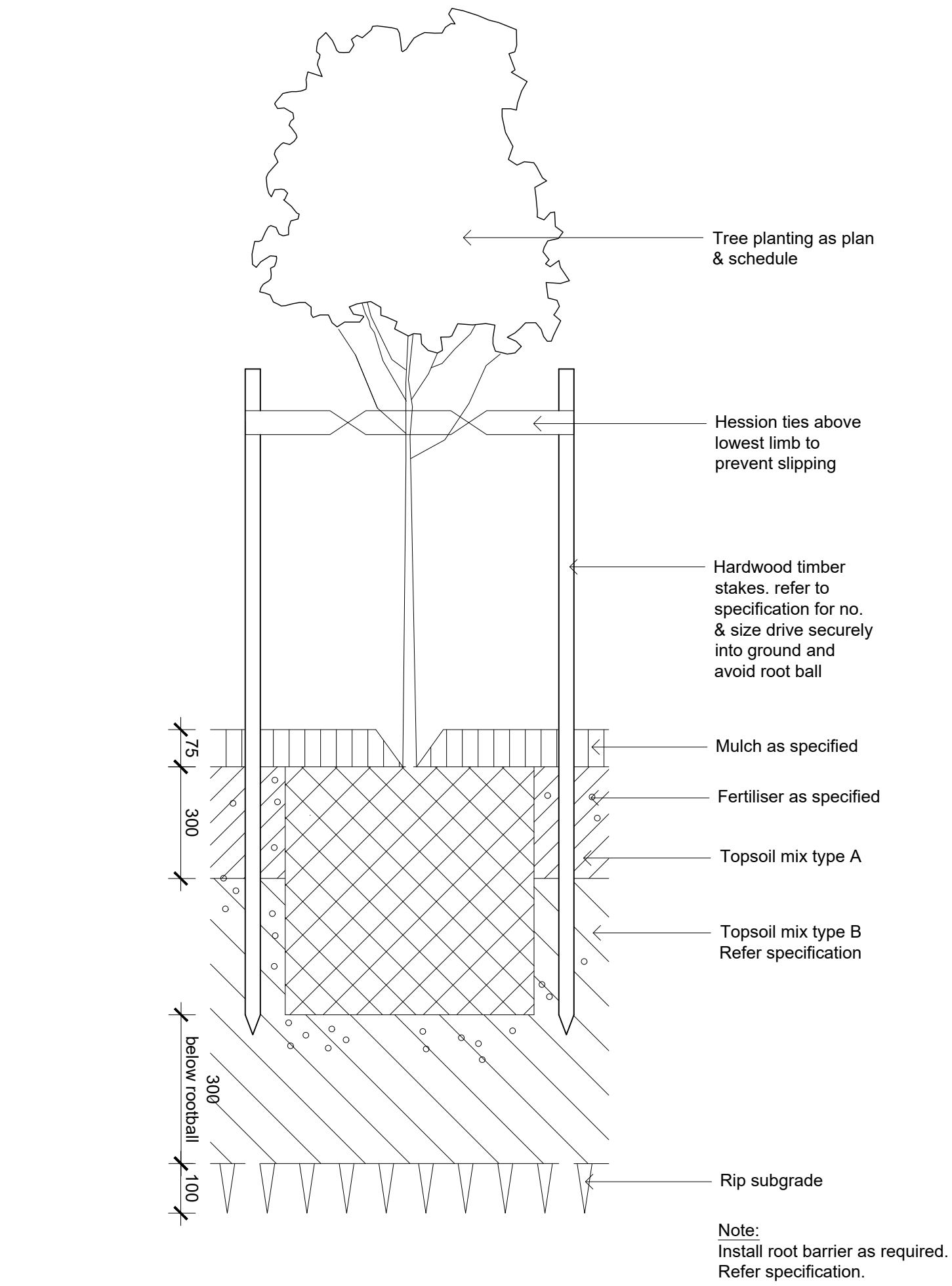

Detail 75-200L Tree Planting on Grade

1:10

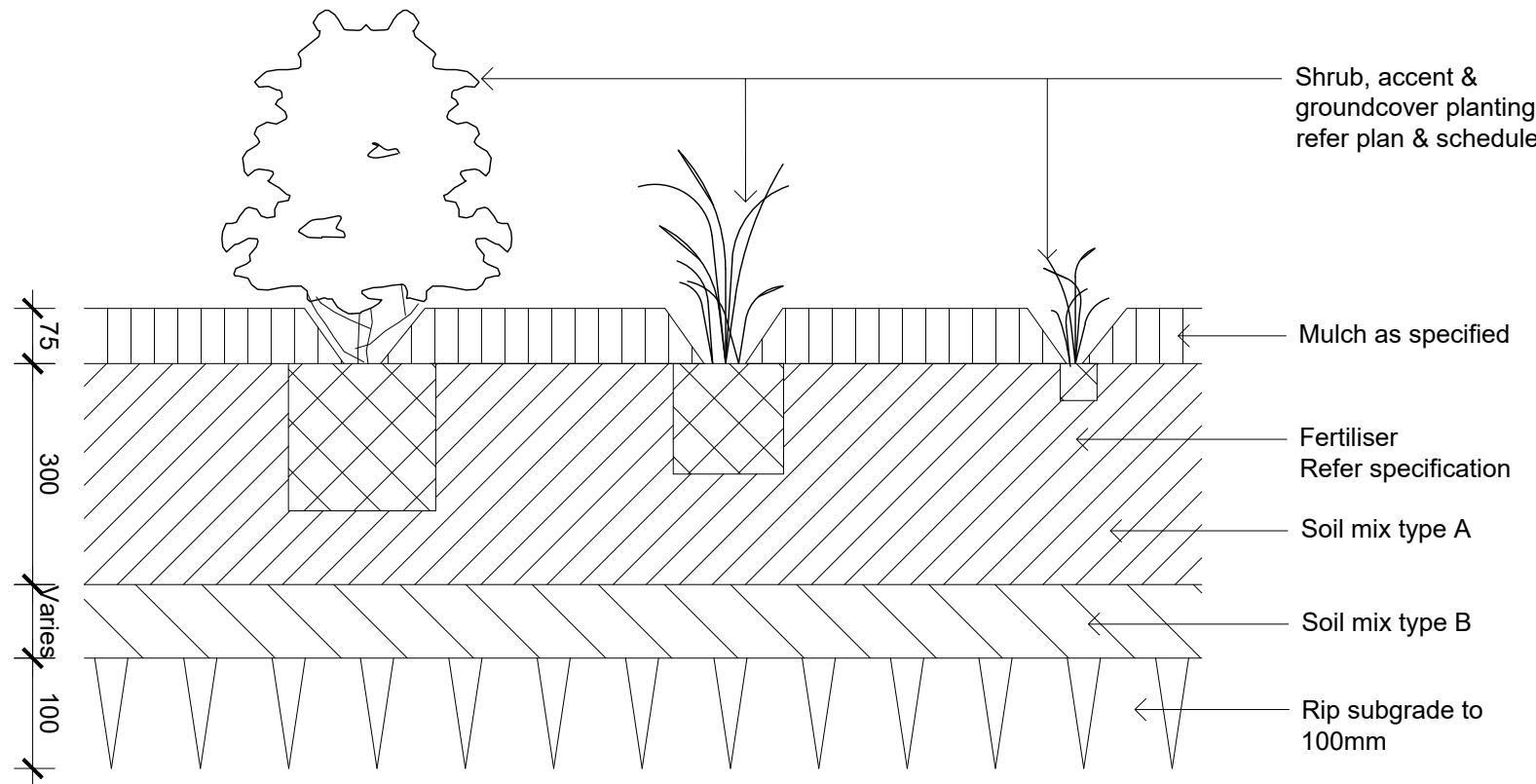

Detail Shrub Accent & Groundcover Planting on Grade

1:10

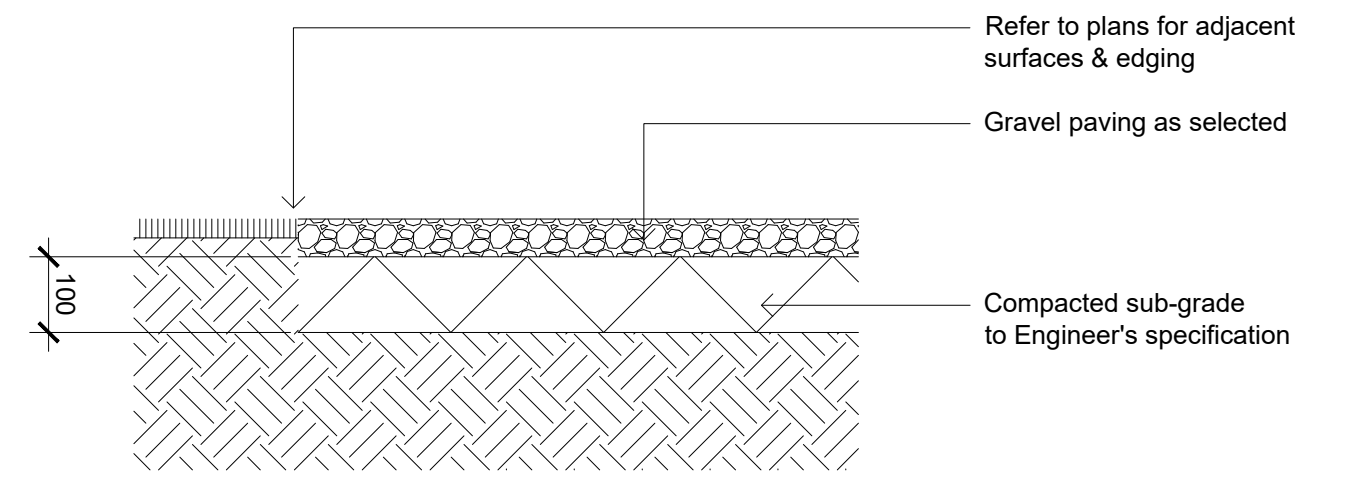
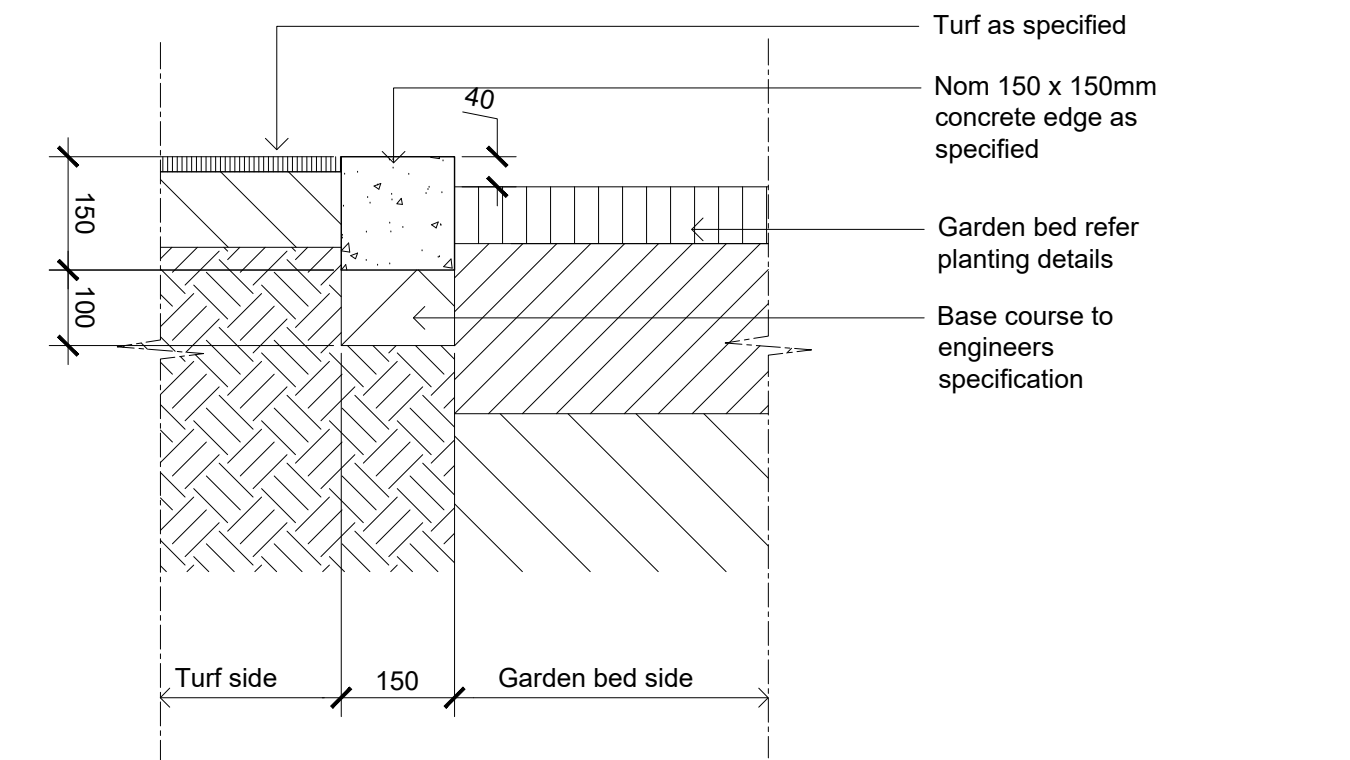
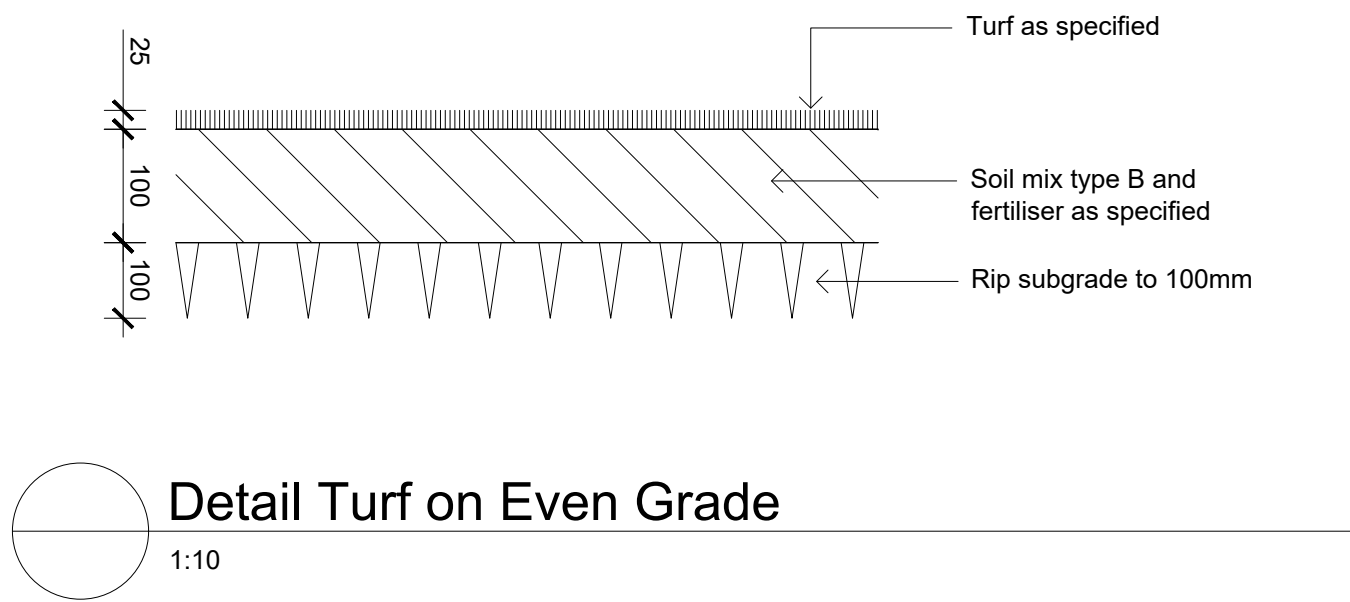

NOT FOR CONSTRUCTION

© 2019 Site Image (NSW) Pty Ltd ABN 44 801 262 380 as agent for Site Image NSW Partnership. All rights reserved. This drawing is copyright and shall not be reproduced or copied in any form or by any means (graphic, electronic or mechanical including photocopy) without the written permission of Site Image (NSW) Pty Ltd Any license, expressed or implied, to use this document for any purpose what so ever is restricted to the terms of the written agreement between Site Image (NSW) Pty Ltd and the instructing party.

The contractor shall check and verify all work on site (including work by others) before commencing the landscape installation. Any discrepancies are to be reported to the Project Manager or Landscape Architect prior to commencing work. Do not scale this drawing. Any required dimensions not shown shall be referred to the Landscape Architect for confirmation.

Issue	Revision Description	Drawn	Check	Date
G	Architectural Coordination	JW	NM	15.10.2020
F	Revised For Comment	LM	NM	01.10.2020
E	Revised For Comment	JW	NM	21.05.2020
D	Revised For Comment	JW	NM	13.05.2020
C	Architectural Coordination	JW	NM	29.04.2020
B	Architectural & Civil Updates	JD	NM	24.02.2020
A	Preliminary	JD	NM	07.11.2019

LEGEND

Key Plan:

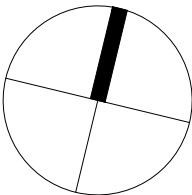

S I T E I M A G E
Landscape Architects
Level 1, 3-5 Baptist Street
Redfern NSW 2016
Australia
Tel: (61 2) 8332 5600
Fax: (61 2) 9698 2877
www.siteimage.com.au

Client:
Mirvac

Project:
**Aspect Industrial Estate
Mamre Rd
Kemps Creek**

Drawing Name:
Landscape Details

Scale:
Job Number:
SS19-4178

SSDA

Drawing Number:
S1-1_501
Issue:
G

Aspect Industrial Estate - Lot 3 (On Lot Works)

Mamre Road, Kemps Creek Landscape Package

Drawing Schedule

Drawing Number	Drawing Title	Scale
S1-3_000	Landscape Coversheet	N/A
S1-3_101	Landscape Plan - Lot 3	1:250
S1-3_102	Landscape Plan - Lot 3	1:250
S1-3_103	Landscape Plan - Lot 3	1:250
S1-3_501	Landscape Details	As Shown

Indicative Plant Schedule

Breakout Spaces			
Botanic Name	Common Name	Mature Size	
		(h x w) (m)	
TREES			
<i>Lagerstroemia 'Natchez'</i>	Crepe Myrtle	8 x 6	
<i>Nyssa sylvatica</i>	Tupelo	12 x 6	
<i>Pistacia chinensis</i>	Chinese Pistachio	8 x 4	
<i>Pyrus calleryana 'Capital'</i>	Capital Ornamental Pear	11 x 3	
<i>Pyrus calleryana 'Chanticleer'</i>	Capital Ornamental Pear	11 x 6	
SHRUBS & ACCENTS			
<i>Acmena smithii</i> var. minor	Lilly Pilly	2 x 2	
<i>Alternanthera dentata</i> 'Little Ruby'		.15 x .6	
<i>Callistemon 'Endeavour'</i>	Bottlebrush	2x3	
<i>Callistemon 'Little John'</i>	Dwarf Bottle Brush	1 x 1	
<i>Loropetalum 'Purple Pixie'</i>		.5 x 1.2	
<i>Melaleuca linariifolia 'Claret Tops'</i>	Honey Myrtle	1 x 1	
<i>Phormium tenax 'Purpureum'</i>	Bronze Flax	1.5 x 1	
<i>Pittosporum 'Miss Muffet'</i>	Miss Muffet Pittosporum	1 x 1	
<i>Rhaphiolepis 'Oriental Pearl'</i>		1 X 1	
<i>Westringia fruticosa</i>	Coastal Roasemary	2 x 2	
<i>Viburnum odoratissimum</i>	Sweet Viburnum	1.5 x 1	
GRASSES AND GROUNDCOVERS			
<i>Carpobrotus glaucescens</i>	Pigface	.15 x 1	
<i>Dichondra repens</i>	Kidney Weed		
<i>Gazania tomentosa</i>	Silver Gazania	.15 x 1	
<i>Dietes grandiflora</i>	Wild Iris	.4 x .6	
<i>Liriope 'Evergreen Giant'</i>		.8 x .8	
<i>Liriope 'Just Right'</i>	Liriope	.4 x .4	
<i>Lomandra longifolia</i>	Matt Rush	1 x 1	
<i>Myoporum parvifolium</i>	Creeping Boobialla	.3 x 2	
<i>Poa 'Kingsdale'</i>	Tussock Grass	.3 x .6	
<i>Pennisetum 'Nafray'</i>	Swamp Foxtail Grass	.6 x .6	
<i>Trachelospermum jasminoides</i>	Star Jasmine	0.3 x 0.3	
Frontage			
Botanic Name	Common Name	Mature Size	
		(h x w) (m)	
TREES			
<i>Corymbia maculata</i>	Spotted Gum	30 x 8	
<i>Eucalyptus eugenioides</i>	Thin leaved stringybark	20 x 8	
<i>Melaleuca styphelioides</i>	Prickly Leaved Paperbark	8 x 6	
SHRUBS & ACCENTS			
<i>Acmena smithii</i> var. minor	Lilly Pilly	2 x 2	
<i>Callistemon 'Endeavour'</i>	Bottlebrush	2x3	
<i>Callistemon 'Little John'</i>	Dwarf Bottle Brush	1 x 1	
<i>Dodonaea viscosa subsp. cuneata</i>	Wedge-leaf Hop-bush		
<i>Melaleuca linariifolia 'Claret Tops'</i>	Honey Myrtle	1 x 1	
<i>Phormium tenax 'Purpureum'</i>	Bronze Flax	1.5 x 1	
<i>Westringia fruticosa</i>	Coastal Roasemary	2 x 2	
GRASSES AND GROUNDCOVERS			
<i>Carpobrotus glaucescens</i>	Pigface	.15 x 1	
<i>Gazania tomentosa</i>	Silver Gazania	.15 x 1	
<i>Hardenbergia violacea</i>	Purple Coral Pea		
<i>Lomandra longifolia</i>	Matt Rush	1 x 1	
<i>Myoporum parvifolium</i>	Creeping Boobialla	.3 x 2	
<i>Poa 'Kingsdale'</i>	Tussock Grass	.3 x .6	
<i>Pennisetum 'Nafray'</i>	Swamp Foxtail Grass	.6 x .6	
<i>Trachelospermum jasminoides</i>	Star Jasmine	0.3 x 0.3	

*(Green) Indicates species from endemic vegetation community

NOT FOR CONSTRUCTION

© 2019 Site Image (NSW) Pty Ltd ABN 44 801 262 380 as agent for Site Image NSW Partnership. All rights reserved. This drawing is copyright and shall not be reproduced or copied in any form or by any means (graphic, electronic or mechanical including photocopy) without the written permission of Site Image (NSW) Pty Ltd Any license, expressed or implied, to use this document for any purpose what so ever is restricted to the terms of the written agreement between Site Image (NSW) Pty Ltd and the instructing party.

The contractor shall check and verify all work on site (including work by others) before commencing the landscape installation. Any discrepancies are to be reported to the Project Manager or Landscape Architect prior to commencing work. Do not scale this drawing. Any required dimensions not shown shall be referred to the Landscape Architect for confirmation.

G	Architectural Coordination	JW	NM	15.10.2020
F	Revised For Comment	LM	NM	01.10.2020
E	Revised For Comment	JW	NM	21.05.2020
D	Revised For Comment	JW	NM	13.05.2020
C	Architectural Coordination	JW	NM	29.04.2020
B	Architectural & Civil Updates	JD	NM	24.02.2020
A	Preliminary	JD	NM	07.11.2019
Issue	Revision Description	Drawn	Check	Date

LEGEND

Key Plan:

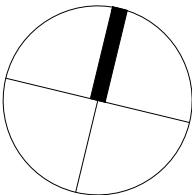

S I T E I M A G E

Landscape Architects

Level 1, 3-5 Baptist Street
Redfern NSW 2016
Australia

Tel: (61 2) 8332 5600
Fax: (61 2) 9698 2877
www.siteimage.com.au

Client:
Mirvac

Project:
Aspect Industrial Estate
Mamre Rd
Kemps Creek

Drawing Name:

Cover Sheet
Lot 3

Scale:

Job Number:

SS19-4178

SSDA

Drawing Number:

S1-3_000

Issue:

G

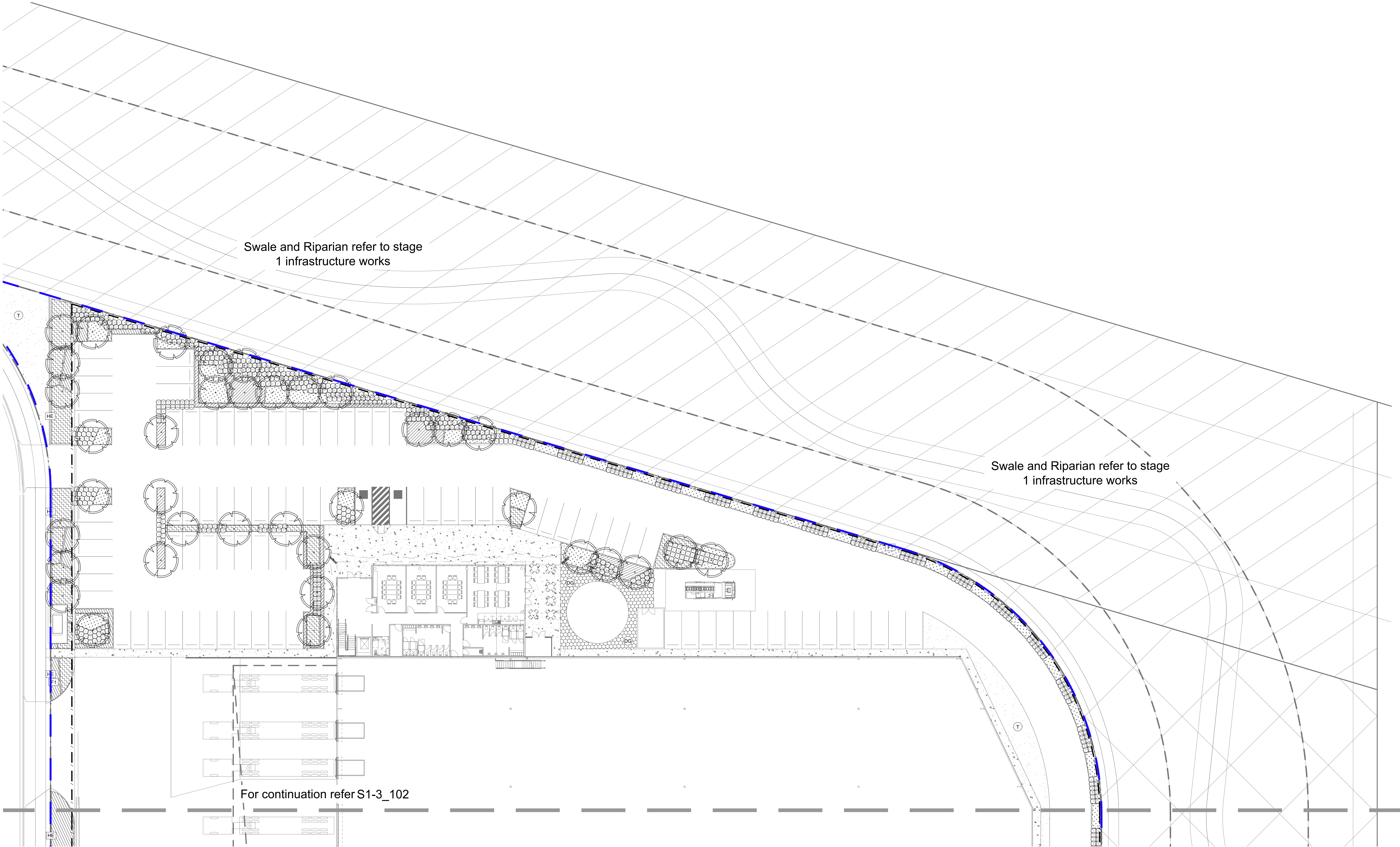

Swale and Riparian refer to stage 1 infrastructure works

Swale and Riparian refer to stage 1 infrastructure works

For continuation refer S1-3_102

NOT FOR CONSTRUCTION

© 2019 Site Image (NSW) Pty Ltd. ABN 44 801 262 380 as agent for Site Image NSW Partnership. All rights reserved. This drawing is copyright and shall not be reproduced or copied in any form or by any means (graphic, electronic or mechanical including photocopy) without the written permission of Site Image (NSW) Pty Ltd. Any license, expressed or implied, to use this document for any purpose what so ever is restricted to the terms of the written agreement between Site Image (NSW) Pty Ltd and the instructing party.

The contractor shall check and verify all work on site (including work by others) before commencing the landscape installation. Any discrepancies are to be reported to the Project Manager or Landscape Architect prior to commencing work. Do not scale this drawing. Any required dimensions not shown shall be referred to the Landscape Architect for confirmation.

G	Architectural Coordination	JW	NM	15.10.2020
F	Revised For Comment	LM	NM	01.10.2020
E	Revised For Comment	JW	NM	21.05.2020
D	Revised For Comment	JW	NM	13.05.2020
C	Architectural Coordination	JW	NM	29.04.2020
B	Architectural & Civil Updates	JD	NM	24.02.2020
A	Preliminary	JD	NM	07.11.2019
Issue	Revision Description	Drawn	Check	Date

LEGEND	
	Extent of Works
	Property Boundary
	Proposed Tree Refer to Plant Schedule
	Groundcover Planting Refer to Plant Schedule

	Proposed Shrubs Refer to Plant Schedule
	Security Fence
	Decorative Gravel

	Hard Edging
	Turf
	Spray Grass

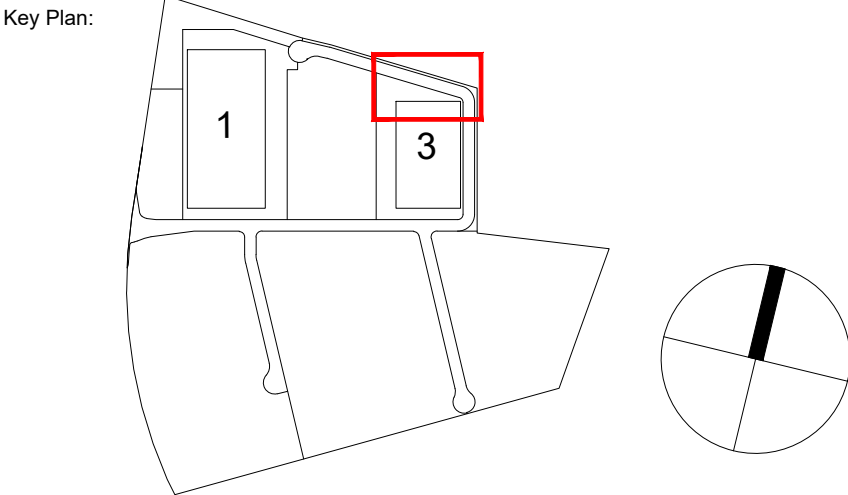

SITE IMAGE
Landscape Architects
Level 1, 3-5 Baptist Street
Redfern NSW 2016
Australia
Tel: (61 2) 8332 5600
Fax: (61 2) 9698 2877
www.siteimage.com.au

Client:
Mirvac
Project:
Aspect Industrial Estate
Mamre Rd
Kemps Creek

Drawing Name:
Landscape Plan
Lot 3
Scale: 1:250 @ A1
Job Number:
SS19-4178

SSDA
0 1 2 4 6 10m
Drawing Number:
S1-3_101
Issue:
G

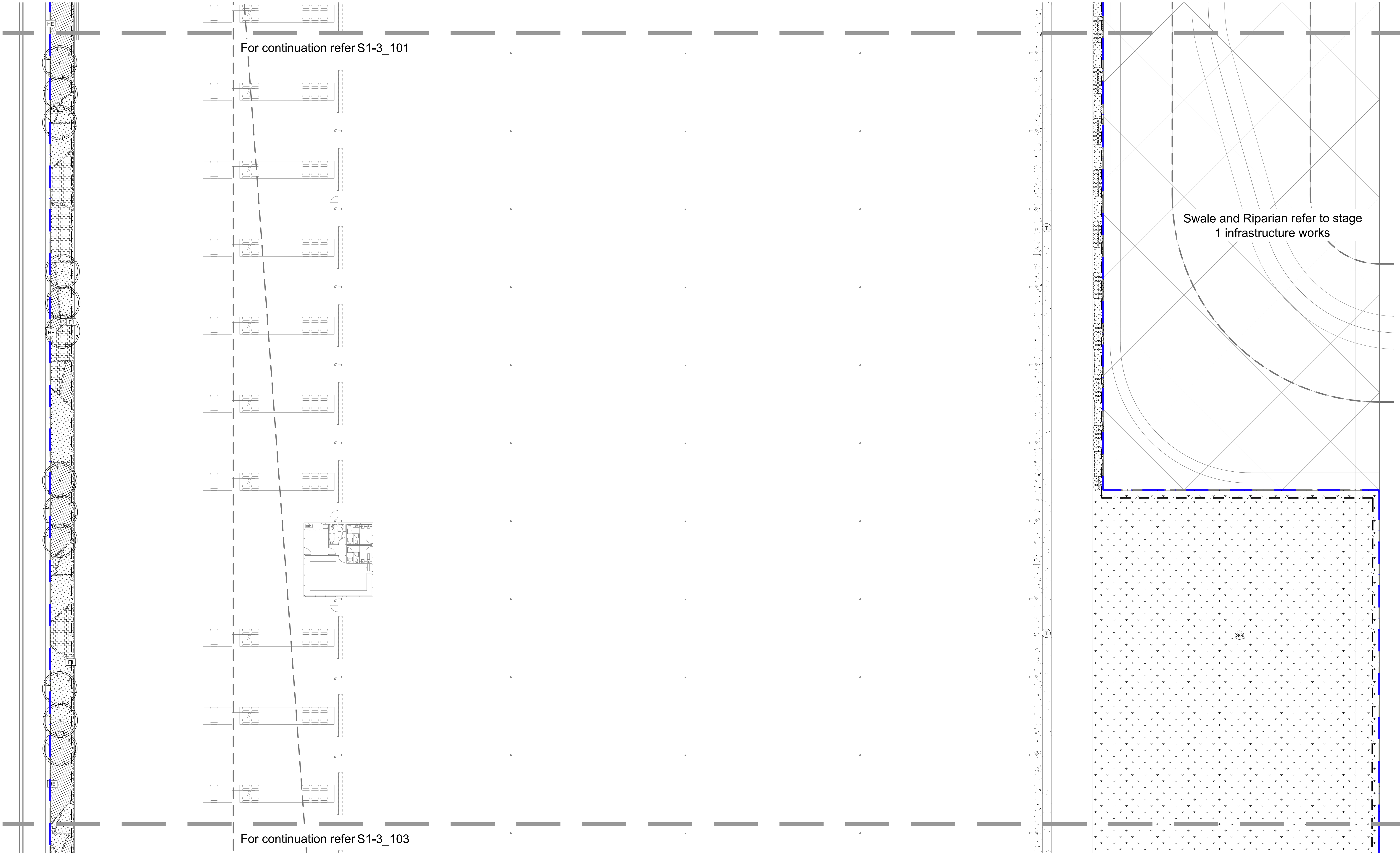

NOT FOR CONSTRUCTION

© 2019 Site Image (NSW) Pty Ltd ABN 44 801 262 380 as agent for Site Image NSW Partnership. All rights reserved. This drawing is copyright and shall not be reproduced or copied in any form or by any means (graphic, electronic or mechanical including photocopy) without the written permission of Site Image (NSW) Pty Ltd. Any license, expressed or implied, to use this document for any purpose what so ever is restricted to the terms of the written agreement between Site Image (NSW) Pty Ltd and the instructing party.

The contractor shall check and verify all work on site (including work by others) before commencing the landscape installation. Any discrepancies are to be reported to the Project Manager or Landscape Architect prior to commencing work. Do not scale this drawing. Any required dimensions not shown shall be referred to the Landscape Architect for confirmation.

G	Architectural Coordination	JW	NM	15.10.2020
F	Revised For Comment	LM	NM	01.10.2020
E	Revised For Comment	JW	NM	21.05.2020
D	Revised For Comment	JW	NM	13.05.2020
C	Architectural Coordination	JW	NM	29.04.2020
B	Architectural & Civil Updates	JD	NM	24.02.2020
A	Preliminary	JD	NM	07.11.2019
Issue	Revision Description	Drawn	Check	Date

LEGEND

- Extent of Works
- Property Boundary
- Proposed Tree
- Refer to Plant Schedule
- Groundcover Planting
- Refer to Plant Schedule

- Proposed Shrubs
- Refer to Plant Schedule
- Security Fence
- Decorative Gravel

- Hard Edging
- Turf
- Spray Grass

Key Plan:

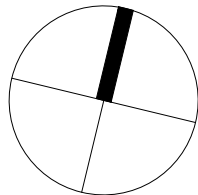
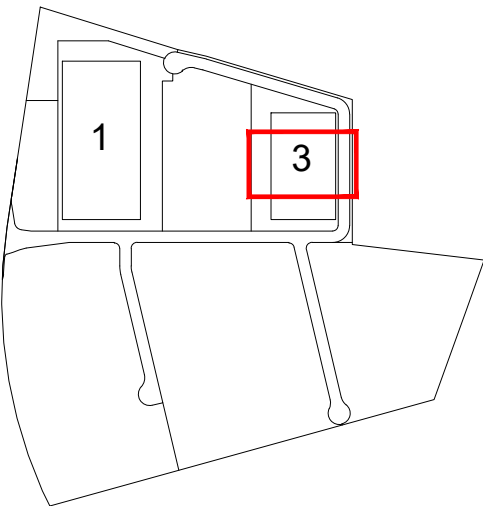

SITE IMAGE
Landscape Architects
Level 1, 3-5 Baptist Street
Redfern NSW 2016
Australia
Tel: (61 2) 8332 5600
Fax: (61 2) 9698 2877
www.siteimage.com.au

Client:
Mirvac

Project:
Aspect Industrial Estate
Mamre Rd
Kemps Creek

Drawing Name:
Landscape Plan
Lot 3

Scale: 1:250 @ A1
Job Number:
SS19-4178

SSDA
0 1 2 4 6 10m
Drawing Number:
S1-3_102

Issue:
G

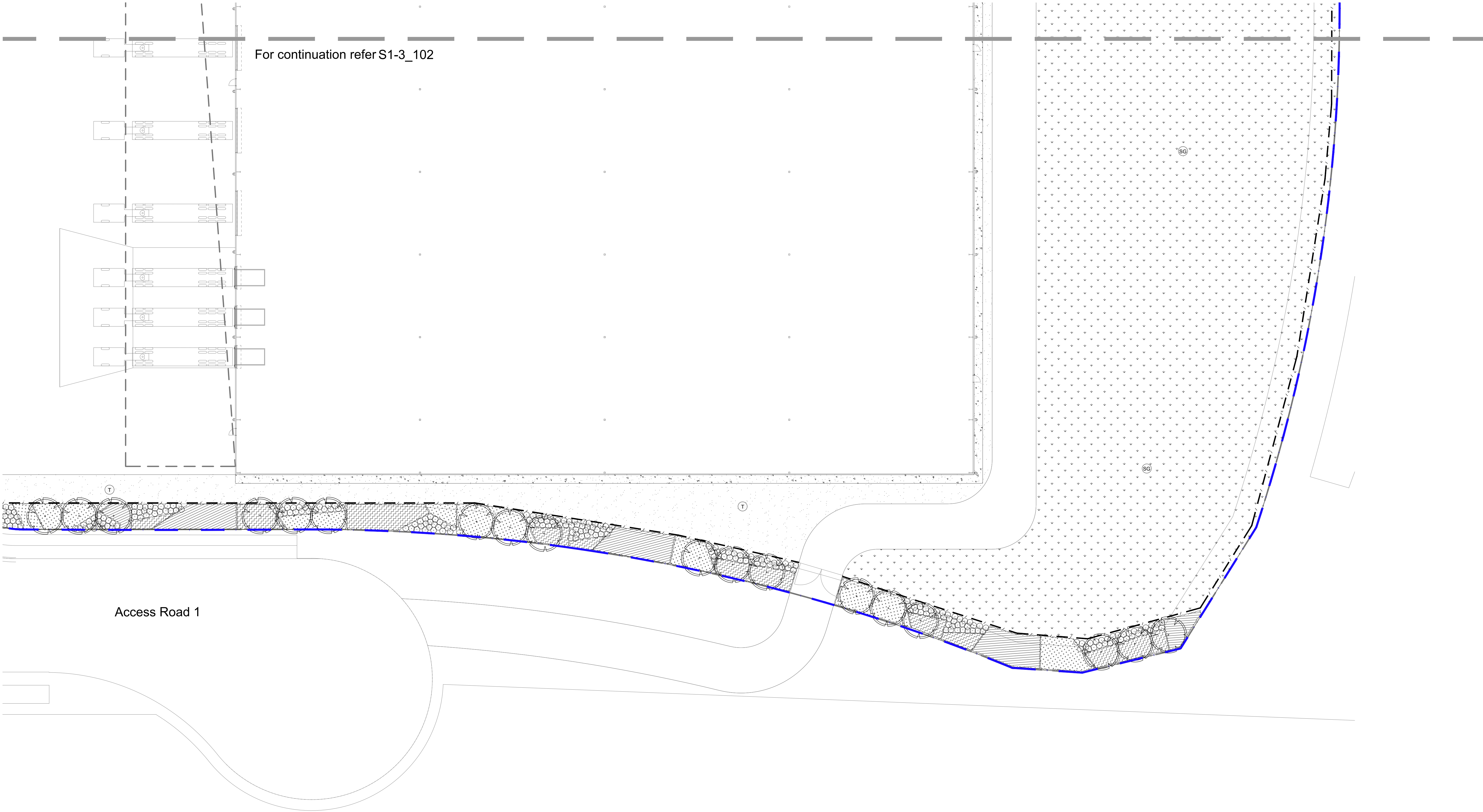

NOT FOR CONSTRUCTION

© 2019 Site Image (NSW) Pty Ltd ABN 44 801 262 380 as agent for Site Image NSW Partnership. All rights reserved. This drawing is copyright and shall not be reproduced or copied in any form or by any means (graphic, electronic or mechanical including photocopy) without the written permission of Site Image (NSW) Pty Ltd. Any license, expressed or implied, to use this document for any purpose what so ever is restricted to the terms of the written agreement between Site Image (NSW) Pty Ltd and the instructing party.

The contractor shall check and verify all work on site (including work by others) before commencing the landscape installation. Any discrepancies are to be reported to the Project Manager or Landscape Architect prior to commencing work. Do not scale this drawing. Any required dimensions not shown shall be referred to the Landscape Architect for confirmation.

G	Architectural Coordination
F	Revised For Comment
E	Revised For Comment
D	Revised For Comment
C	Architectural Coordination
B	Architectural & Civil Updates
A	Preliminary
Issue	Revision Description

JW	NM	15.10.2020
LM	NM	01.10.2020
JW	NM	21.05.2020
JW	NM	13.05.2020
JW	NM	29.04.2020
JD	NM	24.02.2020
JD	NM	07.11.2019
Drawn	Check	Date

LEGEND

	Extent of Works
	Property Boundary
	Proposed Tree Refer to Plant Schedule
	Groundcover Planting Refer to Plant Schedule

	Proposed Shrubs Refer to Plant Schedule
	Security Fence
	Decorative Gravel

	Hard Edging
	Turf
	Spray Grass

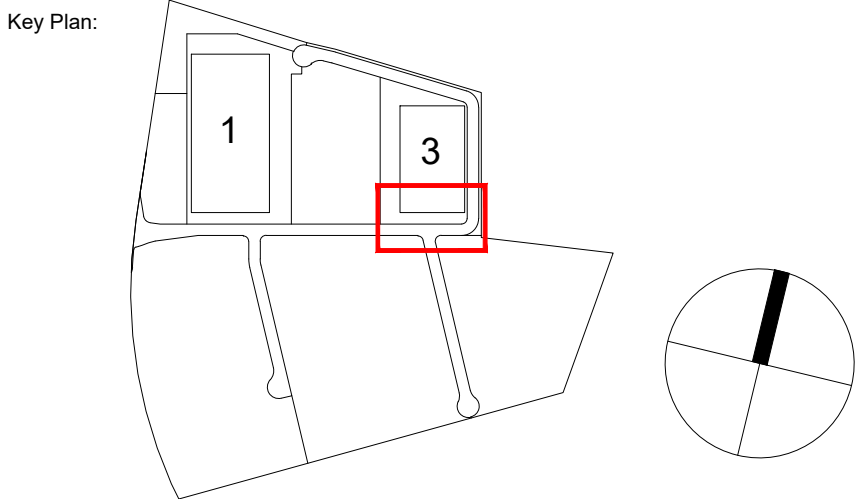

SITE IMAGE
Landscape Architects
Level 1, 3-5 Baptist Street
Redfern NSW 2016
Australia
Tel: (61 2) 8332 5600
Fax: (61 2) 9698 2877
www.siteimage.com.au

Client:
Mirvac

Project:
**Aspect Industrial Estate
Mamre Rd
Kemps Creek**

Drawing Name:
**Landscape Plan
Lot 3**

Scale: 1:250 @ A1
Job Number:
SS19-4178

SSDA
0 1 2 4 6 10m
Drawing Number:
S1-3_103

Issue:
G

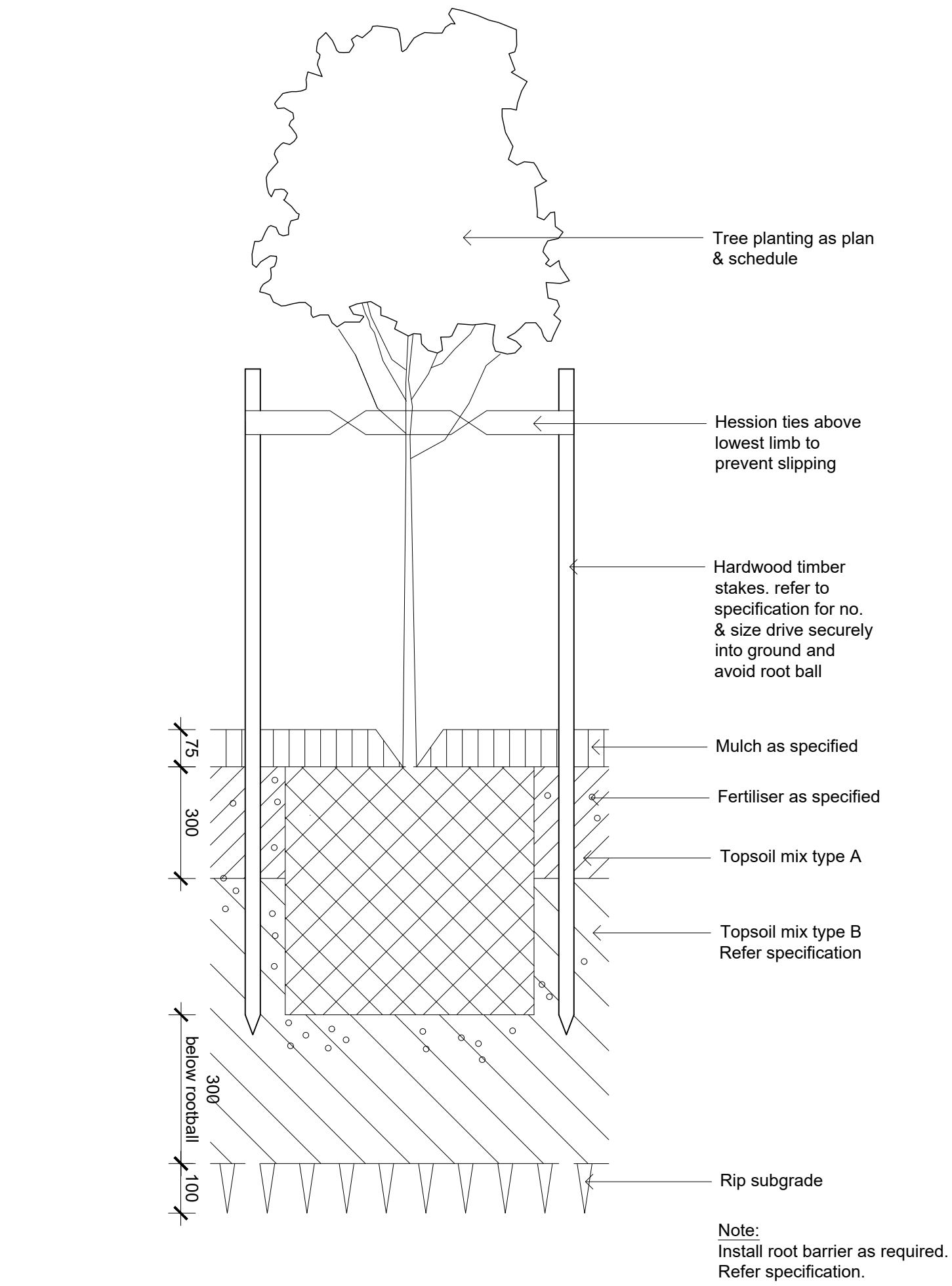

Detail 75-200L Tree Planting on Grade

1:10

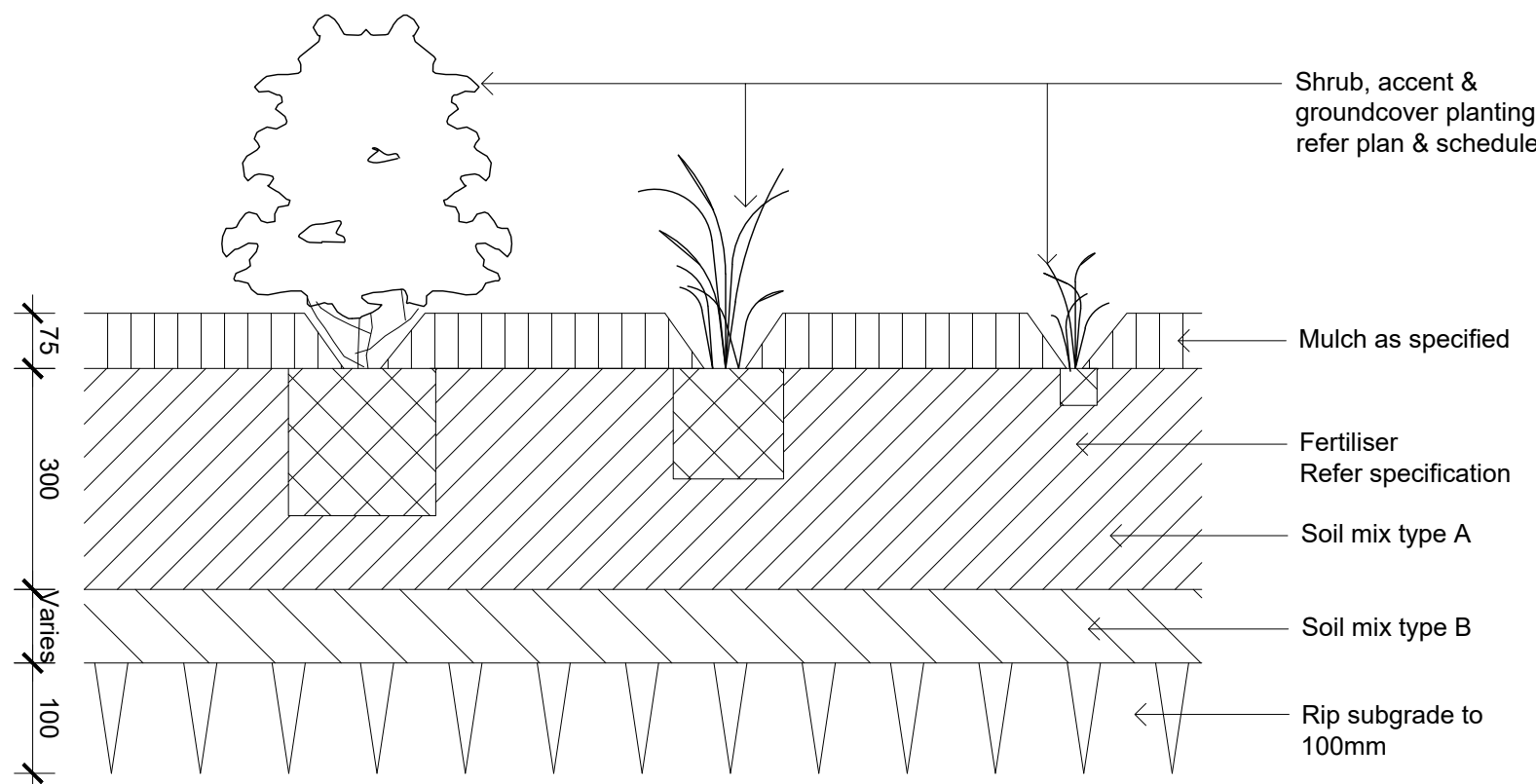

Detail Shrub Accent & Groundcover Planting on Grade

1:10

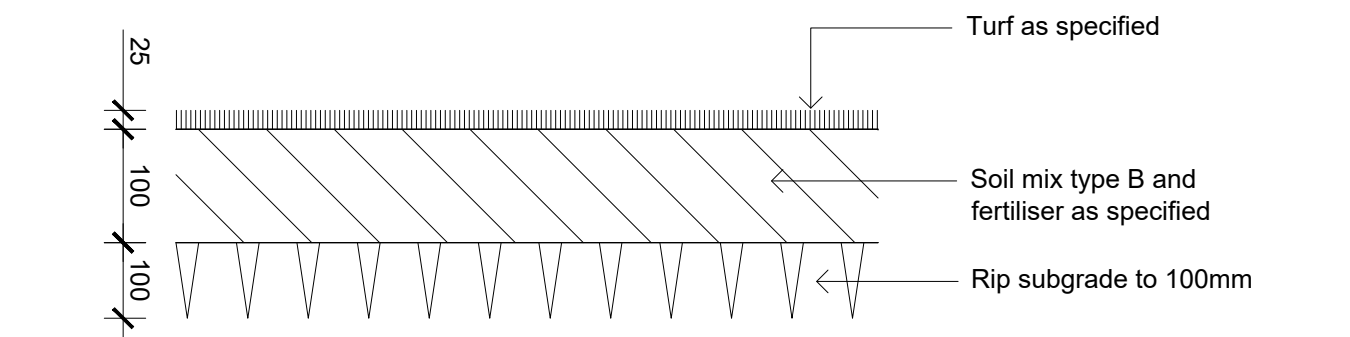

Detail Turf on Even Grade

1:10

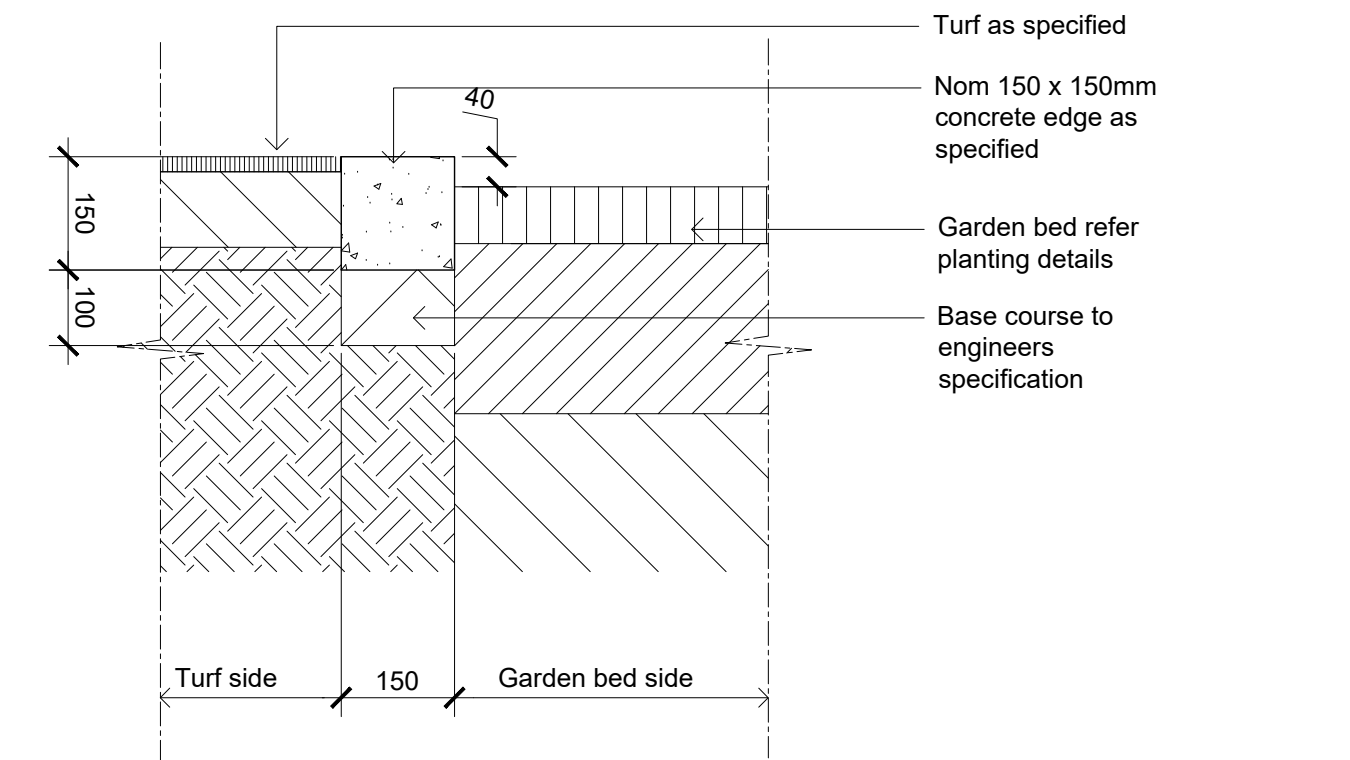

Typical Concrete Edge

1:10

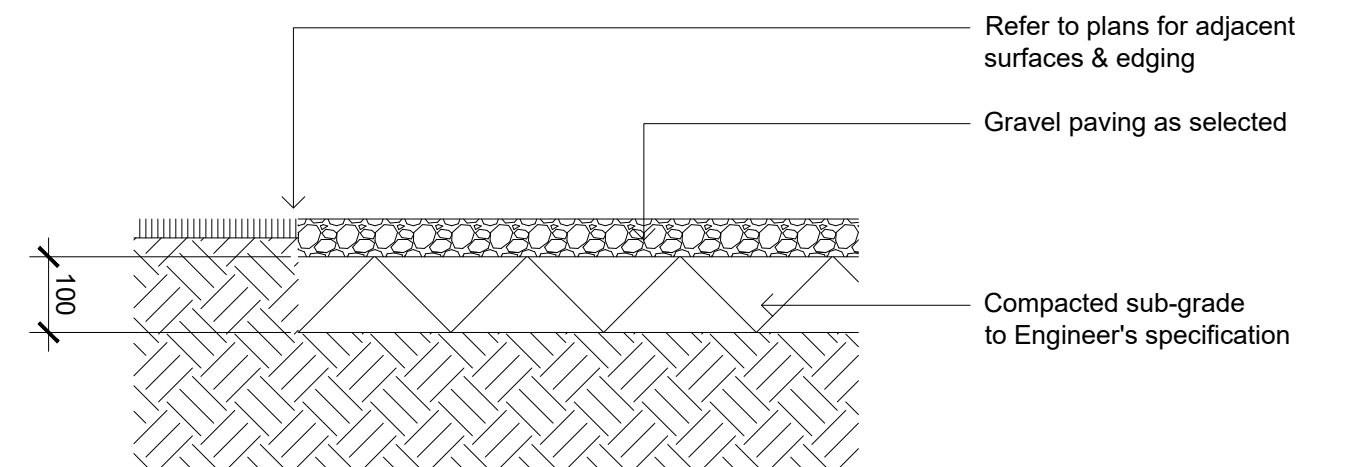

Gravel Paving on Grade

1:10

NOT FOR CONSTRUCTION

© 2019 Site Image (NSW) Pty Ltd ABN 44 801 262 380 as agent for Site Image NSW Partnership. All rights reserved. This drawing is copyright and shall not be reproduced or copied in any form or by any means (graphic, electronic or mechanical including photocopy) without the written permission of Site Image (NSW) Pty Ltd Any license, expressed or implied, to use this document for any purpose what so ever is restricted to the terms of the written agreement between Site Image (NSW) Pty Ltd and the instructing party.

The contractor shall check and verify all work on site (including work by others) before commencing the landscape installation. Any discrepancies are to be reported to the Project Manager or Landscape Architect prior to commencing work. Do not scale this drawing. Any required dimensions not shown shall be referred to the Landscape Architect for confirmation.

LEGEND

G	Architectural Coordination	JW	NM	15.10.2020
F	Revised For Comment	LM	NM	01.10.2020
E	Revised For Comment	JW	NM	21.05.2020
D	Revised For Comment	JW	NM	13.05.2020
C	Architectural Coordination	JW	NM	29.04.2020
B	Architectural & Civil Updates	JD	NM	24.02.2020
A	Preliminary	JD	NM	07.11.2019
Issue	Revision Description	Drawn	Check	Date

Key Plan:

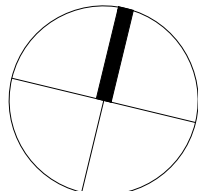

S I T E I M A G E

Landscape Architects

Level 1, 3-5 Baptist Street
Redfern NSW 2016
Australia

Tel: (61 2) 8332 5600
Fax: (61 2) 9698 2877
www.siteimage.com.au

Client:
Mirvac

Project:
Aspect Industrial Estate
Mamre Rd
Kemps Creek

Drawing Name:
Landscape Details

Scale:
Job Number:
SS19-4178

SSDA

Drawing Number:
S1-3_501

Issue:
G