

## STEENSEN VARMING (AUSTRALIA) PTY. LIMITED

CONSULTING ENGINEERS AND PLANNERS A.C.E.A. F.I.D.I.C. *off*

LEVEL 2, 160 SAILORS BAY ROAD, NORTHBRIDGE, AUSTRALIA 2063.

INCORPORATED IN NEW SOUTH WALES ACN 001 189 037 TEL (02) 967 2200 FAX (02) 967 2992

## MEMORANDUM

LIVERPOOL HOSPITAL REDEVELOPMENT

PROJECT OFFICE

TEL: 02 8215769 FAX: 02 602 3034

TO: WORKCOVER *TO* DANGEROUS GOODS

FROM: DAN MACKENZIE

ATTENTION: MR. BUTT, CHIEF INSPECTOR

DATE: 23.10.92

RE: LIVERPOOL HOSPITAL - CLINICAL SERVICES BUILDING MEMO REF No. CS-032

Phil,

We propose to install a 15,000 litre diesel fuel tank for standby generators in the lower level of this building, roughly as shown below

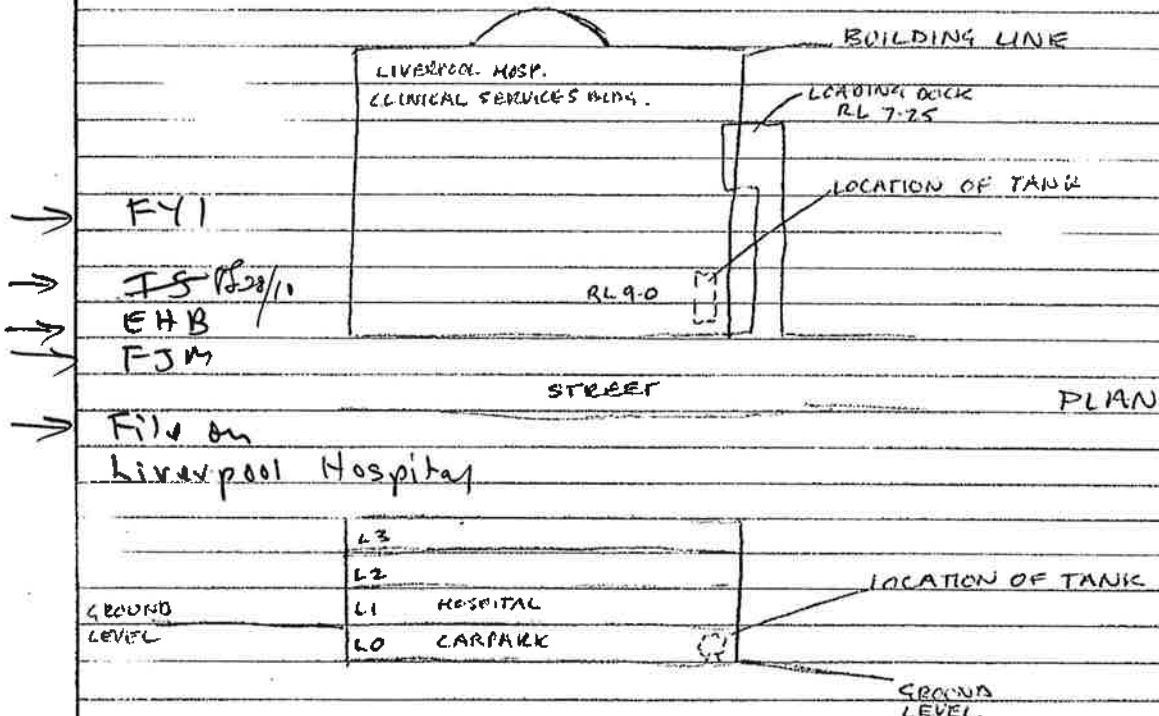

Could you please provide a ruling as to what requirements should be met with regards to the installation ie if a chamber is required etc. The architect believes a bund only is required.

Please contact me if you require any further information.

SIRS - AS PER

AS 1940 - Some pages

attached. *23/10*

CHIEF INSPECTOR OF DANGEROUS GOODS

Application for Registration of Premises or Store License under Division \_\_\_\_\_ or for the transfer, alteration or amendment of any such Registration or License, for the keeping of Inflammable Liquid and/or Dangerous Goods, in accordance with the provisions of the Inflammable Liquid Act, 1915-53, for the ensuing year.

### EXPLANATORY

#### Inflammable Liquid—

Mineral Oil—includes kerosene, mineral turpentine and white spirit (for cleaning), and compositions containing same.  
Mineral Spirit—includes petrol, benzene, benzolene, benzol and naphtha, and compositions containing same.

#### Dangerous Goods—

- Class 1.—Acetone, amyl acetate, butyl acetate, carbon bisulphide; any combination of substances of inflammable character suitable for use as an industrial solvent and having a true flashing point of less than 73 degrees Fahrenheit.  
Class 2.—Nitro-cellulose (also known as "pyroxylin" and "collodion cotton") moistened with an alcohol, butyl alcohol (also known as "butanol"), methylated spirits, vegetable turpentine; and any liquid or solid containing methylated spirits, having a true flashing point of less than 150 degrees Fahrenheit.  
Class 3.—Nitro-cellulose product.  
Class 4.—Compressed or dissolved acetylene contained in a porous substance.

### DIRECTIONS

1. Applications must be forwarded to the Chief Inspector of Inflammable Liquid, Explosives Department, No. 4 Albert Street, off Phillip Street, Circular Quay, Sydney (Box 48, G.P.O.), and must be accompanied by the prescribed fee, as set out hereunder:—

Registration of Premises (Fee £1 10s. 0d. p.a.).—For quantities not exceeding 300 gallons of mineral oil and 100 gallons of mineral spirit, if kept together; or 800 gallons of mineral oil and 100 gallons of mineral spirit, if kept in separate depots; or 500 gallons of mineral spirit, if kept in an underground tank depot; or 800 gallons of mineral oil and 500 gallons of mineral spirit, if mineral spirit is kept in an underground tank depot.

In addition to, or in lieu of the above, similar quantities of Dangerous Goods of Classes 1 and 2 may be kept under the like conditions; reading Dangerous Goods of Class 1 for the words Mineral Spirit and Dangerous Goods of Class 2 for the words Mineral Oil.

Store License, Div. A (Fee, £3 5s. 0d. p.a.).—For quantities in excess of those stated above, but not exceeding 4,000 gallons mineral oil and/or mineral spirit, and/or Dangerous Goods of Classes 1 and 2.

Store License, Div. B (Fees, See Regulation 7).—For quantities exceeding 4,000 gallons of mineral oil and/or mineral spirit, and/or dangerous goods of Classes 1 and 2, and/or dangerous goods of Class 3.

For the keeping of Dangerous Goods of Classes 3 and/or 4. (£7 10s. 0d. p.a.).

2. The certificate of inspection at foot hereof must be signed by an Inspector under the Inflammable Liquid Act, 1915-1953, or Police Officer, or other officer duly authorised in that behalf, and where the premises are situated outside the Metropolitan Area of Sydney, it is requested that such certificate be obtained prior to forwarding application.

1. Name in full of occupier ...

2. Occupation ...

3. Locality of the premises in which the depot or depots are situated ...

4. Nature of premises (Dwelling, Garage, Store, etc.) ...

5. Will mineral spirit be kept in a prescribed underground tank depot?

LIVERPOOL DISTRICT HOSPITAL

PUBLIC HOSPITAL

No. or Name CAR GOULBURN O

Street ELIZABETH STS.

Town LIVERPOOL

PUBLIC HOSPITAL

6. Particulars of construction of depots and maximum quantities of inflammable liquid and/or Dangerous Goods to be kept at any one time.

Depot No.	Construction of Depots.			Inflammable Liquid.		Dangerous Goods.			
	Walls.	Roof.	Floor.	Mineral Spirit. Gallons.	Mineral Oil. Gallons.	Class 1. Gallons.	Class 2. Gallons.	Class 3. lb.	Class 4. cub. ft.
1	Underground tank			500					
2									
3									
4									
5									
6									
7	DATE OF FIRST FILL								
8									
9									
10									

CHG/1301  
Public Revenue Account  
(Date) 1.12.59  
Receipt No. 9201

Date of Application 27/11/59 19

Signature of Applicant

Postal Address

### CERTIFICATE OF INSPECTION.

I, Douglas W. Waghall, being an Inspector under the Inflammable Liquid Act, 1915-53, do hereby certify that the premises or store herein referred to and described is suitable with regard to its situation and construction for the safe keeping of inflammable liquid and/or dangerous goods in quantity and nature specified.

Make Rough Sketches showing—

Ground plans of premises showing position of depot or depots and adjacent buildings, also distances separating depots and buildings.

Sketch of depot or depots showing provision made for ventilation, also inside dimensions (length, width, and depth) of the pit or lower portion, designed to prevent outflow. This sketch is not required for underground tanks.

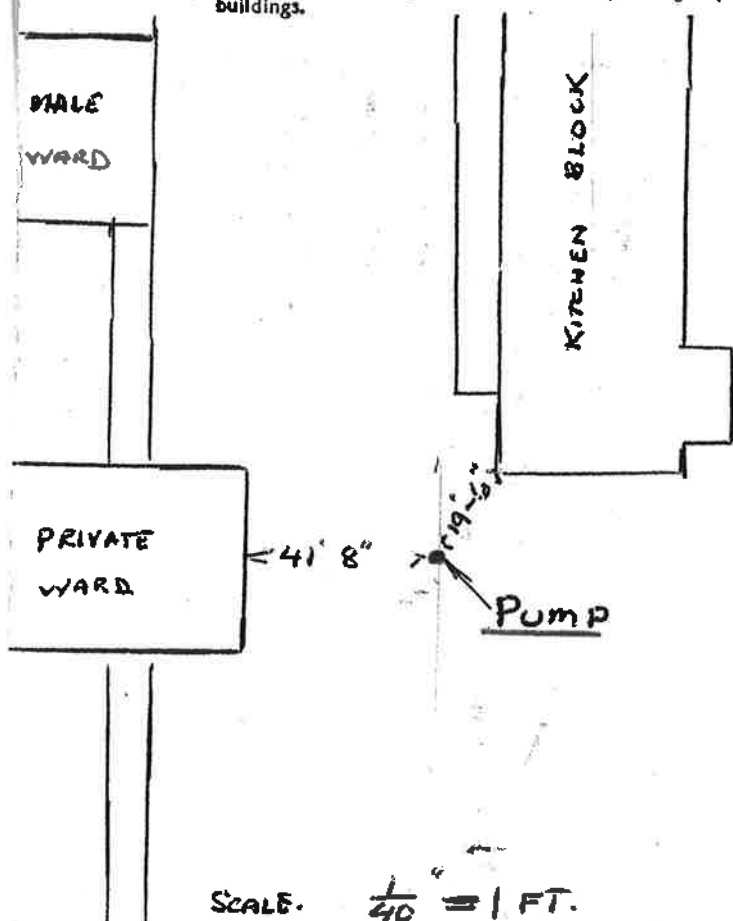

SCALE.  $\frac{1}{40}'' = 1 \text{ FT.}$

TABLES SHOWING DISTANCES WHICH UNDER LICENSE MUST SEPARATE PROTECTED WORKS FROM DEPOTS.

Table I.—Where Mineral Spirit and/or Dangerous Goods of Class 1 (with or without Mineral Oil and/or Dangerous Goods of Class 2) are kept or to be kept :—

In an underground Tank Depot, in quantity exceeding 500 gallons, but not exceeding—	In an aboveground Tank Depot or other Depot, separated from protected works by a screen wall, in quantity exceeding 100 gallons, but not exceeding—	In an aboveground Tank Depot or other Depot not separated from protected works by a screen wall, in quantity exceeding 100 gallons, but not exceeding—	Distance not less than—
Gallons.	Gallons.	Gallons.	Feet.
2,000	1,000	250	10
2,400	1,200	300	11
2,800	1,400	350	12
3,200	1,600	400	13
3,600	1,800	450	14
4,000	2,000	500	15
7,200	3,600	900	16
10,400	5,200	1,300	17
13,600	6,800	1,700	18
16,800	8,400	2,100	19
20,000	10,000	2,500	20
22,000	11,000	2,750	21
24,000	12,000	3,000	22
26,000	13,000	3,250	23
28,000	14,000	3,500	24
30,000	15,000	3,750	25
32,000	16,000	4,000	26
40,000	20,000	5,000	30
60,000	40,000	10,000	40
100,000 and over.	80,000	20,000	50
	160,000	40,000	75
	320,000 and over.	80,000	100
		120,000	115
		240,000	130
		400,000 and over.	150

Table II.—Where Mineral Oil and/or Dangerous Goods of Class 2 only are kept or to be kept :—

In an underground Tank Depot, in quantity exceeding 800 gallons, but not exceeding—	In an aboveground Tank Depot or other Depot separated from protected works by a screen wall, in quantity exceeding 800 gallons, but not exceeding—	In an aboveground Tank Depot or other Depot not separated from protected works by a screen wall, in quantity exceeding 800 gallons, but not exceeding—	Distance not less than—
Gallons.	Gallons.	Gallons.	Feet.
4,000	2,000	1,000	15
8,000	4,000	2,000	15
14,400	7,200	3,600	16
20,800	10,400	5,200	17
40,000	20,000	10,000	20
60,000	40,000	20,000	30
100,000	80,000	40,000	40
160,000	160,000	80,000	55
320,000 and over.	320,000 and over.	160,000	75
		320,000 and over.	100

Provided that the distances shown above may be altered proportionately for intermediate quantities.

# INSPECTION RECORD

Licence No. \_\_\_\_\_

Licencee:

LIVERPOOL DISTRICT HOSPITAL  
GOULBURN ST

Address:

LIVERPOOL

Storage licensed:

1000 MS.

BCC 1200

AMPOL.

Sketch of Premises (Dimensions of depot and distance of same from adjoining "protected works" to be shown).

RAILWAY.

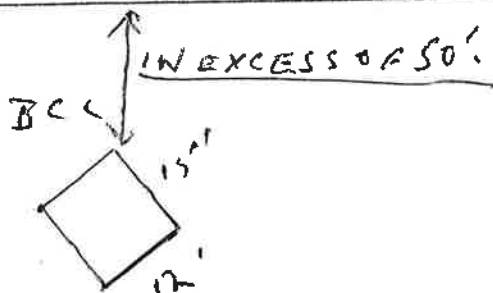
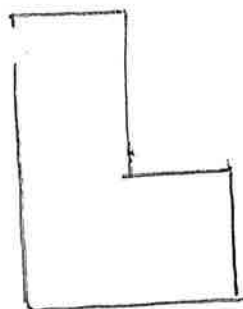

ELIZABETH ST.

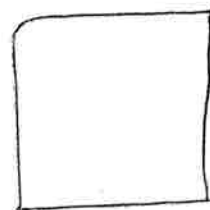
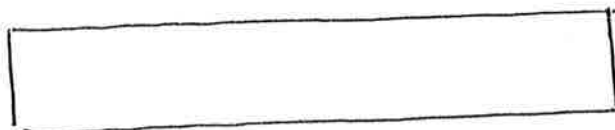

Inspected	Initials	Requisitions made or state of depot
1/5/68	A.P.B.	Inspection left at 1/2 store etc.



OPEN AREA

PROPOSED LARGER  
PAD & VESSEL  
10,000 LTS

EXISTING  
PAD

1.7M EXTENSION

3.5M

10m

.750M  
EXTENSION

4.1M

EXISTING  
K.I.V. 2,500 LBS  
VESSEL

OPEN AREA



ASHFELT  
ROAD

CONCRETE

6M

12M

ASHFELT ROAD

18M

20M

PLANT ROOM



LIQUID AIR AUSTRALIA LIMITED

PROPOSED UPGRADE OF LIQUID OXYGEN FROM  
2,500 LT TO 10,000 LBS AT LIVERPOOL HOSPITAL  
ELIZABETH ST  
LIVERPOOL

SCALE NOT TO SCALE

DRAWN *K.G.*

DATE 11-10-84

APPR.

DATE

DRAWING NO.

REV.

DON EVERETT WING

OPEN SPACE

ACCOMMODATION

PROPOSED DIESEL TANK

EXISTING PETROL

PROPOSED DIESEL PUMP

SERVICE ROAD

RADIOLOGY & STORE

STORE

LINEN

N

THE LIVERPOOL HOSPITAL

FUEL STORAGE

DIESEL & PETROL

SCALE 1:500

AUG. 84.

66P

10,000 NT DIST. U/G

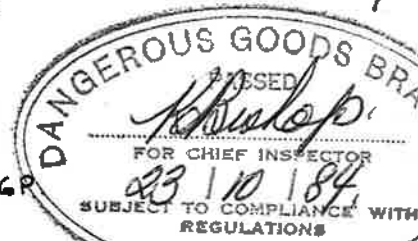

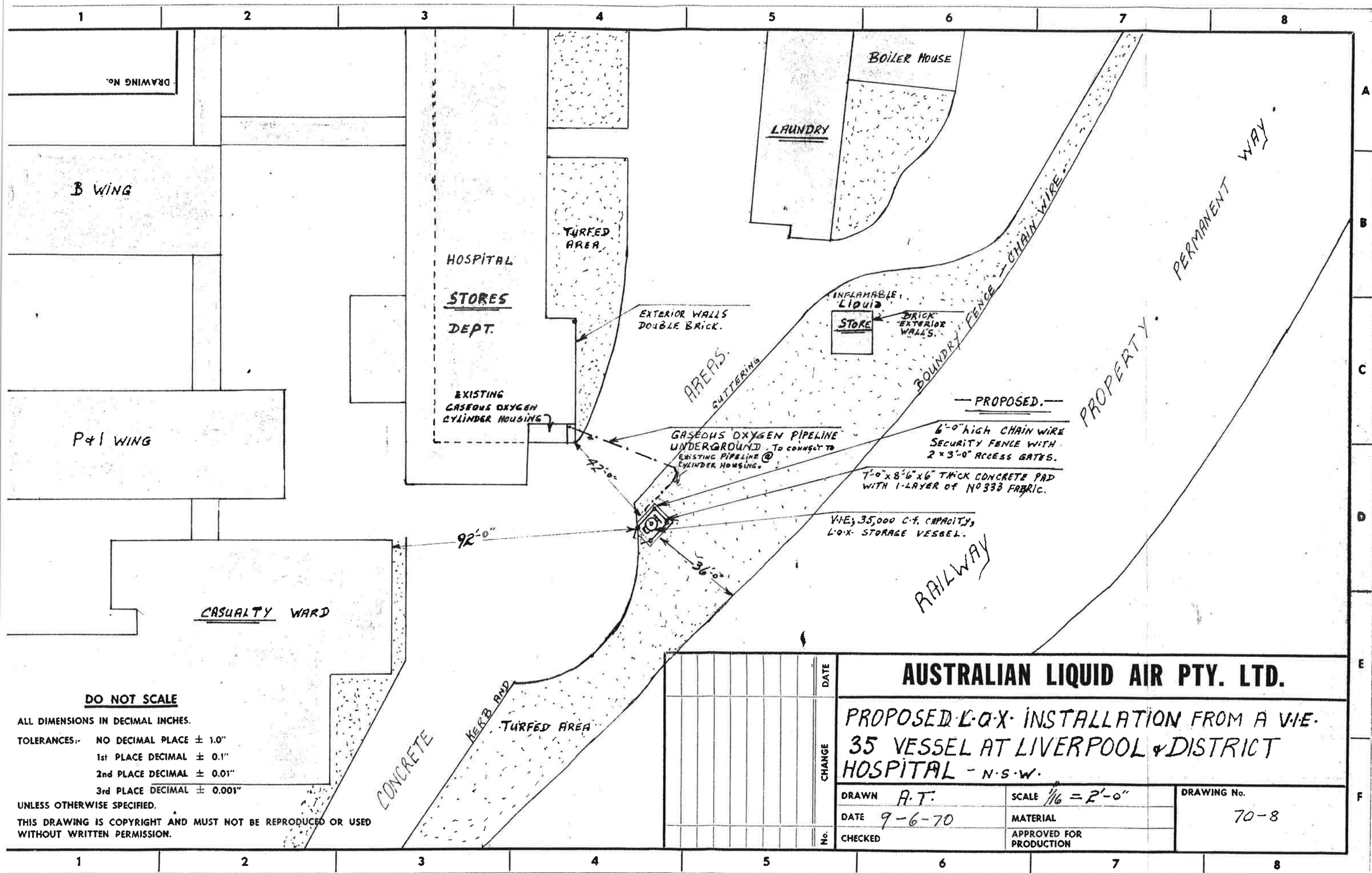

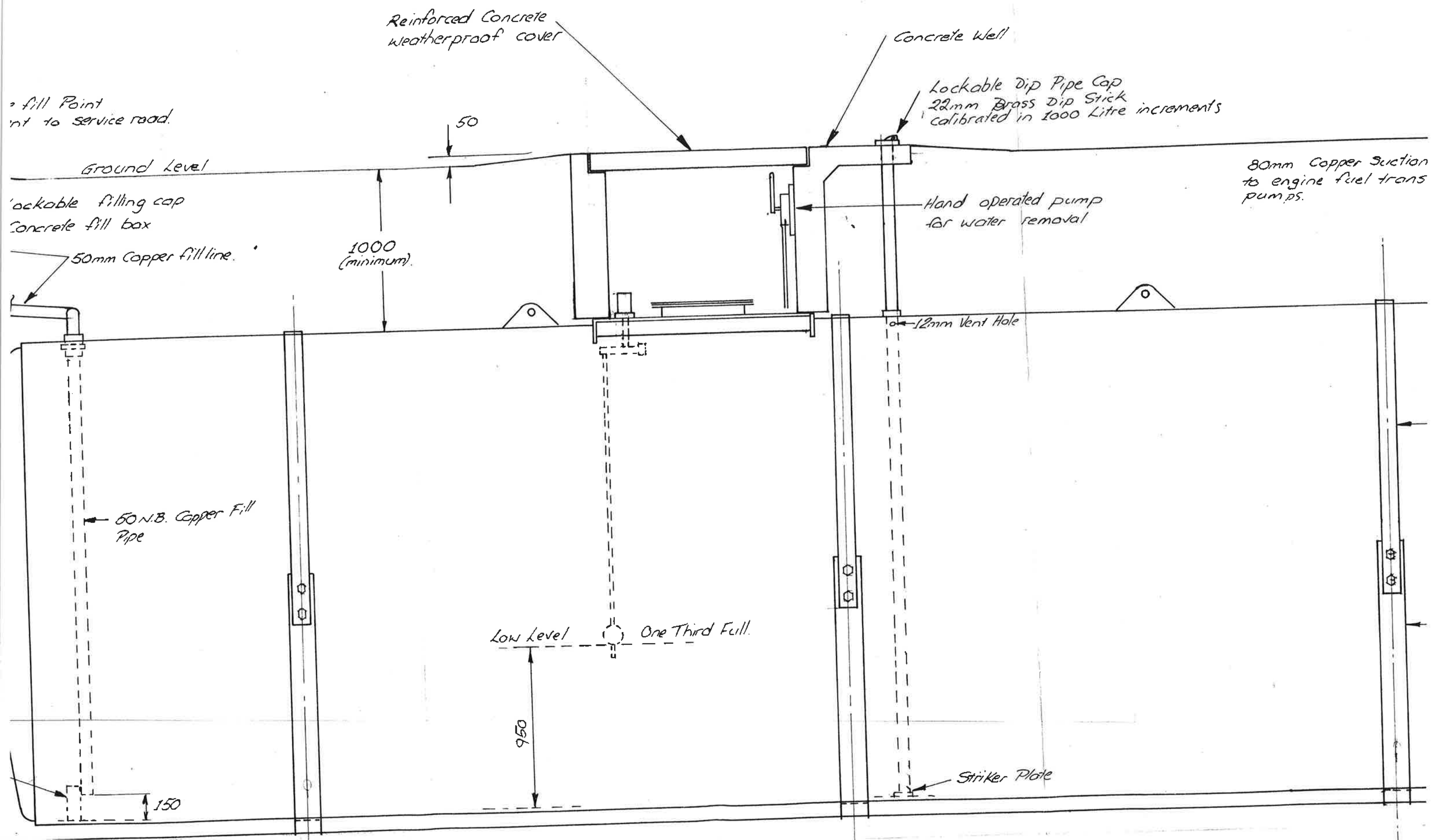

79 joints to allow for tank movement.  
 & elbows.  
 of tank of water = 55 Tonnes.  
 $\text{Kg/m}^3 \therefore \text{Volume of raft} = \frac{55}{2.35}$   
 x 3000mm wide x 820mm deep.  
 sed between cradles, bands

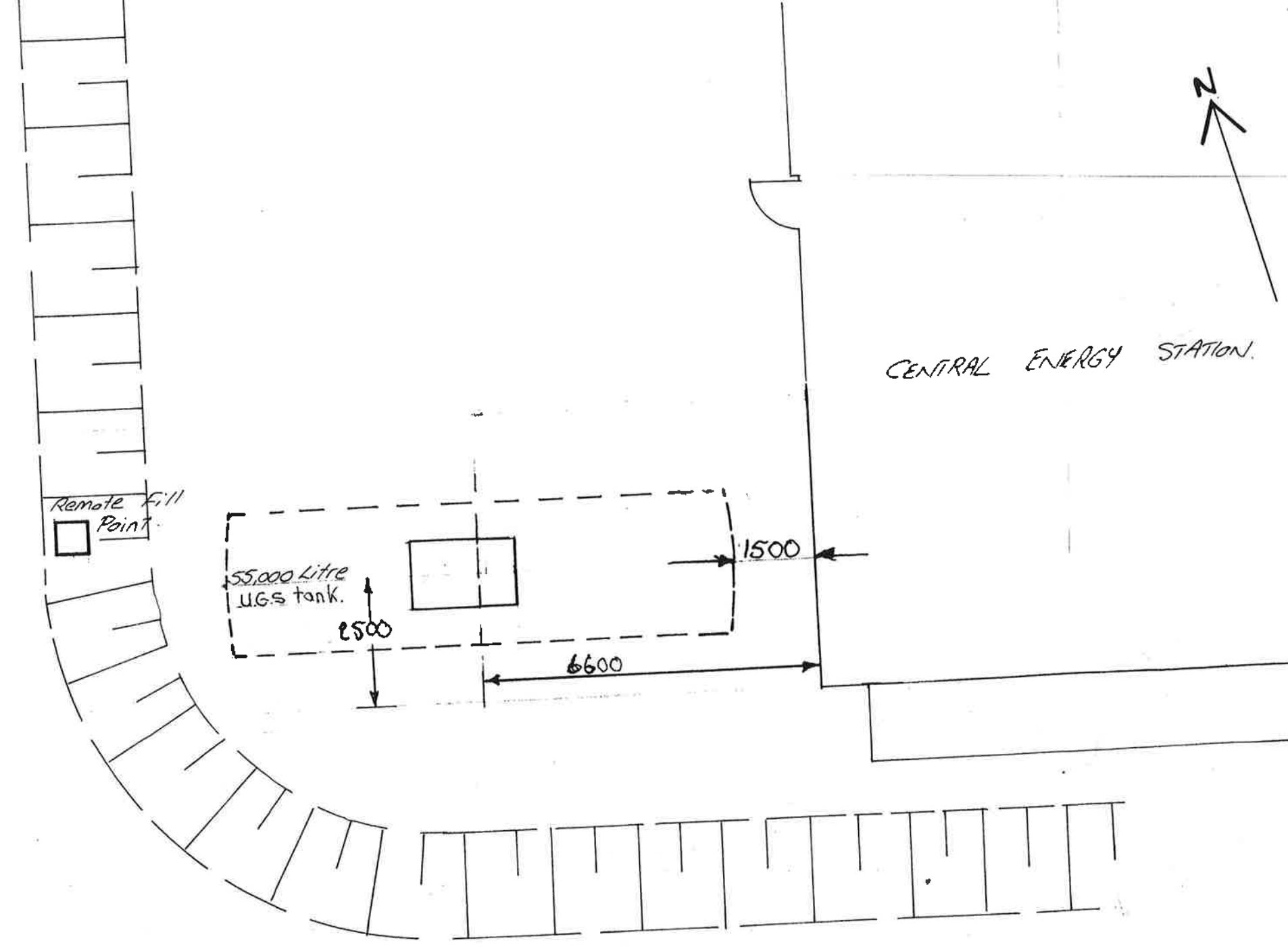

SITE PLAN



T.S.F. ENGINEERING Pty Ltd.  
 63 Bossett St Manawale - Ph 9972072  
 LIVERPOOL DISTRICT HOSPITAL DEVELOPMENT.  
 CENTRAL ENERGY STATION  
 55,000 LITRE U.G. STORAGE TANK  
 INSTALLATION DETAILS.  
 X ACROSS RAILWAY LINE FROM CURRENT  
 HOSPITAL SITE.



return line.  
engine room  
connections.

70mm Copper Vent line run to goose neck  
in engine room wall. Vent line to have  
continuous upwards grade.

Upper Earthing Lug Brazed  
to tank. (Standard Rheem  
lug). Earthing to copper  
coated steel earth stake or  
equal to approval of  
Building Contractor

Ground Level

Line of Excavation

Second Stage  
Backfilling to  
This Level.

First Stage  
Backfilling to  
This Level

Three (3) off Galv. M.S. retaining  
bands 700 x 10mm. Each band  
secured to cradles with  
four (4) M25 bolts.

Three (3) off Galv. M.S. support  
cradles manufactured from  
150mm x 75mm Channels.  
Cradles secured to raft  
anchor by six (6) off 20mm  
Loxins. (Total 18 off).

Concrete Raft Anchor.

820

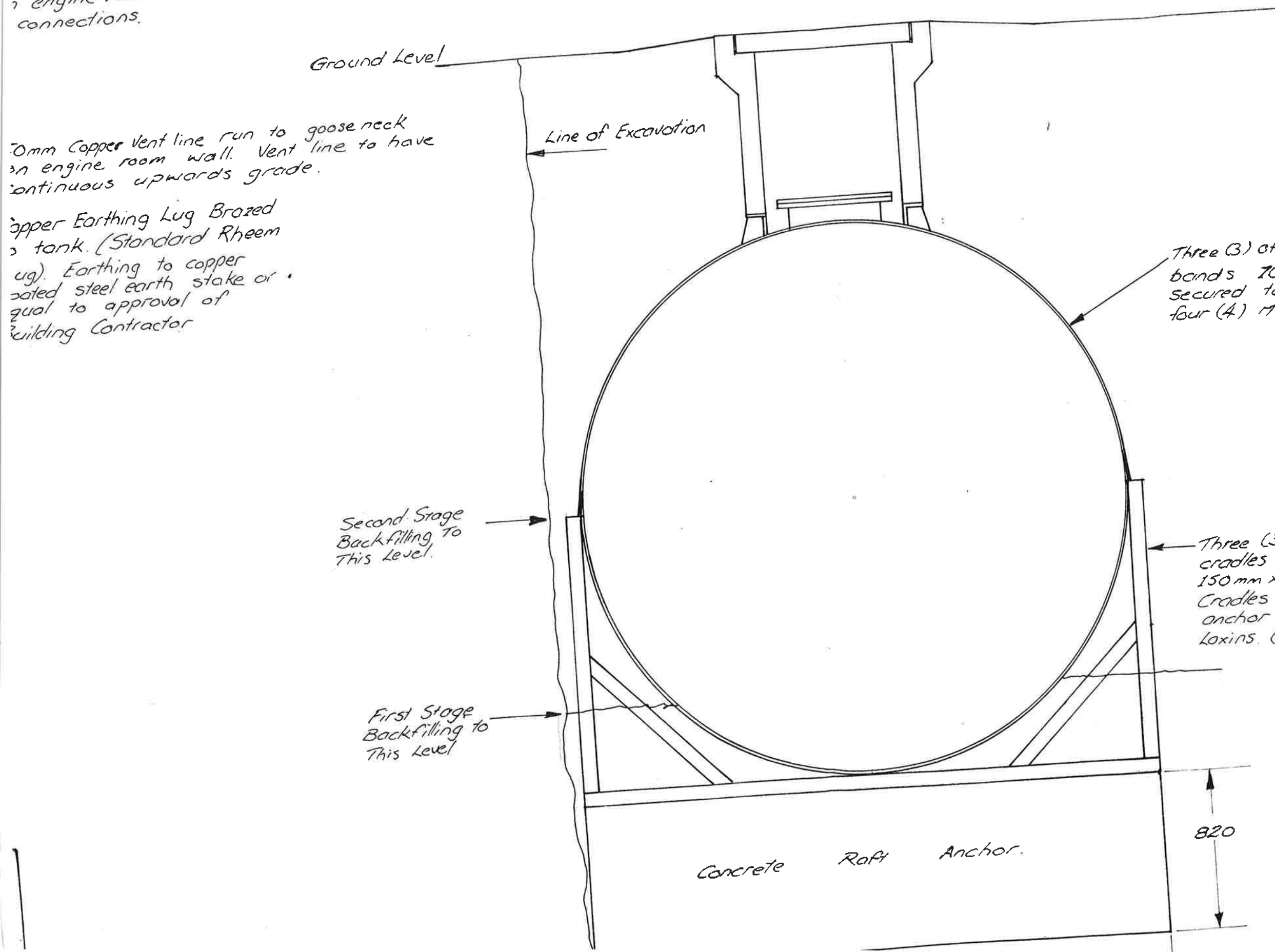



## **Appendix D: NSW EPA Radiation Management Licences**

NSW HEALTH PATHOLOGY  
P O BOX 846  
NEWCASTLE NSW 2300

Contact: JANETTE LEAN

#### LICENCE DETAILS

---

Licence number: **5061637**                      Expiry date: **09 Sep 2020**  
Old licence number: **RML45409**  
Licence type:              Sell, possess, store or give away regulated material (including radiation apparatus, radioactive substances or items containing radioactive substances) for 1 year

---

Subject to the renewal of the licence before the expiry date and to any condition(s) endorsed hereunder, NSW HEALTH PATHOLOGY is hereby licensed under the Radiation Control Act, 1990 by the Environment Protection Authority. The regulated material(s) listed in the attached schedule are included in this licence. The conditions of this licence are attached. Separate to the requirements of this licence, general obligations of licensees are set out in the Radiation Control Act ("the Act"), the Regulations made under the Act and any Codes of Practice referred to therein.

The licence holder can apply to vary the conditions of this licence. An application form for this purpose is available from the EPA. The EPA may also vary the conditions of the licence at any time by written notice without an application being made.

The licensee is responsible for the renewal of this licence before the expiry date and for ensuring that the mailing address is current. Penalties apply for using or selling regulated material without holding a current and appropriate licence.

This licence will remain in force until it expires or is surrendered by the licence holder or until it is suspended or revoked by the EPA. A licence may only be surrendered with the written approval of the EPA.

**Team Leader Chemicals and Radiation Licensing  
Environment Protection Authority NSW**

## Licence Conditions

### 1. General

- 1.1. These conditions apply in addition to the obligations that a person responsible for regulated material has under the Act and Regulation
- 1.2. The licensee commits an offence and may be subject to penalties if the licensee fails to comply with these conditions
- 1.3. The licensee is authorised to own, store, sell or give away regulated material only to the extent specified by the licence type
- 1.4 The licensee must ensure that all regulated material in the form of ionising radiation apparatus, sealed source devices and all sealed sources for which they are the person responsible is detailed in this licence in accordance with the timeframes specified in Condition 7.
- 1.5. The licensee must ensure that all premises where unsealed radioactive substances are used or stored for which the licensee is the person responsible are detailed on this licence within seven days of commencing use or storage in a premises by completing the form published by the Authority and returning the form as instructed.
- 1.6 The regulated material detailed in this licence must only be used for the purpose(s) specified in this licence.
- 1.7. The licensee must notify the Authority within 14 days in writing of any change of the following information:
  - 1.7.1. the registered office address of the licensee
  - 1.7.2. the contact person for licence inquiries delegated by the licensee
  - 1.7.3. the site contact person nominated by the licensee (where applicable)
- 1.8. All notifications required by these conditions must be sent to:

The Manager  
Hazardous Materials, Chemicals and Radiation Section  
NSW Environment Protection Authority  
Department of Premier and Cabinet  
PO Box A290  
SYDNEY SOUTH NSW 1232

Or a PDF file may be sent to [radiation@epa.nsw.gov.au](mailto:radiation@epa.nsw.gov.au)

### 2. Safety information - radioactive substances

- 2.1. The licensee must ensure that a notice is displayed near to the radiation warning sign at the entrance to the premises (room, store, laboratory) where radioactive substances are kept or used that includes the following information:
  - 2.1.1. the licensee's name,
  - 2.1.2. the licence number,
  - 2.1.3. the name and telephone number of the licensee's contact in the event of an emergency affecting the premises, and
  - 2.1.4. the emergency service and telephone number to call in the event of an emergency affecting the premises.
- 2.2. The licensee must ensure that a summary of procedures relating to the safe use of a radioactive source is displayed at the premises where the regulated material is kept.
- 2.3. The licensee must ensure that detailed procedures to be followed in the event of a radiation accident are kept at the premises

### 3. Compliance certification - general

- 3.1. The licensee must ensure that diagnostic imaging apparatus and sealed source devices which are fixed radiation gauges, referred to in Conditions 4 and 5 of the Management Licence Conditions remain under an unbroken state of compliance certification during the transition from the requirements of the Radiation Control Regulation 2003 to the Radiation Control Regulation 2013.

### 4. Compliance certification - diagnostic imaging apparatus

- 4.1. The licensee must ensure that diagnostic imaging apparatus of the type listed in Column 1 of Table 1 for which the licensee is responsible, is certified by a consulting radiation expert accredited by the Authority as complying with the requirements for registration in Schedule 1 of the corresponding Part of Radiation

Guideline 6 - Registration requirements & industry best practice for ionising radiation apparatus used in diagnostic imaging, NSW EPA March 2004 (listed in Column 2 of Table 1), as published by the Authority from time to time:

- 4.1.1. before the apparatus is used, or
- 4.1.2. within two years of the anniversary of initial compliance certification - for mammography apparatus, fluoroscopy apparatus, computed tomography apparatus, and for apparatus that may be used for both fluoroscopy and radiography, or
- 4.1.3. within five years of initial certification - for dental radiography apparatus, radiography apparatus, and bone mineral density apparatus, or
- 4.1.4. if modifications have been made that affect the compliance of the apparatus with the requirements of Schedule 1 of the relevant Guideline, or
- 4.1.5. if the apparatus has been relocated and reassembled, or
- 4.1.6. where the purpose for which the apparatus is used has changed, or
- 4.1.7. in addition, in the case of mammography apparatus, an annual certificate is required in relation to mean glandular dose requirements or following any service or modification that may affect patient dose.

Table 1	
Column 1	Column 2
Apparatus for mammography	The requirements specified in Schedule 1, Part 1 Mammography
Apparatus for fluoroscopy or radiography	The requirements specified in Schedule 1, Part 2 Fluoroscopy and radiography
Apparatus for dental diagnostic purposes	The requirements specified in Schedule 1, Part 3 Dentistry (including maxillofacial)
Apparatus for veterinary purposes	The requirements specified in Schedule 1, Part 4 Veterinary science
Apparatus for computed tomography or bone mineral densitometry	The requirements specified in Schedule 1, Part 5, Computed tomography and bone mineral densitometry

4.2. If a consulting radiation expert certifies that radiation apparatus generally complies with mandatory requirements, but has specified that minor repairs are necessary so that the requirements of Schedule 1 of the relevant Part of Guideline 6 are met, the licensee must:

- 4.2.1. ensure that these repairs are carried out within the timeframe specified by the consulting radiation expert, and
- 4.2.2. adhere to any restrictions on the use or operation of the apparatus specified by the consulting radiation expert until the repairs have been carried out.

## 5. Compliance certification - fixed radiation gauges

5.1. The licensee must ensure that a sealed source device which is a fixed radiation gauge for which the licensee is the person responsible is certified compliant by a consulting radiation expert accredited by the Authority with the mandatory requirements published by the Authority:

- 5.1.1. before it is used, and
- 5.1.2. every two years before the anniversary of its initial compliance certification

## 6. Working life of sealed radioactive sources

6.1. The licensee must ensure that a sealed radioactive source for which the licensee is the person responsible is not used:

- 6.1.1. beyond the manufacturer's recommended working life for the source, or
- 6.1.2. if the manufacturer has not recommended the working life of the source, beyond 15 years after the date of manufacture of the source, or
- 6.1.3. unless the Authority has approved the use of the source for a further period and the licensee complies with any conditions for continued use set down by the Authority.



**7. Notification of receipt and transfer of regulated material**

- 7.1. The licensee must notify the Authority of the receipt or transfer of possession of regulated material (whether by sale or giving away) within seven days of receipt or transfer occurring, by completing the form published by the Authority and returning the form as instructed.
- 7.2. The licensee must notify the Authority within seven days if fixed radiation apparatus for which the licensee is the person responsible is relocated.

Note: This provision (7.1) does not apply to radioactive substances that are not in sealed source form.

**8. Consent to dispose of radiation apparatus**

- 8.1. The licensee may dispose of radiation apparatus, for which the licensee is the person responsible, but only if:
  - 8.1.1. The radiation apparatus has been rendered permanently inoperable, and
  - 8.1.2. The licensee notifies the Authority within seven days using the approved form

**9. Records**

- 9.1. The following records must be kept in relation to regulated material for which the licensee is the person responsible:
  - 9.1.1. Maintenance reports and summaries of quality assurance and / or wipe tests undertaken on any sealed radioactive source or sealed source device
  - 9.1.2. Reports and certificates of compliance issued by a consulting radiation expert in relation to any radiation apparatus or fixed radiation gauge
  - 9.1.3. The source certificate for any sealed radioactive source
  - 9.1.4. Details of the type, location and movement of any radioactive substance(s)
  - 9.1.5. Details of an annual stocktake of all radioactive substances kept or used
  - 9.1.6. Details of all instances where the categories of regulated material used or kept change, as determined by Part 2, Cl.14 of the Regulation, and advise the EPA of any such change in writing within 14 days
- 9.2. The licensee must:
  - 9.2.1. Maintain records in legible form or in a form that can be readily reproduced in a legible form,
  - 9.2.2. Keep all records relating to regulated material for a period of two years after disposal, and
  - 9.2.3. Provide all records relating to regulated material to the person to whom the regulated material is transferred, in the case of sale or giving away

**10. Storage**

- 10.1. Ensure that regulated material for which the licensee is responsible is safely and securely stored if it is not required for immediate use and that:
  - 10.1.1. The store is constructed of durable materials
  - 10.1.2. The store is lockable
  - 10.1.3. Radiation levels in any accessible area outside the store do not exceed the dose limits for exposure in Schedule 5 of the Regulation
  - 10.1.4. Any radioactive substances are not stored with explosives, combustible or corrosive materials

**11. Whole body scanning**

- 11.1. The licensee must ensure that computed tomography apparatus for which the licensee is responsible is not used for screening for early signs of illness in patients who have no symptoms or disease risk factors, except at the written request of an independent medical practitioner and where the licensee has obtained the informed consent of the patient in writing.

Note: Informed consent requires that the patient has been informed of the scale of radiation dose from the procedure and the risks involved, including that persons under the age of 50 years are more at risk of developing cancers as a result of the procedure.

**12. Cyclotron**

- 12.1. The licensee must, prior to commencement of commissioning of the facility, submit a radiation protection plan to the Authority for its approval.
- 12.2. The licensee must, prior to commencement of normal operations, submit a copy of the acceptance test

documentation, providing certification that design features for hazard control are in place and operational, to the Authority for its approval.

- 12.3. The licensee must, if there is any variation to working procedures, engineering protective measures, or radiation monitoring plans, submit an amended radiation protection plan to the Authority for its approval.
- 12.4. The licensee must submit to the Authority a report on the operation of the cyclotron and ancillary facilities, as they relate to safety and radiation control issues for the first three months of its routine operation, and subsequently annually.

### 13. Guidelines

- 13.1. The licensee must comply with the obligations of 'responsible persons' in the following documents, to the extent that they apply to the licensee's radiation practice, as published by the New South Wales Environment Protection Authority (NSW EPA) <http://www.epa.nsw.gov.au/radiation/radiationpubs.htm> from time to time
  - 13.1.1. Radiation Guideline 6 - Registration requirements & industry best practice for ionising radiation apparatus used in diagnostic imaging, NSW EPA March 2004:
    - Part 1: Mammography
    - Part 2: Fluoroscopy & radiography
    - Part 3: Dentistry (including maxillofacial)
    - Part 4: Veterinary science
    - Part 5: Computed tomography & bone mineral densitometry
    - Part 6: Test protocols for parts 2-5

Note: Appendix A of Guideline 6, Parts 2-5 Policy on x-ray protective clothing (2004) has been superseded by Policy on x-ray protective clothing, NSW EPA, Nov 2009.

### 14. Codes

- 14.1. The licensee must comply with the obligations of 'responsible persons' in the following documents, to the extent that they apply to the licensee's radiation practice, as published by the Australian Radiation Protection and Nuclear Safety Agency (ARPANSA) <http://www.arpansa.gov.au/Publications/codes> from time to time:
  - 14.1.1. RPS 2. Code of Practice for the Safe Transport of Radioactive Material, ARPANSA Jan 2008
  - 14.1.2. RPS 5. Code of Practice and Safety Guide for Portable Density/Moisture Gauges containing Radioactive Sources, ARPANSA, May 2004
  - 14.1.3. RPS 8. Code of Practice for the Exposure of Humans to Ionizing Radiation for Research Purposes, ARPANSA, May 2005
  - 14.1.4. RPS 10. Code of Practice and Safety Guide for Radiation Protection in Dentistry, ARPANSA, Dec 2005
  - 14.1.5. RPS 13. Code of Practice and Safety Guide for Safe Use of Fixed Radiation Gauges, ARPANSA, Jan 2007
  - 14.1.6. RPS 14. Code of Practice for Radiation Protection in the Medical Applications of Ionizing Radiation, ARPANSA, May 2008
  - 14.1.7. RPS 17. Code of Practice and Safety Guide for Radiation Protection in Veterinary Medicine, ARPANSA, July 2009
  - 14.1.8. RPS 19. Code of Practice for Radiation Protection in the Application of Ionizing Radiation by Chiropractors, ARPANSA, Nov 2009
  - 14.1.9. RHS 9. Code of practice for protection against ionizing radiation emitted from X-ray analysis equipment, ARPANSA, 1984
  - 14.1.10. RHS 28. Code of practice for the safe use of sealed radioactive sources in bore-hole logging, ARPANSA, 1989
  - 14.1.11. RHS 31. Code of practice for the safe use of industrial radiography equipment, ARPANSA, 1989

In the event of an inconsistency between the Codes and the current relevant NSW legislation, the requirements of the legislation prevail to the extent of the inconsistency.

### 15. Definitions

**Person responsible** has the same meaning as in section 6 of the Act

**Act** means the Radiation Control Act 1990 (<http://www.epa.nsw.gov.au/legislation/ActSummaries.htm#radiation>)

**Diagnostic imaging apparatus** means:

- A. Any ionising radiation apparatus used or intended to be used for any medical diagnostic, veterinary diagnostic or dental purpose, or
- B. Any ionising radiation apparatus used or intended to be used for radiotherapy or radiotherapy planning purposes.

**Fixed radiation gauge** means a sealed source device which is in a fixed position.

**Regulation** means the Radiation Control Regulation 2013  
(<http://www.epa.nsw.gov.au/legislation/RegulationSummaries.htm#RCreg>)

**Regulated material** has the same meaning as in section 4 of the Act

**Occupationally exposed** has the same meaning as in clause 3 of the Regulation

**Radiation accident** has the same meaning as in clause 37 of the Regulation

**Sealed source device** has the same meaning as in section 4 of the Act.

## Radiation Regulated Material (RRM) Schedule (Licence no 5061637)

Location: NSW Health Pathology - CAMPERDOWN - RPA Hospital, Blood Bank, Level 5 77 Missenden Road, CAMPERDOWN, NSW 2050

Radiation regulated material ID No 9168 (former registration number RR9816) (status Active)

<u>Work Area</u>	<u>Fee Group</u>	<u>Type</u>	<u>Equipment</u>	<u>Purpose</u>	
	Group C	Sealed source device	Self-Shielded Irradiator		
Components:	<u>Type</u>	<u>Manufacturer</u>	<u>Model No</u>	<u>Serial No</u>	<u>Source Name</u>
25786	Container	Nordion	GC 3000 Elan	71	
27205	Sealed source	Nordion		A555	caesium-137

Location: NSW Health Pathology - CAMPERDOWN - RPA HOSPITAL, BUILDING 94, VIA JOHN HOPKINS DRIVE, CAMPERDOWN, NSW 2050

Radiation regulated material ID No 18124 (status Active)

<u>Work Area</u>	<u>Fee Group</u>	<u>Type</u>	<u>Equipment</u>	<u>Purpose</u>	
X-Ray Room	Group B	Radiation apparatus	General Radiography	Non-medical analytical or educational	
<hr/>					
Components:	<u>Type</u>	<u>Manufacturer</u>	<u>Model No</u>	<u>Serial No</u>	<u>Source Name</u>
51630	Control console / generator	Faxitron Bioptics	Micro-50	2320A00139	
51631	X-ray tube housing	Faxitron Bioptics	Micro-50	2320A00139	
51632	X-ray tube insert	Faxitron Bioptics	Micro-50	2320A00139	

Location: NSW Health Pathology - LIDCOMBE - 480 Weeroona Road, LIDCOMBE, NSW 2141

Radiation regulated material ID No 16166 (status Active)

<u>Work Area</u>	<u>Fee Group</u>	<u>Type</u>	<u>Equipment</u>	<u>Purpose</u>	
Chemical Criminalistics Unit, Block B NSW FASS	Group B	Radiation apparatus	X-RF/X-RD	Analysis	
Components:	<u>Type</u>	<u>Manufacturer</u>	<u>Model No</u>	<u>Serial No</u>	<u>Source Name</u>
45941	Control console / generator	Oxford Instruments	Series 5000, 93057	133261	

Location: NSW Health Pathology - LIDCOMBE - FORENSIC MEDICINE AND CORONERS COURT  
COMPLEX, 1A MAIN AVENUE, LIDCOMBE, NSW 2141

**Radiation regulated material ID No 12492 (status Active)**

<u>Work Area</u>	<u>Fee Group</u>	<u>Type</u>	<u>Equipment</u>	<u>Purpose</u>
CT Room 1	Group B	Radiation apparatus	Computed Tomography	Non-medical analytical or educational
Components:	<u>Type</u>	<u>Manufacturer</u>	<u>Model No</u>	<u>Serial No</u> <u>Source Name</u>
35484	Control console / generator	Toshiba	CXXG-012A	8AA1512182
35485	X-ray tube housing	Toshiba	CXB-750D/3A	H15255
35486	X-ray tube insert	Toshiba	CXB-750D/3A	15255-Y4

**Radiation regulated material ID No 15889 (status Active)**

<u>Work Area</u>	<u>Fee Group</u>	<u>Type</u>	<u>Equipment</u>	<u>Purpose</u>
Surgery 1	Group B	Radiation apparatus	Dental Radiography	Non-medical analytical or educational
Components:	<u>Type</u>	<u>Manufacturer</u>	<u>Model No</u>	<u>Serial No</u> <u>Source Name</u>
45145	Control console / generator	J M Dental	Veraview V-080	DD5009
45146	X-ray tube housing	J M Dental	Veraview V-080	DD5009
45147	X-ray tube insert	J M Dental	Veraview V-080	DD5009

**Radiation regulated material ID No 15890 (status Active)**

<u>Work Area</u>	<u>Fee Group</u>	<u>Type</u>	<u>Equipment</u>	<u>Purpose</u>
Surgery 2	Group B	Radiation apparatus	Dental Radiography	Non-medical analytical or educational
Components:	<u>Type</u>	<u>Manufacturer</u>	<u>Model No</u>	<u>Serial No</u> <u>Source Name</u>
45148	Control console / generator	Philips Healthcare	98015050104	8350850
45149	X-ray tube housing	Philips Healthcare	98015050104	8350850
45150	X-ray tube insert	Philips Healthcare	98015050104	8350850

**Radiation regulated material ID No 15891 (status Active)**

<u>Work Area</u>	<u>Fee Group</u>	<u>Type</u>	<u>Equipment</u>	<u>Purpose</u>
Surgery 3	Group B	Radiation apparatus	Dental Radiography	Non-medical analytical or educational
Components:	<u>Type</u>	<u>Manufacturer</u>	<u>Model No</u>	<u>Serial No</u> <u>Source Name</u>
45151	Control console / generator	Aribex	Nomad Pro	BX-091028-03



45152	X-ray tube housing	Aribex	Nomad Pro	BX-091028-03
45153	X-ray tube insert	ARI Medical Technology	1724	A80017

## Radiation regulated material ID No 17051 (status Active)

<u>Work Area</u>	<u>Fee Group</u>	<u>Type</u>	<u>Equipment</u>	<u>Purpose</u>	
X- Ray Room	Group B	Radiation apparatus	General Radiography	Non-medical analytical or educational	
<hr/>					
Components:	<u>Type</u>	<u>Manufacturer</u>	<u>Model No</u>	<u>Serial No</u>	<u>Source Name</u>
48429	Control console / generator	Shimadzu	Mobile Art Evolution	MIBDE2147005	
48430	X-ray tube housing	Shimadzu	Mobile Art Evolution	RM74B5946021	
48431	X-ray tube insert	Shimadzu	Mobile Art Evolution	43405	

## Radiation regulated material ID No 17283 (status Active)

<u>Work Area</u>	<u>Fee Group</u>	<u>Type</u>	<u>Equipment</u>	<u>Purpose</u>	
Mortuary	Group B	Radiation apparatus	Computed Tomography	Non-medical analytical or educational	
<hr/>					
Components:	<u>Type</u>	<u>Manufacturer</u>	<u>Model No</u>	<u>Serial No</u>	<u>Source Name</u>
49045	Control console / generator	Canon Medical Systems	TSX-303B/IC	1CB18X2107	
49046	X-ray tube housing	Canon Medical Systems	CXB-750G	33363T8	
49047	X-ray tube insert	Canon Medical Systems	CXB-750G	33363T8	

Location: NSW Health Pathology - LIVERPOOL - Pathology Service Building, Cnr Campbell and Forbes Streets, LIVERPOOL, NSW 2170

## Radiation regulated material ID No 9317 (former registration number RR9715) (status Active)

<u>Work Area</u>	<u>Fee Group</u>	<u>Type</u>	<u>Equipment</u>	<u>Purpose</u>	
	Group C	Sealed source device	Self-Shielded Irradiator		
Components:	<u>Type</u>	<u>Manufacturer</u>	<u>Model No</u>	<u>Serial No</u>	<u>Source Name</u>
25785	Container	Nordion	GC1000	055	
27651	Sealed source	AECL Atomic Energy of Canada Limited		84 Cs-112	caesium-137

Location: NSW Health Pathology - NEW LAMBTON HEIGHTS - Dept of Forensic Medicine, Rosella  
Close, NEW LAMBTON HEIGHTS, NSW 2305

**Radiation regulated material ID No 15654 (status Active)**

<u>Work Area</u>	<u>Fee Group</u>	<u>Type</u>	<u>Equipment</u>	<u>Purpose</u>
Dental Suite	Group B	Radiation apparatus	Dental Radiography	Non-medical analytical or educational
Components:	<u>Type</u>	<u>Manufacturer</u>	<u>Model No</u>	<u>Serial No</u> <u>Source Name</u>
44671	Control console / generator	Gendex (KaVo)	110-0250G1	42-1865553 DP
44672	X-ray tube housing	Gendex (KaVo)	110-0250G1	42-1865553 DP
44673	X-ray tube insert	Gendex (KaVo)	112-0951G1	12-1865482 DP

**Radiation regulated material ID No 16974 (status Active)**

<u>Work Area</u>	<u>Fee Group</u>	<u>Type</u>	<u>Equipment</u>	<u>Purpose</u>
X-Ray Room	Group B	Radiation apparatus	General Radiography	Non-medical analytical or educational
Components:	<u>Type</u>	<u>Manufacturer</u>	<u>Model No</u>	<u>Serial No</u> <u>Source Name</u>
48206	Control console / generator	Villa Sistemi Medicali	Visitor EMC	01090084
48207	X-ray tube housing	Villa Sistemi Medicali	80763035	532215
48208	X-ray tube insert	Villa Sistemi Medicali	OX/110-15	01098231

**Department: Pathology**

**Radiation regulated material ID No 12282 (status Active)**

<u>Work Area</u>	<u>Fee Group</u>	<u>Type</u>	<u>Equipment</u>	<u>Purpose</u>
CT Room	Group B	Radiation apparatus	Computed Tomography	Non-medical analytical or educational
Components:	<u>Type</u>	<u>Manufacturer</u>	<u>Model No</u>	<u>Serial No</u> <u>Source Name</u>
34917	Control console / generator	Toshiba	AQ16LBCTSYS	3KA1452004
34918	X-ray tube housing	Toshiba	CBX-750D/3A	86820-P4
34919	X-ray tube insert	Toshiba	CBX-750D/3A	86820-P4

Location: NSW Health Pathology - NEW LAMBTON HEIGHTS - John Hunter Hospital, Lookout Road,  
NEW LAMBTON HEIGHTS, NSW 2305

## Radiation regulated material ID No 8678 (former registration number RR11383) (status Active)

<u>Work Area</u>	<u>Fee Group</u>	<u>Type</u>	<u>Equipment</u>	<u>Purpose</u>		
Cross matching lab, level 3, HAPS building	Group C	Sealed source device	Self-Shielded Irradiator			
Components:	<u>Type</u>	<u>Manufacturer</u>	<u>Model No</u>	<u>Serial No</u>	<u>Source Name</u>	
25755	Container	Nordion	Gammacell 1000	397		
27156	Sealed source	Nordion		A1491	caesium-137	

**Location: NSW Health Pathology - RANDWICK - POWH - Seals Bloodbank, Campus Centre, Level 4,  
Barker Street, RANDWICK, NSW 2031**

## Radiation regulated material ID No 9183 (former registration number RR9879) (status Active)

<u>Work Area</u>	<u>Fee Group</u>	<u>Type</u>	<u>Equipment</u>	<u>Purpose</u>		
	Group C	Sealed source device	Self-Shielded Irradiator			
Components:	<u>Type</u>	<u>Manufacturer</u>	<u>Model No</u>	<u>Serial No</u>	<u>Source Name</u>	
25698	Container	JL Shepherd	143-45A	2039		
27176	Sealed source	JL Shepherd		87-CS-S-26	caesium-137	
27177	Sealed source	JL Shepherd		87-CS-S-27	caesium-137	

**Location: NSW Health Pathology - ST LEONARDS - Pathology North Transfusion Service RNDH,  
Reserve Road, ST LEONARDS, NSW 2065**

## Radiation regulated material ID No 8973 (former registration number RR13393) (status Active)

<u>Work Area</u>	<u>Fee Group</u>	<u>Type</u>	<u>Equipment</u>	<u>Purpose</u>		
ASB Level 5, Room 01052014	Group C	Sealed source device	Self-Shielded Irradiator			
Components:	<u>Type</u>	<u>Manufacturer</u>	<u>Model No</u>	<u>Serial No</u>	<u>Source Name</u>	
25758	Container	Nordion	Gammacell 1000E	453		
27144	Sealed source	Nordion		A2034	caesium-137	

**Location: NSW Health Pathology - WESTMEAD - Westmead Hospital, Blood Bank, Level 2  
Hawkesbury Road, WESTMEAD, NSW 2145**

## Radiation regulated material ID No 9778 (former registration number RR23906) (status Active)

## Radiation Management Licence



<u>Work Area</u>	<u>Fee Group</u>	<u>Type</u>	<u>Equipment</u>	<u>Purpose</u>		
Pathology west block - room 2143-07	Group C	Sealed source device	Self-Shielded Irradiator			
Components:	<u>Type</u>	<u>Manufacturer</u>	<u>Model No</u>	<u>Serial No</u>	<u>Source Name</u>	
25262	Container	Best Theratronics	Gammacell GC-1000	0486		
27206	Sealed source	Nordion		A2354	caesium-137	
27207	Sealed source	Nordion		A2305	caesium-137	





## Licence Conditions

### 1. General

- 1.1. These conditions apply in addition to the obligations that a person responsible for regulated material has under the Act and Regulation
- 1.2. The licensee commits an offence and may be subject to penalties if the licensee fails to comply with these conditions
- 1.3. The licensee is authorised to own, store, sell or give away regulated material only to the extent specified by the licence type
- 1.4. The licensee must ensure that all regulated material in the form of ionising radiation apparatus, sealed source devices and all sealed sources for which they are the person responsible is detailed in this licence in accordance with the timeframes specified in Condition 7.
- 1.5. The licensee must ensure that all premises where unsealed radioactive substances are used or stored for which the licensee is the person responsible are detailed on this licence within seven days of commencing use or storage in a premises by completing the form published by the Authority and returning the form as instructed.
- 1.6. The regulated material detailed in this licence must only be used for the purpose(s) specified in this licence.
- 1.7. The licensee must notify the Authority within 14 days in writing of any change of the following information:
  - 1.7.1. the registered office address of the licensee
  - 1.7.2. the contact person for licence inquiries delegated by the licensee
  - 1.7.3. the site contact person nominated by the licensee (where applicable)
- 1.8. All notifications required by these conditions must be sent to:

The Manager  
Hazardous Materials, Chemicals and Radiation Section  
NSW Environment Protection Authority  
Department of Premier and Cabinet  
PO Box A290  
SYDNEY SOUTH NSW 1232

Or a PDF file may be sent to [radiation@epa.nsw.gov.au](mailto:radiation@epa.nsw.gov.au)

### 2. Safety information - radioactive substances

- 2.1. The licensee must ensure that a notice is displayed near to the radiation warning sign at the entrance to the premises (room, store, laboratory) where radioactive substances are kept or used that includes the following information:
  - 2.1.1. the licensee's name,
  - 2.1.2. the licence number,
  - 2.1.3. the name and telephone number of the licensee's contact in the event of an emergency affecting the premises, and
  - 2.1.4. the emergency service and telephone number to call in the event of an emergency affecting the premises.
- 2.2. The licensee must ensure that a summary of procedures relating to the safe use of a radioactive source is displayed at the premises where the regulated material is kept.
- 2.3. The licensee must ensure that detailed procedures to be followed in the event of a radiation accident are kept at the premises

### 3. Compliance certification - general

- 3.1. The licensee must ensure that diagnostic imaging apparatus and sealed source devices which are fixed radiation gauges, referred to in Conditions 4 and 5 of the Management Licence Conditions remain under an unbroken state of compliance certification during the transition from the requirements of the Radiation Control Regulation 2003 to the Radiation Control Regulation 2013.

### 4. Compliance certification - diagnostic imaging apparatus

- 4.1. The licensee must ensure that diagnostic imaging apparatus of the type listed in Column 1 of Table 1 for which the licensee is responsible, is certified by a consulting radiation expert accredited by the Authority as complying with the requirements for registration in Schedule 1 of the corresponding Part of Radiation

Guideline 6 - Registration requirements & industry best practice for ionising radiation apparatus used in diagnostic imaging, NSW EPA March 2004 (listed in Column 2 of Table 1), as published by the Authority from time to time:

- 4.1.1. before the apparatus is used, or
- 4.1.2. within two years of the anniversary of initial compliance certification - for mammography apparatus, fluoroscopy apparatus, computed tomography apparatus, and for apparatus that may be used for both fluoroscopy and radiography, or
- 4.1.3. within five years of initial certification - for dental radiography apparatus, radiography apparatus, and bone mineral density apparatus, or
- 4.1.4. if modifications have been made that affect the compliance of the apparatus with the requirements of Schedule 1 of the relevant Guideline, or
- 4.1.5. if the apparatus has been relocated and reassembled, or
- 4.1.6. where the purpose for which the apparatus is used has changed, or
- 4.1.7. in addition, in the case of mammography apparatus, an annual certificate is required in relation to mean glandular dose requirements or following any service or modification that may affect patient dose.

Table 1	
Column 1	Column 2
Apparatus for mammography	The requirements specified in Schedule 1, Part 1 Mammography
Apparatus for fluoroscopy or radiography	The requirements specified in Schedule 1, Part 2 Fluoroscopy and radiography
Apparatus for dental diagnostic purposes	The requirements specified in Schedule 1, Part 3 Dentistry (including maxillofacial)
Apparatus for veterinary purposes	The requirements specified in Schedule 1, Part 4 Veterinary science
Apparatus for computed tomography or bone mineral densitometry	The requirements specified in Schedule 1, Part 5, Computed tomography and bone mineral densitometry

4.2. If a consulting radiation expert certifies that radiation apparatus generally complies with mandatory requirements, but has specified that minor repairs are necessary so that the requirements of Schedule 1 of the relevant Part of Guideline 6 are met, the licensee must:

- 4.2.1. ensure that these repairs are carried out within the timeframe specified by the consulting radiation expert, and
- 4.2.2. adhere to any restrictions on the use or operation of the apparatus specified by the consulting radiation expert until the repairs have been carried out.

## 5. Compliance certification - fixed radiation gauges

5.1. The licensee must ensure that a sealed source device which is a fixed radiation gauge for which the licensee is the person responsible is certified compliant by a consulting radiation expert accredited by the Authority with the mandatory requirements published by the Authority:

- 5.1.1. before it is used, and
- 5.1.2. every two years before the anniversary of its initial compliance certification

## 6. Working life of sealed radioactive sources

6.1. The licensee must ensure that a sealed radioactive source for which the licensee is the person responsible is not used:

- 6.1.1. beyond the manufacturer's recommended working life for the source, or
- 6.1.2. if the manufacturer has not recommended the working life of the source, beyond 15 years after the date of manufacture of the source, or
- 6.1.3. unless the Authority has approved the use of the source for a further period and the licensee complies with any conditions for continued use set down by the Authority.

**7. Notification of receipt and transfer of regulated material**

- 7.1. The licensee must notify the Authority of the receipt or transfer of possession of regulated material (whether by sale or giving away) within seven days of receipt or transfer occurring, by completing the form published by the Authority and returning the form as instructed.
- 7.2. The licensee must notify the Authority within seven days if fixed radiation apparatus for which the licensee is the person responsible is relocated.

Note: This provision (7.1) does not apply to radioactive substances that are not in sealed source form.

**8. Consent to dispose of radiation apparatus**

- 8.1. The licensee may dispose of radiation apparatus, for which the licensee is the person responsible, but only if:
  - 8.1.1. The radiation apparatus has been rendered permanently inoperable, and
  - 8.1.2. The licensee notifies the Authority within seven days using the approved form

**9. Records**

- 9.1. The following records must be kept in relation to regulated material for which the licensee is the person responsible:
  - 9.1.1. Maintenance reports and summaries of quality assurance and / or wipe tests undertaken on any sealed radioactive source or sealed source device
  - 9.1.2. Reports and certificates of compliance issued by a consulting radiation expert in relation to any radiation apparatus or fixed radiation gauge
  - 9.1.3. The source certificate for any sealed radioactive source
  - 9.1.4. Details of the type, location and movement of any radioactive substance(s)
  - 9.1.5. Details of an annual stocktake of all radioactive substances kept or used
  - 9.1.6. Details of all instances where the categories of regulated material used or kept change, as determined by Part 2, Cl.14 of the Regulation, and advise the EPA of any such change in writing within 14 days
- 9.2. The licensee must:
  - 9.2.1. Maintain records in legible form or in a form that can be readily reproduced in a legible form,
  - 9.2.2. Keep all records relating to regulated material for a period of two years after disposal, and
  - 9.2.3. Provide all records relating to regulated material to the person to whom the regulated material is transferred, in the case of sale or giving away

**10. Storage**

- 10.1. Ensure that regulated material for which the licensee is responsible is safely and securely stored if it is not required for immediate use and that:
  - 10.1.1. The store is constructed of durable materials
  - 10.1.2. The store is lockable
  - 10.1.3. Radiation levels in any accessible area outside the store do not exceed the dose limits for exposure in Schedule 5 of the Regulation
  - 10.1.4. Any radioactive substances are not stored with explosives, combustible or corrosive materials

**11. Whole body scanning**

- 11.1. The licensee must ensure that computed tomography apparatus for which the licensee is responsible is not used for screening for early signs of illness in patients who have no symptoms or disease risk factors, except at the written request of an independent medical practitioner and where the licensee has obtained the informed consent of the patient in writing.

Note: Informed consent requires that the patient has been informed of the scale of radiation dose from the procedure and the risks involved, including that persons under the age of 50 years are more at risk of developing cancers as a result of the procedure.

**12. Cyclotron**

- 12.1. The licensee must, prior to commencement of commissioning of the facility, submit a radiation protection plan to the Authority for its approval.
- 12.2. The licensee must, prior to commencement of normal operations, submit a copy of the acceptance test

documentation, providing certification that design features for hazard control are in place and operational, to the Authority for its approval.

- 12.3. The licensee must, if there is any variation to working procedures, engineering protective measures, or radiation monitoring plans, submit an amended radiation protection plan to the Authority for its approval.
- 12.4. The licensee must submit to the Authority a report on the operation of the cyclotron and ancillary facilities, as they relate to safety and radiation control issues for the first three months of its routine operation, and subsequently annually.

### 13. Guidelines

- 13.1. The licensee must comply with the obligations of 'responsible persons' in the following documents, to the extent that they apply to the licensee's radiation practice, as published by the New South Wales Environment Protection Authority (NSW EPA) <http://www.epa.nsw.gov.au/radiation/radiationpubs.htm> from time to time
  - 13.1.1. Radiation Guideline 6 - Registration requirements & industry best practice for ionising radiation apparatus used in diagnostic imaging, NSW EPA March 2004:
    - Part 1: Mammography
    - Part 2: Fluoroscopy & radiography
    - Part 3: Dentistry (including maxillofacial)
    - Part 4: Veterinary science
    - Part 5: Computed tomography & bone mineral densitometry
    - Part 6: Test protocols for parts 2-5

Note: Appendix A of Guideline 6, Parts 2-5 Policy on x-ray protective clothing (2004) has been superseded by Policy on x-ray protective clothing, NSW EPA, Nov 2009.

### 14. Codes

- 14.1. The licensee must comply with the obligations of 'responsible persons' in the following documents, to the extent that they apply to the licensee's radiation practice, as published by the Australian Radiation Protection and Nuclear Safety Agency (ARPANSA) <http://www.arpansa.gov.au/Publications/codes> from time to time:
  - 14.1.1. RPS 2. Code of Practice for the Safe Transport of Radioactive Material, ARPANSA Jan 2008
  - 14.1.2. RPS 5. Code of Practice and Safety Guide for Portable Density/Moisture Gauges containing Radioactive Sources, ARPANSA, May 2004
  - 14.1.3. RPS 8. Code of Practice for the Exposure of Humans to Ionizing Radiation for Research Purposes, ARPANSA, May 2005
  - 14.1.4. RPS 10. Code of Practice and Safety Guide for Radiation Protection in Dentistry, ARPANSA, Dec 2005
  - 14.1.5. RPS 13. Code of Practice and Safety Guide for Safe Use of Fixed Radiation Gauges, ARPANSA, Jan 2007
  - 14.1.6. RPS 14. Code of Practice for Radiation Protection in the Medical Applications of Ionizing Radiation, ARPANSA, May 2008
  - 14.1.7. RPS 17. Code of Practice and Safety Guide for Radiation Protection in Veterinary Medicine, ARPANSA, July 2009
  - 14.1.8. RPS 19. Code of Practice for Radiation Protection in the Application of Ionizing Radiation by Chiropractors, ARPANSA, Nov 2009
  - 14.1.9. RHS 9. Code of practice for protection against ionizing radiation emitted from X-ray analysis equipment, ARPANSA, 1984
  - 14.1.10. RHS 28. Code of practice for the safe use of sealed radioactive sources in bore-hole logging, ARPANSA, 1989
  - 14.1.11. RHS 31. Code of practice for the safe use of industrial radiography equipment, ARPANSA, 1989

In the event of an inconsistency between the Codes and the current relevant NSW legislation, the requirements of the legislation prevail to the extent of the inconsistency.

### 15. Definitions

**Person responsible** has the same meaning as in section 6 of the Act

**Act** means the Radiation Control Act 1990 (<http://www.epa.nsw.gov.au/legislation/ActSummaries.htm#radiation>)

**Diagnostic imaging apparatus** means:

- A. Any ionising radiation apparatus used or intended to be used for any medical diagnostic, veterinary diagnostic or dental purpose, or
- B. Any ionising radiation apparatus used or intended to be used for radiotherapy or radiotherapy planning purposes.

**Fixed radiation gauge** means a sealed source device which is in a fixed position.

**Regulation** means the Radiation Control Regulation 2013  
(<http://www.epa.nsw.gov.au/legislation/RegulationSummaries.htm#RCreg>)

**Regulated material** has the same meaning as in section 4 of the Act

**Occupationally exposed** has the same meaning as in clause 3 of the Regulation

**Radiation accident** has the same meaning as in clause 37 of the Regulation

**Sealed source device** has the same meaning as in section 4 of the Act.

## Radiation Regulated Material (RRM) Schedule (Licence no 5061564)

Location: South Western Sydney Local Health District - LIVERPOOL - Liverpool Hospital, Cnr Hart & Lachlan Streets, LIVERPOOL, NSW 2170

## Radiation regulated material ID No 16622 (status Active)

<u>Work Area</u>	<u>Fee Group</u>	<u>Type</u>	<u>Equipment</u>	<u>Purpose</u>	
PET/CT - Room 021, GA 241	Group B	Radiation apparatus	Computed Tomography	Medical diagnostic	
Components:	<u>Type</u>	<u>Manufacturer</u>	<u>Model No</u>	<u>Serial No</u>	<u>Source Name</u>
47224	Control console / generator	General Electric (GE Healthcare)	2371333-6	204367WG7	
47225	X-ray tube housing	General Electric (GE Healthcare)	2137130-17	103225TY9	
47226	X-ray tube insert	General Electric (GE Healthcare)	5401074	215223GI9	

Department: Dept of Nuclear Medicine & PET

## Radiation regulated material ID No 14232 (status Active)

<u>Work Area</u>	<u>Fee Group</u>	<u>Type</u>	<u>Equipment</u>	<u>Purpose</u>	
Cyclotron facility - basement (adjacent to P3 carpark)	Group D	Radiation apparatus	Cyclotron	Isotope production	
Components:	<u>Type</u>	<u>Manufacturer</u>	<u>Model No</u>	<u>Serial No</u>	<u>Source Name</u>
40501	Control console / generator	General Electric (GE Healthcare)	PETtrace 800 series	286233	

Location: South Western Sydney Local Health District - BANKSTOWN - Bankstown Child Oral Health Clinic, 322 Hume Highway, BANKSTOWN, NSW 2200

## Radiation regulated material ID No 3280 (former registration number RR6840) (status Active)

<u>Work Area</u>	<u>Fee</u> <u>Group</u>	<u>Type</u>	<u>Equipment</u>	<u>Purpose</u>	
Surgery 1	Group A	Radiation apparatus	Dental Radiography	Dental diagnostic	
Components:	<u>Type</u>	<u>Manufacturer</u>	<u>Model No</u>	<u>Serial No</u>	<u>Source</u> <u>Name</u>
4351	Control console / generator	De Gotzen	X-Mind	25821	
4768	X-ray tube housing	De Gotzen	Image X	25564	
4769	X-ray tube insert	Toshiba	DG-073B	38776	



## Radiation regulated material ID No 3282 (former registration number RR6841) (status Active)

<u>Work Area</u>	<u>Fee Group</u>	<u>Type</u>	<u>Equipment</u>	<u>Purpose</u>
Surgery 2	Group A	Radiation apparatus	Dental Radiography	Dental diagnostic
Components:	<u>Type</u>	<u>Manufacturer</u>	<u>Model No</u>	<u>Serial No</u> <u>Source Name</u>
	4352	X-ray tube insert	Toshiba	DG-073B-AC 37967
	4770	Control console / generator	De Gotzen	Synchro 1657 25813
	4771	X-ray tube housing	De Gotzen	CE-0434 23904

## Radiation regulated material ID No 3283 (former registration number RR6842) (status Active)

<u>Work Area</u>	<u>Fee Group</u>	<u>Type</u>	<u>Equipment</u>	<u>Purpose</u>
Surgery 3	Group A	Radiation apparatus	Dental Radiography	Dental diagnostic
Components:	<u>Type</u>	<u>Manufacturer</u>	<u>Model No</u>	<u>Serial No</u> <u>Source Name</u>
	4772	Control console / generator	De Gotzen	X-Mind 25822
	4773	X-ray tube housing	De Gotzen	Image X 21986
	4774	X-ray tube insert	Toshiba	DG-073B 34155

## Radiation regulated material ID No 3284 (former registration number RR6843) (status Active)

<u>Work Area</u>	<u>Fee Group</u>	<u>Type</u>	<u>Equipment</u>	<u>Purpose</u>
Surgery 4	Group A	Radiation apparatus	Dental Radiography	Dental diagnostic
Components:	<u>Type</u>	<u>Manufacturer</u>	<u>Model No</u>	<u>Serial No</u> <u>Source Name</u>
	4353	X-ray tube housing	De Gotzen	Image X 21988
	4354	X-ray tube insert	Toshiba	DG-073B 34158
	4775	Control console / generator	De Gotzen	X-Mind 25817

Location: South Western Sydney Local Health District - BANKSTOWN - Bankstown-Lidcombe Hospital, 70 Eldridge Road, BANKSTOWN, NSW 2200

## Radiation regulated material ID No 1223 (former registration number RR12531) (status Active)

<u>Work Area</u>	<u>Fee Group</u>	<u>Type</u>	<u>Equipment</u>	<u>Purpose</u>
Room 5	Group B	Radiation apparatus	Radiography / Fluoroscopy	Medical diagnostic
Components:	<u>Type</u>	<u>Manufacturer</u>	<u>Model No</u>	<u>Serial No</u> <u>Source Name</u>
	11685	X-ray tube insert	Shimadzu	0.6/1.2 P364DK-85 70195
	11686	X-ray tube insert	Shimadzu	0.6/1.2 P364 DK-85 CM6D92022 015
	11996	Control console / generator	Shimadzu	UD-150-B40 0362R71603
	11997	X-ray tube housing	Shimadzu	0.6/1.2 P38DE-85 70417
	11998	X-ray tube housing	Shimadzu	0.6/1.2 P364DK-85 CM6D92022 015

## Radiation regulated material ID No 1327 (former registration number RR12662) (status Active)

<u>Work Area</u>	<u>Fee Group</u>	<u>Type</u>	<u>Equipment</u>	<u>Purpose</u>
CT Room	Group B	Radiation apparatus	Computed Tomography	Medical diagnostic
Components:	<u>Type</u>	<u>Manufacturer</u>	<u>Model No</u>	<u>Serial No</u> <u>Source Name</u>
	13381	X-ray tube insert	Philips Healthcare	989000008536 107874
	13541	Control console / generator	Philips Healthcare	453567303961 10016
	13546	X-ray tube housing	Philips Healthcare	989000085891 17496M107874

## Radiation regulated material ID No 1898 (former registration number RR1611) (status Active)

<u>Work Area</u>	<u>Fee Group</u>	<u>Type</u>	<u>Equipment</u>	<u>Purpose</u>
Mobile - AMX-4 No 1	Group B	Radiation apparatus	General Radiography	Medical diagnostic
Components:	<u>Type</u>	<u>Manufacturer</u>	<u>Model No</u>	<u>Serial No</u> <u>Source Name</u>
	713	X-ray tube housing	General Electric (GE Healthcare)	46-155750G8 45802EC6
	714	X-ray tube insert	General Electric (GE Healthcare)	46-125686G8 090372
	841	Control console / generator	General Electric (GE Healthcare)	46-270954G1 9027ED4

## Radiation regulated material ID No 1900 (former registration number RR1613) (status Active)

<u>Work Area</u>	<u>Fee Group</u>	<u>Type</u>	<u>Equipment</u>	<u>Purpose</u>
Mobile - AMX-4 No 2	Group B	Radiation apparatus	General Radiography	Medical diagnostic
Components:	<u>Type</u>	<u>Manufacturer</u>	<u>Model No</u>	<u>Serial No</u> <u>Source Name</u>
	717	X-ray tube housing	General Electric (GE Healthcare)	46-155750G8 11285EX4
	842	Control console / generator	General Electric (GE Healthcare)	46-270954G1 22010303
	843	X-ray tube insert	General Electric (GE Healthcare)	46-125686G8 15296TX7

## Radiation regulated material ID No 1905 (former registration number RR1620) (status Active)

<u>Work Area</u>	<u>Fee Group</u>	<u>Type</u>	<u>Equipment</u>	<u>Purpose</u>
General Room 4	Group B	Radiation apparatus	General Radiography	Medical diagnostic
Components:	<u>Type</u>	<u>Manufacturer</u>	<u>Model No</u>	<u>Serial No</u> <u>Source Name</u>
	847	Control console / generator	Philips Healthcare	989000002001 961152
	848	X-ray tube housing	Philips Healthcare	987400516122 84010-981240
	849	X-ray tube insert	Philips Healthcare	980620670102 981240

## Radiation regulated material ID No 5490 (former registration number RR20687) (status Active)

<u>Work Area</u>	<u>Fee Group</u>	<u>Type</u>	<u>Equipment</u>	<u>Purpose</u>
Theatres - Mobile 11	Group B	Radiation apparatus	Radiography / Fluoroscopy	Medical diagnostic
Components:	<u>Type</u>	<u>Manufacturer</u>	<u>Model No</u>	<u>Serial No</u> <u>Source Name</u>
15748	Control console / generator	Philips Healthcare	452216514011	050717109
15749	X-ray tube housing	Philips Healthcare	452212905322	042951005
15860	X-ray tube insert	Philips Healthcare	RO-0306	222505

**Radiation regulated material ID No 7181 (former registration number RR22749) (status Active)**

<u>Work Area</u>	<u>Fee Group</u>	<u>Type</u>	<u>Equipment</u>	<u>Purpose</u>
CT Room	Group B	Radiation apparatus	Computed Tomography	Medical diagnostic
Components:	<u>Type</u>	<u>Manufacturer</u>	<u>Model No</u>	<u>Serial No</u> <u>Source Name</u>
20549	Control console / generator	General Electric (GE Healthcare)	Lightspeed VCT	423186CN6
20550	X-ray tube insert	General Electric (GE Healthcare)	2291563-2	157053GIO
20846	X-ray tube housing	General Electric (GE Healthcare)	2219500	32762GM7

**Radiation regulated material ID No 7483 (former registration number RR23116) (status Active)**

<u>Work Area</u>	<u>Fee Group</u>	<u>Type</u>	<u>Equipment</u>	<u>Purpose</u>
SPECT/CT Room Nuclear Medicine Dept	Group B	Radiation apparatus	Computed Tomography	Medical diagnostic
Components:	<u>Type</u>	<u>Manufacturer</u>	<u>Model No</u>	<u>Serial No</u> <u>Source Name</u>
21543	X-ray tube housing	General Electric (GE Healthcare)	2137130-2	76160BC1
21544	X-ray tube insert	General Electric (GE Healthcare)	2120785-2	70608B15
21717	Control console / generator	General Electric (GE Healthcare)	Discovery 670	276872HM9

**Radiation regulated material ID No 10001 (former registration number RR10086) (status Active)**

<u>Work Area</u>	<u>Fee Group</u>	<u>Type</u>	<u>Equipment</u>	<u>Purpose</u>
Hot Lab, Store and Ward ZJ	Group B	Unsealed radioactive substance		Nuclear medicine public facility
Components:	<u>Type</u>	<u>Manufacturer</u>	<u>Model No</u>	<u>Serial No</u> <u>Source Name</u>

**Radiation regulated material ID No 10002 (former registration number RR10087) (status Active)**

<u>Work Area</u>	<u>Fee Group</u>	<u>Type</u>	<u>Equipment</u>	<u>Purpose</u>
Waste Storage	Group B	Unsealed radioactive substance		Nuclear medicine public facility

Components:	Type	Manufacturer	Model No	Serial No	Source Name
-------------	------	--------------	----------	-----------	-------------

**Radiation regulated material ID No 10394 (status Active)**

<u>Work Area</u>	<u>Fee Group</u>	<u>Type</u>	<u>Equipment</u>	<u>Purpose</u>	
Radiology Dept	Group B	Radiation apparatus	General Radiography	Medical diagnostic	
Components:	<u>Type</u>	<u>Manufacturer</u>	<u>Model No</u>	<u>Serial No</u>	<u>Source Name</u>
29780	Control console / generator	Philips Healthcare	M-CAB	14-A0073	
29781	X-ray tube housing	Philips Healthcare	SRO33/00 - ROT360	39013A245475	

**Radiation regulated material ID No 10395 (status Active)**

<u>Work Area</u>	<u>Fee Group</u>	<u>Type</u>	<u>Equipment</u>	<u>Purpose</u>	
Radiology Dept - Mobile Unit	Group B	Radiation apparatus	General Radiography	Medical diagnostic	
Components:	<u>Type</u>	<u>Manufacturer</u>	<u>Model No</u>	<u>Serial No</u>	<u>Source Name</u>
29782	Control console / generator	Philips Healthcare	Mobile Diagnost	A6097-16	
29783	X-ray tube housing	Toshiba	E7886X	14C054	
29784	X-ray tube insert	Toshiba	E7886	4B540	

**Radiation regulated material ID No 10653 (former registration number RR1619) (status Active)**

<u>Work Area</u>	<u>Fee</u>	<u>Type</u>	<u>Equipment</u>	<u>Purpose</u>	
	<u>Group</u>				
	Group B	Radiation apparatus	Radiography / Fluoroscopy	Medical diagnostic	
Components:	<u>Type</u>	<u>Manufacturer</u>	<u>Model No</u>	<u>Serial No</u>	<u>Source</u>
					<u>Name</u>
30435	Control console / generator	Siemens	3827362X2122	01187	
30436	X-ray tube insert	Siemens	3133506V2159	904319505	
30437	X-ray tube housing	Siemens	3754509X2141	064219602	

**Radiation regulated material ID No 10686 (former registration number RR20060) (status Active)**

<u>Work Area</u>	<u>Fee Group</u>	<u>Type</u>	<u>Equipment</u>	<u>Purpose</u>	
BMD Room 20893	Group B	Radiation apparatus	Bone Mineral Densitometry	Medical diagnostic	
Components:	<u>Type</u>	<u>Manufacturer</u>	<u>Model No</u>	<u>Serial No</u>	<u>Source Name</u>
30524	X-ray tube housing	Lunar	8743	302387	
30525	Control console / generator	Lunar	Prodigy	302387	
30526	X-ray tube insert	UNKNOWN	BX-1L	-	

**Radiation regulated material ID No 13319 (status Active)**

Work Area	Fee Group	Type	Equipment	Purpose
-----------	-----------	------	-----------	---------

Operating theatre	Group B	Radiation apparatus	Radiography / Fluoroscopy	Medical diagnostic	
Components:	<u>Type</u>	<u>Manufacturer</u>	<u>Model No</u>	<u>Serial No</u>	<u>Source Name</u>
37995	Control console / generator	Philips Healthcare	452226514012	071304070	
37996	X-ray tube housing	Philips Healthcare	459800884051	060188005	
37997	X-ray tube insert	Philips Healthcare	RO-0308	82P270	

**Radiation regulated material ID No 13321 (status Active)**

<u>Work Area</u>	<u>Fee Group</u>	<u>Type</u>	<u>Equipment</u>	<u>Purpose</u>	
Mobile Unit	Group B	Radiation apparatus	Radiography / Fluoroscopy	Medical diagnostic	
Components:	<u>Type</u>	<u>Manufacturer</u>	<u>Model No</u>	<u>Serial No</u>	<u>Source Name</u>
38001	Control console / generator	Shimadzu	Mobile Dart	MPE09C15A001	
38002	X-ray tube housing	Shimadzu	0.7/1.3U163C-36	RM7485959044	
38003	X-ray tube insert	Shimadzu	0.7/1.3U163C-36	53560	

**Radiation regulated material ID No 13637 (status Active)**

<u>Work Area</u>	<u>Fee Group</u>	<u>Type</u>	<u>Equipment</u>	<u>Purpose</u>	
X-Ray Room	Group B	Radiation apparatus	General Radiography	Medical diagnostic	
Components:	<u>Type</u>	<u>Manufacturer</u>	<u>Model No</u>	<u>Serial No</u>	<u>Source Name</u>
38730	Control console / generator	Shimadzu	UD-150B-40E	LM5249F59003	
38731	X-ray tube housing	Shimadzu	0.6/1.2 P324DK-85	RM6D85858069	
38732	X-ray tube insert	Shimadzu	0.6/1.2 P324DK-85	RM6D85858069	

**Radiation regulated material ID No 14992 (status Active)**

<u>Work Area</u>	<u>Fee Group</u>	<u>Type</u>	<u>Equipment</u>	<u>Purpose</u>	
OPG Room	Group A	Radiation apparatus	Panoramic Radiography	Dental diagnostic	
Components:	<u>Type</u>	<u>Manufacturer</u>	<u>Model No</u>	<u>Serial No</u>	<u>Source Name</u>
42542	Control console / generator	Carestream	CS-8100	EK1A435	
42543	X-ray tube housing	Carestream	CU-244	EKXG150	
42544	X-ray tube insert	Toshiba	D-054	97281	

**Radiation regulated material ID No 14995 (status Active)**

<u>Work Area</u>	<u>Fee Group</u>	<u>Type</u>	<u>Equipment</u>	<u>Purpose</u>	
Mobile Image Intensifier	Group B	Radiation apparatus	Radiography / Fluoroscopy	Medical diagnostic	

Components:	Type	Manufacturer	Model No	Serial No	Source Name
42551	Control console / generator	Philips Healthcare	452216514012	0715181109	
42552	X-ray tube housing	Philips Healthcare	459800884501	061160007	
42553	X-ray tube insert	Philips Healthcare	RO-0306	825656	

**Radiation regulated material ID No 16502 (status Active)**

<u>Work Area</u>	<u>Fee Group</u>	<u>Type</u>	<u>Equipment</u>	<u>Purpose</u>	
Screening Room	Group B	Radiation apparatus	Radiography / Fluoroscopy	Medical diagnostic	
Components:	<u>Type</u>	<u>Manufacturer</u>	<u>Model No</u>	<u>Serial No</u>	<u>Source Name</u>
46872	Control console / generator	Siemens	Artis Zee VD-11	148284	
46873	X-ray tube housing	Siemens	Megalic 10144180	605241674	
46874	X-ray tube insert	Siemens	10144177	682221674	

**Radiation regulated material ID No 17139 (status Active)**

<u>Work Area</u>	<u>Fee</u>	<u>Type</u>	<u>Equipment</u>	<u>Purpose</u>	
	<u>Group</u>				
CT Room	Group B	Radiation apparatus	Computed Tomography	Medical diagnostic	
Components:	<u>Type</u>	<u>Manufacturer</u>	<u>Model No</u>	<u>Serial No</u>	<u>Source</u>
					<u>Name</u>
48636	Control console / generator	Philips Healthcare	I Qon Spectral	0860093	
48637	X-ray tube housing	Philips Healthcare	I Qon Spectral	0860093	
48638	X-ray tube insert	Philips Healthcare	CTXS Tube	302750	

**Department: Nuclear Medicine****Radiation regulated material ID No 8911 (former registration number RR10304) (status Active)**

<u>Work Area</u>	<u>Fee Group</u>	<u>Type</u>	<u>Equipment</u>	<u>Purpose</u>	
	Group B	Sealed source device	PET/SPECT Gamma Camera		
Components:	<u>Type</u>	<u>Manufacturer</u>	<u>Model No</u>	<u>Serial No</u>	<u>Source Name</u>
25995	Container	Siemens	HEGL-0064	LL-808	
26422	Sealed source	Isotopes Product Laboratory		LL-808	americium-241

**Radiation regulated material ID No 10000 (former registration number RR10085) (status Active)**

<u>Work Area</u>	<u>Fee Group</u>	<u>Type</u>	<u>Equipment</u>	<u>Purpose</u>	
	Group B	Unsealed radioactive substance		Nuclear medicine public facility	
<hr/>					
Components:	<u>Type</u>	<u>Manufacturer</u>	<u>Model No</u>	<u>Serial No</u>	<u>Source Name</u>

Location: South Western Sydney Local Health District - BOWRAL - Bowral Oral Health Clinic,  
Bendooley Street, BOWRAL, NSW 2576

**Radiation regulated material ID No 1681 (former registration number RR10335) (status Active)**

<u>Work Area</u>	<u>Fee Group</u>	<u>Type</u>	<u>Equipment</u>	<u>Purpose</u>
Surgery 3	Group A	Radiation apparatus	Dental Radiography	Dental diagnostic
Components:	<u>Type</u>	<u>Manufacturer</u>	<u>Model No</u>	<u>Serial No</u> <u>Source Name</u>
	11901	Control console / generator	Trophy	Elitys XIQE226
	11905	X-ray tube housing	Trophy	TR-1 XBQF033
	11941	X-ray tube insert	Trophy	TRX-708 212173

**Radiation regulated material ID No 2092 (former registration number RR2305) (status Active)**

<u>Work Area</u>	<u>Fee Group</u>	<u>Type</u>	<u>Equipment</u>	<u>Purpose</u>
Surgery 1	Group A	Radiation apparatus	Dental Radiography	Dental diagnostic
Components:	<u>Type</u>	<u>Manufacturer</u>	<u>Model No</u>	<u>Serial No</u> <u>Source Name</u>
	1603	Control console / generator	Gendex (KaVo)	Densomat 811139
	1604	X-ray tube housing	Gendex (KaVo)	Oralix 65G 953881
	1605	X-ray tube insert	Gendex (KaVo)	800-0004G1 106440

**Radiation regulated material ID No 8528 (status Active)**

<u>Work Area</u>	<u>Fee Group</u>	<u>Type</u>	<u>Equipment</u>	<u>Purpose</u>
Surgery 2	Group A	Radiation apparatus	Dental Radiography	Dental diagnostic
Components:	<u>Type</u>	<u>Manufacturer</u>	<u>Model No</u>	<u>Serial No</u> <u>Source Name</u>
	24734	Control console / generator	Carestream	2200 BDYO121
	24779	X-ray tube insert	Trophy	TRX-708 1310193

Location: South Western Sydney Local Health District - CAMDEN - Camden Hospital, Menangle Road,  
CAMDEN, NSW 2570

**Radiation regulated material ID No 3509 (former registration number RR7442) (status Active)**

<u>Work Area</u>	<u>Fee Group</u>	<u>Type</u>	<u>Equipment</u>	<u>Purpose</u>
General X-Ray Room	Group B	Radiation apparatus	General Radiography	Medical diagnostic
Components:	<u>Type</u>	<u>Manufacturer</u>	<u>Model No</u>	<u>Serial No</u> <u>Source Name</u>
	5074	Control console / generator	Toshiba	KXO-60G B1562189
	5075	X-ray tube housing	Toshiba	B-130 H33553
	5438	X-ray tube insert	Toshiba	A-192 335553-1Q

**Radiation regulated material ID No 11189 (former registration number RR8370) (status Active)**

<u>Work Area</u>	<u>Fee Group</u>	<u>Type</u>	<u>Equipment</u>	<u>Purpose</u>
------------------	------------------	-------------	------------------	----------------



Screening Room	Group B	Radiation apparatus	Radiography / Fluoroscopy	Medical diagnostic		
Components:	<u>Type</u>	<u>Manufacturer</u>	<u>Model No</u>	<u>Serial No</u>	<u>Source Name</u>	
31930	Control console / generator	Shimadzu	MUX-100	503-48500-05		
31931	X-ray tube housing	Shimadzu	07U16303	05136		
31932	X-ray tube insert	Shimadzu	07U16303	05136		

**Radiation regulated material ID No 16736 (status Active)**

<u>Work Area</u>	<u>Fee Group</u>	<u>Type</u>	<u>Equipment</u>	<u>Purpose</u>		
BMD Room	Group B	Radiation apparatus	Bone Mineral Densitometry	Medical diagnostic		
Components:	<u>Type</u>	<u>Manufacturer</u>	<u>Model No</u>	<u>Serial No</u>	<u>Source Name</u>	
47548	Control console / generator	Lunar	Dexa Form	ICT210271		
47549	X-ray tube housing	Lunar	Dexa Form	ICT210271		
47550	X-ray tube insert	Lunar	Dexa Form	ICT210271		

**Location: South Western Sydney Local Health District - CAMPBELLTOWN - Breastsreen NSW, Mawson Centre Ground Level 4 Browne Street, CAMPBELLTOWN, NSW 2560**

**Department: Radiology**

**Radiation regulated material ID No 11908 (status Active)**

<u>Work Area</u>	<u>Fee Group</u>	<u>Type</u>	<u>Equipment</u>	<u>Purpose</u>		
Mammography Room	Group B	Radiation apparatus	Mammography	Medical diagnostic		
Components:	<u>Type</u>	<u>Manufacturer</u>	<u>Model No</u>	<u>Serial No</u>	<u>Source Name</u>	
33871	Control console / generator	Spellman High Voltage Electronics	FF40P9X-3444	77974-1-A00551		
33872	X-ray tube housing	Varian Medical Systems	Mamrad 105H	H99937		
33873	X-ray tube insert	Varian Medical Systems	RAD-70D	99937-R1		

**Radiation regulated material ID No 11909 (status Active)**

<u>Work Area</u>	<u>Fee Group</u>	<u>Type</u>	<u>Equipment</u>	<u>Purpose</u>		
Mammography Room	Group B	Radiation apparatus	Mammography	Medical diagnostic		
Components:	<u>Type</u>	<u>Manufacturer</u>	<u>Model No</u>	<u>Serial No</u>	<u>Source Name</u>	
33874	Control console / generator	Spellman High Voltage Electronics	FF40P9X-3444	77974-1-A00558		
33875	X-ray tube housing	Varian Medical Systems	Mamrad 105-H	H18991		
33876	X-ray tube insert	Varian Medical Systems	RAD-70D	18991-W1		

Location: South Western Sydney Local Health District - CAMPBELLTOWN - Campbelltown Hospital,  
Therry Road, CAMPBELLTOWN, NSW 2560

**Radiation regulated material ID No 2223 (former registration number RR10618) (status Active)**

<u>Work Area</u>	<u>Fee Group</u>	<u>Type</u>	<u>Equipment</u>	<u>Purpose</u>
X-Ray Dept - Mobile Unit	Group B	Radiation apparatus	General Radiography	Medical diagnostic
Components:	<u>Type</u>	<u>Manufacturer</u>	<u>Model No</u>	<u>Serial No</u> <u>Source Name</u>
11851	X-ray tube insert	Circlex	0.7V163CS-36	33642
12018	Control console / generator	Shimadzu	MUX/100H/Mobi I Art	0162Z02207
12019	X-ray tube housing	Shimadzu	0.7V163CS-36	33642

**Radiation regulated material ID No 3134 (former registration number RR6242) (status Active)**

<u>Work Area</u>	<u>Fee Group</u>	<u>Type</u>	<u>Equipment</u>	<u>Purpose</u>
OPG Room	Group A	Radiation apparatus	Panoramic Radiography	Dental diagnostic
Components:	<u>Type</u>	<u>Manufacturer</u>	<u>Model No</u>	<u>Serial No</u> <u>Source Name</u>
3901	X-ray tube insert	Toshiba	D-052SB	9D6434
4379	Control console / generator	Planmeca	PM2002CC	RCC992988
4380	X-ray tube housing	Planmeca	3PM2002CC Proline	RTH998708

**Radiation regulated material ID No 3135 (former registration number RR6250) (status Active)**

<u>Work Area</u>	<u>Fee Group</u>	<u>Type</u>	<u>Equipment</u>	<u>Purpose</u>
Mobile Unit	Group B	Radiation apparatus	General Radiography	Medical diagnostic
Components:	<u>Type</u>	<u>Manufacturer</u>	<u>Model No</u>	<u>Serial No</u> <u>Source Name</u>
4301	Control console / generator	General Electric (GE Healthcare)	AMX-4	428V-13
4302	X-ray tube housing	General Electric (GE Healthcare)	46-155750G8	47027EX8
4303	X-ray tube insert	General Electric (GE Healthcare)	46-125686G8	54935TX2

**Radiation regulated material ID No 3690 (former registration number RR7876) (status Active)**

<u>Work Area</u>	<u>Fee Group</u>	<u>Type</u>	<u>Equipment</u>	<u>Purpose</u>
X-Ray Room 2	Group B	Radiation apparatus	General Radiography	Medical diagnostic
Components:	<u>Type</u>	<u>Manufacturer</u>	<u>Model No</u>	<u>Serial No</u> <u>Source Name</u>
7496	Control console / generator	Siemens	Polydoras IT55	1428
7497	X-ray tube housing	Siemens	4803404	452091043
7563	X-ray tube insert	Siemens	4803388	50371046

**Radiation regulated material ID No 3691 (former registration number RR7877) (status Active)**

<u>Work Area</u>	<u>Fee Group</u>	<u>Type</u>	<u>Equipment</u>	<u>Purpose</u>
X-Ray Room 3	Group B	Radiation apparatus	General Radiography	Medical diagnostic
Components:	<u>Type</u>	<u>Manufacturer</u>	<u>Model No</u>	<u>Serial No</u> <u>Source Name</u>
	7499	Control console / generator	Siemens	Polydoros I755 1427
	7566	X-ray tube housing	Siemens	4803404 2645
	7567	X-ray tube insert	Siemens	4803388 377603

**Radiation regulated material ID No 3714 (former registration number RR7912) (status Active)**

<u>Work Area</u>	<u>Fee Group</u>	<u>Type</u>	<u>Equipment</u>	<u>Purpose</u>
X-Ray Room 1	Group B	Radiation apparatus	General Radiography	Medical diagnostic
Components:	<u>Type</u>	<u>Manufacturer</u>	<u>Model No</u>	<u>Serial No</u> <u>Source Name</u>
	7892	X-ray tube insert	Siemens	3345233 501261042
	8150	Control console / generator	Siemens	Polydoros LX80 1256
	8151	X-ray tube housing	Siemens	3345209 404261042

**Radiation regulated material ID No 4517 (former registration number RR8799) (status Active)**

<u>Work Area</u>	<u>Fee Group</u>	<u>Type</u>	<u>Equipment</u>	<u>Purpose</u>
Mobile- Theatres	Group B	Radiation apparatus	Radiography / Fluoroscopy	Medical diagnostic
Components:	<u>Type</u>	<u>Manufacturer</u>	<u>Model No</u>	<u>Serial No</u> <u>Source Name</u>
	6545	X-ray tube insert	Shimadzu	AD110P-50N 016N609201
	6970	Control console / generator	Shimadzu	Opescope 50N 0161B19804
	6971	X-ray tube housing	Shimadzu	AD110P-50N 0161B19804

**Radiation regulated material ID No 4962 (status Active)**

<u>Work Area</u>	<u>Fee Group</u>	<u>Type</u>	<u>Equipment</u>	<u>Purpose</u>
Bunker M4 - Cancer Therapy Centre	Group B	Radiation apparatus	LINAC with Fluoroscopy	Radiotherapy
Components:	<u>Type</u>	<u>Manufacturer</u>	<u>Model No</u>	<u>Serial No</u> <u>Source Name</u>
	14015	X-ray tube housing	Dunlee	DU-694 53347A225758
	14322	Control console / generator	Elekta	Versa HD 153383
	46800	X-ray tube insert	Dunlee	DU-694 225758

**Radiation regulated material ID No 5630 (former registration number RR20863) (status Active)**

<u>Work Area</u>	<u>Fee Group</u>	<u>Type</u>	<u>Equipment</u>	<u>Purpose</u>
Theatres	Group B	Radiation apparatus	Radiography / Fluoroscopy	Medical diagnostic
Components:	<u>Type</u>	<u>Manufacturer</u>	<u>Model No</u>	<u>Serial No</u> <u>Source Name</u>

16102	Control console / generator	Philips Healthcare	BV Libra	1362
16111	X-ray tube housing	Philips Healthcare	989000061831	09300286
16112	X-ray tube insert	Philips Healthcare	989000064801	992246

**Radiation regulated material ID No 5700 (former registration number RR20958) (status Active)**

<u>Work Area</u>	<u>Fee Group</u>	<u>Type</u>	<u>Equipment</u>	<u>Purpose</u>
Mobile - Theatre 6	Group A	Radiation apparatus	Dental Radiography	Dental diagnostic
Components:	<u>Type</u>	<u>Manufacturer</u>	<u>Model No</u>	<u>Serial No</u> <u>Source Name</u>
16199	Control console / generator	Kodak	2200	XEYA087
16343	X-ray tube insert	Trophy	TRX-708	0911087

**Radiation regulated material ID No 8453 (status Active)**

<u>Work Area</u>	<u>Fee Group</u>	<u>Type</u>	<u>Equipment</u>	<u>Purpose</u>
CT - Cancer Therapy Centre	Group B	Radiation apparatus	Simulator/CT	Radiotherapy
Components:	<u>Type</u>	<u>Manufacturer</u>	<u>Model No</u>	<u>Serial No</u> <u>Source Name</u>
24441	Control console / generator	Philips Healthcare	Brilliance Big Bone	7904
24442	X-ray tube insert	Philips Healthcare	MRC-800	132672
24680	X-ray tube housing	Philips Healthcare	MRC	132672

**Radiation regulated material ID No 11477 (status Active)**

<u>Work Area</u>	<u>Fee Group</u>	<u>Type</u>	<u>Equipment</u>	<u>Purpose</u>
Bunker M5 - Cancer Therapy Centre	Group B	Radiation apparatus	Linear Accelerator	Radiotherapy
Components:	<u>Type</u>	<u>Manufacturer</u>	<u>Model No</u>	<u>Serial No</u> <u>Source Name</u>
32722	Control console / generator	Elekta	Versa	153384
32723	X-ray tube housing	Dunlee	DU-694	703847KR
32724	X-ray tube insert	Dunlee	DU-694	67690

**Radiation regulated material ID No 14652 (status Active)**

<u>Work Area</u>	<u>Fee Group</u>	<u>Type</u>	<u>Equipment</u>	<u>Purpose</u>
CT Room	Group B	Radiation apparatus	Computed Tomography	Medical diagnostic
Components:	<u>Type</u>	<u>Manufacturer</u>	<u>Model No</u>	<u>Serial No</u> <u>Source Name</u>
41641	Control console / generator	Siemens	Definition Flash	74298
41642	X-ray tube housing	Siemens	Straton	660141671
41643	X-ray tube insert	Siemens	Straton	659141674

**Radiation regulated material ID No 16734 (status Active)**

<u>Work Area</u>	<u>Fee Group</u>	<u>Type</u>	<u>Equipment</u>	<u>Purpose</u>
Medical Imaging	Group B	Radiation apparatus	Radiography / Fluoroscopy	Medical diagnostic

Components:	Type	Manufacturer	Model No	Serial No	Source Name
47542	Control console / generator	Toshiba	KXO-80Z	E2G174212 8	
47543	X-ray tube housing	Toshiba	DSRX-T2454G	17D701	
47544	X-ray tube insert	Toshiba	DSRX-T7545G	TC703	

**Radiation regulated material ID No 16735 (status Active)**

<u>Work Area</u>	<u>Fee Group</u>	<u>Type</u>	<u>Equipment</u>	<u>Purpose</u>	
CT Room	Group B	Radiation apparatus	Computed Tomography	Medical diagnostic	
Components:	<u>Type</u>	<u>Manufacturer</u>	<u>Model No</u>	<u>Serial No</u>	<u>Source Name</u>
47545	Control console / generator	General Medical Merate (GMM)	5499115	707521BU1	
47546	X-ray tube housing	General Medical Merate (GMM)	5402800	061821GM5	
47547	X-ray tube insert	General Medical Merate (GMM)	5402799	214642GI1	

**Department: Dentistry****Radiation regulated material ID No 12653 (status Active)**

<u>Work Area</u>	<u>Fee</u>	<u>Type</u>	<u>Equipment</u>	<u>Purpose</u>	
	<u>Group</u>				
Theatres	Group B	Radiation apparatus	Radiography / Fluoroscopy	Medical diagnostic	
Components:	<u>Type</u>	<u>Manufacturer</u>	<u>Model No</u>	<u>Serial No</u>	<u>Source</u>
					<u>Name</u>
36130	Control console / generator	Philips Healthcare	989600193501	000955	
36131	X-ray tube housing	Philips Healthcare	989000061831	15300225	
36132	X-ray tube insert	Philips Healthcare	989000064801	996398	

**Radiation regulated material ID No 12654 (status Active)**

<u>Work Area</u>	<u>Fee</u>	<u>Type</u>	<u>Equipment</u>	<u>Purpose</u>	
	<u>Group</u>				
Mobile Unit	Group B	Radiation apparatus	General Radiography	Medical diagnostic	
Components:	<u>Type</u>	<u>Manufacturer</u>	<u>Model No</u>	<u>Serial No</u>	<u>Source</u>
					<u>Name</u>
36133	Control console / generator	Philips Healthcare	989001089522	15100194	
36134	X-ray tube housing	Toshiba	E7886X	15D152	
36135	X-ray tube insert	Toshiba	E7886	50745	

**Location: South Western Sydney Local Health District - INGLEBURN - Ingleburn Oral Health Clinic, 57 Cumberland Road, INGLEBURN, NSW 2565**

**Radiation regulated material ID No 5750 (former registration number RR21012) (status Active)**

Work Area	Fee Group	Type	Equipment	Purpose
Surgery 2	Group A	Radiation apparatus	Dental Radiography	Dental diagnostic

Components:	Type	Manufacturer	Model No	Serial No	Source Name
16240	Control console / generator	Kodak	2200	XAYA177	
16722	X-ray tube insert	Trophy	TRX-708	0840092	

**Radiation regulated material ID No 5752 (former registration number RR21013) (status Active)**

<u>Work Area</u>	<u>Fee</u>	<u>Type</u>	<u>Equipment</u>	<u>Purpose</u>	
	<u>Group</u>				
Surgery 6	Group A	Radiation apparatus	Dental Radiography	Dental diagnostic	
Components:	<u>Type</u>	<u>Manufacturer</u>	<u>Model No</u>	<u>Serial No</u>	<u>Source</u>
					<u>Name</u>

16593	Control console / generator	Kodak	2200	XGYA333	
16725	X-ray tube insert	Trophy	TRX-708	0925187	

**Radiation regulated material ID No 5753 (former registration number RR21014) (status Active)**

<u>Work Area</u>	<u>Fee</u> <u>Group</u>	<u>Type</u>	<u>Equipment</u>	<u>Purpose</u>	
Surgery 5	Group A	Radiation apparatus	Dental Radiography	Dental diagnostic	
Components:	<u>Type</u>	<u>Manufacturer</u>	<u>Model No</u>	<u>Serial No</u>	<u>Source</u> Name

16241	Control console / generator	Kodak	2200	XGYA329	
16726	X-ray tube insert	Trophy	TRX-708	0925156	

**Radiation regulated material ID No 5768 (former registration number RR21033) (status Active)**

<u>Work Area</u>	<u>Fee</u>	<u>Type</u>	<u>Equipment</u>	<u>Purpose</u>	
	<u>Group</u>				
Surgery 1	Group A	Radiation apparatus	Dental Radiography	Dental diagnostic	
<hr/>					
Components:	<u>Type</u>	<u>Manufacturer</u>	<u>Model No</u>	<u>Serial No</u>	<u>Source</u>
					<u>Name</u>

16248	Control console / generator	Kodak	2200	XAYA179	
16381	X-ray tube insert	Trophy	TRX-708	0846103	

**Radiation regulated material ID No 16739 (status Active)**

<u>Work Area</u>	<u>Fee</u>	<u>Type</u>	<u>Equipment</u>	<u>Purpose</u>	
	<u>Group</u>				
Surgery 3	Group A	Radiation apparatus	Dental Radiography	Dental diagnostic	
Components:	<u>Type</u>	<u>Manufacturer</u>	<u>Model No</u>	<u>Serial No</u>	<u>Source</u>
					<u>Name</u>

47557	Control console / generator	Carestream	CS-2200	GBYX042	
47558	X-ray tube housing	Carestream	CS-2200	GBYX042	
47559	X-ray tube insert	CEI	OCX/65-GC	1271049	

**Radiation regulated material ID No 17138 (status Active)**

Work Area	Fee Group	Type	Equipment	Purpose
Surgery 4	Group A	Radiation apparatus	Dental Radiography	Dental diagnostic

Components:	Type	Manufacturer	Model No	Serial No	Source Name
48633	Control console / generator	Carestream	CS-2200	GHFQ020	
48634	X-ray tube housing	Carestream	CS-2200	GJXV100	
48635	X-ray tube insert	Trophy	TRX-708	181650	

Location: South Western Sydney Local Health District - LIVERPOOL - Breastscreens NSW, 102 Bigge Street, LIVERPOOL, NSW 2170

Radiation regulated material ID No 7138 (former registration number RR22682) (status Active)

<u>Work Area</u>	<u>Fee Group</u>	<u>Type</u>	<u>Equipment</u>	<u>Purpose</u>	
Localisation Room	Group B	Radiation apparatus	Mammography	Medical diagnostic	
Components:	<u>Type</u>	<u>Manufacturer</u>	<u>Model No</u>	<u>Serial No</u>	<u>Source Name</u>
20764	X-ray tube housing	Varian Medical Systems	B-110	H93300	
20765	X-ray tube insert	Varian Medical Systems	M-149	93300-N1	
20897	Control console / generator	Spellman High Voltage Electronics	Multicare Platinum	31504112727	

Radiation regulated material ID No 7607 (former registration number RR23264) (status Active)

<u>Work Area</u>	<u>Fee Group</u>	<u>Type</u>	<u>Equipment</u>	<u>Purpose</u>	
Screening Room 2	Group B	Radiation apparatus	Mammography	Medical diagnostic	
Components:	<u>Type</u>	<u>Manufacturer</u>	<u>Model No</u>	<u>Serial No</u>	<u>Source Name</u>
21996	X-ray tube housing	Varian Medical Systems	B-115	H28968	
21997	X-ray tube insert	Varian Medical Systems	M-113T	28968-N2	
22158	Control console / generator	Hologic	ASY-01966	81403121405	

Radiation regulated material ID No 7917 (former registration number RR23640) (status Active)

<u>Work Area</u>	<u>Fee</u> <u>Group</u>	<u>Type</u>	<u>Equipment</u>	<u>Purpose</u>	
Screening Room 1	Group B	Radiation apparatus	Mammography	Medical diagnostic	
Components:	<u>Type</u>	<u>Manufacturer</u>	<u>Model No</u>	<u>Serial No</u>	<u>Source</u> <u>Name</u>
23124	Control console / generator	Hologic	ASY-01966	81401121275	
23125	X-ray tube housing	Varian Medical Systems	B-115	H28601	
23126	X-ray tube insert	Varian Medical Systems	M-113T	28601-R8	

Department: Radiology



## Radiation regulated material ID No 12490 (status Active)

<u>Work Area</u>	<u>Fee Group</u>	<u>Type</u>	<u>Equipment</u>	<u>Purpose</u>
Mobile Van 1513	Group B	Radiation apparatus	Mammography	Medical diagnostic
Components:	<u>Type</u>	<u>Manufacturer</u>	<u>Model No</u>	<u>Serial No</u> <u>Source Name</u>
35478	Control console / generator	Hologic	ASY-03339	8140515479 7
35479	X-ray tube housing	Varian Medical Systems	B-115	H25717
35480	X-ray tube insert	Varian Medical Systems	M-113T	25717-P5

Location: South Western Sydney Local Health District - LIVERPOOL - Breastscreens, Unit 5, 157-161  
George Street, LIVERPOOL, NSW 2170

Department: Dentistry

## Radiation regulated material ID No 12655 (status Active)

<u>Work Area</u>	<u>Fee Group</u>	<u>Type</u>	<u>Equipment</u>	<u>Purpose</u>
Mammography Room	Group B	Radiation apparatus	Mammography	Medical diagnostic
Components:	<u>Type</u>	<u>Manufacturer</u>	<u>Model No</u>	<u>Serial No</u> <u>Source Name</u>
36136	Control console / generator	Hologic	ASY-05340	8120515507 1
36137	X-ray tube housing	Varian Medical Systems	B-115	H29115
36138	X-ray tube insert	Varian Medical Systems	M-113T	29115-Q5

Location: South Western Sydney Local Health District - LIVERPOOL - Liverpool Hospital, Corner  
Campbell and Goulburn Streets, LIVERPOOL, NSW 2170

## Radiation regulated material ID No 616 (former registration number RR11550) (status Active)

<u>Work Area</u>	<u>Fee Group</u>	<u>Type</u>	<u>Equipment</u>	<u>Purpose</u>
Pain Clinic	Group B	Radiation apparatus	Radiography / Fluoroscopy	Medical diagnostic
Components:	<u>Type</u>	<u>Manufacturer</u>	<u>Model No</u>	<u>Serial No</u> <u>Source Name</u>
9838	Control console / generator	General Electric (GE Healthcare)	Flexview 8800	7335PU3/74 35PU1
9839	X-ray tube housing	General Electric (GE Healthcare)	2299888	42424BT2
10195	X-ray tube insert	General Electric (GE Healthcare)	110/3DF	1103697

## Radiation regulated material ID No 707 (former registration number RR11703) (status Active)

<u>Work Area</u>	<u>Fee Group</u>	<u>Type</u>	<u>Equipment</u>	<u>Purpose</u>
Cath Lab 3	Group B	Radiation apparatus	Radiography / Fluoroscopy	Medical diagnostic
Components:	<u>Type</u>	<u>Manufacturer</u>	<u>Model No</u>	<u>Serial No</u> <u>Source Name</u>
10100	X-ray tube housing	Philips Healthcare	989000085142	42454M133 500
10101	X-ray tube insert	Philips Healthcare	989000004701	133500
10259	Control console / generator	Philips Healthcare	989000065022	044814

## Radiation regulated material ID No 1338 (former registration number RR12686) (status Active)

<u>Work Area</u>	<u>Fee Group</u>	<u>Type</u>	<u>Equipment</u>	<u>Purpose</u>
Mobile - Radiology Dept	Group B	Radiation apparatus	General Radiography	Medical diagnostic
Components:	<u>Type</u>	<u>Manufacturer</u>	<u>Model No</u>	<u>Serial No</u> <u>Source Name</u>
13308	Control console / generator	General Electric (GE Healthcare)	AMX 4 Plus	1012986WK 4
13309	X-ray tube insert	General Electric (GE Healthcare)	2208208	108677TX6
13637	X-ray tube housing	General Electric (GE Healthcare)	2222709	52740BC7

## Radiation regulated material ID No 1352 (former registration number RR12711) (status Active)

<u>Work Area</u>	<u>Fee Group</u>	<u>Type</u>	<u>Equipment</u>	<u>Purpose</u>
Mobile - Radiology Dept	Group B	Radiation apparatus	General Radiography	Medical diagnostic
Components:	<u>Type</u>	<u>Manufacturer</u>	<u>Model No</u>	<u>Serial No</u> <u>Source Name</u>
13410	Control console / generator	Philips Healthcare	989001083631	PCI-0239
13411	X-ray tube housing	Philips Healthcare	451213360111	03/07-3077
13412	X-ray tube insert	Philips Healthcare	X22 0.8-1.3	13F559

## Radiation regulated material ID No 3127 (former registration number RR6214) (status Active)

<u>Work Area</u>	<u>Fee Group</u>	<u>Type</u>	<u>Equipment</u>	<u>Purpose</u>
Room 12	Group B	Radiation apparatus	General Radiography	Medical diagnostic
Components:	<u>Type</u>	<u>Manufacturer</u>	<u>Model No</u>	<u>Serial No</u> <u>Source Name</u>
3836	Control console / generator	Philips Healthcare	Optimus 65	961014
3979	X-ray tube insert	Varian Medical Systems	DG-292	75897-3P
4371	X-ray tube housing	North American Imaging	ROT-350	70292/7589 7P

## Radiation regulated material ID No 3129 (former registration number RR6221) (status Active)

<u>Work Area</u>	<u>Fee Group</u>	<u>Type</u>	<u>Equipment</u>	<u>Purpose</u>
------------------	------------------	-------------	------------------	----------------

Mobile Unit	Group B	Radiation apparatus	General Radiography	Medical diagnostic
Components:	<u>Type</u>	<u>Manufacturer</u>	<u>Model No</u>	<u>Serial No</u> <u>Source Name</u>
3980	X-ray tube housing	Siemens	8463069X1426	01926S02
4297	Control console / generator	Siemens	Polymobile 2	01422S02
4298	X-ray tube insert	Siemens	1101864V1015	296109

**Radiation regulated material ID No 3130 (former registration number RR6223) (status Active)**

<u>Work Area</u>	<u>Fee Group</u>	<u>Type</u>	<u>Equipment</u>	<u>Purpose</u>
Room 11	Group B	Radiation apparatus	General Radiography	Medical diagnostic
Components:	<u>Type</u>	<u>Manufacturer</u>	<u>Model No</u>	<u>Serial No</u> <u>Source Name</u>
3981	X-ray tube housing	Varian Medical Systems	PG-202	H48394
3982	X-ray tube insert	Varian Medical Systems	ROT-350	97653-01
4373	Control console / generator	Philips Healthcare	Optimus 65	961052

**Radiation regulated material ID No 3131 (former registration number RR6226) (status Active)**

<u>Work Area</u>	<u>Fee Group</u>	<u>Type</u>	<u>Equipment</u>	<u>Purpose</u>
Mobile Unit - ICU	Group B	Radiation apparatus	General Radiography	Medical diagnostic
Components:	<u>Type</u>	<u>Manufacturer</u>	<u>Model No</u>	<u>Serial No</u> <u>Source Name</u>
3897	X-ray tube insert	General Electric (GE Healthcare)	RAD-10	31772-P2
4374	Control console / generator	General Electric (GE Healthcare)	2169368-2	534080WK7
4375	X-ray tube housing	General Electric (GE Healthcare)	AMX-4	H210796

**Radiation regulated material ID No 4997 (status Active)**

<u>Work Area</u>	<u>Fee Group</u>	<u>Type</u>	<u>Equipment</u>	<u>Purpose</u>
Room 2291 - International Radiology	Group B	Radiation apparatus	Radiography / Fluoroscopy	Medical diagnostic
Components:	<u>Type</u>	<u>Manufacturer</u>	<u>Model No</u>	<u>Serial No</u> <u>Source Name</u>
14233	Control console / generator	Siemens	Zeego Q	117019
14374	X-ray tube housing	Siemens	Gigalix	611081471
14375	X-ray tube insert	Siemens	Gigalix	629021472

**Radiation regulated material ID No 6563 (former registration number RR21996) (status Active)**

<u>Work Area</u>	<u>Fee Group</u>	<u>Type</u>	<u>Equipment</u>	<u>Purpose</u>
Room A132	Group B	Radiation apparatus	General Radiography	Medical diagnostic
Components:	<u>Type</u>	<u>Manufacturer</u>	<u>Model No</u>	<u>Serial No</u> <u>Source Name</u>

18889	Control console / generator	CMP	VZW2556RQ2-0	CPD07224F
			2	10
18954	X-ray tube housing	Varian Medical Systems	B-130H	H75067
18955	X-ray tube insert	Varian Medical Systems	RAD-60	75067-50

## Radiation regulated material ID No 6572 (former registration number RR22009) (status Active)

<u>Work Area</u>	<u>Fee Group</u>	<u>Type</u>	<u>Equipment</u>	<u>Purpose</u>
Room 2280	Group B	Radiation apparatus	Computed Tomography	Medical diagnostic
Components:	<u>Type</u>	<u>Manufacturer</u>	<u>Model No</u>	<u>Serial No</u> <u>Source Name</u>
18894	X-ray tube housing	Siemens	Straton	755231094
18992	Control console / generator	Siemens	Definition AS	64888
18993	X-ray tube insert	Siemens	Straton	755231094

## Radiation regulated material ID No 6573 (former registration number RR22010) (status Active)

<u>Work Area</u>	<u>Fee Group</u>	<u>Type</u>	<u>Equipment</u>	<u>Purpose</u>
Room 2282	Group B	Radiation apparatus	Radiography / Fluoroscopy	Medical diagnostic
Components:	<u>Type</u>	<u>Manufacturer</u>	<u>Model No</u>	<u>Serial No</u> <u>Source Name</u>
18895	Control console / generator	Siemens	Artis Z Biplane	153737
18896	X-ray tube housing	Siemens	10145086	703451292
18897	X-ray tube insert	Siemens	10144179	900471205

## Radiation regulated material ID No 6709 (former registration number RR22180) (status Active)

<u>Work Area</u>	<u>Fee Group</u>	<u>Type</u>	<u>Equipment</u>	<u>Purpose</u>
Room 2219	Group B	Radiation apparatus	Radiography / Fluoroscopy	Medical diagnostic
Components:	<u>Type</u>	<u>Manufacturer</u>	<u>Model No</u>	<u>Serial No</u> <u>Source Name</u>
19314	Control console / generator	Siemens	Astis Zeego	160352
19315	X-ray tube housing	Siemens	10144184	619151272
19593	X-ray tube insert	Siemens	10144179	68911274

## Radiation regulated material ID No 7069 (former registration number RR22605) (status Active)

<u>Work Area</u>	<u>Fee Group</u>	<u>Type</u>	<u>Equipment</u>	<u>Purpose</u>
X-Ray Room 4	Group B	Radiation apparatus	General Radiography	Medical diagnostic
Components:	<u>Type</u>	<u>Manufacturer</u>	<u>Model No</u>	<u>Serial No</u> <u>Source Name</u>
20275	X-ray tube insert	Varian Medical Systems	RAD-60	47595-WZ
20322	Control console / generator	Carestream	VZW2556RD2-0	CPD08612C
			2	11
20695	X-ray tube housing	Varian Medical Systems	B-130H	H47595

**Radiation regulated material ID No 7070 (former registration number RR22606) (status Active)**

<u>Work Area</u>	<u>Fee Group</u>	<u>Type</u>	<u>Equipment</u>	<u>Purpose</u>	
General Room 5	Group B	Radiation apparatus	General Radiography	Medical diagnostic	
Components:	<u>Type</u>	<u>Manufacturer</u>	<u>Model No</u>	<u>Serial No</u>	<u>Source Name</u>
20431	X-ray tube insert	Varian Medical Systems	RAD-60	22549-Y1	
20605	Control console / generator	Carestream	BZW2556RD2-02	CPD08624C11	
20696	X-ray tube housing	Varian Medical Systems	B-130H	H22549	

**Radiation regulated material ID No 7119 (former registration number RR22658) (status Active)**

<u>Work Area</u>	<u>Fee Group</u>	<u>Type</u>	<u>Equipment</u>	<u>Purpose</u>	
Flouroscopy Room 15	Group B	Radiation apparatus	Radiography / Fluoroscopy	Medical diagnostic	
Components:	<u>Type</u>	<u>Manufacturer</u>	<u>Model No</u>	<u>Serial No</u>	<u>Source Name</u>
20376	X-ray tube insert	Toshiba	DSR-T7545G	OJ704	
20652	Control console / generator	Toshiba	KXO-80Z	U1A1152127	
20653	X-ray tube housing	Toshiba	DSRX-T7545GF	11D701	

**Radiation regulated material ID No 7580 (former registration number RR23236) (status Active)**

<u>Work Area</u>	<u>Fee Group</u>	<u>Type</u>	<u>Equipment</u>	<u>Purpose</u>	
Bunker M6 - Cancer Therapy Centre	Group B	Radiation apparatus	Linear Accelerator	Radiotherapy	
Components:	<u>Type</u>	<u>Manufacturer</u>	<u>Model No</u>	<u>Serial No</u>	<u>Source Name</u>
22080	Control console / generator	Accuray	Hi-Art	10403	

**Radiation regulated material ID No 7774 (former registration number RR23478) (status Active)**

<u>Work Area</u>	<u>Fee</u>	<u>Type</u>	<u>Equipment</u>	<u>Purpose</u>	
	<u>Group</u>				
CT Room 1	Group B	Radiation apparatus	Computed Tomography	Medical diagnostic	
Components:	<u>Type</u>	<u>Manufacturer</u>	<u>Model No</u>	<u>Serial No</u>	<u>Source</u>
					<u>Name</u>
22710	Control console / generator	Siemens	Somatom	65994	
22711	X-ray tube housing	Siemens	10141785	605081274	
22712	X-ray tube insert	Siemens	10141785	XRTMX0002	

**Radiation regulated material ID No 7833 (former registration number RR23545) (status Active)**

<u>Work Area</u>	<u>Fee Group</u>	<u>Type</u>	<u>Equipment</u>	<u>Purpose</u>
General Room 1	Group B	Radiation apparatus	General Radiography	Medical diagnostic

Components:	Type	Manufacturer	Model No	Serial No	Source Name
22746	Control console / generator	Philips Healthcare	989001088391	12-F0039	
22747	X-ray tube housing	Philips Healthcare	989000086101	35932A240778	
22771	X-ray tube insert	Philips Healthcare	980620670102	240778	

**Radiation regulated material ID No 7834 (former registration number RR23546) (status Active)**

<u>Work Area</u>	<u>Fee Group</u>	<u>Type</u>	<u>Equipment</u>	<u>Purpose</u>	
Mobile Unit	Group B	Radiation apparatus	General Radiography	Medical diagnostic	
Components:	<u>Type</u>	<u>Manufacturer</u>	<u>Model No</u>	<u>Serial No</u>	<u>Source Name</u>
22396	Control console / generator	DRX Revolution	VZW2559RH11-YY	MBL00188H12	
22748	X-ray tube housing	Varian Medical Systems	DIA-150-KV	H30336	
22772	X-ray tube insert	Varian Medical Svstems	RAD-68	30336-P2	

**Radiation regulated material ID No 7835 (former registration number RR23547) (status Active)**

<u>Work Area</u>	<u>Fee Group</u>	<u>Type</u>	<u>Equipment</u>	<u>Purpose</u>	
Mobile Unit	Group B	Radiation apparatus	General Radiography	Medical diagnostic	
Components:	<u>Type</u>	<u>Manufacturer</u>	<u>Model No</u>	<u>Serial No</u>	<u>Source Name</u>
22499	Control console / generator	DRX Revolution	VZW2559RH11-YY	MBL00186G12	
22749	X-ray tube housing	Varian Medical Systems	DIA-150-KV	H27508	
22750	X-ray tube insert	Varian Medical Systems	RAD-68	27508-M2	

**Radiation regulated material ID No 7887 (former registration number RR23606) (status Active)**

<u>Work Area</u>	<u>Fee</u> <u>Group</u>	<u>Type</u>	<u>Equipment</u>	<u>Purpose</u>	
Mobile Unit	Group B	Radiation apparatus	General Radiography	Medical diagnostic	
Components:	<u>Type</u>	<u>Manufacturer</u>	<u>Model No</u>	<u>Serial No</u>	<u>Source</u> <u>Name</u>
22822	Control console / generator	Philips Healthcare	989001089521	12000065	
23100	X-ray tube housing	Philips Healthcare	E7886X	12B824	
23101	X-ray tube insert	Philips Healthcare	E7886	2B182	

**Radiation regulated material ID No 8452 (status Active)**

<u>Work Area</u>	<u>Fee</u>	<u>Type</u>	<u>Equipment</u>	<u>Purpose</u>	
	<u>Group</u>				
Ground Floor, New Clinical Building GA240	Group B	Radiation apparatus	Computed Tomography	Medical diagnostic	
<hr/>					
Components:	<u>Type</u>	<u>Manufacturer</u>	<u>Model No</u>	<u>Serial No</u>	<u>Source</u>
					<u>Name</u>

24570	Control console / generator	General Electric (GE Healthcare)	Discovery PET/CT 710	12473PT5
24571	X-ray tube housing	General Electric (GE Healthcare)	2137130-11	82374BC0
24572	X-ray tube insert	General Electric (GE Healthcare)	2120785-2	164935GI9

## Radiation regulated material ID No 8454 (status Active)

<u>Work Area</u>	<u>Fee Group</u>	<u>Type</u>	<u>Equipment</u>	<u>Purpose</u>
CT - Cancer Therapy Centre	Group B	Radiation apparatus	Simulator/CT	Radiotherapy
Components:	<u>Type</u>	<u>Manufacturer</u>	<u>Model No</u>	<u>Serial No</u> <u>Source Name</u>
	24443	Control console / generator	Philips Healthcare	Big Bone CT 7914
	24444	X-ray tube housing	Philips Healthcare	989000085921 41885M132 926
	24445	X-ray tube insert	Philips Healthcare	989000085911 132926

## Radiation regulated material ID No 9321 (former registration number RR9724) (status Active)

<u>Work Area</u>	<u>Fee Group</u>	<u>Type</u>	<u>Equipment</u>	<u>Purpose</u>
Bunker - Orthobrachy	Group C	Sealed source device	Therapy Device (Brachytherapy & others)	
Components:	<u>Type</u>	<u>Manufacturer</u>	<u>Model No</u>	<u>Serial No</u> <u>Source Name</u>
	25795	Container	Nucletron	Microselectron V3 20053
	28097	Sealed source	Mallinckrodt	D36H0018 iridium-192

## Radiation regulated material ID No 10396 (status Active)

<u>Work Area</u>	<u>Fee Group</u>	<u>Type</u>	<u>Equipment</u>	<u>Purpose</u>
OPG - Room 14	Group A	Radiation apparatus	Panoramic Radiography	Dental diagnostic
Components:	<u>Type</u>	<u>Manufacturer</u>	<u>Model No</u>	<u>Serial No</u> <u>Source Name</u>
	29785	Control console / generator	Carestream	CS-9000 CSBG001
	29786	X-ray tube housing	Toshiba	CU-241 CFX064
	29787	X-ray tube insert	Toshiba	D-054 29992

## Radiation regulated material ID No 10718 (former registration number RR20133) (status Active)

<u>Work Area</u>	<u>Fee Group</u>	<u>Type</u>	<u>Equipment</u>	<u>Purpose</u>
Level 2 Operating Theatres	Group B	Radiation apparatus	Radiography / Fluoroscopy	Medical diagnostic
Components:	<u>Type</u>	<u>Manufacturer</u>	<u>Model No</u>	<u>Serial No</u> <u>Source Name</u>
	30598	X-ray tube housing	Philips Healthcare	452212905322 040006002
	30599	Control console / generator	Philips Healthcare	989600193512 000093
	30600	X-ray tube insert	Philips Healthcare	R0-0306 217589



## Radiation regulated material ID No 10731 (former registration number RR20156) (status Active)

<u>Work Area</u>	<u>Fee Group</u>	<u>Type</u>	<u>Equipment</u>	<u>Purpose</u>
Level 2 Operating Theatres	Group B	Radiation apparatus	Radiography / Fluoroscopy	Medical diagnostic
Components:	<u>Type</u>	<u>Manufacturer</u>	<u>Model No</u>	<u>Serial No</u>
				<u>Source Name</u>
30630	Control console / generator	Philips Healthcare	989600193512	000099
30631	X-ray tube housing	Philips Healthcare	452212905322	041700014
30632	X-ray tube insert	Philips Healthcare	RO-0306	219848

## Radiation regulated material ID No 10812 (former registration number RR20296) (status Active)

<u>Work Area</u>	<u>Fee Group</u>	<u>Type</u>	<u>Equipment</u>	<u>Purpose</u>
Bunker 1	Group B	Radiation apparatus	Linear Accelerator	Radiotherapy
Components:	<u>Type</u>	<u>Manufacturer</u>	<u>Model No</u>	<u>Serial No</u>
				<u>Source Name</u>
30860	Control console / generator	Elekta	Synergy	151693
30861	X-ray tube housing	Elekta	Synergy	701211AM
30862	X-ray tube insert	Dunlee	DA1094CSEL	74309

## Radiation regulated material ID No 10886 (former registration number RR22334) (status Active)

<u>Work Area</u>	<u>Fee Group</u>	<u>Type</u>	<u>Equipment</u>	<u>Purpose</u>
CCL Lab 1	Group B	Radiation apparatus	Radiography / Fluoroscopy	Medical diagnostic
Components:	<u>Type</u>	<u>Manufacturer</u>	<u>Model No</u>	<u>Serial No</u>
				<u>Source Name</u>
31055	X-ray tube insert	Philips Healthcare	989000004701	120900
31056	X-ray tube insert	Philips Healthcare	989000004701	120726
31057	X-ray tube housing	Philips Healthcare	989000085142	30173M120
				962
31058	X-ray tube housing	Philips Healthcare	989000085142	30114M120
				900
31059	Control console / generator	Philips Healthcare	451220400071	10130134/1
				0130176

## Radiation regulated material ID No 13322 (status Active)

<u>Work Area</u>	<u>Fee Group</u>	<u>Type</u>	<u>Equipment</u>	<u>Purpose</u>
CCL Lab 4	Group B	Radiation apparatus	Radiography / Fluoroscopy	Medical diagnostic
Components:	<u>Type</u>	<u>Manufacturer</u>	<u>Model No</u>	<u>Serial No</u>
				<u>Source Name</u>
38004	Control console / generator	Siemens	10092631	1458
38005	X-ray tube housing	Siemens	10144181	738411593
38006	X-ray tube insert	Siemens	10144177	942251506

## Radiation regulated material ID No 13517 (status Active)

<u>Work Area</u>	<u>Fee Group</u>	<u>Type</u>	<u>Equipment</u>	<u>Purpose</u>
------------------	------------------	-------------	------------------	----------------

Mobile Unit	Group B	Radiation apparatus	General Radiography	Medical diagnostic
Components:	<u>Type</u>	<u>Manufacturer</u>	<u>Model No</u>	<u>Serial No</u> <u>Source Name</u>
38412	Control console / generator	Carestream	DRXR-1	2101
38413	X-ray tube housing	Varian Medical Systems	DIA-150KV	H45609
38414	X-ray tube insert	Varian Medical Systems	RAD-68	45609-Y5

**Radiation regulated material ID No 13590 (status Active)**

<u>Work Area</u>	<u>Fee Group</u>	<u>Type</u>	<u>Equipment</u>	<u>Purpose</u>
Ground Floor, New Clinical Building - GA251	Group B	Radiation apparatus	PET/SPECT - CT X-ray	Medical diagnostic
Components:	<u>Type</u>	<u>Manufacturer</u>	<u>Model No</u>	<u>Serial No</u> <u>Source Name</u>
38594	Control console / generator	General Electric (GE Healthcare)	OPTIMA H3100-YC	25270
38595	X-ray tube housing	General Electric (GE Healthcare)	2232785-2	112123BC5
38596	X-ray tube insert	General Electric (GE Healthcare)	46-274891G1	107739BI5

**Radiation regulated material ID No 13600 (status Active)**

<u>Work Area</u>	<u>Fee Group</u>	<u>Type</u>	<u>Equipment</u>	<u>Purpose</u>
TMT Room 4	Group B	Radiation apparatus	Kilovoltage Therapy X-Ray	Radiotherapy
Components:	<u>Type</u>	<u>Manufacturer</u>	<u>Model No</u>	<u>Serial No</u> <u>Source Name</u>
38623	Control console / generator	Gulmay	CP225-1/29	2717-0316
38624	X-ray tube housing	Comet	MXR-226	582753
38625	X-ray tube insert	Comet	MXR-226	582753

**Radiation regulated material ID No 14991 (status Active)**

<u>Work Area</u>	<u>Fee Group</u>	<u>Type</u>	<u>Equipment</u>	<u>Purpose</u>
Level 3 - Chest Clinic	Group B	Radiation apparatus	General Radiography	Medical diagnostic
Components:	<u>Type</u>	<u>Manufacturer</u>	<u>Model No</u>	<u>Serial No</u> <u>Source Name</u>
42539	Control console / generator	Carestream	Ascend	QG50SE-17 R0203
42540	X-ray tube housing	Toshiba	Rotanode E7252	16K1015
42541	X-ray tube insert	Toshiba	E7252	6K127

**Radiation regulated material ID No 14993 (status Active)**

<u>Work Area</u>	<u>Fee Group</u>	<u>Type</u>	<u>Equipment</u>	<u>Purpose</u>
Bunker M7, Cancer Therapy Centre	Group B	Radiation apparatus	Linear Accelerator	Radiotherapy

Components:	Type	Manufacturer	Model No	Serial No	Source Name
42545	Control console / generator	Elekta	Vers HD	109003	
42546	X-ray tube housing	Dunlee	DA-1094	50950A2533	
				08	
42547	X-ray tube insert	Dunlee	DU-694	253308	

**Radiation regulated material ID No 15633 (status Active)**

<u>Work Area</u>	<u>Fee Group</u>	<u>Type</u>	<u>Equipment</u>	<u>Purpose</u>	
Surgery 5	Group A	Radiation apparatus	Dental Radiography	Dental diagnostic	
Components:	<u>Type</u>	<u>Manufacturer</u>	<u>Model No</u>	<u>Serial No</u>	<u>Source Name</u>
44608	Control console / generator	Carestream	CS-2200	EEYO254	
44609	X-ray tube housing	Carestream	CS-2200	EEYO254	
44610	X-ray tube insert	Trophy	TRX-708	1614049	

**Radiation regulated material ID No 15634 (status Active)**

<u>Work Area</u>	<u>Fee Group</u>	<u>Type</u>	<u>Equipment</u>	<u>Purpose</u>	
Surgery 6	Group A	Radiation apparatus	Dental Radiography	Dental diagnostic	
Components:	<u>Type</u>	<u>Manufacturer</u>	<u>Model No</u>	<u>Serial No</u>	<u>Source Name</u>
44611	Control console / generator	Carestream	CS-2200	EEYO125	
44612	X-ray tube housing	Carestream	CS-2200	EEYO125	
44613	X-ray tube insert	Trophy	TRX-708	1549111	

**Radiation regulated material ID No 15635 (status Active)**

<u>Work Area</u>	<u>Fee Group</u>	<u>Type</u>	<u>Equipment</u>	<u>Purpose</u>	
Surgery 7	Group A	Radiation apparatus	Dental Radiography	Dental diagnostic	
Components:	<u>Type</u>	<u>Manufacturer</u>	<u>Model No</u>	<u>Serial No</u>	<u>Source Name</u>
44614	Control console / generator	Carestream	CS-2200	EEYO243	
44615	X-ray tube housing	Carestream	CS-2200	EEYO243	
44616	X-ray tube insert	Trophy	TRX-708	1615025	

**Radiation regulated material ID No 15636 (status Active)**

<u>Work Area</u>	<u>Fee</u> <u>Group</u>	<u>Type</u>	<u>Equipment</u>	<u>Purpose</u>	
Surgery 8	Group A	Radiation apparatus	Dental Radiography	Dental diagnostic	
Components:	<u>Type</u>	<u>Manufacturer</u>	<u>Model No</u>	<u>Serial No</u>	<u>Source</u> <u>Name</u>
44617	Control console / generator	Carestream	CS-2200	EEYO238	
44618	X-ray tube housing	Carestream	CS-2200	EEYO238	
44619	X-ray tube insert	Trophy	TRX-708	1614092	

**Radiation regulated material ID No 16503 (status Active)**

<u>Work Area</u>	<u>Fee</u> <u>Group</u>	<u>Type</u>	<u>Equipment</u>	<u>Purpose</u>	
Surgery 4	Group A	Radiation apparatus	Dental Radiography	Dental diagnostic	
Components:	<u>Type</u>	<u>Manufacturer</u>	<u>Model No</u>	<u>Serial No</u>	<u>Source</u> <u>Name</u>
46875	Control console / generator	De Gotzen	X Genus AC	303337	
46876	X-ray tube housing	De Gotzen	CE-0434	303337	
46877	X-ray tube insert	Toshiba	DG-073B-DC	10382	

**Radiation regulated material ID No 16737 (status Active)**

<u>Work Area</u>	<u>Fee Group</u>	<u>Type</u>	<u>Equipment</u>	<u>Purpose</u>	
CT Room	Group B	Radiation apparatus	Computed Tomography	Medical diagnostic	
Components:	<u>Type</u>	<u>Manufacturer</u>	<u>Model No</u>	<u>Serial No</u>	<u>Source Name</u>
47551	Control console / generator	General Electric (GE Healthcare)	Revolution	83179606020	
47552	X-ray tube housing	General Electric (GE Healthcare)	Perfomrix	61578GM1	
47553	X-ray tube insert	General Electric (GE Healthcare)	5402799	214491GI3	

**Radiation regulated material ID No 16741 (status Active)**

<u>Work Area</u>	<u>Fee</u>	<u>Type</u>	<u>Equipment</u>	<u>Purpose</u>	
	<u>Group</u>				
Surgery 3	Group A	Radiation apparatus	Dental Radiography	Dental diagnostic	
Components:	<u>Type</u>	<u>Manufacturer</u>	<u>Model No</u>	<u>Serial No</u>	<u>Source</u>
					<u>Name</u>
47563	Control console / generator	Trophy	Elitys	9949J0017	
47564	X-ray tube housing	Trophy	TR-1	QGXB276	
47565	X-ray tube insert	Trophy	TRX-708	222171	

**Radiation regulated material ID No 17529 (status Active)**

<u>Work Area</u>	<u>Fee Group</u>	<u>Type</u>	<u>Equipment</u>	<u>Purpose</u>	
Mobile Unit	Group B	Radiation apparatus	Radiography / Fluoroscopy	Medical diagnostic	
Components:	<u>Type</u>	<u>Manufacturer</u>	<u>Model No</u>	<u>Serial No</u>	<u>Source Name</u>
49763	Control console / generator	Philips Healthcare	Veradius Unity	1603	
49764	X-ray tube housing	Philips Healthcare	10457100	063130003	
49765	X-ray tube insert	Philips Healthcare	RO-0306	82V149	

**Radiation regulated material ID No 17530 (status Active)**

<u>Work Area</u>	<u>Fee Group</u>	<u>Type</u>	<u>Equipment</u>	<u>Purpose</u>
Mobile Unit	Group B	Radiation apparatus	Radiography / Fluoroscopy	Medical diagnostic
Components:	<u>Type</u>	<u>Manufacturer</u>	<u>Model No</u>	<u>Serial No</u> <u>Source Name</u>

49766	Control console / generator	Philips Healthcare	Veradius Unity	1604
49767	X-ray tube housing	Philips Healthcare	10457100	063952003
49768	X-ray tube insert	Philips Healthcare	RO-0306	82V355

## Department: Dentistry

## Radiation regulated material ID No 11972 (status Active)

<u>Work Area</u>	<u>Fee Group</u>	<u>Type</u>	<u>Equipment</u>	<u>Purpose</u>
Surgery 2	Group A	Radiation apparatus	Dental Radiography	Dental diagnostic
Components:	<u>Type</u>	<u>Manufacturer</u>	<u>Model No</u>	<u>Serial No</u> <u>Source Name</u>
34050	Control console / generator	Carestream	CS-2200	BKYO369
34051	X-ray tube housing	Carestream	TR-1	BKYO369
34052	X-ray tube insert	Trophy	TRX-708	1345201

## Radiation regulated material ID No 12530 (status Active)

<u>Work Area</u>	<u>Fee Group</u>	<u>Type</u>	<u>Equipment</u>	<u>Purpose</u>
Surgery 1	Group A	Radiation apparatus	Dental Radiography	Dental diagnostic
Components:	<u>Type</u>	<u>Manufacturer</u>	<u>Model No</u>	<u>Serial No</u> <u>Source Name</u>
35595	Control console / generator	Trophy	Eliltys	9949J0041
35596	X-ray tube housing	Trophy	TR-1	XBOA102
35597	X-ray tube insert	Trophy	TRX-708	949033

## Department: Nuclear Medicine

## Radiation regulated material ID No 9953 (former registration number RR10034) (status Active)

<u>Work Area</u>	<u>Fee Group</u>	<u>Type</u>	<u>Equipment</u>	<u>Purpose</u>
Basement Storage Facility	Group B	Unsealed radioactive substance		Nuclear medicine public facility
Components:	<u>Type</u>	<u>Manufacturer</u>	<u>Model No</u>	<u>Serial No</u> <u>Source Name</u>

## Radiation regulated material ID No 9955 (former registration number RR10035) (status Active)

<u>Work Area</u>	<u>Fee Group</u>	<u>Type</u>	<u>Equipment</u>	<u>Purpose</u>
Scanning rooms and Cold Lab	Group B	Unsealed radioactive substance		Nuclear medicine public facility
Components:	<u>Type</u>	<u>Manufacturer</u>	<u>Model No</u>	<u>Serial No</u> <u>Source Name</u>

## Radiation regulated material ID No 9959 (former registration number RR10036) (status Active)

<u>Work Area</u>	<u>Fee Group</u>	<u>Type</u>	<u>Equipment</u>	<u>Purpose</u>
------------------	------------------	-------------	------------------	----------------

Therapy Rooms	Group B	Unsealed radioactive substance			Nuclear medicine public facility
Components:	<u>Type</u>	<u>Manufacturer</u>	<u>Model No</u>	<u>Serial No</u>	<u>Source Name</u>

## Radiation regulated material ID No 9963 (former registration number RR10037) (status Active)

<u>Work Area</u>	<u>Fee</u>	<u>Type</u>	<u>Equipment</u>	<u>Purpose</u>	
	<u>Group</u>				
Hot Lab	Group B	Unsealed radioactive substance		Nuclear medicine public facility	
<hr/>					
Components:	<u>Type</u>	<u>Manufacturer</u>	<u>Model No</u>	<u>Serial No</u>	<u>Source Name</u>

## Radiation regulated material ID No 10677 (former registration number RR20040) (status Active)

<u>Work Area</u>	<u>Fee Group</u>	<u>Type</u>	<u>Equipment</u>	<u>Purpose</u>	
Ground Floor, New Clinical Building - GA222	Group B	Radiation apparatus	Bone Mineral Densitometry	Medical diagnostic	
<hr/>					
Components:	<u>Type</u>	<u>Manufacturer</u>	<u>Model No</u>	<u>Serial No</u>	<u>Source Name</u>
30500	Control console / generator	Lunar	Prodigy	302399	
30501	X-ray tube housing	Lunar	8743	73710	
30502	X-ray tube insert	Brand (Thermo Fisher Scientific)	BXIL	P097	

## Department: Radiology

## Radiation regulated material ID No 6438 (former registration number RR21833) (status Active)

<u>Work Area</u>	<u>Fee Group</u>	<u>Type</u>	<u>Equipment</u>	<u>Purpose</u>	
Bunker M2 - Cancer Therapy Centre	Group B	Radiation apparatus	LINAC with Fluoroscopy	Radiotherapy	
Components:	<u>Type</u>	<u>Manufacturer</u>	<u>Model No</u>	<u>Serial No</u>	<u>Source Name</u>
18642	Control console / generator	Elekta	Synergy	152131	
46763	X-ray tube housing	Dunlee	DA1084-DU694	9816055809	
46764	X-ray tube insert	Dunlee	DU-694	253293	

## Radiation regulated material ID No 11980 (status Active)

<u>Work Area</u>	<u>Fee Group</u>	<u>Type</u>	<u>Equipment</u>	<u>Purpose</u>	
State Mobile Van 15-03	Group B	Radiation apparatus	Mammography	Medical diagnostic	
Components:	<u>Type</u>	<u>Manufacturer</u>	<u>Model No</u>	<u>Serial No</u>	<u>Source Name</u>

34076	Control console / generator	Hologic	ASY-03339	8141114414 5
34077	X-ray tube housing	Varian Medical Systems	B-115	H14223
34078	X-ray tube insert	Varian Medical Systems	M-113T	14223-W4

## Radiation regulated material ID No 12097 (status Active)

<u>Work Area</u>	<u>Fee Group</u>	<u>Type</u>	<u>Equipment</u>	<u>Purpose</u>
Ground Floor, New Clinical Building - GA247	Group B	Radiation apparatus	PET/SPECT - CT X-ray	Medical diagnostic

Components:	<u>Type</u>	<u>Manufacturer</u>	<u>Model No</u>	<u>Serial No</u>	<u>Source Name</u>
34391	Control console / generator	General Electric (GE Healthcare)	Discovery 670	250604HM6	
34392	X-ray tube housing	General Electric (GE Healthcare)	2137130-2	71767BC8	
34393	X-ray tube insert	General Electric (GE Healthcare)	2120785-2	65718B79	

## Radiation regulated material ID No 12098 (status Active)

<u>Work Area</u>	<u>Fee Group</u>	<u>Type</u>	<u>Equipment</u>	<u>Purpose</u>
Ground Floor, New Clinical Building - GA246	Group B	Radiation apparatus	PET/SPECT - CT X-ray	Medical diagnostic

Components:	<u>Type</u>	<u>Manufacturer</u>	<u>Model No</u>	<u>Serial No</u>	<u>Source Name</u>
34394	Control console / generator	General Electric (GE Healthcare)	Discovery 670	142029WG8	
34395	X-ray tube housing	General Electric (GE Healthcare)	2137130-2	71767BC2	
34396	X-ray tube insert	General Electric (GE Healthcare)	2120785-2	71414BI7	

Location: South Western Sydney Local Health District - NARELLAN - Narellan Oral Health Clinic, 14 Queen Street, NARELLAN, NSW 2567

## Radiation regulated material ID No 14994 (status Active)

<u>Work Area</u>	<u>Fee Group</u>	<u>Type</u>	<u>Equipment</u>	<u>Purpose</u>
Surgery 2	Group A	Radiation apparatus	Dental Radiography	Dental diagnostic

Components:	<u>Type</u>	<u>Manufacturer</u>	<u>Model No</u>	<u>Serial No</u>	<u>Source Name</u>
42548	Control console / generator	Carestream	CS-2200	FBYO110	
42549	X-ray tube housing	Carestream	CS-2200	FBYO110	
42550	X-ray tube insert	Trophy	TRX-708	1650106	



## Radiation regulated material ID No 14996 (status Active)

<u>Work Area</u>	<u>Fee Group</u>	<u>Type</u>	<u>Equipment</u>	<u>Purpose</u>
Surgery 1	Group A	Radiation apparatus	Dental Radiography	Dental diagnostic
Components:	<u>Type</u>	<u>Manufacturer</u>	<u>Model No</u>	<u>Serial No</u> <u>Source Name</u>
	42554	Control console / generator	Carestream	CS-2200 EE0122
	42555	X-ray tube housing	Carestream	CS-2200 EE0122
	42556	X-ray tube insert	Trophy	TRX-708 1650009

## Radiation regulated material ID No 14998 (status Active)

<u>Work Area</u>	<u>Fee Group</u>	<u>Type</u>	<u>Equipment</u>	<u>Purpose</u>
Surgery 3	Group A	Radiation apparatus	Dental Radiography	Dental diagnostic
Components:	<u>Type</u>	<u>Manufacturer</u>	<u>Model No</u>	<u>Serial No</u> <u>Source Name</u>
	42560	Control console / generator	Carestream	CS-2200 FBYO125
	42561	X-ray tube housing	Carestream	CS-2200 FBYO125
	42562	X-ray tube insert	Trophy	TRX-708 1650117

Location: South Western Sydney Local Health District - PRAIRIEWOOD - Fairfield Oral Health Clinic,  
Corner Polding Street and Prairievale Road, PRAIRIEWOOD, NSW 2176

## Radiation regulated material ID No 324 (former registration number RR11037) (status Active)

<u>Work Area</u>	<u>Fee Group</u>	<u>Type</u>	<u>Equipment</u>	<u>Purpose</u>
Child Surgery 2	Group A	Radiation apparatus	Dental Radiography	Dental diagnostic
Components:	<u>Type</u>	<u>Manufacturer</u>	<u>Model No</u>	<u>Serial No</u> <u>Source Name</u>
	9032	Control console / generator	De Gotzen	X Genus DC D02104
	9033	X-ray tube housing	De Gotzen	CE0434 D02104
	9034	X-ray tube insert	Toshiba	DG-073B-DC 25963

## Radiation regulated material ID No 2528 (former registration number RR4085) (status Active)

<u>Work Area</u>	<u>Fee Group</u>	<u>Type</u>	<u>Equipment</u>	<u>Purpose</u>
Child Surgery 5	Group A	Radiation apparatus	Dental Radiography	Dental diagnostic
Components:	<u>Type</u>	<u>Manufacturer</u>	<u>Model No</u>	<u>Serial No</u> <u>Source Name</u>
	2558	Control console / generator	Trophy	CCX C7909128
	2559	X-ray tube housing	Trophy	708G 730190
	2560	X-ray tube insert	Trophy	OCX-65G 260551

## Radiation regulated material ID No 4461 (former registration number RR8925) (status Active)

<u>Work Area</u>	<u>Fee Group</u>	<u>Type</u>	<u>Equipment</u>	<u>Purpose</u>
Adult Surgery 4	Group A	Radiation apparatus	Dental Radiography	Dental diagnostic

Components:	Type	Manufacturer	Model No	Serial No	Source Name
6770	Control console / generator	De Gotzen	X-Mind	27080	
6771	X-ray tube housing	De Gotzen	Image X	23041	
6772	X-ray tube insert	Toshiba	DG-073B	35322	

**Radiation regulated material ID No 4462 (former registration number RR8926) (status Active)**

Work Area	Fee Group	Type	Equipment	Purpose
Adult Surgery 8	Group A	Radiation apparatus	Dental Radiography	Dental diagnostic

Components:	Type	Manufacturer	Model No	Serial No	Source Name
6774	X-ray tube housing	De Gotzen	CE-0434	07830496	
6775	X-ray tube insert	Toshiba	DG-073B-AC	13519	
7082	Control console / generator	De Gotzen	X-Mind	27079	

**Radiation regulated material ID No 4566 (former registration number RR9108) (status Active)**

Work Area	Fee Group	Type	Equipment	Purpose
Adult Surgery 6	Group A	Radiation apparatus	Dental Radiography	Dental diagnostic

Components:	Type	Manufacturer	Model No	Serial No	Source Name
7205	Control console / generator	De Gotzen	X Genus DC	D00338	
7242	X-ray tube housing	De Gotzen	CE-0434	D00338	
7243	X-ray tube insert	Toshiba	DG-073B-DC	11653	

**Radiation regulated material ID No 4567 (former registration number RR9109) (status Active)**

Work Area	Fee Group	Type	Equipment	Purpose
Adult Surgery 7	Group A	Radiation apparatus	Dental Radiography	Dental diagnostic

Components:	Type	Manufacturer	Model No	Serial No	Source Name
7206	X-ray tube insert	Toshiba	DG-073B-DC	10052	
7244	Control console / generator	De Gotzen	X Genus DC	D00278	
7245	X-ray tube housing	De Gotzen	CE-0434	D00278	

**Radiation regulated material ID No 4722 (former registration number RR9382) (status Active)**

Work Area	Fee Group	Type	Equipment	Purpose
Adult -OPG Room	Group A	Radiation apparatus	Panoramic Radiography	Dental diagnostic

Components:	Type	Manufacturer	Model No	Serial No	Source Name
7408	Control console / generator	De Gotzen	X Genus DC	D00342	
7409	X-ray tube housing	De Gotzen	CE0434	D00342	
7410	X-ray tube insert	Toshiba	DG073-BDC	11714	

**Radiation regulated material ID No 4723 (former registration number RR9383) (status Active)**

Work Area	Fee Group	Type	Equipment	Purpose
-----------	-----------	------	-----------	---------

Adult Surgery 9	Group A	Radiation apparatus	Dental Radiography	Dental diagnostic
Components:	<u>Type</u>	<u>Manufacturer</u>	<u>Model No</u>	<u>Serial No</u> <u>Source Name</u>
7768	Control console / generator	De Gotzen	X Genus	D00345
7769	X-ray tube housing	De Gotzen	CE-0434	D00342
7770	X-ray tube insert	Toshiba	DG-073B-DC	11714

**Radiation regulated material ID No 5328 (former registration number RR20491) (status Active)**

<u>Work Area</u>	<u>Fee Group</u>	<u>Type</u>	<u>Equipment</u>	<u>Purpose</u>
Child Surgery 4	Group A	Radiation apparatus	Dental Radiography	Dental diagnostic
Components:	<u>Type</u>	<u>Manufacturer</u>	<u>Model No</u>	<u>Serial No</u> <u>Source Name</u>
15171	X-ray tube housing	Kodak	TR-1	WEYA623
15172	X-ray tube insert	Kodak	TRX-708	0818042
15510	Control console / generator	Kodak	2200	WEYA623

**Radiation regulated material ID No 7867 (former registration number RR23584) (status Active)**

<u>Work Area</u>	<u>Fee Group</u>	<u>Type</u>	<u>Equipment</u>	<u>Purpose</u>
Adult Surgery 3	Group A	Radiation apparatus	Dental Radiography	Dental diagnostic
Components:	<u>Type</u>	<u>Manufacturer</u>	<u>Model No</u>	<u>Serial No</u> <u>Source Name</u>
23190	Control console / generator	De Gotzen	X-Mind DC	D20038
23191	X-ray tube housing	De Gotzen	X-Mind DC	D20038
23192	X-ray tube insert	Toshiba	DG-073B-DC	39831

**Radiation regulated material ID No 8527 (status Active)**

<u>Work Area</u>	<u>Fee Group</u>	<u>Type</u>	<u>Equipment</u>	<u>Purpose</u>
Child Surgery 1	Group A	Radiation apparatus	Dental Radiography	Dental diagnostic
Components:	<u>Type</u>	<u>Manufacturer</u>	<u>Model No</u>	<u>Serial No</u> <u>Source Name</u>
24733	Control console / generator	Carestream	2200	BDYO120
24778	X-ray tube insert	Trophy	TRX-708	1311040

**Radiation regulated material ID No 14990 (status Active)**

<u>Work Area</u>	<u>Fee Group</u>	<u>Type</u>	<u>Equipment</u>	<u>Purpose</u>
Child Surgery 3	Group A	Radiation apparatus	Dental Radiography	Dental diagnostic
Components:	<u>Type</u>	<u>Manufacturer</u>	<u>Model No</u>	<u>Serial No</u> <u>Source Name</u>
42536	Control console / generator	Carestream	CS-2200	FBYO123
42537	X-ray tube housing	Carestream	CS-2200	FBYO123
42538	X-ray tube insert	Trophy	TRX-708	1650073

**Radiation regulated material ID No 17009 (status Active)**

<u>Work Area</u>	<u>Fee Group</u>	<u>Type</u>	<u>Equipment</u>	<u>Purpose</u>
Adult Surgery 5	Group A	Radiation apparatus	Dental Radiography	Dental diagnostic
Components:	<u>Type</u>	<u>Manufacturer</u>	<u>Model No</u>	<u>Serial No</u> <u>Source Name</u>
48311	Control console / generator	Carestream	CS-2200	GCYX081
48312	X-ray tube housing	Carestream	CS-2200	GCYX081
48313	X-ray tube insert	Carestream	OCX/65-GC	180815

**Radiation regulated material ID No 17015 (status Active)**

<u>Work Area</u>	<u>Fee Group</u>	<u>Type</u>	<u>Equipment</u>	<u>Purpose</u>
Adult Surgery 2	Group A	Radiation apparatus	Dental Radiography	Dental diagnostic
Components:	<u>Type</u>	<u>Manufacturer</u>	<u>Model No</u>	<u>Serial No</u> <u>Source Name</u>
48329	Control console / generator	Carestream	CS-2200	GCYX084
48330	X-ray tube housing	Carestream	CS-2200	GCYX084
48331	X-ray tube insert	Carestream	OCX/65-GC	181321

**Radiation regulated material ID No 17019 (status Active)**

<u>Work Area</u>	<u>Fee Group</u>	<u>Type</u>	<u>Equipment</u>	<u>Purpose</u>
Adult Surgery 1	Group A	Radiation apparatus	Dental Radiography	Dental diagnostic
Components:	<u>Type</u>	<u>Manufacturer</u>	<u>Model No</u>	<u>Serial No</u> <u>Source Name</u>
48337	Control console / generator	Carestream	CS-2200	GCYX083
48338	X-ray tube housing	Carestream	CS-2200	GCYX083
48339	X-ray tube insert	Carestream	OCX/65-GC	180581

**Location: South Western Sydney Local Health District - ROSEMEADOW - Rosemeadow Oral Health Clinic, 5 Thomas Rose Drive, ROSEMEADOW, NSW 2560**

**Radiation regulated material ID No 2165 (former registration number RR10486) (status Active)**

<u>Work Area</u>	<u>Fee Group</u>	<u>Type</u>	<u>Equipment</u>	<u>Purpose</u>
Surgery 2	Group A	Radiation apparatus	Dental Radiography	Dental diagnostic
Components:	<u>Type</u>	<u>Manufacturer</u>	<u>Model No</u>	<u>Serial No</u> <u>Source Name</u>
10944	Control console / generator	Takara Belmont	Belray 096C	C05383
10949	X-ray tube housing	Takara Belmont	096H	C05383
10999	X-ray tube insert	Toshiba	D-088T	90580

**Radiation regulated material ID No 3113 (former registration number RR6182) (status Active)**

<u>Work Area</u>	<u>Fee Group</u>	<u>Type</u>	<u>Equipment</u>	<u>Purpose</u>
Surgery 3	Group A	Radiation apparatus	Dental Radiography	Dental diagnostic

Components:	Type	Manufacturer	Model No	Serial No	Source Name
3963	Control console / generator	Trophy	CCX	XANC0255	
4281	X-ray tube housing	Trophy	708G	XANC0255	
4282	X-ray tube insert	Trophy	OCX-65G	901093	

**Radiation regulated material ID No 3117 (former registration number RR6191) (status Active)**

Work Area	Fee Group	Type	Equipment	Purpose
-----------	-----------	------	-----------	---------

Surgery 4	Group A	Radiation apparatus	Dental Radiography	Dental diagnostic
-----------	---------	---------------------	--------------------	-------------------

Components:	Type	Manufacturer	Model No	Serial No	Source Name
3830	X-ray tube insert	Toshiba	D-088T	54080	
3968	Control console / generator	Takara Belmont	Belray 096C	R08300	
3969	X-ray tube housing	Takara Belmont	096H	R08300	

**Radiation regulated material ID No 14997 (status Active)**

Work Area	Fee Group	Type	Equipment	Purpose
-----------	-----------	------	-----------	---------

Surgery 7	Group A	Radiation apparatus	Dental Radiography	Dental diagnostic
-----------	---------	---------------------	--------------------	-------------------

Components:	Type	Manufacturer	Model No	Serial No	Source Name
42557	Control console / generator	Carestream	CS-2200	EE0124	
42558	X-ray tube housing	Carestream	CS-2200	EE0124	
42559	X-ray tube insert	Trophy	TRX-708	1550102	

**Radiation regulated material ID No 16740 (status Active)**

Work Area	Fee Group	Type	Equipment	Purpose
-----------	-----------	------	-----------	---------

Surgery 6	Group A	Radiation apparatus	Dental Radiography	Dental diagnostic
-----------	---------	---------------------	--------------------	-------------------

Components:	Type	Manufacturer	Model No	Serial No	Source Name
47560	Control console / generator	Carestream	CS-2200	EEYO123	
47561	X-ray tube housing	Carestream	CS-2200	EEYO123	
47562	X-ray tube insert	Trophy	TRX-708	1550099	

**Radiation regulated material ID No 17325 (status Active)**

Work Area	Fee Group	Type	Equipment	Purpose
-----------	-----------	------	-----------	---------

Surgery 5	Group A	Radiation apparatus	Dental Radiography	Dental diagnostic
-----------	---------	---------------------	--------------------	-------------------

Components:	Type	Manufacturer	Model No	Serial No	Source Name
49160	Control console / generator	Carestream	CS-2200	GGXV132	
49161	X-ray tube housing	Carestream	CS-2200	GGXV132	
49162	X-ray tube insert	Trophy	TRX-708	182062	