

S19-0011
LIVERPOOL HEALTH & ACADEMIC PRECINCT
MULTISTOREY CAR PARK (MSCP) SSDA
VOLUME 1 OF 1
LANDSCAPE WORKS DRAWING SET

FINAL

30th MARCH 2020

NOTE: THIS DOCUMENT IS PRELIMINARY UNLESS VERIFIED.

THE FOLLOWING FORM PART OF THE DOCUMENTATION AND CONSTRUCTION SET.

DRAWING NO.	TITLE	SCALE	REV
L-SSDA-MSCP-00	COVER PAGE	N/A	02
L-SSDA-MSCP-01	SITE PLAN	1:750@A1	02
L-SSDA-MSCP-02	GROUND PLANE 01	1:250@A1	02
L-SSDA-MSCP-03	GROUND PLANE 02	1:250@A1	02
L-SSDA-MSCP-04	ELEVATIONS 01	1:200@A1	02
L-SSDA-MSCP-05	INDICATIVE PLANTING PALETTE	N/A	01
L-SSDA-MSCP-06	INDICATIVE MATERIALS PALETTE	N/A	01

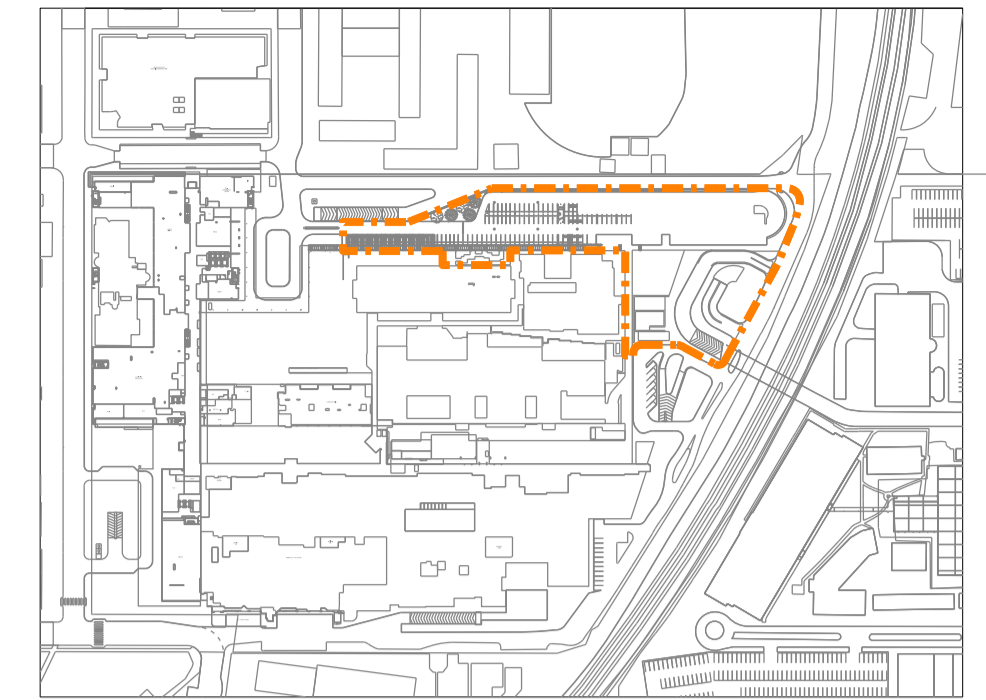

KEY PLAN ①

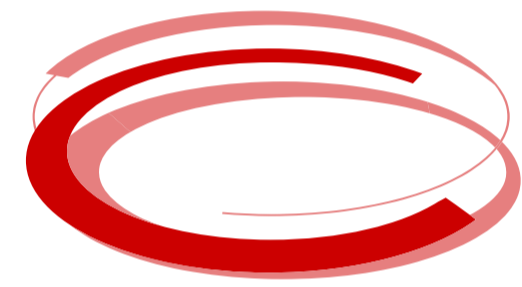

CLOUSTON associates

Prepared by

CLOUSTON associates

LANDSCAPE ARCHITECTS URBAN DESIGNERS LANDSCAPE PLANNERS

65-69 KENT STREET
 SYDNEY NSW 2000
 EMAIL sydney@clouston.com.au
 TELEPHONE (02) 8272 4999
www.clouston.com.au

NOTE: This document is Preliminary unless Verified.

REV	REVISION DESCRIPTION	REVISION DATE	REVIEW	VERIFY	VALIDATE
02	FINAL	30.03.2020	AD	MOD	MOD
01	FINAL FOR REVIEW	21.02.2020	JG	AD	CL

CLIENT
HEALTH INFRASTRUCTURE CLIENT
 14-77 PACIFIC HWY
 NORTH SYDNEY
 SYDNEY NSW 2060

LANDSCAPE ARCHITECTS
CLOUSTON Associates
 LANDSCAPE ARCHITECTS
 65-69 KENT STREET
 SYDNEY NSW 2000
 EMAIL sydney@clouston.com.au
 TELEPHONE (02) 8272 4999

PROJECT MANAGER
JOHNSTAFF
 LEVEL 5/9-13
 CASTLEREAGH ST
 SYDNEY NSW 2000



DRAWINGS TO BE PRINTED IN COLOUR

PROJECT LIVERPOOL HEALTH & ACADEMIC PRECINCT MULTISTOREY CAR PARK SSDA	CLIENT HEALTH INFRASTRUCTURE	SCALE
DRAWING TITLE COVER PAGE	DRAWING NUMBER L-SSDA-MW-00	DRAWN JG
	REVISION 02	

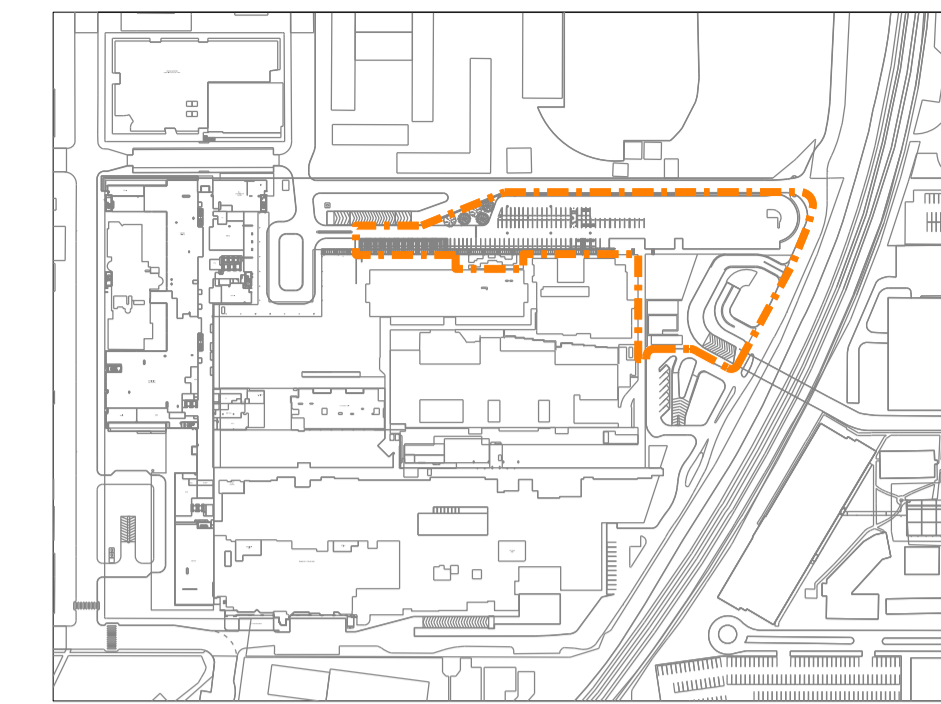
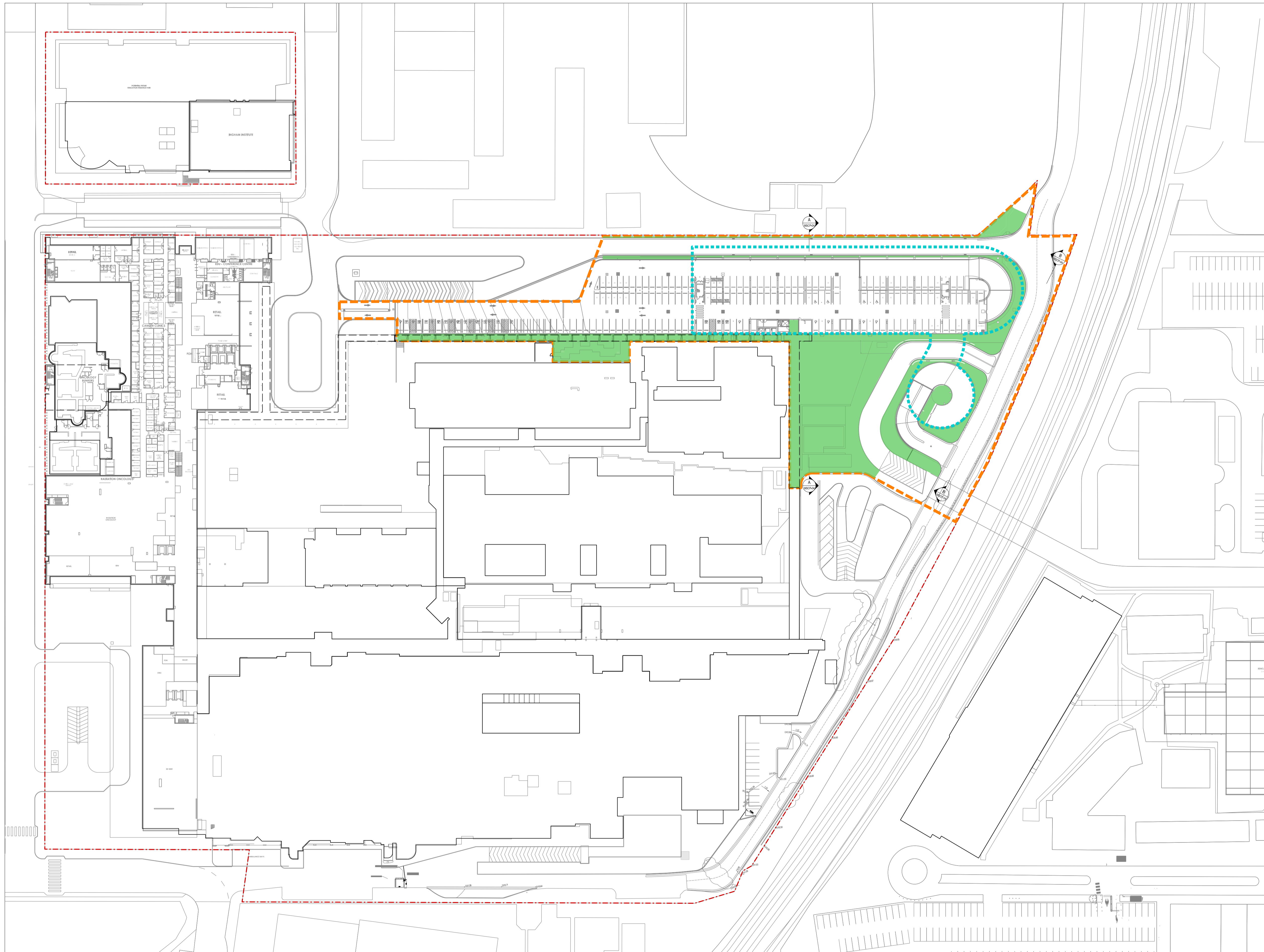

KEY PLAN ①

LEGEND

- MSCP Landscape Extent of Works
- MSCP Building Outline
- LHAP Site Boundary
- MSCP SSDA Boundary

NOTE: This document is Preliminary unless Verified.

REV	REVISION DESCRIPTION	REVISION DATE	REVIEW	VERIFY	VALIDATE
02	FINAL	30.03.2020	AD	MOD	MOD
01	FINAL FOR REVIEW	21.02.2020	JG	AD	CL

CLIENT
HEALTH INFRASTRUCTURE CLIENT

14-77 PACIFIC HWY
NORTH SYDNEY
SYDNEY NSW 2060

LANDSCAPE ARCHITECTS
CLOUSTON Associates
LANDSCAPE ARCHITECTS

65-69 KENT STREET
SYDNEY NSW 2000
EMAIL: sydney@couston.com.au
TELEPHONE (02) 8272 4999

PROJECT MANAGER
JOHNSTAFF

LEVEL 5/9-13
CASTLEREAGH ST
SYDNEY NSW 2000



DRAWINGS TO BE PRINTED IN COLOUR

PROJECT LIVERPOOL HEALTH & ACADEMIC PRECINCT
MULTISTOREY CAR PARK SSDA

DRAWING TITLE
SITE PLAN

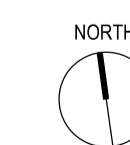
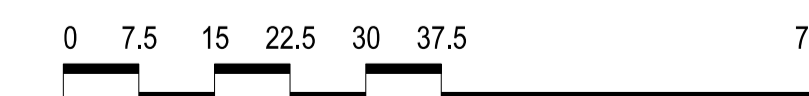

CLIENT
HEALTH INFRASTRUCTURE

DRAWING NUMBER
L-SSDA-MSCP-01

SCALE
1:750@A1

DRAWN
JG

REVISION
02

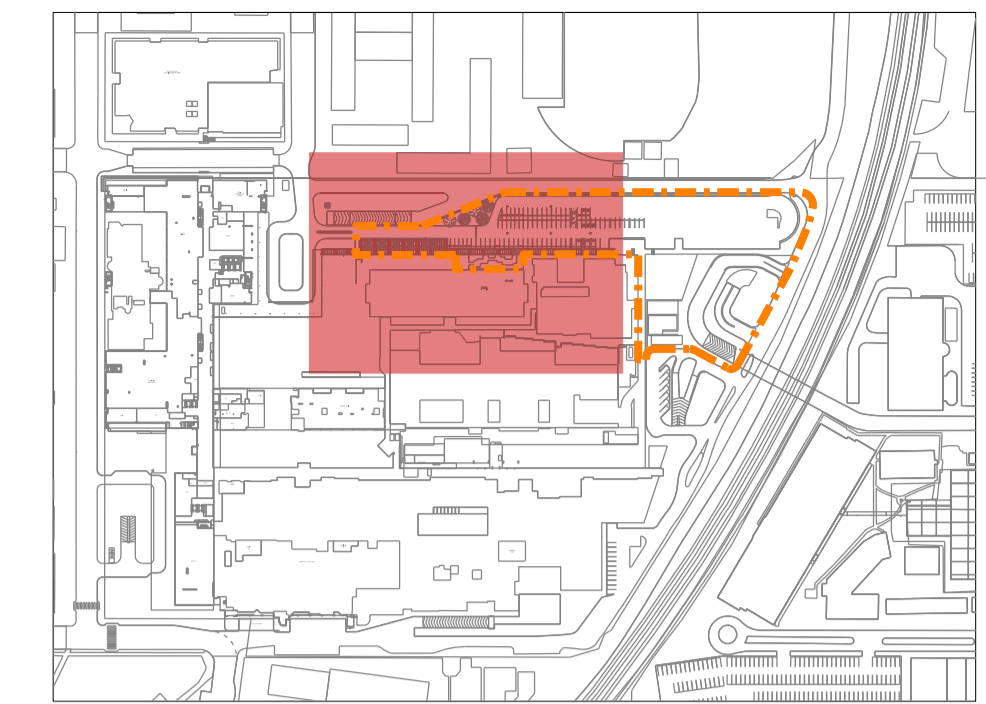
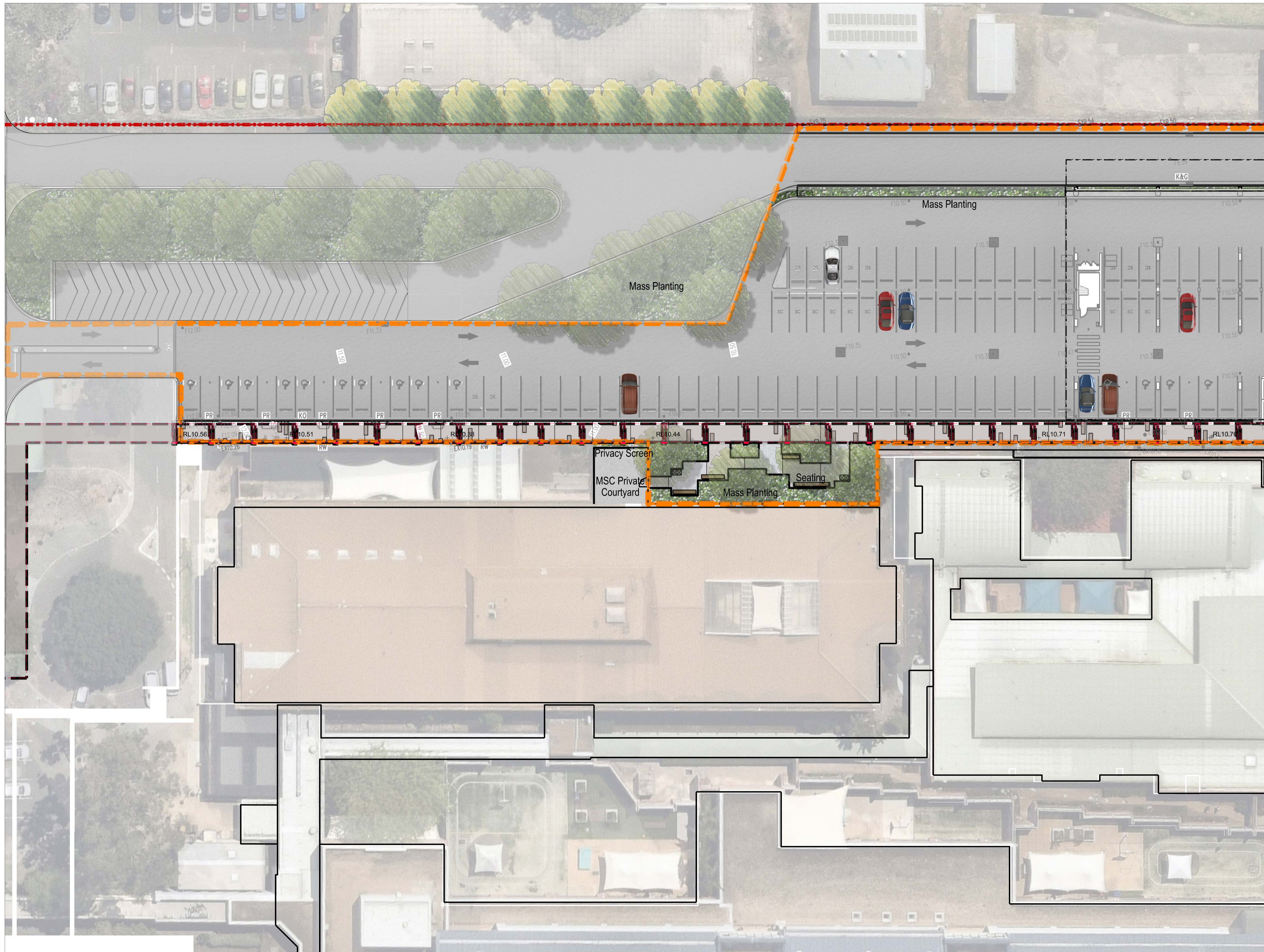

KEY PLAN ①

LEGEND

- Concrete Unit Paving
- Feature Paving Inlay
- Mass Planting
- Turf
- Synthetic Turf
- Gravel
- Road
- Timber Seating
- Climber Planting
- Proposed Evergreen Trees
- Existing Trees
- Covered Way
- LHAP Site Boundary
- MSCP SSDA Boundary

NOTE: This document is Preliminary unless Verified.

REV	REVISION DESCRIPTION	REVISION DATE	REVIEW	VERIFY	VALIDATE
02	FINAL	30.03.2020	AD	MOD	MOD
01	FINAL FOR REVIEW	21.02.2020	JG	AD	CL

CLIENT
HEALTH INFRASTRUCTURE CLIENT
14-77 PACIFIC HWY
NORTH SYDNEY
SYDNEY NSW 2060

LANDSCAPE ARCHITECTS
CLOUSTON Associates
LANDSCAPE ARCHITECTS
65-69 KENT STREET
SYDNEY NSW 2000
EMAIL: sydney@clouston.com.au
TELEPHONE (02) 8272 4999

PROJECT MANAGER
JOHNSTAFF
LEVEL 5/9-13
CASTLEREAGH ST
SYDNEY NSW 2000



DRAWINGS TO BE PRINTED IN COLOUR

PROJECT LIVERPOOL HEALTH & ACADEMIC PRECINCT
MULTISTOREY CAR PARK SSDA
DRAWING TITLE
GROUND PLANE 01

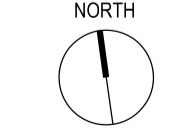

CLIENT
HEALTH INFRASTRUCTURE
DRAWING NUMBER
L-SSDA-MSCP-02

SCALE
1:250@A1
DRAWN
JG
REVISION
02

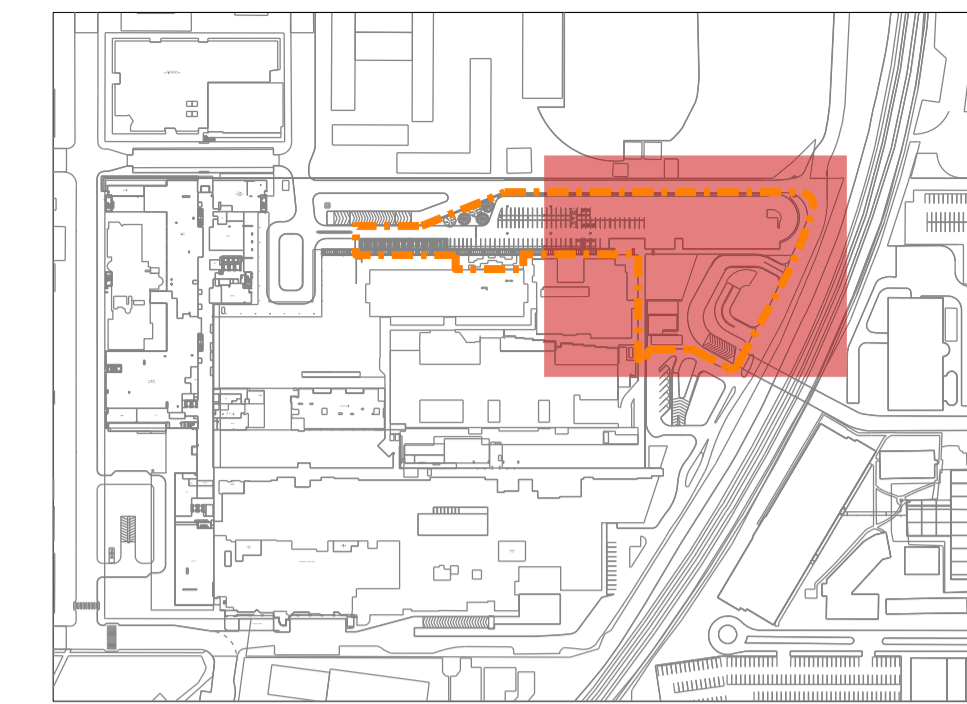

KEY PLAN

LEGEND

- Concrete Unit Paving
- Feature Paving Inlay
- Mass Planting
- Turf
- Synthetic Turf
- Gravel
- Road
- Timber Seating
- Climber Planting
- Proposed Evergreen Trees
- Existing Trees
- Covered Way
- LHAP Site Boundary
- MSCP SSDA Boundary

NOTE: This document is Preliminary unless Verified.

REV	REVISION DESCRIPTION	REVISION DATE	REVIEW	VERIFY	VALIDATE
02	FINAL	30.03.2020	AD	MOD	MOD
01	FINAL FOR REVIEW	21.02.2020	JG	AD	CL

CLIENT
HEALTH INFRASTRUCTURE CLIENT

14-77 PACIFIC HWY
NORTH SYDNEY
SYDNEY NSW 2060

LANDSCAPE ARCHITECTS
CLOUSTON Associates
LANDSCAPE ARCHITECTS

65-69 KENT STREET
SYDNEY NSW 2000
E:MAIL: sydney@clouston.com.au
TELEPHONE: (02) 8272 4999

PROJECT MANAGER
JOHNSTAFF

LEVEL 5/9-13
CASTLEREAGH ST
SYDNEY NSW 2000



DRAWINGS TO BE PRINTED IN COLOUR

PROJECT LIVERPOOL HEALTH & ACADEMIC PRECINCT
MULTISTOREY CAR PARK SSDA

DRAWING TITLE
GROUND PLANE 02

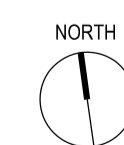

CLIENT
HEALTH INFRASTRUCTURE

DRAWING NUMBER
L-SSDA-MSCP-03

DRAWN
JG

SCALE
1:250@A1

REVISION
02



A ELEVATION A THROUGH MULTISTOREY COURTYARD
1:200 @ A1

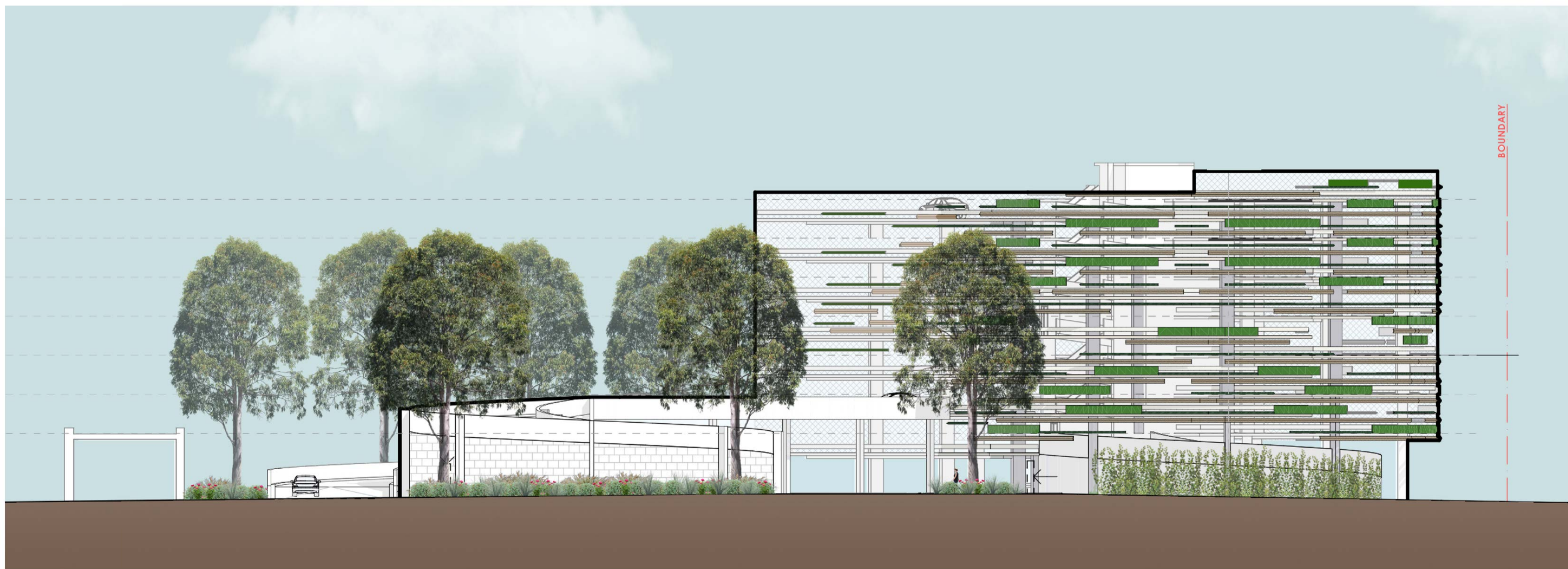

B WESTERN ELEVATION OF MULTISTOREY COURTYARD
1:200 @ A1

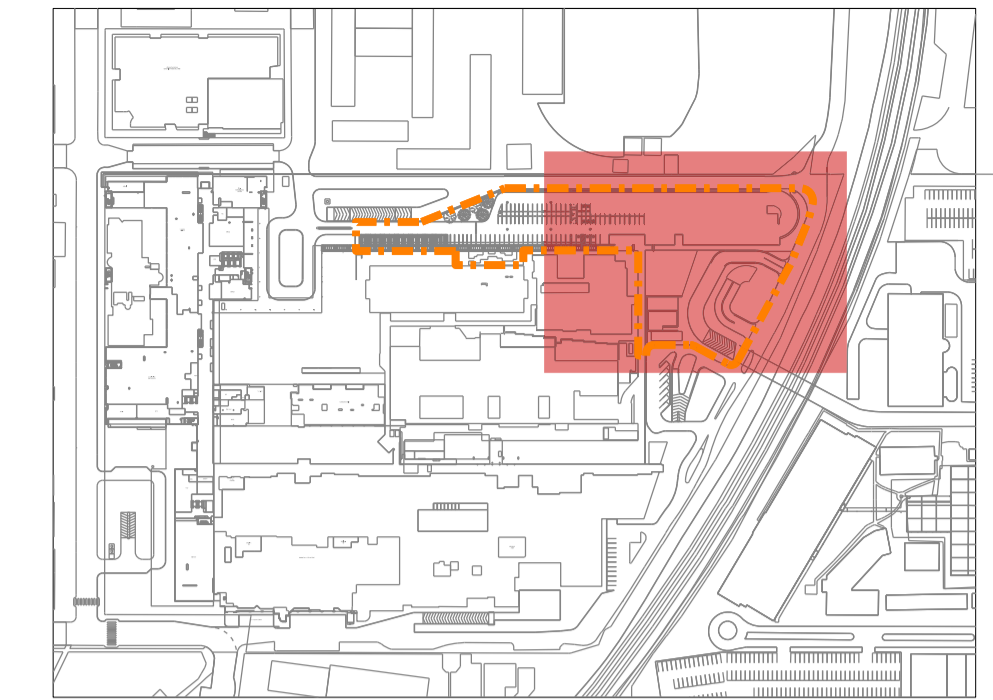

KEY PLAN
LEGEND

NOTE: This document is Preliminary unless Verified.

REV	REVISION DESCRIPTION	REVISION DATE	REVIEW	VERIFY	VALIDATE
02	FINAL	30.03.2020	AD	MOD	MOD
01	FINAL FOR REVIEW	21.02.2020	JG	AD	CL

CLIENT
HEALTH INFRASTRUCTURE
CLIENT

14-77 PACIFIC HWY
NORTH SYDNEY
SYDNEY NSW 2060

LANDSCAPE ARCHITECTS
CLOUSTON Associates
LANDSCAPE ARCHITECTS

65-69 KENT STREET
SYDNEY NSW 2000
EMAIL: sydney@couston.com.au
TELEPHONE (02) 8272 4999

PROJECT MANAGER
JOHNSTAFF

LEVEL 5/9-13
CASTLEREAGH ST
SYDNEY NSW 2000



DRAWINGS TO BE PRINTED IN COLOUR



PROJECT LIVERPOOL HEALTH & ACADEMIC PRECINCT
MULTISTOREY CAR PARK SSSA

DRAWING TITLE
ELEVATIONS 01

CLIENT
HEALTH INFRASTRUCTURE

DRAWING NUMBER
L-SSDA-MSCP-04

SCALE
1:200@A1

DRAWN
JG

REVISION
02

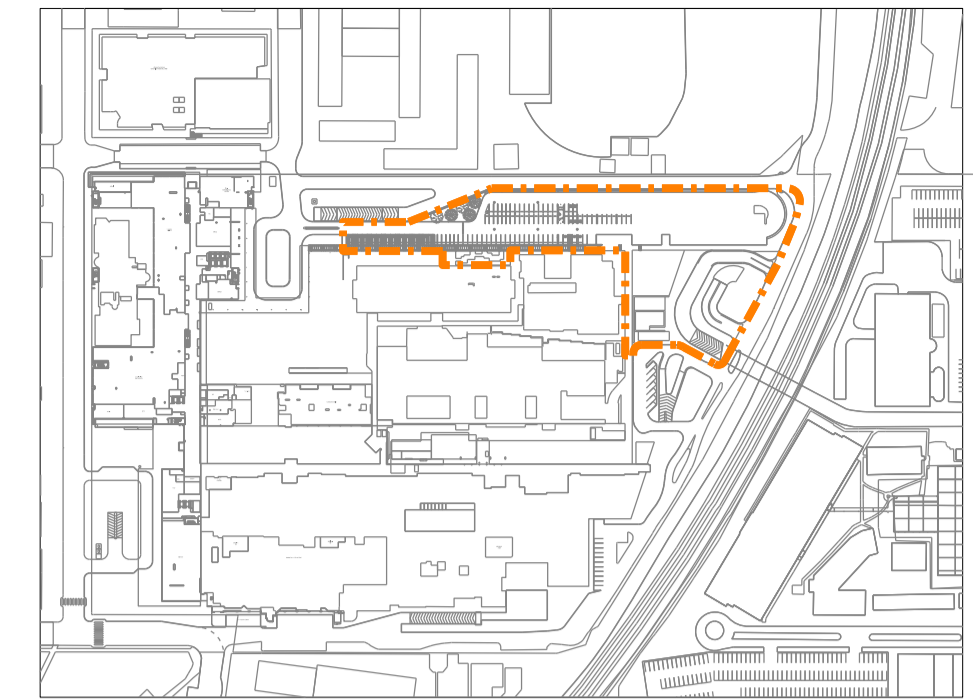

KEY PLAN ①

LEGEND

INDICATIVE PLANTING PALETTE

The below indicative planting palette incorporates native plant species from the Cumberland Shale Plains Woodland and other Australian native species.

TREES



Eucalyptus tereticornis | Forest Red Gum



Corymbia maculata | Spotted Gum



Lagerstroemia indica 'Sioux' | Crepe Myrtle

SHRUBS



Westringia fruticosa 'Mundi' | Native Rosemary



Grevillea 'Robyn Gordon' | Robyn Gordon Grevillea



Callistemon viminalis 'Red Alert' | Red Alert Callistemon



Rhagodia spinescens | Aussie Flat Bush



Hardenbergia violacea | Native Sarsaparilla



Indigofera australis | Native Indigo

CLIMBERS



Hibbertia scandens | Snake Vine



Ficus pumila | Creeping Fig



Pandorea pandorana | Wonga-wonga Vine

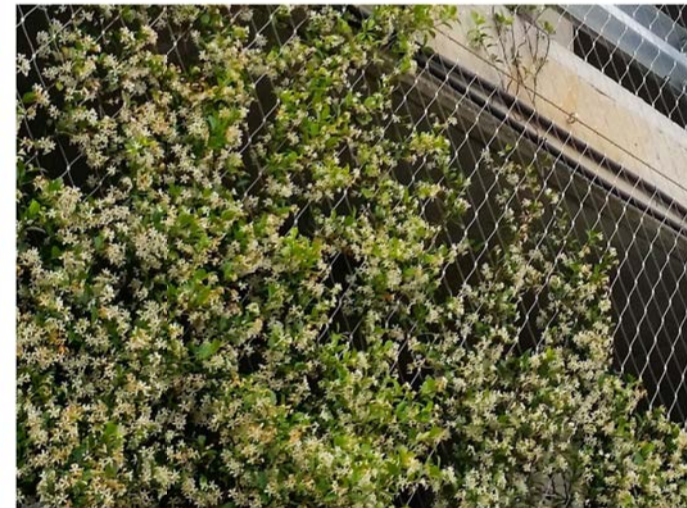

Trachelospermum jasminoides | Star Jasmine

GRASSES & GROUNDCOVERS



Themeda australis 'Mingo' | Blue Kangaroo Grass



Lomandra longifolia | Spiny-Headed Mat-rush



Themeda australis | Kangaroo Grass



Grevillea 'Royal Rambler' | Royal Rambler Grevillea



Liriope muscari 'Amethyst' | Lily Turf



Impirica cylindrica | Blady grass



Pennisetum alopecuroides 'PA400' | PURPLE LEA®



Dianella longifolia 'Forte' | Blueberry Lily

NOTE: This document is Preliminary unless Verified.

REV	REVISION DESCRIPTION	REVISION DATE	REVIEW	VERIFY	VALIDATE
01	FINAL	30.03.2020	AD	MOD	MOD

30/03/2020 5:41:50 PM P:\5191514011 LIVERPOOL HEALTH AND ACADEMIC PRECINCT\707 DOCC VOL 1 PLANS\MSCP\51914011_MSCP_SSDA_LA_PLANS.dwg

CLIENT
HEALTH INFRASTRUCTURE CLIENT

14-77 PACIFIC HWY
NORTH SYDNEY
SYDNEY NSW 2060

LANDSCAPE ARCHITECTS
CLOUSTON Associates
LANDSCAPE ARCHITECTS

65-69 KENT STREET
SYDNEY NSW 2000
EMAIL: sydney@clouston.com.au
TELEPHONE (02) 8272 4999

PROJECT MANAGER
JOHNSTAFF

LEVEL 5/9-13
CASTLEREAGH ST
SYDNEY NSW 2000



DRAWINGS TO BE PRINTED IN COLOUR

PROJECT LIVERPOOL HEALTH & ACADEMIC PRECINCT MULTISTOREY CAR PARK SSDA	CLIENT HEALTH INFRASTRUCTURE	SCALE
DRAWING TITLE INDICATIVE PLANTING PALETTE	DRAWING NUMBER L-SSDA-MSCP-05	DRAWN JG
	REVISION 01	

MATERIALS AND FINISHES

Paving / Surfaces



Exposed Aggregate Concrete



Exposed Aggregate Concrete



Feature Banding



Gravel



Permeable Paving



Turf Lawn



Artificial Turf

Walls & Seating

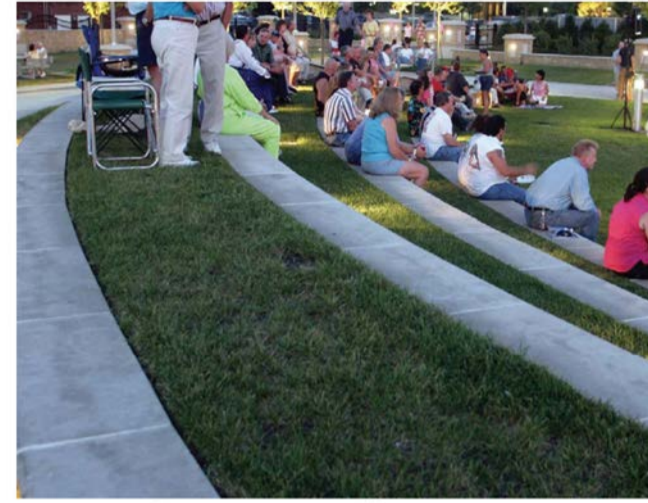

Terraced Seating Walls



Concrete seat with timber



Twig Seats

Furniture & Fixtures



Bicycle Rack

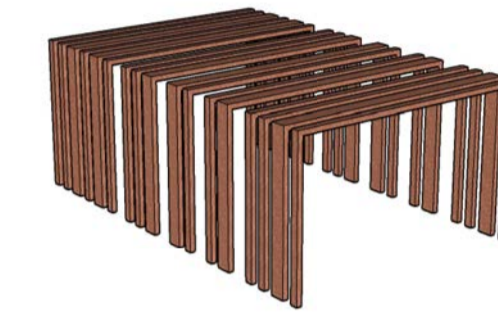

Bespoke Pergola shade structure

Planting (Refer to L-SSDA-MSCP-05 for more information)



Trees



Shrubs



Groundcovers /Grasses

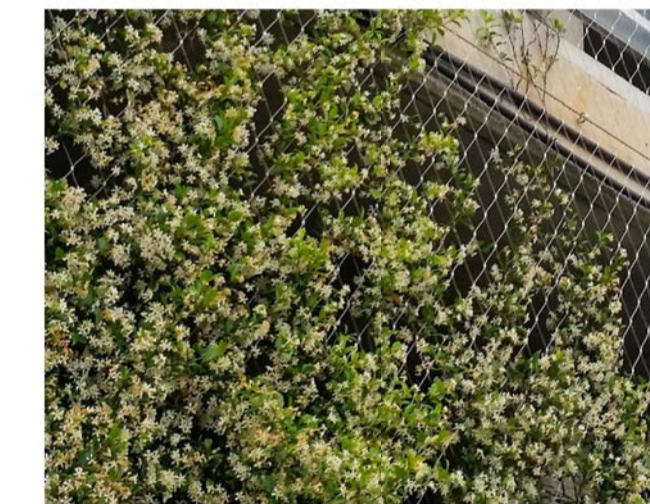

Climbers

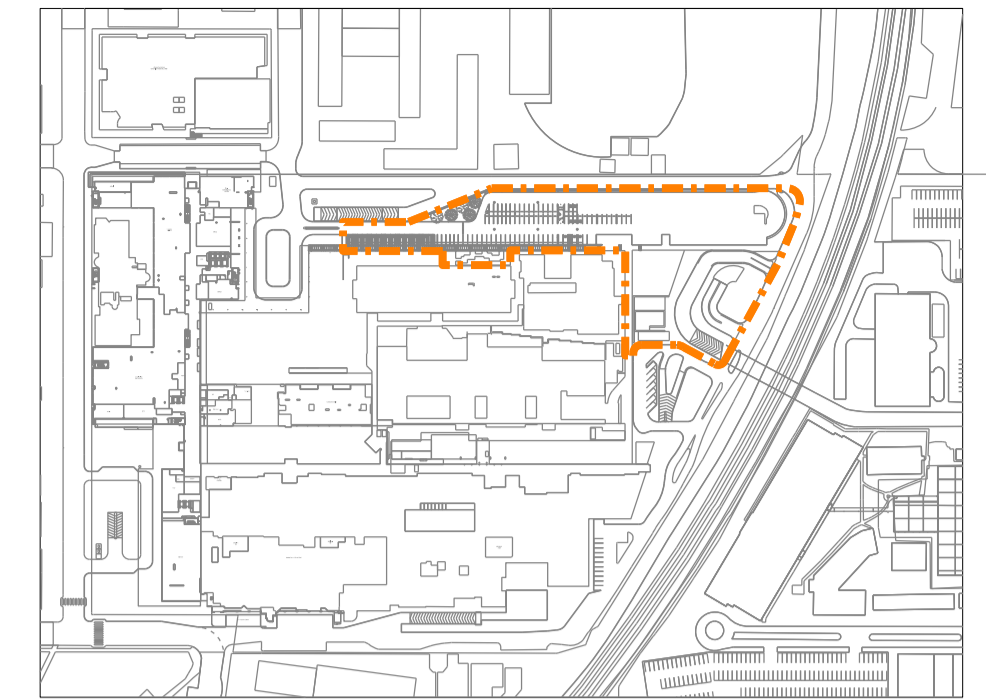

KEY PLAN

LEGEND

NOTE: This document is Preliminary unless Verified.

REV	REVISION DESCRIPTION	REVISION DATE	REVIEW	VERIFY	VALIDATE
01	FINAL	30.03.2020	AD	MOD	MOD

CLIENT
HEALTH INFRASTRUCTURE CLIENT
14-77 PACIFIC HWY
NORTH SYDNEY
SYDNEY NSW 2060

LANDSCAPE ARCHITECTS
CLOUSTON Associates
LANDSCAPE ARCHITECTS
65-69 KENT STREET
SYDNEY NSW 2000
EMAIL: sydney@clouston.com.au
TELEPHONE (02) 8272 4999

PROJECT MANAGER
JOHNSTAFF
LEVEL 5/9-13
CASTLEREAGH ST
SYDNEY NSW 2000



DRAWINGS TO BE PRINTED IN COLOUR

PROJECT LIVERPOOL HEALTH & ACADEMIC PRECINCT MULTISTOREY CAR PARK SSDA	CLIENT HEALTH INFRASTRUCTURE	SCALE
DRAWING TITLE INDICATIVE MATERIALS PALETTE	DRAWING NUMBER L-SSDA-MSCP-06	DRAWN JG
	REVISION 01	