



STAKEHOLDER AND COMMUNITY ENGAGEMENT OUTCOMES REPORT

WESTMEAD CATHOLIC COMMUNITY

20 FEBRUARY 2020

P0009478

FINAL

PREPARED FOR CATHOLIC EDUCATION DIOCESE OF PARRAMATTA



URBIS STAFF RESPONSIBLE FOR THIS REPORT WERE:

Director	Dianne Knott
Senior Consultant	Alisha Filmer
Project Code	P0009478
Report Number	2

TABLE OF CONTENTS.....	3
Glossary and abbreviations	i
1. Introduction	1
2. Overview of proposal	2
2.1. Response to SEARs	3
3. Engagement process	4
3.1. Purpose of engagement	4
3.2. Engagement approach.....	4
3.3. Level of engagement	5
3.4. Previous engagement	5
4. Stakeholder analysis	6
4.1. Project stakeholders	6
4.1.1. Consultation with authorities	9
5. Engagement activities	10
5.1.1. Letter to schools.....	10
5.1.2. Letter to Parish.....	10
5.1.3. Website	10
5.1.4. Media	10
5.1.5. Community Information Sessions	11
5.1.6. Engagement email and phone line	11
6. Engagement feedback	12
6.1. Key themes	13
6.2. Detailed feedback and responses	14
7. Overview of future engagement.....	19
Disclaimer	20

Appendix A	Approach to engagement matrix
Appendix B	Website
Appendix C	Media release
Appendix D	Letter to schools
Appendix E	Letter to Parish
Appendix F	Information boards
Appendix G	Frequently asked questions
Appendix H	Feedback Form

FIGURES:

Figure 1 – Artist’s impression of the future of the site	1
Figure 2 – Project 1, Stage 1 proposal site plan	2

TABLES:

Table 1 – Glossary and abbreviations	i
Table 2 – SEARS Item.....	3
Table 3 – Stakeholder identification	6
Table 4 – Consultation with authorities.....	9
Table 5 – Outline of numbers for direct feedback received	12
Table 6 – Summary of key issues	14

GLOSSARY AND ABBREVIATIONS

Table 1 – Glossary and abbreviations

Term of Abbreviation	Description
CBD	Central Business District
CEDP	Catholic Education Diocese of Parramatta
DPIE	Department of Planning, Industry and Environment
ELC	Early Learning Centre
EIS	Environmental Impact Statement
Fr	Father (Parish Priest)
IAP2	International Association of Public Participation
LGA	Local Government Area
SEARs	Secretary's Environmental Assessment Requirements
SSD	State Significant Development
SSDA	State Significant Development Application
Urbis	Urbis Pty Ltd
WCC	Westmead Catholic Community

1. INTRODUCTION

This report supports a State Significant Development Application for the Westmead Catholic Community (WCC) at 2 Darcy Road, Westmead.

As the proposal is for the purposes of alterations and additions to an existing school and has a capital investment value in excess of \$20 million, it is State Significant Development (SSD) for the purposes of the Environmental Planning and Assessment Act 1979 (the Act). The Parish church is also SSD under clause 8(2)(a) of State Environmental Planning Policy (State and Regional Development) 2011 as it forms part of the proposal which comprises a single, integrated development with significant functional links between the education and church uses. Urbis Pty Ltd (Urbis) has been engaged by Catholic Education Diocese of Parramatta (CEDP) and the project team to develop and deliver stakeholder engagement and communication to support the Westmead Catholic Community project.

The subject site is located at 2 Darcy Road, Westmead, approximately 2km to the north-west of the Parramatta CBD and approximately 300m to the west of Westmead Train Station. The site is located within the Parramatta Local Government Area (LGA). The State Significant Development application will seek approval for:

- A primary school with capacity for approximately 1,680 students, to provide expanded facilities for the existing Mother Teresa Primary School on the site and to replace the existing Sacred Heart Primary School at Ralph Street;
- A new Parish church;
- A Catholic early learning centre (fit-out within an existing building);
- New landscaping.

Whilst the communication and community engagement undertaken relates to Project 1, Stage 1, this proposal was discussed in the context of future development (Project 1, Stage 2) integrating the schools in a vertical building accessible by a new internal road network and the full master plan (Project 2), which will be subject to a separate SSDA process.

This engagement and communication outcomes report documents the engagement and communications process, feedback received and considerations in response to feedback undertaken for CEDP during September - December 2019.

Figure 1 – Artist's impression of the future of the site



2. OVERVIEW OF PROPOSAL

The WCC project seeks to meet the needs of the growing population within the region by providing upgraded school facilities for Mother Teresa and Sacred Heart Primary Schools, as well as a new Parish church. WCC is a collaboration between Catholic Education Diocese of Parramatta (CEDP), the Diocese of Parramatta (DoP), the Sisters of Mercy and the Marist Brothers Province of Australia. The State Significant Development application will seek approval for:

A primary school with capacity for approximately 1,680 students, to provide expanded facilities for the existing Mother Teresa Primary School on the site and to replace the existing Sacred Heart Primary School at Ralph Street;

A new Parish church;

A Catholic early learning centre (fit-out within an existing building);

New landscaping.

Sacred Heart Primary Westmead will cater for students from Early Learning to Year 2 and Mother Teresa Primary Westmead will serve students from Year 3 to Year 6.

The projections of students for each stream and grade will be refined throughout the development of the project. It is anticipated upon completion of the masterplan the site will accommodate up to 6,000 students. This will be a staged growth over 10-20 years.

The first phase of the Westmead Catholic Community project, new parish and primary school facilities and a Catholic Early Learning Centre, is set to open in 2023.

This proposal was discussed in context of the full masterplan which will be subject to a separate SSDA process.

Figure 2 – Project 1, Stage 1 proposal site plan



Source: Alleanza Architecture

2.1. RESPONSE TO SEARS

The engagement and communication outcomes report is required by the Secretary’s Environmental Assessment Requirements (SEARs) for SSD-10383.

Table 2 – SEARS Item

SEARS Item
<p>Consultation</p> <p>During the preparation of the EIS, you must consult with the relevant local, State or Commonwealth Government authorities, service providers, community groups, special interest groups, including local Aboriginal land councils and registered Aboriginal stakeholders, and affected landowners. In particular, you must consult with:</p> <ul style="list-style-type: none">▪ City of Parramatta▪ GA NSW▪ Transport for NSW (TfNSW)▪ Transport for NSW (Roads and Maritime Services) (TfNSW RMS). <p>Consultation with Council, GA NSW, TfNSW and TfNSW (RMS) should commence as soon as practicable to agree the scope of investigation. The EIS must describe the consultation process and the issues raised, and identify where the design of the development has been amended in response to these issues. Where amendments have not been made to address an issue, a short explanation should be provided.</p>

3. ENGAGEMENT PROCESS

Early, open and transparent communication that emphasises the core benefits of Westmead Catholic Community project will minimise misinformation and create a shared sense of trust and ownership between project stakeholders. An accountable and robust process will also demonstrate efforts to engage genuinely with stakeholders and will reduce risk for decision makers.

3.1. PURPOSE OF ENGAGEMENT

The stakeholder and community engagement process for the Westmead Catholic Community project aimed to:

- Provide accurate information about the proposed concept plans
- Deliver an independent, transparent and accountable consultation process and provide a range of ways for people to engage and give feedback
- Create pathways for stakeholder interaction and feedback that are open and transparent
- Document key feedback to inform ongoing design and planning
- Collate feedback to inform the planning and development of all stages of the project
- Invite proactive engagement on key community issues and concerns, and
- Deliver an independent, transparent and accountable consultation process.

3.2. ENGAGEMENT APPROACH

The engagement approach is underpinned by CEDP's Engagement Framework, in accordance with the International Association of Public Participation's (IAP2) Public Participation principles and guided by Department of Planning, Industry and Environment (formerly Department of Planning and Environment), Community and Stakeholder Engagement guidelines, June 2017.

CEDP will measure the outcome of effective stakeholder engagement as having informed and meaningfully engaged stakeholders who contribute to CEDP's decision-making processes, service delivery and success. CEDP measures effective engagement as:

- Purposeful, planned and transparent
- Fit-for-purpose and appropriate for the stakeholders involved
- Creates opportunities for dialogue
- Flexible and responsive.

The *Approach to Engagement Worksheet* (Department of Planning and Environment, Draft Community and Stakeholder Engagement Guideline 6, 2007), Appendix A, has been used during the scoping process to understand level of impact, interest and inform the scope and level of engagement to be applied for the Westmead Catholic Community project.

3.3. LEVEL OF ENGAGEMENT

Urbis Engagement works in line with the International Association of Public Participation's (IAP2) Public Participation spectrum and utilises the participation principles of:

- **Inform:** To provide the public with balanced and objective information to assist them in understanding the problem, alternatives, opportunities and/or solutions.
- **Consult:** To obtain public feedback on analysis alternatives and/or decisions.
- **Involve:** To work directly with the public throughout the process to ensure that public concerns and aspirations are consistently understood and considered.
- **Collaborate:** To partner with the public in each aspect of the decision including the development of alternatives and the identification of the preferred solution.

Westmead Catholic Community stakeholders and corresponding level of engagement can be found in Table 3 – Stakeholder identification.

3.4. PREVIOUS ENGAGEMENT

CEDP has proactively engaged the school and wider community and conducted the following activities to date:

- Stakeholder Engagement and Change Committee, 25 July 2017
- Pastoral Letter to School Community, 8 August 2017
- Meeting with School Principals and Staff, Morley Centre, 26 October 2017
- Letter to Sacred Heart Parish, 26 October 2017

4. STAKEHOLDER ANALYSIS

Stakeholders are individuals, groups of individuals or organisations that may be impacted (positively or negatively) by a project. To ensure a coordinated approach, Urbis Engagement collaborated with CEDP to engage with the various stakeholder groups for Westmead Catholic Community project.

The following table outlines the key stakeholders who will form a part of the consultation process. The stakeholder identification matrix is based on the principles in accordance with the IAP2 Public Participation spectrum as outlined in Section 3.3.

4.1. PROJECT STAKEHOLDERS

Table 3 – Stakeholder identification

Stakeholder	Level of engagement
Project partners	
Marist Australia	Involve
Sisters of Mercy Parramatta	Involve
Schools	
Sacred Heart Primary School Executive Team, staff, teachers, students and parents	Involve
Mother Teresa Primary School Executive Team, staff, teachers, students and parents	Involve
Parramatta Marist High Executive Team, staff, teachers, students and parents	Involve
Catherine McAuley Executive Team, staff, teachers, students and parents	Involve
Parramatta Marist High Old Boys Union – Alumni Association	Consult
Marist Brothers residing at the Darcy Rd site	Consult
Catherine McAuley Alumni	Consult
Future students and parents	Consult
Sacred Heart Parish Community	Involve

Stakeholder	Level of engagement
Independent Education Union of Australia NSW/ACT Branch	Inform
Government	
NSW Health and the Local Health District	Involve
State Minister for Education and Early Childhood Learning	Consult
Shadow Minister for Education	Inform
State Minister for Skills and Tertiary Education	Consult
State Shadow Minister for Education	Inform
State Shadow Minister for Early Education	Inform
State Member for Granville	Consult
Minister for Education	Inform
City of Parramatta – Mayor and Councillors	Involve
Greater Sydney Commission	Consult
Roads and Maritime Services	Inform
Transport NSW	Consult
NSW Department of Planning, Industry and Environment	Involve
NSW Department of Education	Consult
Westmead Alliance	Consult
Community	
Jesuit Refugee Services	Inform
NSW Health and the Local Health District Patients and visitors	Inform
Westmead Private Hospital Staff, patients and visitors	Inform
Sydney University Executive, staff and students	Inform
Western Sydney University Executive, staff and students	Inform
Parramatta Eels	Inform

Stakeholder	Level of engagement
Neighbours	Inform
Local community	Inform
Local businesses	Inform
Media	
Media outlets (Parramatta Advertiser, Catholic Outlook)	Inform
Channel 9	Inform

4.2. CONSULTATION WITH AUTHORITIES

The following meetings were undertaken with key authorities to discuss the project planning and proposed design.

Table 4 – Consultation with authorities

Stakeholder	Meeting date
City of Parramatta	29 October 2018 (informal discussion) 27 November 2018 Early-Mid July 2018 1 August 2019 30 August 2019 18 September 2019
Government Architect of NSW	3 September 2019 (project briefing) 30 October 2019 (briefing 2)
State Design Review Panel (SRDP)	6 November 2019 January 2020
Westmead Alliance	Multiple meetings held with Westmead Alliance and collaboration in master planning design integration 2017 - 2019
Schools Infrastructure NSW	Established memorandum of understanding in 2018 and meet on a regular basis.
RMS	12 February 2020
Metro and Rail	Multiple meetings with Sydney Metro and RMS on transport infrastructure provisions during 2018

5. ENGAGEMENT ACTIVITIES

5.1.1. Letter to schools

A school newsletter was prepared to outline key facts of the Westmead Catholic Community proposal and invite members of the school community to contribute their ideas and thoughts.

A newsletter was distributed directly to parents and students on 20 September 2019 by each of the school Principals. A copy of the newsletter and distribution catchment can be found in Appendix D.

A detailed summary of feedback has been outlined in Section 6.2 of this report.

5.1.2. Letter to Parish

A letter was prepared to outline key features of the proposal and inform the Parish community of opportunities to provide feedback or ask questions via a dedicated email address and phone number.

Letters were circulated in the form of printed letters and through the Parish newsletter on 20 September 2019.

A detailed summary of feedback has been outlined in Section 6.2 of this report.

5.1.3. Website

As part of the consultation process, and to ensure access to specialised information regarding the proposal, a dedicated project information website was developed and published on 20 September 2019.

The website westmeadcatholiccommunity.org provides information about the proposed development application, the planning process and contact information.

This engagement activity was designed to be used as an inform tool, with easily accessible information available anywhere, at any time. It also included details of a project email and phone number managed by CEDP, to enable people to provide feedback on the project.

The website is updated periodically and at key milestones during the Project.

5.1.4. Media

On 20 September 2019, a media release was circulated to provide members of the wider community information about the Westmead Catholic Community proposal. A copy of the media release is provided in Appendix C. The media release was provided to:

- The Daily Telegraph
- Parramatta Advertiser.

On 20 September 2019, Catholic Education Diocese of Parramatta shared the announcement via their social media channels including facebook page.

5.1.5. Staff and Community Information Sessions

On 20 September 2019, separate information sessions were held with staff of Sacred Heart Primary School, Mother Theresa Primary School, Catherine McCauley High School and Parramatta Marist High School.

Letters to school communities were issued inviting to attend Community Information Sessions.

Five information sessions were held during September – October 2019, at the below times and locations:

- Sacred Heart School and Parish Information Session, Saturday 28 September, 6.45pm – 7.30pm and Sunday 29 September, 8.30am – 9.30am, Sacred Heart Primary School
- Sacred Heart School Information Session, Monday 28 October 2019, 7pm – 8pm, Sacred Heart Primary School
- Catherine McAuley Information Session, Tuesday 22 October, 5.30pm – 6.45pm, Catherine McAuley High School
- Parramatta Marist High School Information Session, Monday 4 November, 7pm – 8.30pm, Parramatta Marist High School
- Mother Teresa Primary School Information Session, Tuesday 5 November, 7pm – 8pm, Mother Teresa Primary School

Cumulatively approximately 150 people attended the five sessions.

At the information session, feedback was received via:

- Direct discussions with members of the project team and Catholic Education Diocese of Parramatta who were briefed to note key issues and questions raised during discussions, and these were collated and reviewed at the end of the Information sessions. All feedback was scribed by an Urbis staff member at the sessions.
- Feedback form collected on the day, and via email following the information session.

A copy of the feedback form is provided in Appendix F.

Information boards outlining key project facts were displayed at the Information sessions and are provided in Appendix E.

A detailed summary of feedback has been outlined in Section 6.2 of this report.

5.1.6. Engagement email and phone line

Members of the public were invited to contact CEDP through a dedicated phone number and email address. A total of five people have phoned or emailed to provide feedback or seek further information during the period from September 2019 – January 2020.

A detailed summary of feedback has been outlined in Section 6.2 of this report.

5.1.7. Summary of engagement activities

Table 5 – Outline of numbers for direct feedback received

Feedback mechanism	Number received
School/Parishioner Community Information Sessions	150
Consultation with authorities	More than 20 meetings held, see section 4.2
Feedback forms	12
Enquiry number and email	5
Total	187

6. ENGAGEMENT FEEDBACK

6.1. KEY THEMES

The key themes from consultations are outlined below.

Initial response

- Concern expressed about the lack of communication and enquiries why community wasn't consulted earlier, particularly for Sacred Heart Parish and Primary Schools.
- Sense of wanting to understand the reason behind the approach, and if there is any "evidence" to support this new approach/model.
- Seeking clarity on the funding of the development and if there would be any negative financial impacts on parents and caregivers, including if there would be any proposed changes to school fees and building levy.
- Concern about how the school reputation and charisms will be protected.

Learning model, student wellbeing and safety

- Primary school learning model and structure, including why is it proposed to retain two schools rather than form one school and seeking clarity on the operational impacts of this change.
- Enquiries regarding the size of schools, streams, teacher ratios and any potential negative impact on student learning and community due to the increase in student numbers.
- Enquiries regarding the increase in student population and seeking clarity on how many streams for each grade and each school, and how this will be managed over time.
- Enrolment processes.
- Maintaining the single sex schools and how the two secondary schools would interact with each other and the primary schools.

Access, traffic and parking

- Pedestrian access, traffic and parking is a key concern the increase in development in surrounding Westmead.
- Concern that the increase in population, dwellings, students and parishioners at Darcy Road site will further compound this issue.

Masterplan and complementary uses

- Queries about the type of complementary uses that may be considered as master planning progresses.
- Perception of commercialisation of the site.
- Concern about student safety with other uses in the area.
- Interest in how any revenue generated from these uses would be used.

6.2. DETAILED FEEDBACK AND RESPONSES

Feedback generated from the engagement activities is detailed below with corresponding responses.

The nature of the feedback pertained to the project need and reason for change, seeking greater understanding of the proposed built form and impacts on open space, transport and access in context of the local area, construction impacts, community benefit and future masterplanning, school-specific feedback and operational matters.

Table 6 – Summary of key issues

Feedback	Response
Project need	
<ul style="list-style-type: none"> • Desire to understand the rationale for the relocation of Sacred Heart school and Parish • Desire to understand the broader benefits of co-location. 	<ul style="list-style-type: none"> • Catholic schools in Westmead are unable to meet growing demand, turning away more than 500 enrolment applicants every year for several years. A plan has been announced by the Diocese of Parramatta, Marist Trustees and supported by the Sisters of Mercy Parramatta, to provide more enrolment opportunities to meet the growing need from families seeking a Catholic education for their children locally. These changes are part of the Westmead Catholic Community initiative, which also includes new Parish facilities. • Further, the Sacred Heart Primary School facilities no longer services the changing needs for contemporary learning. The proposal will provide opportunity to develop purpose-built facilities that are flexible to meet the learning and curriculum delivered by Catholic Education.
Built form	
<ul style="list-style-type: none"> • Enquiries received about how students will students access classrooms. 	<ul style="list-style-type: none"> • Students will be able to access classrooms via stairwell or lifts which will be carefully planned as part of the design.
<ul style="list-style-type: none"> • Feedback that equitable access for children with special needs or physical impairments is important. 	<ul style="list-style-type: none"> • Students with special needs will be accommodated during the design of the school. Lift access will be available.
<ul style="list-style-type: none"> • Clarity sought on the connections between high school and primary school areas. 	<ul style="list-style-type: none"> • The safety of all students will always be the number one priority for Westmead Catholic schools and in the design of Westmead Catholic Community. • Primary school learning areas are separate from secondary school facilities. However, shared resources including specialist learning areas will provide new opportunities for collaboration. Access to these resources will be carefully supervised to ensure that shared usage is safe and appropriate. Visitors to the school will be required to follow strict protocols.

Feedback	Response
<ul style="list-style-type: none"> • Segregation of ages and sex and managing shared services and spaces. 	<ul style="list-style-type: none"> • Open space will be incorporated on each level, and dedicated play areas will be incorporated on selected levels of the building which align to the learning stage and pedagogical needs. • Catherine McAuley Westmead and Parramatta Marist High School will continue to be single-sex schools. • The built form design will enable provision of separate spaces which a designed for the learning stage, age and sex of the students. Connections between buildings and spaces will enable the sharing of services and facilities. • The Westmead Catholic Community will provide additional opportunities for sharing resources and collaboration between schools. This will result in increased subject choices for secondary students and may mean occasionally senior students from Catherine McAuley Westmead and Parramatta Marist High School share a class to make the provision of a specialist subject possible. • Sufficient facilities will be provided to allow for combinations of single-sex and co-educational learning in a limited number of subjects .
<ul style="list-style-type: none"> • Concerns express about managing student safety between the high school and primary schools. 	<ul style="list-style-type: none"> • Student safety has been a key consideration in the planning process for the site. A great benefit of redesigning the site and the buildings will be the ability to ensure site lines for supervision are considered holistically, further adding to the overall safety and wellbeing of each child. The secure school premises feature covered play areas designed for the exclusive use of particular year groupings to provide a safe environment for recreational activities. These arrangements promote student safety and encourage the development of social skills through opportunities to play with students of a similar age.
Open Space	
<ul style="list-style-type: none"> • Clarification sought on the proposed approach to open space, how it will be integrated into the design, and students' level of access to sunlight. • Queries about the staging of delivery of open space • Queries about whether the Marist swimming pool (currently not used) will be reinstated. 	<ul style="list-style-type: none"> • The design of the new facilities for both primary and secondary students at schools in Westmead will see some changes to recreational facilities for students. Open spaces will be complemented by significant investment in creating up-to-date and exciting play and recreation spaces throughout the new buildings. These new spaces will be usable all-year round, in all weather and be tailored for the age groups who use different areas. <p>Research supports spaces like these to encourage more activity in children. Providing spaces throughout the new buildings, as well as on the ground, reduces the need for</p>

Feedback	Response
<ul style="list-style-type: none"> • Queries on size and capacity of the Church. • Expressed interest in ensuring there was good acoustics and noise mitigation between the school and the Church. • Some people stated a preference for the design to be traditional and not modelled on the more contemporary St Patrick's Cathedral Parramatta. 	<p>children to use stairs and lifts during the day and ensures all their break times can be used for play based and social activity. These spaces are also then easily accessible for outdoor learning and breakout areas as part of the overall learning engagement.</p> <ul style="list-style-type: none"> • During the construction, some recreational spaces used by the schools will be relocated. These changes will be made in consultation with the school leadership teams. On completion, Westmead Catholic Community will maintain sufficient play space and open space for the planned number of students on campus. • The current location of the pool will be infilled to enable landscape and open space works. Masterplan engagement and communication will include consultation on the provision of a pool and recreational facilities. • Parishioners and the community will be consulted on the design of the Church. Acoustics will be considered as part of the detailed design process.
Transport and access	
<ul style="list-style-type: none"> • Pedestrian access, traffic and parking is a key concern the increase in development in surrounding Westmead, concern that the increase in population, dwellings and increase in students and Parishioner at Darcy Road will compound this issue. • Seeking more information on traffic management, heavy traffic around Darcy Rd, and surrounding streets • Enquiries received regarding staggered school start times, busy kiss and drop 	<ul style="list-style-type: none"> • The Project Team is working closely with local transport and traffic authorities, NSW Government including Transport NSW, Westmead Alliance and Innovation Precinct Planning, Western Sydney Local Health District, to discuss traffic management and transport. • A traffic engineer will be consulted to provide expert advice on how to best manage the movement of people and vehicles. • This is a major opportunity to improve traffic management and parking across the Darcy Road site, including during construction. A multi-deck carpark is being constructed as the project and a separate secondary school drop off points. Future development will include improvements to the road network (Project 1, Stage 2 and Project 2). • Staggered start times will be continued into the immediate future. The operations of all schools will be reviewed as the proposal progresses and further consultation with

Feedback	Response
<p>and how will this be managed into the future.</p>	<p>parents, caregivers and teachers will be undertaken to further develop an understanding of the community preferences.</p> <ul style="list-style-type: none"> • Kiss and drop for secondary schools on the Darcy Road site will be relocated as part of Project 1, this will alleviate pressure on the current primary school kiss and drop location and improve traffic flow.
<ul style="list-style-type: none"> • Church - request for easy drop off areas for elderly and people with disability, parking availability and access. 	<ul style="list-style-type: none"> • Drop off areas will be considered as part of the design. Parking will be adjacent to the Church.
Construction	
<ul style="list-style-type: none"> • Concerns expressed about construction impacts including noise, dust, debris and contamination on students and staff. 	<ul style="list-style-type: none"> • CEDP is committed to ensuring safety and minimising disruption to current students during construction of new facilities. • A construction management plan will be developed as part of the planning process which will outline ways to mitigate noise, dust and debris. • The Project Team will be working closely with each of the schools to plan ways to schedule classes and activities to minimise disruption to learning and teaching, particularly during major examination periods. • Subject to planning approval, the new Catholic primary school in Westmead will open in 2023. Sacred Heart Primary will continue to operate at its current site until this time, mitigating any construction impacts on Sacred Heart students.
Community benefit	
<ul style="list-style-type: none"> • Queries about the type of complementary uses that may be considered as master planning progresses. 	<ul style="list-style-type: none"> • Westmead Catholic Community will foster collaboration and outreach to enhance the lives of those in need within the local and wider community. As part of the masterplan for the site at Darcy Road, complementary services and uses will be considered to help parishioners, students, their families and the wider community. These could include health care, aged care, university partnerships and accommodation. The community will be invited to provide ideas and feedback on what might be suitable and useful for this site.
<ul style="list-style-type: none"> • Concern about student safety with other uses in the area. 	<ul style="list-style-type: none"> • The safety of all students will always be the number one priority for Westmead Catholic schools and in the design of Westmead Catholic Community. This will be considered during the masterplanning process.

Feedback	Response
<ul style="list-style-type: none"> • Perception of commercialisation of the site. • Interest in how any revenue generated from these uses would be used. 	<ul style="list-style-type: none"> • Westmead Catholic Community will foster collaboration and outreach to enhance the lives of those in need within the local and wider community. Any future uses of the site will be considered against this objective. The community will be consulted during the masterplanning process on any future uses of the site. • Catholic Education Diocese of Parramatta and Diocese of Parramatta will identify complementary uses throughout the masterplanning process that are consistent with the mission and goals of the Westmead Catholic Community. Community engagement will continue through the masterplanning process.
School-specific feedback	
<ul style="list-style-type: none"> • Seeking clarity on the funding of the development and any proposed changes to school fees and building levy – concern that parents will be financially impacted as a result of this change. 	<ul style="list-style-type: none"> • There will be no changes to school fees or levies as a result of this proposal.
<ul style="list-style-type: none"> • Representation, reputation and charisms and how this will be protected. 	<ul style="list-style-type: none"> • Each school will retain their own identity, have a separate Principal, leadership team and appropriate staffing to meet the needs of students. • The Westmead Catholic Community will provide many opportunities for schools to work together, including to share different approaches to contemporary learning with students and their families. As students' progress through the schools, expectations and administrative arrangements will be age-appropriate. There will be many opportunities for siblings of different ages and support needs to share in Westmead Catholic Community celebrations together.

7. OVERVIEW OF FUTURE ENGAGEMENT

At the time of writing this report, community and stakeholder engagement activities are ongoing.

The following activities are scheduled to be jointly delivered by CEDP and Urbis Engagement to support the remaining project phases:

- Engagement number and email will remain active
- Westmead Catholic Community website will be updated at project milestones
- Community Advisory Panel

The purpose of the Westmead Catholic Community Advisory Panel is to play an advisory role in the future options and considerations of the Westmead Catholic Community. The panel will bring together a diversity of views from a broad cross section of the community and provide quality input from the community. The advisory panel will not be a decision-making body.

Expression of interest to participate in the panel was advertised in 2019. The panel will convene for a minimum of 12 months from February 2020.

- Stakeholder briefings with key community leaders, local and state members and neighbouring land owners and community groups.
- Design workshops will be held with the Project Team and key stakeholders including but not limited to members of the school and Parish communities, students, parents and staff. The purpose of the workshops are to discuss the proposed design, masterplan, current uses, opportunities and constraints and specific aspect of the proposed architectural and urban design.
- Letter to school communities
- Media releases
- Newspaper advertisements
- Social media updates
- Community Information Sessions with all school communities to provide an update on the proposal, key project and planning updates and outline the future masterplanning process and further consultation opportunities. Feedback will be collected from the attendees at each session.

DISCLAIMER

This report is dated 20 February 2020 and incorporates information and events up to that date only and excludes any information arising, or event occurring, after that date which may affect the validity of Urbis Pty Ltd's (**Urbis**) opinion in this report. Urbis prepared this report on the instructions, and for the benefit only, of Catholic Education Diocese of Parramatta (**Instructing Party**) for the purpose of Stakeholder and Community Engagement (**Purpose**) and not for any other purpose or use. To the extent permitted by applicable law, Urbis expressly disclaims all liability, whether direct or indirect, to the Instructing Party which relies or purports to rely on this report for any purpose other than the Purpose, and to any other person which relies or purports to rely on this report for any purpose whatsoever (including the Purpose).

In preparing this report, Urbis was required to make judgements which may be affected by unforeseen future events, the likelihood and effects of which are not capable of precise assessment.

All surveys, forecasts, projections and recommendations contained in or associated with this report are made in good faith and on the basis of information supplied to Urbis at the date of this report, and upon which Urbis relied. Achievement of the projections and budgets set out in this report will depend, among other things, on the actions of others over which Urbis has no control.

In preparing this report, Urbis may rely on or refer to documents in a language other than English, which Urbis may arrange to be translated. Urbis is not responsible for the accuracy or completeness of such translations and disclaims any liability for any statement or opinion made in this report being inaccurate or incomplete arising from such translations.

Whilst Urbis has made all reasonable inquiries it believes necessary in preparing this report, it is not responsible for determining the completeness or accuracy of information provided to it. Urbis (including its officers and personnel) is not liable for any errors or omissions, including in information provided by the Instructing Party or another person or upon which Urbis relies, provided that such errors or omissions are not made by Urbis recklessly or in bad faith.

This report has been prepared with due care and diligence by Urbis and the statements and opinions given by Urbis in this report are given in good faith and in the reasonable belief that they are correct and not misleading, subject to the limitations above.

APPENDIX A APPROACH TO ENGAGEMENT MATRIX

Approach to Engagement

extracted from Community and Stakeholder Engagement guidelines, June 2017, Department of Planning and Environment

		Evaluation scale					
		None	Very low	Low	Moderate	High	Very high
	Question						
1	What is the potential direct impact on the community and other stakeholders i.e. on individual properties, amenity or the availability of services?					x	
2	What is the potential indirect impact on the community and other stakeholders?					x	
3	What is the potential for community and other stakeholder uncertainty around environmental impacts or their significance?				x		
4	What is the potential current or likely community and other stakeholder interest based on the type of development?					x	
5	What is the potential current or likely community and other stakeholders interest based on the location of the development?					x	
6	What is the extent of community and other stakeholder involvement historically or currently in developments of this kind or other developments in this location?				x		
7	What is the potential for conflict as a result of differing environmental, economic or social values held by the community and other stakeholders?		x				
8	What is the likelihood that the community and other stakeholders will perceive the potential for significant environmental impacts?			x			
9	What is the current interest level or likely level of interest from recognised community and other stakeholders or interest groups?			x			
10	What is the likely level of involvement that the community and other stakeholders will expect based on previous practice and current activity?			x			
	Total ticks		1	3	2	4	0
	Multiplier to determine engagement	X0	x1	x2	X3	x4	X5
Total = 29 = Medium level of potential community and other stakeholder impact/interest		0	1	6	6	16	0

APPENDIX B WEBSITE

WESTMEAD CATHOLIC COMMUNITY WEBSITE

W: westmeadcatholiccommunity.org

DIocese of PARRAMATTA

[Project](#)
[About](#)
[Community philosophy](#)
[Parish](#)
[FAQs](#)
[Contact us](#)



WESTMEAD CATHOLIC COMMUNITY

Growing together in faith and learning

Second (West) (West) Westmead and local Catholic schools, we're growing to meet the needs of the growing Westmead community. The Westmead Catholic Community project is a strategic response to these needs, providing new facilities at a central location in Cherry Road to support the local community through faith, learning and outreach. This will include new parish and community services and additional sacramental opportunities through major investment in the local Catholic schools.

Parish facilities fit for the future

Second (West) (West) Westmead was founded in 1951, and its community has grown from modest parish church and facilities on South Street. From 2025, new parish facilities will be located at Cherry Road at the heart of the Westmead Catholic Community.

The relocation of the Second (West) Parish will provide new facilities including a church able to accommodate more parishes, meeting rooms to support an active community life and an administration building for effective organisation and outreach to those in need. Working closely with all four Westmead Catholic schools will support the pastoral work of the parish as both formative of students as future community leaders.

A vital community hub

Westmead Catholic Community will foster collaboration and outreach to enhance the lives of those in need within the local and wider community. As part of the masterplan for the site at Cherry Road, complementary services and uses will be considered to help parishioners, students, their

families and the wider community. These could include health care, aged care, university partnerships and social accommodation. The community will be shaped to provide ideas and feedback on what might be suitable and useful for this site. Subject to planning approval, these facilities could be delivered between 2025 and 2030.

A great place to learn, and learn to lead

For students, Westmead Catholic Community will be a contemporary learning environment that gives the potential of students, fostering faith, leadership and sense of belonging. Positioned at a central location and with many grounds, this will provide learning opportunities through industry partnerships and community connections.

Westmead Catholic Community will provide more vibrant opportunities to meet the growing need from families seeking a Catholic education for their children locally. Subject to planning approval, new Catholic primary school facilities in Westmead will open in 2025 and will be located at Cherry Road, Westmead. Second (West) Parish will continue to operate at South Street and Cherry Road, where students will travel to Cherry Road.

The students and staff of all four Westmead Catholic schools will remain strong and active within the Westmead Catholic Community. Second (West) (West) Westmead will care for students from early learning to Year 12 and 13. Further, further Westmead will serve students from Year 12 to Year 13. Expanding educational opportunities at Catholic (Middle Westmead) and (Catholic) (West) High through new facilities at a later date remains a priority.



Project overview

Learn more about the project and key timelines

[Discover](#)



Questions and answers

Answer to your questions

[Learn more](#)



Contact us

Share your thoughts and ideas

[Contact](#)



We're empowering democracy with 

APPENDIX C MEDIA RELEASE

20 September 2019

WESTMEAD CATHOLIC COMMUNITY – THE FUTURE REIMAGINED

Sacred Heart Parish Westmead and local Catholic schools are thriving and now seek the support of the community to meet local needs through the creation of the Westmead Catholic Community. Subject to planning approval, a new Parish church and contemporary school facilities for Sacred Heart Primary, Mother Teresa Primary, Catherine McAuley Westmead and Parramatta Marist High School at a central location in Darcy Road will better support the local community through faith, learning and outreach.

A response to unprecedented population growth and growing demand for Parish infrastructure, education and learning services in Westmead and the local region, the project was launched today by Most Reverend Vincent Long Van Nguyen OFM Conv DD STL, Bishop of Parramatta; Brother Peter Carroll FMS and Sister Mary-Louise Petro RSM.

“Westmead Catholic Community is a collaboration between the Diocese of Parramatta including its agencies and Sacred Heart Parish, and those who laid the foundations of this vibrant community: the Sisters of Mercy Parramatta and the Marist Brothers. I also acknowledge all who have contributed to the history of the Parish, both Religious and laypeople. This will be a wonderful expression of Church and Mission and an opportunity to do more for the local community,” Bishop Vincent said.

The first phase of the Westmead Catholic Community project is the building of new facilities for the Sacred Heart Church and primary school on the Darcy Road site. It will also involve the creation of a Catholic Early Learning Centre on the Darcy Road site. These facilities are set to open in 2023.

The second phase of the Westmead Catholic Community project - new facilities at Catherine McAuley and Parramatta Marist and other complementary and community facilities - is a longer term program, set to occur from 2025-2028. Over time, students will be provided with contemporary learning opportunities from the adjacent health and education precincts. The new facilities are also expected to benefit the broader local community.

Sacred Heart Parish Westmead was founded in 1951, and its community has outgrown the modest Parish Church and facilities in Ralph Street. Sacred Heart Primary was established by the Sisters of Mercy Parramatta in 1956 and has also outgrown its small premises in Ralph Street, Westmead.

The identities and traditions of all four Westmead Catholic schools will remain strong and vibrant within the Westmead Catholic Community: Sacred Heart Primary Westmead will cater for students from Early Learning to Year 2 and Mother Teresa Primary Westmead will serve students from Year 3 to Year 6.

The planning application for new Sacred Heart Parish and primary school facilities is expected to be lodged with the Department of Planning, Industry and Environment (DPIE) in late 2019. The plans will be on public exhibition in early 2020.

Community engagement will commence in September 2019 and will include information sessions and workshops. Parents and community members are encouraged to attend and learn more about the proposal.

Please visit www.westmeadcatholiccommunity.org for more information.

Media enquiries: Dianne Knott on 0401 456 656.

APPENDIX D LETTER TO SCHOOLS

29 October 2017

Westmead Catholic Community Project

Dear friends

On the Feast of St Mary of the Cross MacKillop, Bishop Vincent wrote to us about responding to growth and need in Western Sydney. It is in that spirit that I invite you to be part of an exciting project that will grow our local Catholic community.

As you know, Westmead is experiencing both population growth and significant government infrastructure investment. Bishop Vincent flagged that the Diocese of Parramatta will also undertake a new project in Westmead, furthering the Church's mission in response to our local needs. The project, which will involve our parish as well as all four local Catholic schools, is critically important if we are going to be able to meet our pastoral commitments as Westmead grows, particularly caring for those most in need.

This project of reimagination and renewal is called the *Westmead Catholic Community Project*. It will allow us to be more and to do more for the community we serve. For our local Catholic schools in particular, it will mean closer collaboration with the parish and each other. There will also be significant opportunities to partner with other institutions such as the University of Sydney, Western Sydney University, Westmead Hospital and Westmead Children's Hospital as part of the NSW government's redevelopment of the Westmead Hospital Precinct. The project will make Westmead one of the largest health, education, research and training precincts in Australia and a key provider of jobs for the greater Parramatta and western Sydney region.

We are already unable to meet the demand for enrolments at the four outstanding Westmead Catholic schools – our two parish schools, Sacred Heart Primary and Mother Teresa Primary, and Catherine McAuley and Parramatta Marist High School. This means that families seeking to join the Westmead Catholic community through a quality faith-based education for their children are often turned away.

Each of these schools has a strong community and culture. The charisms of the Parramatta Sisters of Mercy and the Marist Brothers are deeply embedded in the everyday life and culture of our local schools and we are committed to ensuring this rich heritage continues into the future. One of the aims of the project is to provide opportunities for more families to experience a high-quality Catholic education by being part of the Westmead Catholic community. All four schools will continue to operate separately but with a higher degree of cooperation and partnership.

These are early days and we have only just begun the process of considering what Westmead Catholic community could look like. Each of us has a valuable contribution to make to the process of determining how we can best meet the needs of our community into the future. Together with the Diocese, I am committed to consulting widely and valuing the voices of the whole community, especially those from our parish.

Similarly, our parish church, originally intended as an interim place of worship, struggles to meet the current worshipping and pastoral needs of the parish. Reimagining the Westmead Catholic community will consider the possibility of an expanded church.

More information will be shared with you about the *Westmead Catholic Community Project* as it progresses. This will include dates for community consultations and a link to a website that will contain details about the project. The website will be progressively updated with new information.

This is a very exciting time and I look forward to sharing this journey with you and ask for your prayers as, together, we reimagine Jesus' mission in our community.

Yours sincerely in Christ

A handwritten signature in black ink, appearing to read 'Walter Fogarty', with a stylized flourish at the end.

Father Walter Fogarty

Parish Priest

Sacred Heart Parish

Communication to teachers and unions

26 October 2017

Westmead Catholic Community Project

Dear colleagues

I am writing to you with exciting news that, over time, will transform Westmead Catholic schools and parish. An initiative of the Diocese of Parramatta, the *Westmead Catholic Community Project* will reimagine the way that the Church meets the needs of the growing Westmead community.

The *Westmead Catholic Community Project* will provide opportunities for more families to experience a high-quality Catholic education. As you know, Catholic Education Diocese of Parramatta (CEDP) is already unable to meet the demand for enrolments at our two parish schools, Sacred Heart Primary and Mother Teresa Primary, and Catherine McAuley and Parramatta Marist High School. With the area continuing to grow and major infrastructure planned, this is the right time to be thinking about how we can be more and do more for the Westmead community.

The *Westmead Catholic Community Project* does not involve combining schools. I want to be very clear that all four Catholic schools will continue to operate separately. In particular, we are committed to ensuring the rich heritage and charisms of the Parramatta Sisters of Mercy and the Marist Brothers remain deeply embedded in the everyday life and culture of our local schools. To realise the benefits of being a community of Catholic schools in the Westmead precinct, these schools will however work in closer collaboration, cooperation and partnership.

The *Westmead Catholic Community Project* will mean closer collaboration between schools and the parish. There will also be opportunities to partner with other institutions such as the University of Sydney, Western Sydney University, Westmead Hospital and Westmead Children's Hospital as part of the NSW government's redevelopment of the Westmead Hospital Precinct.

This project is not connected in any way to the current enterprise agreement negotiations. It is all about ensuring a vibrant and flourishing faith and education community into the future and one that will benefit students, families, staff and the broader parish community.

I look forward to your input as, together, we determine how we can best meet the needs of our community through this exciting initiative. Dates for community consultations and a link to a website that will be progressively updated with new information will be shared with you as the project progresses.

Regards

Greg Whitby

Communication to parents and carers

26 October 2017

Westmead Catholic Community Project

Dear parents and carers

We are writing to you with exciting news that, over time, will transform Westmead Catholic schools and parish. An initiative of the Diocese of Parramatta, the *Westmead Catholic Community Project* will reimagine the way that the Diocese realises the Church's mission in responding to the needs of the growing Westmead community.

The *Westmead Catholic Community Project* will provide opportunities for more families to experience a high-quality Catholic education. As you know, Catholic Education Diocese of Parramatta (CEDP) is already unable to meet the demand for enrolments at our two parish schools - Sacred Heart Primary and Mother Teresa Primary, and Catherine McAuley and Parramatta Marist High School. With the area continuing to grow, and major infrastructure planned by private and government sectors, this is the right time to be thinking about how we can be more and do more for the Westmead community.

The *Westmead Catholic Community Project* does not involve combining schools. I want to be very clear that all four schools will continue to operate separately. In particular, we are committed to ensuring the rich heritage and charisms of the Parramatta Sisters of Mercy and the Marist Brothers remain deeply embedded in the everyday life and culture of our local schools. To realise the benefits of being a community of Catholic schools in the Westmead precinct, these schools will however work in closer collaboration, cooperation and partnership.

The *Westmead Catholic Community Project* will mean closer collaboration between schools and the Sacred Heart Parish, ensuring a greater integration and expansion of pastoral and faith initiatives in response to the community's needs. Also, there will also be opportunities to partner with other institutions such as the University of Sydney, Western Sydney University, Westmead Hospital and Westmead Children's Hospital as part of the NSW government's redevelopment of the Westmead Hospital Precinct.

This project is about guaranteeing a vibrant and flourishing faith and education community into the future, and one that will benefit students, families, staff and the broader parish community. We look forward to your input as together we determine how we can best meet the needs of our community.

Dates for community consultations and a link to a website that will be progressively updated with new information will be shared with you as the project progresses.

Kind regards

Father Walter Fogarty PP and Greg Whitby

APPENDIX E LETTER TO PARISH



20 September 2019

Dear fellow parishioners,

As you know, Sacred Heart Parish Westmead was founded in 1951 and our thriving community has outgrown our modest church and Parish facilities in Ralph Street. I am writing to you with significant news about the future of Sacred Heart Parish, as well as local Catholic schools.

Today, Bishop Vincent Long, Bishop of Parramatta, announced that from 2020 to 2028, and subject to the necessary planning and regulatory approvals, new Parish facilities including a church, new facilities for Sacred Heart Primary, Mother Teresa Primary, Catherine McAuley Westmead and Parramatta Marist High School, a Catholic Early Learning Centre and a learning centre for students with high support needs and a moderate intellectual disability will be built at a central location on Darcy Road.

The new facilities will better support the parish and schools in their mission through faith formation, evangelisation, pastoral care, outreach and learning. Being a fresh and vibrant expression of Church will benefit the wider local area. To be known as the Westmead Catholic Community, the first stage of the project – the co-locating of Sacred Heart Parish and Primary with a new Catholic Early Learning Centre and other Westmead Catholic schools on Darcy Road - will open in 2023.

The second phase of the Westmead Catholic Community project - new facilities at Catherine McAuley, Parramatta Marist High School, a learning centre on site for students with high support needs and a moderate intellectual disability and other complementary and community facilities - is set to open at a later date. The new facilities are expected to benefit the local community as well.

Westmead Catholic Community is a collaboration between the Diocese of Parramatta, including many of its agencies, Sacred Heart Parish, and those who laid the foundations upon whose charisms the community continues to grow: the Sisters of Mercy Parramatta and the Marist Brothers. Representatives of both these orders joined Bishop Vincent today to make this important announcement about the long-term future of Sacred Heart Parish and Westmead Catholic schools. Bishop Vincent identified the project as “a wonderful expression of Church and Mission and opportunity to do more for the local community.”

The planning application for new Sacred Heart Parish and primary school facilities is expected to be lodged with the Department of Planning, Industry and Environment (DPIE) in late 2019. The plans will be on public exhibition in early 2020.

Next weekend, two information sessions will be held so that Sacred Heart parishioners can learn more. There will be many opportunities for parishioner and community engagement, including the formation of a Community Advisory Panel and Parish Vision Committee. A website with more information is available here: www.westmeadcatholiccommunity.org.

As we embark on this new era for our parish, I ask for your prayers for our parish during this time of transition as we continue to respond to Christ's call to be effect witnesses of the Word in our local community.

With every blessing

Fr Walter Fogarty

Parish Priest

Sacred Heart Parish Westmead

APPENDIX F INFORMATION BOARDS

WESTMEAD CATHOLIC COMMUNITY

Growing together in faith and learning

- Sacred Heart Parish Westmead
- Catherine McAuley Westmead
- Mother Teresa Primary School
- Parramatta Marist High School
- Sacred Heart Primary School

Sacred Heart Parish Westmead and local Catholic schools are growing to meet the needs of the growing Westmead community. The Westmead Catholic Community project is a response to these needs, providing new facilities at a central location in Darcy Road to support the local community through faith, learning and outreach.

This will include new Parish and community services and additional enrolment opportunities through major investment in the four outstanding Westmead Catholic schools.

SNAPSHOT



By 2041 additional 252,591 persons



3400 new dwellings



New lightrail in 2023



New Early Learning Centre, community outreach and facilities



Sacred Heart Parish Church set to open in 2023.

Have your say:

T: (02) 9840 5600

E: communityliaison@parra.catholic.edu.au

“Westmead Catholic Community is a collaboration between the Diocese of Parramatta including its agencies and Sacred Heart Parish, and those who laid the foundations of this vibrant community: the Sisters of Mercy Parramatta and the Marist Brothers. I also acknowledge all who have contributed to the history of the Parish, both Religious and laypeople. This will be a wonderful expression of Church and Mission and an opportunity to do more for the local community,”

– **Most Reverend Vincent Long Van Nguyen OFM Conv DD STL**
Bishop of Parramatta



DIOCESE of
PARRAMATTA



A GROWING COMMUNITY

A faith and learning community that works together to share ideas, facilities and learning. Providing opportunities to benefit our families and the wider community.

Parish facilities fit for the future

Sacred Heart Parish Westmead was founded in 1951, and its community has outgrown the modest Parish Church and facilities in Ralph Street.

From 2023, new Parish facilities will be located at Darcy Road, at the heart of the Westmead Catholic Community.

The relocation of the Sacred Heart Parish will provide new facilities including a church able to accommodate more parishioners, meeting rooms to support an active community life and an administration block to foster effective organisation and outreach to those in need. Sharing the site with all four Westmead Catholic schools will support the pastoral work of the Parish in faith formation of students as future community leaders.

A vital community hub

Westmead Catholic Community will foster collaboration and outreach to enhance the lives of those in need within the local and wider community. As part of the masterplan for the site at Darcy Road, complementary services and uses will be considered to help parishioners, students, their families and the wider community. These could include health care, aged care, university partnerships and accommodation. The community will be invited to provide ideas and feedback on what might be suitable and useful for this site. Subject to planning approval, these facilities would be delivered between 2025 and 2028.

Building industry partnerships

Westmead is a growing health and innovation precinct. The close location with world leading health, education, science and innovative organisations will enable real-world learning, going beyond the classroom.

“

Sacred Heart Parish Westmead and local Catholic schools are growing to meet the needs of the growing Westmead community.



DIOCESE of
PARRAMATTA



LEARNING TOGETHER

A great place to learn, and learn to lead

Westmead Catholic Community will be a contemporary learning environment that grows the potential of students, responds to their needs as well as fostering faith, leadership and sense of belonging.

Being positioned in a world class health and education precinct will provide learning opportunities through industry partnerships and community connections.

Westmead Catholic Community will provide more enrolment opportunities to meet the growing need from families seeking a Catholic education for their children locally. Subject to planning approval, new Catholic primary school facilities in Westmead will open in 2023 and will be located at Darcy Road Westmead. Sacred Heart Primary will continue to operate at its current site until this time, when students will move to Darcy Road.

The identities and traditions of all four Westmead Catholic schools will remain strong and vibrant within the Westmead Catholic Community: Sacred Heart Primary Westmead will cater for students from Early Learning to Year 2 and Mother Teresa Primary Westmead will serve students from Year 3 to Year 6. Expanding enrolment opportunities at Catherine McAuley Westmead and Parramatta Marist High School through new facilities at a later date remains a priority.

Westmead Catholic Community is a collaboration between the Diocese of Parramatta including its agencies and Sacred Heart Parish, as well as those who laid the foundations upon whose charisms the community continues to grow, the Sisters of Mercy Parramatta and Marist Brothers. Each school will make a significant contribution to this vibrant Catholic community with a long-term commitment to the care of all people, especially those most in need.



DIOCESE of
PARRAMATTA

WESTMEAD CATHOLIC COMMUNITY

Growing together in faith and learning

- Sacred Heart Parish Westmead
- Catherine McAuley Westmead
- Mother Teresa Primary School
- Parramatta Marist High School
- Sacred Heart Primary School

Sacred Heart Parish Westmead and local Catholic schools are growing to meet the needs of the growing Westmead community. The Westmead Catholic Community project is a response to these needs, providing new facilities at a central location in Darcy Road to support the local community through faith, learning and outreach.

This will include new Parish and community services and additional enrolment opportunities through major investment in the four outstanding Westmead Catholic schools.

SNAPSHOT



By 2041 additional 252,591 persons



3400 new dwellings



New lightrail in 2023



New Early Learning Centre, community outreach and facilities



Sacred Heart Parish Church set to open in 2023.

Have your say:

T: (02) 9840 5600

E: communityliaison@parra.catholic.edu.au

“Westmead Catholic Community is a collaboration between the Diocese of Parramatta including its agencies and Sacred Heart Parish, and those who laid the foundations of this vibrant community: the Sisters of Mercy Parramatta and the Marist Brothers. I also acknowledge all who have contributed to the history of the Parish, both Religious and laypeople. This will be a wonderful expression of Church and Mission and an opportunity to do more for the local community,”

– **Most Reverend Vincent Long Van Nguyen OFM Conv DD STL**
Bishop of Parramatta



DIOCESE of
PARRAMATTA



A GROWING COMMUNITY

A faith and learning community that works together to share ideas, facilities and learning. Providing opportunities to benefit our families and the wider community.

Parish facilities fit for the future

Sacred Heart Parish Westmead was founded in 1951, and its community has outgrown the modest Parish Church and facilities in Ralph Street.

From 2023, new Parish facilities will be located at Darcy Road, at the heart of the Westmead Catholic Community.

The relocation of the Sacred Heart Parish will provide new facilities including a church able to accommodate more parishioners, meeting rooms to support an active community life and an administration block to foster effective organisation and outreach to those in need. Sharing the site with all four Westmead Catholic schools will support the pastoral work of the Parish in faith formation of students as future community leaders.

A vital community hub

Westmead Catholic Community will foster collaboration and outreach to enhance the lives of those in need within the local and wider community. As part of the masterplan for the site at Darcy Road, complementary services and uses will be considered to help parishioners, students, their families and the wider community. These could include health care, aged care, university partnerships and accommodation. The community will be invited to provide ideas and feedback on what might be suitable and useful for this site. Subject to planning approval, these facilities would be delivered between 2025 and 2028.

Building industry partnerships

Westmead is a growing health and innovation precinct. The close location with world leading health, education, science and innovative organisations will enable real-world learning, going beyond the classroom.

“

Sacred Heart Parish Westmead and local Catholic schools are growing to meet the needs of the growing Westmead community.



DIOCESE of
PARRAMATTA



LEARNING TOGETHER

A great place to learn, and learn to lead

Westmead Catholic Community will be a contemporary learning environment that grows the potential of students, responds to their needs as well as fostering faith, leadership and sense of belonging.

Being positioned in a world class health and education precinct will provide learning opportunities through industry partnerships and community connections.

Westmead Catholic Community will provide more enrolment opportunities to meet the growing need from families seeking a Catholic education for their children locally. Subject to planning approval, new Catholic primary school facilities in Westmead will open in 2023 and will be located at Darcy Road Westmead. Sacred Heart Primary will continue to operate at its current site until this time, when students will move to Darcy Road.

The identities and traditions of all four Westmead Catholic schools will remain strong and vibrant within the Westmead Catholic Community: Sacred Heart Primary Westmead will cater for students from Early Learning to Year 2 and Mother Teresa Primary Westmead will serve students from Year 3 to Year 6. Expanding enrolment opportunities at Catherine McAuley Westmead and Parramatta Marist High School through new facilities at a later date remains a priority.

Westmead Catholic Community is a collaboration between the Diocese of Parramatta including its agencies and Sacred Heart Parish, as well as those who laid the foundations upon whose charisms the community continues to grow, the Sisters of Mercy Parramatta and Marist Brothers. Each school will make a significant contribution to this vibrant Catholic community with a long-term commitment to the care of all people, especially those most in need.



DIOCESE of
PARRAMATTA

CONNECTING OUR COMMUNITIES

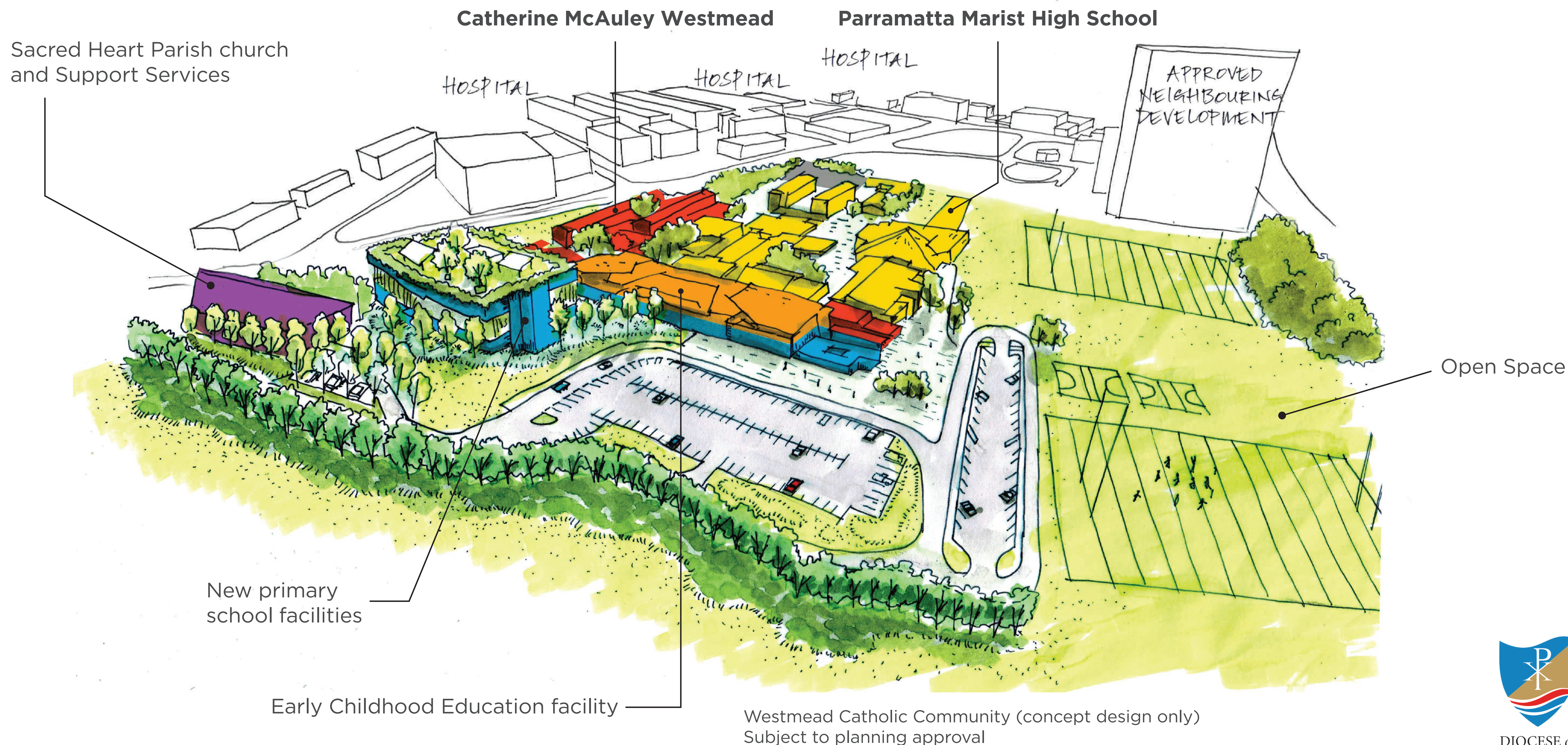

WESTMEAD CATHOLIC COMMUNITY: STAGE ONE

Stage one of the Westmead Catholic Community project, new Parish and primary school facilities and a Catholic Early Learning Centre, is set to open in 2023.



KEY

- Existing Catherine McAuley Westmead
- Existing Parramatta Marist High School
- New Sacred Heart Primary Westmead
- New Mother Teresa Primary (including integrated open space)
- New Church and Parish Centre
- Existing on-grade carpark
- New Multi Storey School Carpark and Senior Schools drop-off

Subject to planning approval

Westmead Catholic Community 2023 (concept only)

WESTMEAD CATHOLIC COMMUNITY: STAGE TWO

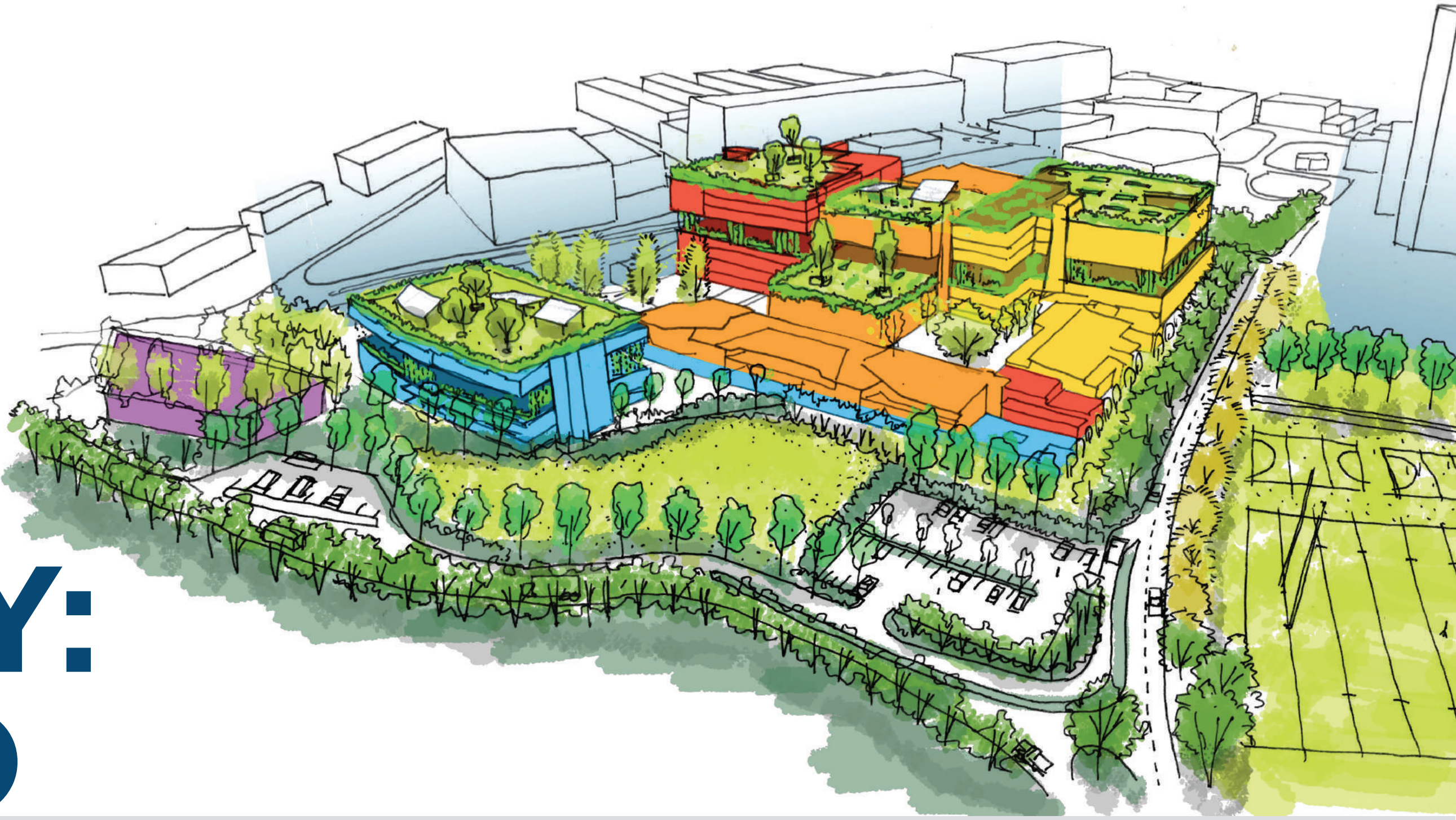

Stage two of the Westmead Catholic Community project, new facilities at Catherine McAuley Westmead and Parramatta Marist High and other complementary and community facilities, is set to open between 2025-28. A masterplan will be developed in consultation with Sacred Heart Parish, all schools and the wider community.



- KEY**
- New Catherine McAuley Westmead (including integrated open space)
 - New Parramatta Marist High School (including integrated open space)
 - New Secondary Specialist Facilities (including integrated open space)
 - New Sacred Heart Primary Westmead (including integrated open space)
 - New Mother Teresa Primary
 - New Church and Parish Centre
 - New Multi Storey School Carpark
 - Future Complementary Uses

Subject to planning approval

Westmead Catholic Community 2025-8 (concept only)

WHAT'S NEXT

Parish church, Early Learning Centre and K-6 school

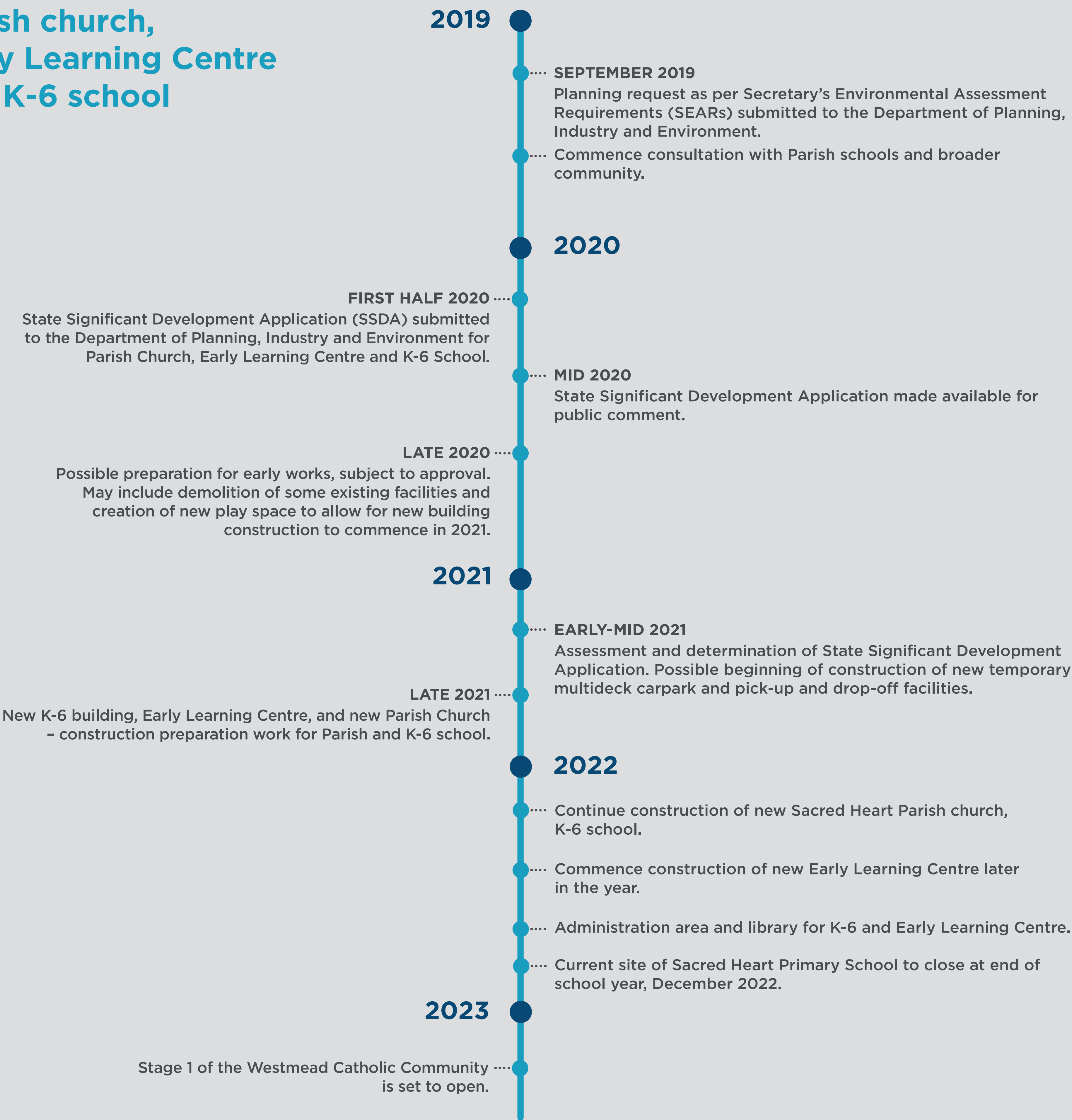

Timeframes for the full masterplan are under development.

APPENDIX G FREQUENTLY ASKED QUESTIONS

Frequently Asked Questions

Why Westmead Catholic Community?

Sacred Heart Parish Westmead and local Catholic schools are growing to meet the needs of the growing Westmead community. The Westmead Catholic Community project is a strong response to these needs, building on the strengths of the Parish and each school by providing new facilities at a central location in Darcy Road to support the local community through faith, learning and outreach. This will include new Parish and community services and additional enrolment opportunities through major investment in the four outstanding Westmead Catholic schools.

Key Facts:

- Sacred Heart Parish Westmead was founded in 1951, and its community has outgrown the modest Parish church and facilities in Ralph Street
- Sacred Heart Primary was established by the Sisters of Mercy Parramatta in 1956 and has also outgrown its small premises in Ralph Street, Westmead
- Each of the four Catholic schools in Westmead is unable to meet the demand for enrolment, collectively turning away more than 500 children seeking a Catholic education each year
- The thriving Westmead precinct will see significant population growth in coming years
- The Westmead Catholic Community will be a fresh expression of Church for the local area
- New facilities will support local Catholic schools to offer a dynamic and contemporary learning environment
- The first phase of the Westmead Catholic Community project - new Parish and primary school facilities and a Catholic Early Learning Centre - is set to open in 2023.
- The second phase of the Westmead Catholic Community project, new facilities at Catherine McAuley Westmead and Parramatta Marist High School and other complementary and community facilities, is set to open at a later date.

What is the enrolment situation in Westmead Catholic schools today?

Catholic schools in Westmead are unable to meet growing demand, turning away more than 500 enrolment applicants every year for several years. A plan has been announced by the Diocese of Parramatta, the trustees of the Marist Brothers and supported by the Sisters of Mercy Parramatta, to provide more enrolment opportunities to meet the growing need from families seeking a Catholic education for their children locally. These changes are part of the Westmead Catholic Community initiative, which also includes new Parish facilities.

Subject to planning approval, new Catholic primary school facilities in Westmead will open in 2023 and will be located at Darcy Road, Westmead. Sacred Heart Primary will continue to operate at its current site until this time, when students will move to Darcy Road. The identities and traditions of each primary school will remain strong and vibrant within the Westmead Catholic Community: Sacred Heart Primary Westmead will cater for students from Early Learning to Year 2 and Mother Teresa Primary Westmead will serve students from Year 3 to Year 6. Expanding enrolment opportunities at Catherine McAuley Westmead and Parramatta Marist High School through new facilities at a later date remains a priority

How will the changes impact on enrolment opportunities and processes in Westmead Catholic schools?

Catholic schools in Westmead will remain focused on ensuring the needs of students and their families are met. In the first instance, additional places will be available for primary school only and it is anticipated that enrolments will increase gradually. Please note that after 2023, students enrolled in Sacred Heart Primary for Early Childhood Education to Year 2 will be automatically transferred to Mother Teresa Primary for Year 3 to Year 6. Expanding enrolment opportunities at Catherine McAuley Westmead and Parramatta Marist High School through new facilities at a later date remains a priority.

As indicated earlier, and subject to the necessary approvals, 2023 is the scheduled time for the opening of the new primary school and Parish facilities. [Catholic Education Diocese of Parramatta's enrolment policy](#) continues to apply to all Catholic schools in Westmead.

What do the changes mean for staff?

As we work together to meet increasing need for Catholic school places in Westmead, it is anticipated that there will be increased employment opportunities for teachers and support staff. Catholic Education Diocese of Parramatta is committed to fair and transparent processes as the Westmead Catholic Community grows and will keep staff informed.

In the long-term, Westmead Catholic Community will also provide additional opportunities for sharing resources, collaboration between schools, pathways and partnerships. New facilities will support schools to offer a dynamic and contemporary learning environment. The project will result in increased subject choices for secondary students and may mean, for example, students share a class to support the provision of a specialist subject that they may otherwise not have had the chance to study. This may provide opportunities to teach students at both Catherine McAuley Westmead and Parramatta Marist High School. Teachers will continue to be required to be appropriately qualified for the work they are engaged in.

How will Catholic Education Diocese of Parramatta support the increased size of the schools in Westmead?

Catholic schools in Westmead are committed to meeting the needs of every learner. This includes ensuring that students are supported through appropriate structures and pastoral care during growth within their own school communities.

Westmead Catholic Community will provide additional opportunities for sharing of resources between schools to cater to specific student needs. A learning centre on site for students with high support needs and a moderate intellectual disability and a Catholic Early Learning Centre are also planned for the site.

The current site of Sacred Heart Primary is extremely limited and its classroom facilities were not designed to support contemporary learning. The school site also includes some playground space on short-term lease from the Anglican Church. It is anticipated that the Westmead Catholic Community initiative will provide more space for students to learn and play at the new location on Darcy Road.

What is the plan for traffic management and parking?

Traffic management has been and will continue to be a major consideration in the planning for the Westmead Catholic Community initiative. The Project Team are working closely with local transport and traffic authorities, NSW Government including Transport NSW and Western Sydney Local Health District, to discuss traffic management and transport. A traffic engineer will be consulted to provide expert advice on how to best manage the movement of people and vehicles. This is a major opportunity to improve traffic management and parking across the Darcy Road site, including during construction. A multi-deck carpark is being constructed as part of Stage 1 of the project, as well as drop off and access routes to school.

Safe and healthy travel to school is an important consideration for the planning and design process. At present, 75% of students at Catherine McAuley Westmead and Parramatta Marist High School travel to school by public transport or on foot. In the medium to long-term, the Westmead precinct will benefit from active pedestrian and cycle paths, Parramatta Light Rail, Sydney Metro West and the existing heavy rail and T-Way.



These facilities will support increased use of active travel and public transport, particularly for older students and those who will live within the Westmead precinct. "Active travel means walking, cycling, scootering, skateboarding or any similar transport where human energy is spent to travel" (NSW Government, Healthy Kids). Parents, students, staff and community will be invited to participate in discussions on 'active travel' during consultation for the Masterplan.

How will recreational facilities change for students?

The design of the new facilities for both primary and secondary students at schools in Westmead will see some changes to recreational facilities for students. Open spaces will be complemented by significant investment in creating up-to-date and exciting play and recreation spaces throughout the new buildings. These new spaces will be usable all-year round, in all weather and be tailored for the age groups who use different areas.

Research supports spaces like these to encourage more activity in children. Providing spaces throughout the new buildings, as well as on the ground, reduces the need for children to use stairs and lifts during the day and ensures all their break times can be used for play based and social activity. These spaces are also then easily accessible for outdoor learning and breakout areas as part of the overall learning engagement.

During the construction, some recreational spaces used by the schools will be relocated. These changes will be made in consultation with the school leadership teams. On completion, Westmead Catholic Community will maintain sufficient play space and open space for the planned number of students on campus.

How will student safety be ensured?

The safety of all students will always be the number one priority for Westmead Catholic schools and in the design of Westmead Catholic Community. Primary school learning areas are separate from secondary school facilities. However, shared resources including specialist learning areas will provide new opportunities for collaboration. Access to these resources will be carefully supervised to ensure that shared usage is safe and appropriate. Visitors to the schools will be required to follow strict protocols.

Student safety has been a key consideration in the planning process for the site. A great benefit of redesigning the site and the buildings will be the ability to ensure sight lines for supervision are considered holistically, further adding to the overall safety and well being of each child. The secure school premises feature covered play areas designed for the exclusive use of particular year groupings to provide a safe environment for recreational activities. These arrangements promote student safety and encourage the development of social skills through opportunities to play with students of a similar age.

Will Catherine McAuley Westmead and Parramatta Marist High School still be single-sex schools?

Yes, Catherine McAuley Westmead and Parramatta Marist High School will still be single-sex schools. The Westmead Catholic Community will provide additional opportunities for sharing resources and collaboration between schools. This will result in increased subject choices for secondary students and may mean occasionally senior students from Catherine McAuley Westmead and Parramatta Marist High School share a class to make the provision of a specialist subject possible. Sufficient facilities will be provided to allow for combinations of single-sex and co-educational learning in a limited number of subjects for the two separate Year 7 to 12 secondary schools.

What does this mean for each of the local schools?

Westmead Catholic Community is committed to increasing enrolment opportunities for local families. To support the growth of local schools, Sacred Heart Primary Westmead will cater for students from Early Learning to Year 2 and Mother Teresa Primary Westmead will serve students from Year 3 to Year 6.

Each school will have a separate Principal, leadership team and appropriate staffing to meet the needs of students. The Diocese of Parramatta is committed to fair and transparent processes as the Westmead Catholic Community grows and will keep families and staff informed.



The Westmead Catholic Community will provide many opportunities for schools to work together, including to share different approaches to contemporary learning with students and their families. As students progress through the schools, expectations and administrative arrangements will be age-appropriate. There will be many opportunities for siblings of different ages and support needs to share in Westmead Catholic Community celebrations together.

We appreciate that some parents will have concerns about what these changes might mean for primary school uniforms. Please be assured that any changes will be a process undertaken in consultation with families with the priority being to ensuring the least financial impact to everyone.

What will the changes mean for families and siblings?

The Westmead Catholic Community will see local Catholic systemic schools located on the same site. A learning centre on site for students with high support needs and a moderate intellectual disability and a Catholic Early Learning Centre are also planned as part of the initiative. This may provide convenience for some families including opportunities for siblings to travel to school together. There will be many opportunities for siblings of different ages and support needs to share in Westmead Catholic Community celebrations together.

How will the impacts of construction be safely managed so that disruption to schooling is minimised?

Westmead Catholic schools are committed to ensuring safety and minimising disruption to current students during construction of new facilities. A construction management plan will be developed as part of the planning process which will outline ways to mitigate noise, dust and debris. The Project Team will be working closely with each of the schools to plan ways to schedule classes and activities to minimise disruption to learning and teaching, particularly during HSC trials and examinations.

Subject to planning approval, the new Catholic primary school in Westmead will open in 2023. Sacred Heart Primary will continue to operate at its current site until this time.

Marist Brothers' Residence

There are three Marist Brothers who currently live in the Marist Brothers' residence on Darcy Road, Westmead. This building will be demolished during Stage 1 of the Westmead Catholic Community project. This community will be relocated to a mutually agreed location with care and consideration. Suitable accommodation will be provided to the Brothers to ensure the ongoing presence of the Marist Brothers in the community.

Where will Jesuit Refugee Services be located?

Jesuit Refugee Services currently provides some services from the Marist Brothers' residence on Darcy Road. The arrangement between the Trustees of the Marist Brothers and Jesuit Refugee Services will continue until the date previously agreed. After this time, it is hoped that the Diocese of Parramatta and the Trustees of the Marist Brothers can work together with Jesuit Refugee Services in identifying suitable premises locally to continue their important work.

What is the planning process?

The Westmead Catholic Community project meets the NSW Government definition of a State Significant Project. Therefore, the relevant decision-making body is the Department of Planning, Industry & Environment (DPIE).

What other services and uses will be coming to Westmead Catholic Community?

Westmead Catholic Community will foster collaboration and outreach to enhance the lives of those in need within the local and wider community. As part of the masterplan for the site at Darcy Road, complementary services and uses will be considered to help parishioners, students, their families and the wider community. These could include health care, aged care, university partnerships and accommodation. The community will be invited to provide ideas and feedback on what might be suitable and useful for this site.

What are the environmental impacts of the Westmead Catholic Community project?



As part of the Catholic Church, Westmead Catholic Community shares a responsibility to care for God's creation. The project will comply with all government requirements regarding environmental impacts. Facilities provided as part of the project will be more environmentally efficient. There will also be the possibility of Westmead Catholic schools participating in the Catholic Education Diocese of Parramatta Energy Efficiency Program.

Will any land be sold?

The future of the land at Ralph Street that is currently the site of Sacred Heart church and Primary School has not yet been determined. However, in the event that this land is sold, the proceeds will be dedicated to funding the new Sacred Heart Parish church. Please note that part of the site currently used by Sacred Heart Primary for recreation belongs to the Anglican Church and the lease for this part of the property is expected to conclude in the next few years.

In reference to the Darcy Street site, the Church is not currently planning to sell any of its landholding. However, any future decisions regarding the sale of land would be carefully considered in terms of impacts on the Westmead Catholic Community and stewardship responsibilities.

Have your say

You can submit your feedback here: www.westmeadcatholiccommunity.org. A Westmead Catholic Community Advisory Panel will also be established to bring together voices from across the Parish, school and local communities. We are looking for people who want to help guide and shape the Westmead Catholic Community.

This panel will provide advice and support to the Project Team and meet on a monthly basis.

What is the timeline for Westmead Catholic Community?

Late 2019

- New K-6 building, Early Learning Centre, and new Parish facilities including church – Planning request as per Secretary's Environmental Assessment Requirements (SEARs) submitted to the Department of Planning, Industry and Environment
- Commence consultation with Westmead Catholic Community on the Masterplan including new facilities for Catherine McAuley Westmead and Parramatta Marist High School.

First Half 2020

- New K-6 building, Early Learning Centre, and new Parish facilities including church – State Significant Development Application (SSDA) submitted to the Department of Planning, Industry and Environment (DPIE).

Mid 2020

- New K-6 building, Early Learning Centre, and new Parish facilities including church – State Significant Development Application made available for public comment.

Late 2020

- New K-6 building, Early Learning Centre, and new Parish Church – Possible preparation for early works, subject to further approval. May include demolition of some existing facilities and creation of new play space to allow for new building construction to commence in 2021.



Early-Mid 2021

- New K-6 building, Early Learning Centre, and new Parish facilities including church – Assessment and determination of State Significant Development Application.
- Possible beginning of construction of new temporary multi-deck carpark and pick-up and drop-off facilities

Late 2021

- New K-6 building, Early Learning Centre, and new Parish Church – further construction preparation work and possibly commencement of construction of some new buildings for Parish and K-6 school.
- 2022
- Continue construction of new Sacred Heart Parish church, K-6 school
- Commence construction of new Early Learning Centre later in the year
- Administration area and library for K-6 and Early Learning Centre
- Current site of Sacred Heart Primary School to close at end of school year, December 2022.

2023

- Stage 1 of the Westmead Catholic Community is set to open.



APPENDIX H FEEDBACK FORM

WESTMEAD CATHOLIC COMMUNITY FEEDBACK FORM

1. Please tick which category below describes you best?

- | | |
|---------------------------------------------------------------------------|------------------------------------------------------------------------|
| <input type="checkbox"/> Parishioner of Sacred Heart Parish Westmead | <input type="checkbox"/> Former student of Sacred Heart Primary School |
| <input type="checkbox"/> Sacred Heart Primary School, parent or caregiver | <input type="checkbox"/> Local resident |
| <input type="checkbox"/> Sacred Heart Primary School, teacher | <input type="checkbox"/> Other _____ |

2. What do you think are the benefits of a new Parish Church, community outreach and facilities co-located on the Darcy Road Westmead site?

.....

.....

3. What do you think are the challenges that should be considered with the development of a new Parish Church, community outreach and facilities at Darcy Road?

.....

.....

4. What sort of facilities and services would you like to see incorporated into the proposal?

.....

.....

5. Do you have any other comments you would like to make about this proposal?

.....

.....

6. What is the best way we can keep you updated?

- | |
|-----------------------------------------------------|
| <input type="checkbox"/> Parish Heartbeats Bulletin |
| <input type="checkbox"/> During mass services |
| <input type="checkbox"/> By email |
| <input type="checkbox"/> On social media |
| <input type="checkbox"/> Other _____ |

If you would like to be kept up to date via email, please provide your details below:

NAME

EMAIL

Thank you taking the time to complete this feedback form. Your feedback is being collected by Urbis Engagement on behalf of the Catholic Education Diocese of Parramatta.

You can drop your completed feedback form into the box provided, or via e-mail to engagement@urbis.com.au by Friday 20 December 2019.

