

8.0 The Sky Terraces

8.1 Overview

Dramatically spanning between the towers and soaring 100m+ above Castlereagh Street, three unique experiences have been proposed;

Level 32 : Sky Terrace Bar and Restaurant

Level 34 : Sky Pool Terrace

Level 36; Residnetial Communal Gardens

A mix of public, hotel and resident amenities come together for unimpeded views of Hyde Park and Sydney Harbour from an iconic setting.

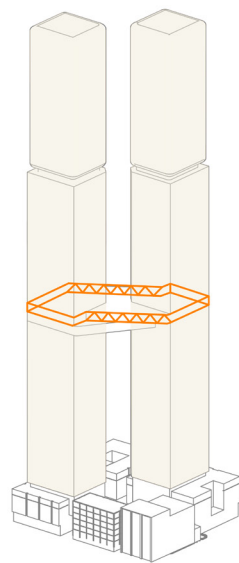

Structural Optimisation

The tower cores are 'coupled' by two 4 story trusses. Along with supporting the sky terraces, these coupling trusses optimise each towers lateral stability enabling simple continuous core boxes to the top without the need for outriggers or mass dampeners to mitigate natural frequencies and building sway.

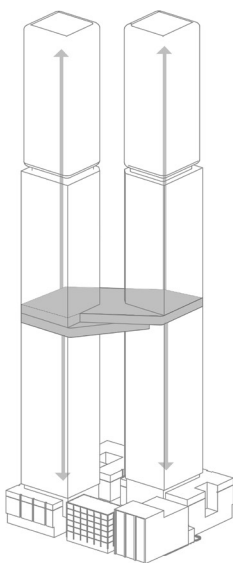

Centralised Services

Spanning the entire level (31) of the under side of the sky terraces is a shared mid level plant room. This enables efficient centralised services reticulation to both towers from an optimum mid-level location.

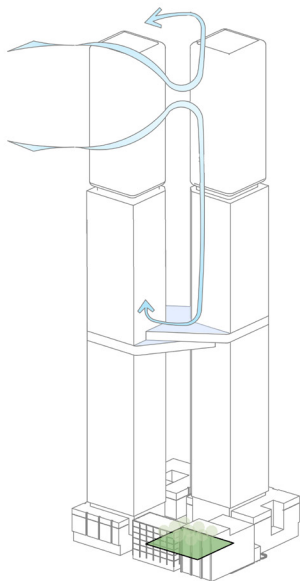

Wind Mitigation

The sky terraces break up and deflect accumulated tower down draft, protecting the ground plane and podium rooftop open spaces.

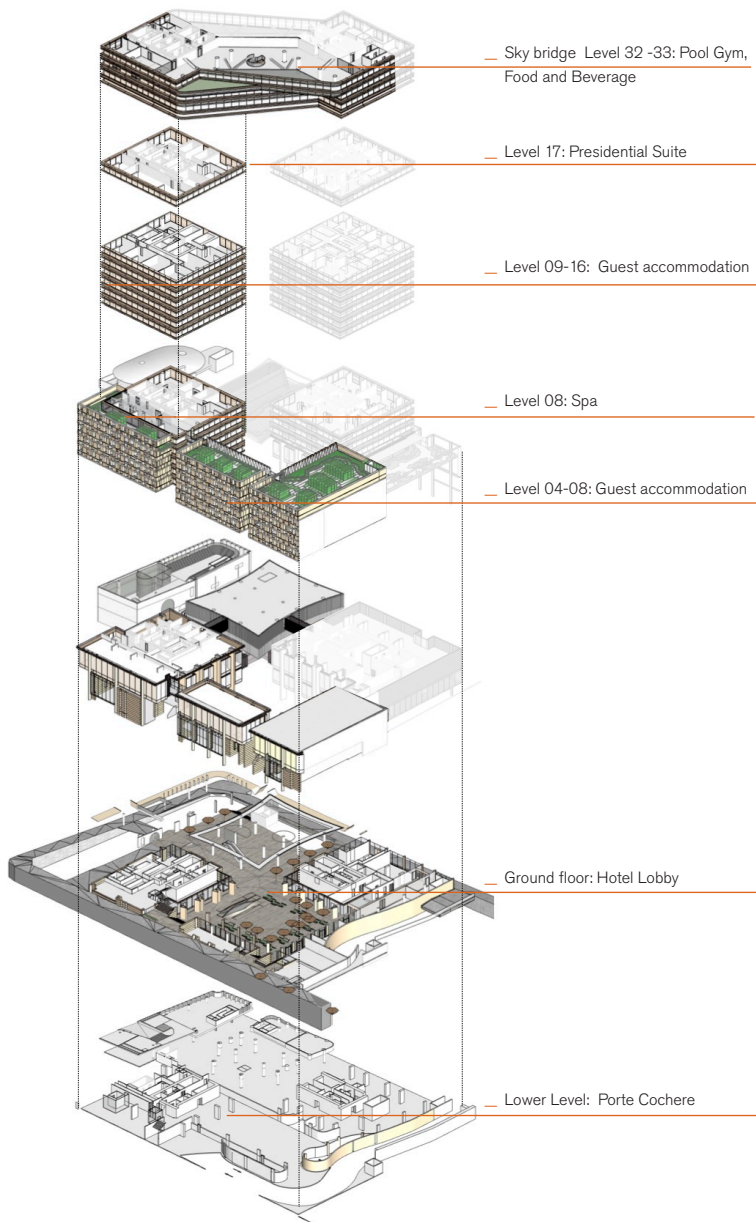

Amenity

World class facilities, unique in Sydney.

8.2 Structure

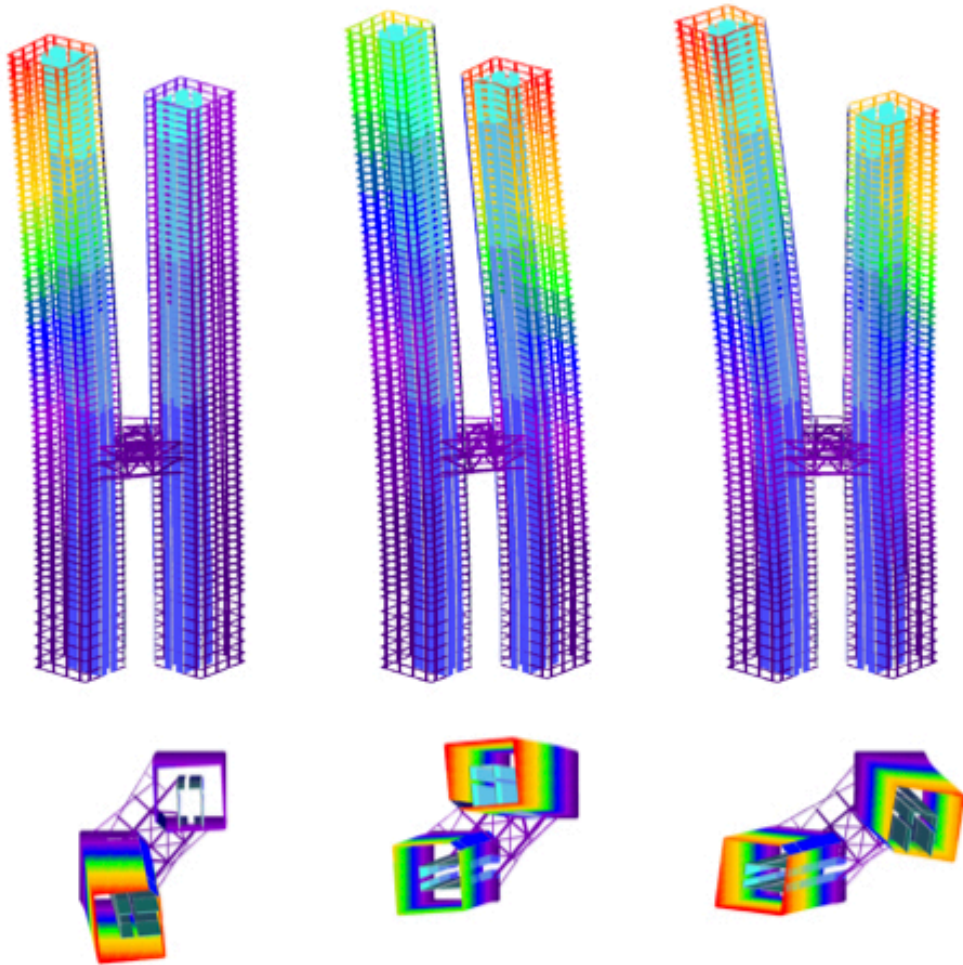
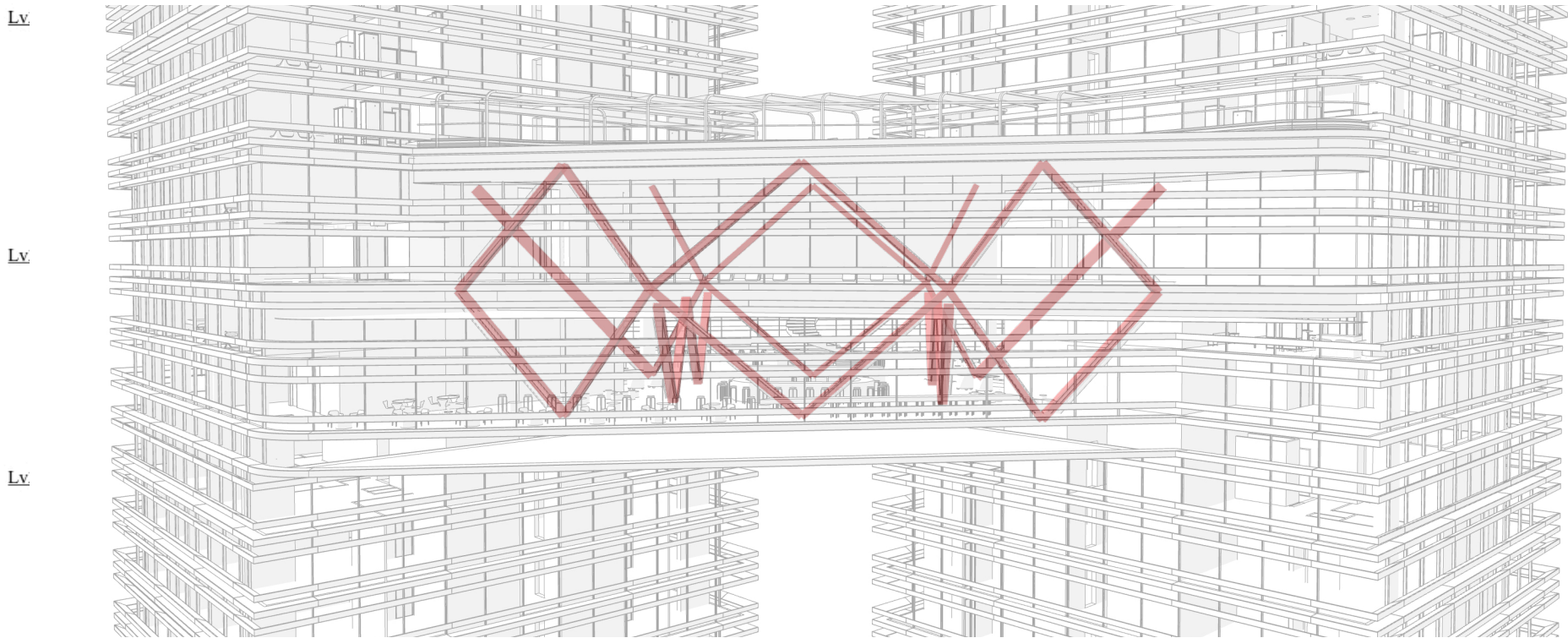
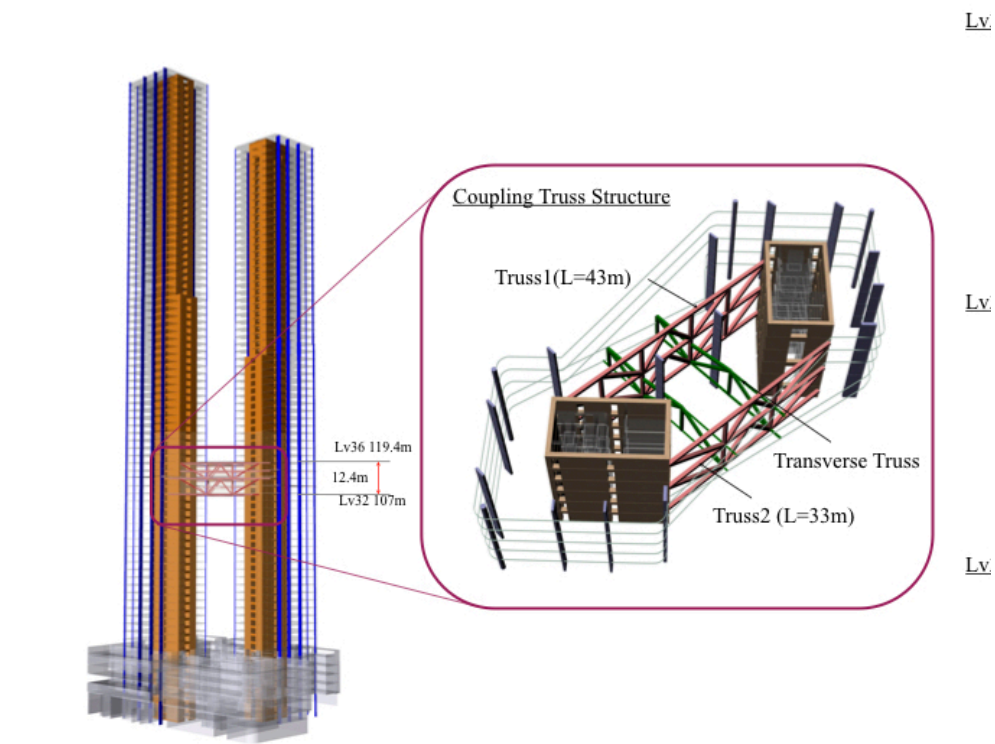

8.3 Hotel/Public

8.3.1 Restaraunt / Sky Bar

On the 32nd floor, spanning 100m+ above Castlereagh Street with unimpeded views of Hyde Park and the harbour, a destination cocktail and dining experience has been proposed.

This 1780m2 venue includes a lounge bar and a 250 seat restaurant accessible to the public, and directly by hotel guests and residents This facility elevates the standing of the proposed hotel and residential development with a signature feature unique in Sydney.

3 hotel passenger lifts and 2 public shuttle lifts connect the restaurant to the hotel lobby and public plaza at ground floor.

The full-service kitchen is served by a hotel dedicated goods lift and is invisioned to cover the hotel business centre and room service.

Legend

- 1 Restaraunt & Bar
- 2 Hotel Lift Lobby
- 3 Sky Terrace Shuttle Lift Lobby
- 4 Residential Lift Lobby
- 5 Kitchen
- 6 Amenities
- 7 Stair to Pool Deck

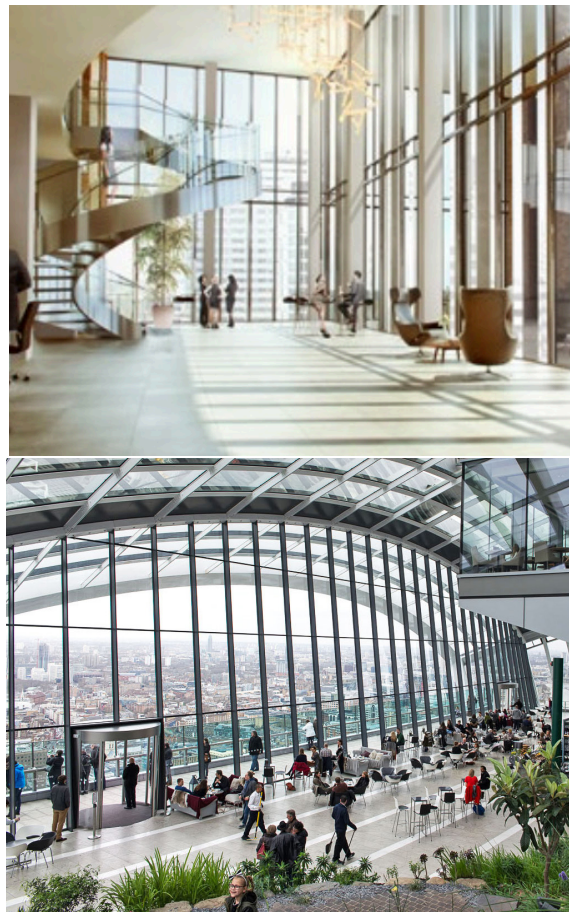
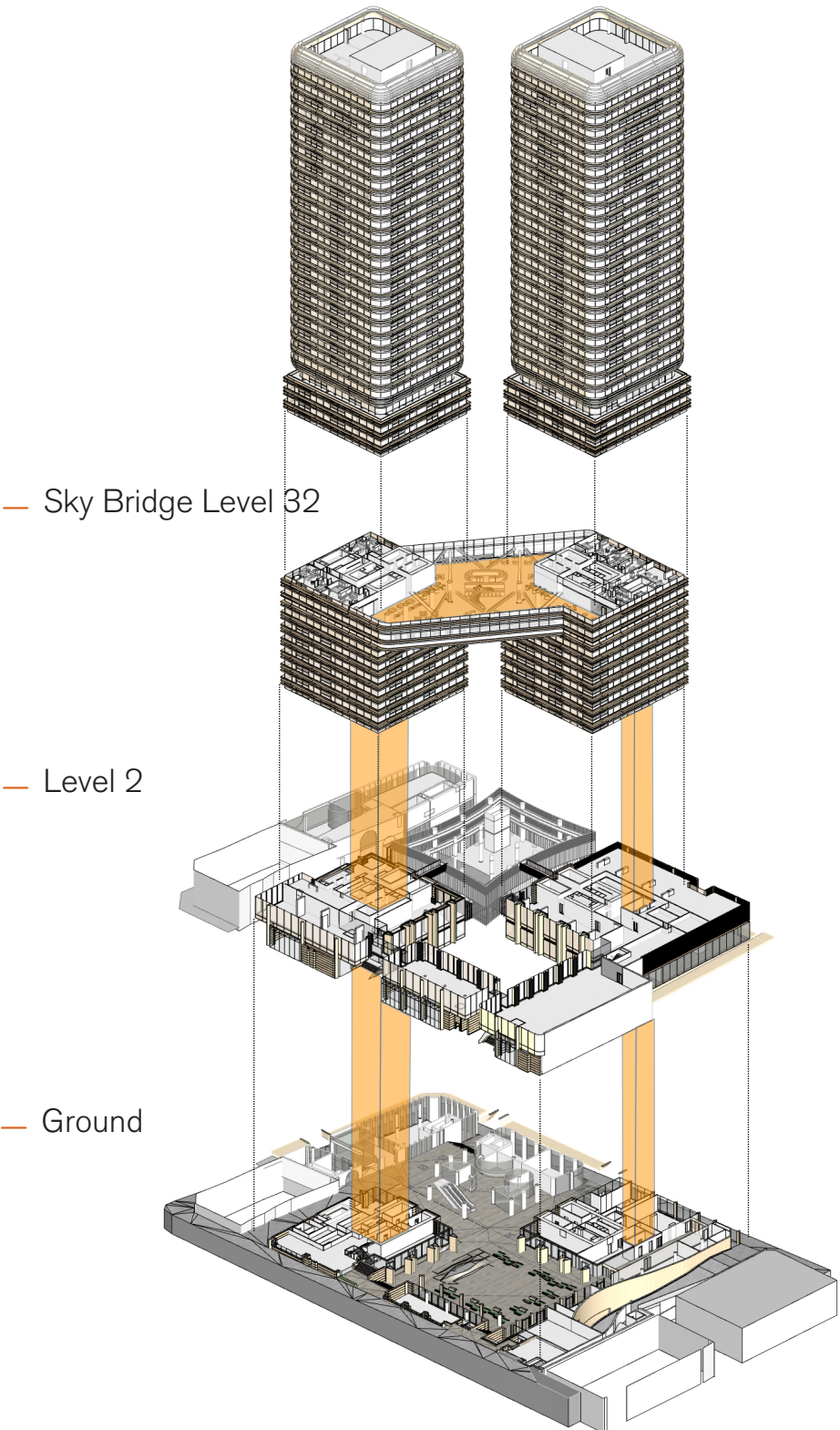
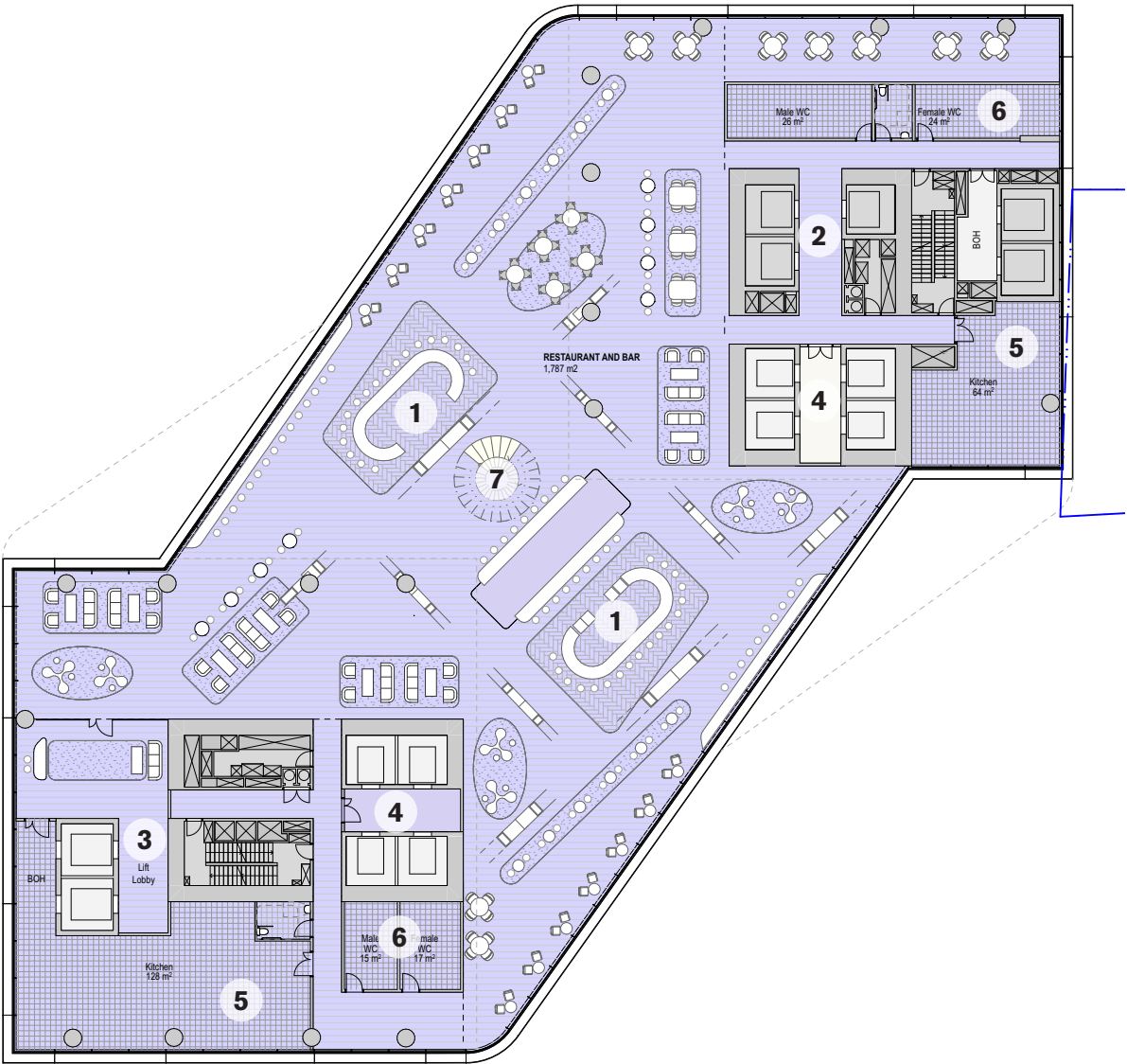

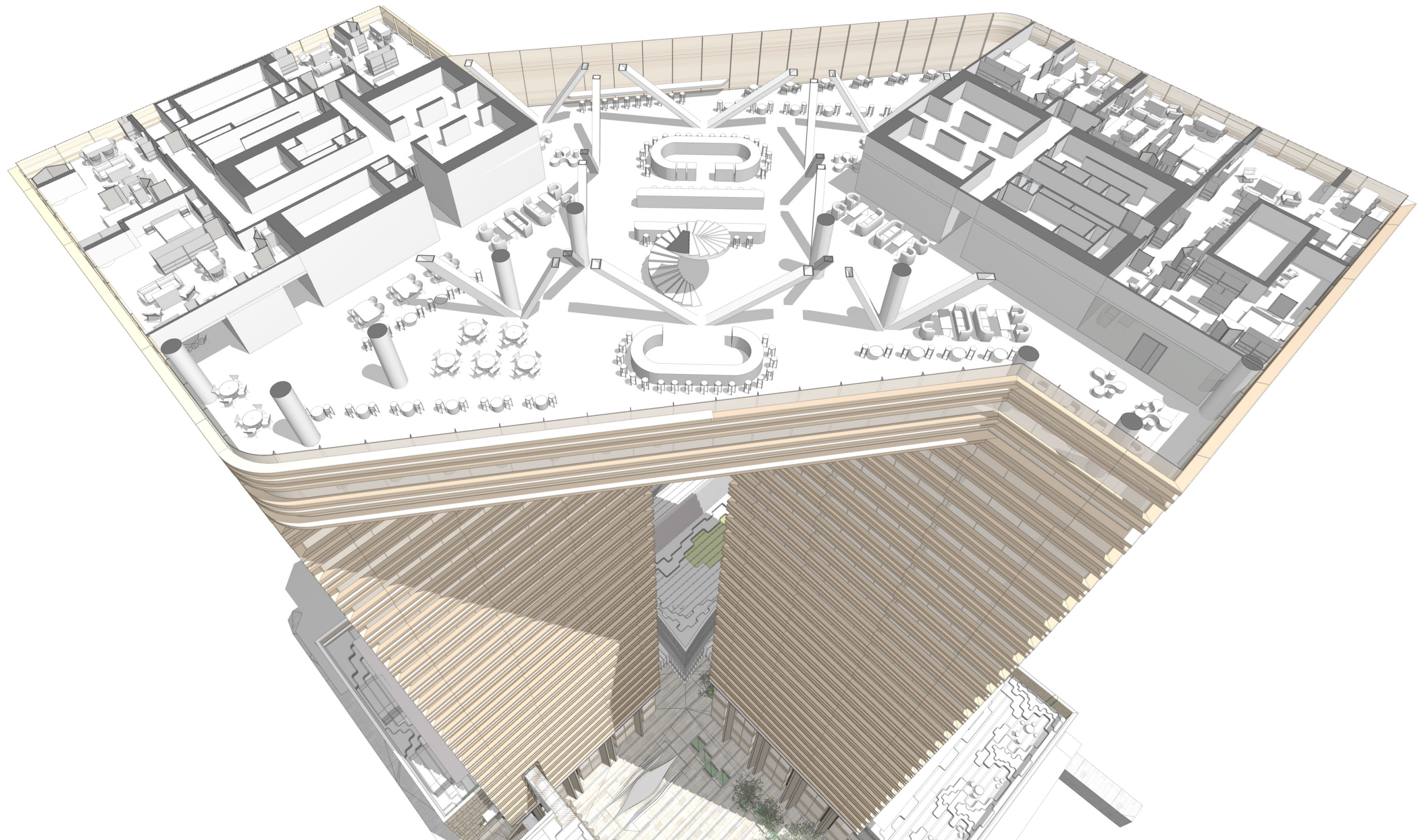

8.3.2 Wellness and Pool

Level 34 combines residential communal open space and hotel facilities into a signature feature, iconically spanning between the two towers.

With never-to-be-built-out Hyde Park and Harbour views Two dramatic and column-free infinity-edge pools take centre stage with leisure decks, spas, gym and change facilities surrounding. A world class amenity, unique in Sydney.

Communal spaces are increasingly becoming a key and marketable point of difference in major residential developments. In addition to this pool, a series of exciting and diverse resident-only communal space offerings have been proposed..

- Legend**
- 1 Hotel Pool
 - 2 Hotel Lift Lobby
 - 3 Sky Terrace Shuttle Lift Lobby
 - 4 Hotel Change/Amenities
 - 5 Hotel Gym
 - 6 Hotel Pool Bar
 - 7 Stair to restaurnt & Bar

