

CNSW WESTERN SYDNEY CRICKET & COMMUNITY CENTRE CIVIL WORKS

[illegible]

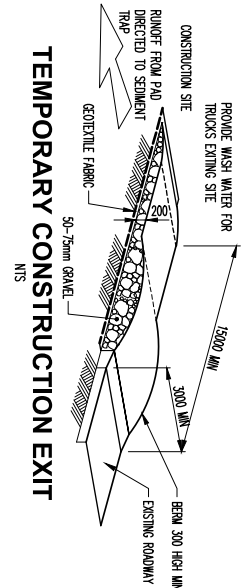
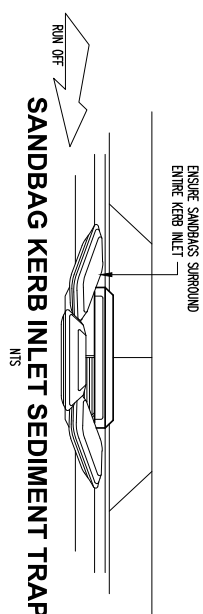
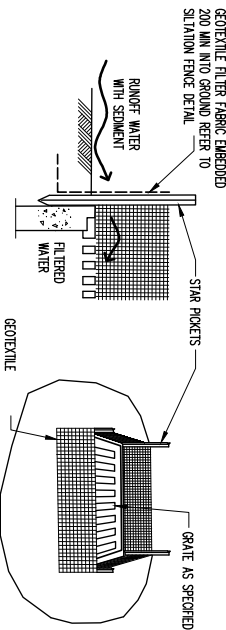
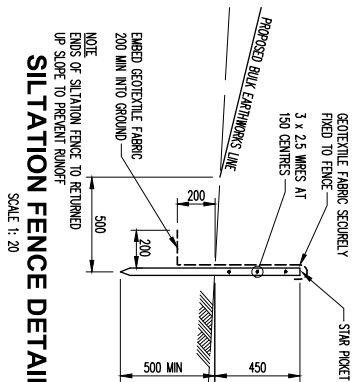
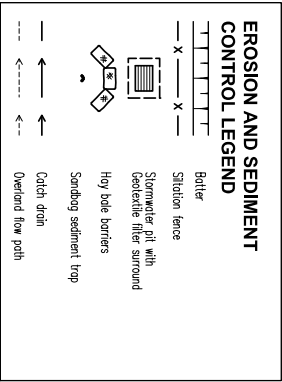
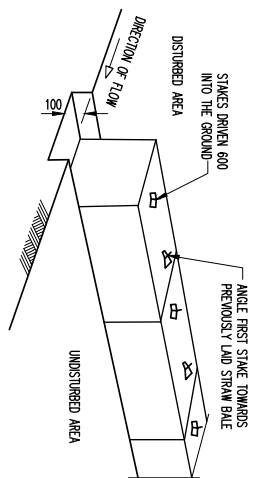
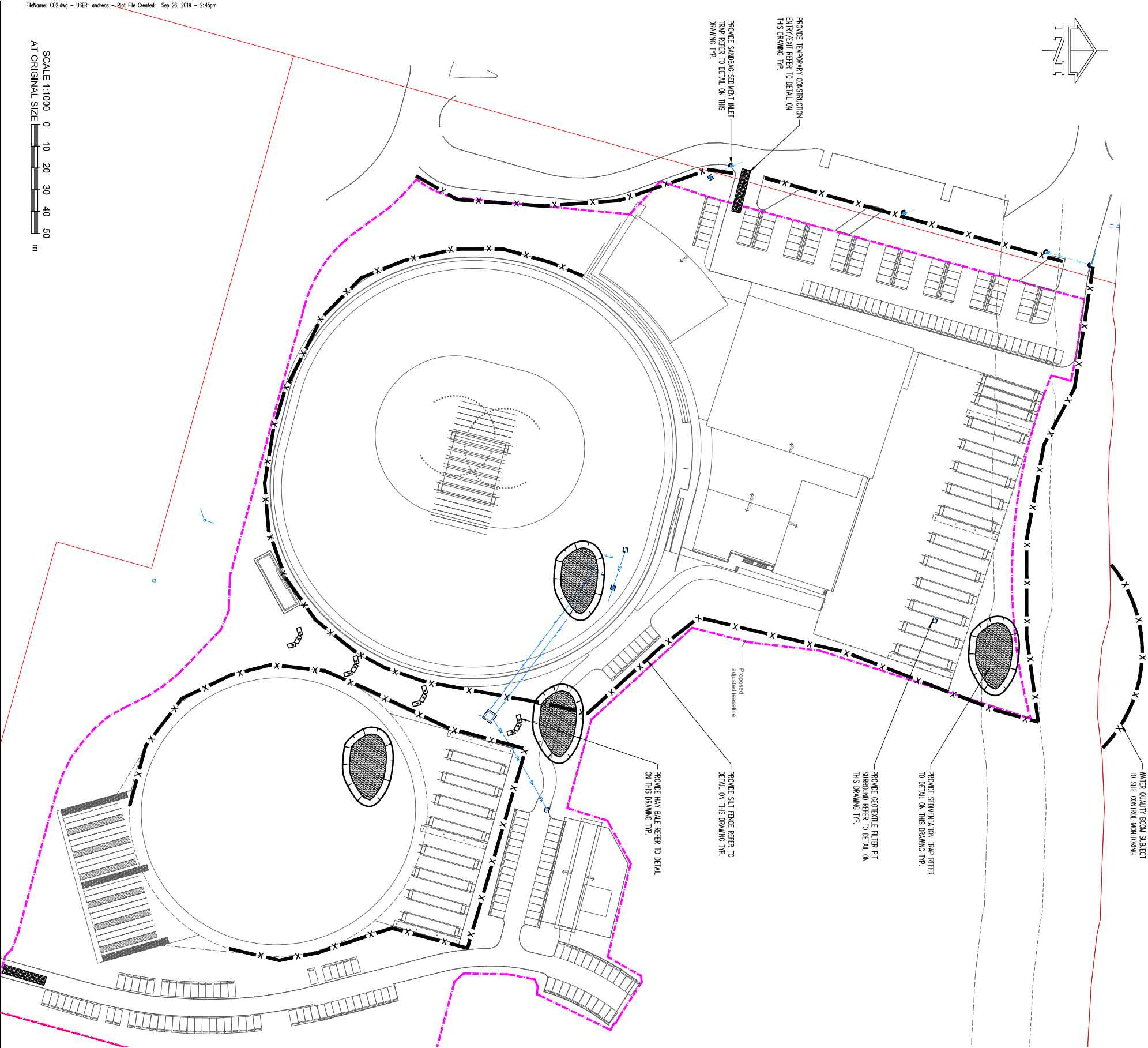

Filename: C02.dwg - USER: andress - Plot File Created: Sep 26, 2019 - 2:45pm

SCALE 1:1000 0 10 20 30 40 50
AT ORIGINAL SIZE

Architect				Civil Engineer				Project				Sheet Subject			
COX ARCHITECTURE				TTW Taylor Thomson Whitting				CNSW WESTERN SYDNEY CRICKET & COMMUNITY CENTRE, SILVERWATER				EROSION AND SEDIMENT CONTROL PLAN			
155 Clarence St, Sydney NSW 2000				612 9439 7288 48 Chandos Street St Leonards NSW 2055											
P2 SSQA				S8 AS 27/08/19				Scale A1				1:750 AS			
P1 SSQA				S8 AS 10/08/19				Job No				191180			
Rev Description				Eng Draft Date				Drawing No				C02			
								Revision				P2			
								Plot File Created: Sep 26, 2019 - 2:45pm							

SSDA

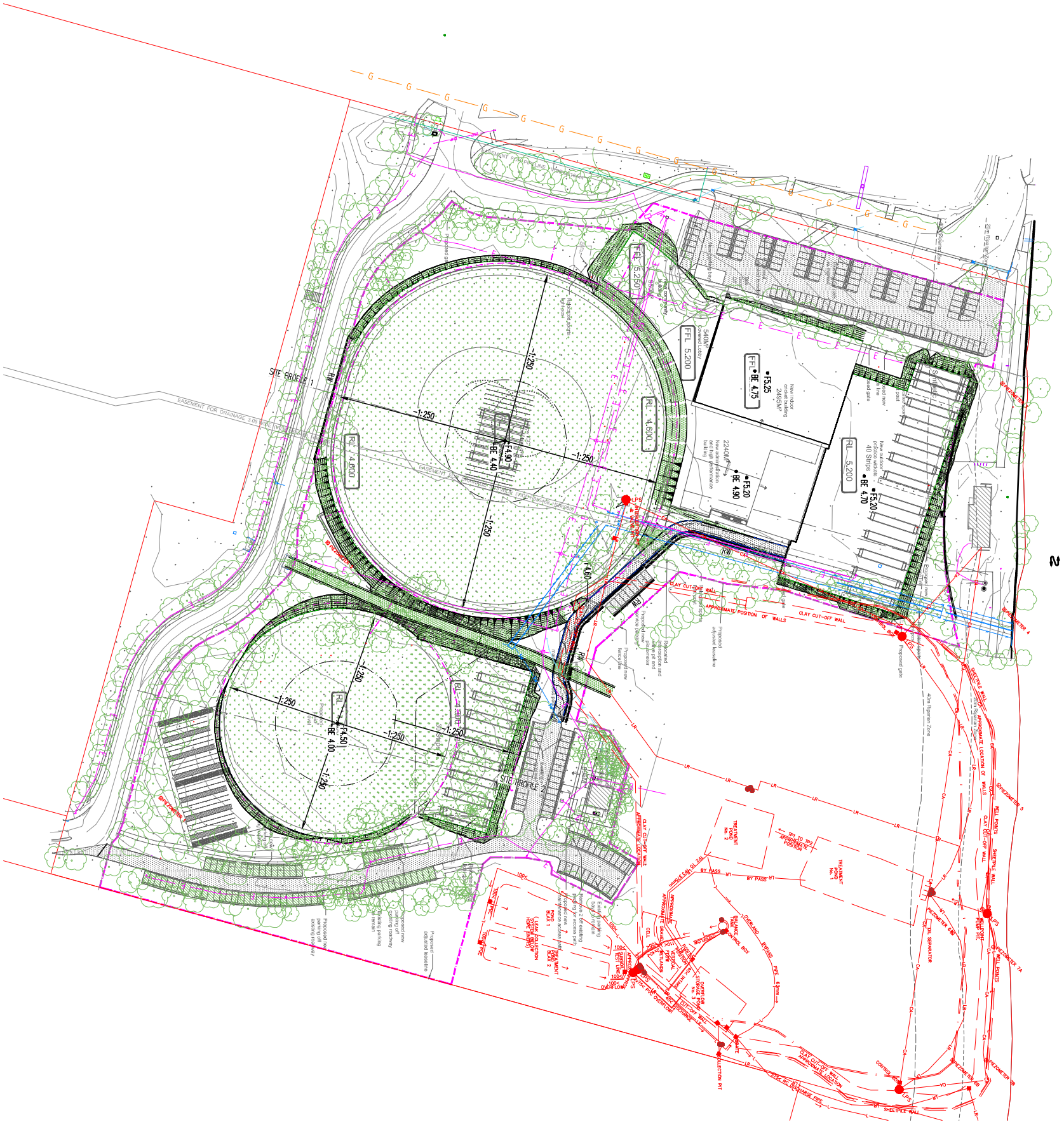
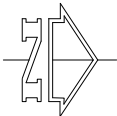

SCALE 1:1000
AT ORIGINAL SIZE

Architect				Civil Engineer				Project				Sheet Subject			
COX ARCHITECTURE				TTW Taylor Thomson Whitting				CNSW WESTERN SYDNEY CRICKET & COMMUNITY CENTRE, SILVERWATER				OVERALL FINISH LEVELS PLAN			
156 Clarence St, Sydney NSW 2000				612 9439 7288 48 Chandos Street St Leonards NSW 2065											
P3 SSQA				S8 AS 27/04/19				Scale: A1				AS			
P2 SSQA				S8 AS 10/06/19				1:1000				Drawn			
P1 PRE SSQA				S8 AS 29/06/19				Job No				191180			
Rev Description				Eng Draft Date				Drawing No				C05			
				Rev Description				Revision				P3			
				Eng Draft Date				Plot File Created				Sep 26, 2019 - 3:05pm			

SSDA

SCALE 1:1000 0 10 20 30 40 50 m
AT ORIGINAL SIZE

Scale : A1	Drawn	Authorised
1:1000	AS	
Job No	Drawing No	Revision
191180	C07	P3

Plot File Created Sep 26, 2019 - 3:16pm

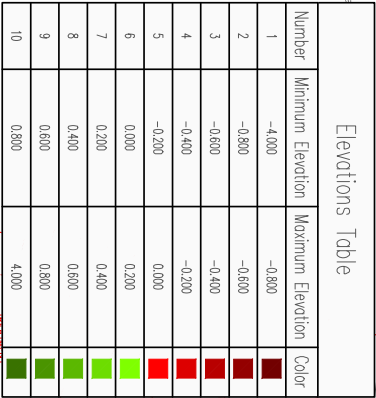

Cut/Fill Summary					
Name	Cut Factor	Fill Factor	2d Area	Cut	Fill
BULK ELEV	1.000	1.000	44099.54sq.m	2462.40 Cu. M.	2462.40 Cu. M.
Totals			44099.54sq.m	2462.40 Cu. M.	2462.40 Cu. M.

SSDA

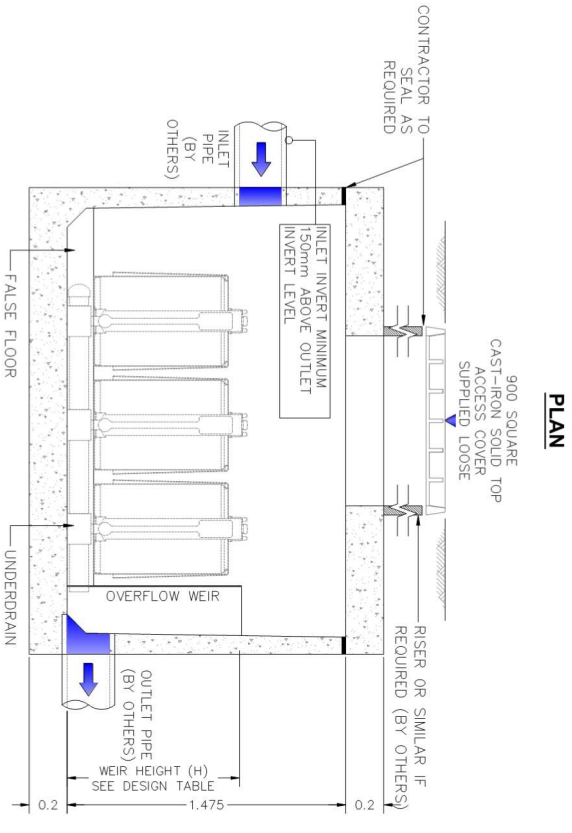
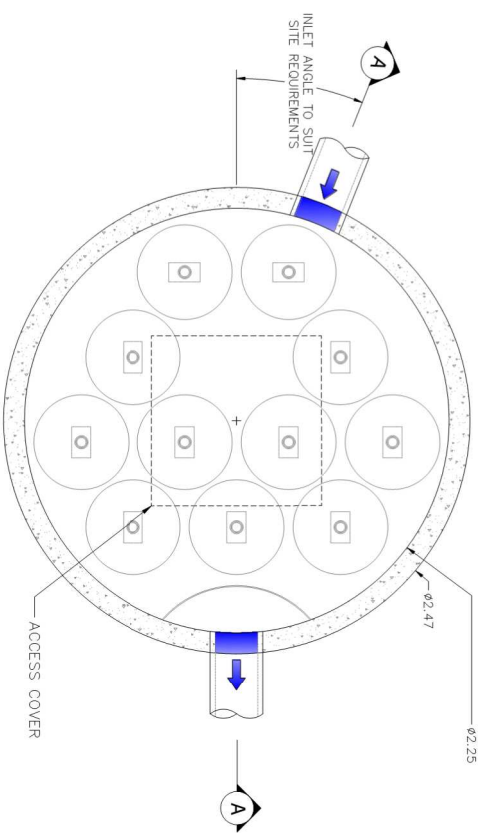

11 CARTRIDGE STORMFILTER SYSTEM
DN2250 MANHOLE

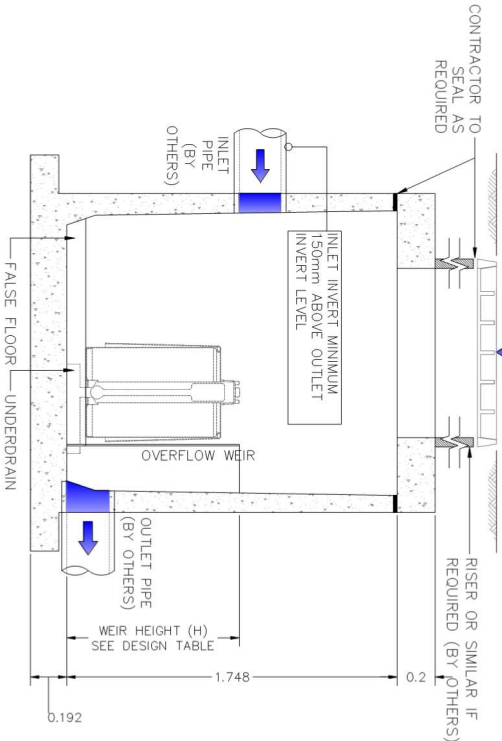
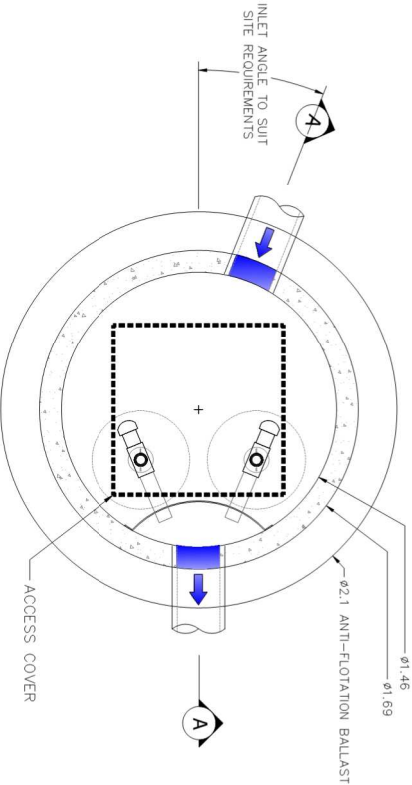

2 CARTRIDGE STORMFILTER SYSTEM
DN1460 MANHOLE

GENERAL NOTES		
1. THE MINIMUM CLEARANCE DEPENDS ON THE CONFIGURATION (SEE NOTE 2) AND THE LOCAL COUNCIL REQUIREMENTS.		
2. CLEARANCE FOR ANY PIT WITHOUT AN INLET PIPE (ONLY USED FOR SURFACE FLOW) CAN BE AS LOW AS 50mm. FOR OTHER PITS, THE RECOMMENDED CLEARANCE SHOULD BE GREATER OR EQUAL TO THE PIPE OBVERT SO AS NOT TO INHIBIT HYDRAULIC CAPACITY.		
3. OCEAN PROTECT PROVIDES TWO FILTRATION BAG TYPES- 200 MICRON BAGS FOR HIGHER WATER QUALITY FILTERING AND A COARSE BAG FOR TARGETING GROSS POLLUTANTS.		
4. DRAWINGS NOT TO SCALE.		
DEPTH ID	BAG DEPTH	OVERALL DEPTH
1	170	270
2	300	450
3	600	700

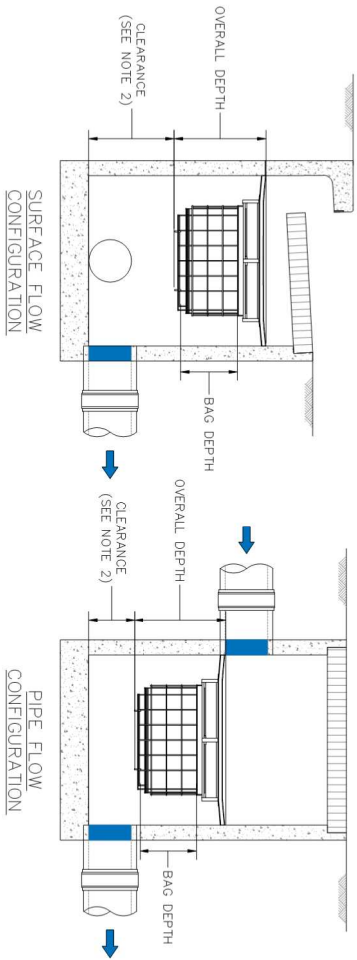

OCEANGAURD

STORMFILTER DESIGN TABLE

STORMFILTER TREATMENT CAPACITY VARIES BY NUMBER OF FILTER CARTRIDGES INSTALLED. THE STANDARD CONFIGURATION IS SHOWN. ACTUAL CONFIGURATION OF THE SPECIFIED STRUCTURE(S) PER CERTIFYING ENGINEER WILL BE SHOWN ON SUBMITTAL DRAWINGS.				
FILTER CARTRIDGES SHALL BE MEDIA-FILTER, PASSIVE, SIPHON ACTIVATED, RADIAL FLOW, AND SELF-CLEANING. RADIAL MEDIA DEPTH SHALL BE 178mm.				
CARTRIDGE NAME / SIPHON HEIGHT (mm)	690	460	310	
CARTRIDGE PHYSICAL HEIGHT (mm)	840	600	600	
TYPICAL WEIR HEIGHT [H] (mm)	920	690	540	
CARTRIDGE FLOW RATE FOR ZPG MEDIA (L/s)	1.6	1.1	0.7	
CARTRIDGE FLOW RATE FOR PSORB MEDIA (L/s)	0.9	0.46	0.39	
SITE SPECIFIC DATA REQUIREMENTS				
STRUCTURE ID				
NUMBER OF CARTRIDGES REQ'D			8	
SIPHON HEIGHT (310 / 460 / 690)				
MEDIA TYPE (ZPG / PSORB)				
WATER QUALITY FLOW RATE (L/S)				90
HYDRAULIC CAPACITY (L/S)				
PIPE DATA:		1L	MATERIAL	DIAMETER
INLET PIPE #1				
INLET PIPE #2				
INLET PIPE #3				
OUTLET PIPE				
PRECAST MANHOLE WEIGHT			6500kg	
PRECAST LID WEIGHT			2000kg	

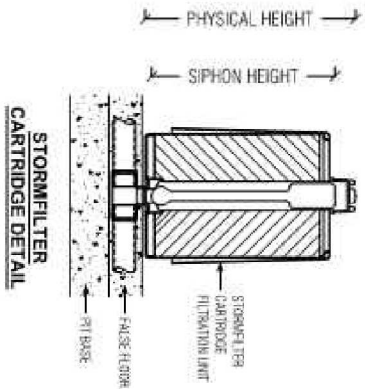

- GENERAL NOTES**
- PRECAST STRUCTURE SUPPLIED WITH CORE HOLES TO SUIT OUTER DIAMETER OF NOMINATED PIPE SIZE / MATERIAL.
 - PRECAST STRUCTURE SHALL MEET WIND WHEEL LOAD RATING ASSUMING A MAXIMUM EARTH COVER OF 2.0m AND A GROUND WATER ELEVATION AT OR BELOW THE OUTLET PIPE INVERT ELEVATION. CERTIFYING ENGINEER TO CONFIRM ACTUAL GROUNDWATER ELEVATION. PRECAST STRUCTURE SHALL BE IN ACCORDANCE WITH ASS600.
 - IF THE PEAK FLOW RATE, AS DETERMINED BY THE SITE CERTIFYING ENGINEER, EXCEEDS THE PEAK HYDRAULIC CAPACITY OF THE SYSTEM, AN UPSTREAM BYPASS STRUCTURE IS REQUIRED.
 - ALL WATER QUALITY TREATMENT DEVICES REQUIRE PERIODIC MAINTENANCE. REFER TO OPERATION AND MAINTENANCE MANUAL FOR GUIDELINES AND ACCESS REQUIREMENTS.
 - SITE SPECIFIC PRODUCTION DRAWING WILL BE PROVIDED ON PLACEMENT OF ORDER.
 - DRAWING NOT TO SCALE.
- INSTALLATION NOTES**
- ANY SUB-BASE, BACKFILL DEPTH, AND/OR ANTI-FLOTATION PROVISIONS ARE SITE-SPECIFIC DESIGN CONSIDERATIONS AND SHALL BE SPECIFIED BY CERTIFYING ENGINEER.
 - CONTRACTOR TO PROVIDE ALL EQUIPMENT WITH SUFFICIENT LIFTING AND REACH CAPACITY TO LIFT AND SET THE STORMFILTER STRUCTURE (LIFTING DETAIL PROVIDED SEPARATELY).
 - CONTRACTOR TO APPLY SEALANT TO ALL JOINTS AND TO PROVIDE, INSTALL AND GROUT INLET AND OUTLET PIPES.

SSDA

Architect				Project			
COX ARCHITECTURE 156 Clarence St, Sydney NSW 2000				CNSW WESTERN SYDNEY CRICKET & COMMUNITY CENTRE, SILVERWATER			
Civil Engineer				Sheet Subject			
TTW Taylor Thomson Whitting				DETAILS SHEET 1			
B12 9439 7288 48 Charndon Street St Leonards NSW 2055				Scale: A1 AS SHOWN AS Job No: 191180 Drawing No: C20 Revision: P1			
Rev Description	Eng Draft Date	Rev Description	Eng Draft Date	Rev Description	Eng Draft Date	Rev Description	Eng Draft Date
P1 SSDA	S8 AS 27/09/19						