

TWEED VALLEY HOSPITAL

– STAGE 2

HERITAGE AND ARCHAEOLOGICAL MANAGEMENT PLAN

20/09/2019 | Revision No: 5.0



Plan Revision Status				
Date	Revision (in numbers)	Purpose and Summary of Amendments	Reviewed by	Approved by
30/01/17	2	General update including LLB GMR and legislative amendments	Tracey Wallbridge	Brian Falls
09/07/19	2.1	Project Specific – Preliminary	LB	Luis Biaggini
12/07/19	2.2	SSD Requirements added	AW	Luis Biaggini
05/09/19	3.0	Finalisation for EIS Submission	MW	Luis Biaggini
17/09/19	4.0	Finalisation for EIS Submission	MW	Luis Biaggini
20/09/19	5.0	Finalisation for EIS Submission	MW	Luis Biaggini

*Note that all printed paper/hard copies of this document remain uncontrolled. The controlled copy of this document is found either in the project collaboration tool, within the Project Management Plan section, or other project specific database/server approved by the Regional EHS Manager / Head of EHS Integrated Project.

1. OVERVIEW

1.1 Overview

On the 11 June 2019 the Minister for Planning and Public Spaces granted approval for the Concept Plan and Stage 1 Early and Enabling Works for the new Tweed Valley Hospital (SSD 18_9575) located at 771 Cudgen Road, Cudgen (Lot 11 DP1246853).

The Environmental Impact Statement (EIS) has been prepared to assist in the State Significant Development (SSD) Stage 2 Application for the Tweed Valley Hospital which will be assessed under Part 4 Division 4.1 of the Environmental Planning and Assessment Act. This, along with supporting documentation, will provide a clear outline of the Stage 2 Application.

The Tweed Valley Hospital Project broadly consists of:

- Delivery of the Tweed Valley Hospital; a new Level 5 major regional referral hospital to provide the health services required to meet the needs of the growing population of the Tweed-Byron region (in conjunction with the other hospitals and community health facilities across the region);
- Delivery of the supporting infrastructure required for the Tweed Valley Hospital, including green space and other amenities, roads and car parking, external road upgrades and connections, utilities connections, and other supporting infrastructure.

1.1.1 Concept Proposal and Stage 1 Early and Enabling Works

The Concept Proposal and Stage 1 Early and Enabling Works were approved for the new Tweed Valley Hospital (SSD 18_9575) by the Minister of Planning and Public Spaces on 11 June 2019. All documents relating to the Concept Proposal and Stage 1 Early and Enabling Works can be found on the project website at <https://www.planningportal.nsw.gov.au/major-projects/project/10756>

1.1.2 Stage 2 Hospital Delivery - Main Works and Operation

The Stage 2 SSD component will seek consent for the Main Works and Operation of the Tweed Valley Hospital, including:

- **Construction of Main Hospital Building**
 - Main entry and retail area
 - Administration
 - Community health
 - In-Patient units
 - Outpatient clinics and day only units
 - Child and Adolescent Services
 - Intensive Care Unit
 - Mental Health Unit
 - Maternity Unit and Birthing Suites
 - Renal Dialysis
 - Pathology
 - Pharmacy
 - Radiation Oncology as part of integrated Cancer Care
 - Emergency Department
 - Perioperative Services
 - Interventional Cardiology
- Back of House services
- Rooftop Helipad
- **Construction of Support Building, referred to as the 'Health Hub', containing:**
 - Oral Health
 - Community Health
 - Aboriginal Health
 - Administration
 - Education, Training and Research
- **Internal Roads and carparking, including multi-deck parking for staff, patients and visitors;**
- **External road infrastructure upgrades and main site access**
- **Environmental and wetland rehabilitation, including rehabilitation of existing farm dam as outlined in the Biodiversity Development Assessment Report (BDAR) prepared for the Concept Proposal and Stage 1 works**

-
- Medical Imaging
 - Mortuary
 - Education, Training, Research
 - **Site landscaping**
 - **Signage**
 - **Utility and service works**

Plans for Stage 2 Main Works and Operation are attached in Appendix B of the EIS. Approval of Stage 2 will enable the new Tweed Valley Hospital to be built which will provide a much-needed contemporary health service facilities for the surrounding region.

1.1.3 Potential Future Expansions

Any subsequent stages or modifications to the proposal would be subject to separate applications as required including the potential future expansion of the facility.

2. SSD REQUIREMENTS

State Significant Development Conditions

Name of this Plan (as per SSD Conditions): N/A

B14. The Stage 2 application must include details of the retained stone walls on the site (where feasible), the associated archival recordings and interpretation techniques (where removal is proposed) as required by conditions A12 and A13 of schedule 3 and the recommendations of the Historical Heritage Assessment Report prepared by Niche Environment and Heritage dated 19 October 2018.

Refer to 5. Details of actions for dry stone walls

3. SCOPE OF PROJECT AND PLAN

Project Details	
Scope of the Plan	This Heritage and Archaeological Management Plan provides strategies and control measures for the protection and management of previously known and unidentified heritage features, including the dry-stone walls. It outlines appropriate measures to ensure that identified Heritage, Cultural and Archaeological items, are managed appropriately during the construction phase and measures that may need to be taken if unexpected finds of items are uncovered. This may include trees, buildings, artefacts, relics, human remains and places, encountered during site establishment and construction of the project. It describes measures to be implemented during relevant construction activities, which enables assessment of the impacts of construction activities on potentially affected relics, items or areas.
Objectives of the Plan	<ul style="list-style-type: none"> • To protect, preserve or conserve known heritage, culturally significant and archaeological items on the site, where possible in accordance with the Stage 1 SSD Conditions of Consent. • To establish procedures for the identification, protection and management of previously undiscovered heritage, culturally significant and archaeological items. • To align the work activities with the recommendations raised in Niche's TVH Historical Heritage Assessment
Scope of Works	<p>This Plan has been prepared based on consideration of the following scope of works:</p> <ul style="list-style-type: none"> • Site establishment including ATF, fixed temporary fence and hoarding installation, office and compound setup; • Civil Works, including carparks and roads to Stage 2;

Project Details	
	<ul style="list-style-type: none"> • Monitoring and maintenance of existing Sedimentation Basins; • Construction of the multi-level Main Works Stage. This new build will include a new emergency department, helipad, IPUs, ICU, MAU, expanded rehab and ambulatory care facilities and operating theatres • Landscaping
Key Issues and Risks	<p>The heritage and archaeological assessment, for the site indicates that the following items/features are potentially or known to exist within or are adjacent to the site:</p> <ul style="list-style-type: none"> ○ Five dry-stone walls were identified during a heritage survey of the site. The walls were likely constructed by South Sea Islander workers during the late nineteenth century. Three walls (one only in part) were removed in Stage 1 works. Refer to Appendix 2 for stockpile location. ○ Three mature trees – two figs and one Poinciana. The mature trees on the Project Site have individual aesthetic value and contribute to the Project Site's overall aesthetic qualities. ○ Refer to Appendix 1 for location of walls and trees. <p>The following activities will be monitored to reduce impact:</p> <ul style="list-style-type: none"> ○ Material storage resulting in spills or ground compaction near heritage landscape features (trees and gardens); and ○ Physical damage by machinery
Legislation and Guidelines	<p>Federal/National:</p> <ul style="list-style-type: none"> • Environment Protection and Biodiversity Conservation Act 1999 • Aboriginal and Torres Strait Islander Heritage Protection Act • Ask First: A Guide to Respecting Indigenous Places and Values (Australian Heritage Commission) <p>State:</p> <ul style="list-style-type: none"> • Code of Practice for Archaeological Investigation of Aboriginal Objects in NSW • Aboriginal cultural heritage consultation requirements for proponents 2010. Part 6 National Parks & Wildlife Act 1974. • Heritage Act 1977 <p>Local:</p> <ul style="list-style-type: none"> • NSW Police • Tweed Byron Local Aboriginal Land Council <p>Lendlease Requirements:</p>

Project Details	
	<ul style="list-style-type: none"> • GMR: 4.13 Degradation or Pollution of the Environment • GMR: 4.15 Uncontrolled Release of Stored Energy (non-electrical)) • Lendlease Building Workplace Delivery Code (WDC)
Protection of Disassembled Dry-Stone Walls	<p>Procedures for the Retention, Protection or Disassembly were generally in accordance with Niche Environment and Heritage's Historical Heritage Assessment Report and advice. Walls 1 (in part), 3 and 4 are positioned within the construction footprint of the hospital development, are not possible to be retained and therefore will need to be catalogued for archival recording purposes and removed.</p> <p>Dry-stone walls (1 in part, 3 and 4) were removed within Stage 1 works and stones stored as per Appendix 2.</p> <p>Any further recommendations made by Niche should be evaluated and implemented if feasible.</p>
Summary of Site Controls	<p>Site specific controls, monitoring, reporting and performance measurements have been identified in this Plan to prevent or minimise the impacts of construction on previously known and unidentified heritage and archaeological features. These include but are not limited to:</p> <ul style="list-style-type: none"> • The installation of protective fencing and signage around known sites, items or buildings; • The establishment of 'buffer zones' around known sites and items, for vibration and access control; • The appropriate selection of plant and equipment working close to heritage items and buildings; • The implementation of an Unexpected Find Protocol for previously unidentified items (refer below). <p>A Heritage/Archaeological assessment/survey must be available (Niche Report) prior to any works commencing including site establishment. The requirements of the assessment/survey must be incorporated into this Plan and detailed on the Environmental Management Diagram (EMD) included in Appendix 1.</p> <p>Ground penetrating radar testing were undertaken to confirm surrounding ground conditions and the presence of burial sites.</p> <p>Construction stage heritage and archaeological excavation and protection measures must be included in relevant specifications, contract agreements, quality assurance documents, and subcontractor work method statements.</p> <p>Site inspections, monitoring and reporting will be undertaken by Lendlease and subcontractors as detailed in the following implementation table.</p>
Unexpected Find Protocol	<ol style="list-style-type: none"> 1. Cease work, turn off machines and clear the area immediately if a potential burial site or item of heritage or archaeological significance has been discovered or is suspected. 2. Contact the EHS Coordinator, Site Manager or Construction Manager immediately.

Project Details	
(Refer to Appendix 3)	<ol style="list-style-type: none"> 3. Erect barricades to isolate the immediate area and prevent entry. Establish a buffer of 10m between the potential heritage/ archaeological item and the barrier (as a minimum where possible). 4. The appropriate regulatory authorities should be notified as soon as possible if applicable. Contact the nominated appropriately qualified Heritage or archaeological specialist. 5. No person shall enter the barricaded area unless expressly permitted by the qualified Heritage /Archaeological specialist. A clearance certificate or approval should be given in writing prior to entry. 6. Sampling / inspection of the fine is to be carried out by the Heritage /Archaeological specialist as advised by the LLB construction manager. 7. The nominated Heritage /Archaeological Specialist (in liaison with LLB senior site personnel and/or relevant authorities) will determine if further management actions are necessary based on an available information. 8. All permits to carry out additional actions are to be obtained prior to the commencement of any new works and the nominated Environmental Specialist must provide written clearance approval. 9. The barricade may then be removed and work activities may resume under the direction of the LLB Construction Manager. <p>Note: For unexpected finds involving human skeletal remains, contact must be made with local Police. The area must be secured immediately.</p>

4. IMPLEMENTATION OF THE PLAN

Control Measure	Timing	Methodology	Responsibility	Monitoring and Reporting	Performance Measurement
Planning and Site Establishment					
Obtain a heritage/archaeological survey/report to identify the significance of the site and any surrounding areas/features/buildings/trees (if necessary).	Prior to works commencing	In consultation with a heritage specialist prepare: *a list of items and areas of significance; *an Environmental Management Diagram (EMD – Appendix 1) showing the location of <i>known</i> heritage items areas; *a heritage zoning plan showing areas with high, medium and/or low heritage 'potential'.	CM/SM	List of items and areas of significance prepared. Diagram prepared and reviewed. Heritage zoning plan prepared (if required).	List and diagram prepared containing all relevant details and communicated prior to commencing any works.
Include information in the Site Induction about the potential impacts of construction activities on known and previously unidentified heritage/archaeology and address cultural heritage of the site.	Before works commence and ongoing	Revise Lendlease standard induction package to include site specific information. Deliver induction material.	CM/SM	WMSs prepared by subcontractor's address heritage issues.	Site induction delivered to all workers on site.
Install barriers/protective fencing and clear signage to control access to known heritage areas until approval to enter or excavate is obtained.	Prior to works commencing	Install access controls in accordance with heritage consultant recommendations. Do not permit access without CM approval.	SM	Daily surveillance to assess integrity of barriers/fencing. Weekly/monthly inspection checklist.	No access into significant areas. Barriers/fencing not removed until a clearance certificate is provided by heritage consultant.
Monitor ground stripping/disturbance and spoil handling activities in actual and potential heritage areas (where works have been approved to proceed for site establishment or clearing).	Areas of potential impact identified prior	Obtain approval to commence works in heritage areas within the project footprint. (Early excavation of potential	CM/SM External reps	Surveillance during earthworks. WMS	No unnecessary land disturbance. No disturbance of identified areas without approval.

	to works commencing	archaeological deposits (PAD) may be required). Establish a protocol and work method for ground disturbance works. May involve visual monitoring of surface disturbance and spoil by specialist consultant or external representatives (eg LALC). Ensure appropriate external representatives are involved as required.			Protective fencing and signage maintained until a clearance certificate has been issued.
During Construction					
Maintain fences/barriers/signage around heritage items/buildings etc that are required to be retained and protected.	At all times	Check the condition and integrity of controls. Address the importance of controls and access restrictions in a toolbox.	SM	Daily surveillance. Weekly inspection checklist.	No breach of fence line.
Minimise the potential for damage to heritage structures through the appropriate selection of work methods, plant and equipment, and the establishment of buffer zones.	At all times	Prepare WMS for all works affecting or close to heritage items/structures. Use appropriately sized plant and equipment to minimise ground vibration and reduce the potential for damage to relics. Establish safe use buffer zones.	CM/SM	WMS for works near heritage structures/items.	No damage to existing structures or items. Compliance with WMS.
All permits to carry out archaeological investigations or excavations are to be obtained prior to the commencement of any new works.	After discovery of relic	In accordance Heritage & Archaeological Management Plan.	CM	Monitor compliance.	Sighting permit.

Enact the Unexpected Find Protocol in the event that a potential heritage item, artefact or relic is discovered.	At any time	Cease work immediately.	SM/ Contractor	Monitor earthworks. Maintain site records of any findings.	No construction impact to unexpected finds Protocols followed Sighting permit
Human remains identified – Stop work provision	Human remains are encountered	Cease work immediately. Baricate 20m around area NSW Police contacted immediately and no further action until NSW provide written notification.	SM/ Contractor	Monitor earthworks. Maintain site records of any findings.	No construction impact to unexpected finds Protocols followed Sighting permit
Protocol for unexpected finds when working adjacent walls.	At all times	Workers are to be briefed prior to working. Establish signage around area.	SM/ Contractor	Prestart Minutes SWMS Maintain site records of any findings.	No construction impact to unexpected finds Protocols followed
Ground disturbances within Northern Wetland area	As required	consultation with the RAPs and a further cultural heritage survey with representatives of the RAPs	CM, SPE and SE	Consultation with Heritage Consultant	No harm caused by unexpected aboriginal finds.

Dry-Stone Walls

Archival recording of the dry-stone walls	Completed in Stage 1.	Advice or report to be prepared	SM / Heritage Consultant	Report or letter.	Detailed summary of existing wall for record for either rebuild or reuse of stones.
Location of disassembled stones from walls 3 & 4 and part of wall 1 to be protected.	After disassembly of wall.	Prepare WMS for all works affecting or close to heritage items/structures.	SM/F	Weekly inspection checklist.	Minimise damage to walls.
Avoid removing trees and vegetation which may be supporting walls 1,2 and 5..	During bush regeneration.	Coordination between heritage consultant and ecological	SM/ Heritage &	Site Inspection Report	Minimise damage to walls.

			consultant on vegetation to be removed.	Ecological Consultant		
--	--	--	---	-----------------------	--	--

5. DETAILS OF ACTIONS FOR DRY STONE WALLS

All of the work for the heritage stone walls will follow the procedures outlined in the Niche's TVH Historical Heritage Assessment.

Heritage Stone Walls		
Wall Number	Location (Appendix 2)	Description Measure
1	Located on the southern perimeter of site, along Cudgen Road footpath. Approximately 5-10m will interfere with new Slip Lane.	Part retention of wall 1, archival recordings of the demolished section. Interpretation options are currently under development in consultation with Council and the South Sea Islander community, in accordance with the Conditions of Consent, and will be included in the Interpretation Plan as part of the Stage 2 SSD application.
2	Located within the retained undisturbed forest.	Protection of wall 2, exclusion zone established. Weeds to be removed from the wall.
3	Located internal to site, within the windrows. Will require removal for site works.	Removal of wall 3, archival recordings of wall prior to disassembly. Interpretation options are currently under development in consultation with Council and the South Sea Islander community, in accordance with the Conditions of Consent, and will be included in the Interpretation Plan as part of the Stage 2 SSD application.
4	Located internal to site, within the windrow. Will require removal for site works.	Removal of wall 4, archival recordings of wall prior to disassembly. Interpretation options are currently under development in consultation with Council and the South Sea Islander community, in accordance with the Conditions of Consent, and will be included in the Interpretation Plan as part of the Stage 2 SSD application.
5	Located on the eastern perimeter of the site.	Protection of wall 5, exclusion zone established. Weeds to be removed from the wall.

Appendix 1 – Site Layout



Appendix 2 – Location of Stockpile for storing of Rocks from Walls 1, 3 and 4

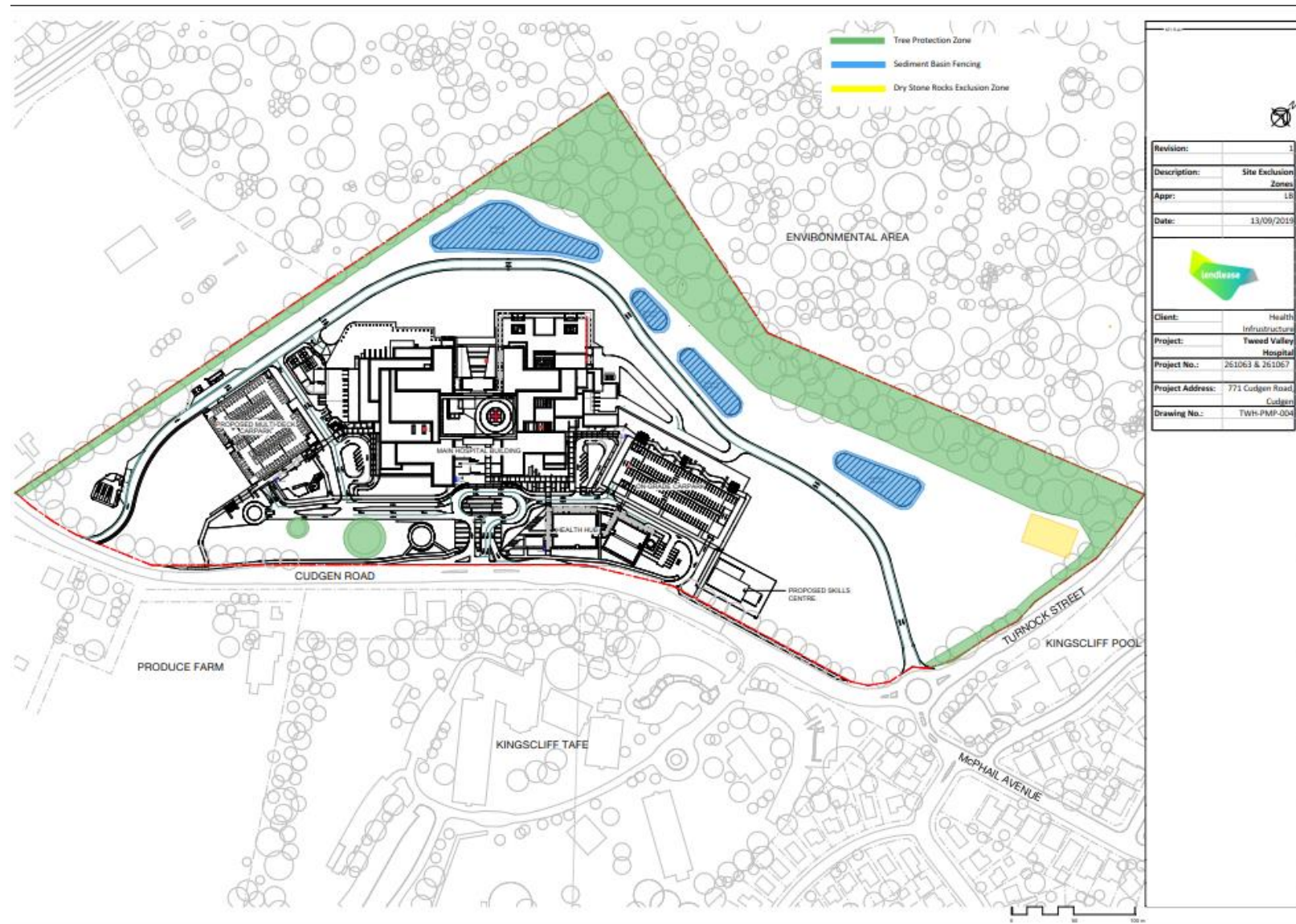

Appendix 3 – Unexpected Finds Protocol



UNEXPECTED FINDS PROTOCOL

Unexpected Find items can include, but are not limited to, hazardous building material, potential burial site or item of heritage or archaeological significance, medical paraphernalia, illicit items including weapons and drugs related objects

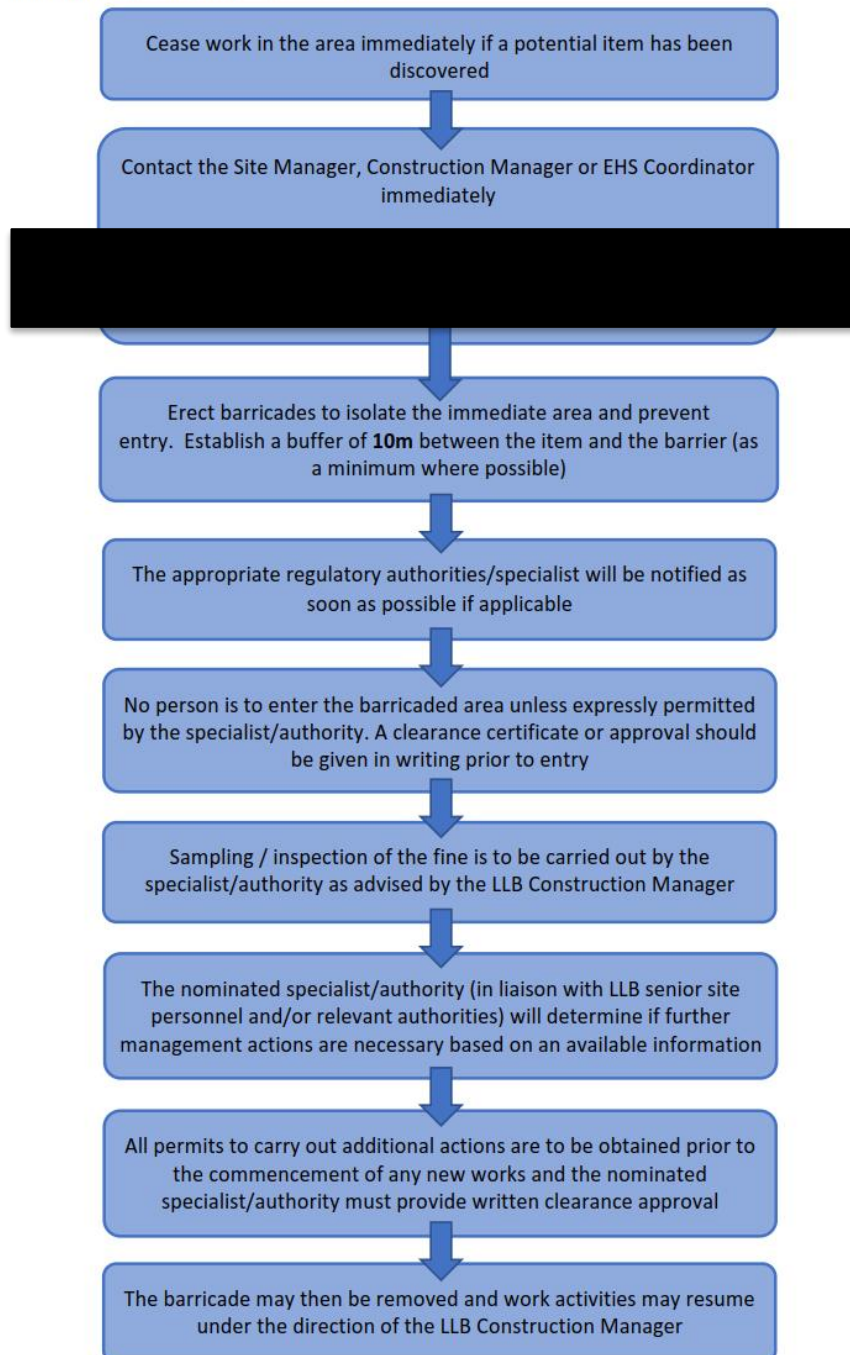

Appendix 4 – Reference Photos (Walls, Tree and Rubbish Deposit)



Plate 2. Wall 1, view northeast.



Plate 13. Spreading fig tree on northeast side of house, view east.