

FT11
C.O.L.A.s

All over the site children will find Covered Outdoor Learning Areas (C.O.L.A.) which shall provide varying degrees of enclosure and protection to entry points and external circulation corridors. A louvre and panelised roof system at the top of each COLA. will provide a shading element to shelter outdoor learning environments and offer opportunities for covered play during inclement weather. Similar to other key feature elements displayed by the new buildings, these forms are designed with accentuated verticality to respond to the heritage buildings.

They reflect the language of Building J and H by exposing feature structural frames, made from cross laminated timber. Reflecting their technological era they shall be more slender and more finely detailed with modern assembly techniques and combustibility treatments. This timber detailing will also act as an emblem for the sustainability initiative for the Fort Street Public School's ecological stance and for the broader Environmentally Sustainable Design initiatives for Schools Infrastructure.



NORTH ELEVATION



WEST ELEVATION



FACADE TYPE EXTENT

FT11
Exposed feature
structural members.
Engineered, Cross
Laminated Timber
frames

FT11
Timber sunshade
profiled louvres

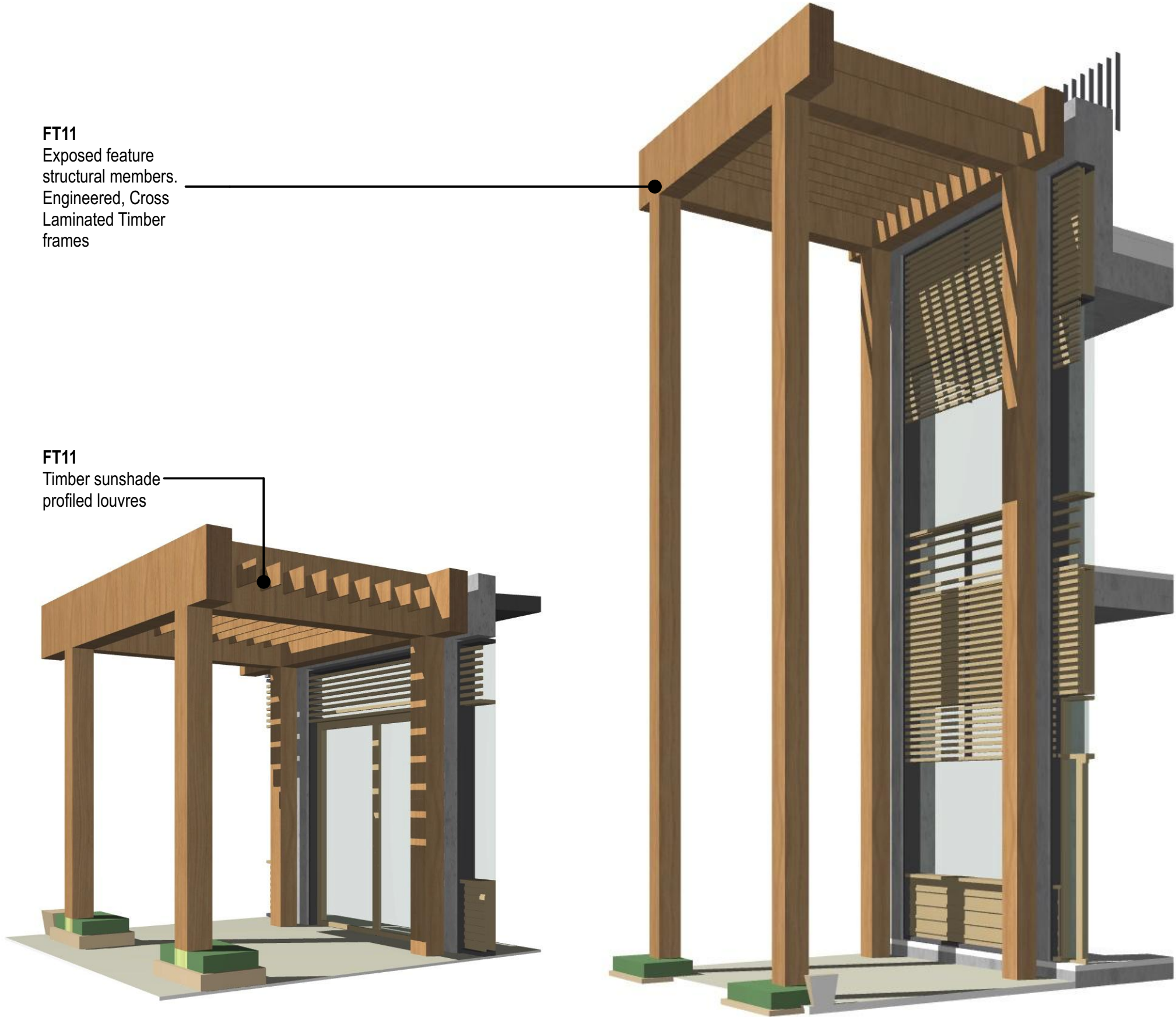

SSD A01	18/12/19	State Significance Development Application	CTK
rev	date	name	by

fjmt studio architecture interiors landscape urban community
sydney melbourne uk
Level 5, 70 King Street E +61 2 9251 7077 • fjmtstudio.com



project
Fort Street Public School
Observatory Hill
Sydney NSW 2000

title
Facade Diagrams
FT11 C.O.L.A.

scale	1:200 @ A1	first issued	18/10/19
project code	FSS	sheet no.	DA-5908
		revision	SSDA01