



SITE CONTEXT - NTS

* PLEASE NOTE: PLANS TO BE READ IN CONJUNCTION
WITH THE FOLLOWING DA DESIGN REPORT PREPARED
BY SCOTT CARVER -
20180199-DR-SSD001 LANDSCAPE DESIGN REPORT [2]

LANDSCAPE - SSDA

QANTAS GROUP FLIGHT TRAINING CENTRE, 297 KING STREET, MASCOT, 2020

QANTAS
DATE - JULY 31, 2019

20180199: LANDSCAPE ARCHITECTURAL DRAWING LIST

LANDSCAPE DRAWING REGISTER		
SHEET	SHEET NAME	REVISION
LD-DA000	COVER SHEET	3
LD-DA100	GENERAL ARRANGEMENT LAYOUT	3
LD-DA101	GENERAL ARRANGEMENT 1	3
LD-DA102	GENERAL ARRANGEMENT 2	3
LD-DA103	GENERAL ARRANGEMENT 3	3
LD-DA104	GENERAL ARRANGEMENT 4	3

History		
[Rev#]	[Description]	[Date]
1	For SSDA	12.04.19
2	For SSDA RTS	31.07.19
3	For SSDA RTS	11.09.19

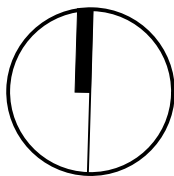

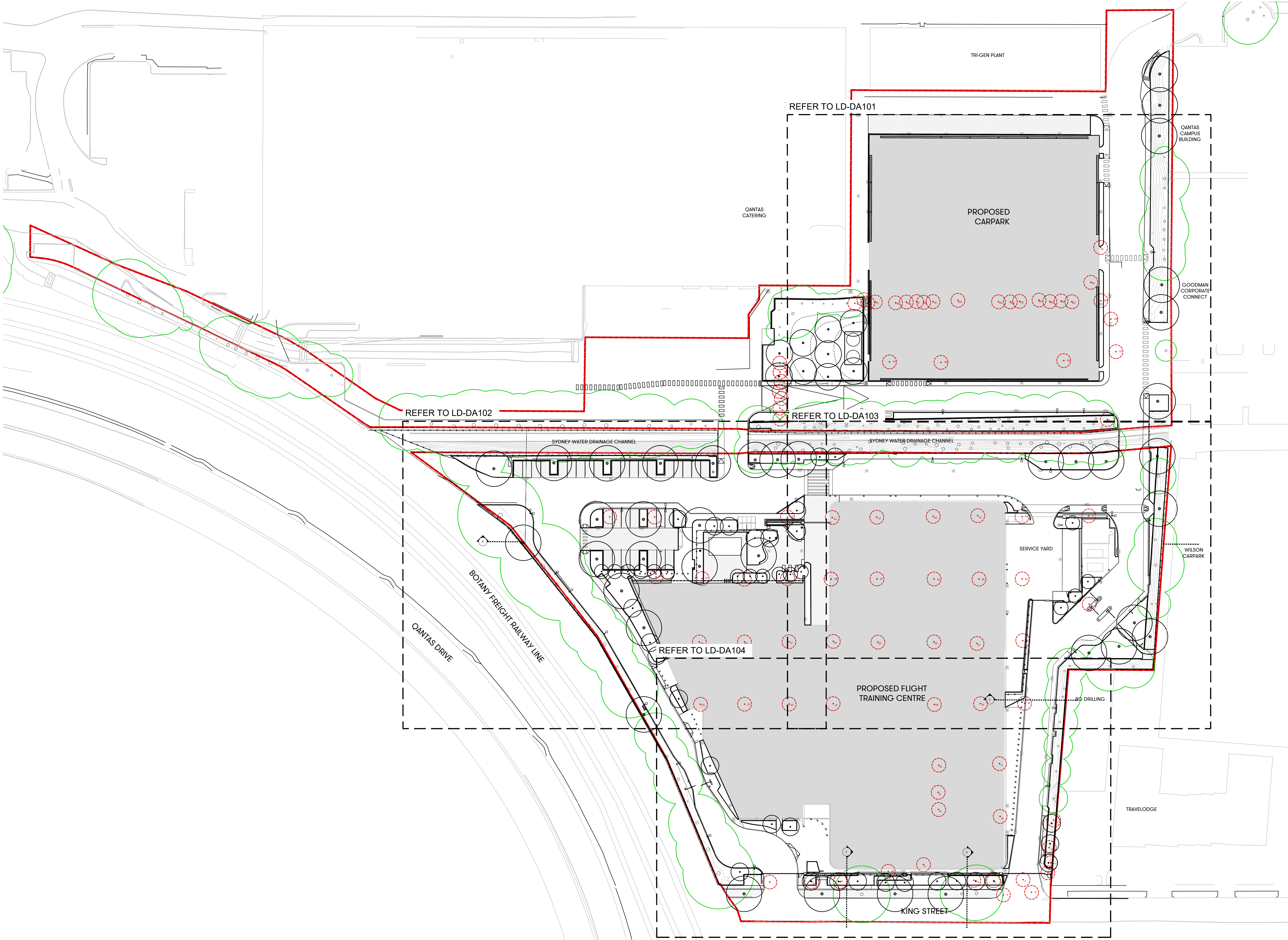

[Status] FOR SSD APPLICATION

[Nom. Architect] Esther Dickins
RLA #1053

[File] 20180199-LD-DA100.DWG

[Print Date] 11 September 2019

History

[Rev#]	[Description]	[Date]
1	For SSDA	12.04.19
2	For SSDA RTS	31.07.19
3	For SSDA RTS	11.09.19

LEGEND:

- Project Site Boundary
- +RL 0.00 Proposed nominal design levels (Refer Civil)
- +EX 0.00 Existing level
- Existing 0.1m contour
- Proposed 0.5m contour
- Tree to be removed - refer to Arborist's Report
- Tree to be retained and protected - refer to Arborist's Report
- Proposed tree

Landscape plan to be read in conjunction with the Architectural and Engineers dwgs.

Plans to be read in conjunction with the following reports/Documentation

- Landscape Design Report
- Arboricultural Impact Assessment Report by EntsTree Consultancy
- Geotechnical engineering report
- Site Survey by Land Partners
- Noxon Giffen Architects

For Site levels and architectural information refer to Civil and Architect's drawings respectively.

For courtyard and overflow drainage refer to Hydraulic Engineer's drawings

All trees to be retained and are subject to tree protection & management in accordance with relevant Australian standards.

External Lighting and electrical: refer to Engineer's * Architect's drawings.

Contractor to protect all landscape works during construction including but not exclusive to existing verge.

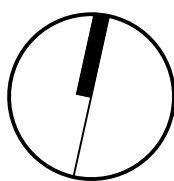

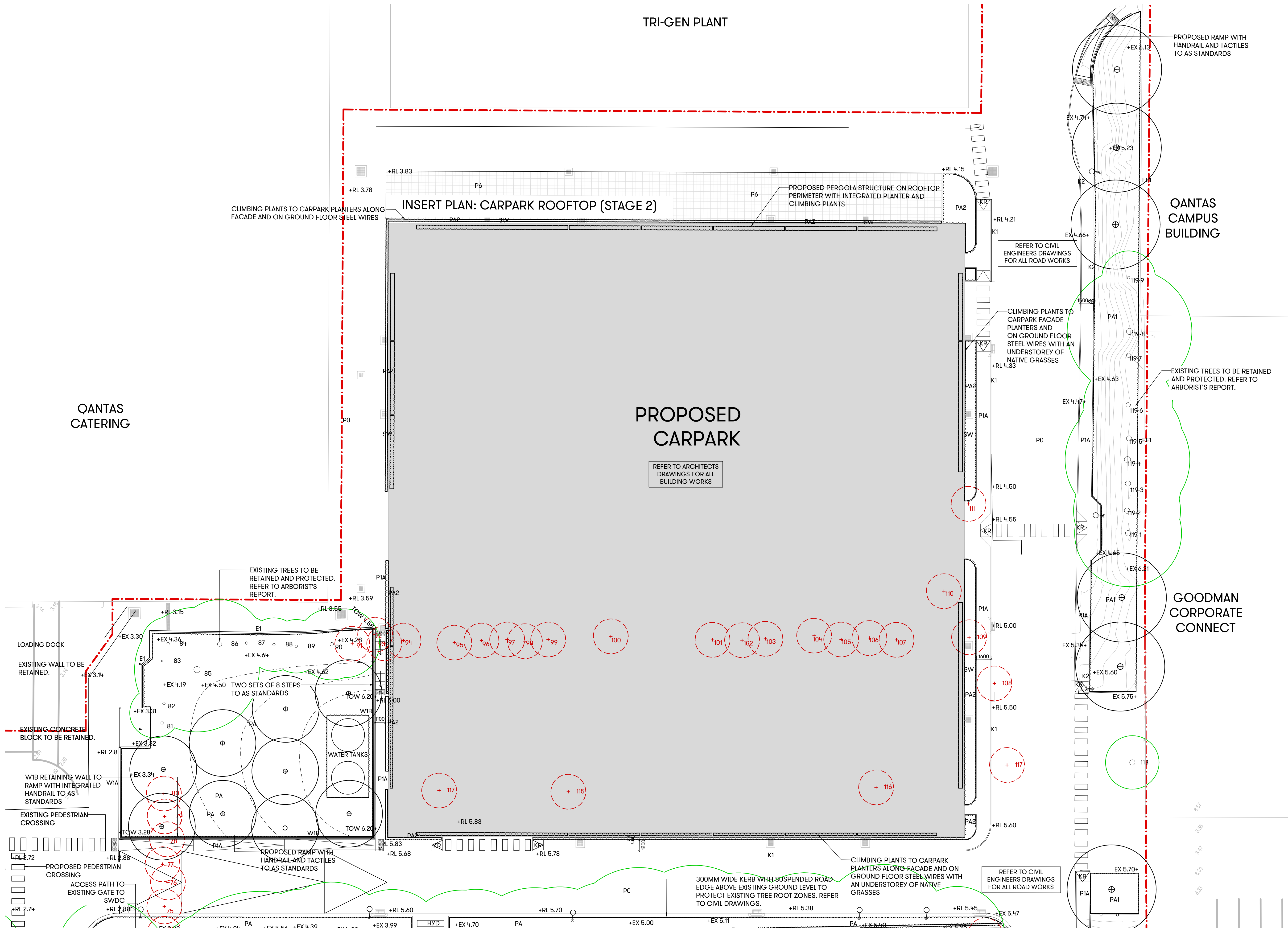

[Status] FOR SSD APPLICATION

[Nom. Architect] Esther Dickens
RLA #1053

[File] 20180199-LD-DA100.DWG

[Print Date] 11 September 2019

History

[Rev#]	[Description]	[Date]
1	For SSDA	12.04.19
2	For SSDA RTS	31.07.19
3	For SSDA RTS	11.09.19

LEGEND:

- Project Site Boundary
- Extent of Works
- +RL 0.00 Proposed nominal design levels (Refer Civil)
- +EX 0.00 Existing level
- Existing 0.1m contour
- Proposed 0.5m contour
- Tree to be removed - refer to Arborist's Report
- Tree to be retained and protected - refer to Arborist's Report
- Proposed tree
- TU Turf
- PA Planting area. Refer to planting schedule
- PA1 Existing planting area to be improved with weed control & additional planting. Refer to planting schedule
- PA2 Planting area with climbers to grow up stainless steel wire. Refer to planting schedule
- P0 Road finish to Engineer's drawings
- P1A Paving type 1A: Pedestrian concrete pavement*
- P1B Paving type 1B: Vehicle concrete pavement*
- P2 Paving type 2: Granite pavers*
- P3 Paving type 3: Granite pavers*
- P4 Paving type 4: Pre-cast concrete path*
- P5 Paving type 5: No fines porous concrete*
- P6 Paving type 6: Porous paving*
- G1 Gate type 1: Pedestrian gate*
- G2 Gate Type 2: Vehicle gate. Refer to Architect's drawings
- GR Gravel*
- DE Decomposed granite*
- B1 Bollard Type 1: Fixed bollard*
- B2 Bollard Type 2: Removable bollard*
- F1 Furniture Type 1: Timber bench*
- F2 Furniture Type 2: Granite seating block*
- FE1 Fence Type 1: Existing fence*
- FE2 Fence Type 2: Security fence*
- FE3 Fence Type 3: Acoustic timber fence*
- K1 Kerb Type 1: Road kerb. Refer to Engineer's drawings
- K2 Kerb Type 2: Concrete kerb*
- SE Steel edge*
- W1A Wall Type 1A: Concrete retaining wall*
- W1B Wall Type 1B: Concrete retaining wall with handrail*
- W2A Wall Type 2A: 2400mm freestanding concrete wall*
- W2B Wall Type 2B: 1980mm freestanding concrete wall*
- LB Litter bin with ashtray*
- BR Bike rack*
- GBR Green roof bus shelter*
- SW Stainless steel wire ropes*
- TA Tactiles*
- KR Concrete kerb ramp to Engineer's details
- Lighting column. Refer to Architect's drawings
- * Refer to LD-CD001 Design Report Schedule
- Refer to LD-CD100 for General Notes

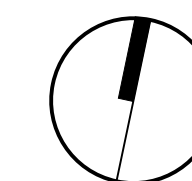

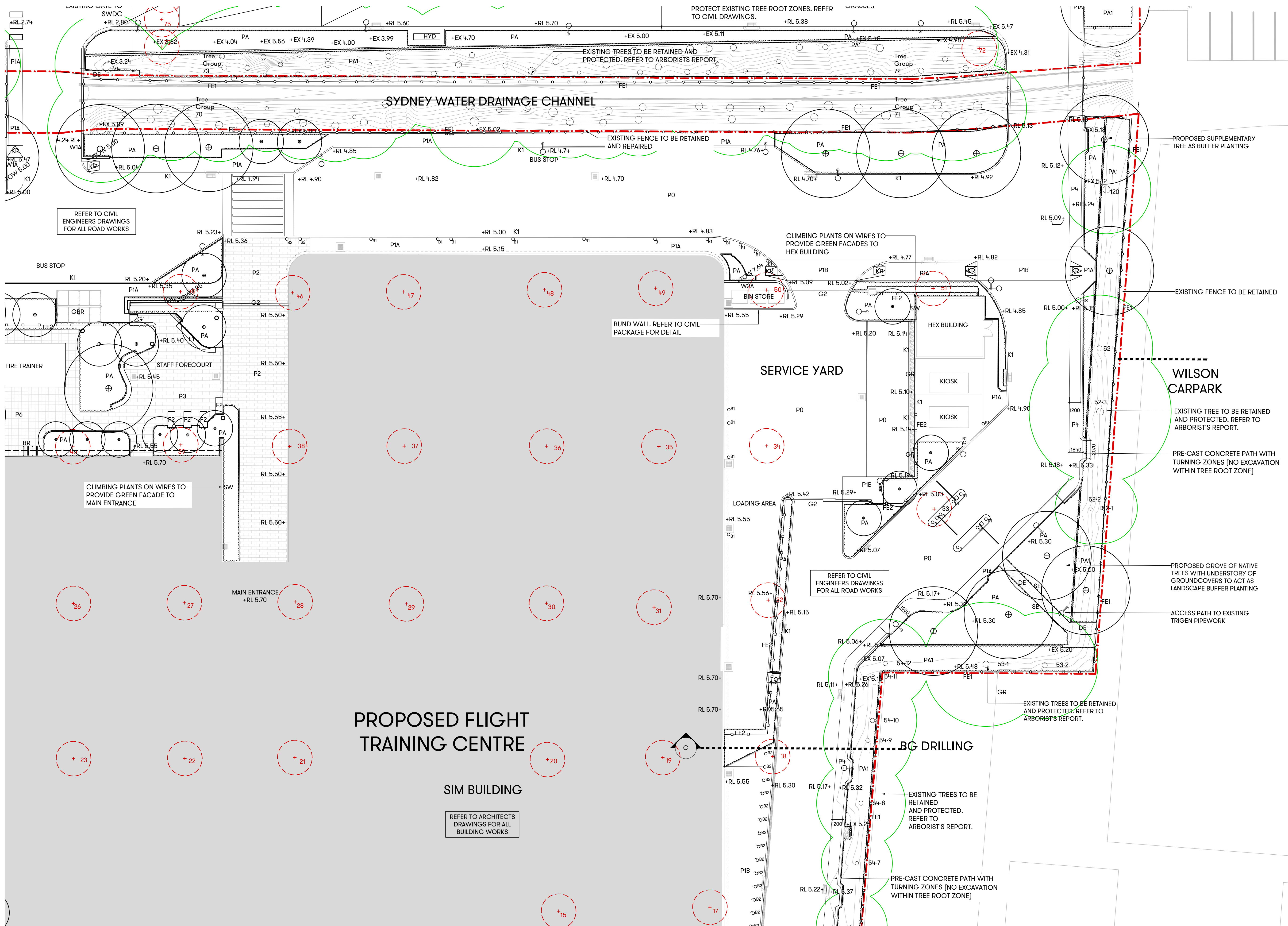

[Status] FOR SSD APPLICATION

[Nom. Architect] Esther Dickens
RLA #1053

[File] 20180199-LD-DA100.DWG

[Print Date] 11 September 2019

History

[Rev#]	[Description]	[Date]
1	For SSDA	12.04.19
2	For SSDA RTS	31.07.19
3	For SSDA RTS	11.09.19

LEGEND:

- Project Site Boundary
- Extent of Works
- +RL 0.00 Proposed nominal design levels (Refer Civil)
- +EX 0.00 Existing level
- Existing 0.1m contour
- Proposed 0.5m contour
- Tree to be removed - refer to Arborist's Report
- Tree to be retained and protected - refer to Arborist's Report
- Proposed tree
- TU Turf
- PA Planting area. Refer to planting schedule
- Existing planting area to be improved with weed control & additional planting. Refer to planting schedule
- PA1 Planting area with climbers to grow up stainless steel wire. Refer to planting schedule
- PA2
- P0 Road finish to Engineer's drawings
- P1A Paving type 1A: Pedestrian concrete pavement*
- P1B Paving type 1B: Vehicle concrete pavement*
- P2 Paving type 2: Granite pavers*
- P3 Paving type 3: Granite pavers*
- P4 Paving type 4: Pre-cast concrete path*
- P5 Paving type 5: No fines porous concrete*
- P6 Paving type 6: Porous paving*
- G1 Gate type 1: Pedestrian gate*
- G2 Gate Type 2: Vehicle gate. Refer to Architect's drawings
- GR Gravel*
- DE Decomposed granite*
- B1 Bollard Type 1: Fixed bollard*
- B2 Bollard Type 2: Removable bollard*
- F1 Furniture Type 1: Timber bench*
- F2 Furniture Type 2: Granite seating block*
- FE1 Fence Type 1: Existing fence*
- FE2 Fence Type 2: Security fence*
- FE3 Fence Type 3: Acoustic timber fence*
- K1 Kerb Type 1: Road kerb. Refer to Engineer's drawings
- K2 Kerb Type 2: Concrete kerb*
- SE Steel edge*
- W1A Wall Type 1A: Concrete retaining wall*
- W1B Wall Type 1B: Concrete retaining wall with handrail*
- W2A Wall Type 2A: 2400mm freestanding concrete wall*
- W2B Wall Type 2B: 1980mm freestanding concrete wall*
- LB Litter bin with ashtray*
- BR Bike rack*
- GBR Green roof bus shelter*
- SW Stainless steel wire ropes*
- TA Tactiles*
- KR Concrete kerb ramp to Engineer's details
- Lighting column. Refer to Architect's drawings
- * Refer to LD-CD001 Design Report Schedule
- Refer to LD-CD100 for General Notes

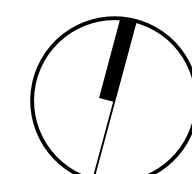

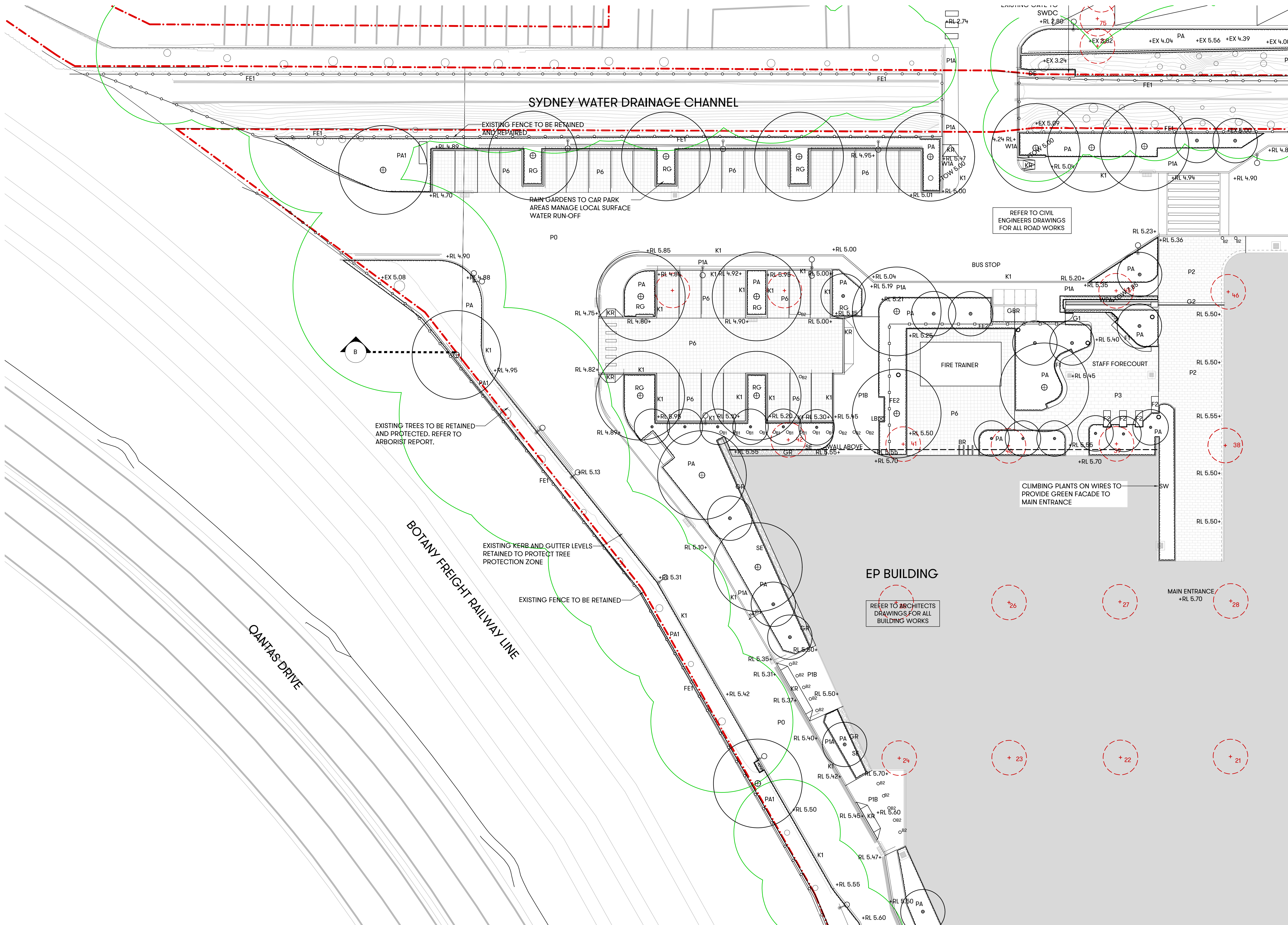

[Status] FOR SSD APPLICATION

[Nom. Architect] Esther Dickens
RLA #1053

[File] 20180199-LD-DA100.DWG

[Print Date] 11 September 2019

History

[Rev#]	[Description]	[Date]
1	For SSDA	12.04.19
2	For SSDA RTS	31.07.19
3	For SSDA RTS	11.09.19

LEGEND:

- Project Site Boundary
 - Extent of Works
 - Proposed nominal design levels (Refer Civil)
 - Existing level
 - Existing 0.1m contour
 - Proposed 0.5m contour
 - Tree to be removed - refer to Arborist's Report
 - Tree to be retained and protected - refer to Arborist's Report
 - Proposed tree
 - Turf
 - Planting area. Refer to planting schedule
 - Existing planting area to be improved with weed control & additional planting. Refer to planting schedule
 - Planting area with climbers to grow up stainless steel wire. Refer to planting schedule
 - P0 Road finish to Engineer's drawings
 - P1A Paving type 1A: Pedestrian concrete pavement*
 - P1B Paving type 1B: Vehicle concrete pavement*
 - P2 Paving type 2: Granite pavers*
 - P3 Paving type 3: Granite pavers*
 - P4 Paving type 4: Pre-cast concrete path*
 - P5 Paving type 5: No fines porous concrete*
 - P6 Paving type 6: Porous paving*
 - G1 Gate type 1: Pedestrian gate*
 - G2 Gate Type 2: Vehicle gate. Refer to Architect's drawings
 - GR Gravel*
 - DE Decomposed granite*
 - B1 Bollard Type 1: Fixed bollard*
 - B2 Bollard Type 2: Removable bollard*
 - F1 Furniture Type 1: Timber bench*
 - F2 Furniture Type 2: Granite seating block*
 - FE1 Fence Type 1: Existing fence*
 - FE2 Fence Type 2: Security fence*
 - FE3 Fence Type 3: Acoustic timber fence*
 - K1 Kerb Type 1: Road kerb. Refer to Engineer's drawings
 - K2 Kerb Type 2: Concrete kerb*
 - SE Steel edge*
 - W1A Wall Type 1A: Concrete retaining wall*
 - W1B Wall Type 1B: Concrete retaining wall with handrail*
 - W2A Wall Type 2A: 2400mm freestanding concrete wall*
 - W2B Wall Type 2B: 1980mm freestanding concrete wall*
 - LB Litter bin with ashtray*
 - BR Bike rack*
 - GBR Green roof bus shelter*
 - SW Stainless steel wire ropes*
 - T1A Tactiles*
 - KR Concrete kerb ramp to Engineer's details
 - Lighting column. Refer to Architect's drawings
- * Refer to LD-CD001 Design Report Schedule
Refer to LD-CD100 for General Notes

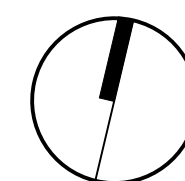

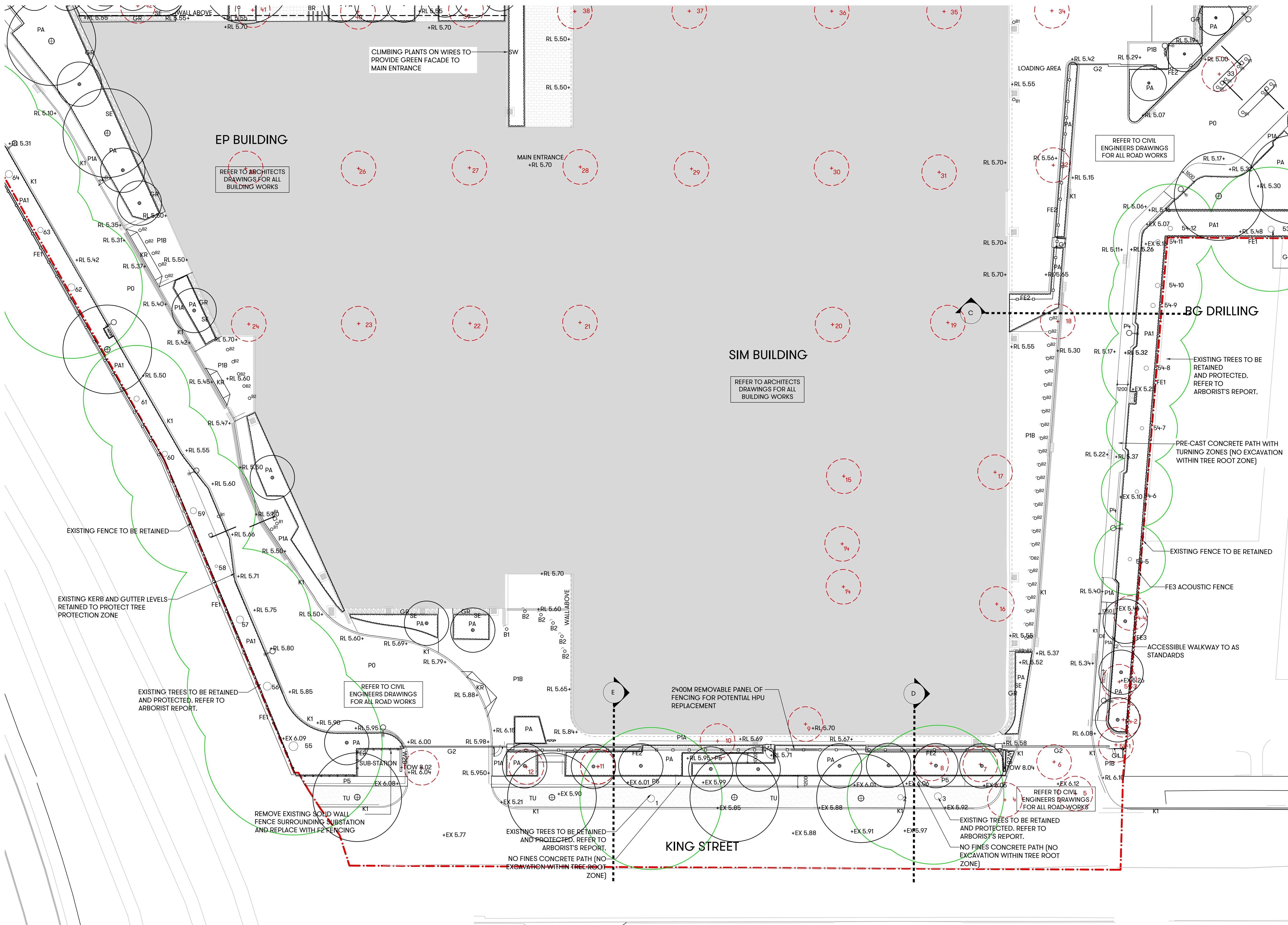

[Status] FOR SSD APPLICATION

[Nom. Architect] Esther Dickens
RLA #1053

[File] 20180199-LD-DA100.DWG

[Print Date] 11 September 2019

History

[Rev#]	[Description]	[Date]
1	For SSDA	12.04.19
2	For SSDA RTS	31.07.19
3	For SSDA RTS	11.09.19

LEGEND:

- Project Site Boundary
- Extent of Works
- +RL 0.00 Proposed nominal design levels (Refer Civil)
- +EX 0.00 Existing level
- Existing 0.1m contour
- Proposed 0.5m contour
- Tree to be removed - refer to Arborist's Report
- Tree to be retained and protected - refer to Arborist's Report
- Proposed tree
- TU Turf
- PA Planting area. Refer to planting schedule
- PA1 Existing planting area to be improved with weed control & additional planting. Refer to planting schedule
- PA2 Planting area with climbers to grow up stainless steel wire. Refer to planting schedule
- P0 Road finish to Engineer's drawings
- P1A Paving type 1A: Pedestrian concrete pavement*
- P1B Paving type 1B: Vehicle concrete pavement*
- P2 Paving type 2: Granite pavers*
- P3 Paving type 3: Granite pavers*
- P4 Paving type 4: Pre-cast concrete path*
- P5 Paving type 5: No fines porous concrete*
- P6 Paving type 6: Porous paving*
- G1 Gate type 1: Pedestrian gate*
- G2 Gate Type 2: Vehicle gate. Refer to Architect's drawings
- GR Gravel*
- DE Decomposed granite*
- B1 Bollard Type 1: Fixed bollard*
- B2 Bollard Type 2: Removable bollard*
- F1 Furniture Type 1: Timber bench*
- F2 Furniture Type 2: Granite seating block*
- FE1 Fence Type 1: Existing fence*
- FE2 Fence Type 2: Security fence*
- FE3 Fence Type 3: Acoustic timber fence*
- K1 Kerb Type 1: Road kerb. Refer to Engineer's drawings
- K2 Kerb Type 2: Concrete kerb*
- SE Steel edge*
- W1A Wall Type 1A: Concrete retaining wall*
- W1B Wall Type 1B: Concrete retaining wall with handrail*
- W2A Wall Type 2A: 2400mm freestanding concrete wall*
- W2B Wall Type 2B: 1980mm freestanding concrete wall*
- LB Litter bin with ashtray*
- BR Bike rack*
- GBR Green roof bus shelter*
- SW Stainless steel wire ropes*
- TA Taciles*
- KR Concrete kerb ramp to Engineer's details
- Lighting column. Refer to Architect's drawings

* Refer to LD-CD001 Design Report Schedule
Refer to LD-CD100 for General Notes



Level One, One Chifley Square Sydney NSW 2000 Australia
www.scottcarver.com.au +61 2 9957 3988

[Project]

QANTAS GROUP FLIGHT TRAINING CENTRE

[Client]

QANTAS

0 2 4 6 8 10

[Scale] 1 : 200 @ A1

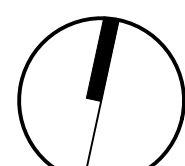

LANDSCAPE GENERAL ARRANGEMENT 4

[Ref] 20180199

[Dwg No] LD-DA104

[Rev] 3