

LEVEL	RETAIL	CINEMA	SHFA	SERVICED APARTMENTS	HOTEL	CAR PARKS	TOTAL
H L24							
H L23					139m ²		139m ²
H L22					1111m ²		1111m ²
H L21					772m ²		772m ²
H L20					1622m ²		1622m ²
H L19					1818m ²		1818m ²
H/SA L18					1839m ²		1839m ²
H/SA L17				36m ²	1567m ²		1933m ²
H/SA L16				668m ²	1546m ²		2214m ²
H/SA L15				687m ²	1530m ²		2217m ²
H/SA L14				1014m ²	1568m ²		2582m ²
H/SA L13				1143m ²	1546m ²		2689m ²
H/SA L12				1234m ²	1521m ²		2755m ²
H/SA L11				1368m ²	1440m ²		2808m ²
H/SA L10				1507m ²	1414m ²		2921m ²
H/SA L09				1534m ²	1381m ²		2915m ²
H/SA L08				1632m ²	1354m ²		2986m ²
H/SA L07				1684m ²	1295m ²		2979m ²
H/SA L06				952m ²	1397m ²		2349m ²
H L05					1285m ²		1285m ²
P L04		68m ²			2265m ²		2333m ²
P L03		389m ²			1712m ²		2101m ²
P L02		444m ²		0m ²	1538m ²		1982m ²
P L01	610m ²	898m ²	144m ²	0m ²	1048m ²		2700m ²
GF	1225m ²	610m ²	174m ²		520m ²		2529m ²
TOTAL	1835m ²	2409m ²	318m ²	13789m ²	33228m ²	0	51579m ²

NOTE:
GROSS FLOOR AREA (GFA)
MEASURED AS PER SYDNEY LOCAL
ENVIRONMENTAL PLAN 2012

Measured drawings:

ARC-HSL-DD-1100	Rev W
ARC-HSL-DD-1101	Rev S
ARC-HSL-DD-1102	Rev P
ARC-HSL-DD-1103	Rev M
ARC-HSL-DD-1104	Rev M
ARC-HSL-DD-1105	Rev M
ARC-HSL-DD-1106	Rev K1
ARC-HSL-DD-1107	Rev J1
ARC-HSL-DD-1108	Rev J1
ARC-HSL-DD-1109	Rev J1
ARC-HSL-DD-1110	Rev J1
ARC-HSL-DD-1111	Rev J1
ARC-HSL-DD-1112	Rev J1
ARC-HSL-DD-1112.1	Rev H
ARC-HSL-DD-1112.2	Rev I
ARC-HSL- 4301	Rev 5
ARC-HSL- 4302	Rev 5

GFA Method of Measurement:

The sum of the floor area of each floor of a building measured from the internal face of external walls, or from the internal face of walls separating the building from any other building, or from the back of the mullions of curtain walls, measured at a height of 1.4 metres above the floor. Areas measured to include perimeter walls around aggregate areas of exclusions, including structural core walls.

Inclusions:

- (a) the area of a mezzanine, and
(b) habitable rooms in a basement or an attic, and
(c) any shop, auditorium, cinema, and the like, in a basement or attic,

Exclusions:

- (d) any area for common vertical circulation, such as lifts and stairs, and
(e) any basement:
(i) storage, and
(ii) vehicular access, loading areas, garbage and services, and
(f) plant rooms, lift towers and other areas used exclusively for mechanical services or ducting, and
(g) car parking to meet any requirements of the consent authority (including access to that car parking), and
(h) any space used for the loading or unloading of goods (including access to it), and
(i) terraces and balconies with outer walls less than 1.4 metres high, and
(j) voids above a floor at the level of a storey or storey above.

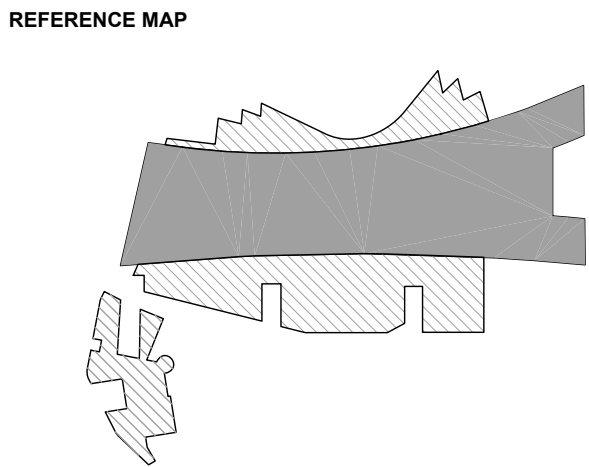

NOTES

- DO NOT SCALE DRAWINGS. WRITTEN DIMENSIONS GOVERN.
- ALL DIMENSIONS ARE IN MILLIMETRES UNLESS NOTED OTHERWISE.
- ALL DIMENSIONS SHALL BE VERIFIED ON SITE BEFORE PROCEEDING WITH THE WORK. HASSELL SHALL BE NOTIFIED IN WRITING OF ANY DISCREPANCIES.
- THIS DRAWING MUST BE READ IN CONJUNCTION WITH ALL RELEVANT CONTRACTS, SPECIFICATIONS AND DRAWINGS.

© COPYRIGHT OF THIS DRAWING IS VESTED IN HASSELL LTD.
2017 HASSELL LTD.

THIS DRAWING IS AN UNCONTROLLED COPY, UNLESS NOTED OTHERWISE.

V	DA MODIFICATION 14	08.09.21
U	DA MODIFICATION 10 (SHFA + PORTE COCHERE)	09.12.19
T	DA MODIFICATION 10 (SHFA + PORTE COCHERE)	06.09.19
S	DA MODIFICATION 8 (IMAX)	10.04.19
R	AMENDED INTERIOR FITOUT DA MODIFICATION 6 (TOWER)	05.04.18
Q	AMENDED INTERIOR FITOUT DA MODIFICATION 6 (TOWER)	26.03.18
P	DA MODIFICATION 6 (TOWER)	23.10.17
N1	AMENDED REVISION DESCRIPTION NEW SEQUENCE DA MOD 5 (ROOM MIX)	23.10.17
N	DA MODIFICATION 4 (ROOM MIX)	15.05.17
M1	AMENDED AREAS DA MODIFICATION 3 (PODIUM)	19.10.17
M	DA MODIFICATION 3 (PODIUM)	27.04.17
L	AMENDED DEVELOPMENT APPLICATION	12.04.17
K	AMENDED DEVELOPMENT APPLICATION	06.04.17
J	AMENDED DEVELOPMENT APPLICATION	16.12.16
H	AMENDED DEVELOPMENT APPLICATION	14.12.16
G	AMENDED DEVELOPMENT APPLICATION	21.03.16
F	AMENDED DEVELOPMENT APPLICATION	15.12.15
E	AMENDED DEVELOPMENT APPLICATION	23.10.15
D	DEVELOPMENT APPLICATION	14.01.14
C	DEVELOPMENT APPLICATION	05.09.13
B	DEVELOPMENT APPLICATION	20.08.13
A	FINAL DRAFT	23.07.13
-	ISSUED FOR INFORMATION	19.07.13
REV	DESCRIPTION	DATE

ARCHITECT

HASSELL Limited ABN 007 711
438 LEVEL 2, PIER 8/8, 23
HICKSON ROAD SYDNEY NSW
2000 AUSTRALIA
SYDNEY@HASSELLSTUDIO.COM
T +61 2 9101 2000 F +61 2 9101
2100

HASSELL

CLIENT



PROJECT

THE RIBBON HOTEL,
SERVICED APARTMENTS AND RETAIL

31 WHEAT ROAD, SYDNEY

DRAWING TITLE

GFA AREA SCHEDULE

STATUS

FOR APPROVAL

SCALE @ B1	DRAWN	CO-ORD	REVIEWED	APPROVED
	RT	MH	MH	EL
PROJECT NUMBER	DRAWING NUMBER	REV		
A004409	ARC-HSL-DD-1052	V		

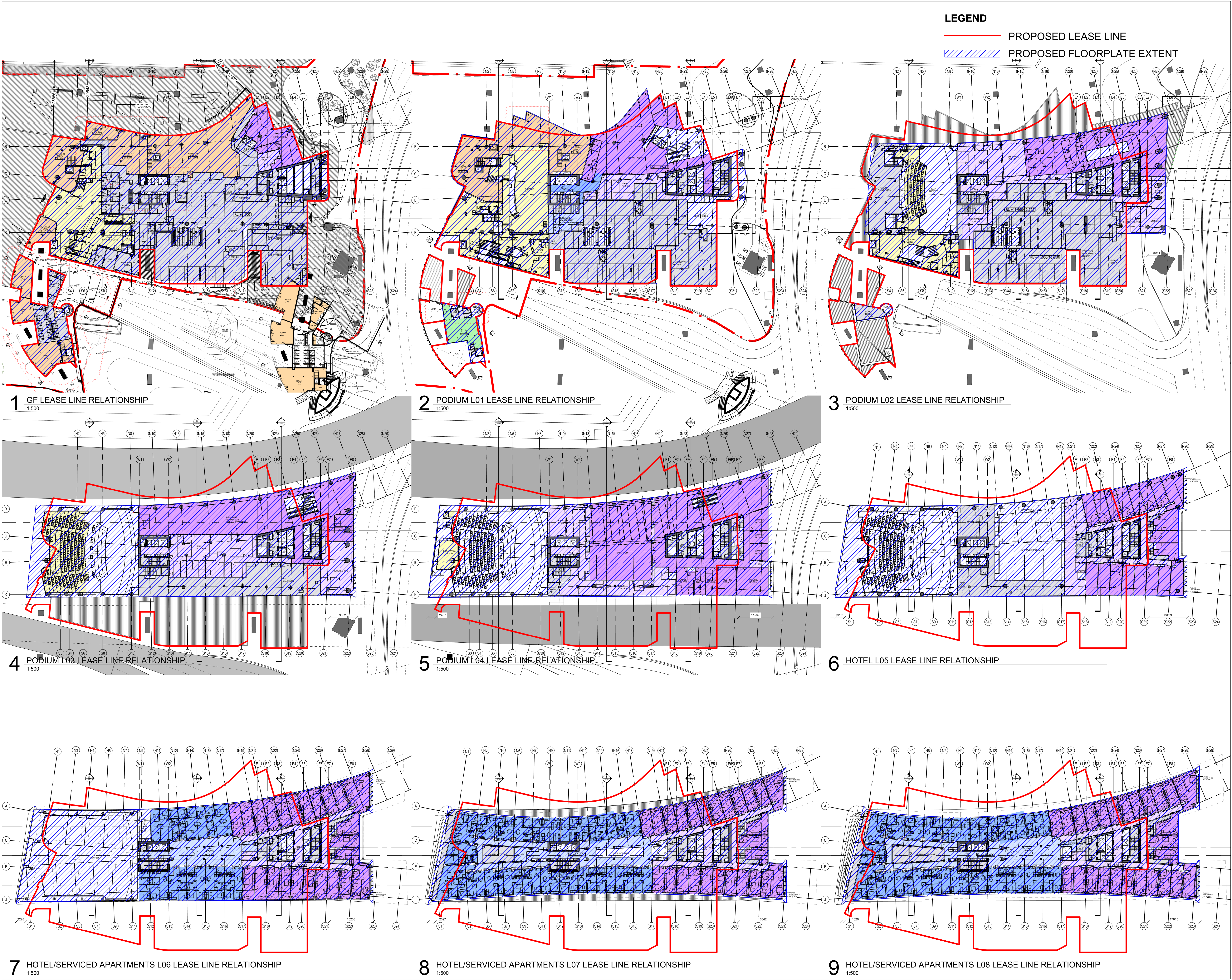

REFERENCE MAP

0 10 20 40m
1:500

NOTES

- DO NOT SCALE DRAWINGS. WRITTEN DIMENSIONS GOVERN.
- ALL DIMENSIONS ARE IN MILLIMETRES UNLESS NOTED OTHERWISE.
- ALL DIMENSIONS SHALL BE VERIFIED ON SITE BEFORE PROCEEDING WITH THE WORK. HASSELL SHALL BE NOTIFIED IN WRITING OF ANY DISCREPANCIES.
- THIS DRAWING MUST BE READ IN CONJUNCTION WITH ALL RELEVANT CONTRACTS, SPECIFICATIONS AND DRAWINGS.

© COPYRIGHT OF THIS DRAWING IS VESTED IN HASSELL LTD.
2017 HASSELL LTD.

THIS DRAWING IS AN UNCONTROLLED COPY, UNLESS NOTED OTHERWISE.

REV	DESCRIPTION	DATE
O	DA MODIFICATION 14	08.09.21
N	DA MODIFICATION 10 (UPDATED INFORMATION)	23.01.20
M	DA MODIFICATION 10 (SHFA + PORTE COCHERE)	06.09.19
L	AMENDED INTERIOR FITOUT DA MODIFICATION 6 (TOWER)	05.04.18
K	AMENDED INTERIOR FITOUT DA MODIFICATION 6 (TOWER)	26.03.18
J	DA MODIFICATION 6 (TOWER)	23.10.17
H1	DELETE HATCH AND ADDITION OF PODIUM CANOPY DA MOD 3 (PODIUM)	19.10.17
H	DA MODIFICATION 3 (PODIUM)	21.04.17
G	AMENDED DEVELOPMENT APPLICATION	12.04.17
F	AMENDED DEVELOPMENT APPLICATION	14.02.17
E	AMENDED DEVELOPMENT APPLICATION	14.12.16
D	AMENDED DEVELOPMENT APPLICATION	01.04.16
C	AMENDED DEVELOPMENT APPLICATION	30.03.16
B	AMENDED DEVELOPMENT APPLICATION	15.12.15
A	AMENDED DEVELOPMENT APPLICATION	23.10.15
-	DEVELOPMENT APPLICATION	20.12.13

ARCHITECT

HASSELL Limited ABN 007 711
435 LEVEL 2, PER 8/8 20
HICKSON ROAD SYDNEY NSW
2000 AUSTRALIA
SYDNEY@HASSELLSTUDIO.COM
T +61 2 9101 2000 F +61 2 9101 2100

HASSELL

CLIENT

Grocon

PROJECT

THE RIBBON HOTEL,
SERVICED APARTMENTS AND RETAIL

31 WHEAT ROAD, SYDNEY

DRAWING TITLE

LEASE LINE RELATIONSHIP PLANS -
SHEET 1

STATUS

FOR APPROVAL

SCALE @ B1	DRAWN	CO-ORD	REVIEWED	APPROVED
1:500	RT	MH	MH	EL

PROJECT NUMBER
A004409

DRAWING NUMBER
ARC-HSL-DD-1078

REV
O

11/9/2021 5:40:00 PM

Original Sheet Size B1-1000 x 707mm

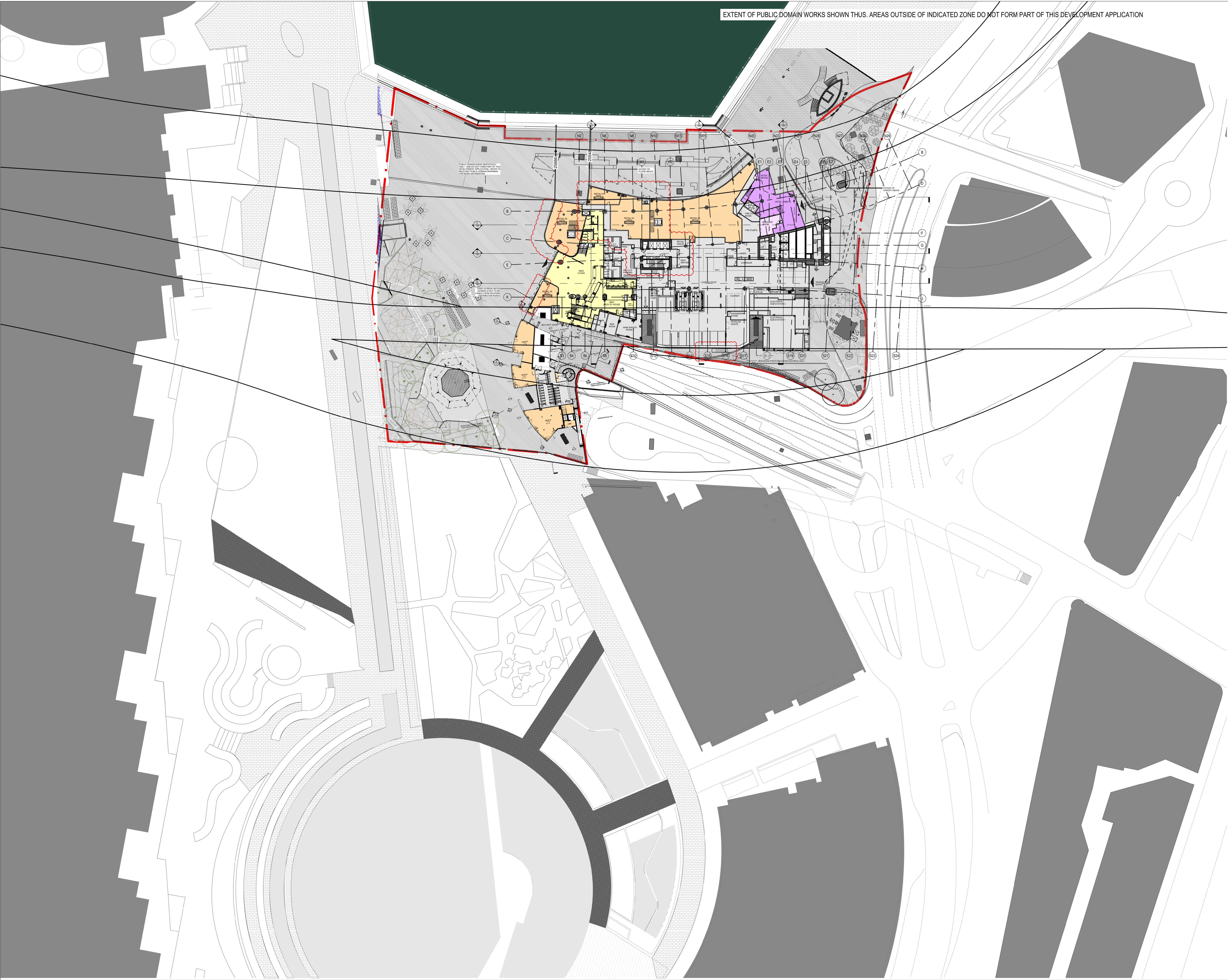

EXTENT OF PUBLIC DOMAIN WORKS SHOWN THUS. AREAS OUTSIDE OF INDICATED ZONE DO NOT FORM PART OF THIS DEVELOPMENT APPLICATION

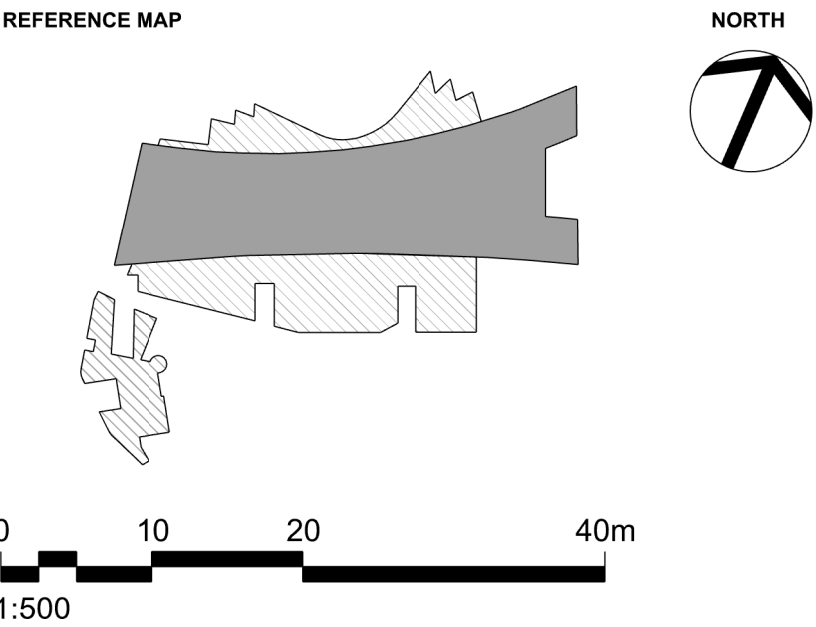

- NOTES
- DO NOT SCALE DRAWINGS. WRITTEN DIMENSIONS GOVERN.
 - ALL DIMENSIONS ARE IN MILLIMETRES UNLESS NOTED OTHERWISE.
 - ALL DIMENSIONS SHALL BE VERIFIED ON SITE BEFORE PROCEEDING WITH THE WORK. HASSELL SHALL BE NOTIFIED IN WRITING OF ANY DISCREPANCIES.
 - THIS DRAWING MUST BE READ IN CONJUNCTION WITH ALL RELEVANT CONTRACTS, SPECIFICATIONS AND DRAWINGS.

© COPYRIGHT OF THIS DRAWING IS VESTED IN HASSELL LTD.
2017 HASSELL LTD.

THIS DRAWING IS AN UNCONTROLLED COPY, UNLESS NOTED OTHERWISE.

REV	DESCRIPTION	DATE
R	DA MODIFICATION 14	08.09.21
Q	DA MODIFICATION 10 (UPDATED INFORMATION)	23.01.20
P	DA MODIFICATION 10 (SHFA + PORTE COCHERE)	19.12.19
O	DA MODIFICATION 10 (SHFA + PORTE COCHERE)	06.09.19
N	AMENDED INTERIOR FITOUT DA MODIFICATION 6 (TOWER)	05.04.18
M	AMENDED INTERIOR FITOUT DA MODIFICATION 6 (TOWER)	26.03.18
L	DA MODIFICATION 6 (TOWER)	23.10.17
K	DA MODIFICATION 3 (PODIUM)	15.09.17
J	AMENDED DEVELOPMENT APPLICATION	01.04.16
H	AMENDED DEVELOPMENT APPLICATION	30.03.16
G	AMENDED DEVELOPMENT APPLICATION	16.12.15
F	AMENDED DEVELOPMENT APPLICATION	15.12.15
E	AMENDED DEVELOPMENT APPLICATION	23.10.15
D	DEVELOPMENT APPLICATION	20.12.13
C	FOR REVIEW	19.12.13
B	DEVELOPMENT APPLICATION	20.08.13
A	FINAL DRAFT	23.07.13
-	ISSUED FOR INFORMATION	19.07.13

ARCHITECT
HASSELL Limited ABN 007 711
435 LEVEL 2, PIER 8/8-20
HICKSON ROAD SYDNEY NSW
2000 AUSTRALIA
SYDNEY@HASSELLSTUDIO.COM
T +61 2 9101 2000 F +61 2 9101 2100

HASSELL

CLIENT

PROJECT
THE RIBBON HOTEL,
SERVICED APARTMENTS AND RETAIL
31 WHEAT ROAD, SYDNEY

DRAWING TITLE
LOWER SITE PLAN

STATUS
FOR APPROVAL

SCALE @ B1	DRAWN	CO-ORD	REVIEWED	APPROVED
1:500	RT	MH	MH	EL
PROJECT NUMBER	DRAWING NUMBER	REV		
A004409	ARC-HSL-DD-1090	R		



REFERENCE MAP

0 4 8 16m

1:200

NORTH

NOTES

- DO NOT SCALE DRAWINGS. WRITTEN DIMENSIONS GOVERN.
- ALL DIMENSIONS ARE IN MILLIMETRES UNLESS NOTED OTHERWISE.
- ALL DIMENSIONS SHALL BE VERIFIED ON SITE BEFORE PROCEEDING WITH THE WORK. HASSELL SHALL BE NOTIFIED IN WRITING OF ANY DISCREPANCIES.
- THIS DRAWING MUST BE READ IN CONJUNCTION WITH ALL RELEVANT CONTRACTS, SPECIFICATIONS AND DRAWINGS.

© COPYRIGHT OF THIS DRAWING IS VESTED IN HASSELL LTD.
2017 HASSELL LTD.

THIS DRAWING IS AN UNCONTROLLED COPY, UNLESS NOTED OTHERWISE.

REV	DESCRIPTION	DATE
X	DA MODIFICATION 14	08.09.21
W	DA MODIFICATION 10 (UPDATED INFORMATION)	23.01.20
V	DA MODIFICATION 10 (ANNOTATIONS REMOVED)	13.01.20
U	DA MODIFICATION 10 (SHFA + PORTE COCHERE)	09.12.19
T	DA MODIFICATION 10 (SHFA + PORTE COCHERE)	06.09.19
S	DA MODIFICATION 8 (IMAX)	10.04.19
R1	INTERIOR FITOUT AMENDMENTS CLOUDED	12.06.18
R	AMENDED INTERIOR FITOUT DA MODIFICATION 6 (TOWER)	05.04.18
Q	AMENDED INTERIOR FITOUT DA MODIFICATION 6 (TOWER)	26.03.18
P	DA MODIFICATION 5 (TOWER)	18.10.17
N1	ADDITION OF CANOPY DA MOD 3 (PODIUM)	20.10.17
N	DA MODIFICATION 3 (PODIUM)	12.04.17
M	AMENDED DEVELOPMENT APPLICATION	28.03.17
L	AMENDED DEVELOPMENT APPLICATION	18.01.17
K	AMENDED DEVELOPMENT APPLICATION	26.04.16
J	AMENDED DEVELOPMENT APPLICATION	01.04.16
H	AMENDED DEVELOPMENT APPLICATION	30.03.16
G	AMENDED DEVELOPMENT APPLICATION	16.12.15
F	AMENDED DEVELOPMENT APPLICATION	15.12.15
E	AMENDED DEVELOPMENT APPLICATION	23.10.15
D	DEVELOPMENT APPLICATION	20.12.13
C	FOR REVIEW	29.11.13
B	DEVELOPMENT APPLICATION	20.08.13
A	FINAL DRAFT	23.07.13
-	ISSUED FOR INFORMATION	19.07.13

ARCHITECT

HASSELL Limited ABN 007 711
435 LEVEL 2, PIER 8/8, 23
HICKSON ROAD SYDNEY NSW
2000 AUSTRALIA
SYDNEY@HASSELLSTUDIO.COM
T +61 2 9101 2200 F +61 2 9101 2100

HASSELL

CLIENT

Grocon

PROJECT

**THE RIBBON HOTEL,
SERVICED APARTMENTS AND RETAIL**

31 WHEAT ROAD, SYDNEY

DRAWING TITLE

GA PLANS - GROUND FLOOR

STATUS

FOR APPROVAL

SCALE @ B1	DRAWN	CO-ORD	REVIEWED	APPROVED
1:200	RT	MH	MH	EL

PROJECT NUMBER	DRAWING NUMBER	REV
A004409	ARC-HSL-DD-1100	X

11/23/2021 9:51:00 AM

Original Sheet Size B1-1000 x 707mm

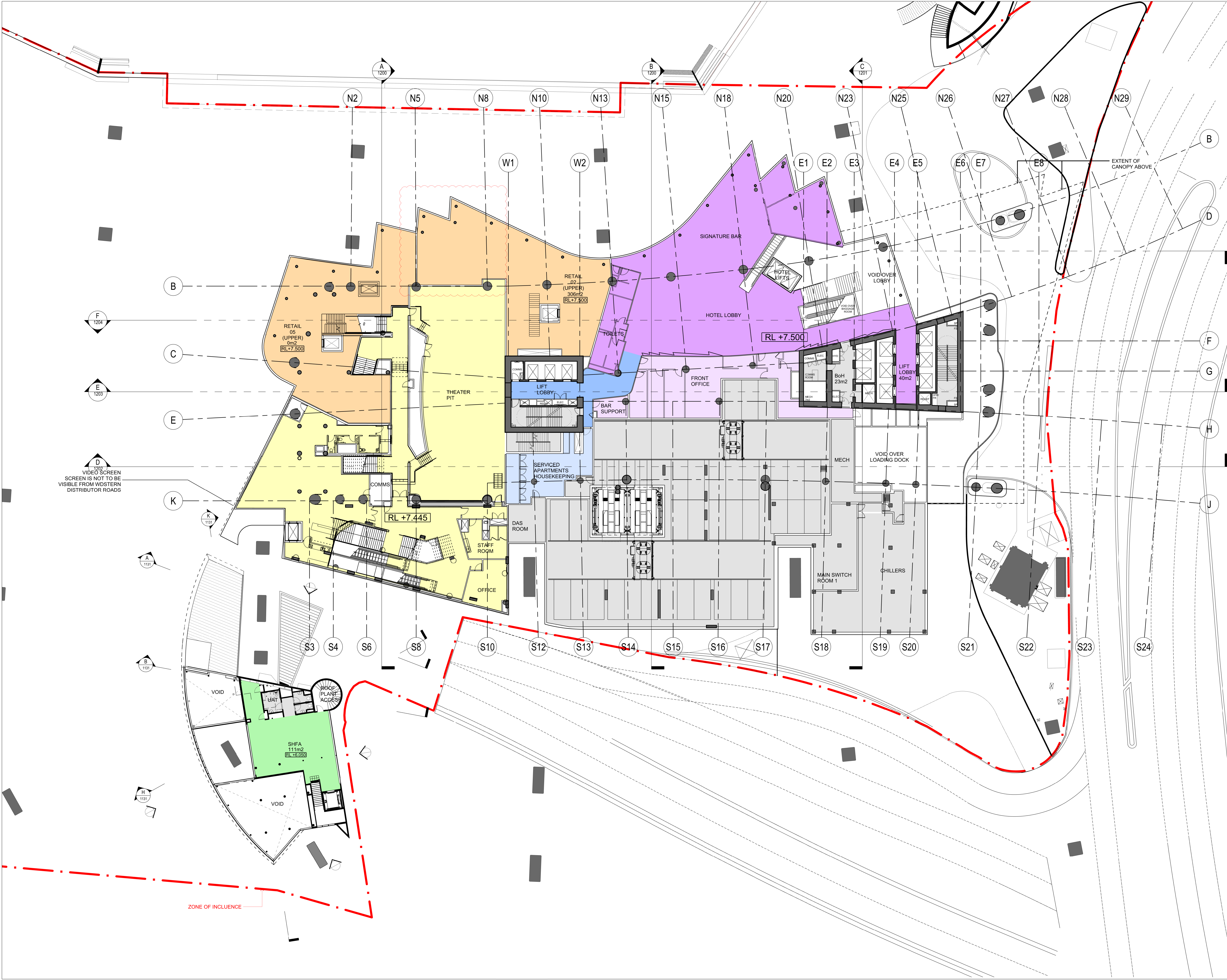

REFERENCE MAP

0 4 8 16m

1:200

NORTH

NOTES

- DO NOT SCALE DRAWINGS. WRITTEN DIMENSIONS GOVERN.
- ALL DIMENSIONS ARE IN MILLIMETRES UNLESS NOTED OTHERWISE.
- ALL DIMENSIONS SHALL BE VERIFIED ON SITE BEFORE PROCEEDING WITH THE WORK. HASSELL SHALL BE NOTIFIED IN WRITING OF ANY DISCREPANCIES.
- THIS DRAWING MUST BE READ IN CONJUNCTION WITH ALL RELEVANT CONTRACTS, SPECIFICATIONS AND DRAWINGS.

© COPYRIGHT OF THIS DRAWING IS VESTED IN HASSELL. LTD.
2017 HASSELL. LTD.

THIS DRAWING IS AN UNCONTROLLED COPY, UNLESS NOTED OTHERWISE.

REV	DESCRIPTION	DATE
T	DA MODIFICATION 14	08.09.21
S	DA MODIFICATION 10 (UPDATED INFORMATION)	23.01.20
R	DA MODIFICATION 10 (SHFA + PORTE COCHERE)	06.09.19
Q	DA MODIFICATION 8 (IMAX)	10.04.19
P	INTERIOR FITOUT AMENDMENTS CLOUDED DA MOD 6 (TOWER)	12.06.18
P	AMENDED INTERIOR FITOUT DA MODIFICATION 6 (TOWER)	05.04.18
N	AMENDED INTERIOR FITOUT DA MODIFICATION 6 (TOWER)	26.03.18
M	DA MODIFICATION 5 (TOWER)	18.10.17
L1	ADDITION OF CANOPY DA MOD 3 (PODIUM)	20.10.17
L	DA MODIFICATION 3 (PODIUM)	12.04.17
K	AMENDED DEVELOPMENT APPLICATION	28.03.17
J	AMENDED DEVELOPMENT APPLICATION	14.12.16
H	AMENDED DEVELOPMENT APPLICATION	26.04.16
G	AMENDED DEVELOPMENT APPLICATION	21.03.16
F	AMENDED DEVELOPMENT APPLICATION	15.12.15
E	AMENDED DEVELOPMENT APPLICATION	23.10.15
D	DEVELOPMENT APPLICATION	20.12.13
C	FOR REVIEW	29.11.13
B	DEVELOPMENT APPLICATION	20.08.13
A	FINAL DRAFT	23.07.13
-	ISSUED FOR INFORMATION	19.07.13

ARCHITECT

HASSELL Limited ABN 007 711
435 LEVEL 2, PIER 8/8, 20
HICKSON ROAD SYDNEY NSW
2000 AUSTRALIA
SYDNEY@HASSELLSTUDIO.COM
T +61 2 9101 2000 F +61 2 9101 2100

HASSELL

CLIENT

Grocon

PROJECT

THE RIBBON HOTEL,
SERVICED APARTMENTS AND RETAIL

31 WHEAT ROAD, SYDNEY

DRAWING TITLE

GA PLANS - PODIUM L01

STATUS

FOR APPROVAL

SCALE @ B1	DRAWN	CO-ORD	REVIEWED	APPROVED
1:200	RT	MH	MH	EL

PROJECT NUMBER	DRAWING NUMBER	REV
A004409	ARC-HSL-DD-1101	T

11/9/2021 1:38:00 PM

C:\Users\luc\Desktop\211171\Recovered model - 1004409_TheRibbon_Hotel DA_SRG_SHFA_Mod 10_Update (857992) RhinoAutosave (181450) RhinoAutosave 3m

Original Sheet Size B1-1000 x 707mm

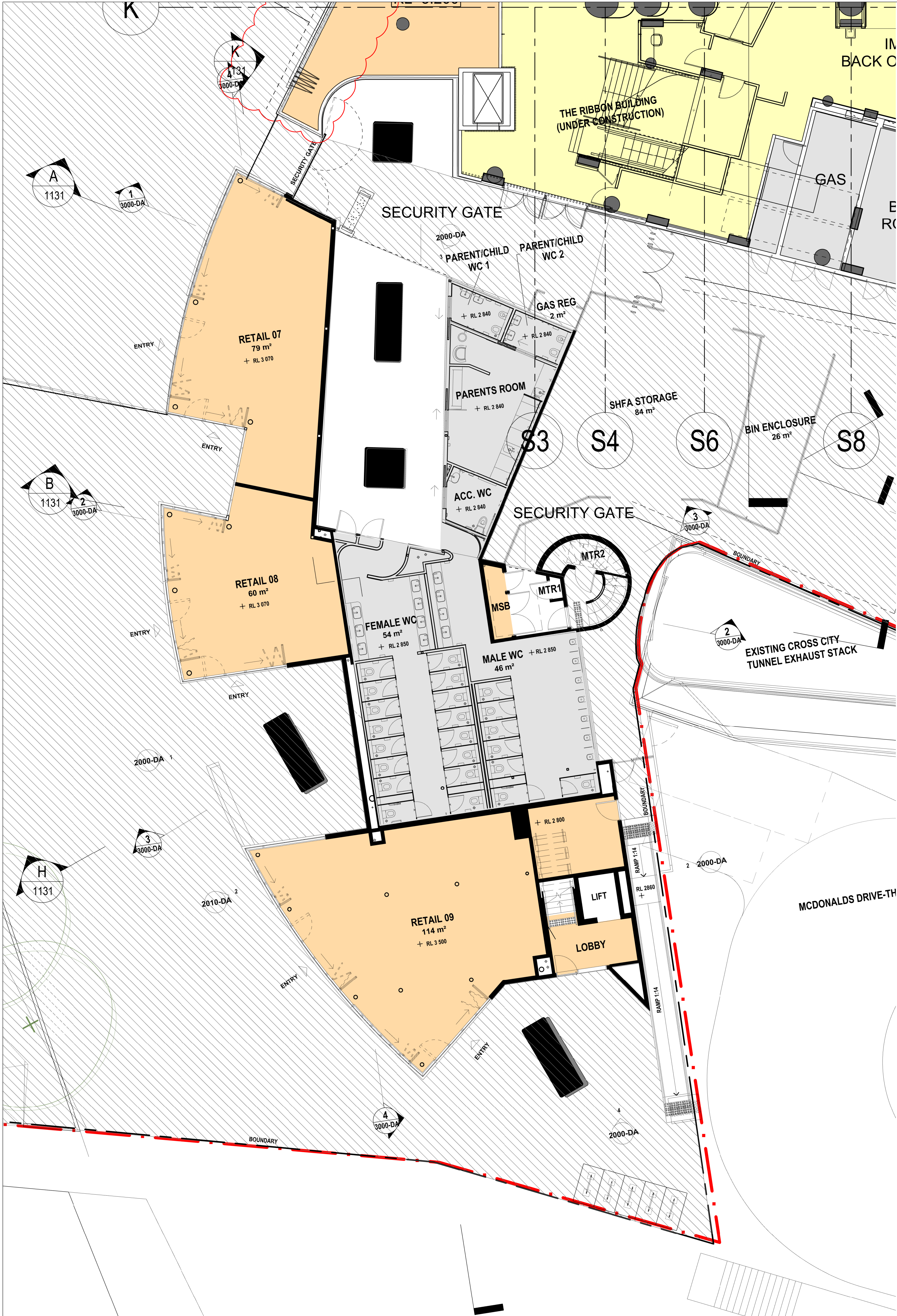

1 BUILDING 2 PODIUM GF
1:100

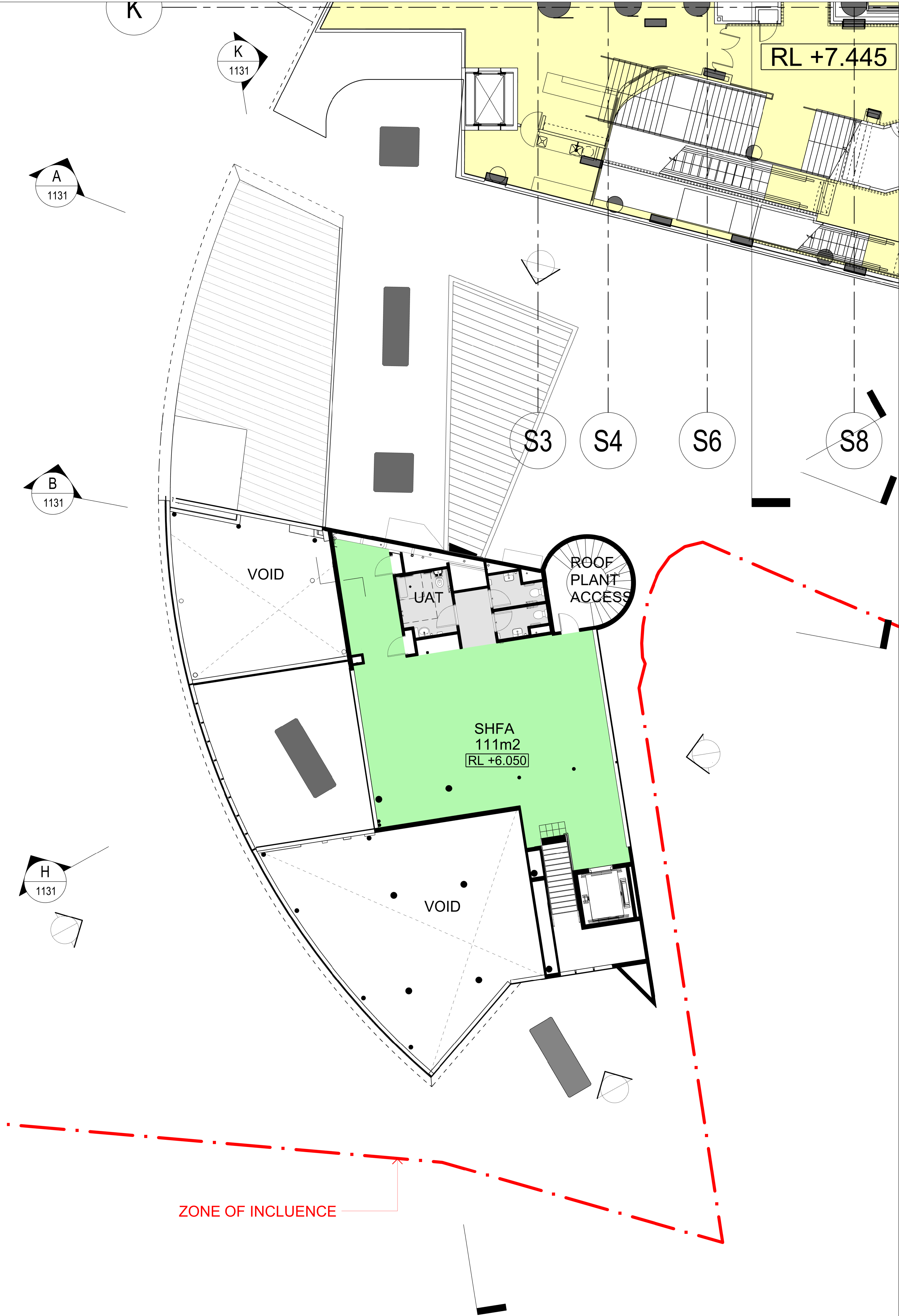

2 BUILDING 2 PODIUM L01
1:100

REFERENCE MAP

0 2 4 8m
1:100

NOTES

- DO NOT SCALE DRAWINGS. WRITTEN DIMENSIONS GOVERN.
- ALL DIMENSIONS ARE IN MILLIMETRES UNLESS NOTED OTHERWISE.
- ALL DIMENSIONS SHALL BE VERIFIED ON SITE BEFORE PROCEEDING WITH THE WORK. HASSELL SHALL BE NOTIFIED IN WRITING OF ANY DISCREPANCIES.
- THIS DRAWING MUST BE READ IN CONJUNCTION WITH ALL RELEVANT CONTRACTS, SPECIFICATIONS AND DRAWINGS.

© COPYRIGHT OF THIS DRAWING IS VESTED IN HASSELL LTD.
2017 HASSELL LTD.

THIS DRAWING IS AN UNCONTROLLED COPY, UNLESS NOTED OTHERWISE.

REV	DESCRIPTION	DATE
D	DA MODIFICATION 10 (SHFA + PORTE COCHERE)	06.09.19
C	DEVELOPMENT APPLICATION	19.02.16
B	ISSUED FOR INFORMATION	15.01.16
A	ISSUED FOR INFORMATION	13.01.16
-	ISSUED FOR INFORMATION	18.12.15

ARCHITECT

HASSELL Limited ABN 007 711
435 LEVEL 2, PIER 8/8 23
HICKSON ROAD SYDNEY NSW
2000 AUSTRALIA
SYDNEY@HASSELLSTUDIO.COM
T +61 2 9101 2000 F +61 2 9101 2100

HASSELL

CLIENT

Grocon

PROJECT

THE RIBBON HOTEL,
SERVICED APARTMENTS AND RETAIL
31 WHEAT ROAD, SYDNEY

DRAWING TITLE

BUILDING 2
GA PLANS

STATUS

FOR APPROVAL

SCALE @ B1	DRAWN	CO-ORD	REVIEWED	APPROVED
1:100	RT	MH	MH	EL

PROJECT NUMBER	DRAWING NUMBER	REV
A004409	ARC-HSL-DD-1130	D

11/22/2021 3:27:00 PM

Original Sheet Size B1-1000 x 707mm

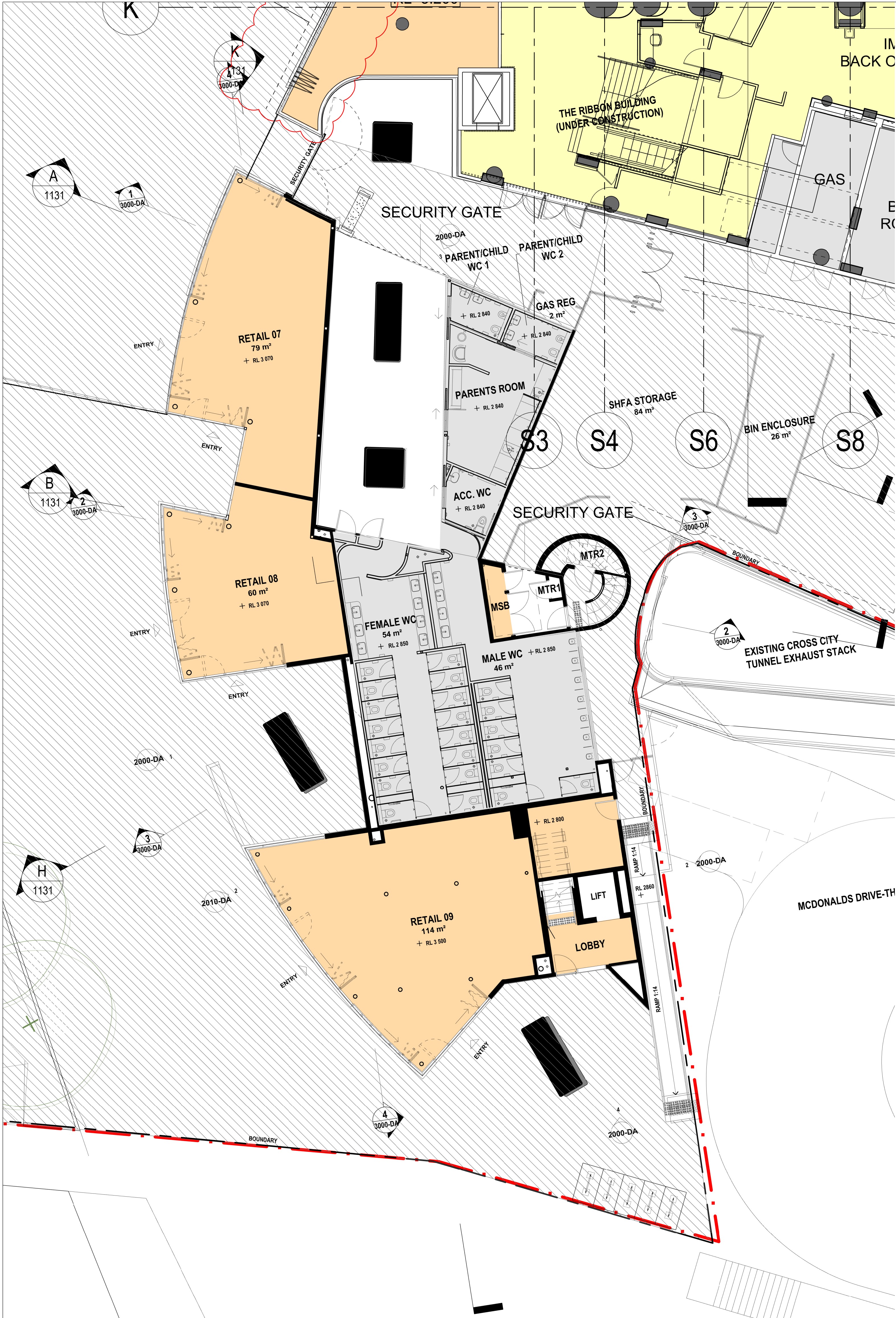

1 COMPARATIVE DIAGRAM BUILDING 2 PODIUM GF
1:100

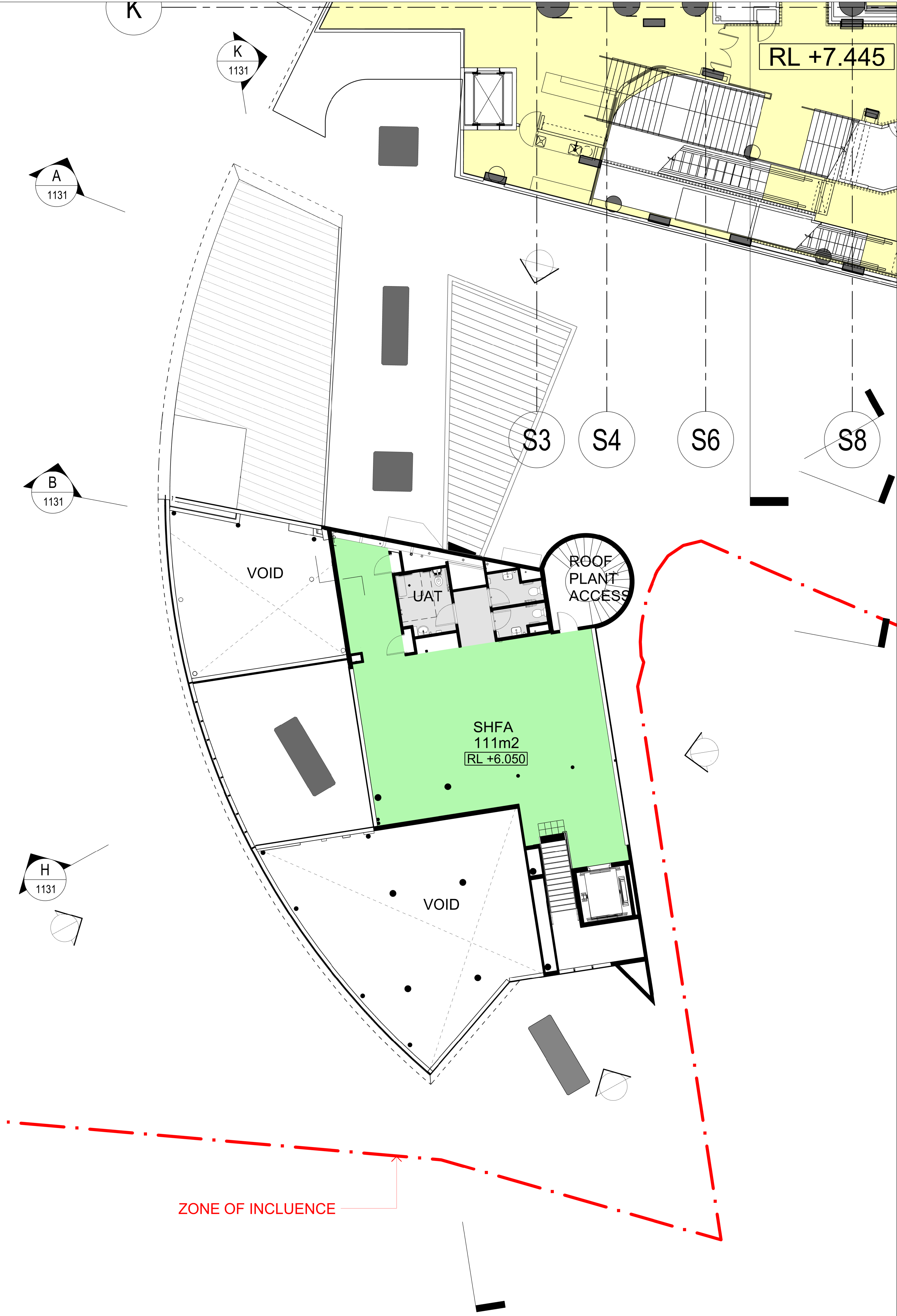

2 COMPARATIVE DIAGRAM BUILDING 2 PODIUM L01
1:100

REFERENCE MAP

NORTH

0 2 4 8m

1:100

NOTES

1. DO NOT SCALE DRAWINGS. WRITTEN DIMENSIONS GOVERN.

2. ALL DIMENSIONS ARE IN MILLIMETRES UNLESS NOTED OTHERWISE.

3. ALL DIMENSIONS SHALL BE VERIFIED ON SITE BEFORE PROCEEDING WITH THE WORK. HASSELL SHALL BE NOTIFIED IN WRITING OF ANY DISCREPANCIES.

4. THIS DRAWING MUST BE READ IN CONJUNCTION WITH ALL RELEVANT CONTRACTS, SPECIFICATIONS AND DRAWINGS.

© COPYRIGHT OF THIS DRAWING IS VESTED IN HASSELL LTD.
2017 HASSELL LTD.

THIS DRAWING IS AN UNCONTROLLED COPY, UNLESS NOTED OTHERWISE.

REV	DESCRIPTION	DATE
A	DA MODIFICATION 10	06.09.19
-	SHFA OPENING APPLICATION	11.02.16

ARCHITECT

HASSELL Limited ABN 007 711
435 LEVEL 2, PIER 8/8 23
HICKSON ROAD SYDNEY NSW
2000 AUSTRALIA
SYDNEY@HASSELLSTUDIO.COM
T +61 2 9101 2000 F +61 2 9101 2100

HASSELL

CLIENT

PROJECT

THE RIBBON HOTEL,
SERVICED APARTMENTS AND RETAIL

31 WHEAT ROAD, SYDNEY

DRAWING TITLE

BUILDING 2
GA PLANS COMPARATIVE DIAGRAM
PROPOSED/CURRENT

STATUS

FOR APPROVAL

SCALE @ B1	DRAWN	CO-ORD	REVIEWED	APPROVED
1:100	RT	MH	MH	EL

PROJECT NUMBER	DRAWING NUMBER	REV
A004409	ARC-HSL-DD-1140	A

11/22/2021 3:27:00 PM

Original Sheet Size B1-1000 x 707mm