

EXISTING WALL AND WINDOWS TO BE DEMOLISHED AND NEW WALL BUILT TO MATCH EXISTING WALL FIRE RATING AND THICKNESS

STAIR WALLS BUILT AS PART OF INFRASTRUCTURE UPGRADE WORKS

FLOOR FINISHES AND CEILINGS WITHIN SCOPE TO BE DEMOLISHED VERIFY DETAILED EXTENT ON SITE

DEMOLISH EXISTING FINS AND SILL & LINTEL; RETAIN EXISTING SLAB

STAIR WALLS BUILT AS PART OF INFRASTRUCTURE UPGRADE WORKS

DUCTS IN THIS AREA TO BE REPLACED. CEILING TO BE REMOVED AND REINSTATED. REFER MECHANICAL DRAWINGS FOR DETAILS. BUILDERS WORKS ASSOCIATED WITH THE INSTALLATION OF THE DUCTING AND WEATHERPROOFING TO MATCH EXISTING.

NOT IN SCOPE

NOT IN SCOPE

NORTH POINT				
<div><div>TRUE NORTH</div><div>THIS DOCUMENT IS THE COPYRIGHT OF HDR. ALL INFORMATION ILLUSTRATED ON THIS DOCUMENT IS TO BE CHECKED AND VERIFIED ON SITE. IN THE EVENT OF DISCREPANCIES REFER TO ARCHITECT PRIOR TO COMMENCEMENT OF THE WORK. DO NOT SCALE DRAWINGS MANUALLY OR ELECTRONICALLY.</div></div>				
REV	DESCRIPTION OF CHANGE	CHECKED BY	ISSUED BY	DATE
1	FOR 50% DD	DS	SJ	30/09/20
2	WIP 75% ISSUE	HDR	HDR	09/12/20
3	WIP 90% ISSUE	HDR	HDR	18/12/20
4	100% DD ISSUE	HDR	HDR	22/01/21

DEMOLITION NOTES AND LEGENDS

- THE DRAWINGS ARE BASED ON CLIENT ISSUED CAD, BIM FILES AND SURVEY OF THE EXISTING HOSPITAL. HDR CAN ONLY RELY ON THE INFORMATION SUPPLIED BY THE CLIENT.
- HDR HAVE NOTED THE PATH OF EXISTING FIRE RATED WALLS - THE COMPLIANCE OF THESE WALLS LIES WITH THE CLIENT.
- ALL NEW FIRE RATED WALLS TO BE COMPLIANT.
- DEMOLITION DRAWINGS TO BE READ IN CONJUNCTION WITH THE REMAINDER OF THE ARCHITECTURAL DRAWING SET.
- DEMOLITION WORKS ARE INDICATED TO THE FULL EXTENT REQUIRED FOR COMPLETION. STAGING OF DEMOLITION WILL BE REQUIRED AND IS TO BE PROPOSED BY THE CONTRACTOR IN ALIGNMENT WITH THE PROJECT PROPOSAL FOR STAGING.
- DEMOLISH EXISTING WALLS TO THE EXTENT SHOWN AND MAKE GOOD. COMPONENTS OF WALLS TO BE DEMOLISHED TO BE VERIFIED ON SITE.
- DEMOLISH FLOOR FINISHES AND CEILINGS WITHIN SCOPE AREA AND WALLS BEING DEMOLISHED - TO BE READ IN CONJUNCTION WITH GENERAL ARRANGEMENT PLAN.
- ANY DAMAGED FINISHED FLOOR, WALL, CEILINGS SURFACES REMAINING POST DEMOLITION TO BE MADE GOOD.
- ALL MECHANICAL, ELECTRICAL, HYDRAULIC, FIRE AND ANY OTHER SERVICES TO BE DECOMMISSIONED, REMOVED, DEMOLISHED, CAPPED AND/OR RELOCATED TO THE EXTENT SHOWN ON THE CONSULTANT'S DRAWINGS.
- ALL FIRE EGRESS DOORS AND FIRE WALLS TO REMAIN 'OPERATIONAL' DURING DEMOLITION.
- EXISTING SANITARY FIXTURES AND FITTINGS TO BE REMOVED, CAPPED OFF, RE-DIRECTED OR AS OTHERWISE REQUIRED TO THE EXTENT SHOWN ON THE CONSULTANT'S DRAWINGS AND SPECIFICATIONS.
- EXISTING SSD FIXTURES AND FITTINGS TO BE REMOVED. ALL ELECTRICAL PLUMBING TO BE DISCONNECTED/CAPPED OFF AND MAKE GOOD TO ACCEPT MODIFIED LAYOUT.
- REMOVE ALL FLOOR FINISHES AS NECESSARY FOR REFURBISHMENT AREAS ONLY.
- SERVICE PENETRATIONS TO EXISTING SLAB IN STAFF AMENITIES TO OCCUR IN CAVITY WALL ZONE - CHECK ON SITE EXISTING PT ZONES PRIOR TO LOCATING PENETRATIONS.
- WHERE POSSIBLE RETAIN ALL CEILINGS AND ONLY PATCH WHERE WALLS ARE REMOVED OR SERVICES ARE RELOCATED ALLOW TO RE-PART PLASTERBOARD CEILINGS IN A ROOM AFFECTED BY CHANGE.
- DEMOLITION PROCESSES TO FOLLOW SESLHDH STRICT REQUIREMENTS TO NOT AFFECT THE OPERATION OF THE HOSPITAL.
- DEMOLITION OF THE FACADE IN THE SSD ZONE TO ALSO FOLLOW SESLHDH STRICT REQUIREMENTS/PROCEDURES.
- WHERE POSSIBLE REPAIR IN LIEU OF REMOVE AND REPLACE FINISHES.
- ANY DEMOLITION OF STRUCTURAL MEMBERS IN EXISTING ROOF IS SUBJECT TO STRUCTURAL ANALYSIS, STRUCTURAL ENGINEER APPROVAL.
- TENDERER AND CLIENT TO AGREE ON SALVAGE ITEMS - NOT PART OF DEMOLITION SCOPE.
- FOR DEMOLITION OF ANY ELEMENTS OTHER THAN BUILDING, REFER CIVIL ENGINEER'S DWGS.

- NOT IN SCOPE

EXISTING WALLS

EXISTING FIRE WALLS

EXISTING WALLS TO BE DEMOLISHED

EXISTING DOORS / CASEWORKS / ROOFS TO BE DEMOLISHED

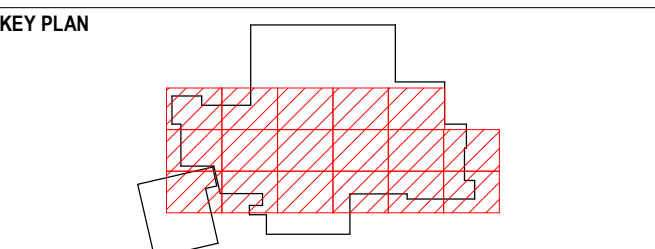

PROJECT MANAGEMENT

CBRE

LEVEL 12, 363 GEORGE STREET, SYDNEY, NSW, AUSTRALIA, 2000. 612 9333 3333. <http://www.cbre.com.au/>

CLIENT

NSW GOVERNMENT

Health Infrastructure

Level 6 77 Pacific Highway, North Sydney, NSW2060  
P: +61 2 9978 5427 | F: +61 2 8904 1377  
[www.hinfra.health.nsw.gov.au](http://www.hinfra.health.nsw.gov.au)

ARCHITECTS

HDR

Level 1, 110 Walker Street, North Sydney NSW 2060, Australia  
+61 2 9956 2686 | [hdrinc.com](http://hdrinc.com)  
HDR Pty. Limited ABN 76 158 075 220 trading as HDR

PROJECT  
THE SUTHERLAND HOSPITAL  
OPERATING THEATRE UPGRADE  
KINGSWAY & KAREENA ROAD,  
CARINGBAH NSW 2229

DRAWING TITLE  
DEMOLITION PLAN - LEVEL  
03

STATUS		
DESIGN DEVELOPMENT		
DRAWN BY	CHECKED BY	APPROVED BY
SJ	AB	DS
SCALE	DATE	
1 : 250 @ A1	22/01/21	
PROJECT NUMBER	DRAWING NUMBER	ISSUE
10192314	HDR-AR-DG-030300	4

FOR INFORMATION