



EXISTING WALLS, DOOR, WINDOW AND PART OF SLAB TO BE DEMOLISHED; AS THIS PART FORMS PART OF PROPOSED WORKS. REFER TO STRUCTURAL CONSULTANT'S DRAWINGS FOR DETAILS

CONTRACTOR TO ASSESS IF PART OF CURRENT FACADE GLAZING CAN BE RETAINED TO ACCOMODATE UC AS PART OF NEW WORKS. PREFERANCE IS TO MAINTAIN MAXIMUM PORTION OF FACADE GLAXING. FOR UC LOCATION REFER TO STRUCTURAL DRAWINGS.

PART OF EXISTING ROOF TO BE DEMOLISHED; AS THIS PART FORMS PART OF PROPOSED WORKS. REFER TO STRUCTURAL CONSULTANT'S DRAWINGS FOR DETAILS

STAIR WALLS BUILT AS PART OF INFRASTRUCTURE UPGRADE WORKS

DEMOLISH PART OF EXISTING WALL TO ACCOMODATE NEW EGRESS DOOR AS PART OF PROPOSED EGRESS STRATEGY; REFER GA PLAN - LEVEL 4

DEMOLISH EXISTING FINS AND SILL & LINTEL; RETAIN EXISTING SLAB

NEW FIRE WALL TO BE CONTRUCTED TO SEPARATE PROPOSED AND EXISTING WORKS. REFER GA PLANS - LEVELS 3 AND 4

STAIR WALLS BUILT AS PART OF INFRASTRUCTURE UPGRADE WORKS

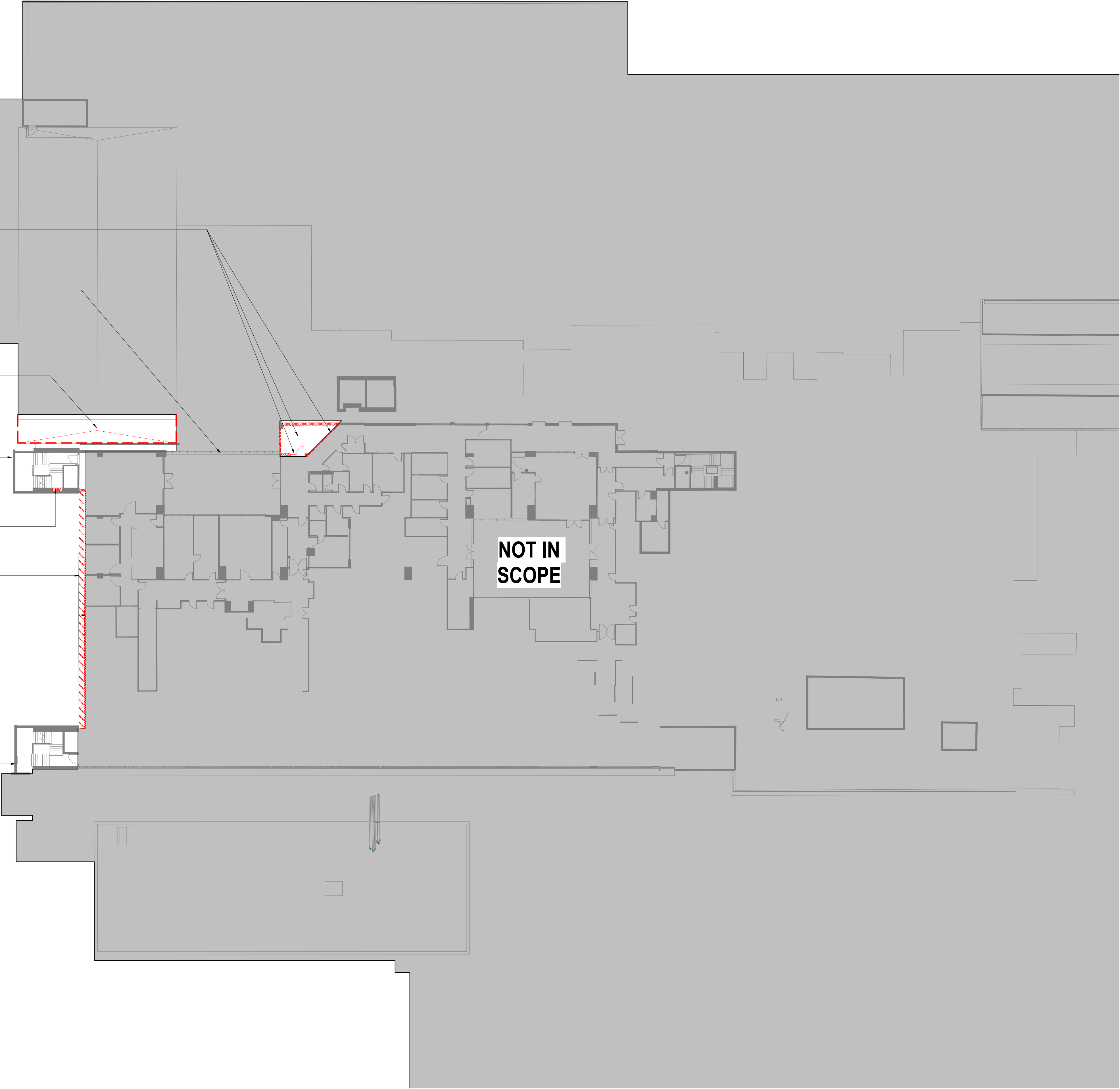
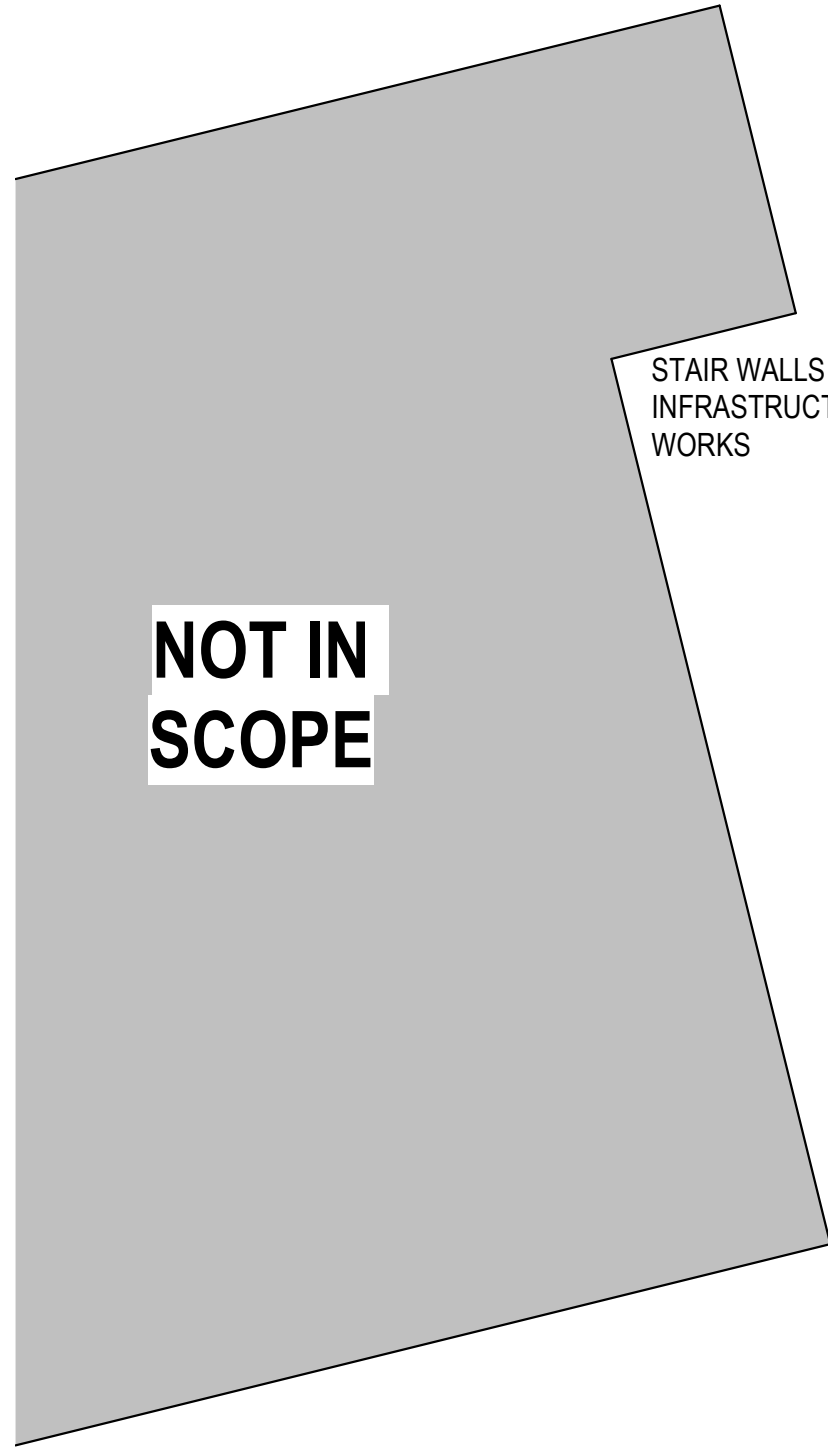

NORTH POINT

THIS DOCUMENT IS THE COPYRIGHT OF HDR.
ALL INFORMATION ILLUSTRATED ON THIS DOCUMENT IS TO BE CHECKED AND VERIFIED ON SITE. IN THE EVENT OF DISCREPANCIES REFER TO ARCHITECT PRIOR TO COMMENCEMENT OF THE WORK. DO NOT SCALE DRAWINGS MANUALLY OR ELECTRONICALLY.

| REV | DESCRIPTION OF CHANGE | CHECKED BY | ISSUED BY | DATE |
|-----|-----------------------|------------|-----------|----------|
| 1 | FOR 50% DD | DS | SJ | 30/09/20 |
| 2 | WIP 75% ISSUE | HDR | HDR | 08/12/20 |
| 3 | WIP 90% ISSUE | HDR | HDR | 18/12/20 |
| 4 | 100% DD ISSUE | HDR | HDR | 22/01/21 |

DEMOLITION NOTES AND LEGENDS

1. THE DRAWINGS ARE BASED ON CLIENT ISSUED CAD, BIM FILES AND SURVEY OF THE EXISTING HOSPITAL. HDR CAN ONLY RELY ON THE INFORMATION SUPPLIED BY THE CLIENT.

2. HDR HAVE NOTED THE PATH OF EXISTING FIRE RATED WALLS - THE COMPLIANCE OF THESE WALLS LIES WITH THE CLIENT.

3. ALL NEW FIRE RATED WALLS TO BE COMPLIANT.

4. DEMOLITION DRAWINGS TO BE READ IN CONJUNCTION WITH THE REMAINDER OF THE ARCHITECTURAL DRAWING SET.

5. DEMOLITION WORKS ARE INDICATED TO THE FULL EXTENT REQUIRED FOR COMPLETION. STAGING OF DEMOLITION WILL BE REQUIRED AND IS TO BE PROPOSED BY THE CONTRACTOR IN ALIGNMENT WITH THE PROJECT PROPOSAL FOR STAGING.

6. DEMOLISH EXISTING WALLS TO THE EXTENT SHOWN AND MAKE GOOD. COMPONENTS OF WALLS TO BE DEMOLISHED TO BE VERIFIED ON SITE.

7. DEMOLISH FLOOR FINISHES AND CEILINGS WITHIN SCOPE AREA AND WALLS BEING DEMOLISHED - TO BE READ IN CONJUNCTION WITH GENERAL ARRANGEMENT PLAN.

8. ANY DAMAGED FINISHED FLOOR, WALL, CEILINGS SURFACES REMAINING POST DEMOLITION TO BE MADE GOOD.

9. ALL MECHANICAL, ELECTRICAL, HYDRAULIC, FIRE AND ANY OTHER SERVICES TO BE DECOMMISSIONED, REMOVED, DEMOLISHED, CAPPED AND/OR RELOCATED TO THE EXTENT SHOWN ON THE CONSULTANT'S DRAWINGS.

10. ALL FIRE EGRESS DOORS AND FIRE WALLS TO REMAIN 'OPERATIONAL' DURING DEMOLITION.

11. EXISTING SANITARY FIXTURES AND FITTINGS TO BE REMOVED, CAPPED OFF, RE-DIRECTED OR AS OTHERWISE REQUIRED TO THE EXTENT SHOWN ON THE CONSULTANT'S DRAWINGS AND SPECIFICATIONS.

12. EXISTING SSD FIXTURES AND FITTINGS TO BE REMOVED, ALL ELECTRICAL PLUMBING TO BE DISCONNECTED, CAPPED OFF AND MAKE GOOD TO ACCEPT MODIFIED LAYOUT.

13. REMOVE ALL FLOOR FINISHES AS NECESSARY FOR REFURBISHMENT AREAS ONLY.

14. SERVICE PENETRATIONS TO EXISTING SLAB IN STAFF AMENITIES TO OCCUR IN CAVITY WALL ZONE - CHECK ON SITE EXISTING PT ZONES PRIOR TO LOCATING PENETRATIONS.

15. WHERE POSSIBLE RETAIN ALL CEILINGS AND ONLY PATCH WHERE WALLS ARE REMOVED OR SERVICES ARE RELOCATED ALLOW TO RE-PAINT PLASTERBOARD CEILINGS IN A ROOM AFFECTED BY CHANGE.

16. DEMOLITION PROCESSES TO FOLLOW SESLHDH STRICT REQUIREMENTS TO NOT AFFECT THE OPERATION OF THE HOSPITAL.

17. DEMOLITION OF THE FACADE IN THE SSD ZONE TO ALSO FOLLOW SESLHDH STRICT REQUIREMENTSPROCEDURES

18. WHERE POSSIBLE REPAIR IN LIEU OF REMOVE AND REPLACE FINISHES.

19. ANY DEMOLITION OF STRUCTURAL MEMBERS IN EXISTING ROOF IS SUBJECT TO STRUCTURAL ANALYSIS, STRUCTURAL ENGINEER APPROVAL.

20. TENDERER AND CLIENT TO AGREE ON SALVAGE ITEMS - NOT PART OF DEMOLITION SCOPE.

21. FOR DEMOLITION OF ANY ELEMENTS OTHER THAN BUILDING, REFER CIVIL ENGINEER'S DWGS.

NOT IN SCOPE

EXISTING WALLS

EXISTING FIRE WALLS

EXISTING WALLS TO BE DEMOLISHED

EXISTING DOORS / CASEWORKS / ROOFS TO BE DEMOLISHED

PROJECT MANAGEMENT

LEVEL 12, 363 GEORGE STREET, SYDNEY, NSW, AUSTRALIA, 2000. 612 9333 3333.
<http://www.cbre.com.au/>

CLIENT

NSW Health
GOVERNMENT Infrastructure
Level 6 77 Pacific Highway, North Sydney, NSW2060
P: +61 2 9978 5427 | F: +61 2 8904 1377
www.hinfra.health.nsw.gov.au

ARCHITECTS

Level 1, 110 Walker Street, North Sydney NSW 2060, Australia
+61 2 9956 2686 | hdrinc.com
HDR Pty. Limited ABN 76 158 075 220 trading as HDR

PROJECT

THE SUTHERLAND HOSPITAL
OPERATING THEATRE UPGRADE
KINGSWAY & KAREENA ROAD,
CARINGBAH NSW 2229

DRAWING TITLE

DEMOLITION PLAN - LEVEL
04

STATUS

DESIGN DEVELOPMENT

DRAWN BY

SJ

CHECKED BY

AB

APPROVED BY

DS

SCALE

1 : 250 @ A1

DATE

22/01/21

PROJECT NUMBER

10192314

DRAWING NUMBER

HDR-AR-DG-030400

ISSUE

4

FOR INFORMATION

21/01/2021 11:30:00 PM

0 1m 5m

A2

A3

A4

BIM 360://10192314_Sutherland_Hospital_Operating_Theatre_Upgrade_2020/TSHOTUP_INTERNAL.rvt