

existing asphalt footpath alignment

TPZ - 506 sqm - cooling tower to have no additional intrusion - refer arborist letter \*AGNSW\_AIAR\_ADD5\_v3\*" for reference.

T1118 canopy extent as per Arborist report

T1228 - New location

69 sqm encroachment to TPZ

450mm shoring pile wall

Sydney Sandstone Woodland Shrub Mix

Existing Tree

Proposed Native Tree

**MCGREGOR COXALL**  
McGregor Coxall Pty Ltd. ACN 082 334 290  
Sydney: +61 2 9977 3853  
Melbourne: +61 3 9999 1608  
sydney@mcgregorcoxall.com  
melbourne@mcgregorcoxall.com  
Web: www.mcgregorcoxall.com

**Client**  
Art Gallery NSW  
  
**Key Consultants**  
SANAA  
Architects

**Project Name**  
**AGNSW Expansion: Sydney Modern Project**  
  
**Project No.**  
458SL  
  
**Address**  
Art Gallery Rd, Sydney, NSW, 2000

**Key Plan**

**Scale**  
1: 100 @ A1  
  
**Scale Bar**  
0 1 2 3 4 5 M  
  
All dimensions are in millimetres unless otherwise noted. Do not scale from this drawing.



Issue Log	
F	Update for cooling tower
G	Updated as per heritage comments
H	Update for RFI
Rev	Revision Description

Phase	
AD	AM
AD	AD
AD	AD
By	Checked

**Sheet Title**  
**Cooling Tower Corner**  
**Sheet No.**  
LD\_DA\_00-17

Rev  
**H**



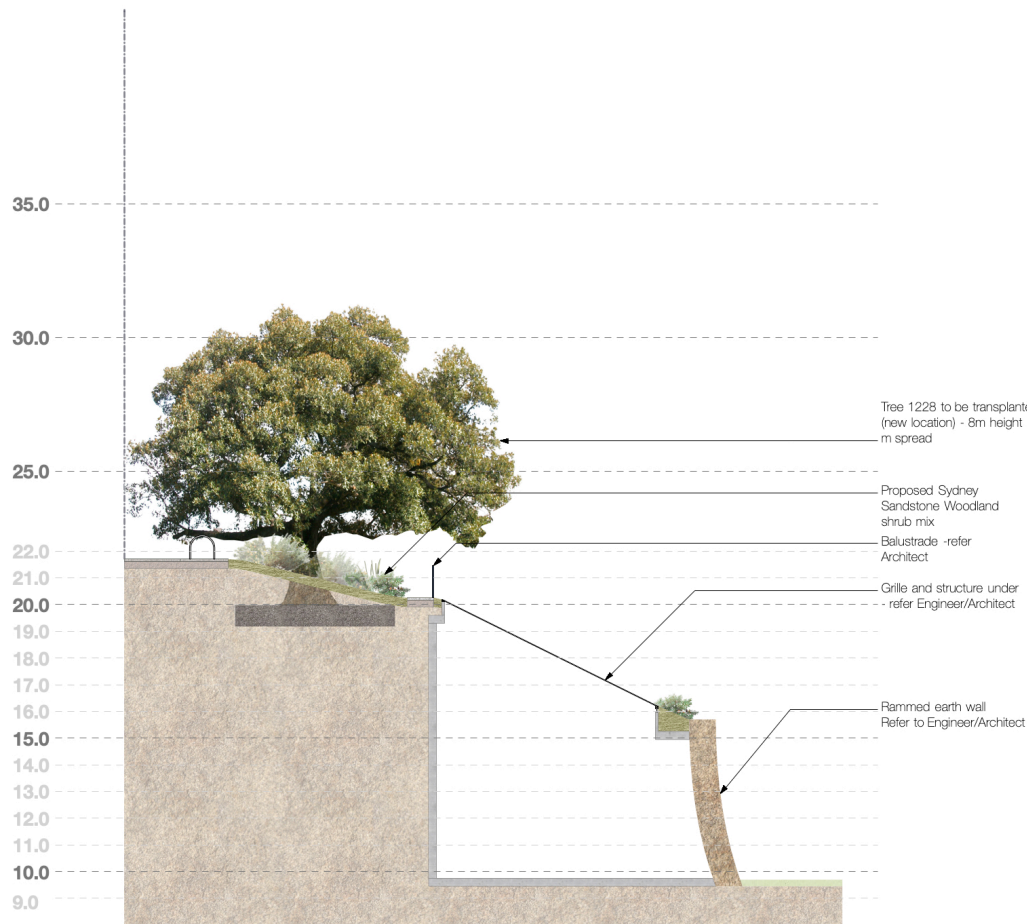

1 Section A  
Scale: 1:100

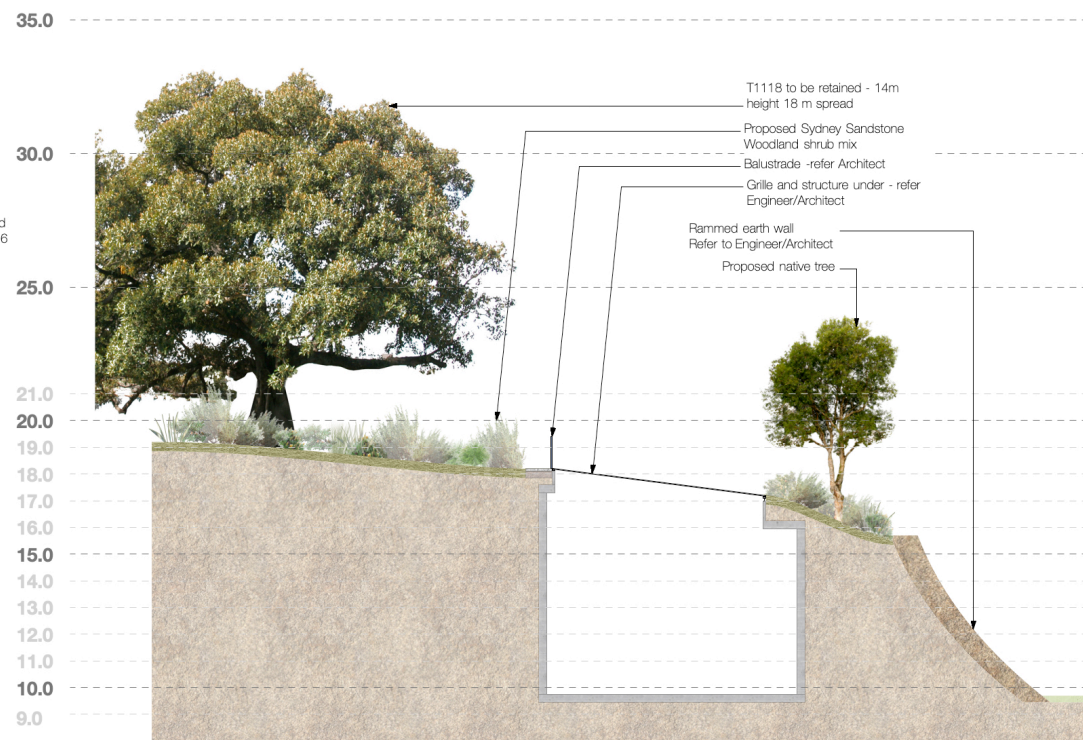

2 Section B  
Scale: 1:100

F	Update for cooling tower	AD	28/5/19
G	Update for cooling tower	AD	30/5/19
H	With levels ref	AD	19/7/19