

DARLING SQUARE PUBLIC REALM SERVICES



lendlease

DARLING SQUARE PUBLIC REALM
LIGHT SOLUTION



DESIGN STATEMENT

Seamless continuity and blending are key attributes which transcends across the different segments that make up Darling Square lighting master plan, lighting makes a statement on image and provides a visual experience.

The lighting solution is the 'conduit' that 'gels' different spaces and destinies, it unifies and complements both building structures and open spaces. At night, the lighting design depicts and accents elements, provides pedestrian wayfinding and embellishment.

The main artery to the precinct, the Boulevard, will be the point of difference by using light fitting style, colour temperature (cool) and slightly higher illuminance to that of the landscaped intimacy of the "rooms", and transition points, which converge along its length. White light will depict the Boulevard pedestrian thoroughfare with accent light from supplementary light

sources providing speckled light through the trees and "halos" of light beneath seating elements. The Boulevard lights will co-exist, match and be strategically placed to provide a seamless symmetry which runs beyond Pier Street underpass and connects with the harbour.

The journey through the precinct uses light to guide and direct attention, low level way finding lights depict paths and ramps, discreetly placed spotlights highlight trees and bushes.

The journey through the precinct uses light to A number of areas will provide a statement, including;

- The Market Square
 - The Green and the Grove
 - The Boulevard
 - Little Hay Street
 - The Veranda
 - Dickson lane
-

Secondary pathways and laneways will support the Boulevard lighting scheme providing circulation lighting and additional accent spots where needed. A warm light source would be used within the Darling Square to blend in with the Darling Harbour Live lighting scheme to unite the precinct.

A combination of light fitting types and locations will complement each space throughout the precinct, along pathways across landscaping and park areas. The lighting scheme will carry through to the canopies above so a complete night time vista is provided for.

Each level of lighting shall be programmed and sequenced for different uses, time of day and/or functions. Lighting will make a statement and be used to complement and identify. Lights will operate to suit the time of day or functional need of the space.

As part of the lighting principals, feeling safe and making the precinct inviting are the prerequisites for the lighting vision; this would be achieved by using best available technology with style, ingenuity and light placement.

A strong directional flow shall be provided by utilising illuminated way finding, visual markers and entry statements. Each light source will supplement and complement each other from the ground up, from in-ground uplights for trees, step lights, art lighting and landscape lighting, from post top lights, all will co-exist and work together. The end result is called "ambiance", a balanced lighting scheme using different light sources.

DARLING SQUARE PUBLIC REALM LIGHT SOLUTION

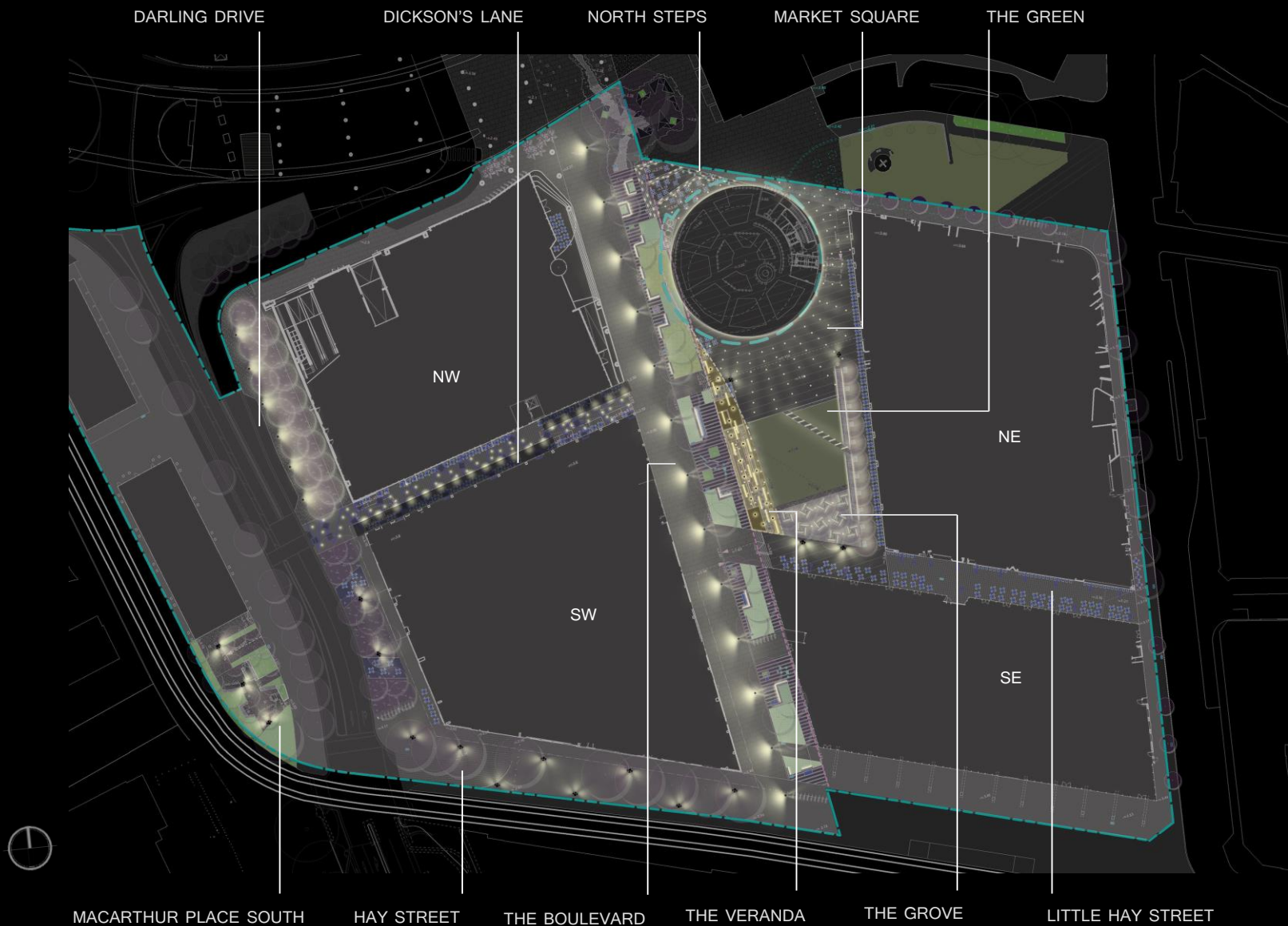

P2	3.50 lux avg, 0.70 min
P4	0.85 lux avg, 0.14 min
P7	14.0 lux avg, 4.00 min
P8	7.00 lux avg, 2.00 min

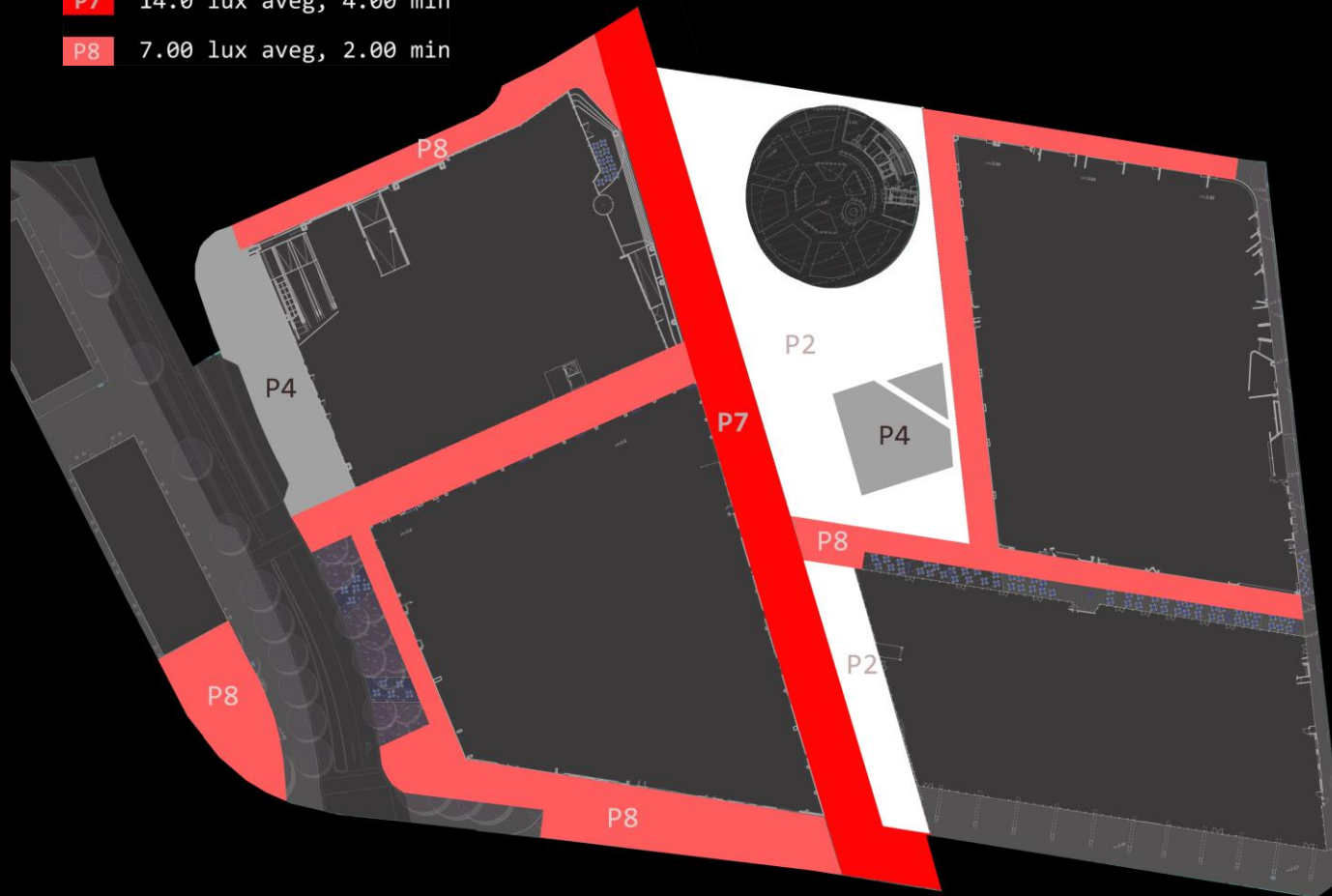



DARLING SQUARE PUBLIC REALM
LIGHT SOLUTION

MACARTHUR PLACE_SOUTH

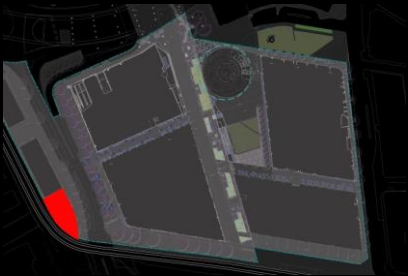

DARLING SQUARE PUBLIC REALM LIGHT SOLUTION

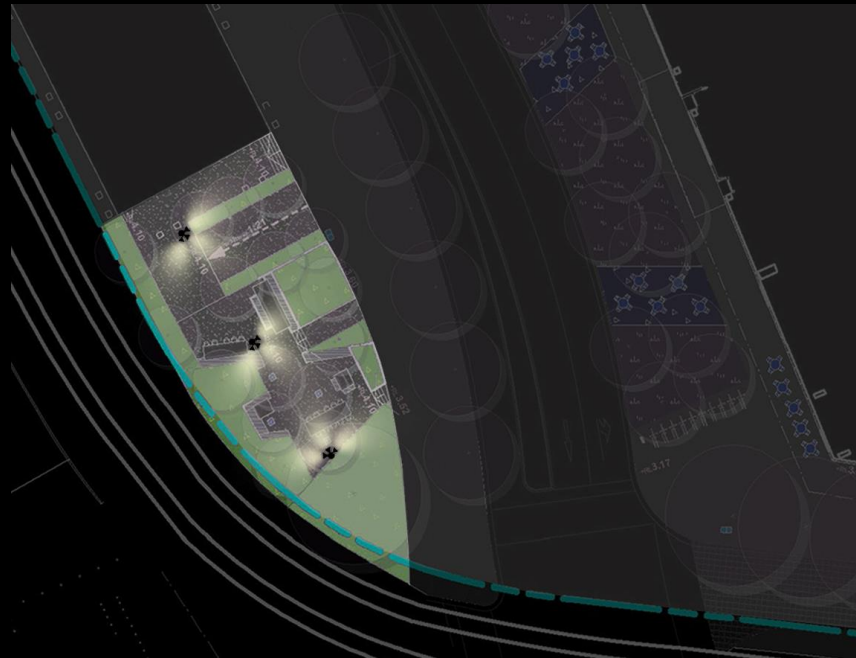

MACARTHUR PLACE_SOUTH

Multihead post top luminaires provide functional lighting levels.

Concealed under bench LED strip complements and provides accent lighting to the space.

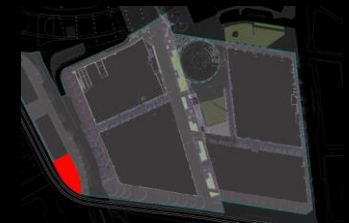



DARLING SQUARE PUBLIC REALM
LIGHT SOLUTION

DARLING DRIVE

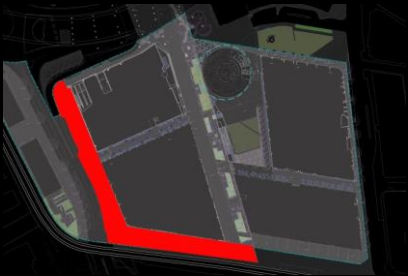

DARLING SQUARE PUBLIC REALM LIGHT SOLUTION

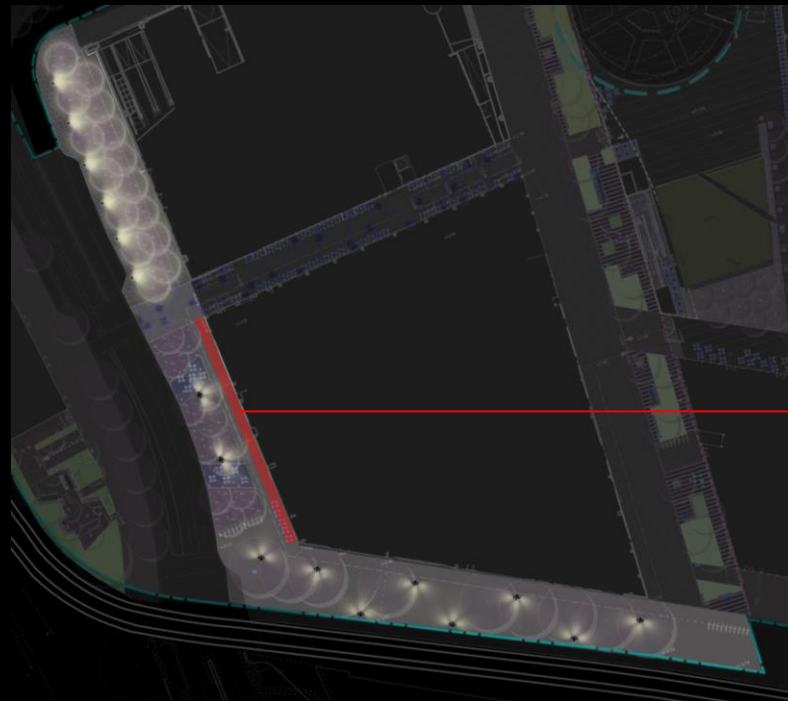

DARLING DRIVE

Multihead post top luminaires provide functional lighting levels to the south east circulation area.

Uplights to trees illuminate the north circulation area.

Under awing lights.

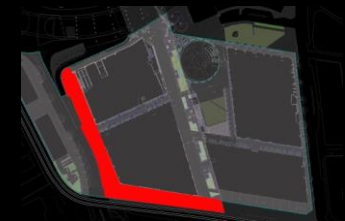



DARLING SQUARE PUBLIC REALM
LIGHT SOLUTION

DICKSON'S LANE

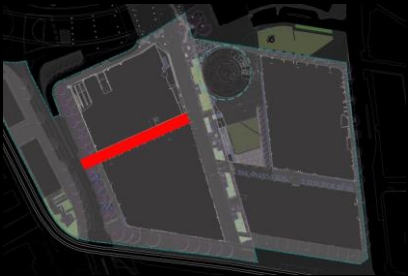

DARLING SQUARE PUBLIC REALM LIGHT SOLUTION

DICKSON'S LANE

A catenary lighting system provides general illumination and accent to the space.

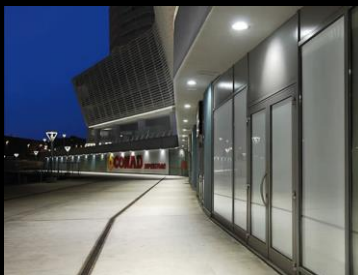
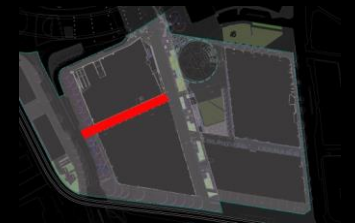
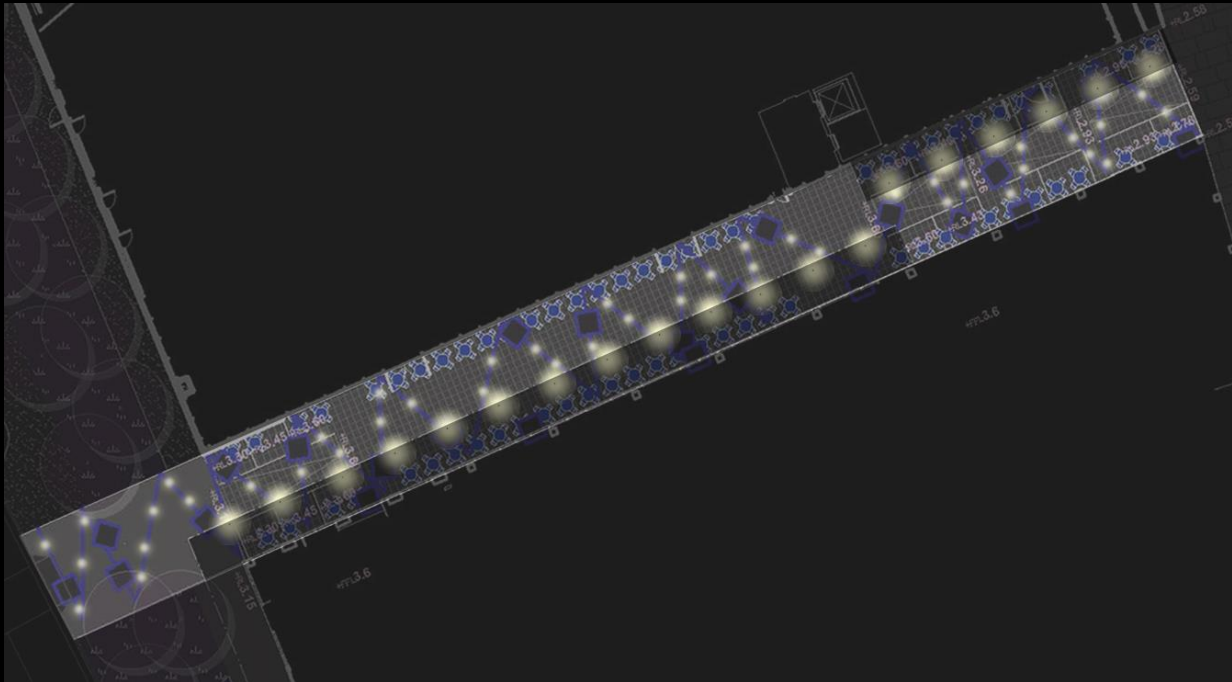

DARLING SQUARE PUBLIC REALM LIGHT SOLUTION

DICKSON'S LANE

Luminaires located on the awnings provide the required level of lighting for pedestrian safe movement, as needed for the public realm requirements.

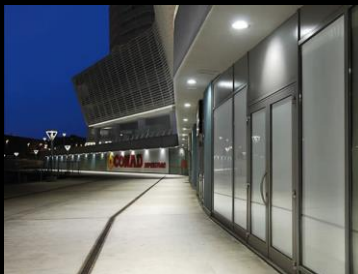
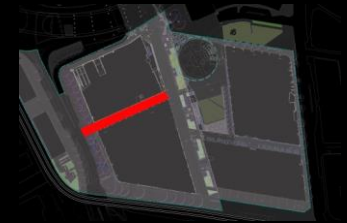
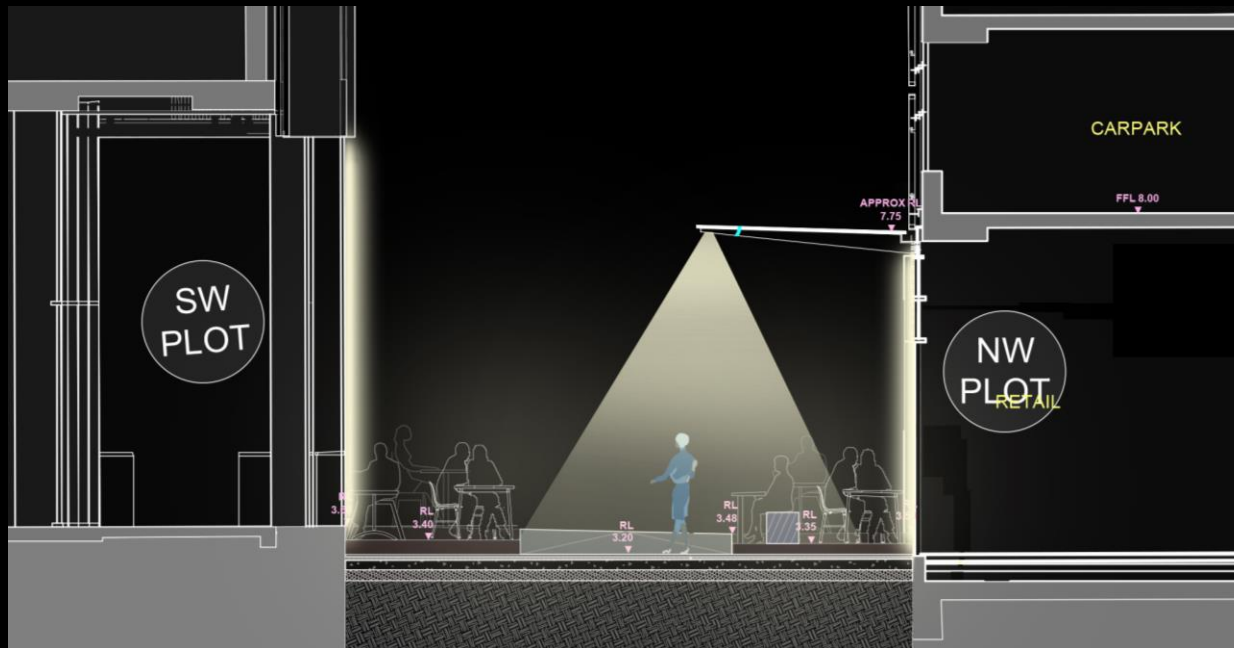

DARLING SQUARE PUBLIC REALM LIGHT SOLUTION

DICKSON'S LANE

Luminaires located on the awnings provide the required level of lighting for pedestrian safe movement, as needed for the public realm requirements.

A catenary lighting system provides accent to the space and illuminates the art piece above.

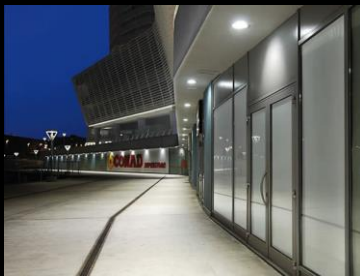
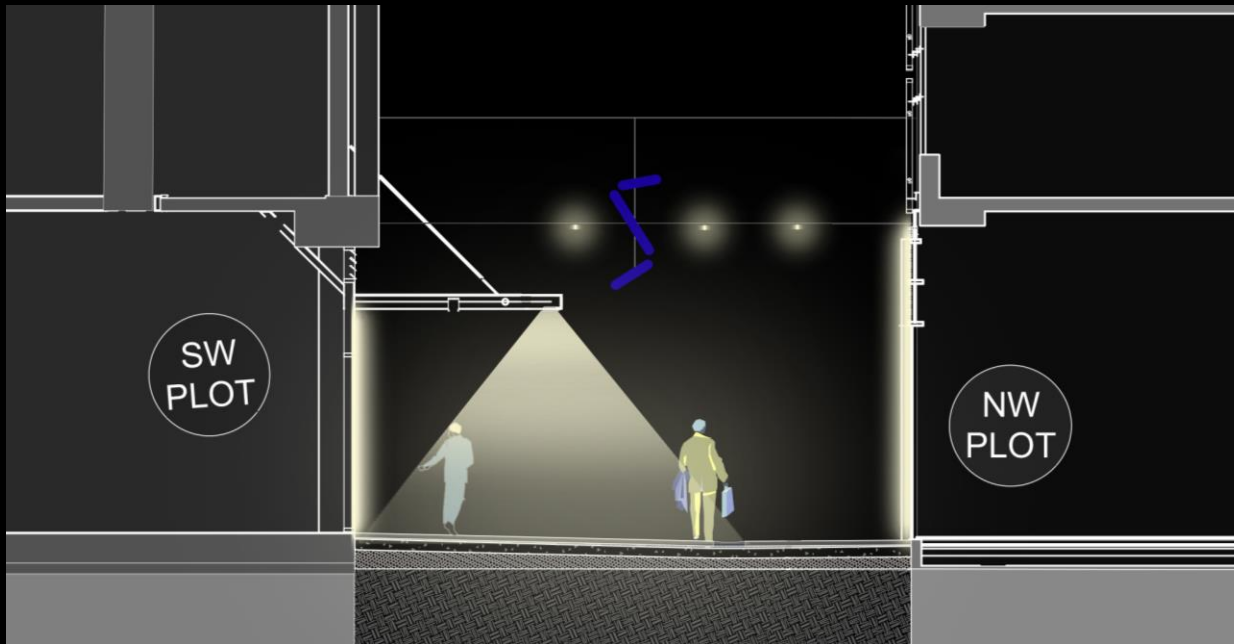
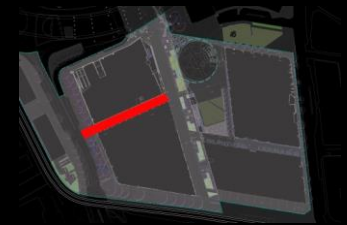



DARLING SQUARE PUBLIC REALM
LIGHT SOLUTION

THE BOULEVARD

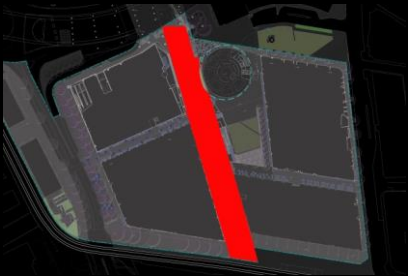

DARLING SQUARE PUBLIC REALM LIGHT SOLUTION

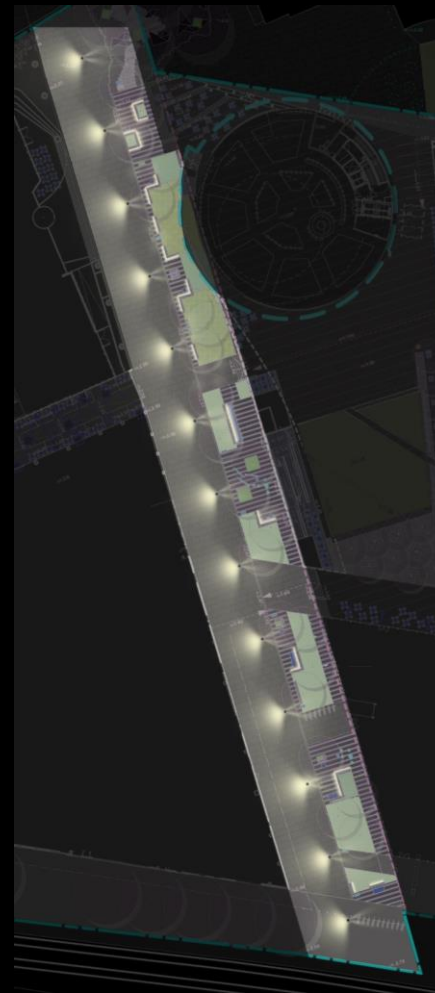
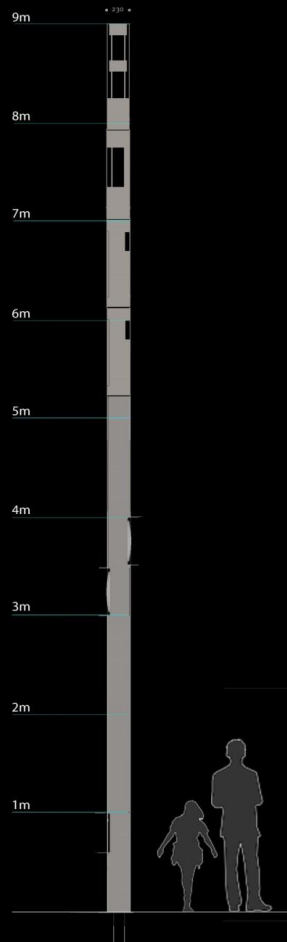

THE BOULEVARD

The Boulevard will be the main artery and thoroughfare across the public realm linking the Darling Harbour basin and the Haymarket Darling Square precinct.

The light pole shall consist of two light sources positioned within the pole structure; one light source facing the main pedestrian thoroughfare, which will provides a uniform light across the pavement, on the reverse side of the pole shall consist of 2 accent spot lights which will accent the landscape area.

Low level discreetly located strip or point source lights shall be located below seats and specific landscape items to provide a halo effect at ground level.

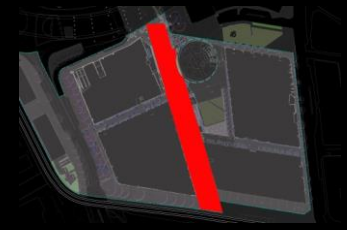

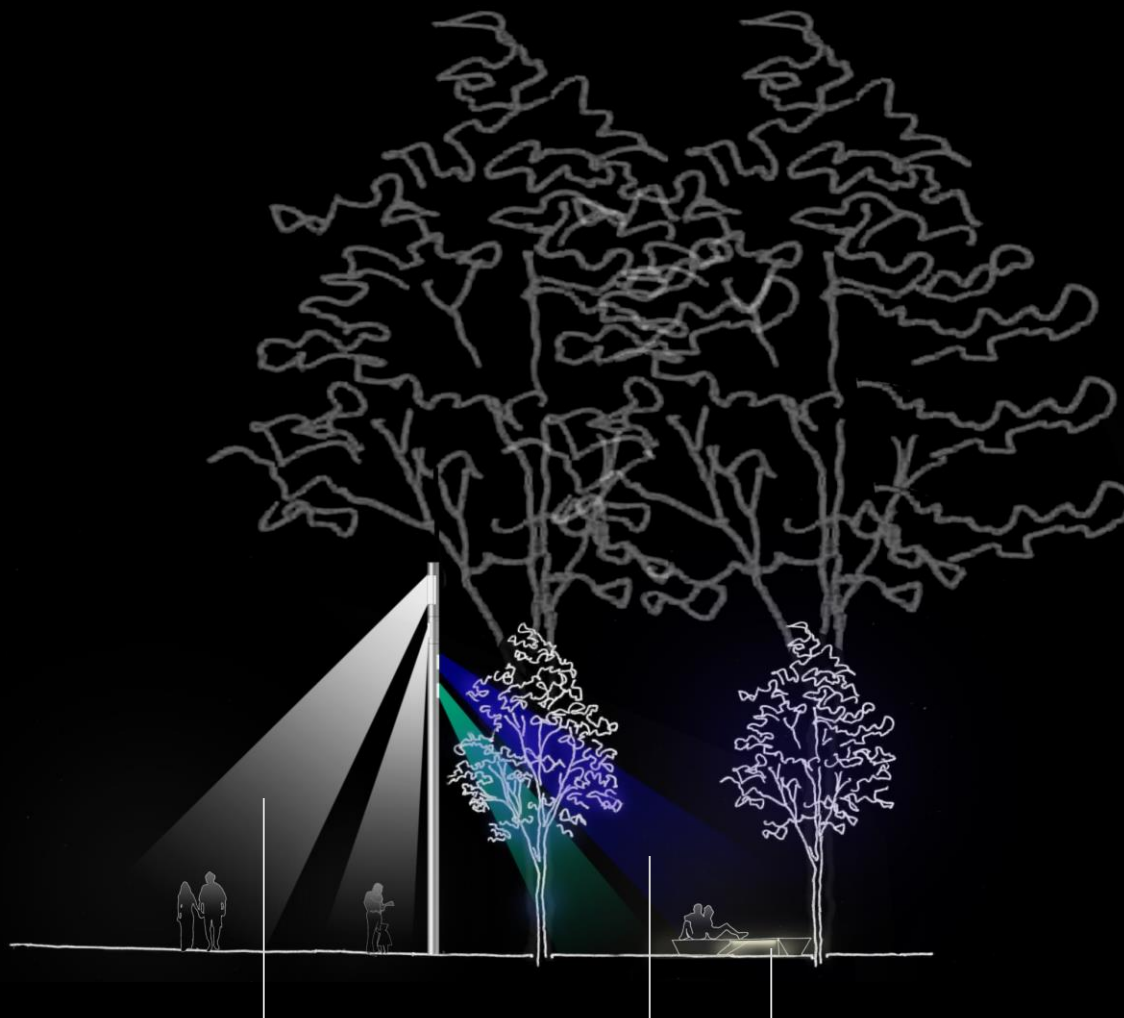

A combined light source provides uniform illumination to the main pedestrian section of The Boulevard

Multi head accent lights filter through trees creating a more intimate experience. RGB colour change allows for dynamic ambient lighting.

Low level lighting to the underside of benches provides uniform glow through LED strip

THE BOULEVARD

The Boulevard will be the main artery and thoroughfare across the public realm linking the Darling Harbour basin and the Haymarket Darling Square precinct.

The light pole shall consist of two light sources positioned within the pole structure; one light source facing the main pedestrian thoroughfare, which will provide a uniform light across the pavement, on the reverse side of the pole shall consist of 2 accent spot lights which will accent the landscape area.

Low level discreetly located strip or point source lights shall be located below seats and specific landscape items to provide a halo effect at ground level.

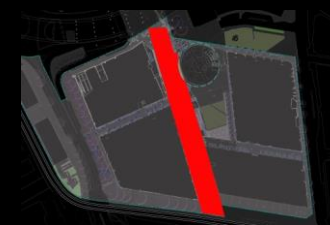



DARLING SQUARE PUBLIC REALM LIGHT SOLUTION

THE NORTH STEPS

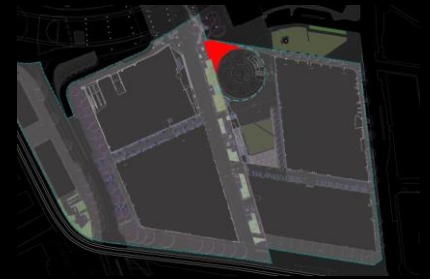

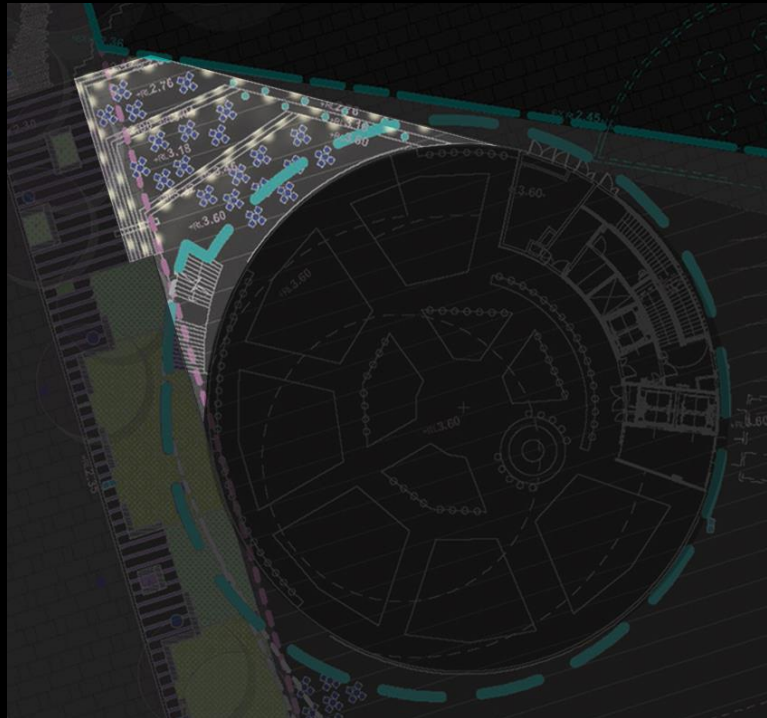

THE NORTH STEPS

The northern steps will be illuminated so that the steps are defined for safety by way of step lights. General circulation lights will be provided by post/sentinel type light fittings.

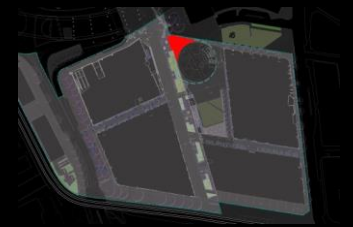



DARLING SQUARE PUBLIC REALM
LIGHT SOLUTION

THE DARLING EXCHANGE

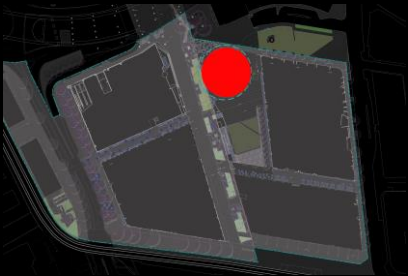

DARLING SQUARE PUBLIC REALM LIGHT SOLUTION

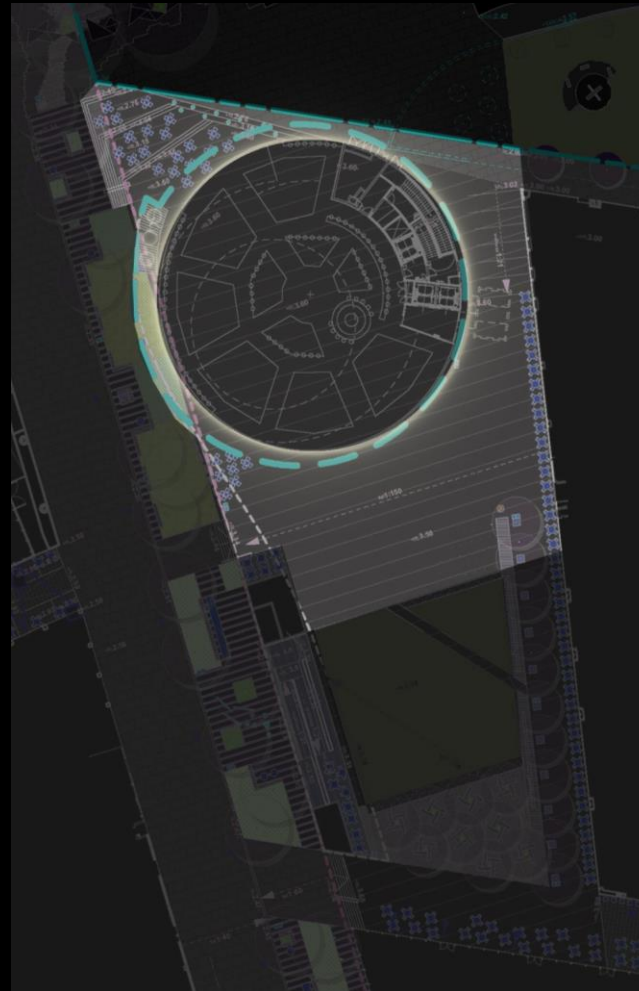
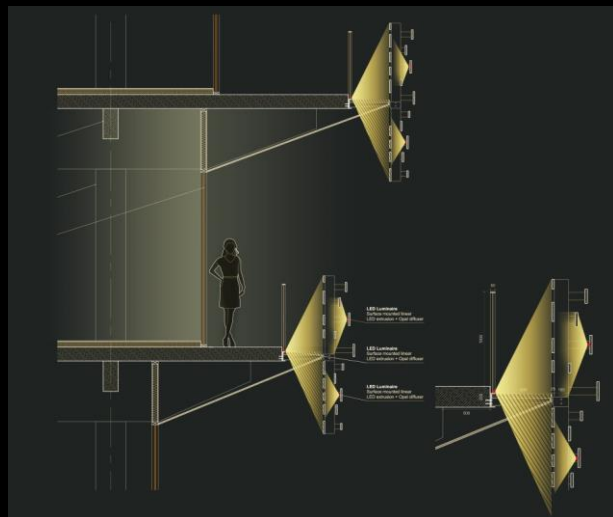
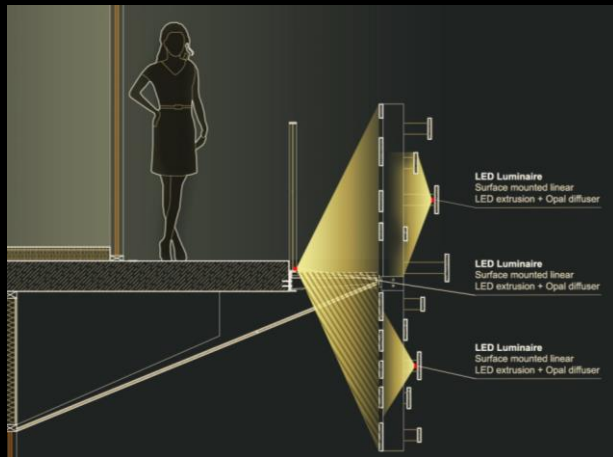

THE DARLING EXCHANGE

Continuous LED concealed strip shall be located at each level to provide illumination through the radial timber slats giving a light and shade affect to the timber. Warm colour temperature 2700K. The LED will be placed discreetly so that the light source is hidden and will emphasise the texture and the circulating shape through its entirety, from the roof to the ground level and on into the canopy. The 'external banding' light would operate from dusk and turn off to suit curfew requirements.

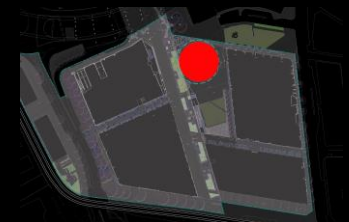





DARLING SQUARE PUBLIC REALM
LIGHT SOLUTION

VERANDA

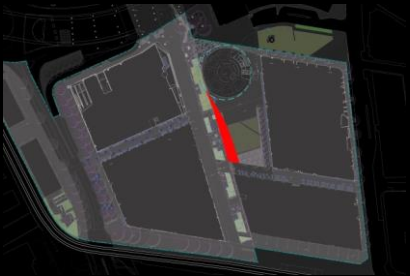

DARLING SQUARE PUBLIC REALM LIGHT SOLUTION

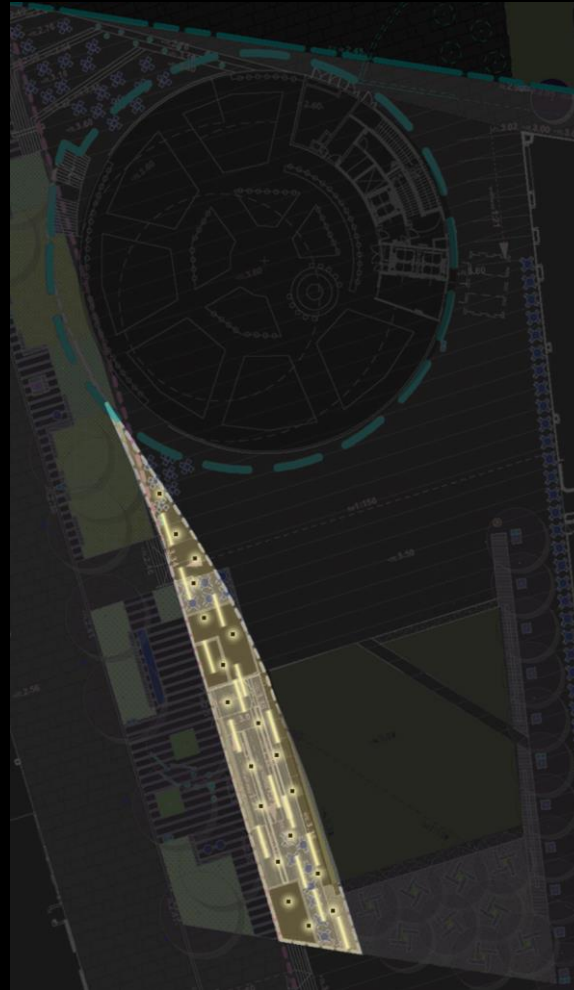
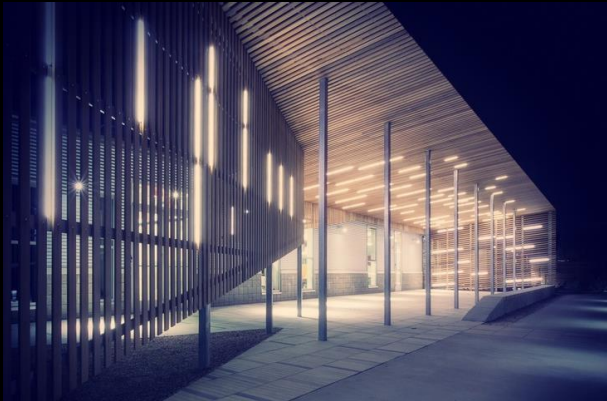

VERANDA

The covered Veranda shall be heavily populated with climbing and trailing plants. The plants, and 'weaving' canopy roof, shall be high-lighted by 'accent' lighting. Flood lights and spot lights discreetly place within and on the structure will provide illumination for public activation below, embellishment to the floribunda above and light spill into the square and green opposite.

Lower located lights below the canopy will accent and provide fit-out lighting requirements. Floor mounted lights will provide the link to the adjacent areas.

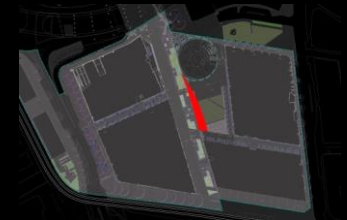



DARLING SQUARE PUBLIC REALM
LIGHT SOLUTION

MARKET SQUARE

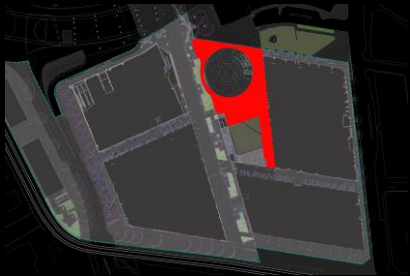

DARLING SQUARE PUBLIC REALM LIGHT SOLUTION

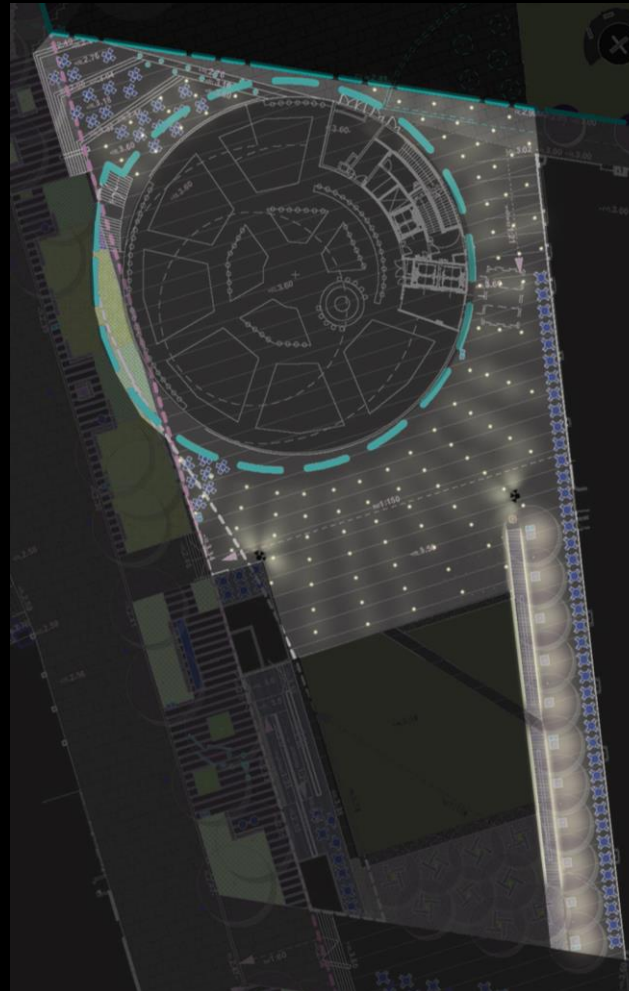

MARKET SQUARE

The Market Square will be a clear open space devoid of clutter, illumination for the space will be via in-ground flush luminaires containing LED's.

Activated lights will be utilised within a water feature which will 'glow' and provide another level of illuminance. Lights from the adjacent veranda feature roof will impact the space by 'feathering' into the square.

Low level lights will act as 'way finders'.

Multihead Post top lights will complement the space.

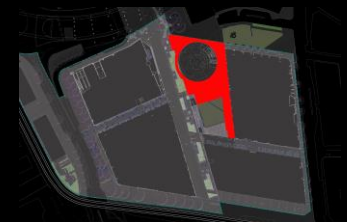

DARLING SQUARE PUBLIC REALM LIGHT SOLUTION

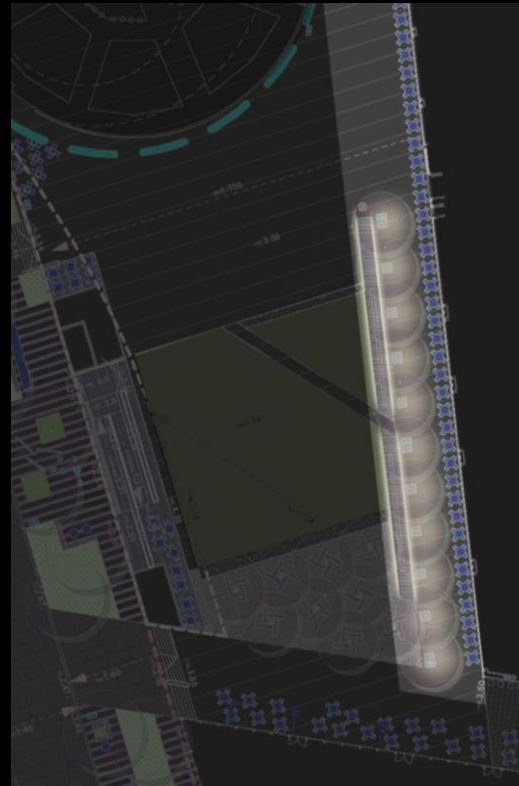

MARKET SQUARE

Lights located fixed to the building and under awnings will provide the first level of lighting for pedestrian safe movement. The fixed building lighting will be supported by the next layer of lights along the tree-line, the ground mounted lights will depict the pedestrian thoroughfare.

Under seat lights will provide definition to the laneway and the green beyond.

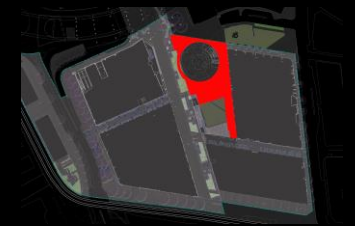



DARLING SQUARE PUBLIC REALM
LIGHT SOLUTION

THE GREEN

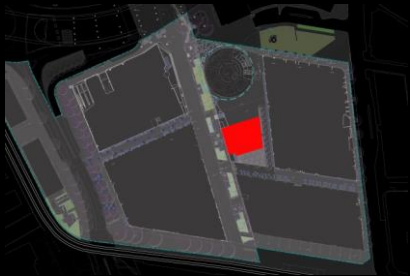

DARLING SQUARE PUBLIC REALM LIGHT SOLUTION

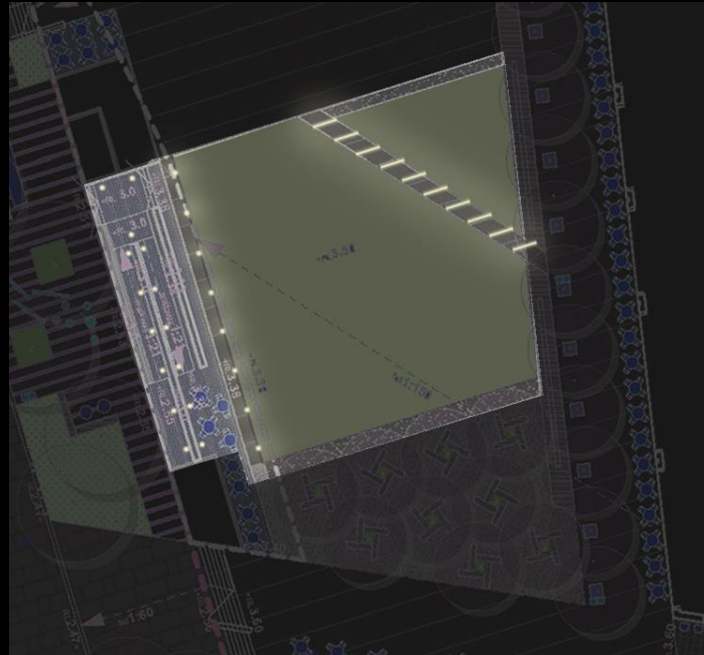

THE GREEN

The green lighting will be minimalistic with low level lighting indicated for the pathway. Lights from the adjacent veranda feature roof will impact the space by 'feathering' into the square.

The Green is a place to dwell, placed between the Veranda canopy and Trinity Lane which will provide peripheral lighting.

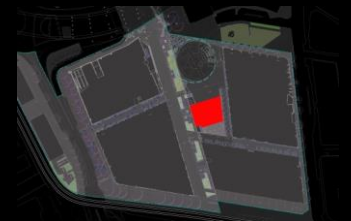



DARLING SQUARE PUBLIC REALM
LIGHT SOLUTION

THE GROVE

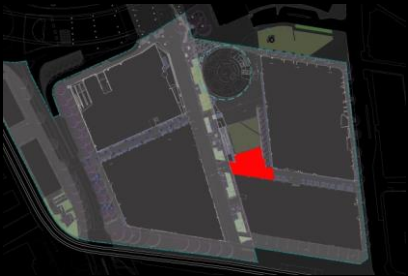

DARLING SQUARE PUBLIC REALM LIGHT SOLUTION

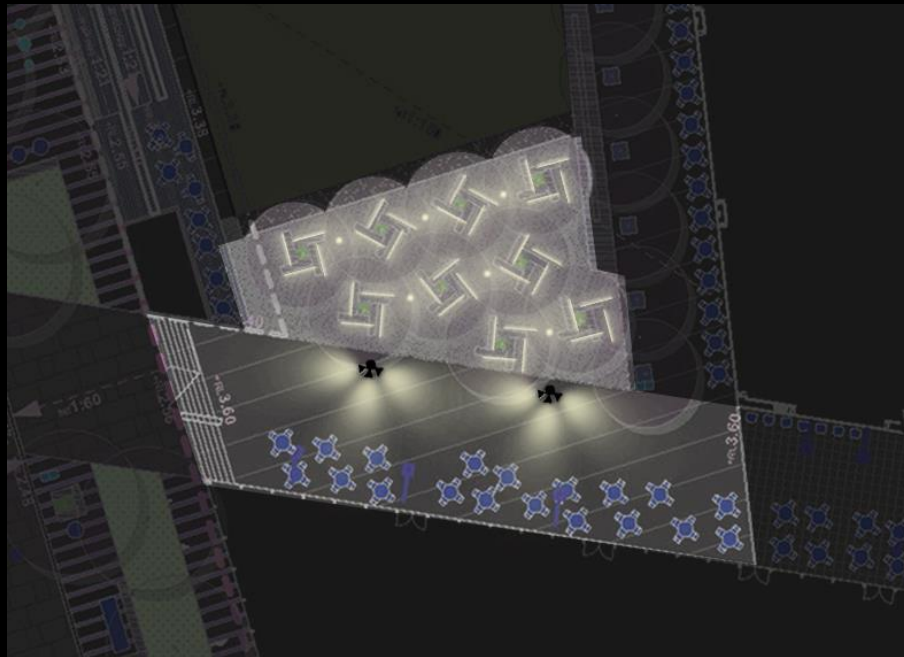

THE GROVE

The Grove is the 'crescendo' at the end of Darling Square or the entry statement on approach from Little Hay Street.

The trees within the Grove will be celebrated by way of up-lighting giving verticality and presence.

Low level discreetly located strip or point source lights shall be located below seats and specific landscape items to provide a halo effect at ground level.

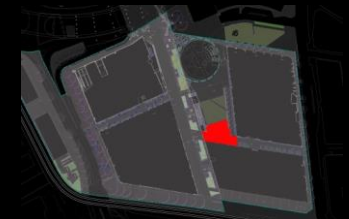

MACARTHUR PLACE

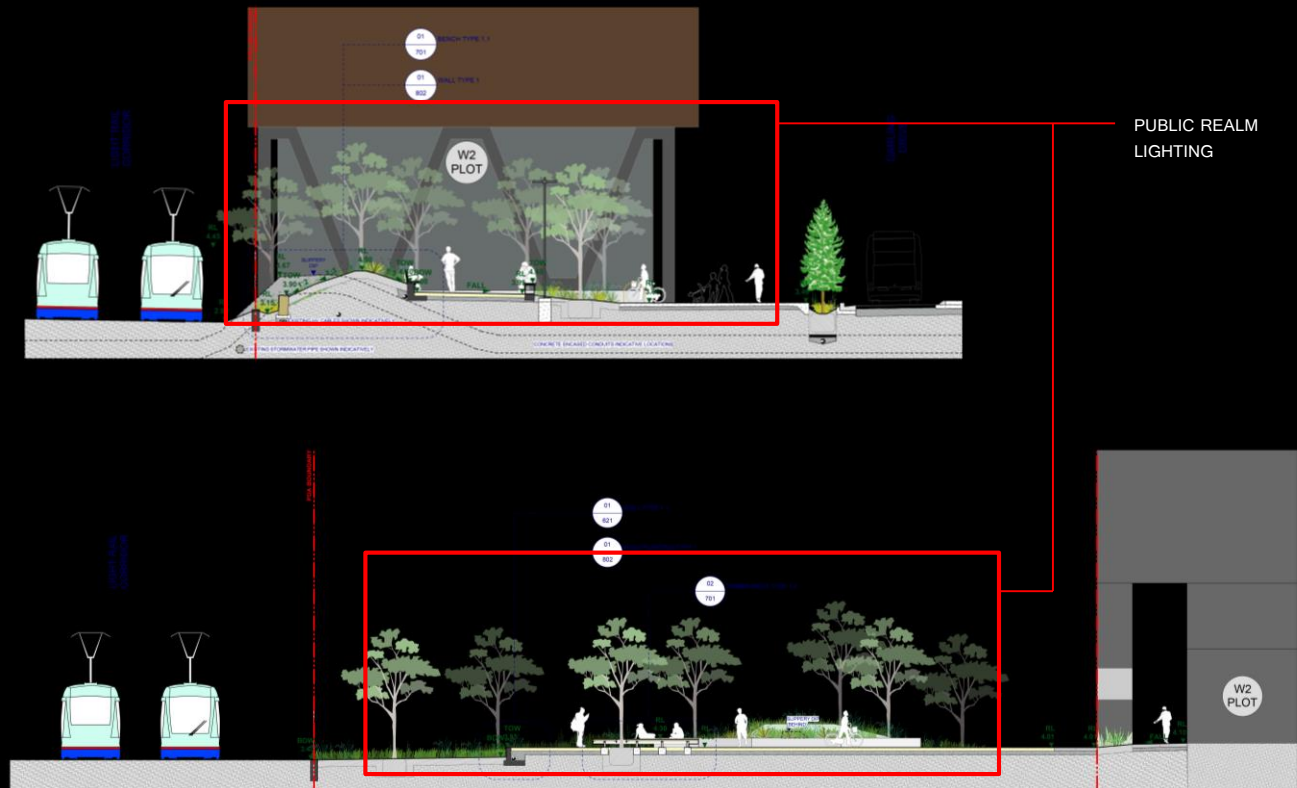

HAY STREET



BOULEVARD POST LIGHT DOCUMENTED
BY M.S. (PUBLIC LIGHTING)

EXTERNAL LIGHTING BY N
PLOT LIGHTING CONSULTANT

LIGHTS UNDER
AWNING TO BE
PROVIDED BY NE PLOT
LIGHTING/ELECTRICAL
CONSULTANT.
OPERATE DUSK-TIL-
DAWN. TO PROVIDE
PEDESTRIAN SAFE
MOVEMENT &
EXTERNAL BUILDING
LIGHTING MINIMUM P8
(AS1158)



BOULEVARD POST LIGHT DOCUMENTED
BY M.S. (PUBLIC LIGHTING)

PUBLIC REALM LIGHTING
DOCUMENTED BY M.S.

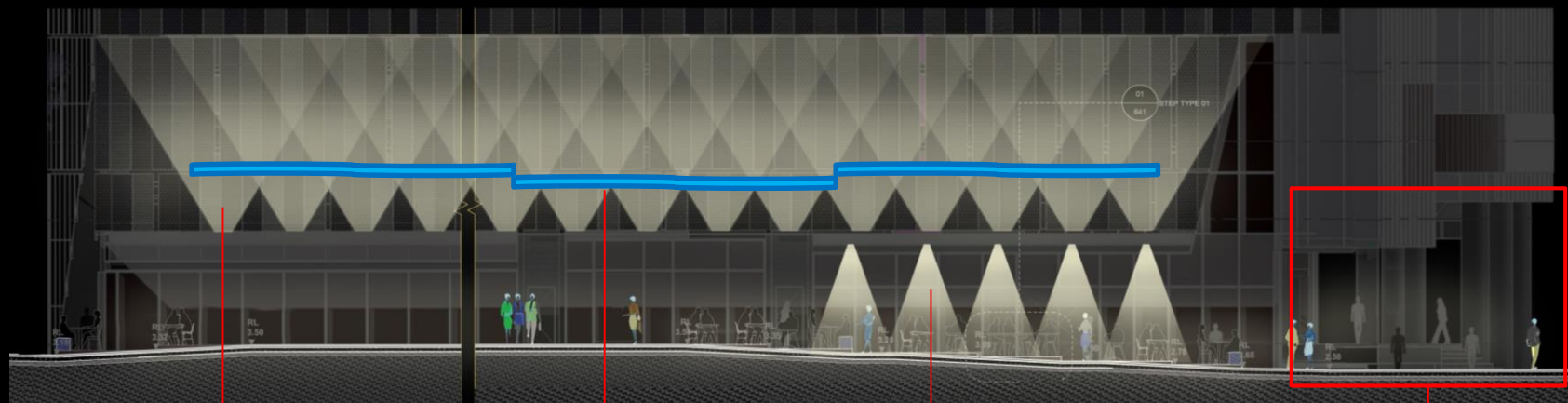

CARPARK STREET LIGHTING
DOCUMENTED BY M.S.

ART (LIGHT)
DOCUMENTED BY ARTIST

NW PLOT UNDER AWNING
LIGHTING DOCUMENTED BY M.S.

NW PLOT EXTERNAL LIGHTING
DOCUMENTED BY M.S.

DICKSON'S LANE

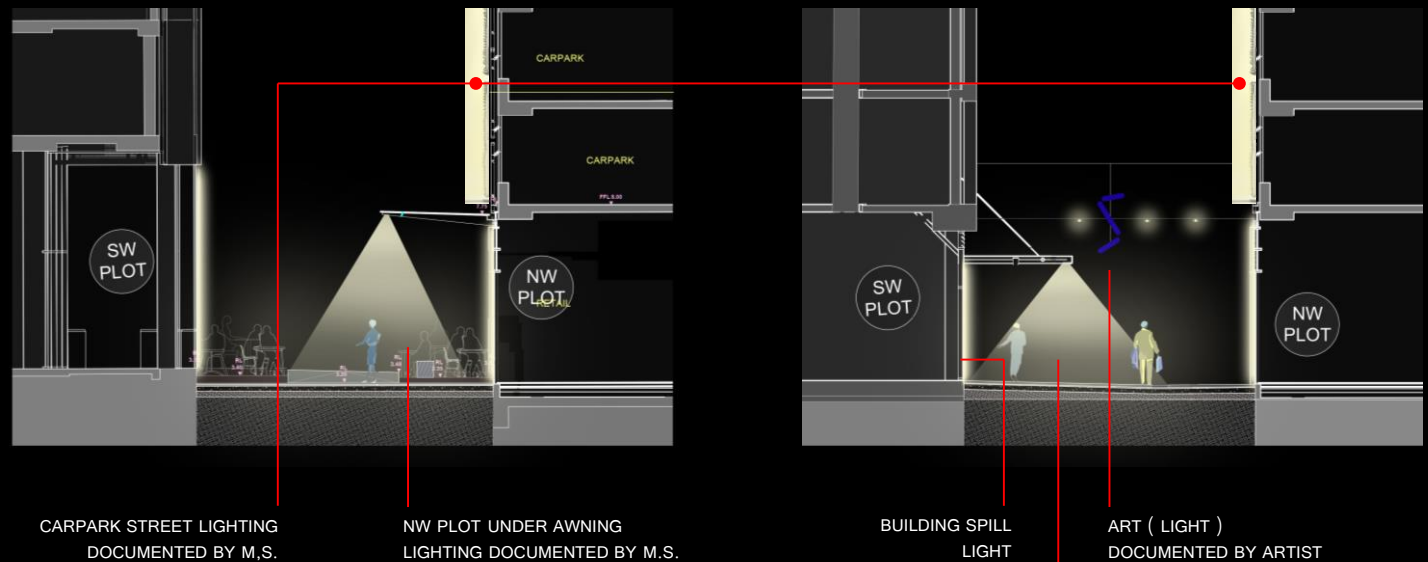

NOTE 1. POSSIBLE SUPPLEMENTARY RETAIL LIGHTING SUCH AS WALL LIGHTS, TO BE BRIEFED & CONTROLLED BY LL RETAIL

LIGHTS UNDER AWNING TO PROVIDE PEDESTRIAN SAFE MOVEMENT LIGHTING & EXTERNAL BUILDING LIGHTING FROM DUSK-TIL-DAWN. LIGHT FITTINGS TO BE NOMINATED BY SW PLOT LIGHTING/ELECTRICAL CONSULTANT TO PROVIDE MINIMUM P8 RATING (AS1158)

THE BOULEVARD SOUTH

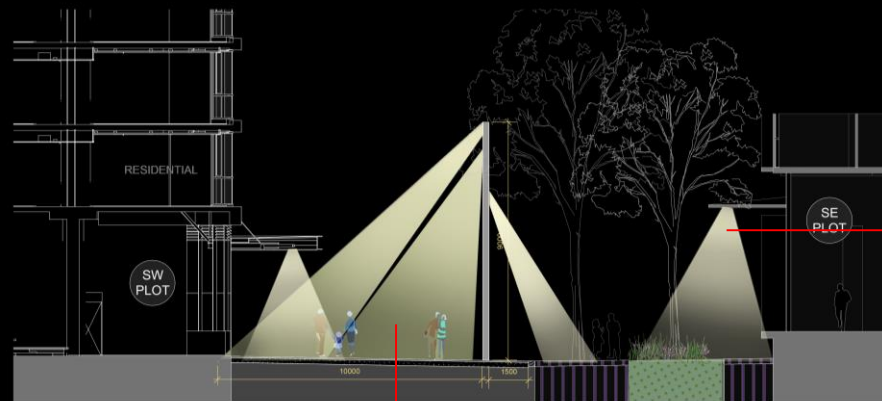

PUBLIC REALM LIGHTING

LIGHTS UNDER AWNING TO PROVIDE PEDESTRIAN SAFE MOVEMENT LIGHTING & EXTERNAL BUILDING LIGHTING FROM DUSK-TIL-DAWN. LIGHT FITTINGS TO BE NOMINATED BY SE PLOT LIGHTING/ELECTRICAL CONSULTANT TO PROVIDE MINIMUM P8 RATING (AS1158)



PUBLIC REALM LIGHTING

NOTE: LIGHTS ON AWNINGS TO BE SELECTED & ARRANGED TO SUIT THE AWNING. RECESSED FITTINGS IN SOLID AWNING WITH A SOFFIT SURFACE MTD WHERE THERE IS NO SOFFIT. POSSIBLE LINEAR LED LIGHTS WHERE GLASS EXISTS. CANVAS & RETRACTABLE AWNINGS WOULD REQUIRE SEPARATELY LOCATED LIGHTS SUCH AS WALL BRACKETS.

HAY STREET

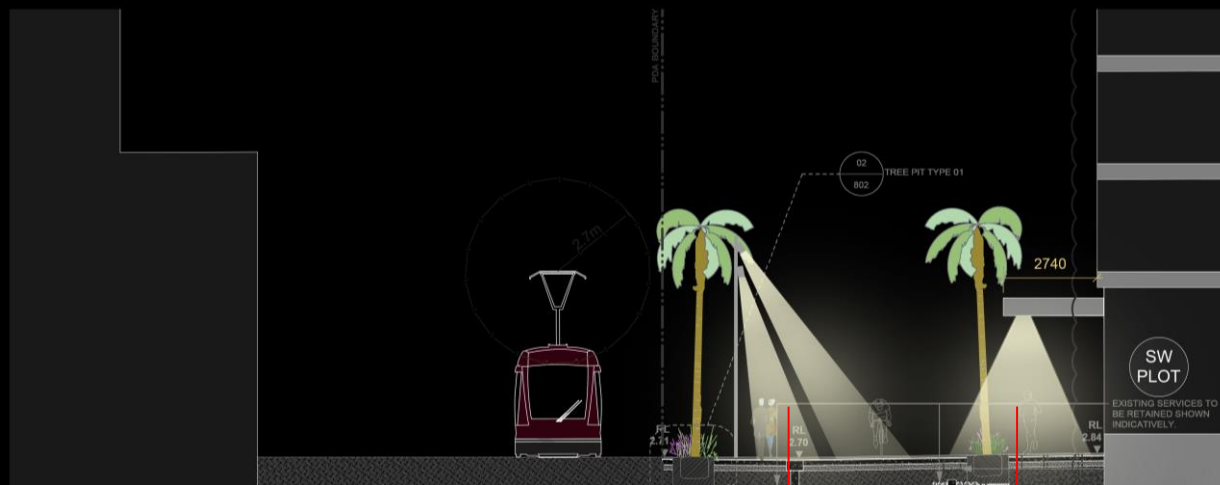

POST LIGHTS PART OF PUBLIC
REALM LIGHTING PACKAGE

LIGHTS UNDER AWNING TO PROVIDE
PEDESTRIAN SAFE MOVEMENT LIGHTING
& EXTERNAL BUILDING LIGHTING FROM
DUSK-TIL-DAWN. LIGHT FITTINGS TO BE
NOMINATED BY SW PLOT
LIGHTING/ELECTRICAL CONSULTANT TO
PROVIDE MINIMUM P8 RATING (AS1158)
3000K LAMP

DARLIN DRIVE

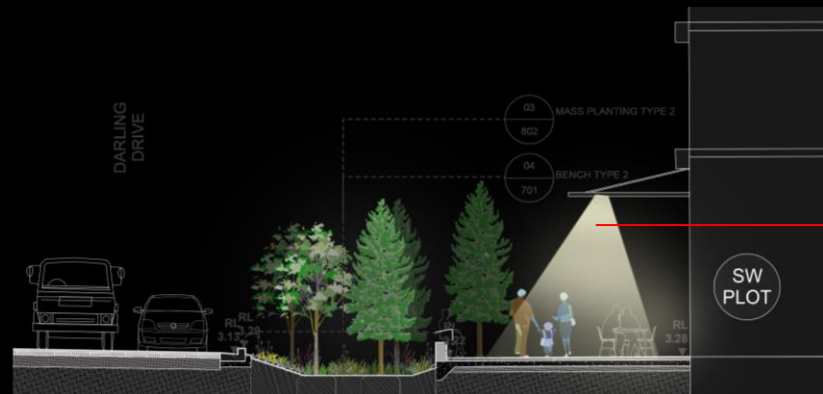

LIGHTS UNDER AWNING TO PROVIDE PEDESTRIAN SAFE MOVEMENT LIGHTING & EXTERNAL BUILDING LIGHTING FROM DUSK-TIL-DAWN. LIGHT FITTINGS TO BE NOMINATED BY SW PLOT LIGHTING/ELECTRICAL CONSULTANT TO PROVIDE MINIMUM P8 RATING (AS1158) 3000K LAMP

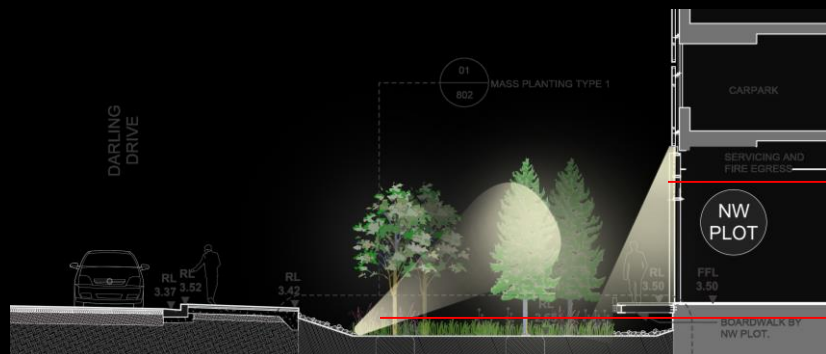

EXTERNAL LIGHTING DOCUMENTED BY NW PLOT LIGHTING CONSULTANT (M.S.)

GROUND MOUNTED FLOOD LIGHTS PART OF PUBLIC REALM LIGHTING PACKAGE

HAY STREET

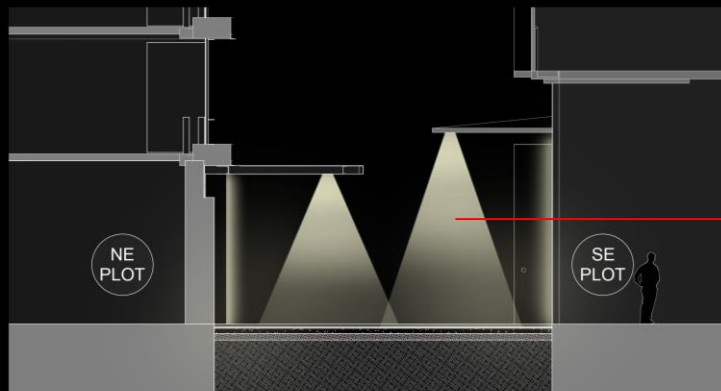

LIGHTS UNDER AWNING TO PROVIDE PEDESTRIAN SAFE MOVEMENT LIGHTING FROM DUSK-TIL-DAWN. THE UNDER AWNINGS LIGHTS TO BE UTILISED FOR BOTH PUBLIC REALM & EXTERNAL BUILDING LIGHTING. THIS AVOIDS DOUBLING UP ON FITTINGS PLUS CLUTTER. LIGHT FITTINGS TO BE NOMINATED BY S.M. TO PROVIDE MINIMUM P8 RATING (AS1158) 3000K LAMP

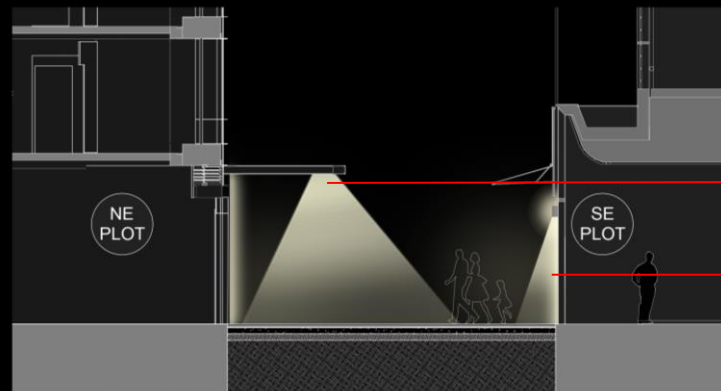

RETAIL NOMINATED LIGHT FITTINGS



DARLING SQUARE PUBLIC REALM LIGHT SOLUTION

REVITALISING ONE OF
SYDNEY'S FAVORITE PLACES
