

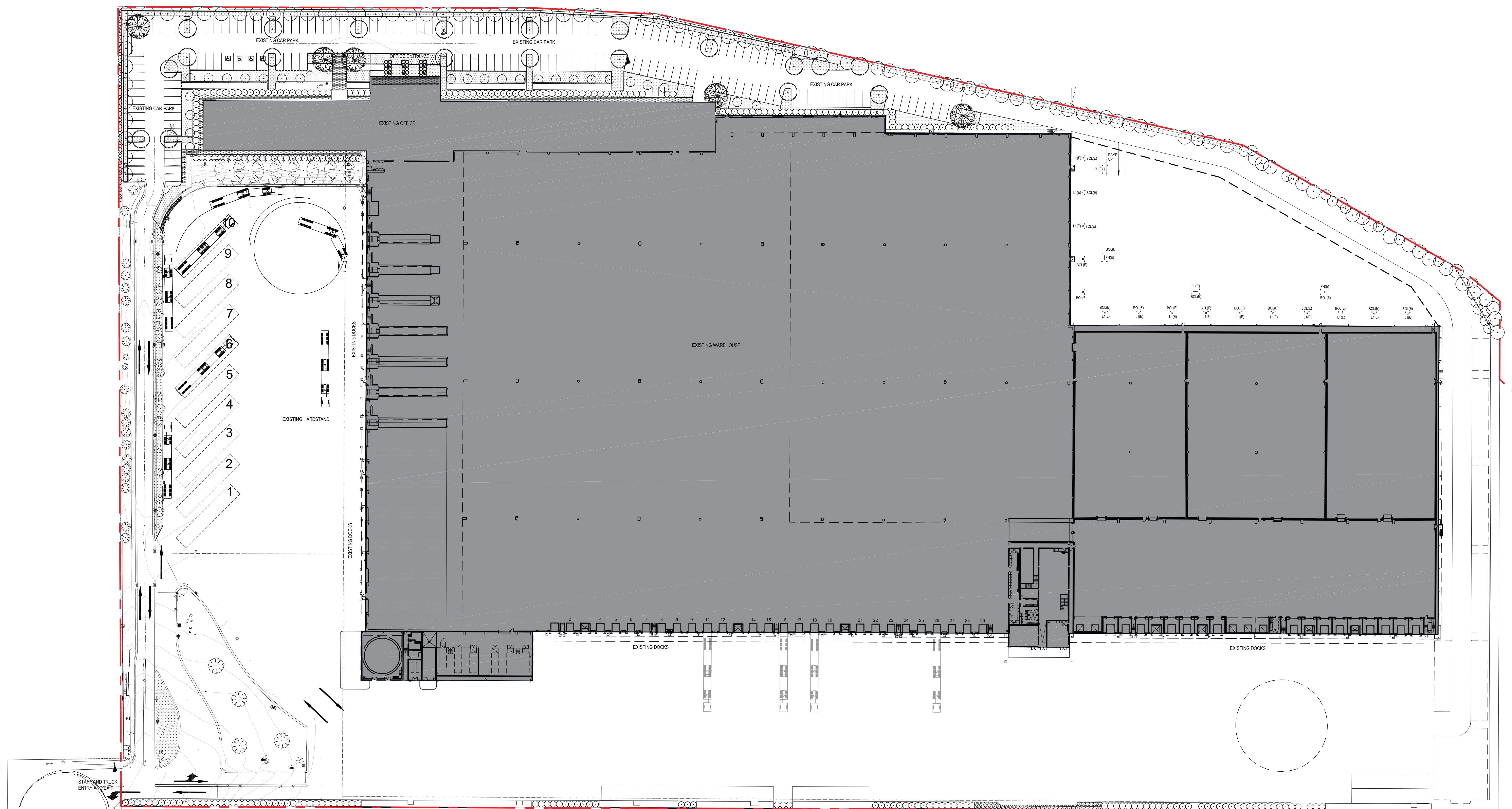

[illegible]

OVERALL SITE PLAN  
EXISTING SCALE 1:500

- LEGEND**
- |   |   |
|---|---|
|  | EXISTING SITE BOUNDARY  |
| (E)   | EXISTING ELEMENT, FITTING OR FIXTURE NOMINATED TO BE RETAINED |
| FHE)  | EXISTING FIRE HYDRANT   |
| GATE(E)   | EXISTING GATE TO BE RETAINED                                  |
|  | ELEMENT NOMINATED TO BE DEMOLISHED                            |

- NOTES:
1. THIS ARCHITECTURAL DRAWING IS TO BE READ IN CONJUNCTION WITH THE SURVEY PLAN, THE PRICED CIVIL ENGINEER'S DRAWINGS, LANDSCAPE ARCHITECT'S DRAWINGS AND THE ARBORIST'S REPORT.
  2. PARKING AREAS ARE TO BE CONSTRUCTED IN ACCORDANCE WITH ASINZS 2886:1/2004 PARKING FACILITIES - OFF-STREET CAR PARKING.
  3. ROADWAY LINE MARKINGS SHALL BE IN ACCORDANCE WITH THE RMS DELINEATION GUIDELINES SECTION 6 TRANSVERSE MARKINGS

CAR PARK NUMBERS: PRESTONS		
	EXISTING	PROPOSED
NORTH CAR PARK	188	177
ACCESSIBLE SPACES	4	4
WESTERN CAR PARK	0	117
<b>TOTAL CAR PARK SPACES</b>	<b>172</b>	<b>298</b>

FOR APPROVAL

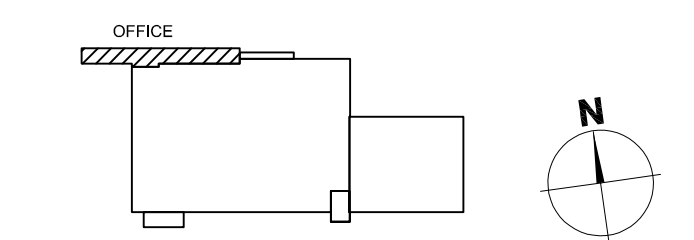

KEY PLAN (NOT TO SCALE)

Glenn



**ALDI FOODS**  
(A LIMITED PARTNERSHIP)  
1 SARGENT'S ROAD  
MINCHINBURY NSW 2770

---

*Archives*

BELL

BELL ARCHITECTURE  
MATT BELL NOMINATED ARCHITECT NSW 6666  
SUITE 202, 25-29 BERRY STREET NORTH SYDNEY NSW 2060  
PO BOX 1037 NORTH SYDNEY NSW 2059  
T 1300 923 460

project details

**ALDI PRESTONS  
CAR PARK & OFFICE REFURB  
PRESTONS NSW**

shoot title

EXISTING OVERALL SITE PLAN

issue date	scale @ A0	stage
26.06.2019	1:500	SKETCH
job no.	dwg no.	revision
BAS190014	PRE-SK-A-1001	S1

original sheet size A0: 341 x 1190mm