



# Appendix A

## Plans

# COFFS HARBOUR HEALTH CAMPUS ON-GRADE CAR PARKING & ACCESS ROAD CIVIL ENGINEERING WORKS - SCHEME DESIGN

## DRAWING INDEX

DRAWING NO.	DRAWING TITLE
01094_C100	COVER SHEET, DRAWING INDEX, LEGEND & LOCALITY SKETCH
01094_C110	GENERAL NOTES
01094_C201	GENERAL ARRANGEMENT PLAN STAGE 1 - SHEET 1
01094_C202	GENERAL ARRANGEMENT PLAN STAGE 1 - SHEET 2
01094_C203	GENERAL ARRANGEMENT PLAN STAGE 1 - SHEET 3
01094_C204	GENERAL ARRANGEMENT PLAN STAGE 1 - SHEET 4
01094_C205	GENERAL ARRANGEMENT PLAN STAGE 1 - SHEET 5
01094_C206	GENERAL ARRANGEMENT PLAN STAGE 1 - SHEET 6
01094_C207	GENERAL ARRANGEMENT PLAN STAGE 1 - SHEET 7
01094_C208	GENERAL ARRANGEMENT PLAN STAGE 1 - SHEET 8
01094_C209	GENERAL ARRANGEMENT PLAN STAGE 1 - SHEET 9
01094_C210	GENERAL ARRANGEMENT PLAN STAGE 2 - SHEET 1
01094_C211	GENERAL ARRANGEMENT PLAN STAGE 2 - SHEET 1
01094_C301	ROAD LONGITUDINAL SECTIONS
01094_C351	TYPICAL SECTIONS
01094_C501	GENERAL DETAILS SHEET 1
01094_C502	GENERAL DETAILS SHEET 2
01094_C701	SEDIMENT & EROSION CONTROL DETAILS
01094_C802	SEDIMENT & EROSION CONTROL PLAN - STAGE 1
01094_C803	SEDIMENT & EROSION CONTROL PLAN - STAGE 2

## DRAWING LEGEND

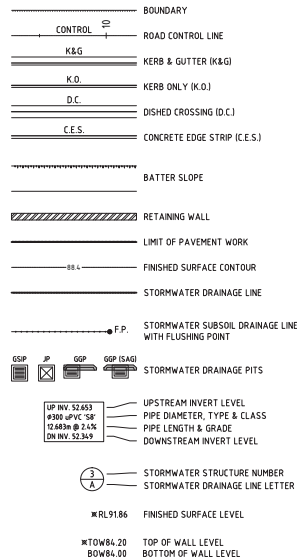

REV.	DES.	VER.	DATE	DESCRIPTION
01	T.T.	A.M.	25.06.14	PRELIMINARY ISSUE

## PRELIMINARY

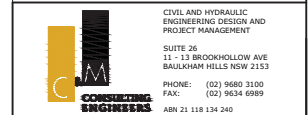

© THIS DRAWING AND DESIGN IS THE COPYRIGHT OF CAM CONSULTING ENGINEERS PTY. LTD. NO PART OF THIS DRAWING OR DESIGN SHALL BE REPRODUCED OR USED WITHOUT PRIOR WRITTEN CONSENT FROM CAM CONSULTING ENGINEERS PTY. LTD.

PROJECT COFFS HARBOUR HEALTH CAMPUS

TITLE COVER SHEET, DRAWING INDEX, LEGEND & LOCALITY SKETCH

DESIGNED	T.T.	DATE	16.04.14
VERIFIED	A.M.	DATE	16.04.14
DRAWN	T.T.	SCALE	# A0 NA
STATUS	DA / SD		
DRAWING No.	01094_C100		REVISION 01

1. ALL WORKS SHALL BE CONSTRUCTED IN ACCORDANCE WITH THE TECHNICAL SPECIFICATION.
2. THE CONTRACTOR SHALL PREPARE A DILAPIDATION REPORT FOR THE EXISTING INFRASTRUCTURE WITHIN THE ROAD RESERVE, INCLUDING BUT NOT LIMITED TO KERBS, GUTTERS, FOOTPATHS, VEHICULAR CROSSINGS, STREET SIGNS, SERVICE FITTING COVERS, ETC.
3. THE CONTRACTOR SHALL REVIEW, BE AWARE AND AT ALL TIMES COMPLY WITH THE SPECIFIC REQUIREMENTS FOR THIS DEVELOPMENT AS SET OUT IN THE DEVELOPMENT APPROVAL FOR THE PROJECT.
4. ANY CHANGES MADE BY THE CONTRACTOR TO ANY LEVEL, DIMENSION, LOCATION, POSITION, ALIGNMENT ETC., OF ANY OF THE WORKS SHOWN ON THE DRAWINGS WITHOUT THE WRITTEN CONSENT OF C&M CONSULTING ENGINEERS PTY. LTD. AND/OR THE PRINCIPAL CERTIFYING AUTHORITY IS DONE SO AT THE CONTRACTORS OWN RISK.
5. THE CONTRACTOR SHALL ALLOW TO LIAISE WITH AND PROVIDE SUFFICIENT NOTICE TO THE PRINCIPAL CERTIFYING AUTHORITY TO ENSURE THAT ALL WORKS ARE INSPECTED TO ENABLE COMPLIANCE CERTIFICATES TO BE ISSUED THROUGHOUT THE CONSTRUCTION PERIOD. THE CONTRACTOR SHALL LIAISE WITH THE PRINCIPAL CERTIFYING AUTHORITY PRIOR TO ANY CONSTRUCTION WORKS COMMENCING AND PREPARE AN INSPECTION AND TEST PLAN WITH A MUTUALLY AGREED WITNESS AND HOLD POINTS FOR THE CONSTRUCTION WORKS.
6. IF THE PRINCIPAL CERTIFYING AUTHORITY IS NOT COFFS HARBOUR COUNCIL, THEN THE CONTRACTOR MUST CONTACT COFFS HARBOUR COUNCIL'S WORKS DIVISION TO ENABLE THEIR INSPECTION OF ALL WORKS (INCLUDING EROSION AND SEDIMENT CONTROL MEASURES) WITHIN THE ROAD RESERVE AREA.
7. THE CONTRACTOR SHALL BE RESPONSIBLE FOR THE MAINTENANCE OF ALL ACCESS TO THE SITE. THE ACCESS SHALL BE ALL WEATHER SAFE ACCESS TO THE CONTRACTOR'S SITE FACILITIES AT ALL TIMES FOR THE DURATION OF THE CONTRACT.
8. A TEMPORARY HOARDING OR FENCE OF MINIMUM 15m HIGH IS TO BE PROVIDED AROUND THE SITE TO PROTECT THE PUBLIC PRIOR TO COMMENCEMENT OF WORKS. HOARDINGS OR FENCES ARE TO BE STRUCTURALLY ADEQUATE. THE CONTRACTOR SHALL OBTAIN AN APPROVAL FROM COUNCIL PRIOR TO ERECTING THE HOARDING OR FENCE.
9. ALL NEW WORKS SHALL MAKE A SMOOTH CONNECTION WITH ANY FORMATIONS, STRUCTURES, ETC.
10. ALL ALTERATIONS AND/OR ADDITIONS TO EXISTING WORK, THE CONTRACTOR SHALL VERIFY THE DIMENSIONS OF THE EXISTING WORK BEFORE PROCEEDING AND NOTIFY THE SUPERINTENDENT OF DISCREPANCIES.
11. THE CONTRACTOR SHALL USE MANUFACTURED ITEMS IN THE WORK ONLY IN ACCORDANCE WITH THE CURRENT PUBLISHED.
12. THE WORKS SHALL BE CONSTRUCTED IN SUCH A MANNER THAT THERE IS MINIMUM DISTURBANCE TO EXISTING TREES AND VEGETATION.
13. THE PUBLIC FOOTWAY AND ROADWAY FRONTING THE SITE SHALL BE MAINTAINED IN A SAFE AND UNOBSTRUCTED MANNER AT ALL TIMES DURING THE CONSTRUCTION WORKS.
14. THE CONTRACTOR SHALL BE RESPONSIBLE FOR REPAIRING TO THE SATISFACTION OF THE ASSET OWNER, ANY DAMAGE CAUSED TO ANY EXISTING INFRASTRUCTURE WITHIN THE ROAD RESERVE, INCLUDING BUT NOT LIMITED TO KERBS, GUTTERS, FOOTPATHS, VEHICULAR CROSSINGS, STREET SIGNS, SERVICE FITTING COVERS, ETC.
15. THE SITE SHALL BE KEPT IN A TIDY CONDITION AT ALL TIMES. LITTER RUBBISH AND BUILDING RUBBLE SHALL BE PLACED IN CONTAINERS OR BINS AND REGULARLY REMOVED FROM SITE AS REQUIRED.

1. PROVIDE TRAFFIC MARKING IN ACCORDANCE WITH THE REQUIREMENTS THE RMS TRAFFIC CONTROL AT WORK SITES MANUAL AND AS 174.3 WHILE UNDERTAKING THE WORK.
2. LINE MARKING AND SIGN POSTING SHALL COMPLY WITH THE REQUIREMENTS OF AS174.2
3. REFLECTIVE RAISED PAVEMENT MARKERS SHALL COMPLY WITH THE REQUIREMENTS OF AS 1906.3. INSTALLATION TO THE REQUIREMENTS OF RMS QA DOCUMENT R14.2
4. THE SURFACE AREA TO BE LINE MARKED MUST BE DRY AND FREE OF DIRT, GRIT, FLAKING PAVEMENT MARKING MATERIAL AND OTHER LOOSE OR FOREIGN MATERIAL.
5. ALL PAVEMENT MARKINGS SHALL BE THERMO PLASTIC WITH REFLECTIVE GLASS BEADS TO AS209, UNLESS NOTED OTHERWISE. THICKNESS OF THERMO PLASTIC SHALL BE 18mm FOR LINES AND 3mm FOR OTHER MARKINGS.
6. SIGN SUPPORTS AND TRAFFIC SIGNS SHALL BE MANUFACTURED IN ACCORDANCE WITH AS 4100. ALL STEEL COMPONENTS SHALL BE HOT-DIP GALVANIZED TO THE REQUIREMENT OF AS5460.

1. STORMWATER DESIGN CRITERIA:  
MINOR STORM ARI: 10 YEARS  
MAJOR STORM ARI: 100 YEARS  
IFD DATA LOCALITY: COFFS HARBOUR
2. PIPES DN375 AND LARGER TO BE STEEL REINFORCED CONCRETE PIPES CLASS "2" APPROVED SPIGOT AND SOCKET WITH RUBBER RING JOINTS U/D 10.
3. PIPES DN300 AND SMALLER SHALL BE GRADE SH (SEWER GRADE) uPVC WITH RUBBER RING JOINTS.
4. EQUIVALENT STRENGTH FIBRE REINFORCED CONCRETE PIPES MAY BE USED UP TO DN450.
5. PIPES FOR SUB-SOIL DRAINS SHALL BE SLOTTED 100MM DIAMETER CLASS 1000 WRAPPED IN GEOFABRIC, U.O.N, COMPLYING WITH THE REQUIREMENTS OF AS 2439.
6. PRECAST PITS, WHERE ALLOWED, AND THE INSITU BASE SHALL COMPLY WITH THE REQUIREMENT OF THE MANUFACTURER.
7. ALL WELD STEEL FIXTURES INCLUDING GRATES, FRAMES, STEP IRONS, LADDERS, ETC. SHALL BE HOT DIP GALVANISED GALVANISING SHALL COMPLY WITH THE REQUIREMENTS OF AS 1214 OR AS 1650, AS APPROPRIATE.
8. GEOFABRIC FILTER SHALL BE PERMEABLE, NON-WOVEN FABRIC MANUFACTURED FROM A POLYMER SUCH AS POLYPROPYLENE OR POLYESTER OF MASS NOT LESS THAN 135G/M2.
9. THE MINIMUM TRENCH WIDTHS SHALL BE AS FOLLOWS:  
CONCRETE AND FRC PIPES: EXTERNAL PIPE DIAMETER PLUS 400MM.  
uPVC PIPE: EXTERNAL DIAMETER OF PIPE PLUS 200MM.  
SUBSOIL PIPE: 250MM.
10. PIPES SHALL BE PLACED CENTRALLY WITHIN THE TRENCH WITH EQUAL CLEARANCE EACH SIDE.
11. PIPE BEDDING MATERIAL SHALL BE CLEAN COARSE RIVER SAND WITH DEPTH AS FOLLOWS:  
CONCRETE AND FRC PIPES: 100MM (175MM IN ROCK)  
UPVC PIPE: 75MM (100MM IN ROCK)  
SUBSOIL DRAINS: 50MM
12. ALL PIPES SHALL BE BACKFILLED WITH GRANULAR MATERIAL SUCH AS QUARRY FINE OR COARSE RIVER SAND TO A MINIMUM OF 150MM ABOVE THE PIPE. THE GRANULAR MATERIAL SHALL BE PLACED IN 150MM THICK LAYERS. MATERIALS ARE REQUIRED TO ACHIEVE A DENSITY INDEX (DI) OF 70%. FREQUENCIES OF COMPACTION TESTS FOR TRENCHES SHALL BE 1 TEST PER 2 LAYERS PER 40 LINE METRE.
13. BACKFILL THE REMAINDER OF THE TRENCH ABOVE THE SAND TO SUBGRADE LEVEL WITH TRENCH MATERIAL. PLACE AND COMPACT MATERIALS IN LAYERS NOT EXCEEDING 150MM LOOSE THICKNESS. MATERIAL LOWER THAN 500MM BELOW SUBGRADE LEVEL SHALL BE COMPACTED TO AT LEAST 95% OF STANDARD MAXIMUM DRY DENSITY. THE TOP 500MM BELOW PAVEMENT SUBGRADE LEVELS SHALL BE COMPACTED TO AT LEAST 100% STANDARD MAXIMUM DRY DENSITY.
14. FILTER MATERIAL FOR SUBSOIL SHALL BE COARSE SAND OR CRUSHED MATERIAL COMPLYING WITH ONE OF THE GRADINGS IN THE TABLE BELOW. WHERE NOTED ON THE DRAWINGS THE 7MM CRUSHED ROCK FILTER MATERIAL SHALL BE ENCLOSED WITHIN FILTER FABRIC SHEET AS SPECIFIED. FILTER MATERIAL SHALL BE PLACED IN 250MM LAYERS AND COMPACTED TO DENSITY INDEX (DI) OF 60%.

AS SIEVE SIZE (mm)	SAND	7mm ROCK
9.5	100	100
6.7	-	75-100
4.75	90-100	20-55
2.36	75-100	0-15
1.18	50-90	
0.6	20-60	
0.3	10-30	
0.15	2-10	
0.075	0-3	0-2

15. UNLESS OTHERWISE DETAILED OR PERMITTED, THE MINIMUM GRADE OF ALL PIPE WORKS SHALL BE 1.0%.

1. ALL WORKSMANSHIP AND MATERIALS IN ACCORDANCE WITH AS 3700 AND AS 2733
2. BLOCKS SHALL BE BORAL SPLIT FACE CHARCOAL WITH MATCHING CAPPING
3. MORTAR SHALL BE FRESHLY PREPARED, UNIFORMLY MIXED IN THE FOLLOWING RATION: 1/1/0.3 CEMENT, LIME SAND, IN ACCORDANCE WITH AS 123 AND AS 3700 CLAUSE 2.2.2.
4. BOTTOM COURSE OF BLOCKS TO HAVE INSPECTION OPENINGS TO ALL CORES TO BE GROUTED. THOROUGHLY CLEAN ALL CORES PRIOR TO REINFORCEMENT PLACING.
5. 3 TOP COURSE OF BLOCKS TO BE WITH MINIMUM GROUT STRENGTH 20MPa. SLUMP = 230MM MAX AGGREGATE SIZE = 10MM
6. PROVIDE VERTICAL CONTROL JOINTS IN WALLS AT 8 METRE MAX. CENTRES U.O.
7. TIE ALL VERTICAL REINFORCEMENT TO STARTER BARS AND TOP HORIZONTAL REINFORCEMENT.
8. MAXIMUM POUR HEIGHT TO BE 2400.
9. OPEN ENDED DOUBLE U - BLOCKS TO BE USED FOR ALL REINFORCED BLOCKWORK.

1. FOR RIGID PAVEMENT COMPONENT, CONCRETE NOTES SHALL ALSO BE REFERRED.
2. BASE MATERIAL, UNLESS NOTED OTHERWISE, SHALL BE UNBOUND DG820 MATERIAL AS SPECIFIED IN THE RTA 3051.
3. SUBBASE MATERIAL, UNLESS NOTED OTHERWISE, SHALL BE UNBOUND DG540 MATERIAL AS SPECIFIED IN THE RTA 3051.
4. SELECT MATERIAL, IF SPECIFIED, SHALL BE CRUSHED ROCK, NATURAL GRAVELS OR SUITABLE SOILS, AND THE MATERIALS SHALL BE FREE OF ORGANIC MATTER AND OTHER OBJECTIONABLE OR DELETERIOUS SUBSTANCES. THE MATERIALS SHALL HAVE A MAXIMUM PARTICLE SIZE OF 75mm AND SHALL HAVE A MINIMUM CCR OF 15% AT 100% STANDARD MAXIMUM DRY DENSITY.
5. FREQUENCIES OF COMPACTION TESTS FOR PAVEMENT CONSTRUCTION SHALL BE AS FOLLOWS (TESTS PER LAYER AND WHICHEVER IS GREATER NUMBER):
  - a. 1 TEST PER 50m LENGTH OF ROAD, OR
  - b. 1 TEST PER 400m<sup>2</sup>
6. COMPACTION REQUIREMENTS FOR PAVEMENT CONSTRUCTION SHALL BE AS FOLLOWS:
  - a. BASE AND SUBBASE: 98% OF MDD TO AS 1289 E2.1
  - b. SELECT AND SUBGRADE: 100% OF MDD
7. THE PRIMER TO BE USED SHALL BE MODM CURING CUTBACK BITUMEN COMPLYING WITH THE REQUIREMENTS OF AS 2157. THE GRADE OF CUTBACK BITUMEN SHOULD BE AM C.
8. AGGREGATES FOR THE SEAL SHALL BE ONE-SIZED OF THE NOMINAL SIZE AND CLASS SPECIFIED ON DRAWING. THESE AGGREGATES SHALL BE PRECOATED WITH A BITUMEN BASED PRECOATING MATERIAL.
9. UNLESS OTHERWISE SPECIFIED OR DIRECTED, BITUMINOUS EMULSION FOR TACK COATING SHALL BE DESIGNATION CRS/170 COMPLYING WITH THE REQUIREMENTS OF AS 1160.
10. ASPHALTIC CONCRETE AS SPECIFIED ON THE DRAWING SHALL COMPLY WITH AS 2150 - ASPHALT (HOT-MIXED).
11. UNLESS OTHERWISE SPECIFIED IN THE DRAWINGS, BINDER SHALL BE CLASS 320 BITUMEN COMPLYING WITH THE REQUIREMENTS OF AS 2008.
12. ANY OTHER BITUMEN TYPE WHERE CALLED UP IN THE DRAWING SHALL MEET THE REQUIREMENTS AS SET OUT IN THE RMS MATERIALS SPECIFICATIONS 3252 OR 3253.

1. THE CONSTRUCTOR SHALL USE A SUITABLY QUALIFIED SURVEYOR TO SET OUT ALL WORKS. THE SURVEYOR SHALL ISSUE A CERTIFICATE TO THE PRINCIPAL CERTIFYING AUTHORITY CERTIFYING THAT THE WORKS HAVE BEEN SET OUT IN ACCORDANCE WITH THE APPROVED DRAWINGS PRIOR TO THE WORKS BEING CONSTRUCTED.
2. THE SURVEY WORK ASSOCIATED WITH THE CONTRACT SHALL INCLUDE SETTING OUT THE FOLLOWING COMPONENTS OF THE WORK:
  - ROADS AND KERBS
  - DRAINAGE STRUCTURES
  - PARKING BAYS

1. ALL WORKSMANSHIP, MATERIALS AND TESTING FOR CONCRETE WORKS SHALL COMPLY WITH THE REQUIREMENTS OF AS3600.
2. ALL WORKSMANSHIP AND MATERIALS FOR FORMWORK SHALL COMPLY WITH THE REQUIREMENTS OF AS3610.
3. THE CONSTRUCTOR SHALL ENSURE THAT ALL REINFORCEMENT IS SECURELY TIED AND SUPPORTED IN IT'S CORRECT POSITION AND WITHIN ACCEPTABLE TOLERANCES SO AS NOT TO BE DISPLACED DURING CONCRETE POURING.
4. PROVIDE CONCRETE WITH A MAXIMUM SLUMP OF 80, TYPE SL CEMENT, MAXIMUM AGGREGATE SIZE 20, APPROVED ADMIXTURES AND STRENGTH GRADE AS FOLLOWS:-

ELEMENT	EXPOSURE CLASSIFICATION	STRENGTH (MPA)
PAVEMENT	A2	32MPA
KERB (ALL TYPES)	A2	25MPA
FOOTPATH	A2	25MPA
RETAINING WALL FOOTING	A1/B1	20MPA

- PROJECT CONTROL TESTING SHALL BE CARRIED OUT IN ACCORDANCE WITH AS 3600.
5. PROVIDE LAPS ONLY AT LOCATIONS SHOWN AND OF DIMENSIONS AS FOLLOWS UNLESS DETAILED OTHERWISE OR APPROVED IN WRITING BY THE ENGINEER

BAR SIZE	N12	N16	N20
LAP	500	750	1000

6. OVERLAP FIRST AND SECOND CROSS WIRES OF EACH SHEET OF FABRIC BY 25 AT LAPs.
7. DO NOT WELD REINFORCEMENT UNLESS SHOWN OR APPROVED BY THE ENGINEER.
8. TIE ALL UNSUPPORTED BARS TO N12.35.0 OR N12.45.0. T CROSSROADS, LAPPED 450 WHERE REQUIRED.
9. PROP. CURE AND STRIP IN ACCORDANCE WITH AS3600, AS3610 AND THE SPECIFICATION.
10. CONCRETE SAWN JOINTS MUST BE DONE WITHIN 8 HOURS OF CONCRETE POUR.
11. JOINT SEALANT MUST BE SILICONE SEALANT FOR CASTING IN-SITU AS SPECIFIED ON DRAWINGS.
12. CONCRETE FINISH SHALL BE AS FOLLOWS:

ELEMENT	EXPOSURE
ROAD (GRADE < 1 IN 10)	BROOM
ROAD (GRADE > 1 IN 10)	GROOVE
FOOTPATH	BROOM

1. THE CONTRACTOR SHALL STRIP THE MATERIAL, CLASSIFIED AS TOPSOIL, OR MATERIAL CONTAINING ORGANIC MATTER TO A LEVEL APPROVED BY THE CONTRACTOR'S GEOTECHNICAL ENGINEER AND THE SUPERINTENDENT. THE STRIPPED TOPSOIL SHOULD BE REMOVED AND STOCKPILED PRIOR TO ANY EARTHWORKS OPERATIONS.
2. THE MAXIMUM HEIGHT OF TOPSOIL STOCKPILES SHALL NOT EXCEED 2.5M AT THE MAXIMUM BATTER SLOPE SHALL NOT EXCEED 2H: 1V.
3. ALL EARTHWORKS OPERATIONS SHALL BE CARRIED OUT TO LEVEL 1 SUPERVISION IN ACCORDANCE WITH AS3579 - 2007. THE CONTRACTOR SHALL ISSUE A WRITTEN LETTER FROM THE GEOTECHNICAL CONSULTANT THAT THEY HAVE BEEN ENGAGED ACCORDINGLY AND TAKES FULL RESPONSIBILITY OF THE EARTHWORKS OPERATION.
4. THE CONTRACTOR SHALL OVER-EXCAVATE TO REMOVE ALL UNACCEPTABLE MATERIAL. MATERIAL CONTAINING BELIEVED TO BE ORGANIC MATERIALS SUCH AS ORGANIC MATTER AND CONSTRUCTION MATERIALS, ALL OVER-EXCAVATED AREAS SHALL BE REPLACED WITH SUITABLE MATERIAL WITH A CBR AT LEAST EQUAL TO THE SPECIFIED SUBGRADE CBR, SOURCED FROM ON SITE, IF AVAILABLE, OR IMPORTED.
5. WET MATERIAL WILL NOT BE REGARDED AS UNSUITABLE. SHOULD WET MATERIAL BE ENCOUNTERED, THE CONTRACTOR SHALL DRY THE MATERIAL SUFFICIENTLY BY RE-WORKING, OR SPREADING IT TO ALLOW DRYING, ALL ASSOCIATED COSTS SHALL BE BORNE BY THE CONTRACTOR.
6. ALL EXCESS EARTHWORKS MATERIAL, INCLUDING EXCESS MATERIALS FROM THE STORMWATER AND SERVICE TRENCH EXCAVATIONS SHALL BE REMOVED AND LEGALLY DISPOSED OF OFF-SITE BY THE CONTRACTOR AT THE CONTRACTOR'S COST.
7. ALL BATTER SLOPES SHALL BE A MAXIMUM OF 1V:5H (U.N.O.)
8. UNLESS NOTED OTHERWISE OR APPROVED ALL FILL MUST BE CONSTITUTED OF VIRGIN EXCAVATED NATURAL MATERIAL (VENM).
9. THE CONTRACTOR SHALL EXCAVATE AND/OR PLACE CONTRACT FILL TO CONFORM TO THE LINES, GRADES, CROSS SECTIONS, AND DIMENSIONS SHOWN ON THE DRAWINGS, ALLOWING FOR PAVEMENT/SLAB AND TOPSOIL LAYERS.
10. FREQUENCIES OF COMPACTION TESTS FOR EARTHWORKS SHALL BE AS FOLLOWS (WHICHEVER IS GREATER NUMBER).

### LARGE SCALE OPERATION (> 1500 m2)

- 1 TEST PER LAYER PER MATERIAL TYPE PER 2500 m<sup>2</sup>, OR
- 1 TEST PER 500m<sup>3</sup>, OR
- 3 TESTS PER LOT (MATERIAL TYPE AND MOISTURE).

12. COMPACTION REQUIREMENTS FOR EARTHWORKS SHALL BE AS FOLLOWS:
  - a. GENERAL FILL: 95% SMD
  - b. TOP 500MM UNDER PAVEMENT OR STRUCTURE: 100% SMD
  - c. BACKFILL WITHIN 2M OF STRUCTURE: 100% SMD
13. MOISTURE CONTENT TO BE IN THE RANGE OF - 2% TO +2% OF THE OPTIMUM MOISTURE CONTENT.
14. ALL COMPACTION TEST RESULTS SHALL BE PROVIDED TO THE SUPERINTENDENT
15. ALL SITE REGRADED AREAS AFTER FORMATION, SHALL BE COVERED WITH A 50MM TOPSOIL LAYER. TOPSOIL STOCKPILED PRIOR TO EARTHWORKS OPERATIONS CAN BE REUSED FOR THIS PURPOSE PROVIDED ANY DELETERIOUS MATERIAL IS REMOVED PRIOR TO PLACING.
16. ALL DISTURBED AND DENuded AREAS SHALL BE REGRASED WITHIN 7 DAYS AFTER THE COMPLETION OF EARTHWORKS FORMATION. REFER LANDSCAPE PLAN 1003 FOR DETAIL OF REGRESS.

1. IT IS THE CONSTRUCTORS RESPONSIBILITY TO NOTIFY THE RELEVANT SERVICES AUTHORITIES OF THE WORKS AND VERIFY THE LOCATION OF ALL EXISTING SERVICES PRIOR TO ANY CONSTRUCTION ACTIVITIES COMMENCING
2. THE CONSTRUCTOR SHALL LIAISE AND COORDINATE THE TIMING OF THE CONSTRUCTION OF THE WORKS WITH THE RELEVANT SERVICES AUTHORITIES AND/OR OTHER CONSTRUCTORS INSTALLING SERVICES CONCURRENTLY AT THE SITE
3. THE LOCATION OF ALL EXISTING SERVICES SHOWN ON THE DRAWINGS ARE APPROXIMATE ONLY AND HAVE BEEN TAKEN FROM INFORMATION PROVIDED BY THE RELEVANT SERVICE AUTHORITIES
4. THE CONSTRUCTOR SHALL BE RESPONSIBLE FOR ALL DAMAGE CAUSED TO EXISTING SERVICES AS A RESULT OF THE CONSTRUCTION WORKS

1. ALL KERBS, GUTTERS, EDGE STRIPS, LAYBACKS AND CROSSINGS TO BE BUILT ON A MINIMUM OF 100mm THICK SUBBASE. THE SUBBASE SHALL BE EXTENDED 150mm BEHIND BACK OF KERB.
2. CONCRETE SHALL BE OF 25MPa COMPRESSIVE STRENGTH (F'c) AT 28 DAYS.
3. EXPANSION JOINTS OF APPROVED BITUMEN IMPREGNATED JOINTING MATERIAL OR EQUIVALENT SHALL BE PLACED AT 12m INTERVALS, AT JUNCTIONS WITH EXISTING WORK, KERB TRANSITIONS AND ADJACENT TO GULLY TIPS. WEAKENED PLANE JOINTS (DUMMY JOINTS) SHALL BE CUT AT 3m INTERVALS.
4. ALL KERBING OR DISH DRAINS TO BE STEEL FLOAT FINISH.
5. ALL RAMPED CROSSINGS TO BE BROODIED FINISH.

REV.	DES.	VER.	DATE	DESCRIPTION
01	T.T.	A.M.	25.06.14	PRELIMINARY ISSUE

---

CLIENT



PROJECT MANAGER
-----------------



CIVIL AND HYDRAULIC  
ENGINEERING DESIGN AND  
PROJECT MANAGEMENT

**CONSULTING ENGINEERS**

© THIS DRAWING AND DESIGN IS THE COPYRIGHT OF C&M CONSULTING

PROJECT	COFFS HARBOUR HEALTH CAMPUS
---------	-----------------------------

## GENERAL NOTES

DESIGNED	T.T.	DATE	16.04.14
VERIFIED	A.M.	DATE	16.04.14
DRAWN	T.T.	SCALE @ A0	NA
STATUS		DA / SD	
DRAWING No.	01094_C100	REVISION	01

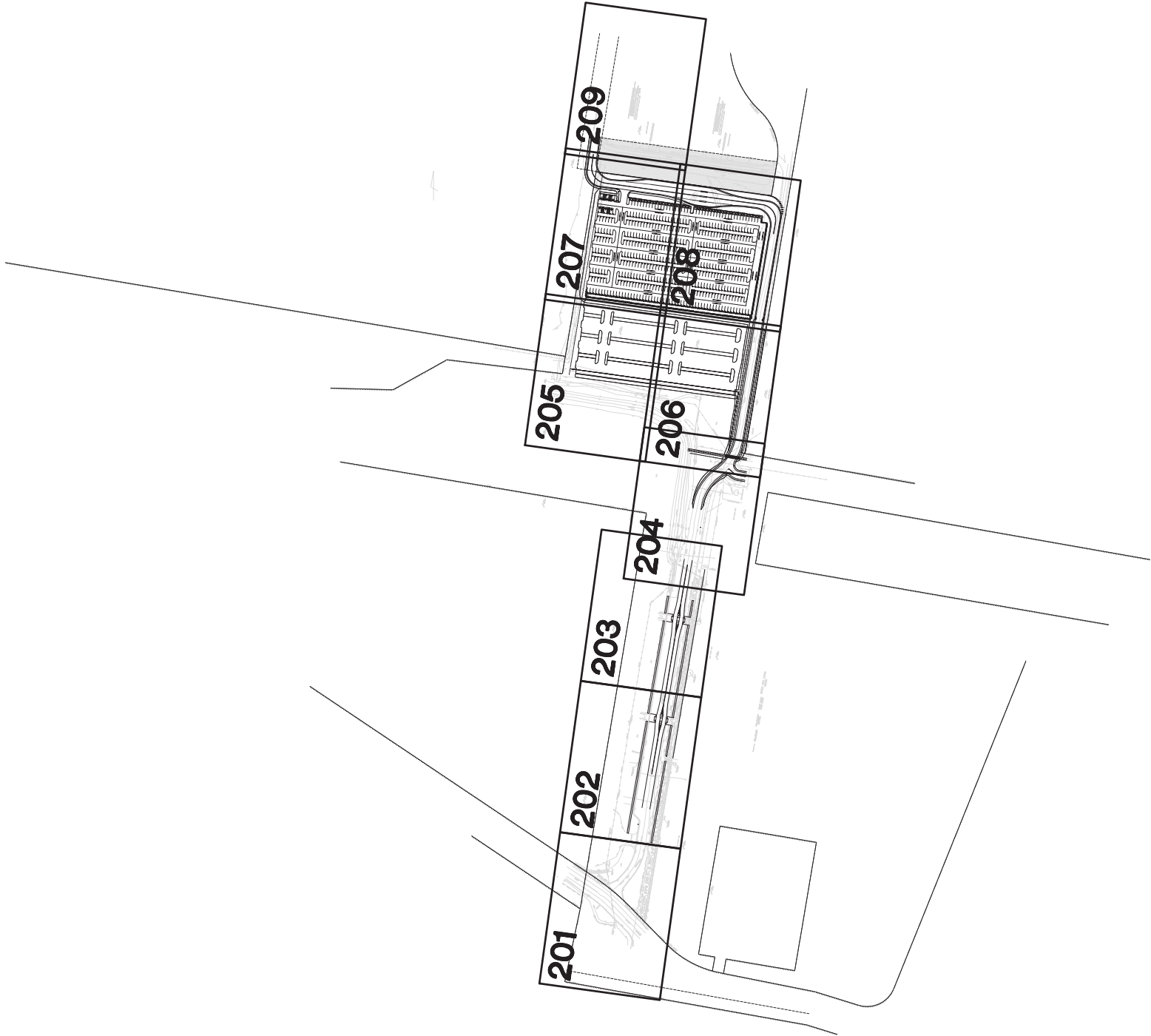

REV.	DES.	VER.	DATE	DESCRIPTION
01	T.T.	A.M.	01.07.14	PRELIMINARY ISSUE

PRELIMINARY

CLIENT:



Health  
Infrastructure

PROJECT MANAGER:





STRUCTURE PTY LTD  
CIVIL AND STRUCTURAL  
ENGINEERS  
www.scd-engineers.com.au ABN 90 180 974 901  
SUITE 2 - BARKER ROAD, 1ST FLOOR STONEY  
HILL NSW 5114  
TEL: 08 8362 1212 FAX: 08 8362 1213  
100 JOSEPH ST - STONEY HILL NSW 5114



CIVIL AND HYDRAULIC  
ENGINEERING DESIGN AND  
PROJECT MANAGEMENT  
SUITE 26  
11 - 13 BROOKHOLLOW AVE  
BAULKHAM HILLS NSW 2153  
PHONE: (02) 9680 3100  
FAX: (02) 9634 6989  
ABN 21 118 134 240

© THIS DRAWING AND DESIGN IS THE COPYRIGHT OF CAM CONSULTING ENGINEERS PTY LTD. NO PART OF THIS DRAWING OR DESIGN SHALL BE REPRODUCED OR USED WITHOUT PRIOR WRITTEN CONSENT FROM CAM CONSULTING ENGINEERS PTY LTD.

PROJECT COFFS HARBOUR HEALTH CAMPUS

TITLE SITE / LAYOUT PLAN

DESIGNED	T.T.	DATE	16.04.14
VERIFIED	A.M.	DATE	16.04.14
DRAWN	T.T.	SCALE	# A0 NA

STATUS DA / SD

DRAWING No.	01094_C100	REVISION	01
-------------	------------	----------	----

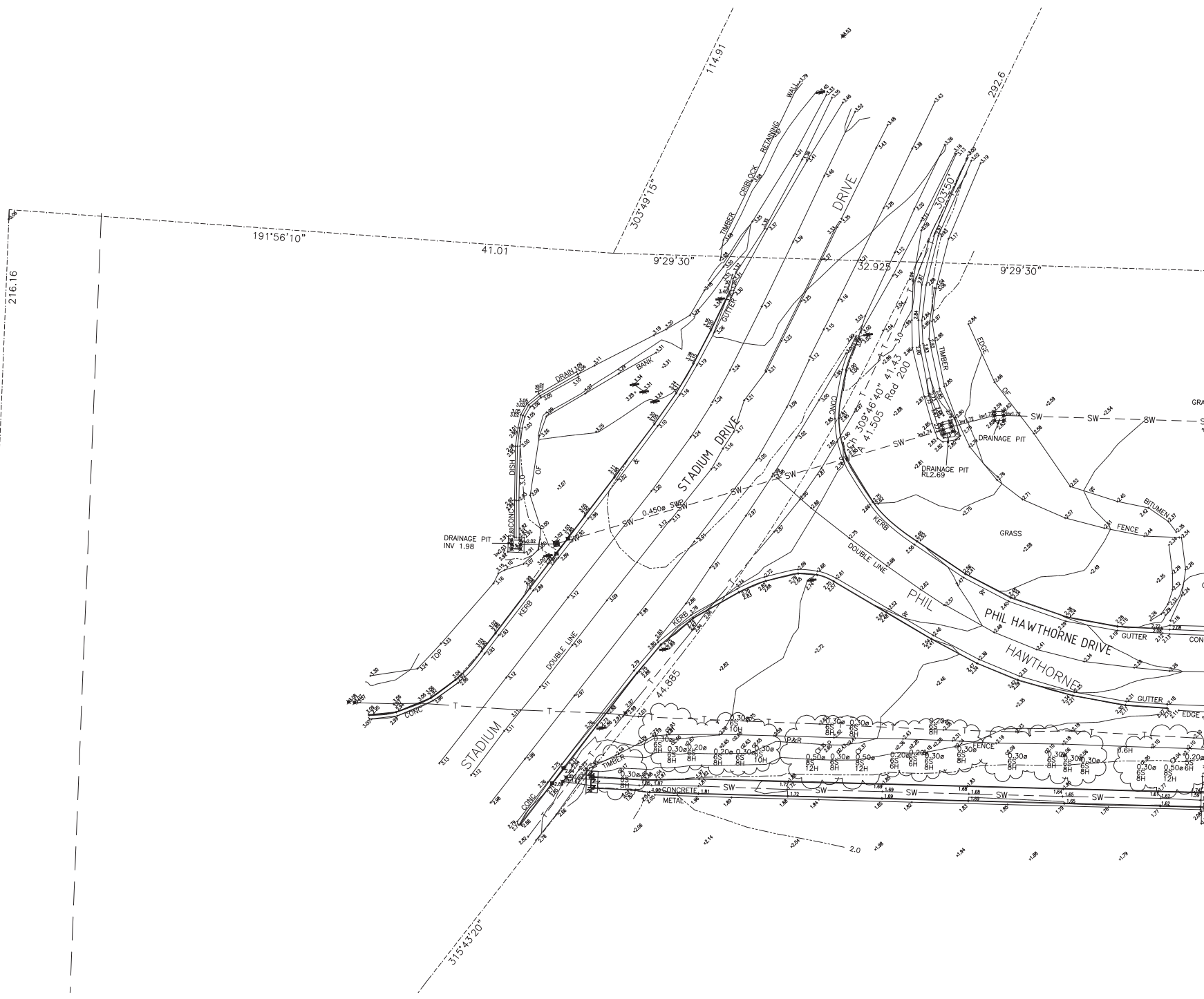

FOR CONTINUATION REFER C202

FOR CONTINUATION REFER C202

REV.	DES.	VER.	DATE	DESCRIPTION
01	T.T.	A.M.	25.06.14	PRELIMINARY ISSUE

# PRELIMINARY

CLIENT:



PROJECT MANAGER:





CONSULTING PTY LTD  
12-13 BROOKHOLLOW AVE  
BAULKHAM HILLS NSW 2153  
PHONE: (02) 9680 3100  
FAX: (02) 9634 6989  
ABN 21 118 134 240



CIVIL AND HYDRAULIC  
ENGINEERING DESIGN AND  
PROJECT MANAGEMENT  
SUITE 26  
12-13 BROOKHOLLOW AVE  
BAULKHAM HILLS NSW 2153  
PHONE: (02) 9680 3100  
FAX: (02) 9634 6989  
ABN 21 118 134 240

PROJECT		COFFS HARBOUR HEALTH CAMPUS	
TITLE		GENERAL ARRANGEMENT PLAN STAGE 1 - SHEET 1	
DESIGNED	T.T.	DATE	16.04.14
VERIFIED	A.M.	DATE	16.04.14
DRAWN	T.T.	SCALE @ A3	1:200
STATUS		DA / SD	
DRAWING No.	01094_C201		REVISION 01



FOR CONTINUATION REFER C201

FOR CONTINUATION REFER C201

CAD FILENAME: C:\Users\Projects\01094-01094-01094 - Coff's Harbour Health Campus - Car Park Project\ACAD\DWG\DWG\_1201.dwg

A1

LOT 102  
DP 1077682

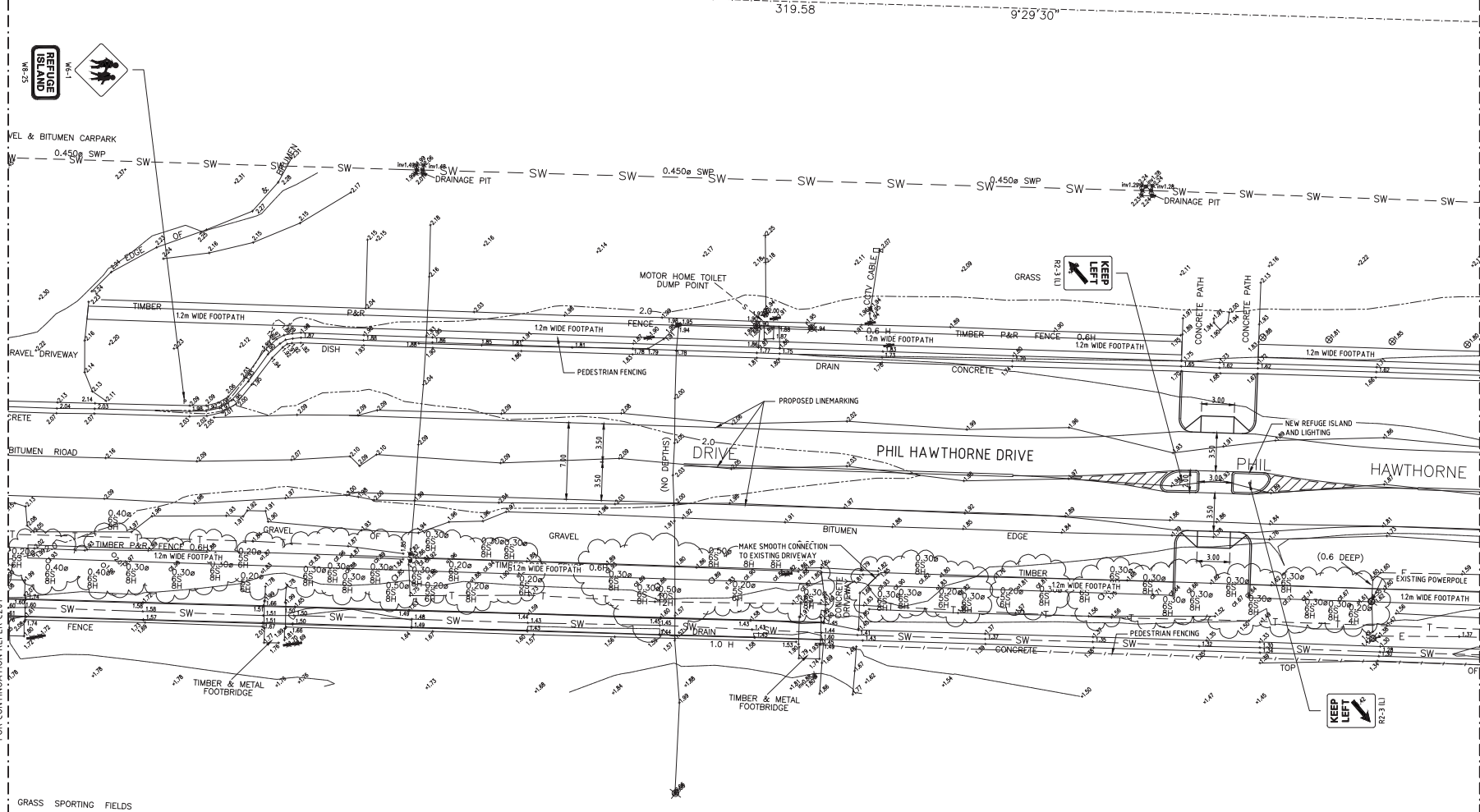

FOR CONTINUATION REFER C203

REV.	DES.	VER.	DATE	DESCRIPTION
01	T.T.	A.M.	25.06.14	PRELIMINARY ISSUE

# PRELIMINARY

CLIENT:



PROJECT MANAGER:



CONSULTING PTY LTD  
CIVIL AND HYDRAULIC  
ENGINEERING DESIGN AND  
PROJECT MANAGEMENT  
SUITE 26  
12-13 BROOKHOLLOW AVE  
BAULKHAM HILLS NSW 2153  
PHONE: (02) 9680 3100  
FAX: (02) 9634 6989  
ABN 21 118 134 240

CONSULTING ENGINEERS PTY LTD  
CIVIL AND HYDRAULIC  
ENGINEERING DESIGN AND  
PROJECT MANAGEMENT  
SUITE 26  
12-13 BROOKHOLLOW AVE  
BAULKHAM HILLS NSW 2153  
PHONE: (02) 9680 3100  
FAX: (02) 9634 6989  
ABN 21 118 134 240

PROJECT  
TITLE  
**COFFS HARBOUR HEALTH CAMPUS**  
**GENERAL ARRANGEMENT PLAN**  
**STAGE 1 - SHEET 2**

DESIGNED	T.T.	DATE	16.04.14
VERIFIED	A.M.	DATE	16.04.14
DRAWN	T.T.	SCALE @ AS	1:200
STATUS	DA / SD		
DRAWING NO.	01094_C202		REVISION 01

LOT 102  
DP 1077682

319.58

R2-3 (L)

PHIL HAWTHORNE DRIVE

DRIVE  
PHIL HAWTHORNE DRIVE

SEALED SEWER  
NO ACCESS



REV.	DES.	VER.	DATE	DESCRIPTION
01	T.T.	A.M.	25.06.14	PRELIMINARY ISSUE

**PRELIMINARY**

CLIENT:



PROJECT MANAGER
-----------------



CIVIL AND HYDRAULIC  
ENGINEERING DESIGN AND  
PROJECT MANAGEMENT

SUITE 26  
11 - 13 BROOKHOLLOW AV  
BAULKHAM HILLS NSW 215  
PHONE: (02) 9680 3100  
FAX: (02) 9634 6989  
ABN 21 118 134 240

© THIS DRAWING AND DESIGN IS THE COPYRIGHT OF C&M CONSULTING ENGINEERS PTY. LTD. NO PART OF THIS DRAWING OR DESIGN SHALL

PROJECT	COFFS HARBOUR HEALTH CAMPUS
---------	-----------------------------

CONTINUED	TITLE
	GENERAL ARRANGEMENT PLAN STAGE 1 - SHEET 3

DESIGNED	T.T.	DATE	16.04.14
VERIFIED	A.M.	DATE	16.04.14
DRAWN	T.T.	SCALE @ A0	1:200

STATUS	DA / SD
--------	---------

DRAWING No.	01094 C203	REVISION
-------------	------------	----------

FOR CONTINUATION REFER C203

FOR CONTINUATION REFER C203

CAD FILENAME: D:\C:\Users\10101\Documents\10101 - Coff's Harbour Health Campus - Car Park Project\ACAD\DWG\DWG\_C201.dwg

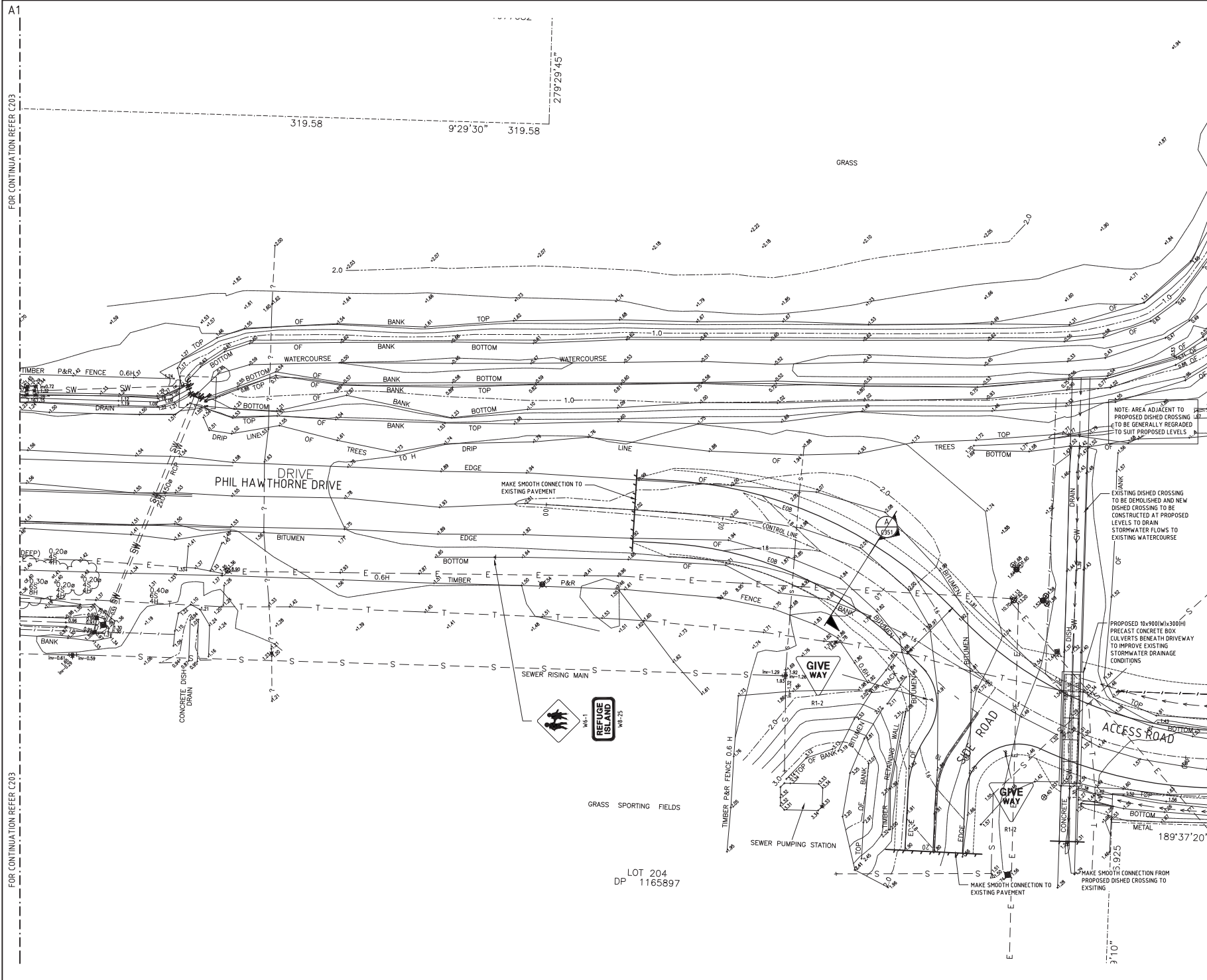

REV.	DES.	VER.	DATE	DESCRIPTION
01	T.T.	A.M.	25.06.14	PRELIMINARY ISSUE

# PRELIMINARY

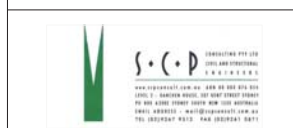

PROJECT: COFFS HARBOUR HEALTH CAMPUS  
TITLE: GENERAL ARRANGEMENT PLAN  
STAGE 1 - SHEET 4

DESIGNED	T.T.	DATE	16.04.14
VERIFIED	A.M.	DATE	16.04.14
DRAWN	T.T.	SCALE	NA
STATUS	DA / SD		
DRAWING NO.	01094_C204		REVISION 01



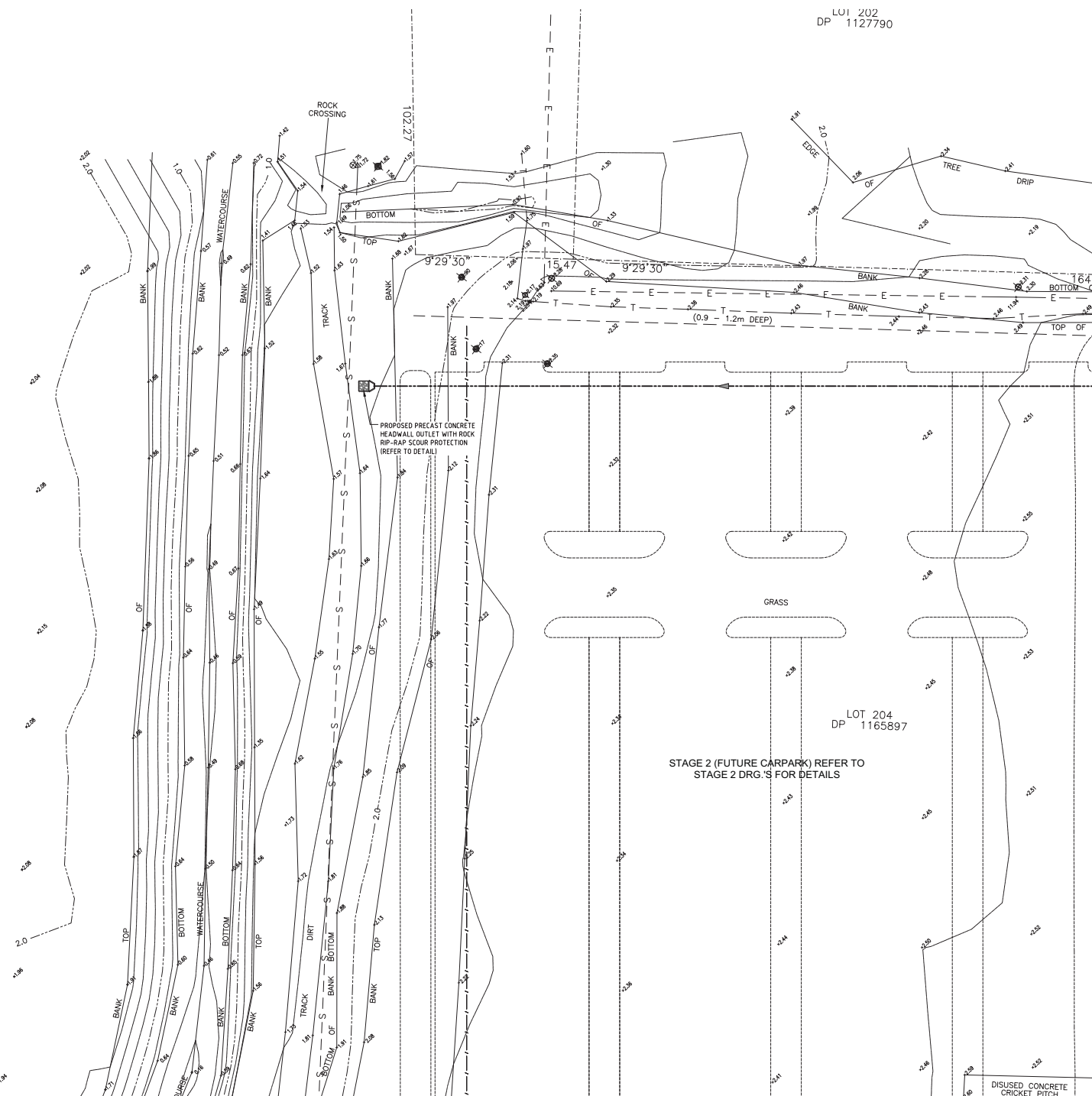

FOR CONTINUATION REFER C207

FOR CONTINUATION REFER C207

REV.	DES.	VER.	DATE	DESCRIPTION
01	T.T.	A.M.	25.06.14	PRELIMINARY ISSUE

# PRELIMINARY

CLIENT:

**Health**

Infrastructure

PROJECT MANAGER:

CONSULTING PTY LTD  
(GOLD AND STRUCTURAL)  
ENGINEERS

[www.scp-engineers.com.au](http://www.scp-engineers.com.au) 200 555 555 555  
LEVEL 1, BARKHAM HOUSE, 100 BENT STREET, SYDNEY  
NSW 2000 (PHONE) 002 958 700 000 (FACSIMILE)  
EMAIL: [info@scponstruct.com.au](mailto:info@scponstruct.com.au)  
TEL: (002) 958 700 000 FAX: (002) 958 700 001

**CIVIL AND HYDRAULIC  
ENGINEERING DESIGN AND  
PROJECT MANAGEMENT**

SUITE 26  
11 - 13 BROOKHOLLOW AVE  
BAULKHAM HILLS NSW 2153

PHONE: (02) 9680 3100  
FAX: (02) 9634 6989  
ABN 21 116 134 240

© THIS DRAWING AND DESIGN IS THE COPYRIGHT OF C&M CONSULTING ENGINEERS PTY. LTD. NO PART OF THIS DRAWING OR DESIGN SHALL BE REPRODUCED OR USED WITHOUT PRIOR WRITTEN CONSENT FROM C&M CONSULTING ENGINEERS PTY. LTD.

PROJECT: **COFFS HARBOUR HEALTH CAMPUS**

TITLE: **GENERAL ARRANGEMENT PLAN  
STAGE 1 - SHEET 5**

DESIGNED	DATE
T.T.	16.04.14
VERIFIED	DATE
A.M.	16.04.14
DRAWN	SCALE @ AS
T.T.	NA
STATUS	DA / SD

DRAWING No. 01094\_C205

REVISION 01

FOR CONTINUATION REFER C207

FOR CONTINUATION REFER C207

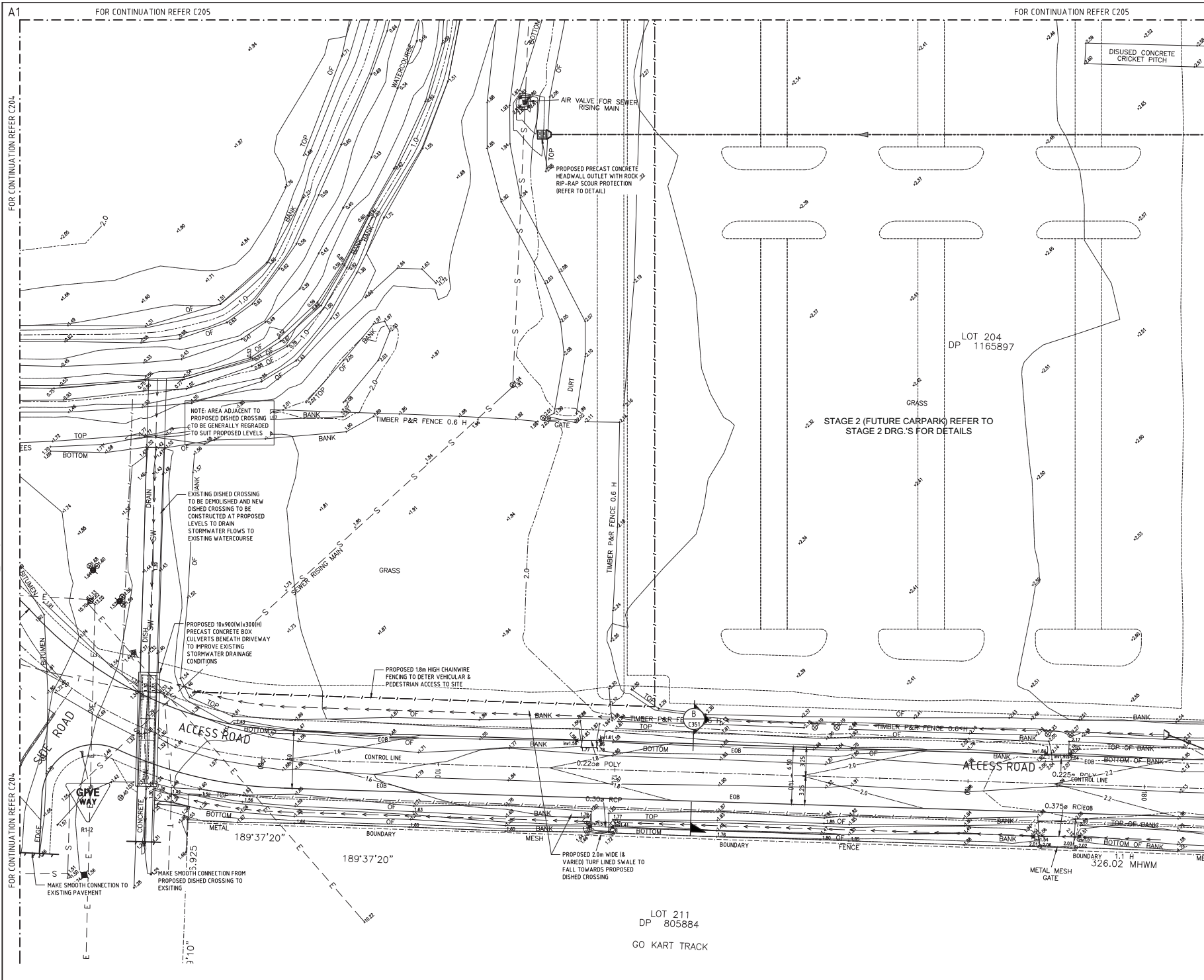

REV.	DES.	VER.	DATE	DESCRIPTION
01	T.T.	A.M.	25.06.14	PRELIMINARY ISSUE

## PRELIMINARY

CLIENT:

PROJECT MANAGER:

CIVIL AND HYDRAULIC ENGINEERING DESIGN AND PROJECT MANAGEMENT

SUITE 26  
12 - 13 BROOKHOLLOW AVE  
BAULKHAM HILLS NSW 2153

PHONE: (02) 9680 3100  
FAX: (02) 9634 6989  
ABN 21 118 134 240

© THIS DRAWING AND DESIGN IS THE COPYRIGHT OF CAM CONSULTING ENGINEERS PTY. LTD. NO PART OF THIS DRAWING OR DESIGN SHALL BE REPRODUCED OR USED WITHOUT PRIOR WRITTEN CONSENT FROM CAM CONSULTING ENGINEERS PTY. LTD.

PROJECT: **COFFS HARBOUR HEALTH CAMPUS**

TITLE: **GENERAL ARRANGEMENT PLAN  
STAGE 1 - SHEET 6**

DESIGNED	T.T.	DATE	16.04.14
VERIFIED	A.M. <td>DATE</td> <td>16.04.14</td>	DATE	16.04.14
DRAWN	T.T. <td>SCALE @ A3</td> <td>NA</td>	SCALE @ A3	NA

STATUS: DA / SD

DRAWING NO.	01094_C206	REVISION	01
-------------	------------	----------	----

CAD FILE NAME: C:\Users\Projects\01094\01094.dwg - Cofts Harbour Health Campus - Car Park Project\ACAD\DWG\01094\_C206.dwg

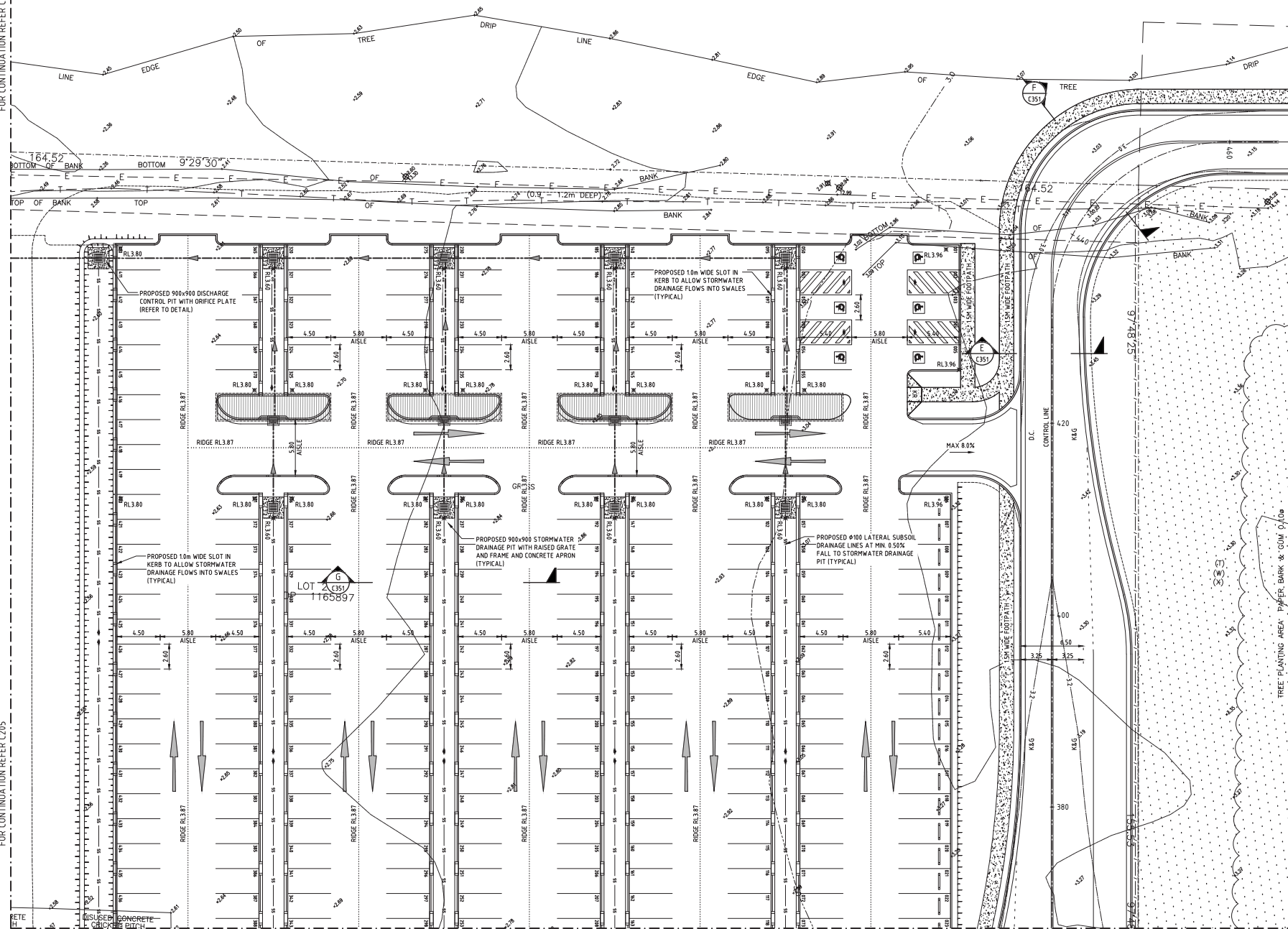

NOTE:  
"ENVIROPOD" WITH 200um FILTER TO BE  
INSTALLED IN ALL GRATED INLET PITS  
WITHIN CARPARKING AREA

LOT 202  
DP 1127790

REV.	DES.	VER.	DATE	DESCRIPTION
02	T.T.	A.M.	01.07.14	DISABLED PARKING ADDED
01	T.T.	A.M.	25.06.14	PRELIMINARY ISSUE

PRELIMINARY

CLIENT:

 **Health**  
Infrastructure

[illegible]

**CIVIL AND HYDRAULIC  
ENGINEERING DESIGN AND  
PROJECT MANAGEMENT**

SUITE 26  
11 - 13 BROOKHOLLOW AVE  
BAULKHAM HILLS NSW 2153

PHONE: (02) 9680 3100  
FAX: (02) 9634 6989

ABN 21 118 134 240

CONTINUATION	PROJECT	COFFS HARBOUR HEALTH CAMPUS
	TITLE	GENERAL ARRANGEMENT PLAN STAGE 1 - SHEET 7

DESIGNED	T.T.	DATE	16.04.14
VERIFIED	A.M.	DATE	16.04.14
DRAWN	T.T.	SCALE @ A0	NA
STATUS		DA / SD	
DRAWING No.	01094_C207	REVISION	02



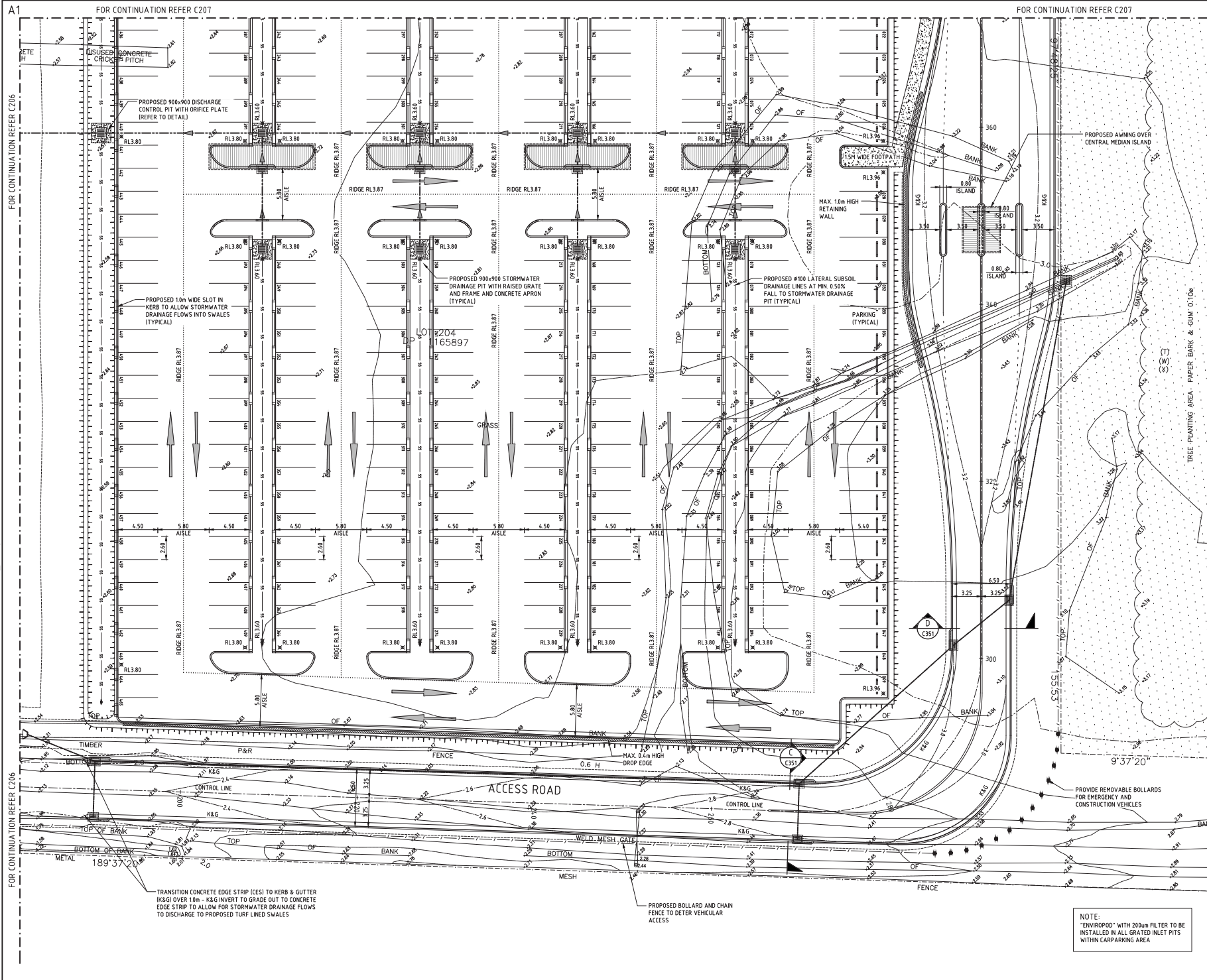

REV.	DES.	VER.	DATE	DESCRIPTION
01	T.T.	A.M.	25.06.14	PRELIMINARY ISSUE

# PRELIMINARY



**CAM CONSULTING ENGINEERS**

CIVIL AND HYDRAULIC  
ENGINEERING DESIGN AND  
PROJECT MANAGEMENT

SUITE 26  
12 - 13 BROOKHOLLOW AVE  
BAULKHAM HILLS NSW 2153

PHONE: (02) 9680 3100  
FAX: (02) 9634 6989  
ABN 21 118 134 240

C THIS DRAWING AND DESIGN IS THE COPYRIGHT OF CAM CONSULTING ENGINEERS PTY. LTD. NO PART OF THIS DRAWING OR DESIGN SHALL BE REPRODUCED OR USED WITHOUT PRIOR WRITTEN CONSENT FROM CAM CONSULTING ENGINEERS PTY. LTD.

PROJECT  
TITLE  
**COFFS HARBOUR HEALTH CAMPUS**  
**GENERAL ARRANGEMENT PLAN**  
**STAGE 1 - SHEET 8**

DESIGNED	T.T.	DATE	16.04.14
VERIFIED	A.M.	DATE	16.04.14
DRAWN	T.T.	SCALE	AS SHOWN
STATUS	DA / SD		
DRAWING NO.	01094_C208		
REVISION	01		

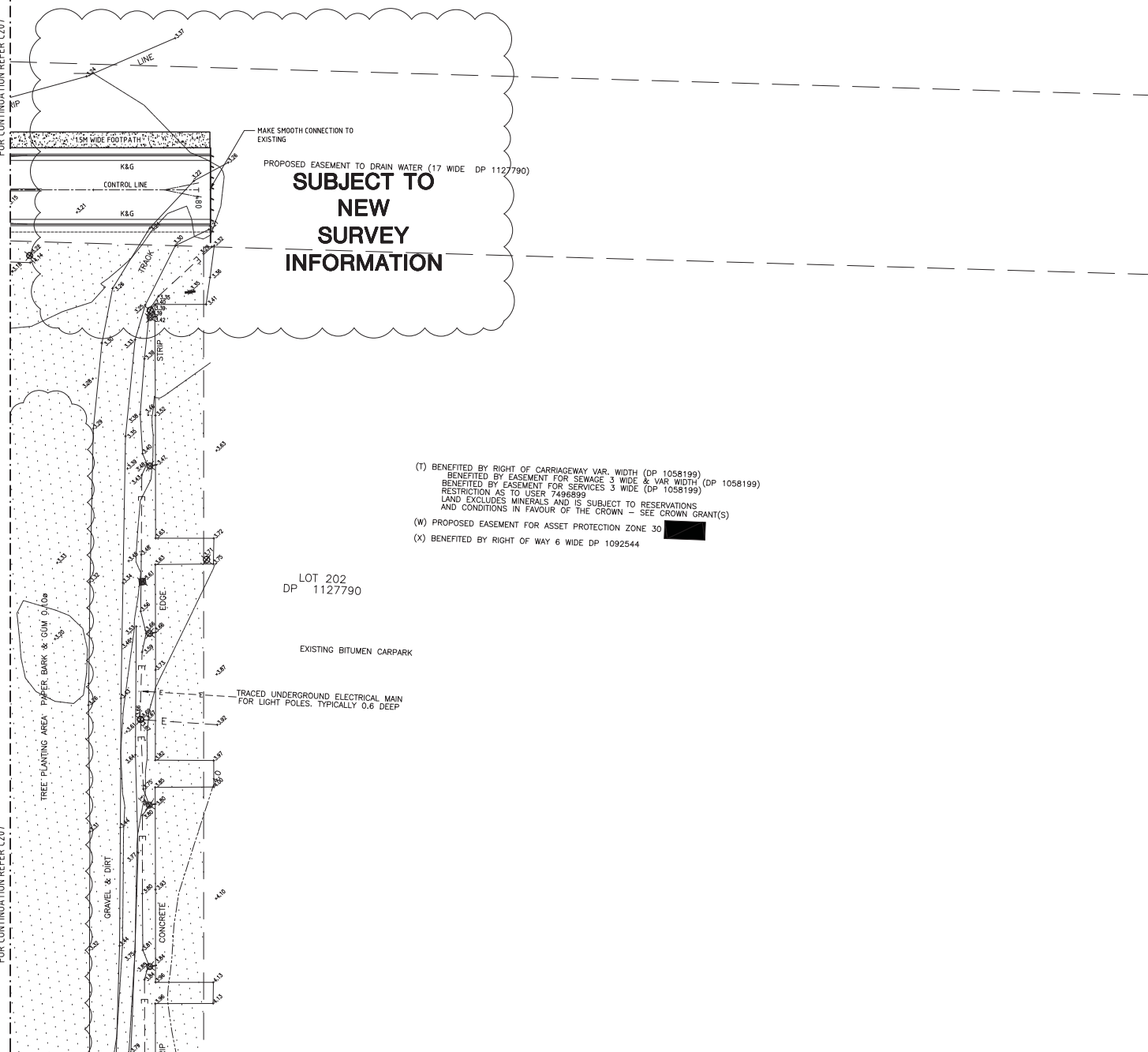

REV.	DES.	VER.	DATE	DESCRIPTION
01	T.T	A.M	25.06.14	PRELIMINARY ISSU

# PRELIMINARY

CLIENT:



	PROJECT MANAGER



**CIVIL AND HYDRAULIC  
ENGINEERING DESIGN AND  
PROJECT MANAGEMENT**

**SUITE 26  
11 - 13 BROOKHOLLOW AV  
BAULKHAM HILLS NSW 215**

**PHONE: (02) 9680 3100  
FAX: (02) 9634 6989**

**ABN 21 118 134 240**

© THIS DRAWING AND DESIGN IS THE COPYRIGHT OF C&M CONSULTING ENGINEERS PTY. LTD. NO PART OF THIS DRAWING OR DESIGN SHALL BE REPRODUCED OR USED WITHOUT PRIOR WRITTEN CONSENT FROM C&M

PROJECT	COFFS HARBOUR HEALTH CAMPUS
---------	-----------------------------

TITLE	GENERAL ARRANGEMENT PLAN STAGE 1 - SHEET 9
-------	---

DESIGNED	T.T.	DATE	16.04.14
VERIFIED	A.M.	DATE	16.04.14
DRAWN	T.T.	SCALE @ A0	NA

STATUS	DA / SD
--------	---------

DRAWING No.	01094 C209	REVISION	01
-------------	------------	----------	----



NOTE:  
"ENVIROPOD" WITH 200µm FILTER TO BE  
INSTALLED IN ALL GRATED INLET PITS  
WITHIN CARPARKING AREA

REV.	DES.	VER.	DATE	DESCRIPTION
01	T.T.	A.M.	25.06.14	PRELIMINARY ISSUE

# PRELIMINARY

CLIENT:



PROJECT MANAGER:



CIVIL AND HYDRAULIC  
ENGINEERING DESIGN AND  
PROJECT MANAGEMENT

SUITE 26  
21-23 BROOKHOLLOW AVE  
BAULKHAM HILLS NSW 2153

PHONE: (02) 9680 3100  
FAX: (02) 9634 6989  
ABN 21 118 134 240

PROJECT COFFS HARBOUR HEALTH CAMPUS

TITLE  
GENERAL ARRANGEMENT PLAN  
STAGE 2 - SHEET 1

DESIGNED	T.T.	DATE	16.04.14
VERIFIED	A.M.	DATE	16.04.14
DRAWN	T.T.	SCALE @ A0	1:200
STATUS	DA / SD		
DRAWING NO.	01094_C210		
REVISION	01		

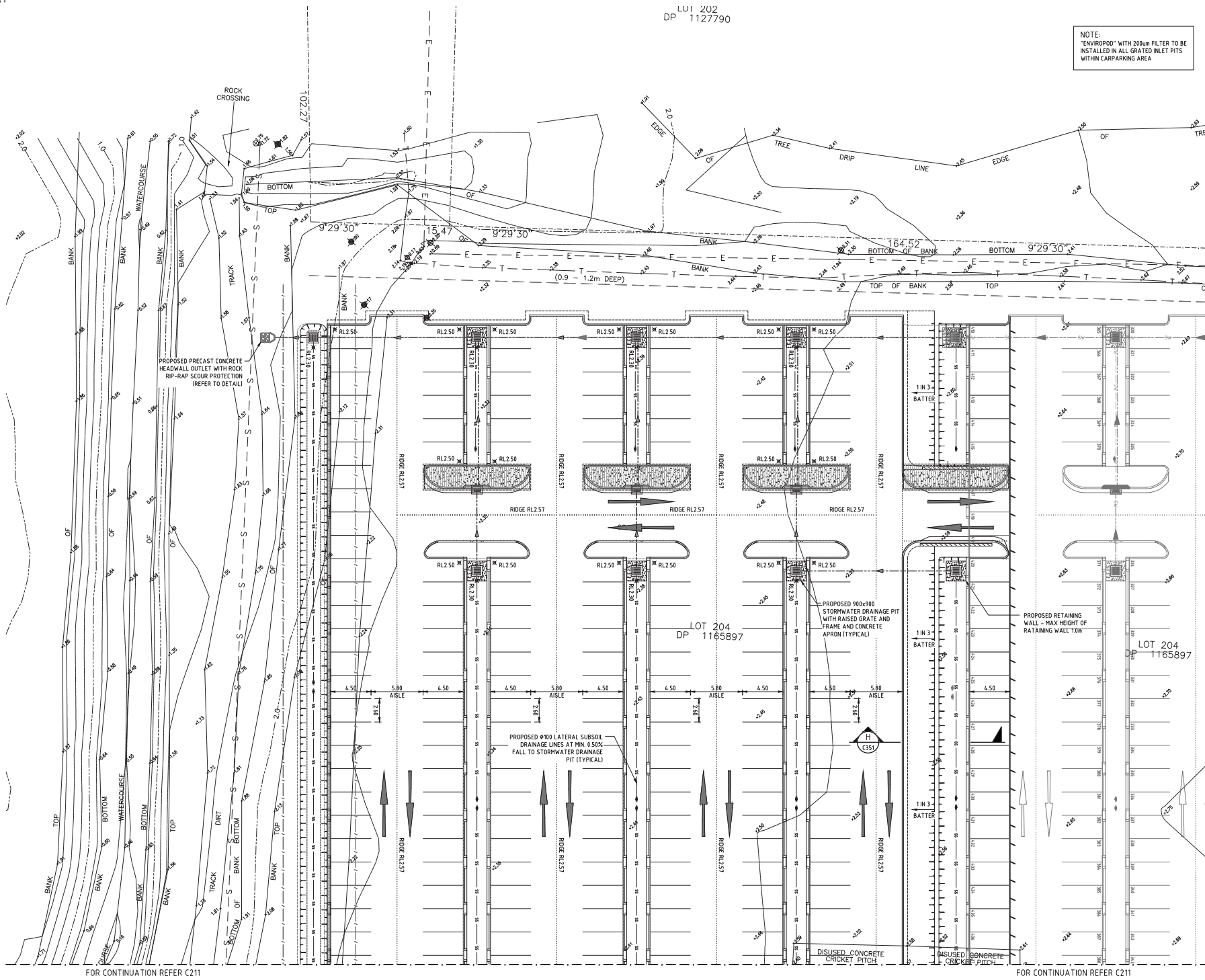

FOR CONTINUATION REFER C211

FOR CONTINUATION REFER C211

A1

FOR CONTINUATION REFER C210

FOR CONTINUATION REFER C210

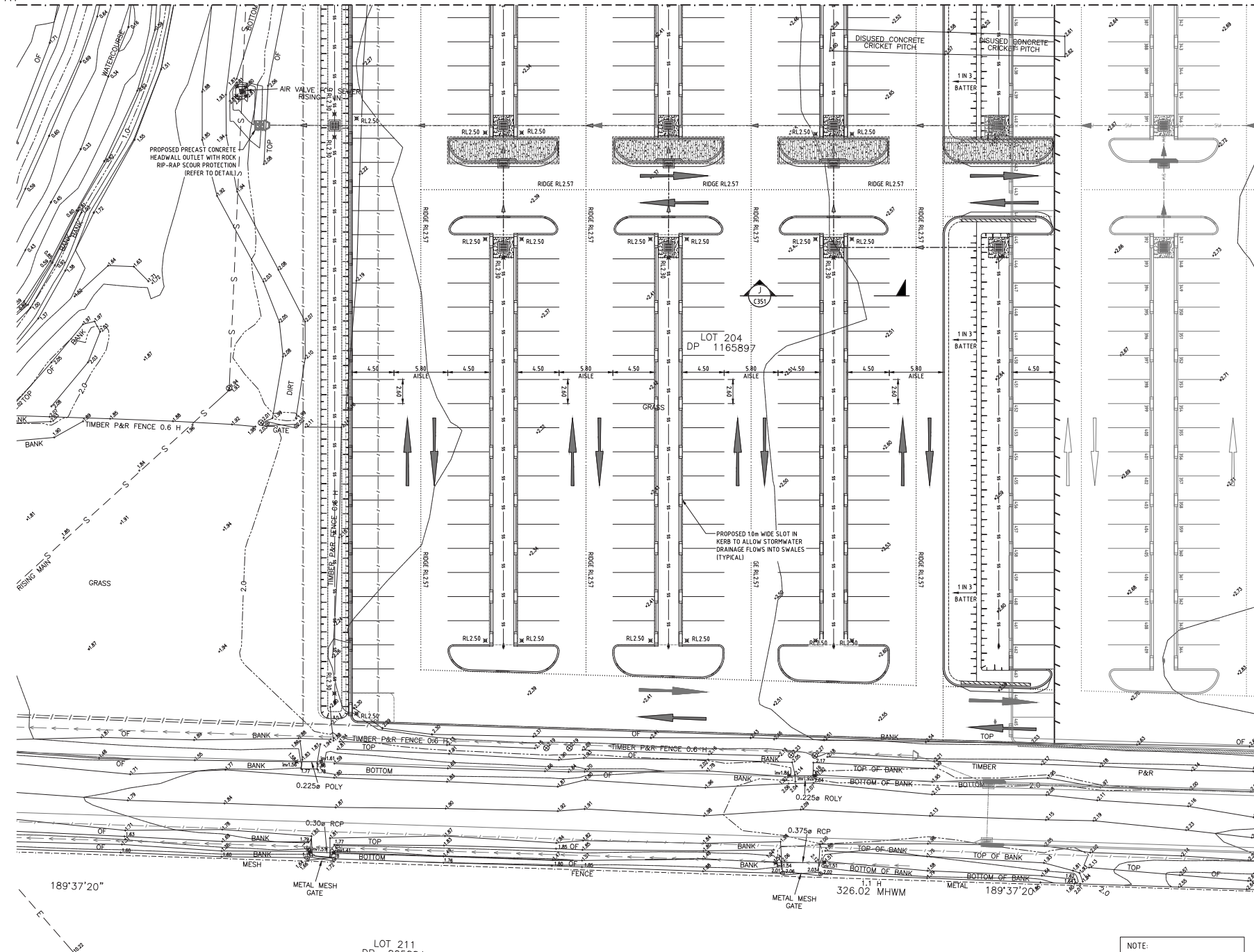

LOT 211  
DP 805884  
GO KART TRACK

NOTE:  
"ENVIROPOD" WITH 200µm FILTER TO BE  
INSTALLED IN ALL GRATED INLET PITS  
WITHIN CARPARKING AREA

REV.	DES.	VER.	DATE	DESCRIPTION
01	T.T.	A.M.	25.06.14	PRELIMINARY ISSUE

# PRELIMINARY

CLIENT:



PROJECT MANAGER:



CIVIL AND HYDRAULIC  
ENGINEERING DESIGN AND  
PROJECT MANAGEMENT

SUITE 26  
11-13 BROOKHOLLOW AVE  
BAULKHAM HILLS NSW 2153

PHONE: (02) 9680 3100  
FAX: (02) 9634 6989  
ABN 21 118 134 240

PROJECT: COFFS HARBOUR HEALTH CAMPUS

TITLE  
GENERAL ARRANGEMENT PLAN  
STAGE 2 - SHEET 2

DESIGNED	T.T.	DATE	16.04.14
VERIFIED	A.M.	DATE	16.04.14
DRAWN	T.T.	SCALE	1:200

STATUS: DA / SD

DRAWING No. 01094\_C211

REVISION 01

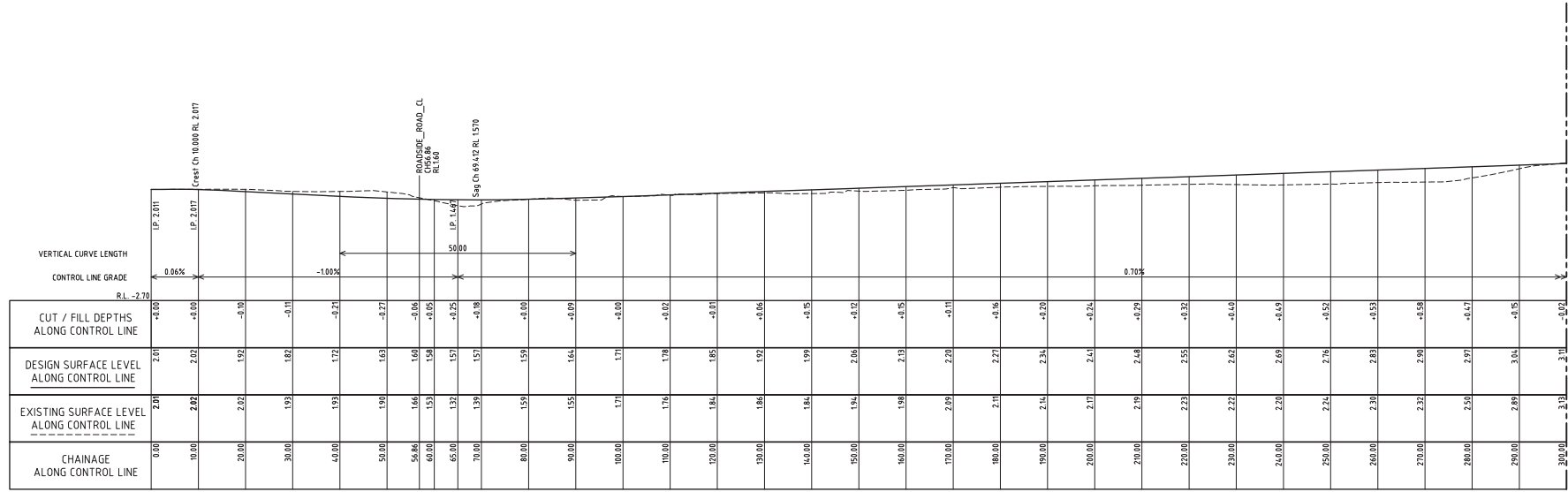
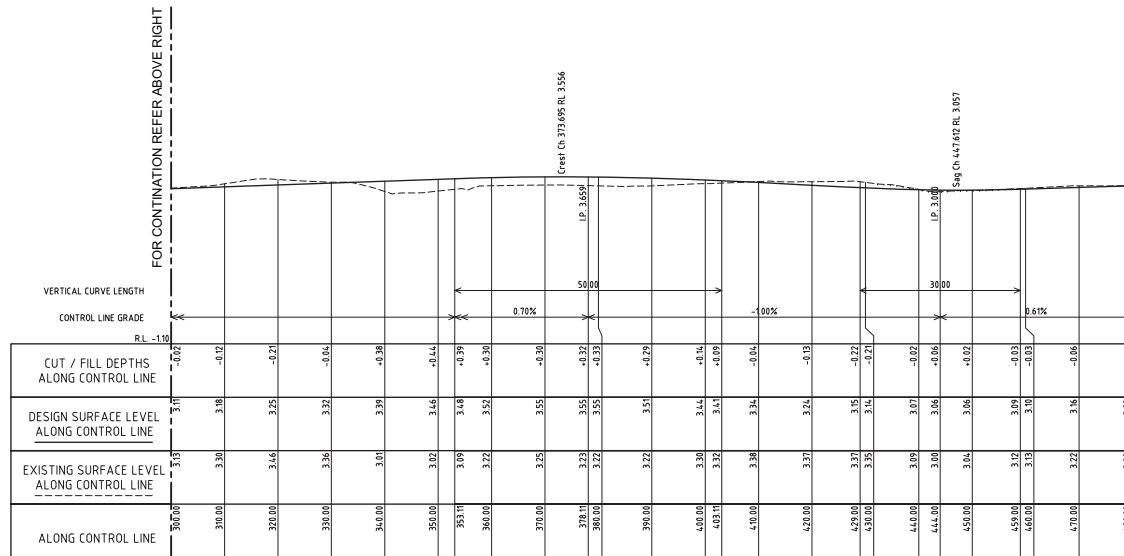

ROAD LONGITUDINAL SECTION ALONG RIDE ROAD CONTROL  
SCALE 1:500 (H) & 1:100 (V)

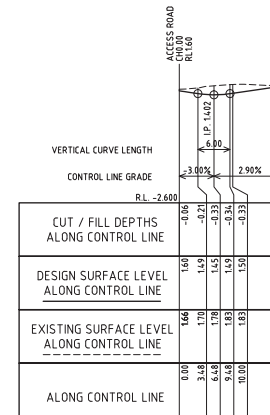

REV.	DES.	VER.	DATE	DESCRIPTION
01	T.T.	A.M.	25.06.14	PRELIMINARY ISSUE

# PRELIMINARY

CLIENT:

PROJECT MANAGER:

CIVIL AND HYDRAULIC ENGINEERING DESIGN AND PROJECT MANAGEMENT

SUITE 26  
11-13 BROOKHOLLOW AVE  
BAULKHAM HILLS NSW 2153

PHONE: (02) 9680 3100  
FAX: (02) 9634 6989  
ABN 21 118 134 240

PROJECT TITLE: COFFS HARBOUR HEALTH CAMPUS

ROAD LONGITUDINAL SECTIONS

DESIGNED	DATE
T.T.	16.04.14

VERIFIED	DATE
A.M.	16.04.14

DRAWN	SCALE
T.T.	SCALE @ A0

STATUS	DA / SD
DA / SD	

DRAWING No.	01094_C301	REVISION	01

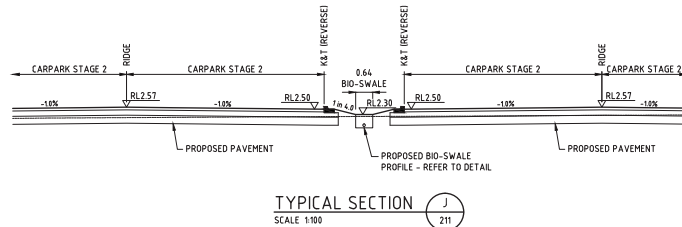
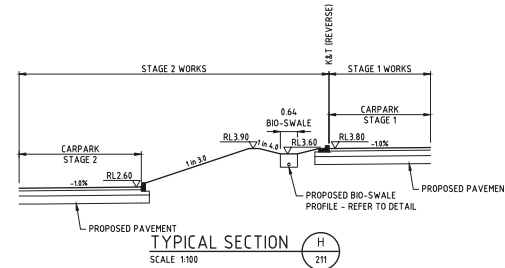
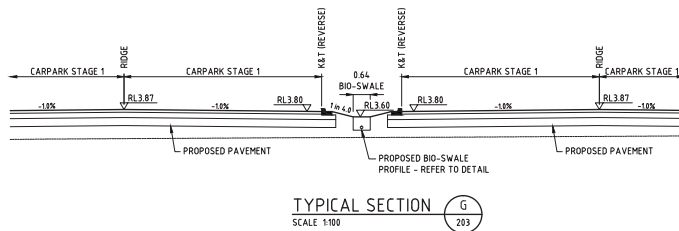
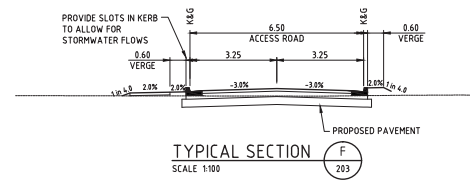
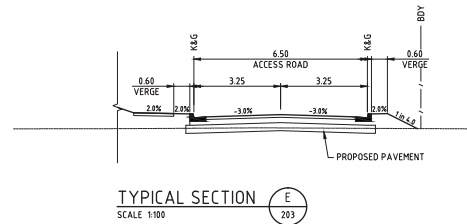
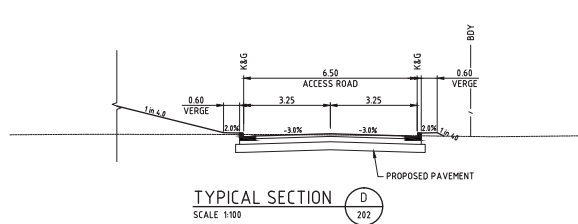
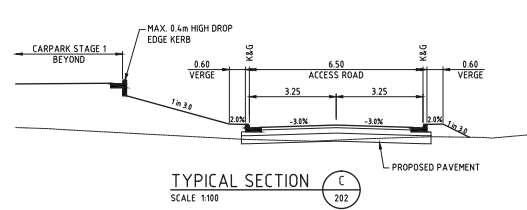
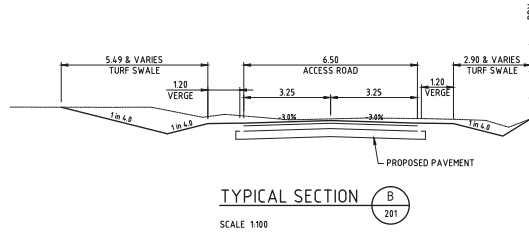
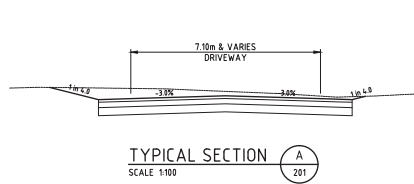

REV.	DES.	VER.	DATE	DESCRIPTION
01	T.T.	A.M.	25.06.14	PRELIMINARY ISSUE

# PRELIMINARY

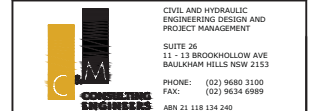

CIVIL AND HYDRAULIC  
ENGINEERING DESIGN AND  
PROJECT MANAGEMENT

SUITE 26  
11-13 BROOKHOLLOW AVE  
BAULKHAM HILLS NSW 2153

PHONE: (02) 9680 3100  
FAX: (02) 9634 6989  
ABN 21 118 134 240

PROJECT: COFFS HARBOUR HEALTH CAMPUS

TITLE: TYPICAL SECTIONS

DESIGNED	T.T.	DATE	16.04.14
VERIFIED	A.M.	DATE	16.04.14
DRAWN	T.T.	SCALE @ A3	1:100 (NAT.)
STATUS: DA / SD			
DRAWING No.	01094_C351	REVISION	01

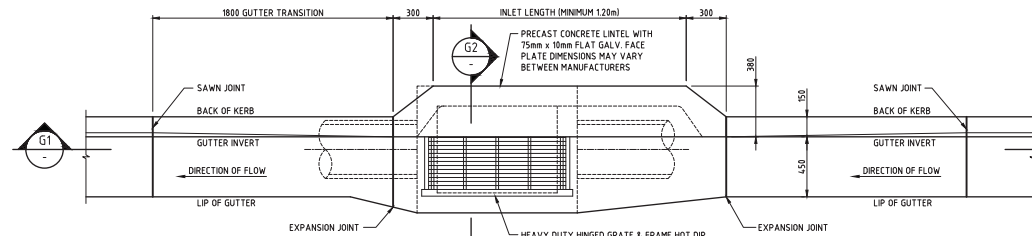

STANDARD GRATED GULLY PIT (ON-GRADE) - PLAN

SCALE 120

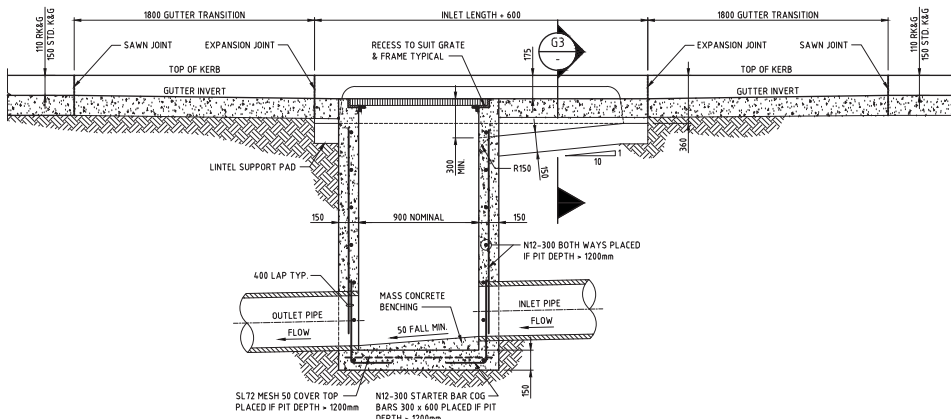

SECTION G1 FOR PIT DEPTHS < 1800mm  
SCALE 120 REFER STORMWATER PIT NOTES

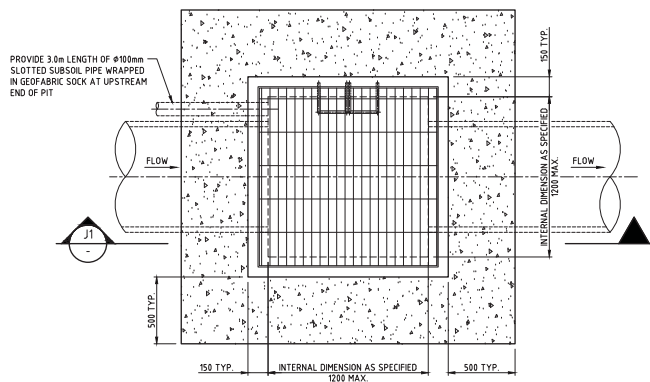

SURCHARGE STORMWATER PIT DETAIL - PLAN

SCALE 120

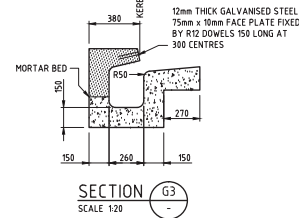

SECTION G3  
SCALE 120

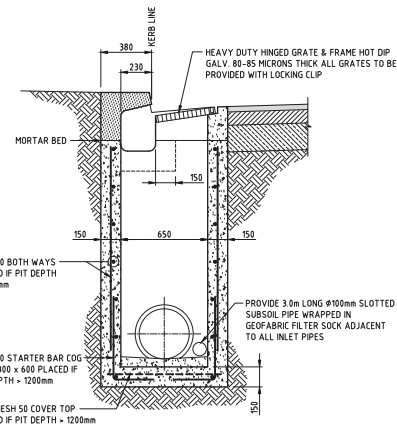

SECTION G2 FOR PIT DEPTHS < 1800mm  
SCALE 120 REFER STORMWATER PIT NOTES

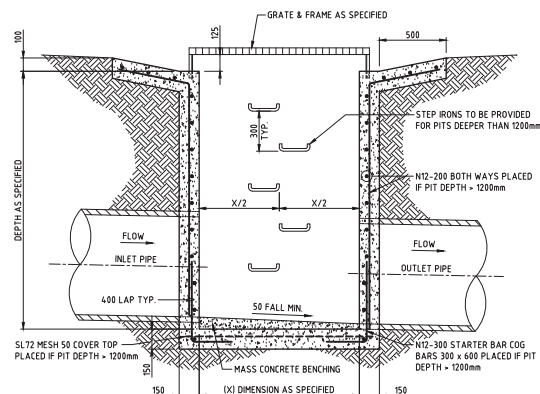

SECTION J1  
SCALE 120

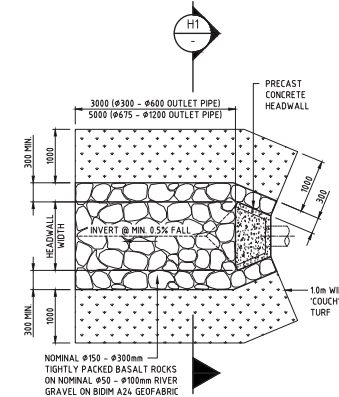

TYPICAL PRECAST CONCRETE HEADWALL  
WITH SCOUR PROTECTION DETAIL - PLAN

SCALE 150

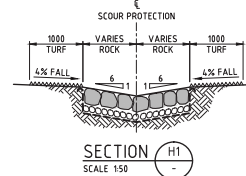

SECTION H1  
SCALE 150

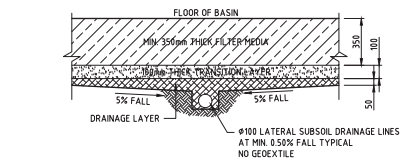

TYPICAL BIO RETENTION PROFILE  
SCALE 120

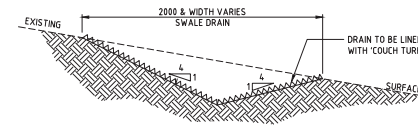

TYPICAL TURF LINED SWALE DRAIN  
SCALE 120

REV.	DES.	VER.	DATE	DESCRIPTION
01	T.T.	A.M.	25.06.14	PRELIMINARY ISSUE

# PRELIMINARY

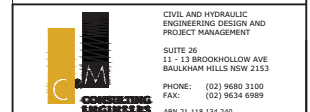

CIVIL AND HYDRAULIC  
ENGINEERING DESIGN AND  
PROJECT MANAGEMENT  
SUITE 26  
11-13 BROOKHOLLOW AVE  
BAULKHAM HILLS NSW 2153  
PHONE: (02) 9680 3100  
FAX: (02) 9634 6989  
ABN 21 118 134 240

© THIS DRAWING AND DESIGN IS THE COPYRIGHT OF C&D CONSULTING ENGINEERS PTY LTD. NO PART OF THIS DRAWING OR DESIGN SHALL BE REPRODUCED OR USED WITHOUT PRIOR WRITTEN CONSENT FROM C&D CONSULTING ENGINEERS PTY LTD.

PROJECT COFFS HARBOUR HEALTH CAMPUS

TITLE GENERAL DETAILS  
SHEET 1

DESIGNED	T.T.	DATE	16.04.14
VERIFIED	A.M.	DATE	16.04.14
DRAWN	T.T.	SCALE	AS NOTED

STATUS DA / SD

DRAWING No.	01094_C501	REVISION	01
-------------	------------	----------	----



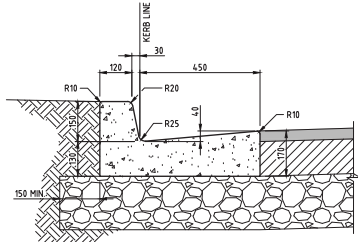

KERB & GUTTER (K&G)  
SCALE 1:10

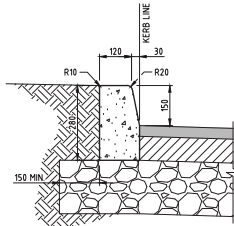

KERB ONLY (K.O.)  
SCALE 1:10

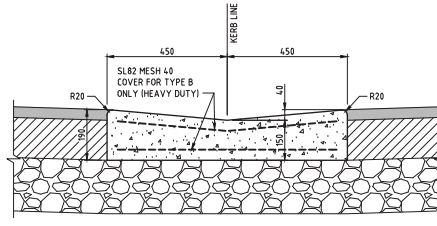

DISHD CROSSING (D.C.)  
SCALE 1:10

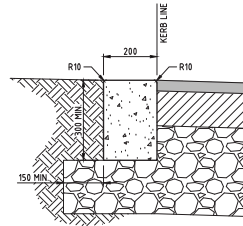

CONCRETE EDGE STRIP (C.E.S.)  
SCALE 1:10

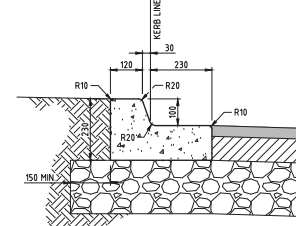

KERB & TOE (K&T)  
SCALE 1:10

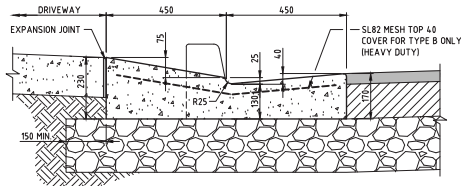

DRIVEWAY LAYBACK (V.C.)  
SCALE 1:10

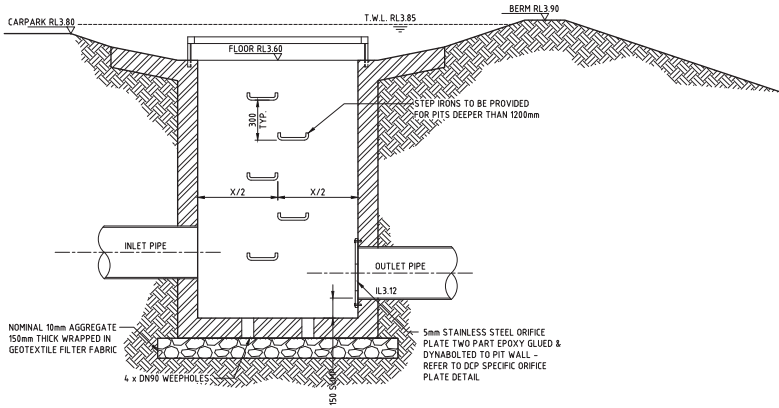

SECTION - TYPICAL DISCHARGE CONTROL  
SCALE 1:20 PIT (DCP)

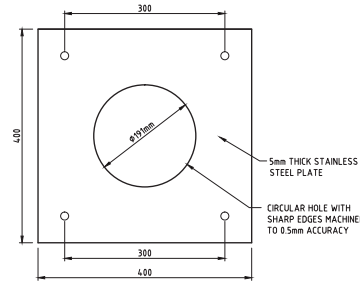

ORIFICE PLATE DETAIL - DCP No.1 (WESTERN)  
SCALE 1:5

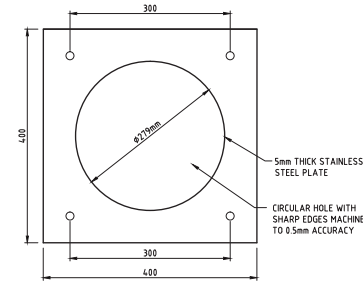

ORIFICE PLATE DETAIL - DCP No.2 (EASTERN)  
SCALE 1:5

REV.	DES.	VER.	DATE	DESCRIPTION
01	T.T.	A.M.	25.06.14	PRELIMINARY ISSUE

## PRELIMINARY

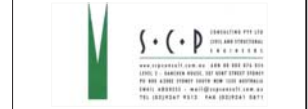

PROJECT: COFFS HARBOUR HEALTH CAMPUS

TITLE: GENERAL NOTES  
SHEET 2

DESIGNED	T.T.	DATE	16.04.14
VERIFIED	A.M.	DATE	16.04.14
DRAWN	T.T.	SCALE	AS NOTED
STATUS	DA / SD		
DRAWING No.	01094_CS02		REVISION 01



**ENVIRONMENTAL CONTROL NOTES:****EROSION AND SEDIMENT CONTROL**

1. THE CONTRACTOR SHALL BE SOLELY RESPONSIBLE FOR THE CONTROL OF EROSION AND SEDIMENTATION TO THE SATISFACTION OF COUNCIL. THE RELEVANT STATE AUTHORITIES AND THE SUPERINTENDENT. TO THIS END, THE EROSION AND SEDIMENTATION CONTROLS SHOWN ON THE DRAWINGS SHALL ONLY BE USED AS A GUIDE BY THE CONTRACTOR, AND SHALL REPRESENT THE MINIMUM REQUIREMENT ONLY.
2. NO CONSTRUCTION WORKS ARE TO COMMENCE ON SITE UNTIL ALL EROSION AND SEDIMENT CONTROL MEASURES ARE IN PLACE AND HAVE BEEN INSPECTED AND APPROVED BY THE COUNCIL ENGINEER AND/OR SUPERINTENDENT.
3. ALL EROSION AND SEDIMENT CONTROL MEASURES SHALL BE REGULARLY INSPECTED, IN PARTICULAR AFTER STORMS, AND REPAIRED OR MAINTAINED AS REQUIRED TO ENSURE THE MEASURES CORRECT AND EFFICIENT FUNCTION THROUGHOUT THE DURATION OF THE WORKS, UNTIL SUCH TIME AS THE COUNCIL ENGINEER AND/OR SUPERINTENDENT AUTHORISES THE REMOVAL OF SUCH MEASURES.
4. ALL STOCKPILES SHALL BE CLEAR OF ALL TREES AND DRAINAGE LINES (INCLUDING OVERLAND FLOW PATHS) AND PROTECTED FROM EROSION.
5. IN THE CASE OF THE TEMPORARY CONSTRUCTION EXIT, THE CONTRACTOR SHALL UNDERTAKE WEEKLY SURFACE CLEANING BY DRAG BROOM OR EQUIVALENT, TO REMOVE ALL BUILD UP OF FOREIGN MATERIAL TO THE SATISFACTION OF THE SUPERINTENDENT.







**TRAFFIC CONTROLS**

1. THE CONTRACTOR SHALL BE SOLELY RESPONSIBLE FOR THE CONTROL OF TRAFFICS INCLUDING VEHICLES AND PEDESTRIANS TO THE SATISFACTION OF COUNCIL, THE RELEVANT STATE AUTHORITIES AND THE SUPERINTENDENT.
2. THE CONTRACTOR IS TO PREPARE A TRAFFIC MANAGEMENT PLAN TO THE REQUIREMENTS OF THE RMS - TRAFFIC CONTROL AT WORK SITE, AS 1742 - AUSTRALIAN STANDARD MANUAL OF UNIFORM TRAFFIC CONTROL DEVICES, AND LOCAL COUNCIL STANDARDS.

**OTHER ENVIRONMENTAL CONTROLS**

1. OTHER ENVIRONMENTAL CONTROLS LIKE NOISE, DUST, VIBRATION, FLORA & FAUNA, FIRE, HAZMAT, AND CONTAMINATIONS MUST BE CONTROLLED TO THE REQUIREMENT OF THE COUNCIL AND THE RELEVANT STATE AUTHORITIES.

**LEGEND**

-  SEDIMENT FENCE
-  GEOTEXTILE INLET FILTER (FOR PITS WITHIN LANDSCAPED AREAS)
-  MESH & GRAVEL INLET FILTER
-  MESH & GRAVEL KERB FILTER
-  STRAW BALE FILTER
-  STABILISED SITE ACCESS

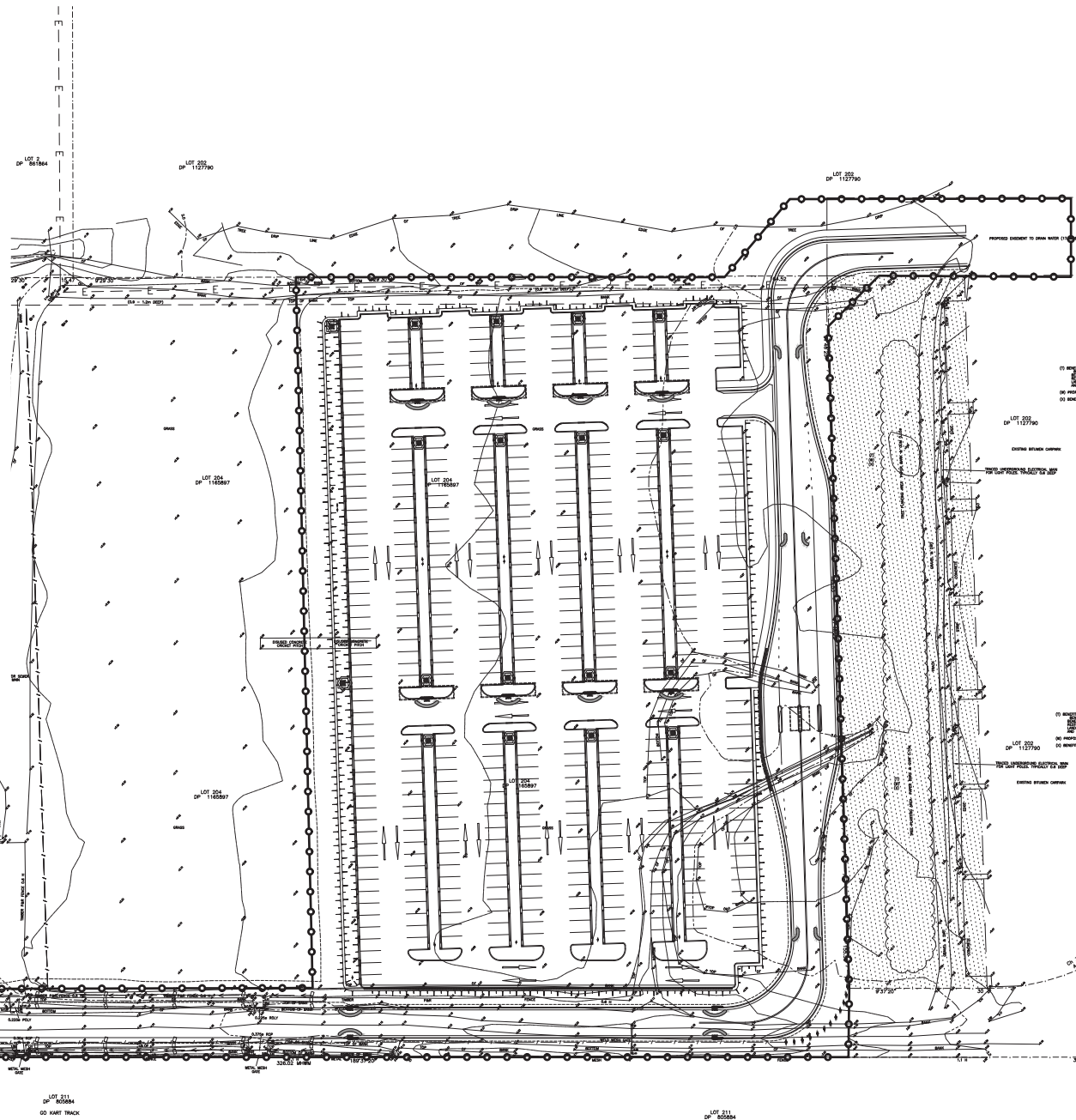



## EROSION AND SEDIMENT CONTROL

1. THE CONTRACTOR SHALL BE SOLELY RESPONSIBLE FOR THE CONTROL OF EROSION AND SEDIMENTATION TO THE SATISFACTION OF COUNCIL, THE RELEVANT STATE AUTHORITIES AND THE SUPERINTENDENT. TO THIS END, THE EROSION AND SEDIMENTATION CONTROLS SHOWN ON THE DRAWINGS SHALL ONLY BE USED AS A GUIDE BY THE CONTRACTOR, AND SHALL REPRESENT THE MINIMUM REQUIREMENT ONLY.
2. NO CONSTRUCTION WORKS ARE TO COMMENCE ON SITE UNTIL ALL EROSION AND SEDIMENT CONTROL MEASURES ARE IN PLACE AND HAVE BEEN INSPECTED AND APPROVED BY THE COUNCIL ENGINEER AND/OR SUPERINTENDENT.
3. ALL EROSION AND SEDIMENT CONTROL MEASURES SHALL BE REGULARLY INSPECTED, IN PARTICULAR AFTER STORMS, AND REPAIRED OR MAINTAINED AS REQUIRED TO ENSURE THE MEASURES ARE CORRECT AND EFFICIENT FUNCTION THROUGHOUT THE DURATION OF THE WORKS. UNTIL SUCH TIME AS THE COUNCIL ENGINEER AND/OR SUPERINTENDENT AUTHORIZES THE REMOVAL OF SUCH MEASURES.
4. ALL STOCKPILES SHALL BE CLEAR OF ALL TREES AND DRAINAGE LINES (INCLUDING OVERLAND FLOW PATHS) AND PROTECTED FROM EROSION.
5. IN THE CASE OF THE TEMPORARY CONSTRUCTION EXIT, THE CONTRACTOR SHALL MAINTAIN A WEEKLY SURFACE CLEANING BY DRAG BROOM OR EQUIVALENT, TO REMOVE ALL BUILD UP OF FOREIGN MATERIAL TO THE SATISFACTION OF THE SUPERINTENDENT.







### TRAFFIC CONTROLS

1. THE CONTRACTOR SHALL BE SOLELY RESPONSIBLE FOR THE CONTROL OF TRAFFICS INCLUDING VEHICLES AND PEDESTRIANS TO THE SATISFACTION OF COUNCIL, THE RELEVANT STATE AUTHORITIES AND THE SUPERINTENDENT.
2. THE CONTRACTOR IS TO PREPARE A TRAFFIC MANAGEMENT PLAN TO THE REQUIREMENTS OF THE RMS - TRAFFIC CONTROL AT WORK SITE, AS 1742 - AUSTRALIAN STANDARD MANUAL OF UNIFORM TRAFFIC CONTROL DEVICES, AND LOCAL COUNCIL STANDARDS.

#### OTHER ENVIRONMENTAL CONTROLS

1. OTHER ENVIRONMENTAL CONTROLS LIKE NOISE, DUST, VIBRATION, FLORA & FAUNA, FIRE, HAZMAT, AND CONTAMINATIONS MUST BE CONTROLLED TO THE REQUIREMENT OF THE COUNCIL AND THE RELEVANT STATE AUTHORITIES.

### LEGEND

- |   |  |
|---|--|
|  | SEDIMENT FENCE   |
|  | GEOTEXTILE INLET FILTER (FOR PITS WITHIN LANDSCAPED AREAS) |
|  | MESH & GRAVEL INLET FILTER                                 |
|  | MESH & GRAVEL KERB FILTER                                  |
|  | STRAW BALE FILTER  |
|  | STABILISED SITE ACCESS                                     |

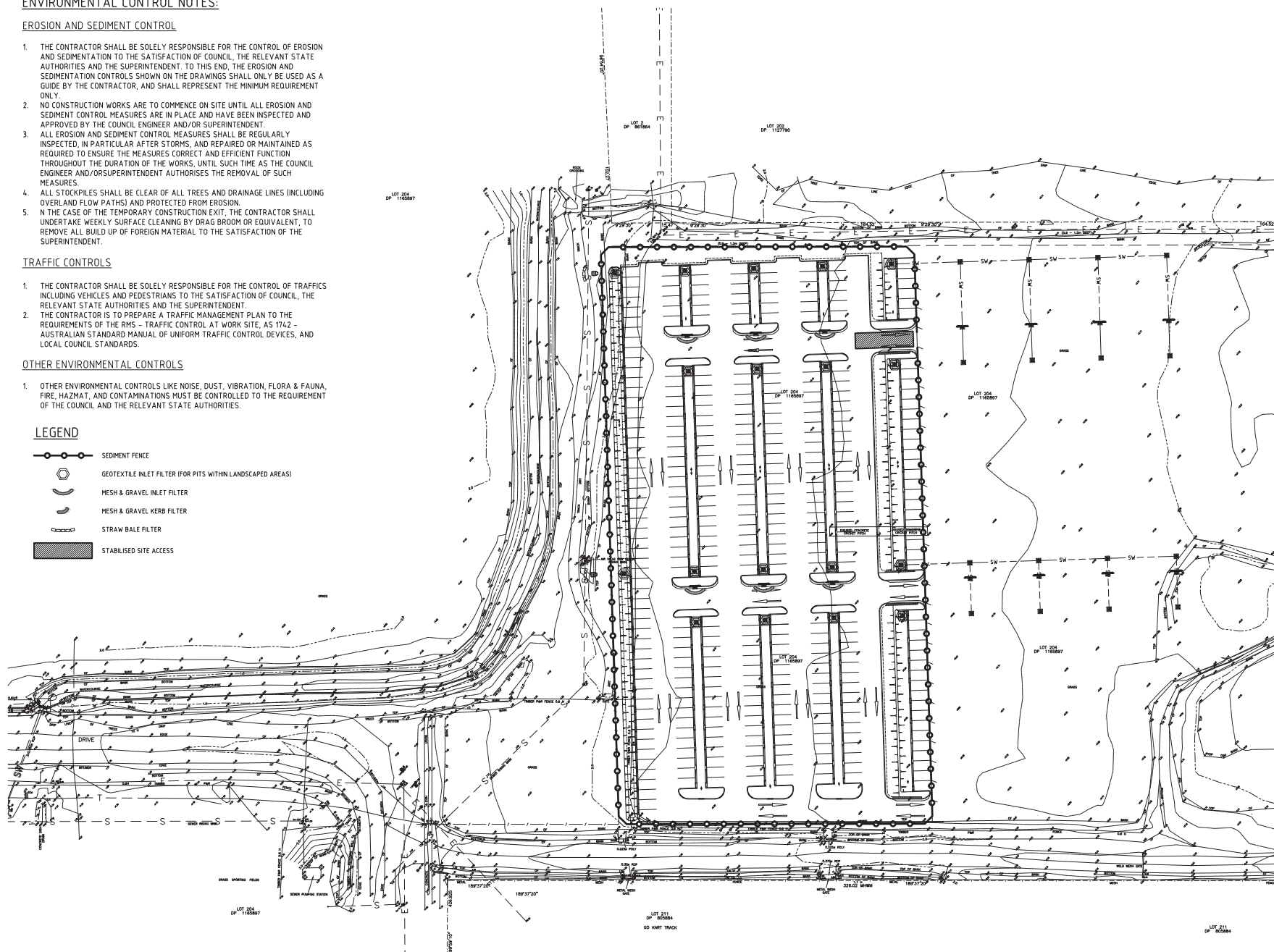

REV.	DES.	VER.	DATE	DESCRIPTION
01	T.T.	A.M.	25.06.14	PRELIMINARY ISSUE

# PRELIMINARY

CLIENT



	PROJECT MANAGER
--	-----------------



© THIS DRAWING AND DESIGN IS THE COPYRIGHT OF C&M CONSULTING ENGINEERS PTY. LTD. NO PART OF THIS DRAWING OR DESIGN SHALL BE REPRODUCED OR USED WITHOUT PRIOR WRITTEN CONSENT FROM C&M CONSULTING ENGINEERS PTY. LTD.

PROJECT	COFFS HARBOUR HEALTH CAMPUS
---------	-----------------------------

TITLE	SEDIMENT & EROSION CONTROL STAGE 2
-------	---------------------------------------

DESIGNED	T.T.	DATE	16.04.14
VERIFIED	A.M.	DATE	16.04.14
DRAWN	T.T.	SCALE @ A3	NA
STATUS		DA / SD	
DRAWING No.	01094_C703	REVISION	01



STATUS	SD		
DRAWING No.	01094_C801	REVISION	01

REFER TO DRG 802 FOR CONTINUATION



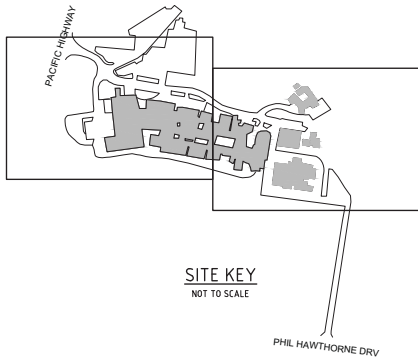
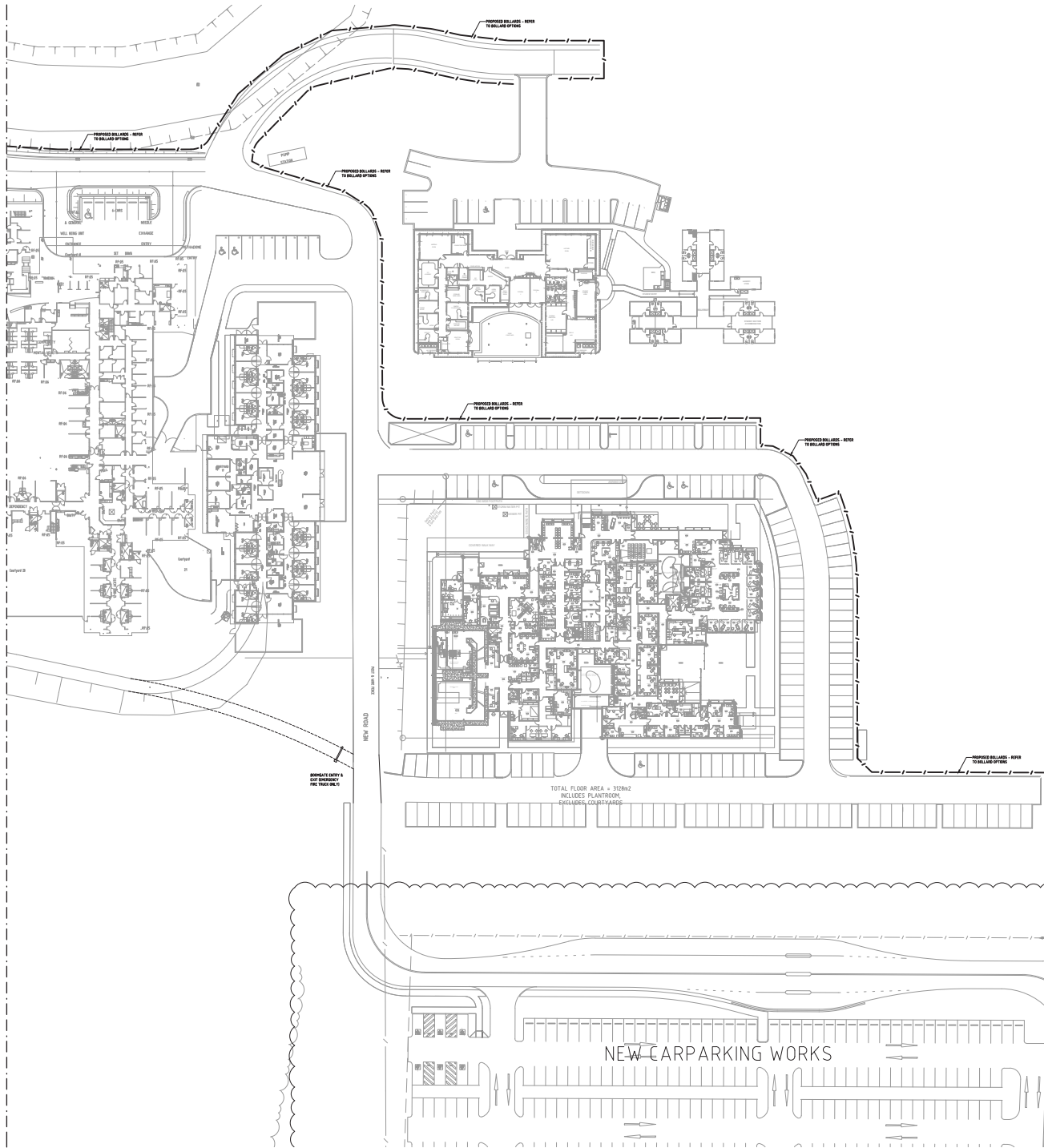

**SITE KEY**  
NOT TO SCALE

## BOLLARD OPTIONS



OPTION 1



OPTION 2



OPTION 3

REV.	DES.	VER.	DATE	DESCRIPTION
01	T.T.	A.M.	0107.14	PRELIMINARY ISSUE

# PRELIMINARY

CLIENT:



PROJECT MANAGER
-----------------



**CIVIL AND HYDRAULIC  
ENGINEERING DESIGN AND  
PROJECT MANAGEMENT**

**SUITE 26  
11 - 13 BROOKHOLLOW AVE  
BAULKHAM HILLS NSW 2153**

**PHONE: (02) 9680 3100  
FAX: (02) 9634 6989**

**ABN 21 118 134 240**

© THIS DRAWING AND DESIGN IS THE COPYRIGHT OF C&M CONSULTING ENGINEERS PTY. LTD. NO PART OF THIS DRAWING OR DESIGN SHALL BE REPRODUCED OR USED WITHOUT PRIOR WRITTEN CONSENT FROM C&M

PROJECT COFFS HARBOUR HEALTH CAMPUS

TITLE
-------

INTERNAL SITE WORKS - SHEET 2

DESIGNED	T.T.	DATE	01.07.14
VERIFIED	A.M.	DATE	01.07.14
DRAWN	T.T.	SCALE @ A0	NTS

STATUS		SD	
DRAWING No.	01094_C802	REVISION	01

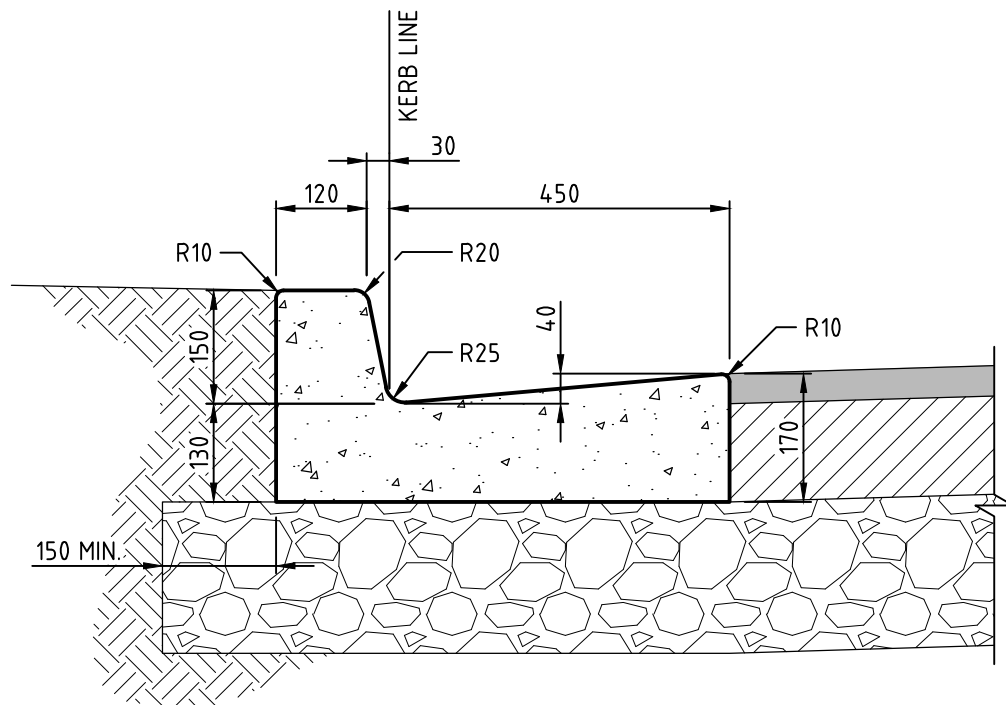

Kerb & Gutter (K&G)  
SCALE 1:10

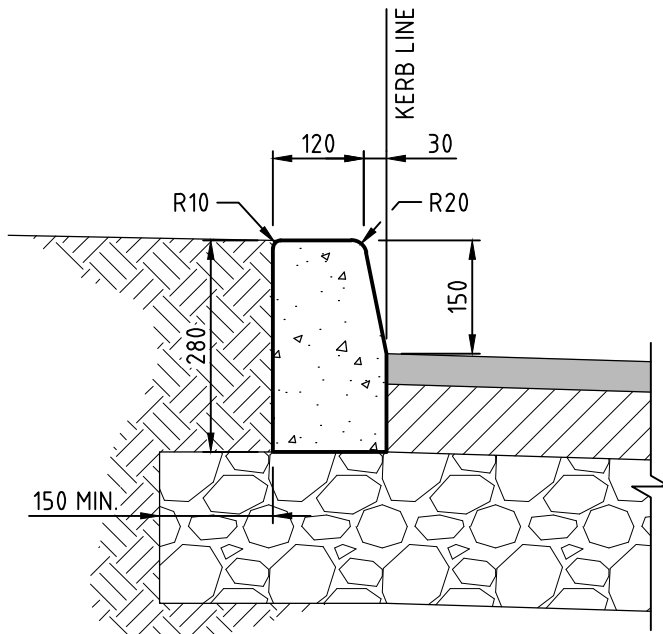

Kerb Only (K.O.)  
SCALE 1:10

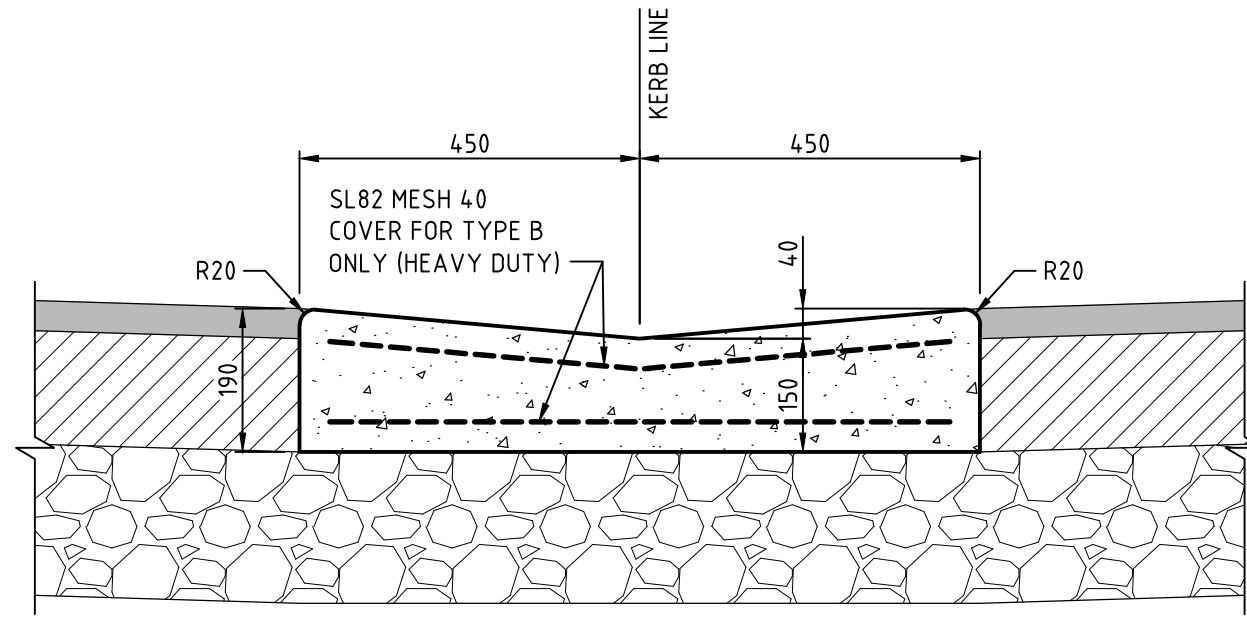

Dished Crossing (D.C.)  
SCALE 1:10

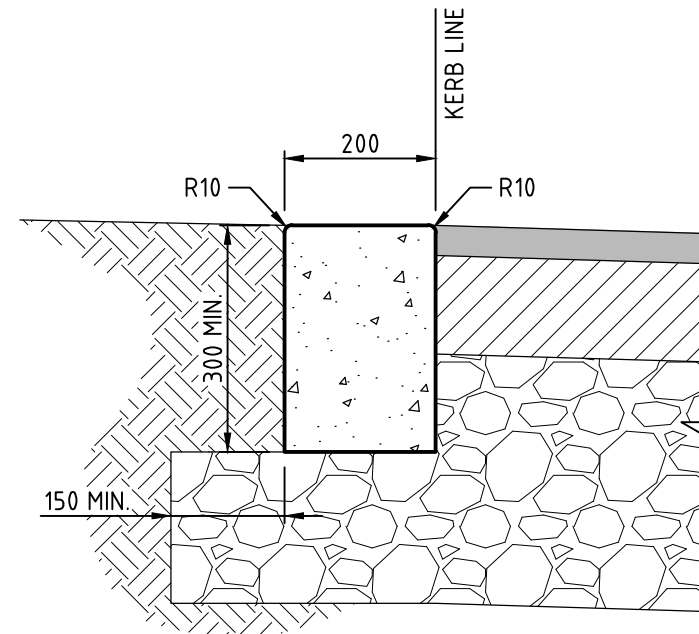

Concrete Edge Strip (C.E.S.)  
SCALE 1:10

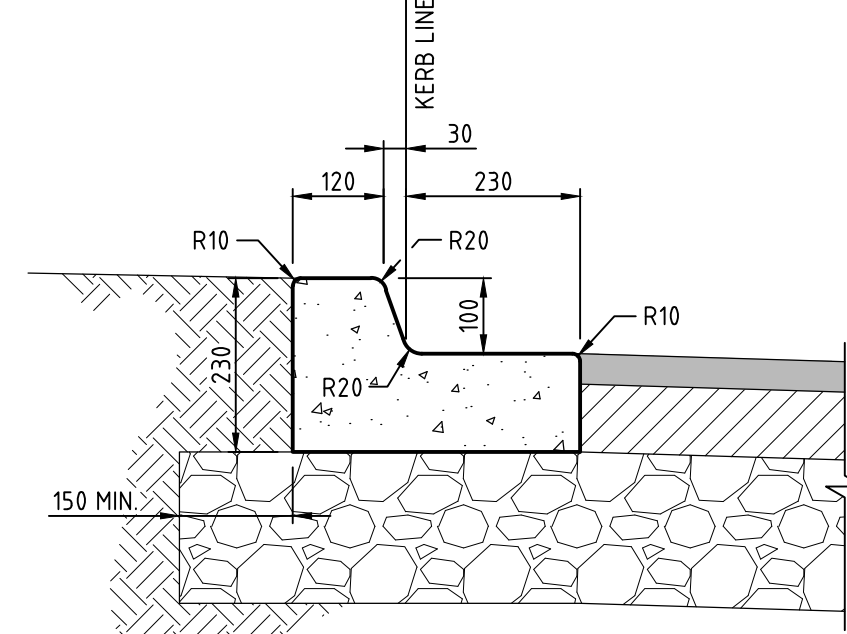

Kerb & Toe (K&T)  
SCALE 1:10

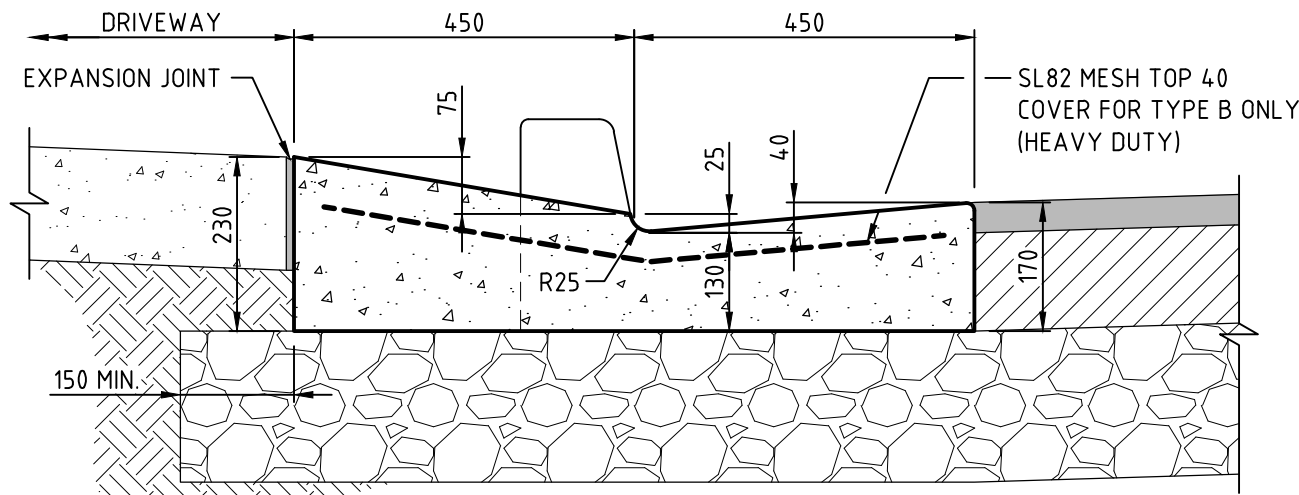

Driveway Layback (V.C.)  
SCALE 1:10

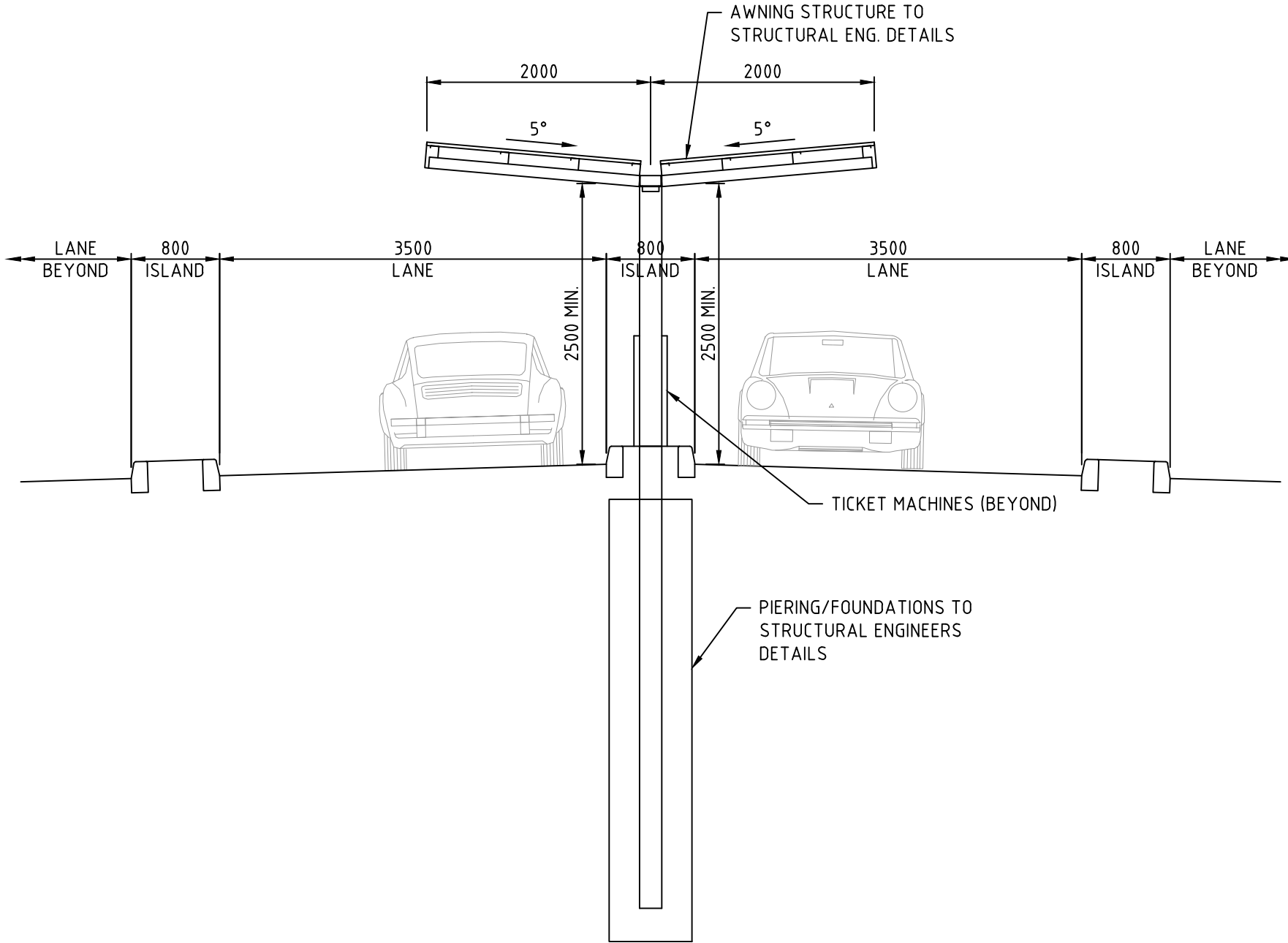

Awning over Ticket Machine  
Island Elevation  
SCALE 1:20

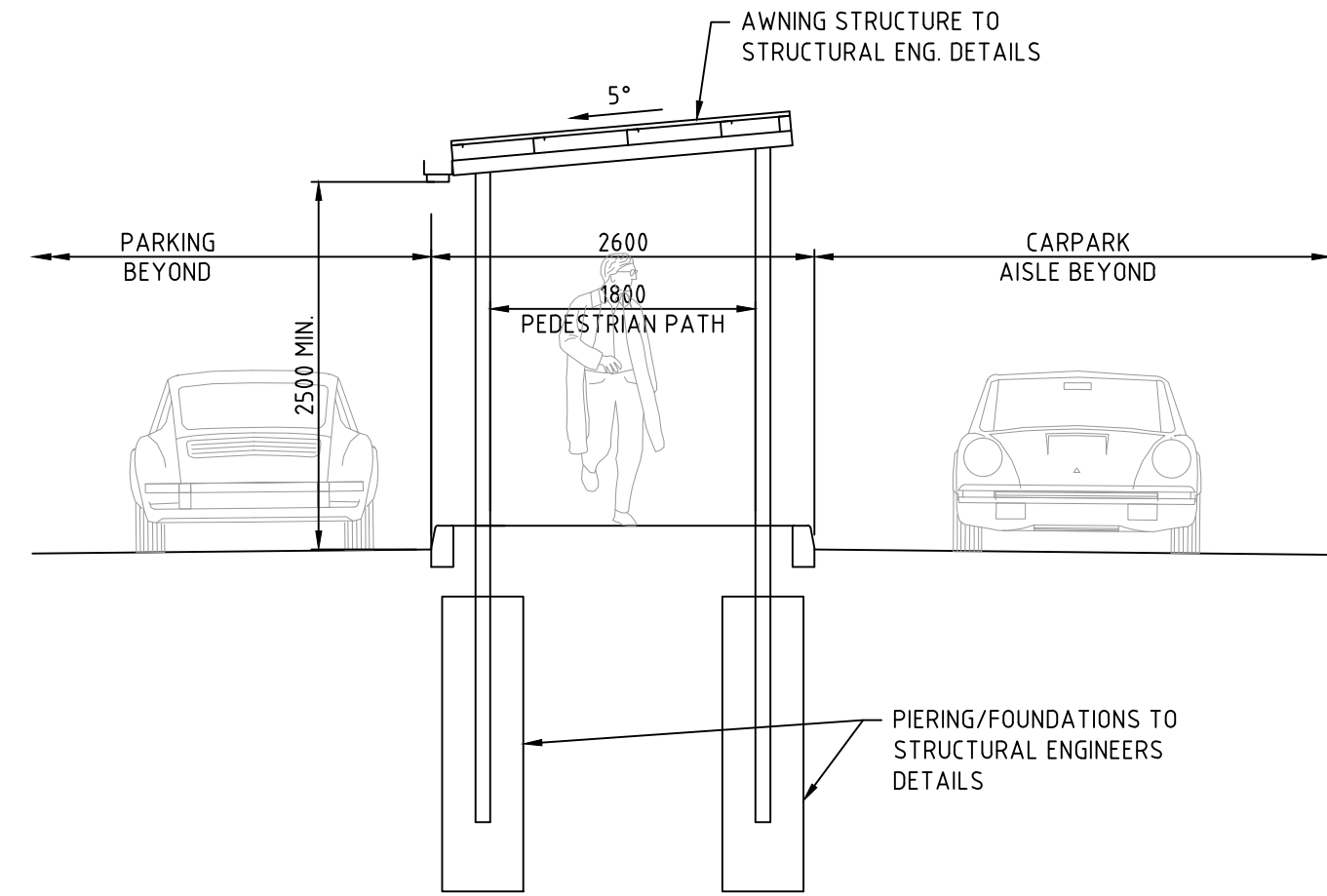

Awning over Pedestrian  
Island Elevation  
SCALE 1:20

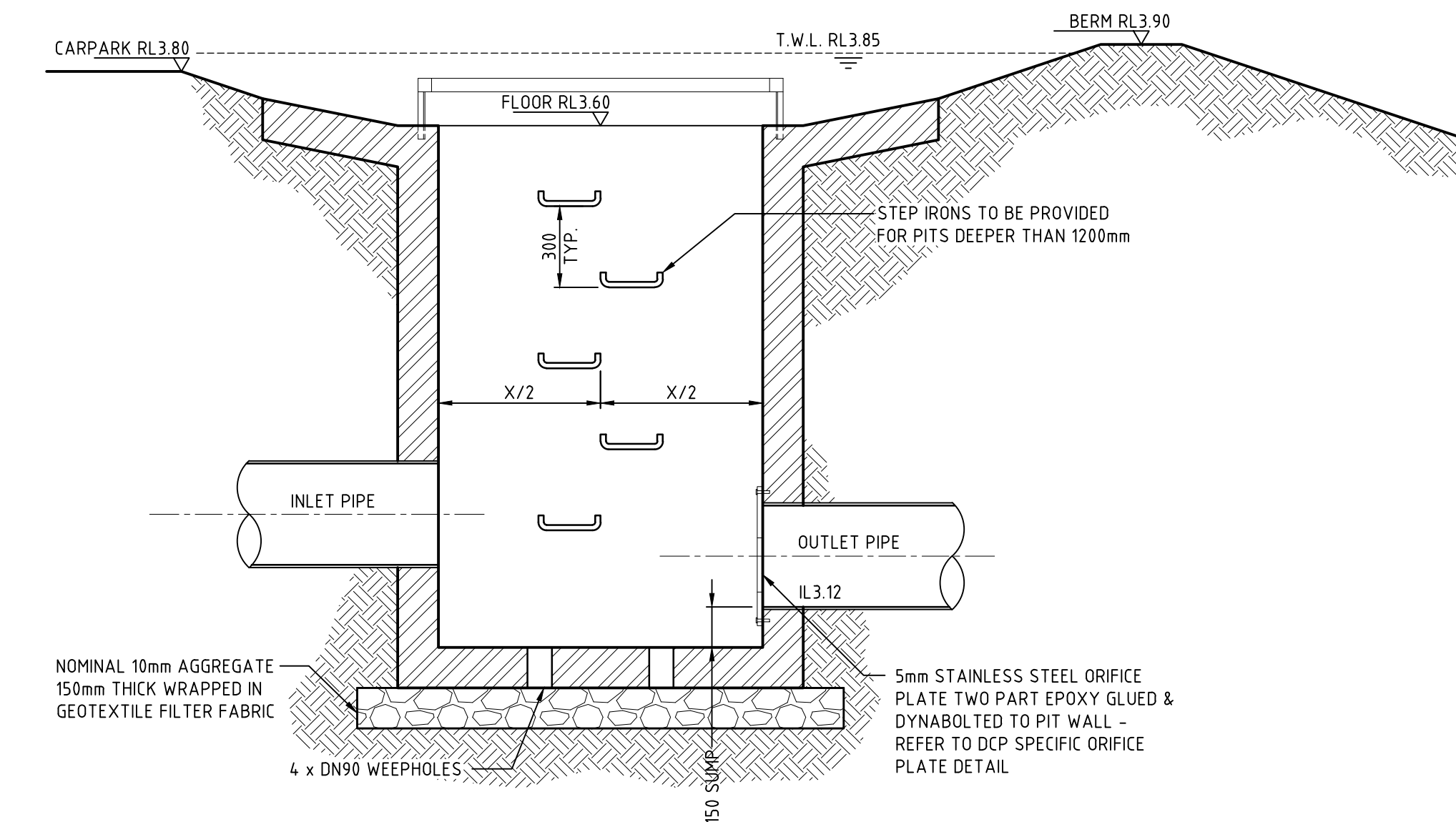

SECTION - Typical Discharge Control  
PIT (DCP)  
SCALE 1:20

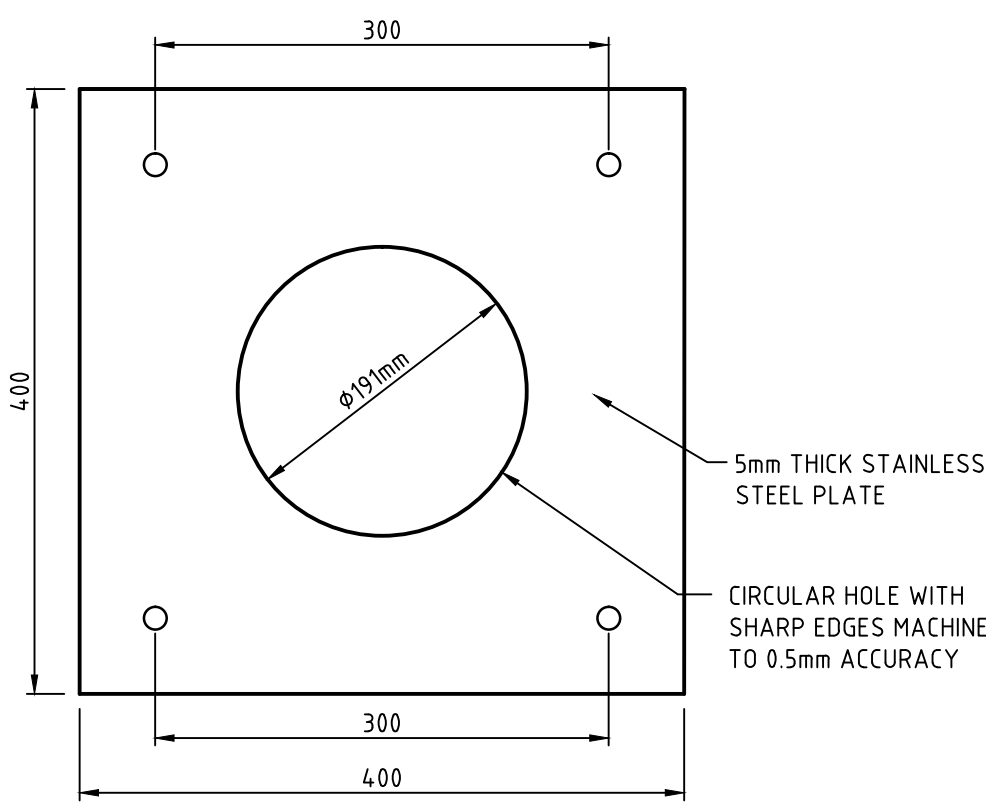

Orifice Plate Detail - DCP No.1 (Western)  
SCALE 1:5

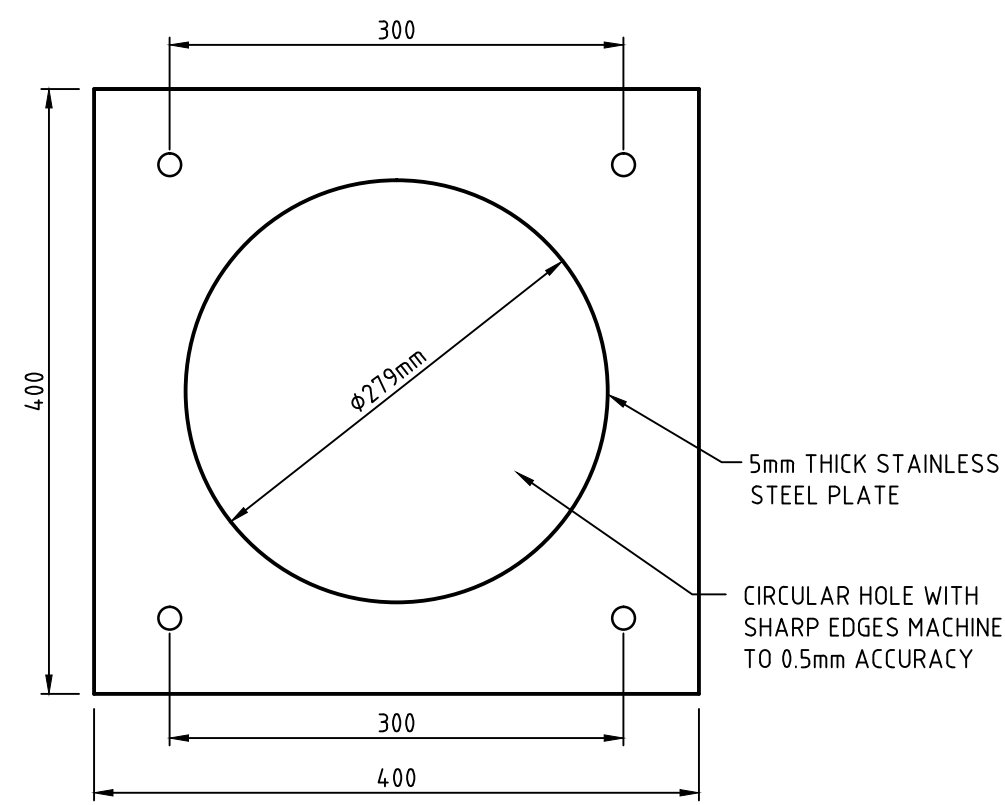

Orifice Plate Detail - DCP No.2 (Eastern)  
SCALE 1:5

NOT FOR CONSTRUCTION

REV.	DES.	VER.	DATE	DESCRIPTION
03	T.T.	A.M.	13.08.14	DESIGN DEVELOPMENT
02	T.T.	A.M.	25.07.14	AWNING, FENCE DETAILS ADDED
01	T.T.	A.M.	25.06.14	PRELIMINARY ISSUE