

Legend

Existing site information courtesy
Masterplan: Gardiner Wetherill Associates 22.08.18







MORIAH COLLEGE BUILDING LIST

BUILDING A	THE BRENDER MOSS LIBRARY	BUILDING L	THE KATZ FAMILY ADMINISTRATION BUILDING
	THE GAVSHON GOULBURN I.L.C	BUILDING M	THE ABRAHAM BILFELD COLLEGE BUILDING
BUILDING B	BUILDING B		THE DANNY GARDOS MUSIC CENTRE
BUILDING C	DESIGN AND TECHNOLOGY BUILDING		THE RACHEL LOWY YEARS T-2 LIBRARY
BUILDING D	THE HARRY TRIGUBOFF JEWISH STUDIES BUILDING	BUILDING N	THE ABRAHAM BILFELD COLLEGE BUILDING
	THE BIGGS FAMILY CAFETERIA	BUILDING P	THE LEON FINK MIDDLE SCHOOL BUILDING
	THE LANDERER FAMILY CENTRE (INFORMAL JEWISH STUDIES)		THE BURGER MOSS GYMNASIUM
BUILDING E	THE VIDOR FAMILY PHYSICAL EDUCATION BUILDING		THE JOHN & GLORIA EISMAN SWIMMING POOL PAVILLION
BUILDING F	THE HUGO LOWY SYNAGOGUE	BUILDING R	THE HENRY ROTH ADMINISTRATION BUILDING
	THE SIMONS FAMILY FOYER	BUILDING S	EXISTING DEMOUNTABLE
BUILDING G	THE MOSHE TRIGUBOFF AUDITORIUM	BUILDING T	THE RAILEA MOSS ASSEMBLY HALL
BUILDING J	THE JOHN SAUNDERS SCIENCE BUILDING	BUILDING U	THE HARRY TRIGUBOFF FAMILY CORNER HOUSE
BUILDING K	THE GISELLA SCHEINBERG ART BUILDING	BUILDING Z	EXISTING DEMOUNTABLE
	THE LINZ FAMILY PERFORMING ARTS CENTRE		

MORIAH COLLEGE GROUNDS

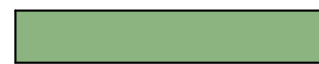
H1.01	GATE 01	H1.14	GATE 14	H1.27	THE SAM FISHER WALL
H1.02	GATE 02	H1.15	GATE 15	H1.28	AKIVA COURT
H1.03	GATE 03	H1.16	QUEENS PARK RD. PARKING	H1.29	MUNICH II MEMORIAL SITE
H1.04	GATE 04	H1.17	OUTDOOR PRACTICE CRICKET NETS	H1.30	THE ABRAHAM RABINOVITCH WALK
H1.05	GATE 05	H1.18	OUTDOOR SPORTING COURTS	H1.31	THE VIDOR FAMILY COURTYARD
H1.06	GATE 06	H1.19	THE ROBERT GOOT WALK / CANOPY	H1.32	ACCESS ROAD (BETWEEN JUNIOR AND SENIOR CAMPUSES)
H1.07	GATE 07	H1.20	EZRA COURT	H1.33	THE REDELMAN FAMILY COURTYARD
H1.08	GATE 08	H1.21	BARONGA AVE TENNIS COURTS	H1.34	YORK RD. PRIMARY CAR PARK
H1.09	GATE 09	H1.22	YORK RD. SECONDARY CAR PARK	H1.35	THE PETER AND SHARON IVANY FORECOURT
H1.10	GATE 10	H1.23	YORK RD. CAR PORT	H1.36	THE ROBERT GAVSHON WALK
H1.11	GATE 11	H1.24	YORK RD. SHELTER	H1.37	THE BEREL & AGNES GINGES AMPITHEATRE
H1.12	GATE 12	H1.25	HILLEL COURT	H1.38	KING DAVID DRIVE
H1.13	GATE 13	H1.26	HERZL COURT	H1.39	THE STANLEY AND CHARMAINE ROTH COURTYARD
				H1.40	WASTE CONTAINMENT AREA

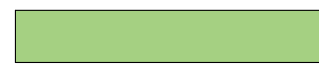
LEGEND

	Existing school buildings		Sport courts
	Vegetation regeneration zone		Hardscape
	Softscape		Roadways

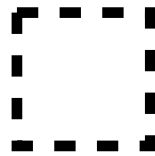
 Zone of Upgrade and New Works



Moriah College Upgrade and New Building Works
Existing Site Plan NTS
17.06.19

Site Opportunities and Constraints

Existing site information courtesy
Masterplan: Gardiner Wetherill Associates 22.08.18

Opportunities

- _ upgrade to Senior Campus to consolidate all major vehicular movements to York Road (Gate 07 and Gate 08/09) and Baronga Avenue (existing layby)
- _ update to Senior Campus to consolidate main student and visitor pedestrian entry to Gate 10/Baronga Avenue through the opportunity to create a new Senior School Entrance from Baronga Avenue.
- _ all major functions associated with the Senior Campus Entrance (Administration) to be relocated in close proximity to new entrance.
- _ new upgrade and new building works will provide for a more flexible and future focussed learning environment to meet the needs of the current and future learners consistent with the GANSW Design Guide for Schools and the Education SEPP.

Constraints

- _ existing fig tree located in current carpark to be removed
- _ existing Biodiversity Zone to be considered in any new development
- _ proximity to Queens Park and its associated amenity to be considered in any new development.
- _ views from properties on Queen's Park Road to be considered with any new development.



Staging

Centennial Park



PHASE 1
Independent Learning Centre
STEAM Learning
Administration



PHASE 2
Early Learning Centre
Administration
Canteen

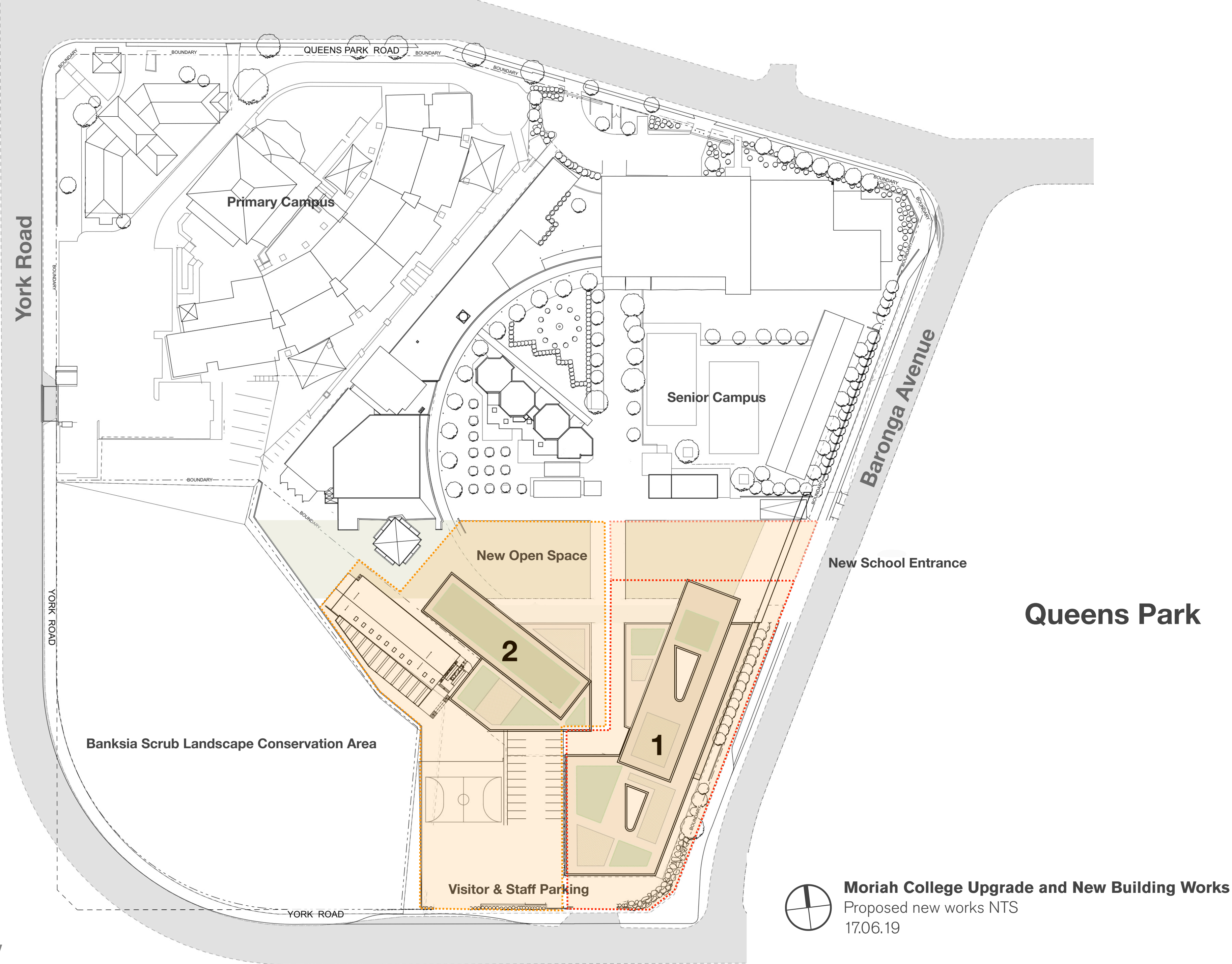

Moriah College Upgrade and New Building Works
Proposed new works NTS
17.06.19

Conceptual Layout



consolidated student
pedestrian entrance



school community focussed
independent learning centre
incl. multipurpose spaces

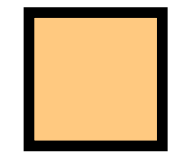

STEAM learning hubs



new green space visual connector

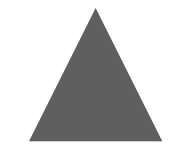

- vehicular entrance
- staff parking
- ELC circulation
- buses
- deliveries

