

BUILDING PERFORMANCE of School

December, 2017

Provided by **LYLUX**

CONTENTS

PROJECT CONTEXT	•	003-006
3D MODLE OF SCHOOL	•	007-032
BUILDING MATERIALS OF SCHOOL	•	033-036
SYSTEM MATERIALS OF SCHOOL	•	037-042

Site Plan

To support a high-quality and performance of study, wellbeing and joy for school.

- 00 Bus stop
- 01 School entrance (As vehicles and people enter and exit the site.)
- 02 6m (w) 2-way vehicle lane
- 03 Child care building (2F), plot area 200m²
- 04 Teaching building (3F), plot area 4200m²
- 05 Swimming pool, 1m (D), plot area 300m²
- 06 Playground, 8 tracks, inner track of 200m
- 07 Open cola, plot area 600m²
- 08 Hall, 10m (H), plot area 800m²
- 09 Canteen (3F), plot area 800m²
- 10 Car parking (x72)
- 11 Fence 2.5m (H), and associated planting provide separation



DESCRIPTION

- The site is approximately 23000m² in size.
- It can accommodate about 1000 students and 50-70 teachers.
- All the building design and material comply with the current Australia building code.
- ALL the classroom is adequately natural lit and ventilation.
- Partition, floor and ceiling will be provide for speech privacy so that normal conversation is inaudible in adjoining classroom.
- The LV (Low voltage) distribution system will consist of main and sub-main LV distribution panels.
- All water provided to people must be drinkable.

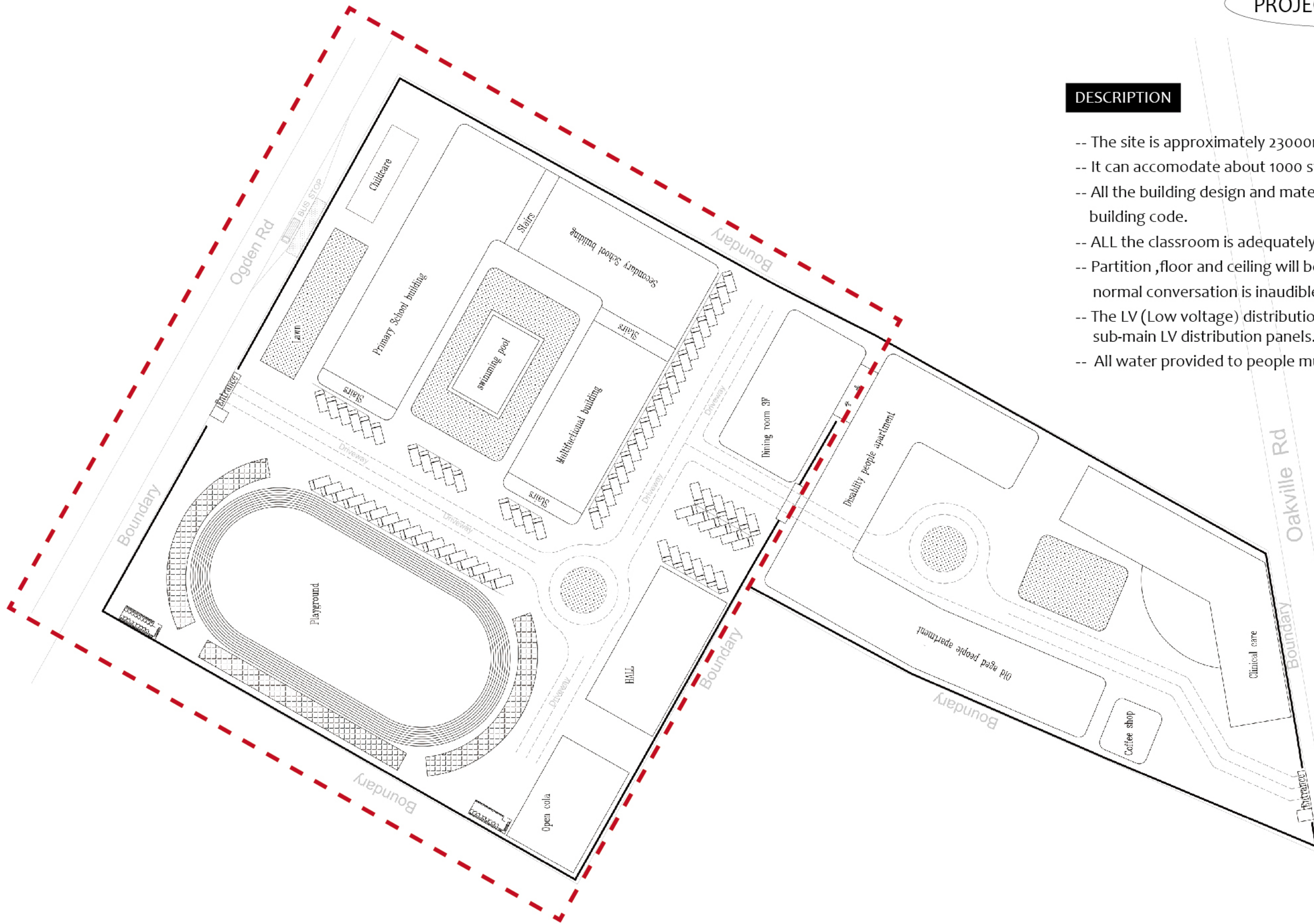

3D Models

This part is the description of School, including teaching building, child care, hall, canteen, open cola, playground, swimming pool, car parking and so on. 3D model of school is as follows for your reference.





















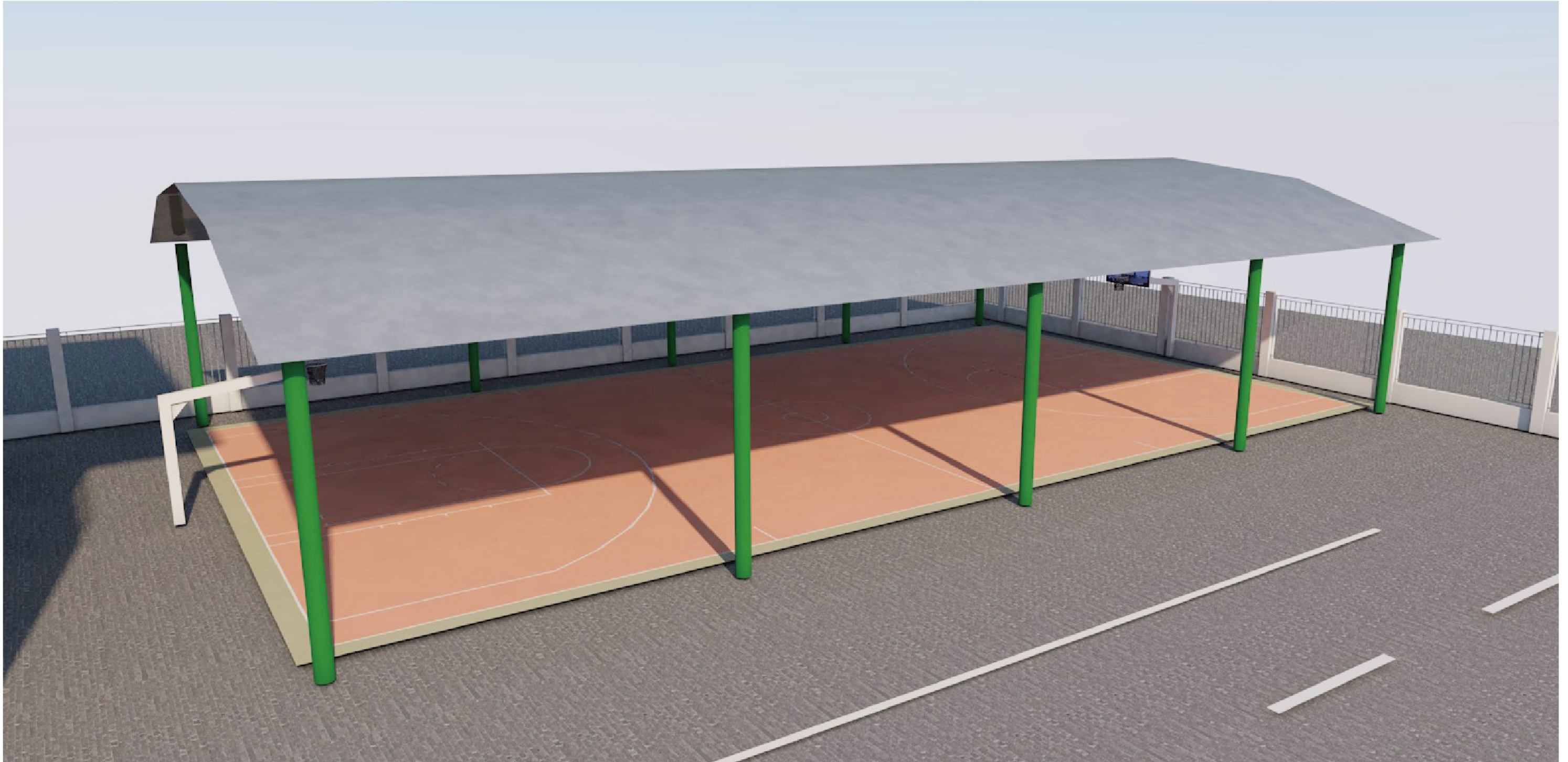

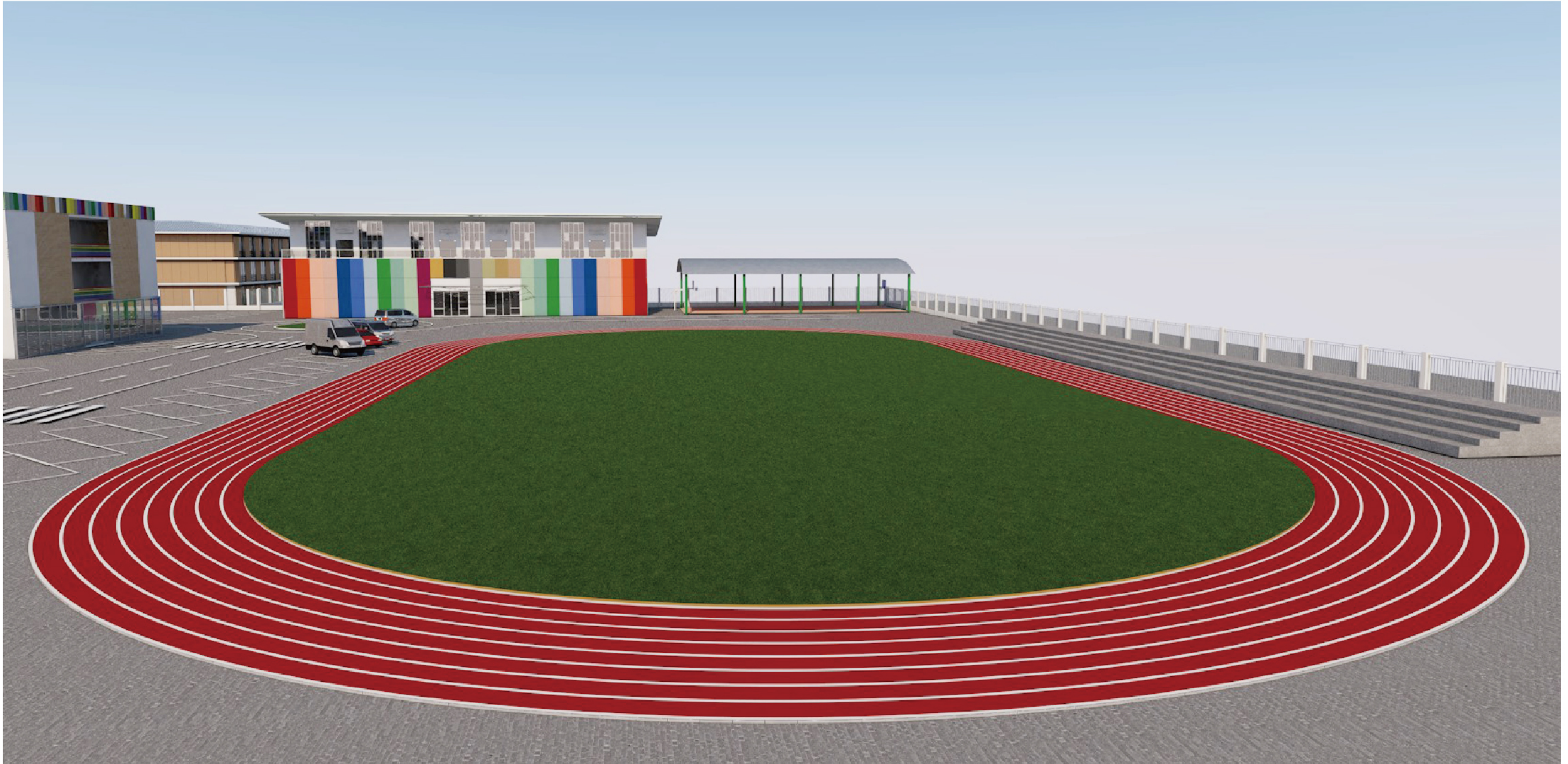

BUILDING MATERIALS

The colourful materials reflecting the character of school are highly recommended. Building materials of school is as follows for your reference.

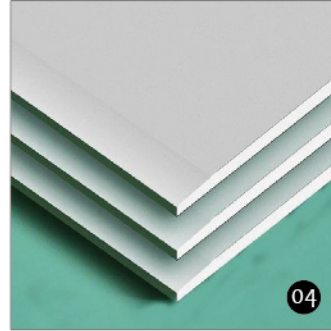
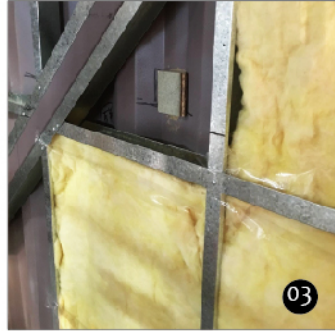

- 01 Steel Structure
- 02 LGS Partition Wall
- 03 Insulation
- 04 Gypsum Board
- 05 Fibercement Board
- 06 Windows
- 07 Doors
- 08 Aluminum Panel

- 09 Timber
- 10 Steel Deck Sheet
- 11 Flooring
- 12 Marble
- 13 Tiles
- 14 Exterior Flooring

- 15 Bunk Bed
- 16 Desk & Chair
- 17 Canopy
- 18 Playground
- 19 Gate
- 20 Fence

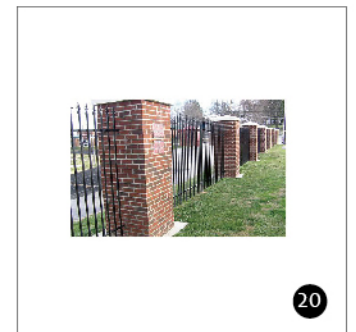
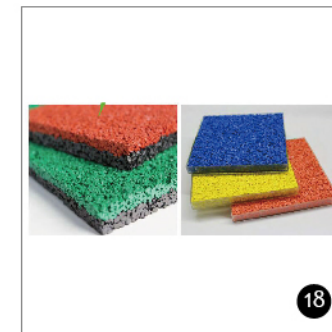
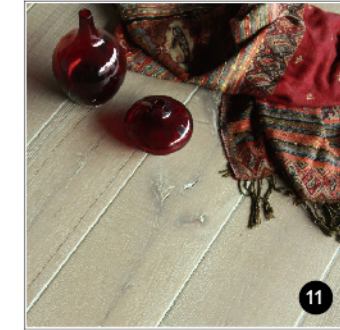
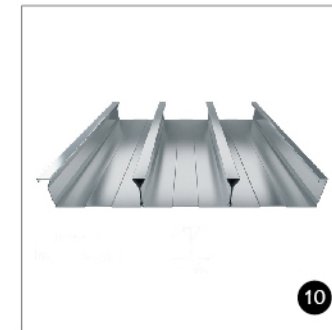

MEP MATERIALS

MEP primarily refer to mechanical, electrical and plumbing, which need to meet requirements, energy efficiency solution, and integration with aesthetic architectural elements. The following context will be for your reference.

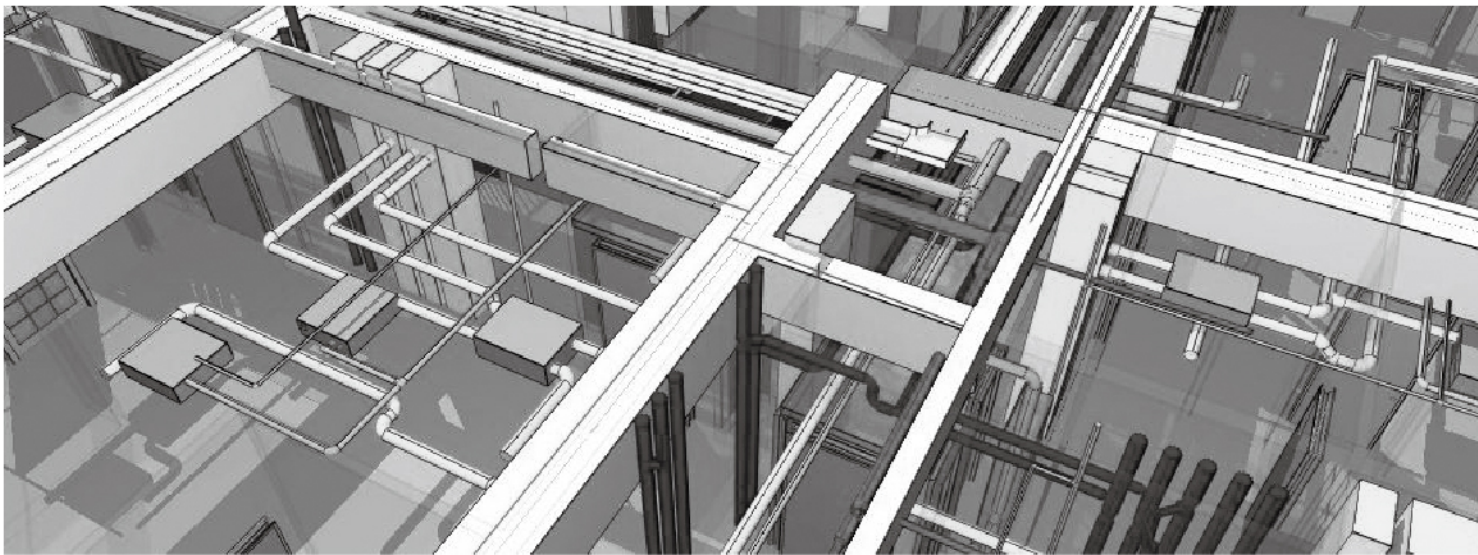
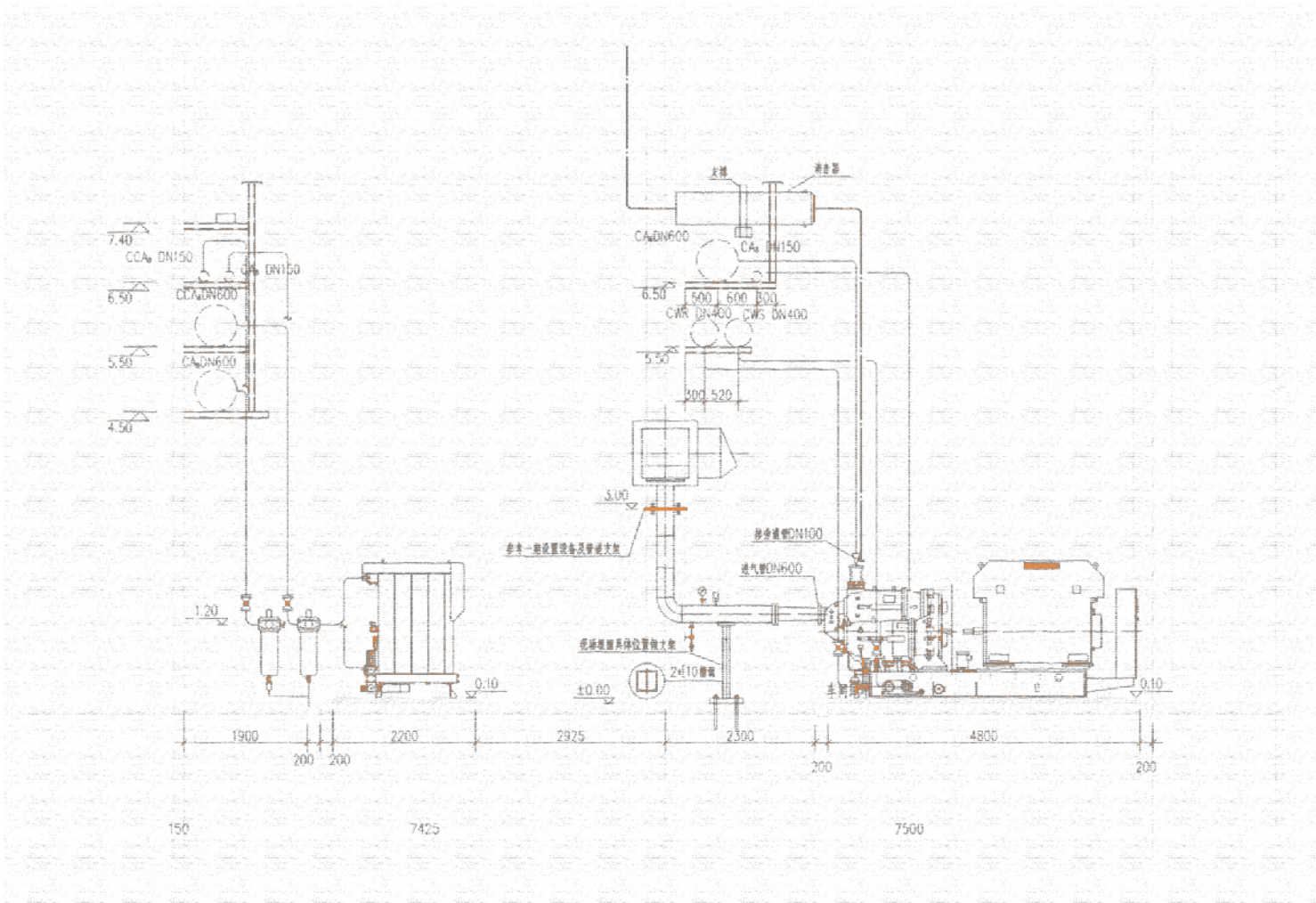

Field	System Name	Remarks
Electrical	Incoming supply and distribution system	
	Lighting system	Main light source: LED
	Earthling and bonding system	
	Security system	
	Communication and data system	TV/TEL/Internet
Plumbing	Water supply and distribution system	
	Sanitary drainage system	
Ventilation	Fan	
	Air-conditioning	
Life safety	Fire-prevention material	
	Fire-alarm and emergency communication system	
	Fire-extinguished system	

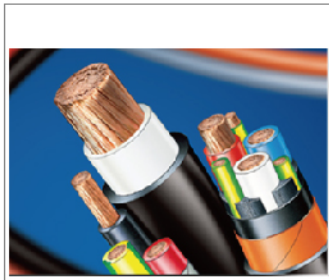

01



02



03

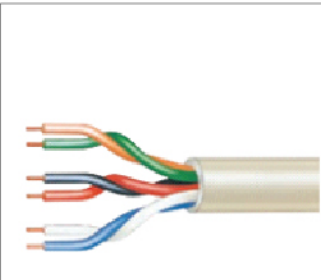

04



05



06



07



08

- 01 Low voltage cable
- 02 Low voltage wire
- 03 TV wire
- 04 TEL /Internet wire
- 05 Switch
- 06 Socket
- 07 Fan
- 08 Light

- 09 Bottom box
- 10 Distribution box
- 11 Conduit
- 12 Pipe
- 13 Drainage
- 14 Tap

- 15 Shower
- 16 VRV indoor unit
- 17 Outdoor unit
- 18 Vent



09



10

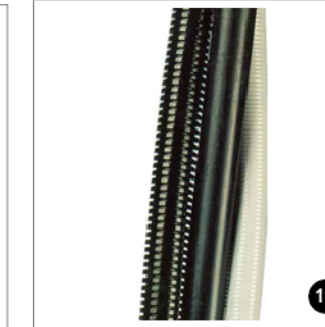

11



12

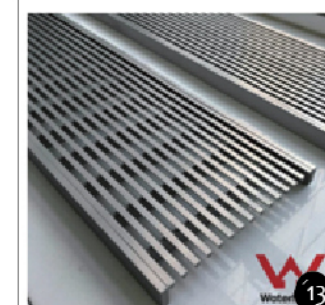

13



14

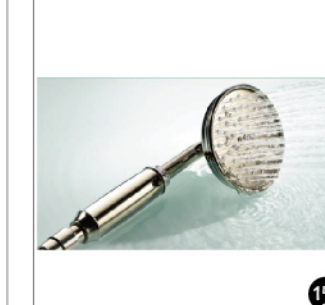

15



16



17



18