

Location Plan

- Legend**
- Building Entry
 - Carpark Entry
 - Services Entry
 - Vegetation to be removed
 - Vegetation to be retained (Interim)
 - Existing Boundary
 - Proposed Boundaries for future developments

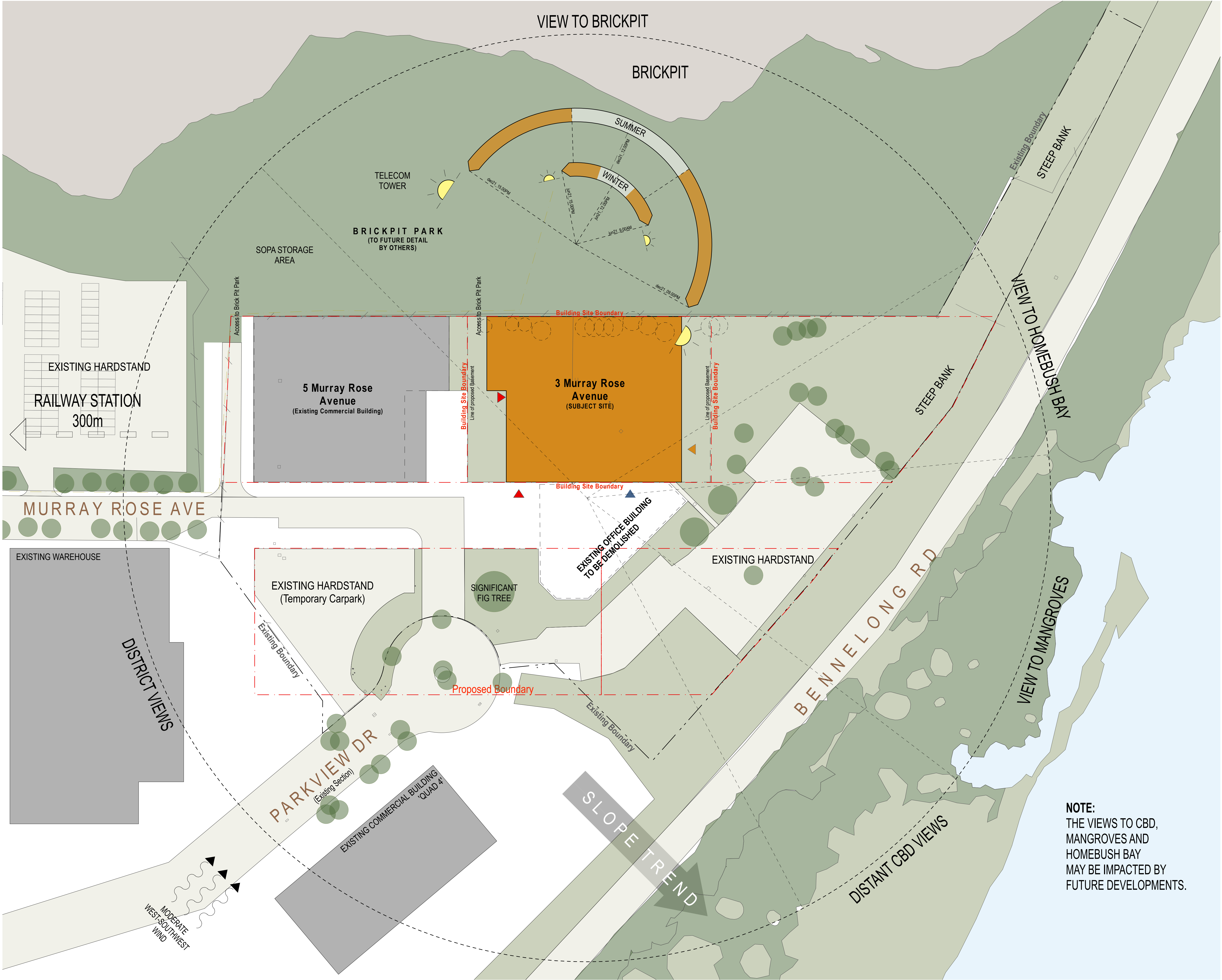

NOTE:
THE VIEWS TO CBD,
MANGROVES AND
HOMEBUSH BAY
MAY BE IMPACTED BY
FUTURE DEVELOPMENTS.



- Legend**
- boundary (existing)
 - subject building (proposed)
 - undercroft
 - existing roads
 - future developments
 - buildings demolished
 - future road road extensions proposed
 - existing buildings
 - proposed roads for building B development
 - services access
 - dock access
 - car park access
 - pedestrian access
 - proposed accessible path of travel by SOPA
 - proposed accessible path of travel within site boundary



Notes:

1. The demolition work will include the removal of tress number 1 through 29 and tree 32 as generally identified in the Arborist Report and Survey File.
2. In addition, the Lilli Pilli hedge as identified in the Arborist Report that will be removed as part of the works.
3. All other trees identified in the Arborist Report that may require removal in the future will be the subject of separate applications.

Legend

- boundary (existing)
- boundary (proposed)
- subject building (proposed)
- undercroft
- existing buildings
- buildings to be demolished
- proposed roads for building B development
- existing roads

Notional Architect Nicholas Turner 9895
200 98 984 911
DLCS Quality Endorsed Company ISO 9001:2008
License Number 4188

NOTES
THIS DRAWING IS COPYRIGHT © AND SHALL REMAIN THE PROPERTY OF TURNER + ASSOCIATES ARCHITECTS. NO
REPRODUCTION WITHOUT PERMISSION. UNLESS NOTED OTHERWISE THIS DRAWING IS NOT FOR CONSTRUCTION.
DO NOT SCALE FROM DRAWING. FIGURED DIMENSIONS SHALL TAKE PRECEDENCE.

CLIENT
THE GPT GROUP
Level 52, MLC Centre 19 Martin Place,
Sydney, NSW 2000
02 8239 3555

GPT
The GPT Group

PROJECT MANAGER
LEND LEASE
30 The Bond, 30 Hickson Road
Millers Point, NSW 2000
02 9236 6111

Lend Lease

PROJECT TITLE
3 MURRAY ROSE AVENUE
SYDNEY OLYMPIC PARK
DRAWING TITLE
Demolition Plan

C 17.09.2012		EA Submission	
Rev.	Date	Revision Notes	
1:500 @B1, 1:125@A3		11002	11002
STATUS	DWG NO.	REV	
EA SUBMISSION	EA004_C		
TURNER + ASSOCIATES			
L1 410 Crown Street Surry Hills NSW 2010 Australia T +61 2 9888 0000 F +61 2 8888 0088			

