

## SP 88935

M.G.

**BUILDING 13**  
7 LEVEL CONCRETE, BRICK & RENDERED  
BRICK RESIDENTIAL BUILDING  
INCORPORATING 1 LEVEL OF  
CARPARKING & PLANT AREAS OVER

NSW GOVERNMENT  
Planning

*Issued under the Environmental Planning and Assessment Act 1979*

Approved Section 75W Modification Application

No. 2 ..... granted on the 09/09/2014 .....

in respect to MP 11-0046

Signed... Awahan

Sheet No. 1 of 18

GENERAL NOTES:

- GENERAL NOTES:
1. THIS PLAN IS PREPARED FROM ARCHITECTURAL DRAWINGS FOR APPROVAL PURPOSES ONLY. CHANGES MAY OCCUR ON THE FINAL PLAN BASED ON FIELD SURVEY.
  2. THIS PLAN IS A DRAFT ONLY AND IS NOT CHECKED OR REGISTERED BY LAND & PROPERTY INFORMATION. ALTERATIONS WILL BE REQUIRED PRIOR TO ITS ACCEPTANCE AND REGISTRATION.
  3. CARSPACE AND STORE ALLOCATIONS MAY CHANGE AS REQUIRED.

13  
DP 270729

(B) DENOTES BALCONY  
(T) DENOTES TERRACE  
(CY) DENOTES COURTYARD

**Surveyor:** Wayne Allen Diver-Tuck  
**Surveyor's Ref:** 124792-EPP-STG3-DA  
**Subdivision No:**

Lengths are in metres. Reduction Ratio 1: 700

Registered

SP

10	20	30	40	50	Table of mm	90	100	110	120	130	140
----	----	----	----	----	-------------	----	-----	-----	-----	-----	-----

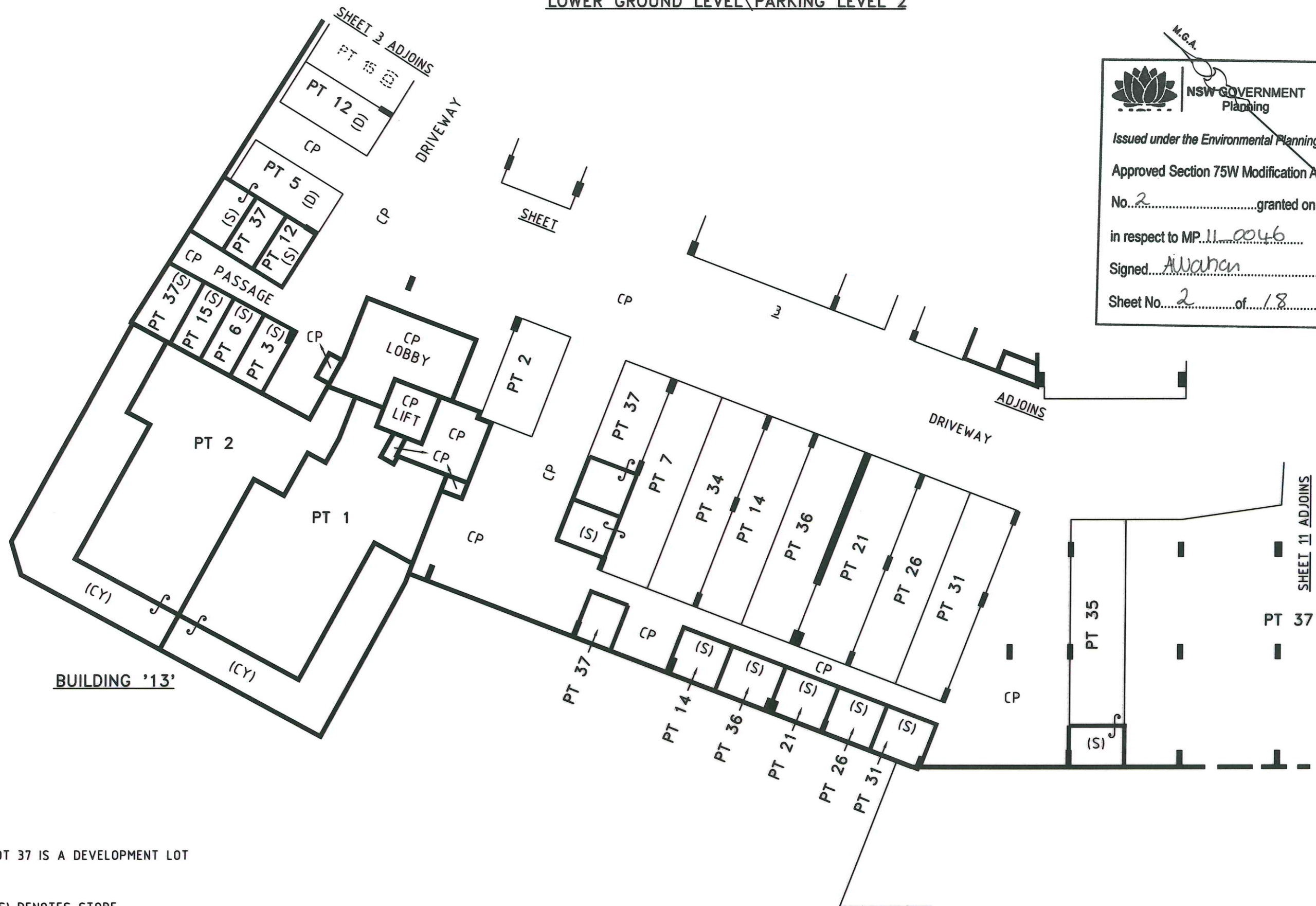
LOWER GROUND LEVEL\ PARKING LEVEL 2SEE SHEET 1 FOR  
GENERAL NOTES

NSW GOVERNMENT  
Planning

Issued under the Environmental Planning and Assessment Act 1979

Approved Section 75W Modification Application

No. 2 granted on the 09/09/2014

in respect to MP 11 0046

Signed AWahan

Sheet No. 2 of 18

LOT 37 IS A DEVELOPMENT LOT

(S) DENOTES STORE  
(CY) DENOTES COURTYARD  
CP DENOTES COMMON PROPERTY

Surveyor: Wayne Allen Diver-Tuck  
Surveyor's Ref: 124792-EPP-STG3-DA  
Subdivision No:

Lengths are in metres. Reduction Ratio 1:200

Registered

SP



SEE SHEET 1 FOR  
GENERAL NOTES

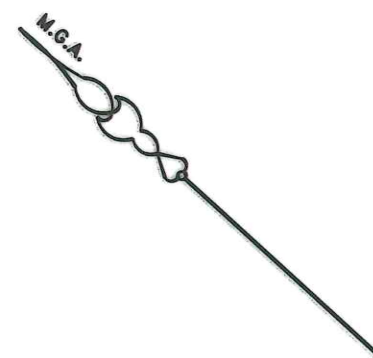

LOWER GROUND LEVEL\ PARKING LEVEL 2

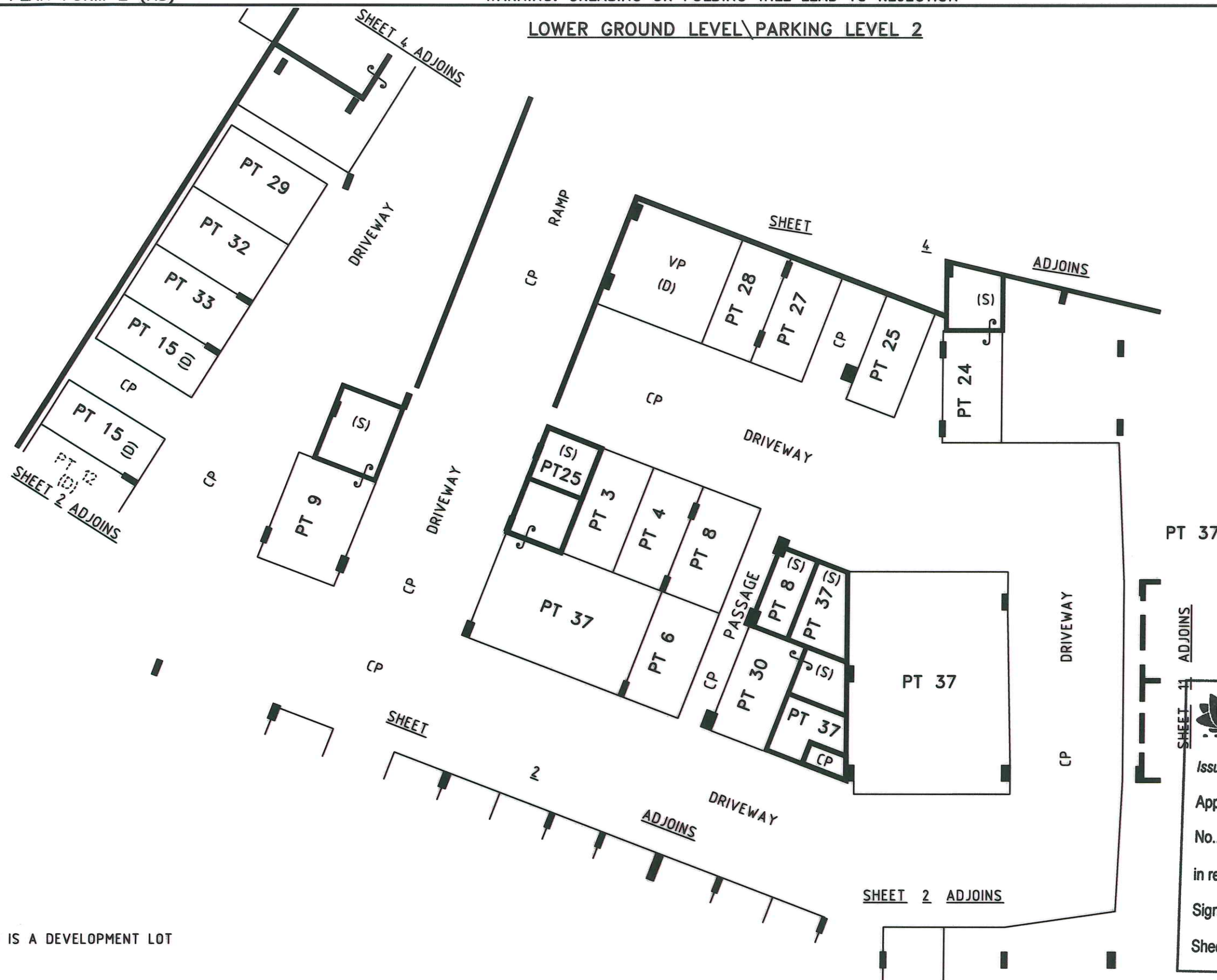

(S) DENOTES STORE  
VP DENOTES VISITOR PARKING - CP  
(D) DENOTES DISABLED PARKING  
CP DENOTES COMMON PROPERTY

NSW GOVERNMENT  
Planning

*Issued under the Environmental Planning and Assessment Act 1979*

**Approved Section 75W Modification Application**

No. 2 ..... granted on the 09/09/2014 .....

in respect to MP 11-0046

Signed.....Awahan

Sheet No. 3 of 18

**Surveyor:** Wayne Allen Diver-Tuck  
**Surveyor's Ref:** 124792-EPP-STG3-DA  
**Subdivision No:**

Lengths are in metres. Reduction Ratio 1:200

Registered

SP

	10	20	30	40	50	Table of mm	90	100	110	120	130	140
--	----	----	----	----	----	-------------	----	-----	-----	-----	-----	-----

## PARKING LEVEL 2

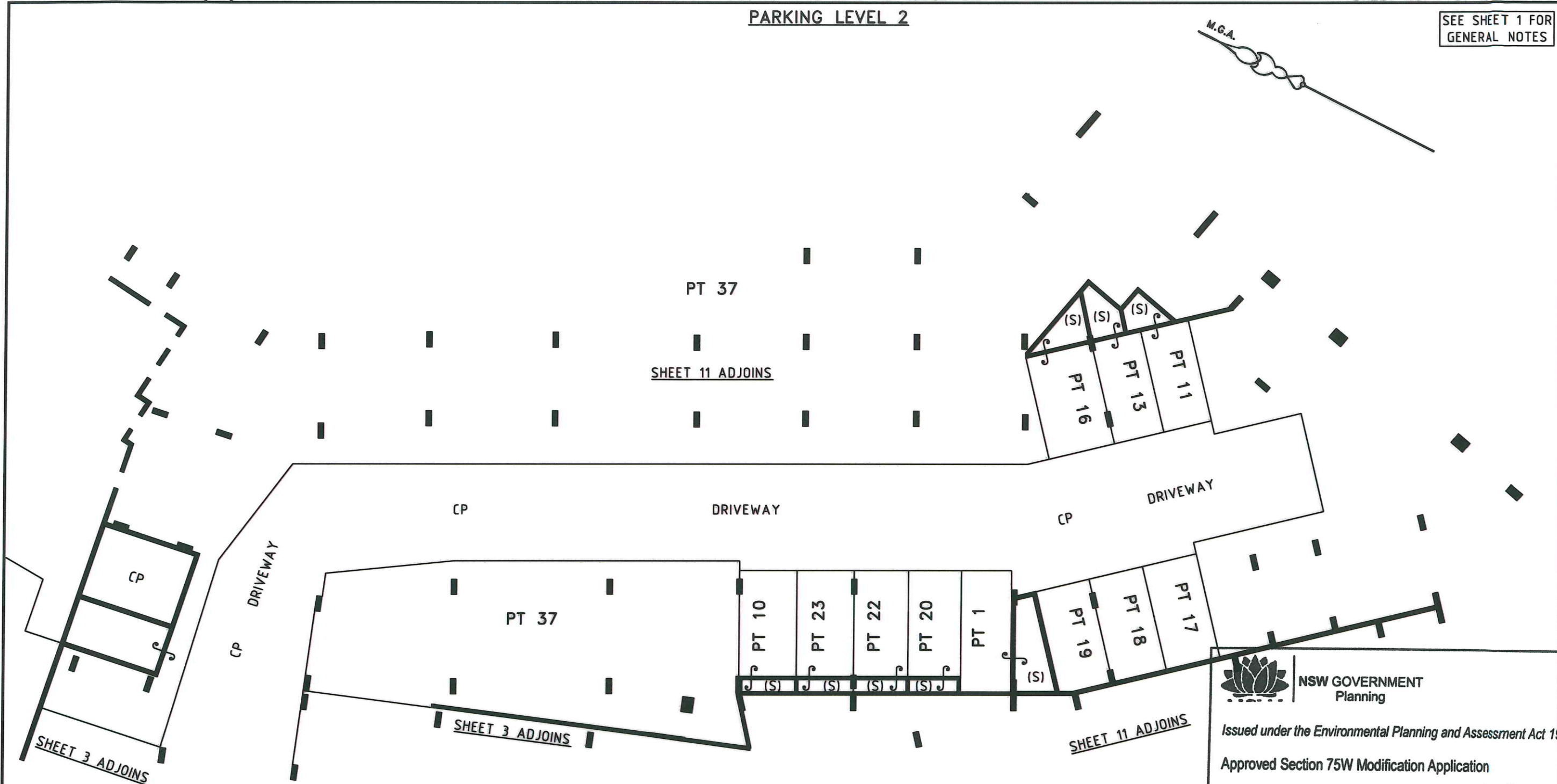
SEE SHEET 1 FOR  
GENERAL NOTESNSW GOVERNMENT  
Planning

Issued under the Environmental Planning and Assessment Act 1979

Approved Section 75W Modification Application

No. 2 granted on the 09/09/2014in respect to MP. 11-0046Signed AWahanSheet No. 4 of 18

LOT 37 IS A DEVELOPMENT LOT

(S) DENOTES STORE  
CP DENOTES COMMON PROPERTYSurveyor: Wayne Allen Diver-Tuck  
Surveyor's Ref: 124792-EPP-STG3-DA  
Subdivision No:

Lengths are in metres. Reduction Ratio 1:200

Registered

SP

10	20	30	40	50	Table of mm	90	100	110	120	130	140
----	----	----	----	----	-------------	----	-----	-----	-----	-----	-----

\\Epping-Mobbs Lane\Epping Stg3\DA



BUILDING '13'  
GROUND LEVELSEE SHEET 1 FOR  
GENERAL NOTES

SHEET 12 ADJOINS

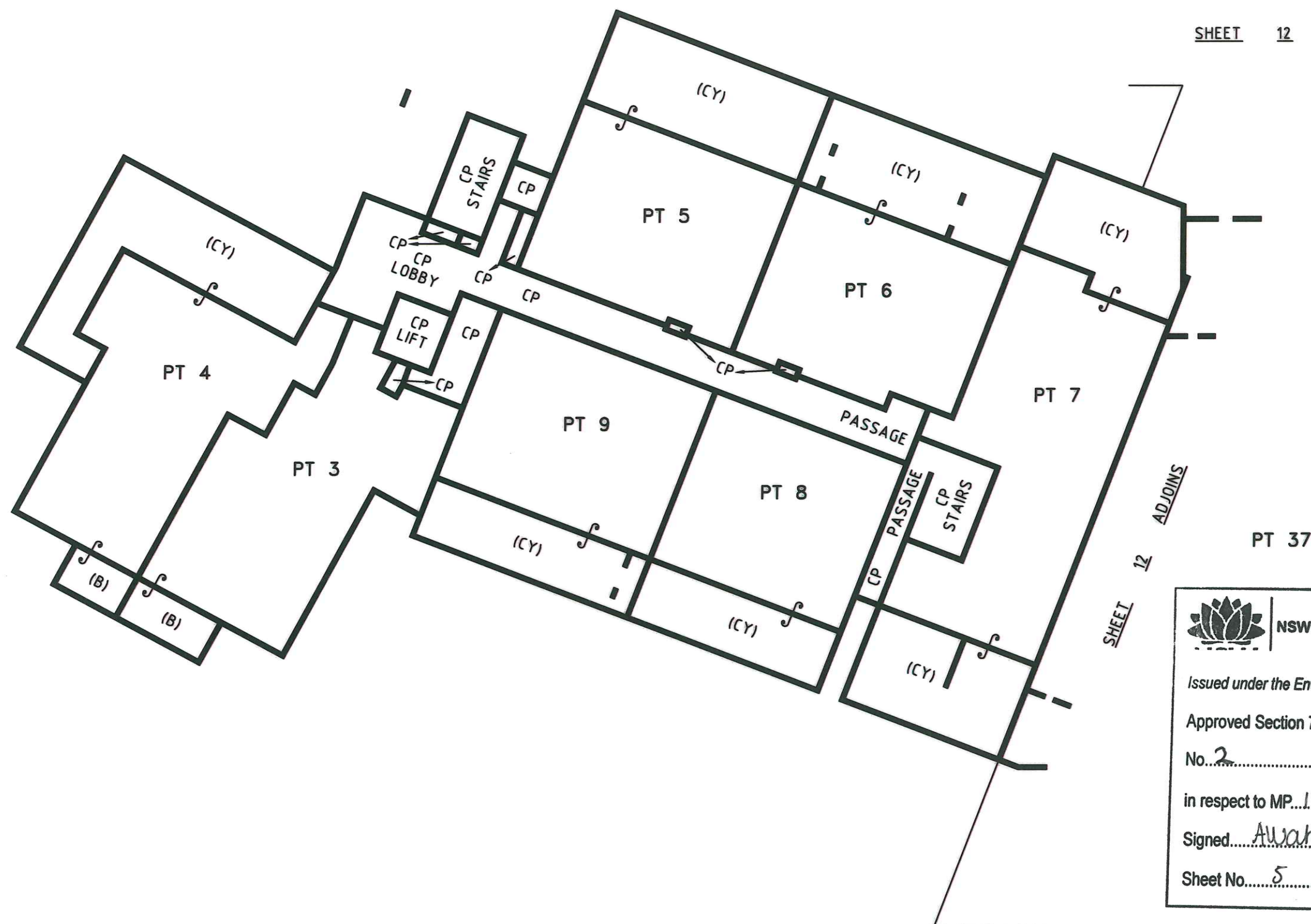
NSW GOVERNMENT  
Planning

Issued under the Environmental Planning and Assessment Act 1979

Approved Section 75W Modification Application

No. 2 granted on the 09/09/2014

in respect to MP 11 0046

Signed: Awahan

Sheet No. 5 of 18

(B) DENOTES BALCONY  
(CY) DENOTES COURTYARD  
CP DENOTES COMMON PROPERTY

Surveyor: Wayne Allen Diver-Tuck  
Surveyor's Ref: 124792-EPP-STG3-DA  
Subdivision No:

Lengths are in metres. Reduction Ratio 1:200

Registered

SP

**BUILDING '13'**  
**LEVEL 1**

SEE SHEET 1 FOR  
GENERAL NOTES

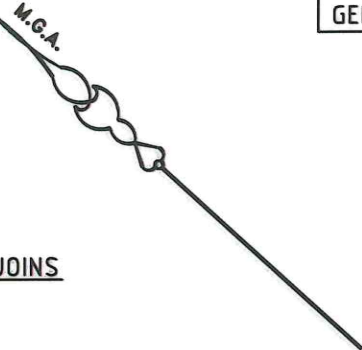

SHEET 13 ADJOINS

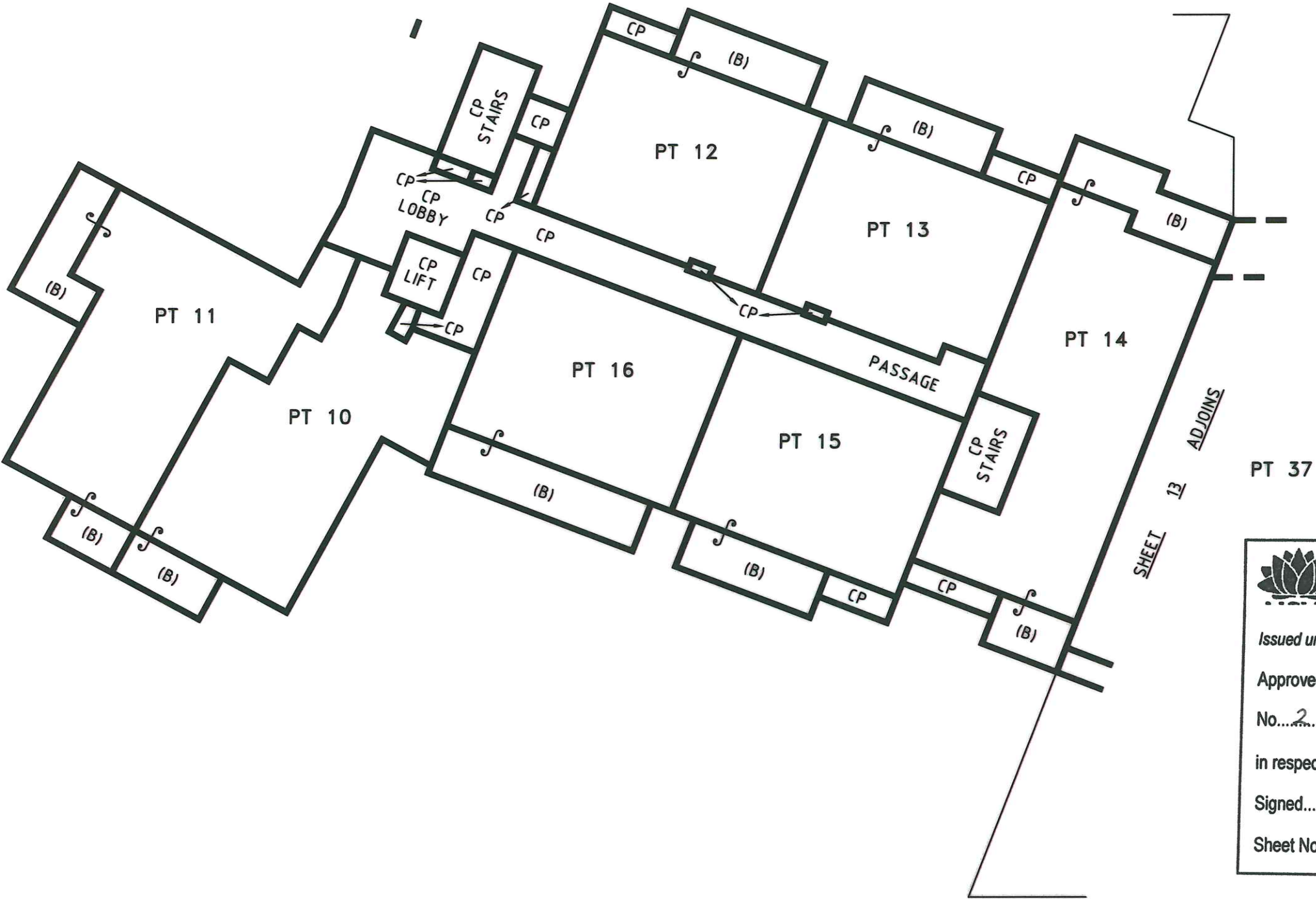

NSW GOVERNMENT  
Planning

Issued under the Environmental Planning and Assessment Act 1979

Approved Section 75W Modification Application

No. 2 granted on the 09/09/2014

in respect to MP 11-0046

Signed: A. Wahan

Sheet No. 6 of 18

(B) DENOTES BALCONY  
CP DENOTES COMMON PROPERTY

Surveyor: Wayne Allen Diver-Tuck  
Surveyor's Ref: 124792-EPP-STG3-DA  
Subdivision No:

Lengths are in metres. Reduction Ratio 1:200

Registered

SP



**BUILDING '13'**  
**LEVEL 2**

SEE SHEET 1 FOR  
GENERAL NOTES

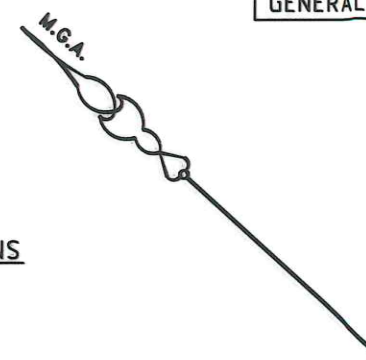

SHEET 14 ADJOINS

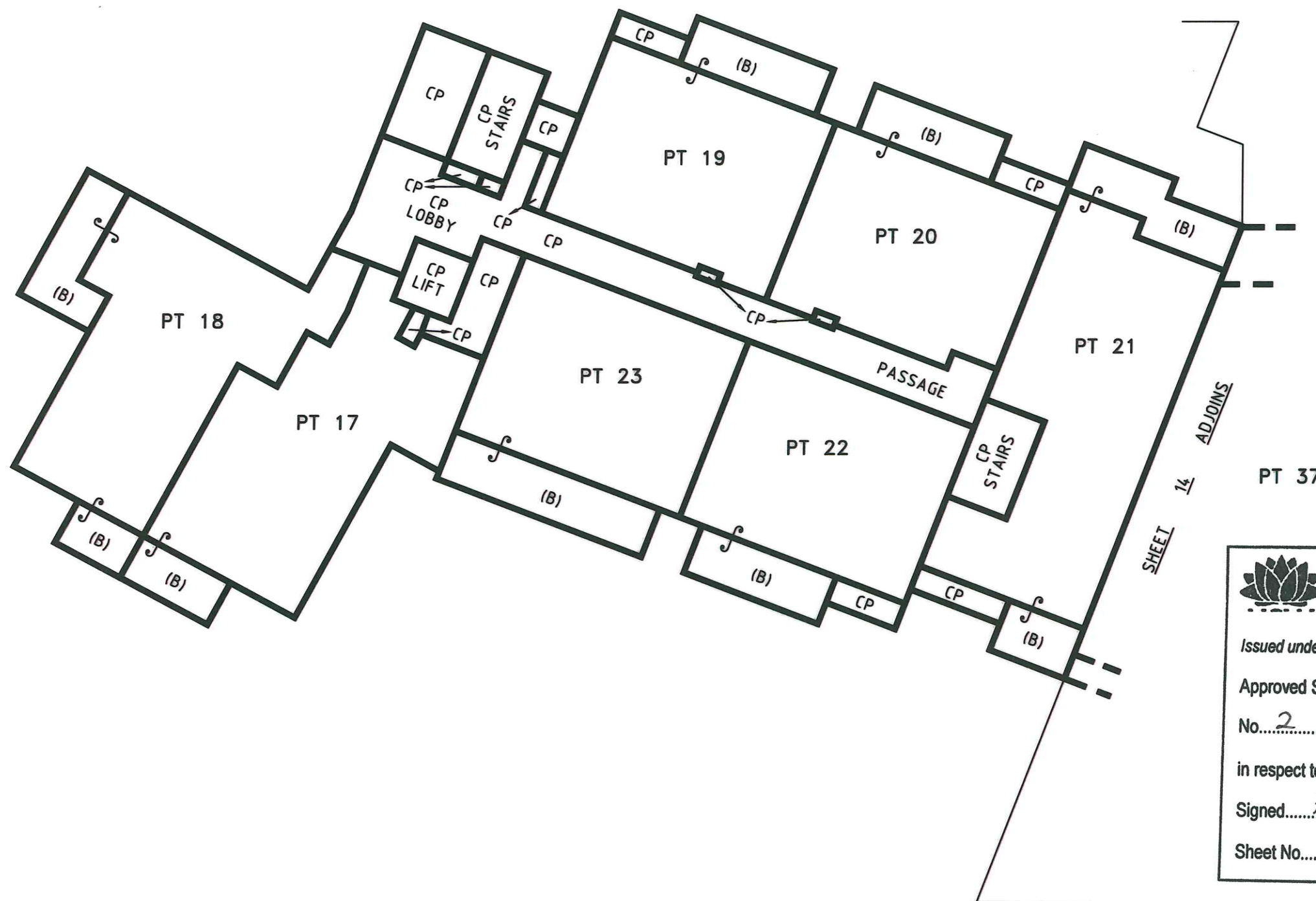

	NSW GOVERNMENT Planning
Issued under the Environmental Planning and Assessment Act 1979	
Approved Section 75W Modification Application	
No. <u>2</u> ..... granted on the <u>09/09/2014</u> .....	
in respect to MP. <u>110046</u> .....	
Signed <u>AWaban</u> .....	
Sheet No. <u>7</u> of <u>18</u> .....	

(B) DENOTES BALCONY  
CP DENOTES COMMON PROPERTY

Surveyor: Wayne Allen Diver-Tuck  
Surveyor's Ref: 124792-EPP-STG3-DA  
Subdivision No:

Lengths are in metres. Reduction Ratio 1:200

Registered

SP

**BUILDING '13'**  
**LEVEL 3**

SEE SHEET 1 FOR  
GENERAL NOTES

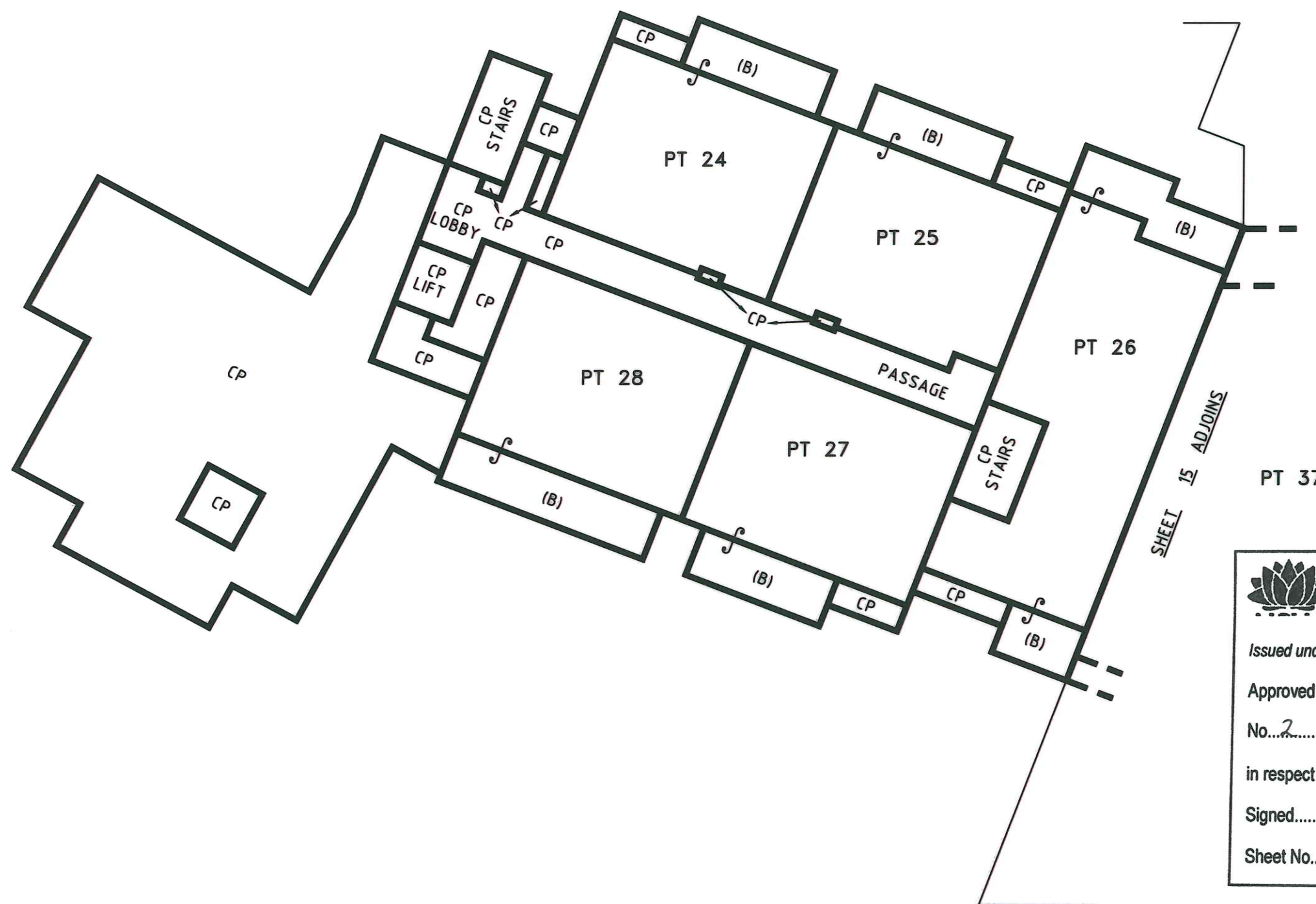

SHEET 15 ADJOINS

SHEET 15 ADJOINS



NSW GOVERNMENT  
Planning

Issued under the Environmental Planning and Assessment Act 1979

Approved Section 75W Modification Application

No. 2 granted on the 09/09/2014

in respect to MP. 11 004 6

Signed: A. Wahan

Sheet No. 8 of 18

(B) DENOTES BALCONY  
CP DENOTES COMMON PROPERTY

Surveyor: Wayne Allen Diver-Tuck  
Surveyor's Ref: 124792-EPP-STG3-DA  
Subdivision No:

Lengths are in metres. Reduction Ratio 1:200

Registered

SP



**BUILDING '13'**  
**LEVEL 4**

SEE SHEET 1 FOR  
GENERAL NOTES

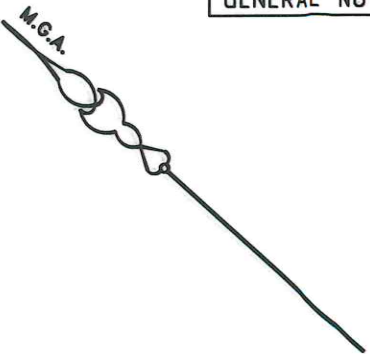

SHEET 16 ADJOINS

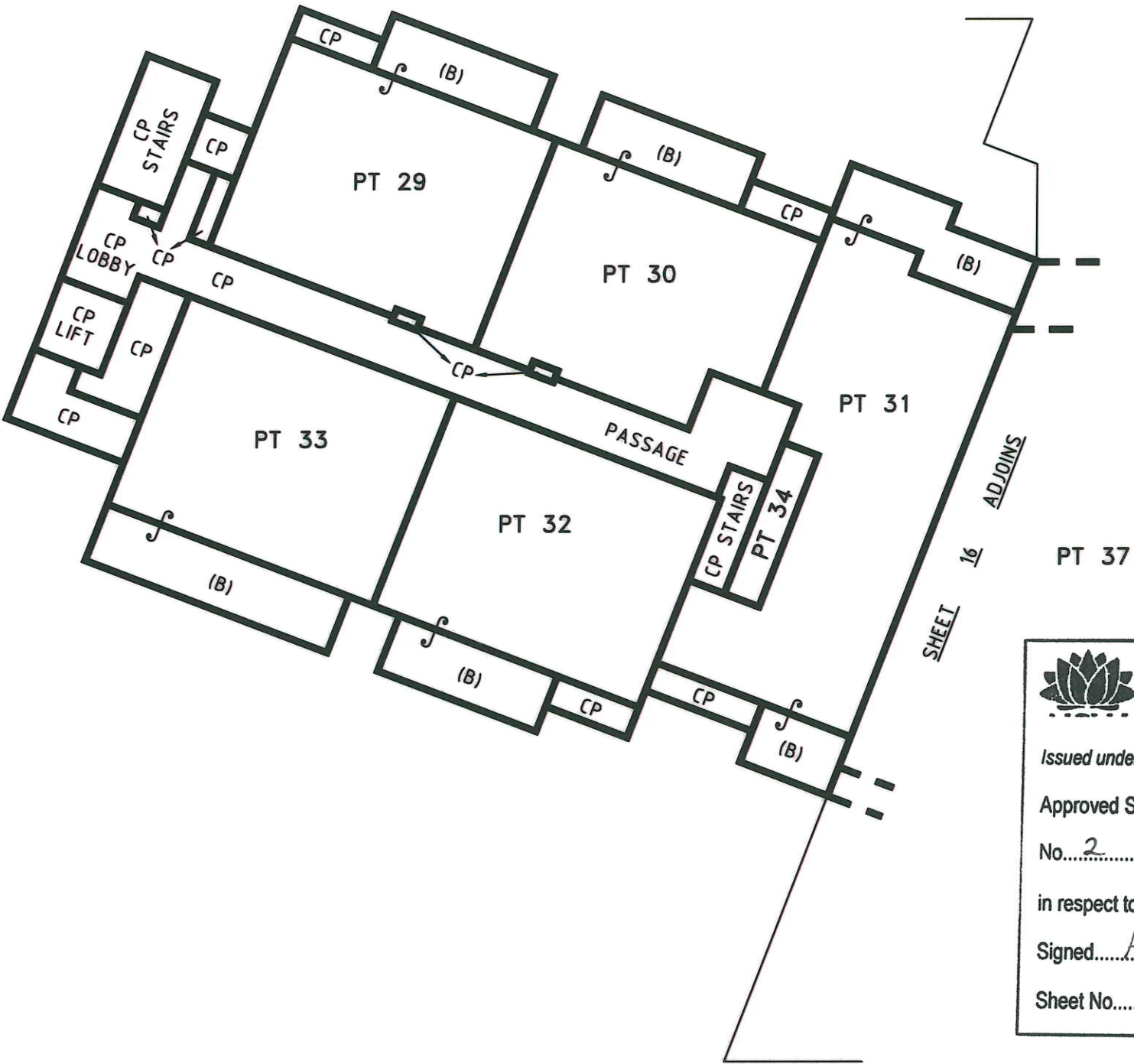

NSW GOVERNMENT  
Planning

Issued under the Environmental Planning and Assessment Act 1979

Approved Section 75W Modification Application

No. 2 granted on the 09/09/2014

in respect to MP 11 0046

Signed: Awaban

Sheet No. 9 of 18

(B) DENOTES BALCONY  
CP DENOTES COMMON PROPERTY

Surveyor: Wayne Allen Diver-Tuck  
Surveyor's Ref: 124792-EPP-STG3-DA  
Subdivision No:

Lengths are in metres. Reduction Ratio 1:200

Registered

SP

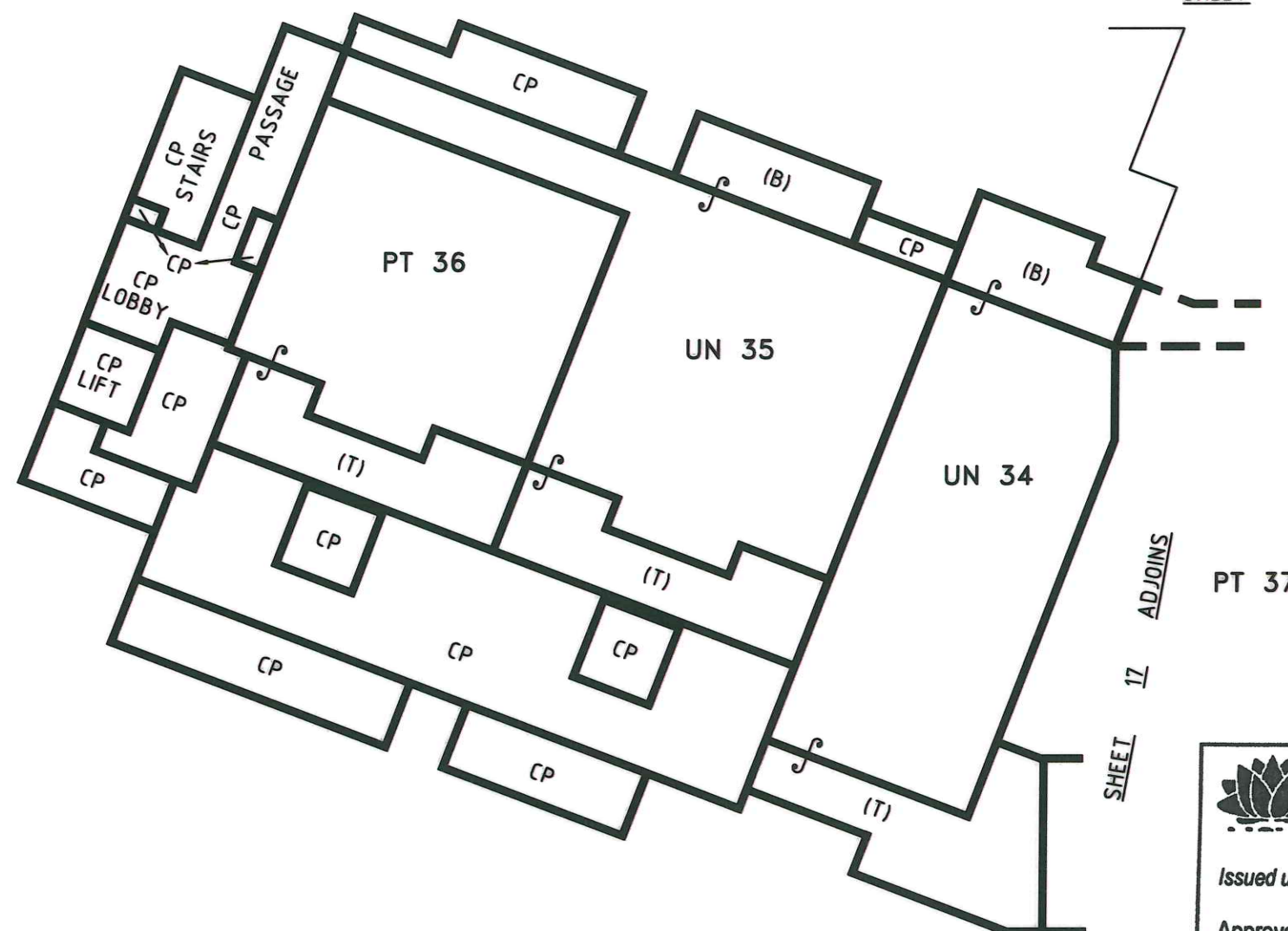
BUILDING '13'  
LEVEL 5SEE SHEET 1 FOR  
GENERAL NOTES

SHEET 17 ADJOINS

SHEET 17 ADJOINS

NSW GOVERNMENT  
Planning

Issued under the Environmental Planning and Assessment Act 1979

Approved Section 75W Modification Application

No. 2 granted on the 09/09/2014

in respect to MP 11-0046

Signed: A. W. A. W. A. W.

Sheet No. 10 of 18

(T) DENOTES TERRACE  
(B) DENOTES BALCONY  
CP DENOTES COMMON PROPERTYSurveyor: Wayne Allen Diver-Tuck  
Surveyor's Ref: 124792-EPP-STG3-DA  
Subdivision No:

Lengths are in metres. Reduction Ratio 1:200

Registered

SP



DEVELOPMENT LOT  
LOWER GROUND LEVEL \ PARKING LEVEL 2

SEE SHEET 1 FOR  
GENERAL NOTES

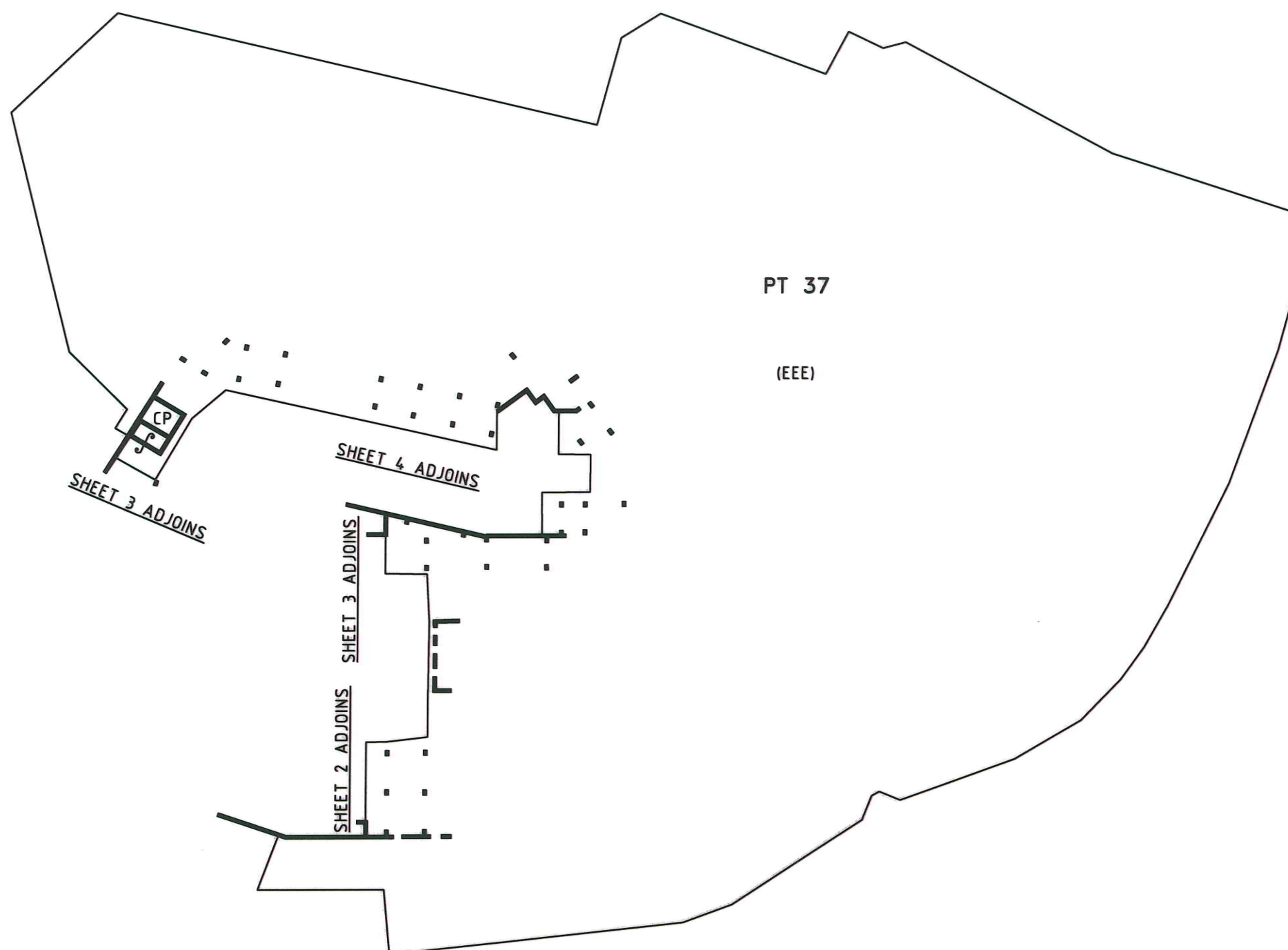

(EEE) EASEMENT FOR EMERGENCY EGRESS VARIABLE WIDTH

LOT 37 IS A DEVELOPMENT LOT  
CP DENOTES COMMON PROPERTY



NSW GOVERNMENT  
Planning

Issued under the Environmental Planning and Assessment Act 1979

Approved Section 75W Modification Application

No. 2 granted on the 09/09/14

in respect to MP 11-004.6

Signed AWahan

Sheet No. 11 of 18

Surveyor: Wayne Allen Diver-Tuck  
Surveyor's Ref: 124792-EPP-STG3-DA  
Subdivision No:

Lengths are in metres. Reduction Ratio 1:700

Registered

SP

**DEVELOPMENT LOT**  
**GROUND LEVEL(BLDG 13)\PARKING LEVEL 1**

SEE SHEET 1 FOR  
GENERAL NOTES

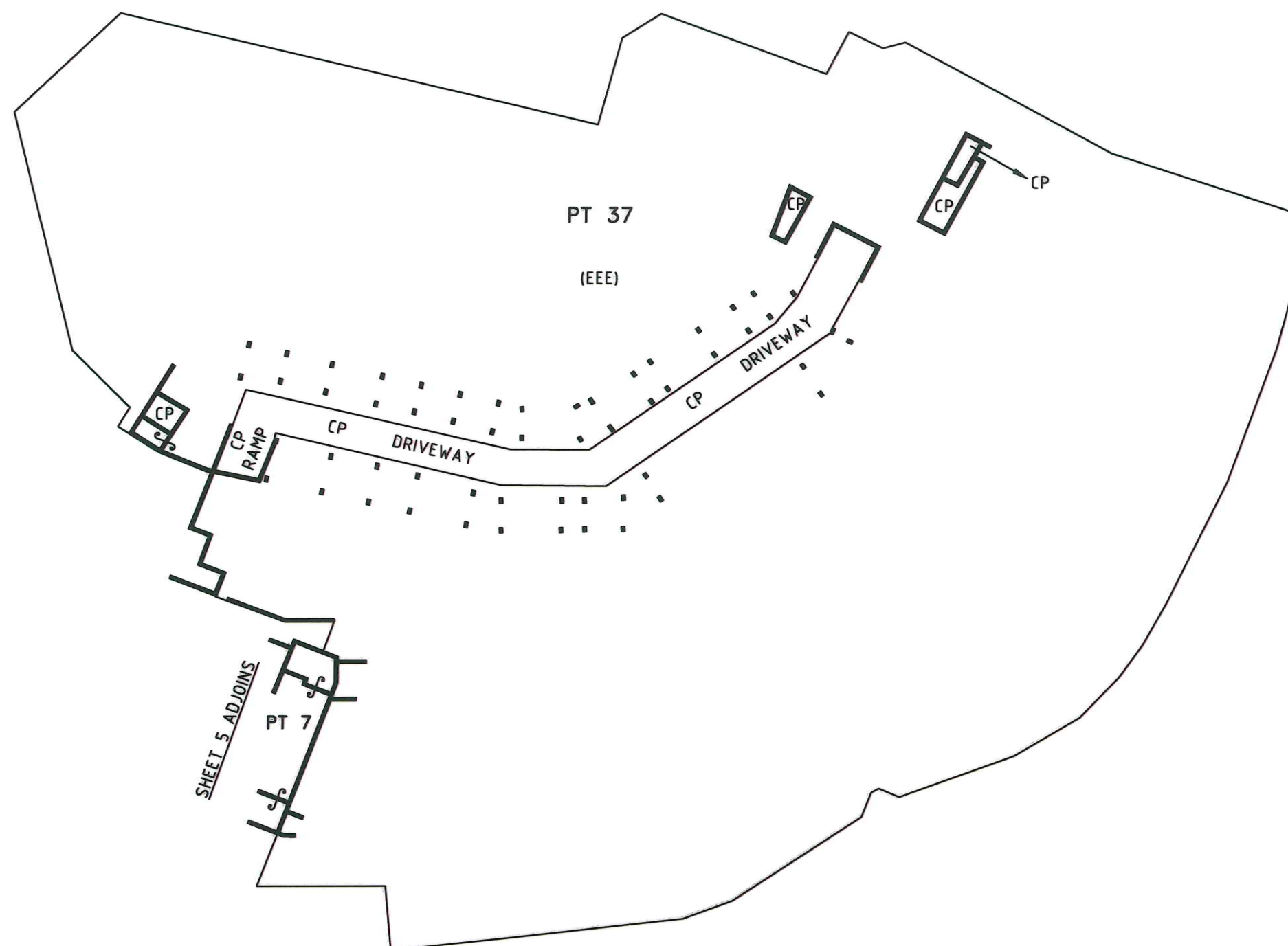

(EEE) EASEMENT FOR EMERGENCY EGRESS VARIABLE WIDTH

LOT 37 IS A DEVELOPMENT LOT  
CP DENOTES COMMON PROPERTY



NSW GOVERNMENT  
Planning

Issued under the Environmental Planning and Assessment Act 1979

Approved Section 75W Modification Application

No. 2 ..... granted on the 09/09/2014

in respect to MP 11-0046

Signed: Awaban

Sheet No. 12 of 18

Surveyor: Wayne Allen Diver-Tuck  
Surveyor's Ref: 124792-EPP-STG3-DA  
Subdivision No:

Lengths are in metres. Reduction Ratio 1:700

Registered

SP



DEVELOPMENT LOT  
LEVEL 1 (BLDG13)

M.G.A.  
SEE SHEET 1 FOR  
GENERAL NOTES

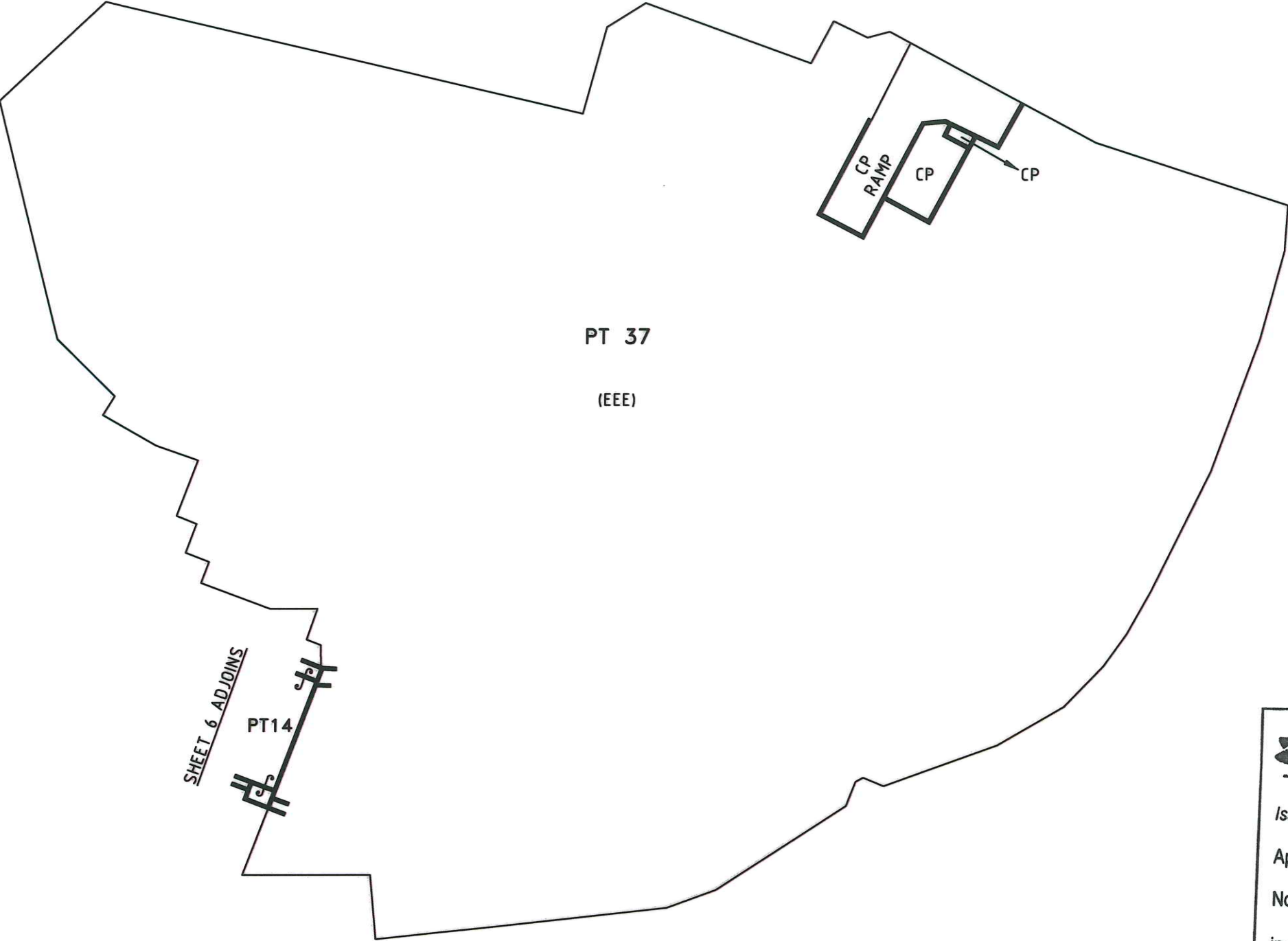



NSW GOVERNMENT  
Planning

Issued under the Environmental Planning and Assessment Act 1979

Approved Section 75W Modification Application

No. 2 ..... granted on the 09/09/2014 .....

in respect to MP 11-0046 .....

Signed A. Wahan .....

Sheet No. 13 ..... of 18 .....

(EEE) EASEMENT FOR EMERGENCY EGRESS VARIABLE WIDTH

LOT 37 IS A DEVELOPMENT LOT  
CP DENOTES COMMON PROPERTY

Surveyor: Wayne Allen Diver-Tuck Surveyor's Ref: 124792-EPP-STG3-DA Subdivision No:  Lengths are in metres. Reduction Ratio 1:700	Registered	SP
---	------------	----

DEVELOPMENT LOT  
LEVEL 2 (BLDG13)

M.G.A.  
SEE SHEET 1 FOR  
GENERAL NOTES



LOT 37 IS A DEVELOPMENT LOT  
CP DENOTES COMMON PROPERTY



NSW GOVERNMENT  
Planning

Issued under the Environmental Planning and Assessment Act 1979

Approved Section 75W Modification Application

No. 2 granted on the 09/09/2014

in respect to MP 11-0046

Signed AWahan

Sheet No. 14 of 18

Surveyor: Wayne Allen Diver-Tuck  
Surveyor's Ref: 124792-EPP-STG3-DA  
Subdivision No:

Registered

SP

Lengths are in metres. Reduction Ratio 1: 700

10	20	30	40	50	Table of mm	90	100	110	120	130	140
----	----	----	----	----	-------------	----	-----	-----	-----	-----	-----



DEVELOPMENT LOT  
LEVEL 3 (BLDG13)

SEE SHEET 1 FOR  
GENERAL NOTES

PT 37

SHEET 8 ADJOINS

PT26



NSW GOVERNMENT  
Planning

Issued under the Environmental Planning and Assessment Act 1979

Approved Section 75W Modification Application

No. 2 ..... granted on the 09/09/2014 .....

in respect to MP 11 0046 .....

Signed AWahan .....

Sheet No. 15 of 18 .....

LOT 37 IS A DEVELOPMENT LOT  
CP DENOTES COMMON PROPERTY

Surveyor: Wayne Allen Diver-Tuck  
Surveyor's Ref: 124792-EPP-STG3-DA  
Subdivision No:

Lengths are in metres. Reduction Ratio 1:700

Registered

SP

DEVELOPMENT LOT  
LEVEL 4 (BLDG13)

SEE SHEET 1 FOR  
GENERAL NOTES

PT 37

SHEET 9 ADJOINS

PT31

LOT 37 IS A DEVELOPMENT LOT  
CP DENOTES COMMON PROPERTY



NSW GOVERNMENT  
Planning

Issued under the Environmental Planning and Assessment Act 1979

Approved Section 75W Modification Application

No. 2 granted on the 09/09/2014

in respect to MP 11-0046

Signed AWaban

Sheet No. 16 of 18

Surveyor: Wayne Allen Diver-Tuck  
Surveyor's Ref: 124792-EPP-STG3-DA  
Subdivision No:

Lengths are in metres. Reduction Ratio 1:700

Registered

SP



DEVELOPMENT LOT  
LEVEL 5 (BLDG13)

M.G.A.  
SEE SHEET 1 FOR  
GENERAL NOTES



LOT 37 IS A DEVELOPMENT LOT  
CP DENOTES COMMON PROPERTY



NSW GOVERNMENT  
Planning

Issued under the Environmental Planning and Assessment Act 1979

Approved Section 75W Modification Application

No. 2 ..... granted on the 09/09/2014

in respect to MP 11 0046

Signed A. Vahan

Sheet No. 17 of 18

Surveyor: Wayne Allen Diver-Tuck  
Surveyor's Ref: 124792-EPP-STG3-DA  
Subdivision No:

Lengths are in metres. Reduction Ratio 1:700

Registered

SP

DEVELOPMENT LOT  
ABOVE LEVEL 5 (BLDG13)

M.G.A.  
SEE SHEET 1 FOR  
GENERAL NOTES



PT 37



NSW GOVERNMENT  
Planning

Issued under the Environmental Planning and Assessment Act 1979

Approved Section 75W Modification Application

No. 2 granted on the 09/09/2014

in respect to MP 11-0046

Signed Awaban

Sheet No. 18 of 18

LOT 37 IS A DEVELOPMENT LOT  
CP DENOTES COMMON PROPERTY

Surveyor: Wayne Allen Diver-Tuck  
Surveyor's Ref: 124792-EPP-STG3-DA  
Subdivision No:

Lengths are in metres. Reduction Ratio 1:700

Registered

SP