

Shadow Diagram Proposed
21 December 9am
1:2000

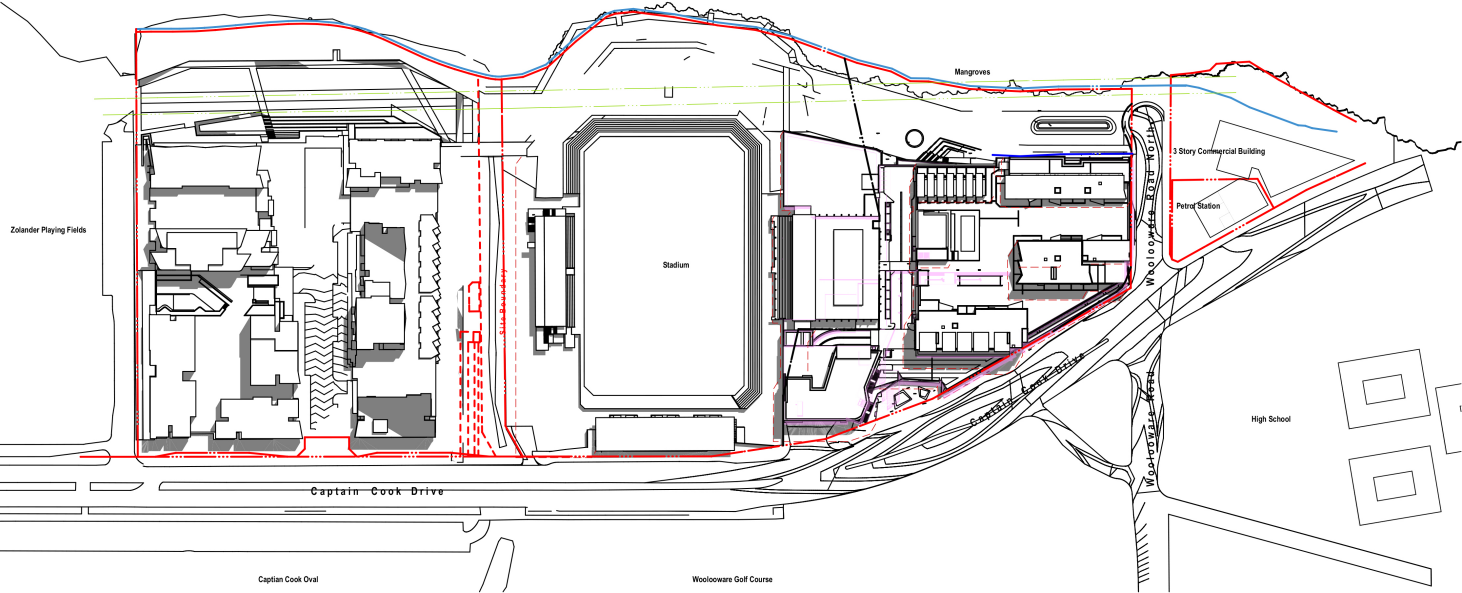

Shadow Diagram Proposed
21 December 12pm
1:2000

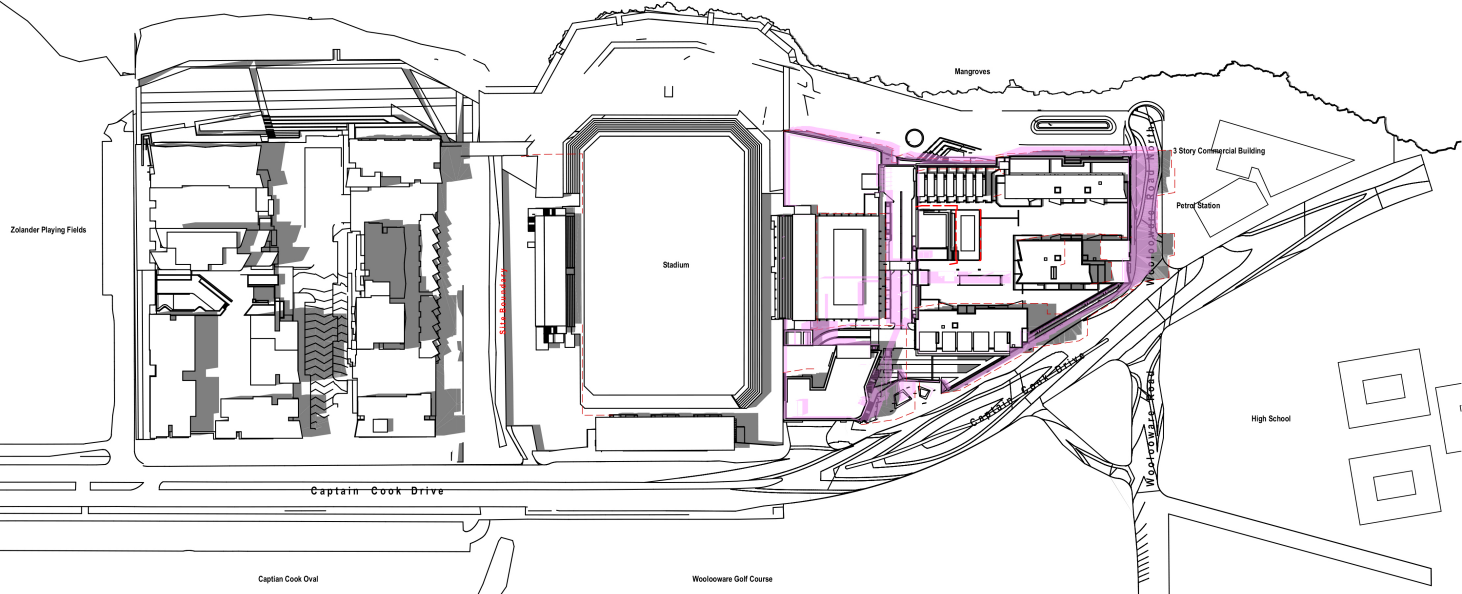

Shadow Diagram Proposed
21 December 3pm
1:2000

NOTES
THIS DRAWING IS THE COPYRIGHT © OF TURNER. NO REPRODUCTION WITHOUT PERMISSION. UNLESS NOTED OTHERWISE THIS DRAWING IS NOT FOR CONSTRUCTION. ALL DIMENSIONS AND LEVELS ARE TO BE CHECKED ON SITE PRIOR TO THE COMMENCEMENT OF WORK. INFORM TURNER OF ANY DISCREPANCIES FOR CLARIFICATION BEFORE PROCEEDING WITH WORK. DRAWINGS ARE NOT TO BE SCALED. USE ONLY DIMENSIONS REFERRED TO IN CONSULTANT DOCUMENTATION FOR FURTHER INFORMATION. DWG, PDF AND DWG FILES ARE UNCONTROLLED DOCUMENTS AND ARE ISSUED FOR INFORMATION ONLY.

CLIC Quality Endorsed Company ISO 9001:2008, License Number 4188
Notified Architect Nicholas Turner 3009, ARB 90 084 004 011

KEY PLAN

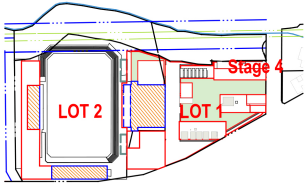

LEGEND

- Main building Envelope Shadow
- Illustrative Scheme Shadow
- Approved Concept Plan Illustrative Shadow

NOTE:
1. SHADOWS GENERATED USING ARCHI CAD 17
2. THIS MODEL IS INDICATIVE ONLY. IT IS INTENDED TO PROVIDE AN UNDERSTANDING OF THE PROPOSED INDICATIVE SCHEME AND ITS IMPACT ON THE SHADOWING OF THE AREA.



Rev.	Date	Approved by	Revision Notes
K	23.09.16	JM	For S75W Submission
L	01.12.16	JM	Updated S75W Submission

CLIENT
Bluestone Capital Ventures No. 1 PL
Suite 1, Level 6, 71 Macquarie St Sydney NSW 2000 AU

RETAIL ARCHITECTS
HDR Rise Drafting
Level 1, 110 Walker Street, North Sydney NSW 2060 AU

Project Title
Bay Central Uplift - Concept Plan
Captain Cook Drive Woollooware NSW 2230 AU

Drawing Title
Illustrative Shadow Diagrams
Shadow Diagrams Dec 21st

Scale	Project No.	Drawn by	North
1:5000, 1:2000 @A1, 50% @A3	14020	PM, AT, JM	↑
Status	Dwg No.	Rev	
S75W Submission	S6-A-507-004	L	

turner.

Level 7, ONE Oxford Street
Sydney NSW 2010
Australia

T +61 2 8668 0300
F +61 2 8668 0388
turnerstudio.com.au