

| Rev. | Date | Approved by | Revision Notes |
|------|----------|-------------|-------------------------|
| A | 25.05.17 | JM | For Information |
| B | 23.06.17 | JM | For S7SW Submission |
| C | 12.07.17 | JM | Updated S7SW Submission |

CLIENT
Bluestone Capital Ventures No. 1 PL
Suite 1, Level 6, 71 Macquarie St Sydney NSW 2000 AU
RETAIL ARCHITECTS
HCR Rice & Co
Level 1, 110 Walker Street, North Sydney NSW 2060 AU
Project Title

Bay Central Uplift - Concept Plan
Captain Cook Drive Woollooware NSW 2230 AU

Drawing Title
Report Diagrams - Residential Access

| Scale | Project No. | Drawn by | North |
|------------------|--------------|------------|-------|
| 1:1 @A1, 50% @A3 | 14020 | PM, AT, JM | ↑ |
| Status | Dwg No. | Rev | |
| S7SW Submission | S6-A-727-003 | C | |

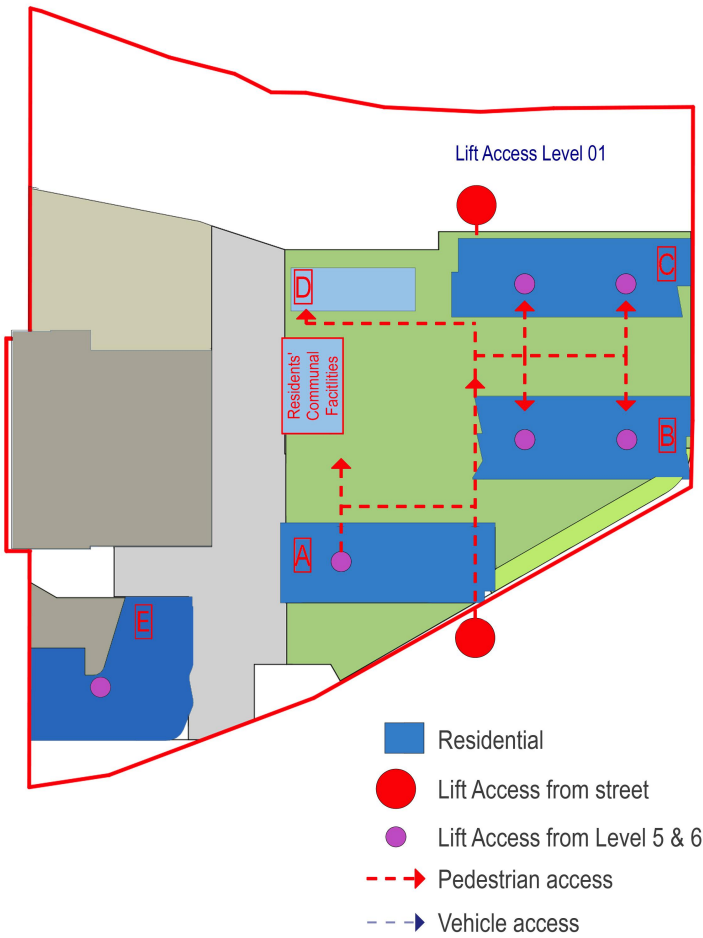

RESIDENTIAL ACCESS - LEVEL 7



| Rev. | Date | Approved by | Revision Notes |
|------|----------|-------------|-------------------------|
| A | 25.05.17 | JM | For Information |
| B | 23.06.17 | JM | For S7SW Submission |
| C | 12.07.17 | JM | Updated S7SW Submission |

CLIENT
Bluestone Capital Ventures No. 1 PL
Suite 1, Level 6, 71 Macquarie St Sydney NSW 2000 AU
RETAIL ARCHITECTS
HCR Roca Architects
Level 1, 110 Walker Street, North Sydney NSW 2060 AU
Project Title

Bay Central Uplift - Concept Plan
Captain Cook Drive Woollooware NSW 2230 AU

Drawing Title
Report Diagrams - Residential Access

| Scale | Project No. | Drawn by | North |
|------------------|--------------|------------|-------|
| 1:1 @A1, 50% @A3 | 14020 | PM, AT, JM | ↑ |
| Status | Dwg No. | Rev | |
| S7SW Submission | S6-A-729-004 | C | |