

*Medical and day surgery*  
*Pharmacy*  
*Health and Fitness Centre*  
*Advice*  
*Aerobics*  
*Swimming*  
*Weights*  
*Yoga*





## Health & Wellbeing

Health & Wellbeing is a pivotal precinct of Woollooware Bay. It is a place for people to look after their bodies and receive health advice, treatments or to indulge themselves.

The space is anchored to the Medical Centre, with associated shops and services clustered around. Pharmacies, day-spas and salons provide additional services and reinforce the health focus of this area.

Health & Wellbeing incorporates a large leisure and fitness centre on the ground level, flanking the pedestrian link from the Entry Forecourt to the Waterfront. The leisure centre opens out onto the Waterfront.





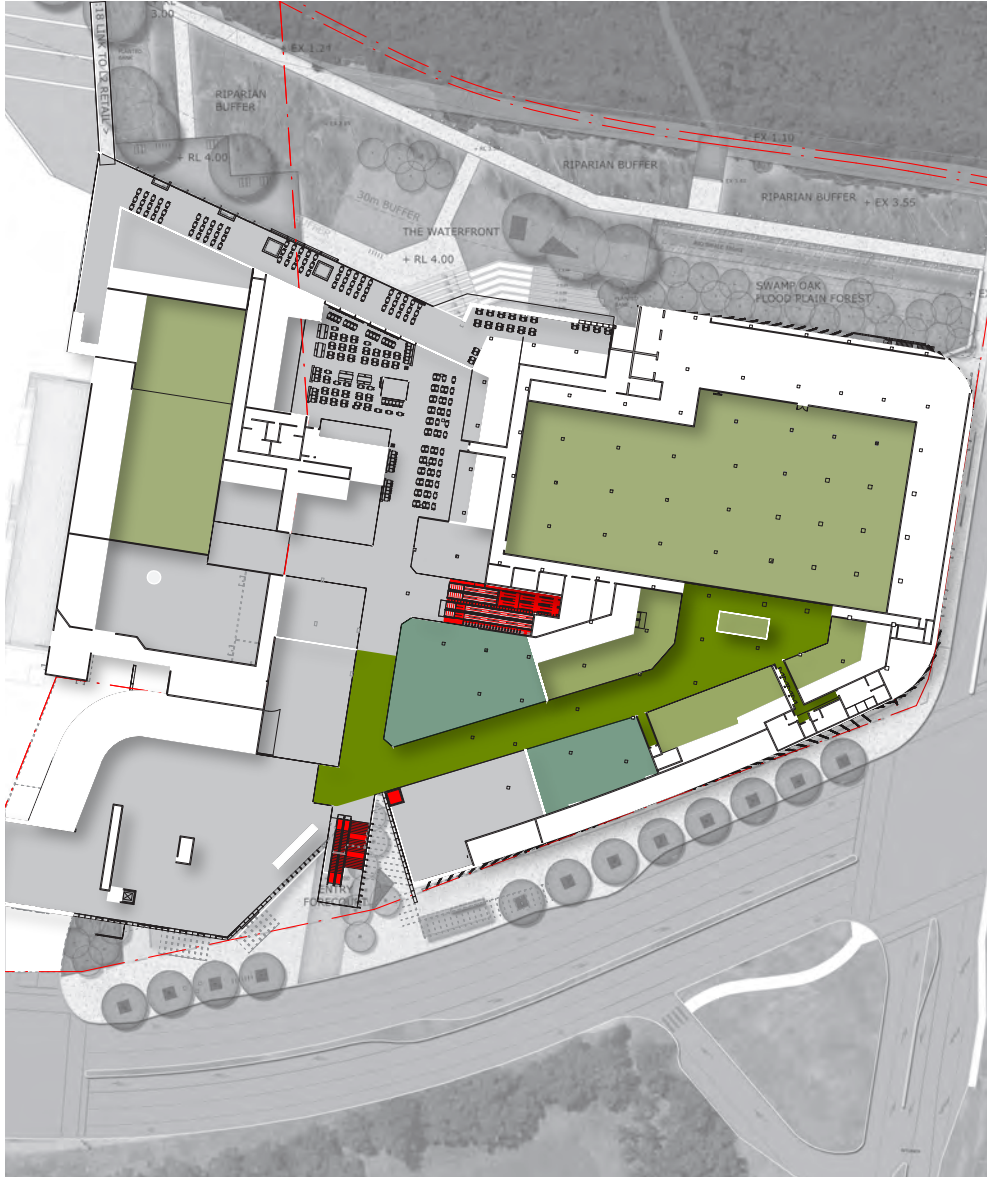

Groceries  
Services  
Shops along arcade





## Everyday Shopping & Services

Everyday Shopping is the cornerstone of the Woollooware Bay shopping experience. It is the place to do a weekly shop and to nip into the newsagent or the florist.

Everyday Shopping is connected to the Entrance Forecourt, Health & Wellbeing and the Market Hall. It houses an anchor supermarket and a range of other service and lifestyle retail offers. It is a busy, active space.

Everyday Shopping is a well-lit, open space; flanked on both sides by brightly lit shops. It carries the timber theme through the centre.

