

ACCESS TO TRAIN STATION

Status	For DA	
Nom. Landscape Architect	Andrew Turnbull 673	
Print Date	6 October 2011	
Rev	Description	Date
A	For DA	06.10.11

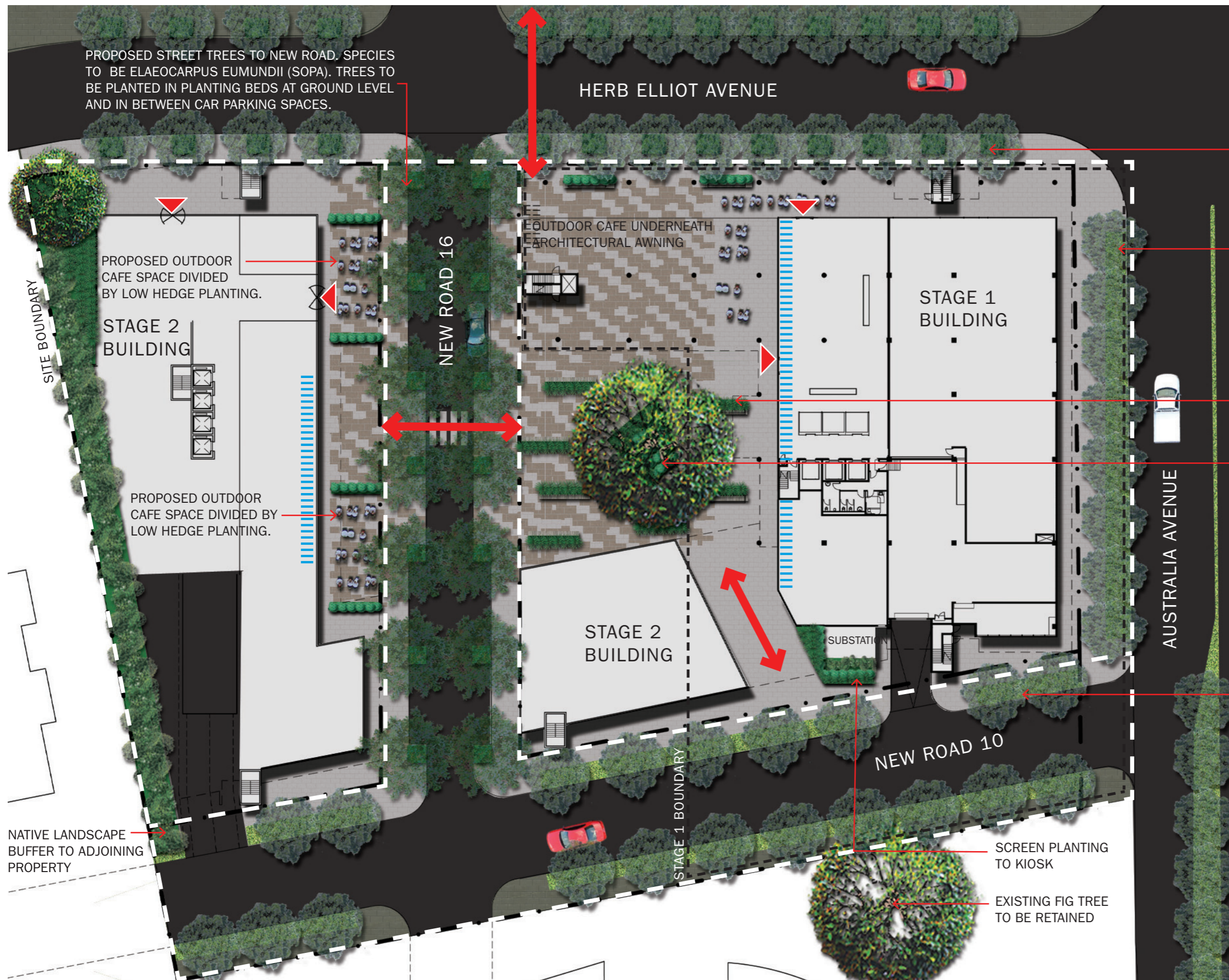

EXISTING STREET TREES TO BE RETAINED WITH NEW PLANTER BEDS UNDERNEATH TO MATCH STYLE ON OTHER SIDE OF THE ROAD.

EXISTING STREET TREES TO BE RETAINED.

PROPOSED STRIPS OF LANDSCAPE WITH LOW FEATURE PLANTING AND TIMBER SEAT ELEMENT.

LARGE FEATURE TREE IN RAISED PLANTER (450MM) TO DOUBLE AS CENTRAL SEAT ELEMENT. TIMBER SEAT BUILT INTO SIDE OF PLANTER TO PROVIDE SHADED SEATING AND 'MEETING POINT' FOR CENTRAL SQUARE.

PROPOSED STREET TREES TO NEW ROAD. SPECIES TO BE EUCALYPTUS CITRIODORA (SOPA).

Legend

- ||||| Active frontage
- ▲ Building entry point
- ← Pedestrian access

