

METCASH DISTRIBUTION CENTRE
PROJECT MUSTANG
BUNGARRIBEE INDUSTRIAL ESTATE, HUNTINGWOOD NSW
CIVIL WORKS PACKAGE FOR DEVELOPMENT APPLICATION

DRAWING LIST

DRAWING NO.	DRAWING TITLE
Co9628.03- DA10	DRAWING LIST & GENERAL NOTES
Co9628.03- DA15	SITE MASTER PLAN
Co9628.03- DA20	EROSION AND SEDIMENT CONTROL PLAN & DETAILS
Co9628.03- DA40	CONCEPT STORMWATER DRAINAGE PLAN - STAGE 5A/5B
Co9628.03- DA41	CONCEPT STORMWATER DRAINAGE PLAN - STAGE 5C
Co9628.03- DA45	CONCEPT STORMWATER DRAINAGE DETAILS
Co9628.03- DA50	FINISHED LEVELS PLAN - STAGE 5A/5B
Co9628.03- DA51	FINISHED LEVELS PLAN - STAGE 5C

GENERAL NOTES:

- G1 THESE DRAWINGS SHALL BE READ IN CONJUNCTION WITH ALL ARCHITECTURAL AND OTHER CONSULTANTS' DRAWINGS AND SPECIFICATIONS AND WITH SUCH OTHER WRITTEN INSTRUCTIONS AS MAY BE ISSUED DURING THE COURSE OF THE CONTRACT. ANY DISCREPANCY SHALL BE REFERRED TO THE ENGINEER BEFORE PROCEEDING WITH THE WORK.
- G2 ALL MATERIALS AND WORKMANSHIP SHALL BE IN ACCORDANCE WITH THE RELEVANT AND CURRENT STANDARDS AUSTRALIA CODES AND WITH THE BY-LAWS AND ORDINANCES OF THE RELEVANT BUILDING AUTHORITIES EXCEPT WHERE VARIED BY THE PROJECT SPECIFICATION.
- G3 ALL DIMENSIONS SHOWN SHALL BE VERIFIED BY THE BUILDER ON SITE. ENGINEER'S DRAWINGS SHALL NOT BE SCALED FOR DIMENSIONS. ENGINEER'S DRAWINGS ISSUED IN ANY ELECTRONIC FORMAT MUST NOT BE USED FOR DIMENSIONAL SETOUT. REFER TO THE ARCHITECT'S DRAWINGS FOR ALL DIMENSIONAL SETOUT INFORMATION.
- G4 DURING CONSTRUCTION THE STRUCTURE SHALL BE MAINTAINED IN A STABLE CONDITION AND NO PART SHALL BE OVERSTRESSED. TEMPORARY BRACING SHALL BE PROVIDED BY THE BUILDER TO KEEP THE WORKS AND EXCAVATIONS STABLE AT ALL TIMES.
- G5 UNLESS NOTED OTHERWISE ALL LEVELS ARE IN METRES AND ALL DIMENSIONS ARE IN MILLIMETRES.
- G6 ALL WORKS SHALL BE UNDERTAKEN IN ACCORDANCE WITH ACCEPTABLE SAFETY STANDARDS & APPROPRIATE SAFETY SIGNS SHALL BE INSTALLED AT ALL TIMES DURING THE PROGRESS OF THE JOB.

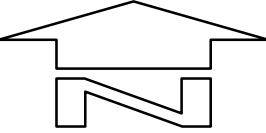

LOCATION PLAN
N.T.S.

FOR DEVELOPMENT APPLICATION

FOR DEVELOPMENT APPLICATION	07.11.12	D
FOR DEVELOPMENT APPLICATION	24.10.12	C
FOR DEVELOPMENT APPLICATION	22.10.12	B
FOR INFORMATION ONLY	14.08.12	A
AMENDMENTS	DATE	ISSUE

ARCHITECT
GILES TRIBE ARCHITECTS
LEVEL 8, 263 CLARENCE STREET
SYDNEY NSW 2000

CLIENT
 LEVEL 10,
60 Castlereagh Street
SYDNEY
NSW, 2000, Australia
Tel: (02) 9230 7400
Fax: (02) 9230 7444

PROJECT
METCASH DISTRIBUTION CENTRE
PROJECT MUSTANG
BUNGARRIBEE I.E., HUNTINGWOOD NSW

DESIGNED M.W.	DRAWN M.C.	DATE 07.08.12	CHECKED	SIZE B1	SCALE AS SHOWN	CAD REF: Co9628.03-DA10
------------------	---------------	------------------	---------	------------	-------------------	----------------------------



Costin Roe Consulting Pty Ltd.
Consulting Engineers
Level 1, 8 Windmill Street
Walsh Bay, Sydney NSW 2000
Tel: (02) 9251-7699 Fax: (02) 9251-3731
email: mail@costinroe.com.au @

Costin Roe Consulting

Value in Engineering and Management

DRAWING TITLE
DRAWING LIST AND GENERAL
NOTES

DRAWING No
Co9628.03-DA10

ISSUE
D



SITE MASTER PLAN
1:750

FOR DEVELOPMENT APPLICATION

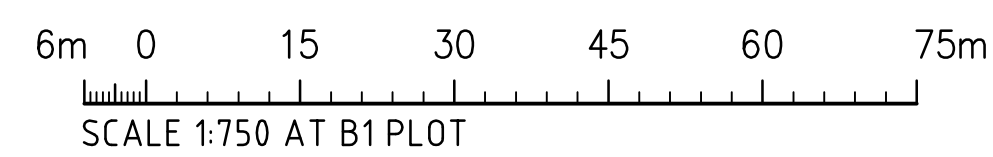

FOR DEVELOPMENT APPLICATION	07.11.12	E			
FOR DEVELOPMENT APPLICATION	24.10.12	D			
FOR DEVELOPMENT APPLICATION	22.10.12	C			
REVISION AS CLOUDED	24.08.12	B			
FOR INFORMATION ONLY	16.08.12	A			
AMENDMENTS	DATE	ISSUE	AMENDMENTS	DATE	ISSUE

ARCHITECT
GILES TRIBE ARCHITECTS
LEVEL 8, 263 CLARENCE STREET
SYDNEY NSW 2000

CLIENT
Goodman
LEVEL 10,
60 Castlereagh Street
SYDNEY
NSW, 2000, Australia
Tel: (02) 9230 7400
Fax: (02) 9230 7444

PROJECT
**METCASH DISTRIBUTION CENTRE
PROJECT MUSTANG**
BUNGARRIBEE I.E., HUNTINGWOOD NSW

DESIGNED M.W.	DRAWN M.C.	DATE 07.08.12	CHECKED B1	SCALE AS SHOWN	CAD REF: Co9628-03-DAT5
------------------	---------------	------------------	---------------	-------------------	----------------------------

Costin Roe Consulting Pty Ltd.
Consulting Engineers
Level 1, 8 Windmill Street
Walsh Bay, Sydney NSW 2000
Tel: (02) 9251-7699 Fax: (02) 9241-3731
email: mail@costinroe.com.au @

Value in Engineering and Management

Costin Roe Consulting

DRAWING TITLE
SITE MASTER PLAN

DRAWING No
Co9628.03-DA15

ISSUE
E

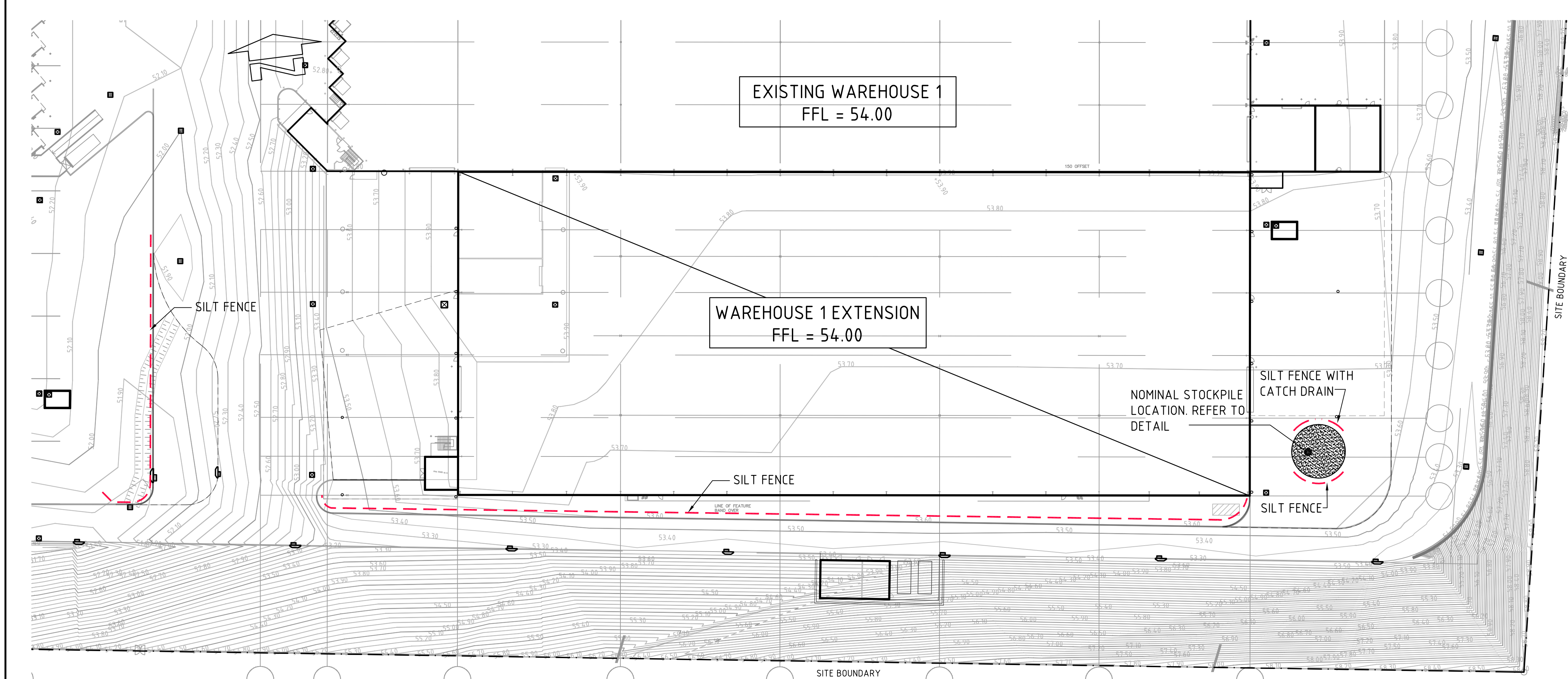

EROSION AND SEDIMENT CONTROL PLAN - WAREHOUSE 1 EXTENSION
1:500

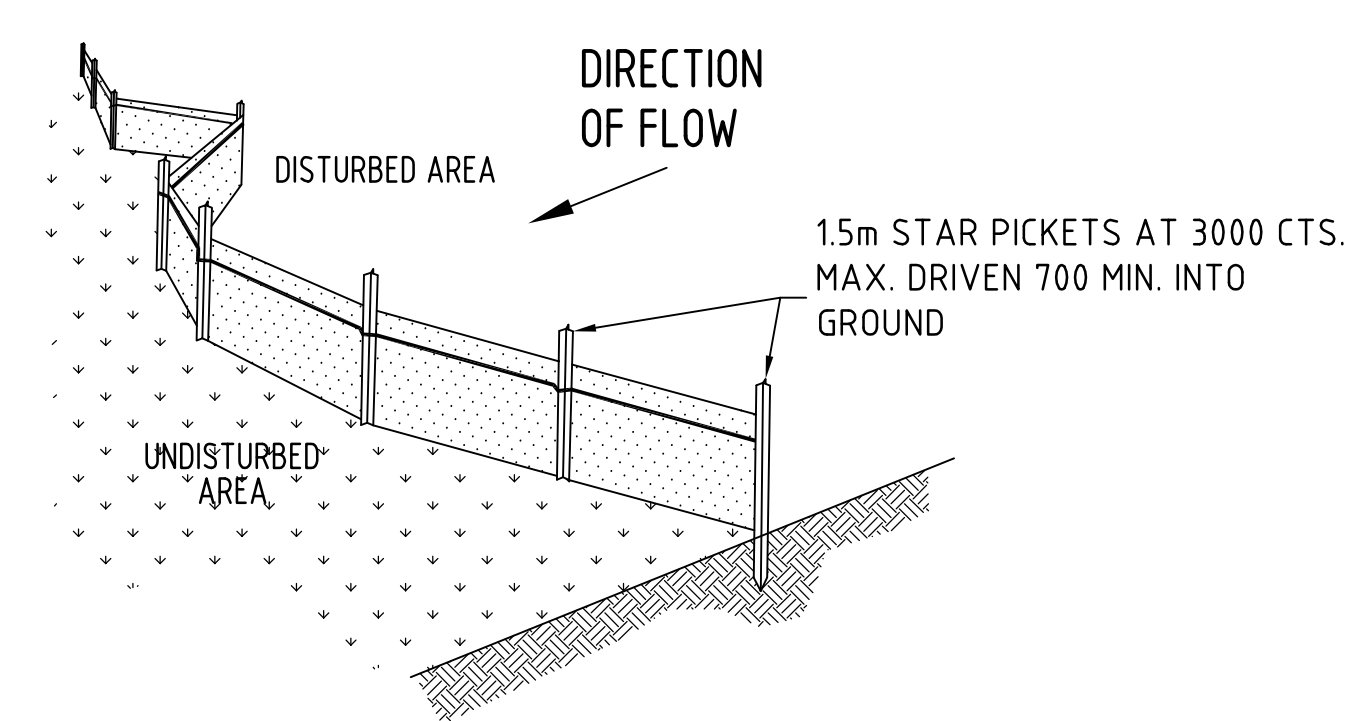

TYPICAL SILT FENCE DETAIL
N.T.S.
PROVIDE 1m RETURNS AT 30m INTERVALS.
TYPICAL

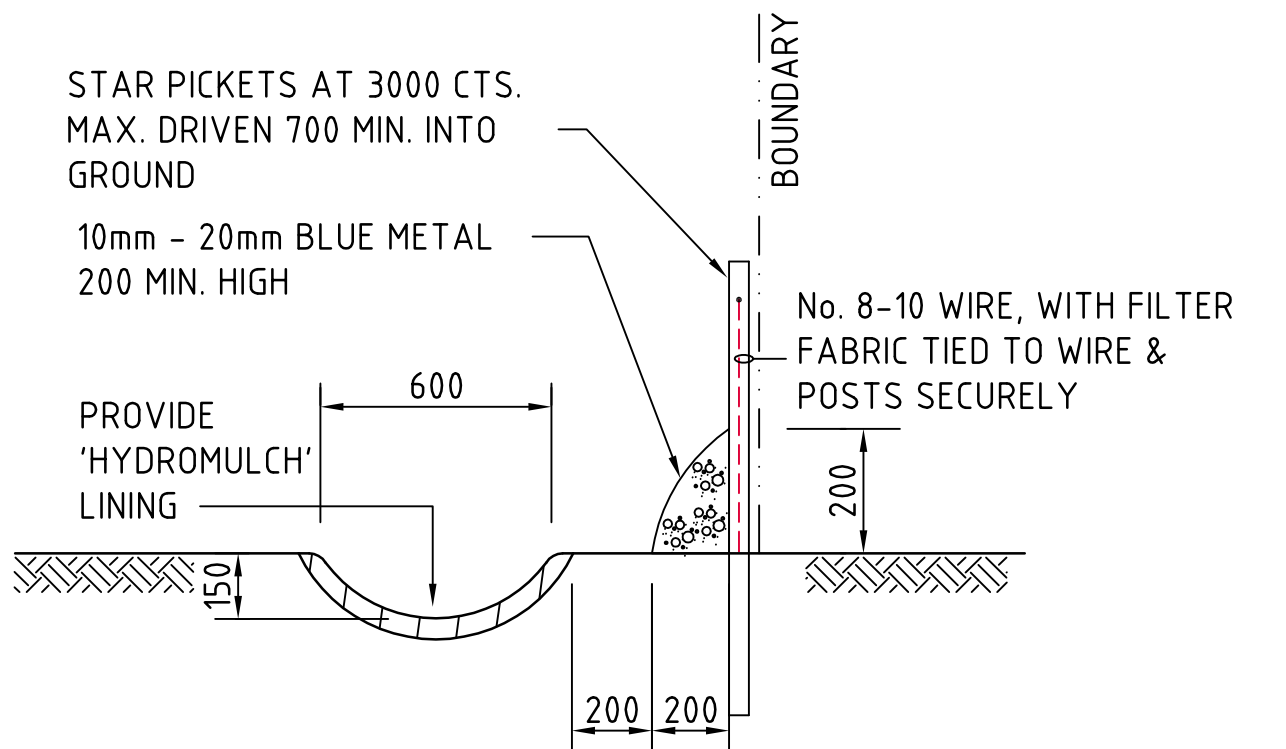

TYPICAL OPEN DRAIN & SILT FENCE
SCALE 1:20

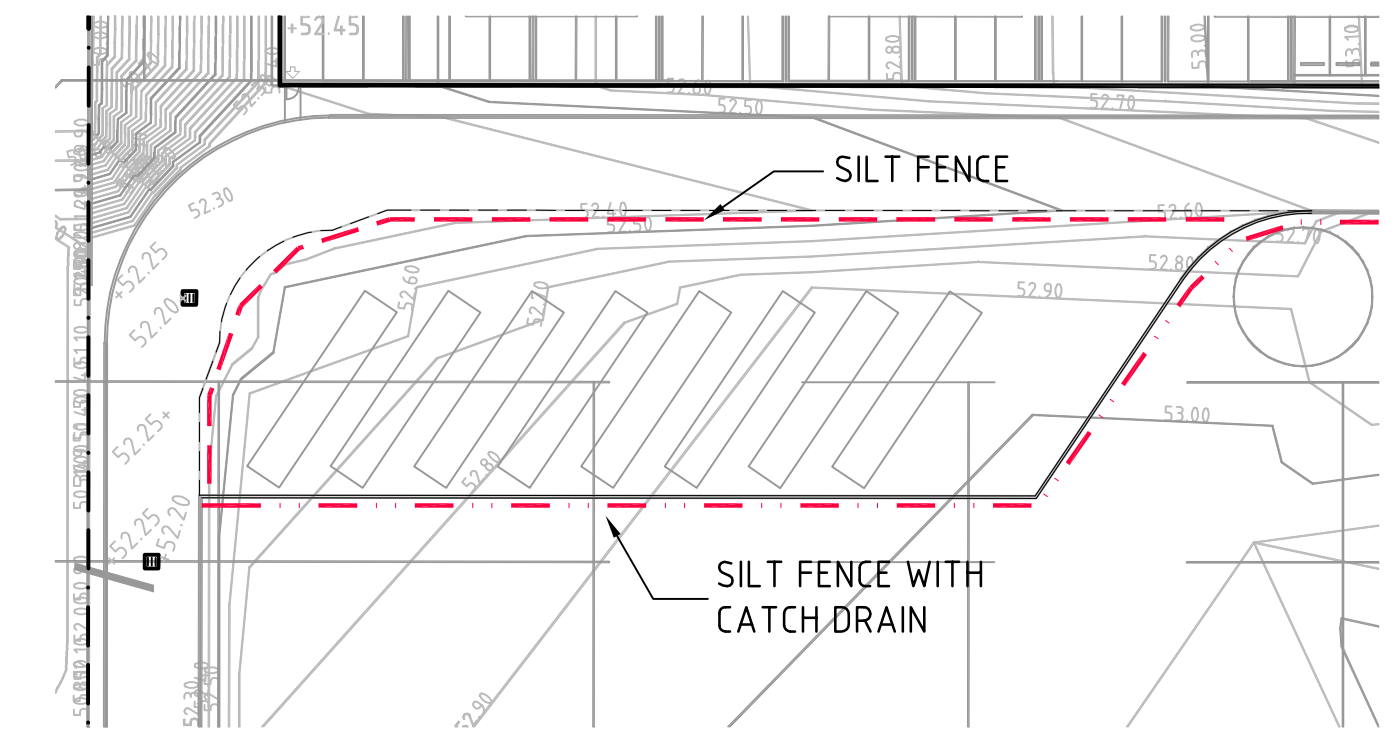

EROSION AND SEDIMENT CONTROL PLAN - TRAILER PARKING AREA
1:500

- STOCKPILE NOTES**
1. PLACE ALL STOCKPILES IN LOCATIONS MORE THAN 5m FROM EXISTING VEGETATION, ROADS & HAZARD AREAS.
 2. CONSTRUCT ON THE CONTOUR AS LOW, FLAT ELONGATED MOUNDS. SIDE SLOPE TO BE 1 V: 2 H MAX.
 3. WHERE THERE IS SUFFICIENT AREA, TOPSOIL STOCKPILES SHALL BE LESS THAN 2m IN HEIGHT.
 4. WHERE STOCKPILES ARE TO BE IN PLACE FOR MORE THAN 10 DAYS, STABILISE USING WOOD CHIP MULCH - 16 TONNE/Ha.
 5. CONSTRUCT SILT FENCE WITH CATCH DRAIN ON UPSLOPE SIDE TO DIVERT WATER AROUND STOCKPILES & SILT FENCE ONLY 1 TO 2m DOWNSLOPE AS SHOWN.

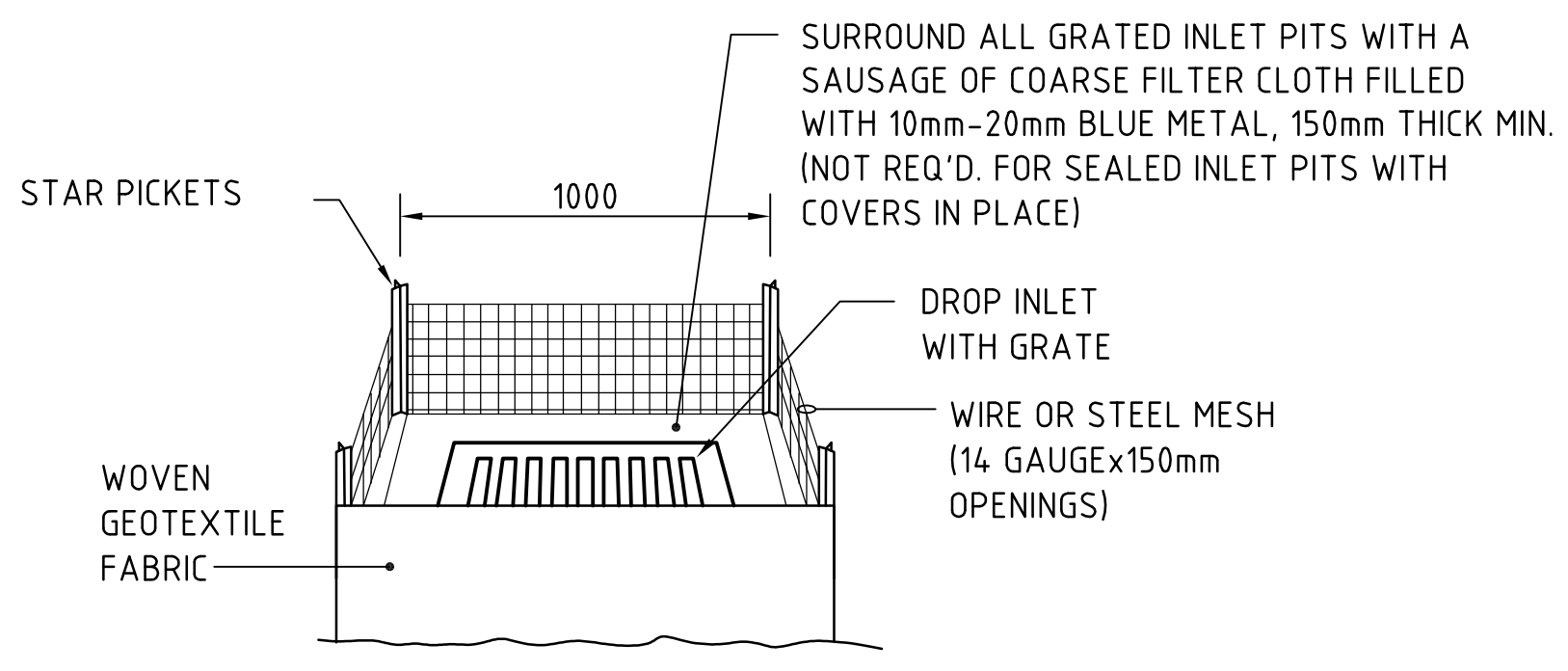

GRATED INLET PIT FILTER DETAIL
N.T.S.

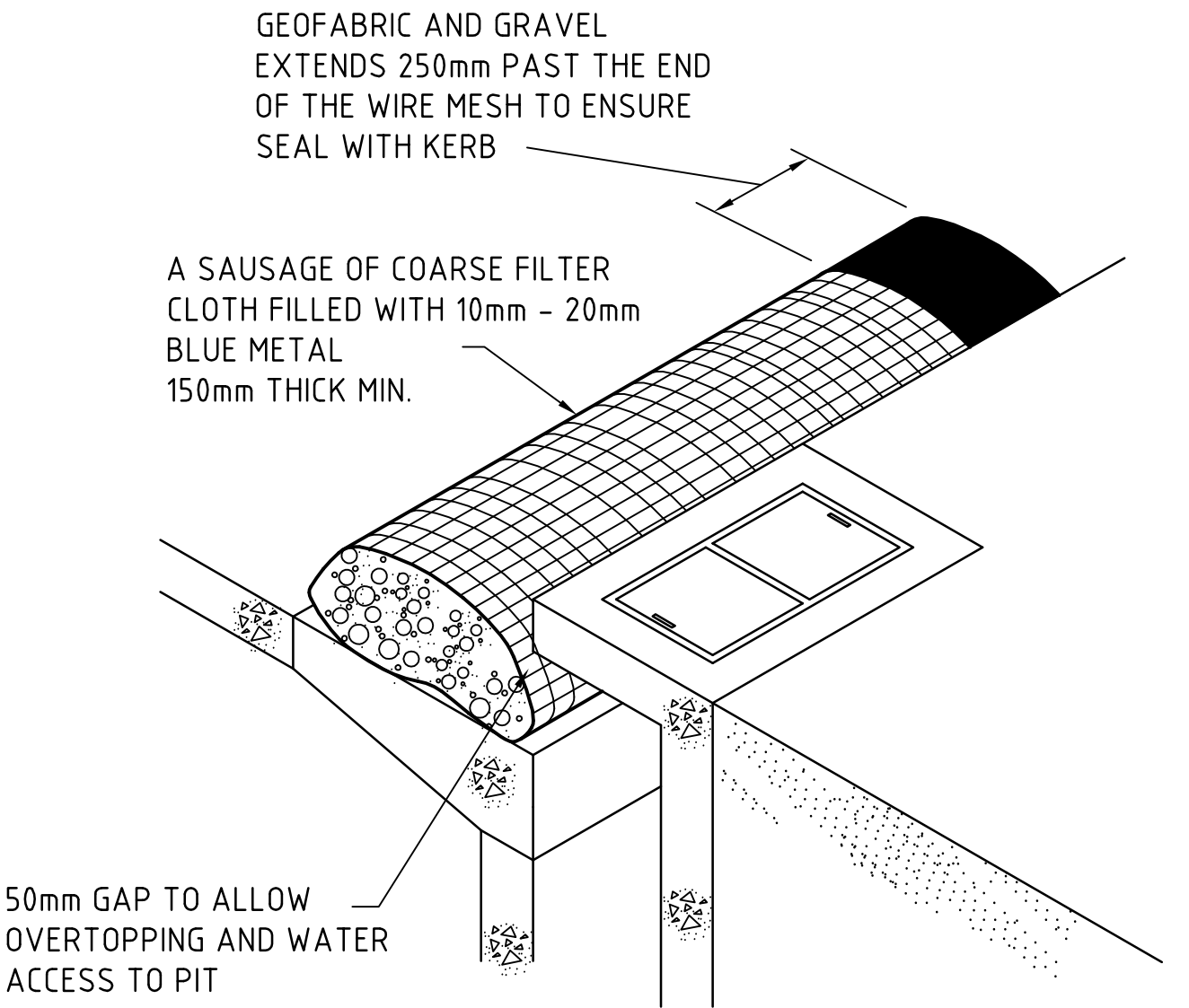

KERB INLET PIT CONTROL
N.T.S.

NOTE: ADOPT ABOVE DETAILS AROUND ALL PITS WITHIN AREA ENCOMPASSED BY SILT FENCE & TO PITS ON THE ROAD ADJACENT TO SITE BOUNDARY.

EROSION CONTROL NOTES

ALL CONTROL WORK INCLUDING DIVERSION BANKS AND CATCH DRAINS, V-DRAINS AND SILT FENCES SHALL BE COMPLETED DIRECTLY FOLLOWING THE COMPLETION OF THE EARTHWORKS.

1. SILT FENCES AND SILT FENCE RETURNS SHALL BE ERECTED CONVEX TO THE CONTOUR TO POND WATER.
2. HAY BALE BARRIERS AND GEOFABRIC FENCES ARE TO BE CONSTRUCTED TO TOE OF BATTER, PRIOR TO COMMENCEMENT OF EARTHWORKS, IMMEDIATELY AFTER CLEARING OF VEGETATION AND BEFORE REMOVAL OF TOP SOIL.
3. ALL TEMPORARY EARTH BERMS, DIVERSION AND SILT DAM EMBANKMENTS ARE TO BE MACHINE COMPACTED, SEEDED AND MULCHED FOR TEMPORARY VEGETATION COVER AS SOON AS THEY HAVE BEEN FORMED.
4. CLEAR WATER IS TO BE DIVERTED AWAY FROM DISTURBED GROUND AND INTO THE DRAINAGE SYSTEM.
5. THE CONTRACTOR IS RESPONSIBLE FOR MAINTAINING AND PROVIDING ON GOING ADJUSTMENT TO EROSION CONTROL MEASURES AS REQUIRED DURING CONSTRUCTION.
6. ALL SEDIMENT TRAPPING STRUCTURES AND DEVICES ARE TO BE INSPECTED AFTER STORMS FOR STRUCTURAL DAMAGE OR CLOGGING, TRAPPED MATERIAL IS TO BE REMOVED TO A SAFE, APPROVED LOCATION.
7. ALL FINAL EROSION PREVENTION MEASURES INCLUDING THE ESTABLISHMENT OF GRASSING ARE TO BE MAINTAINED UNTIL THE END OF THE DEFECTS LIABILITY PERIOD.
8. ALL EARTHWORKS AREAS SHALL BE ROLLED ON A REGULAR BASIS TO SEAL THE EARTHWORKS.
9. ALL FILL AREAS ARE TO BE LEFT WITH A BUND AT THE TOP OF THE SLOPE AT THE END OF EACH DAYS EARTHWORKS. THE HEIGHT OF THE BUND SHALL BE A MINIMUM OF 200MM.
10. ALL CUT AND FILL SLOPES ARE TO BE SEEDED AND MULCHED WITHIN 10 DAYS OF COMPLETION OF FORMATION.
11. AFTER REVEGETATION OF THE SITE IS COMPLETE AND THE SITE IS STABLE IN THE OPINION OF A SUITABLY QUALIFIED PERSON ALL TEMPORARY WORK SUCH AS SILT FENCE, DIVERSION DRAINS ETC SHALL BE REMOVED.
12. ALL TOPSOIL STOCKPILES ARE TO BE SUITABLY COVERED TO THE SATISFACTION OF THE CONTRACT ADMINISTRATOR TO PREVENT WIND AND WATER EROSION.
13. ANY AREA THAT IS NOT APPROVED BY THE CONTRACT ADMINISTRATOR FOR CLEARING OR DISTURBANCE BY THE CONTRACTOR'S ACTIVITIES SHALL BE CLEARLY MARKED AND SIGN POSTED, FENCED OFF OR OTHERWISE APPROPRIATELY PROTECTED AGAINST ANY SUCH DISTURBANCE.
14. ALL STOCKPILE SITES SHALL BE SITUATED IN AREAS APPROVED FOR SUCH USE BY THE CONTRACT ADMINISTRATOR. A 6m BUFFER ZONE SHALL EXIST BETWEEN STOCKPILE SITES AND ANY STREAM OR FLOW PATH. ALL STOCKPILES SHALL BE ADEQUATELY PROTECTED FROM EROSION AND CONTAMINATION OF THE SURROUNDING AREA BY USE OF THE MEASURES APPROVED IN THE EROSION AND SEDIMENTATION CONTROL PLAN.
15. ACCESS AND EXIT AREAS SHALL INCLUDE SHAKE-DOWN OR OTHER METHODS APPROVED BY THE CONTRACT ADMINISTRATOR FOR THE REMOVAL OF SOIL MATERIALS FORM MOTOR VEHICLES.
16. THE CONTRACTOR IS TO ENSURE RUNOFF FROM ALL AREAS WHERE THE NATURAL SURFACE IS DISTURBED BY CONSTRUCTION, INCLUDING ACCESS ROADS, DEPOT AND STOCKPILE SITES, SHALL BE FREE OF POLLUTANTS BEFORE IT IS EITHER DISPERSED TO STABLE AREAS OR DIRECTED TO NATURAL WATERCOURSES.
17. THE CONTRACTOR SHALL PROVIDE AND MAINTAIN SLOPES, CROWNS AND DRAINS ON ALL EXCAVATIONS AND EMBANKMENTS TO ENSURE SATISFACTORY DRAINAGE AT ALL TIMES WATER SHALL NOT BE ALLOWED TO POND ON THE WORKS UNLESS SUCH PONDING IS PART OF AN APPROVED ESCP / SWMP.
18. THE CONTRACTOR SHALL INCORPORATE THE MEASURES ON THIS PLAN WITHIN THE CONTRACTORS CONSTRUCTION MANAGEMENT PLAN.

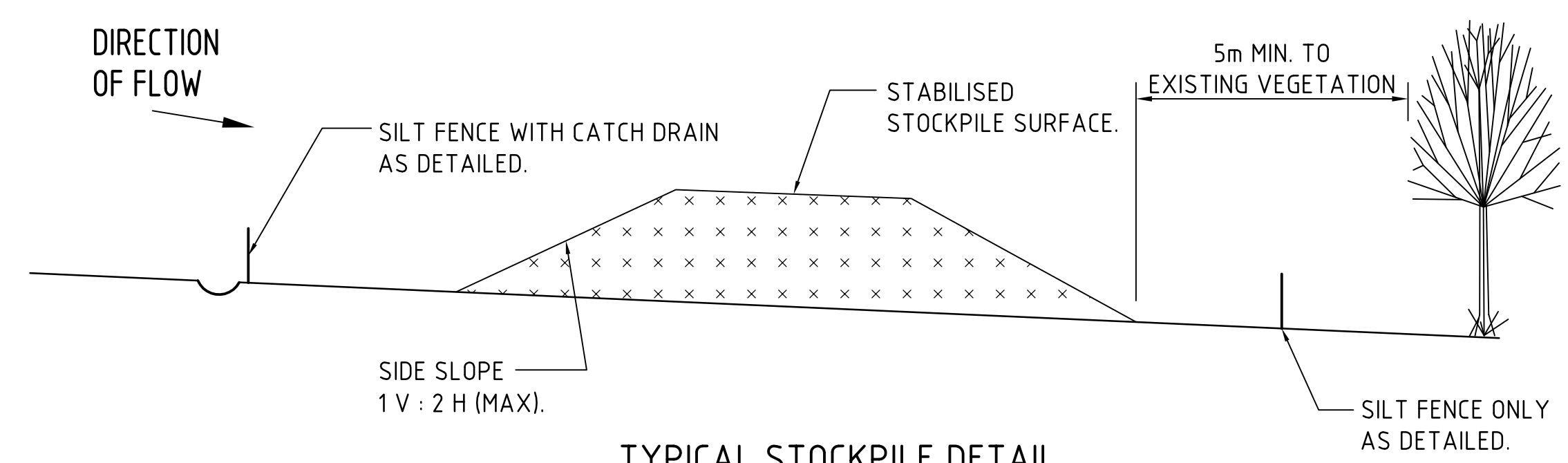

TYPICAL STOCKPILE DETAIL
N.T.S.

- LEGEND:**
- PROVIDE 1m RETURNS TO SILT FENCE AT 30m MAX. INTERVALS. TYPICAL (N.S.O.P.)
- - - - - SILT FENCE WITH CATCH DRAIN.
 - - - - - SILT FENCE ONLY

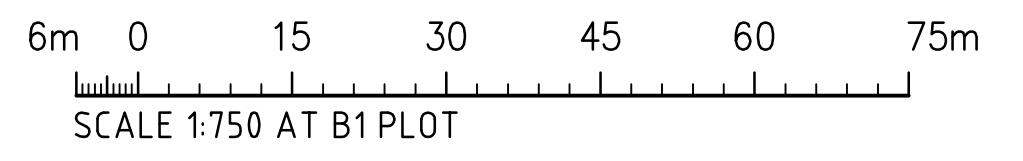

FOR DEVELOPMENT APPLICATION

FOR DEVELOPMENT APPLICATION	07.11.12	E		
FOR DEVELOPMENT APPLICATION	24.10.12	D		
FOR DEVELOPMENT APPLICATION	22.10.12	C		
REVISION AS CLOUDED	24.08.12	B		
FOR INFORMATION ONLY	16.08.12	A		
AMENDMENTS	DATE	ISSUE	AMENDMENTS	DATE

ARCHITECT
GILES TRIBE ARCHITECTS
LEVEL 8, 263 CLARENCE STREET
SYDNEY NSW 2000

CLIENT
Goodman
LEVEL 10,
60 Castlereagh Street
SYDNEY NSW 2000, Australia
Tel (02) 9230 7400
Fax (02) 9230 7444

PROJECT
**METCASH DISTRIBUTION CENTRE
PROJECT MUSTANG**
BUNGARRIBEE I.E, HUNTINGWOOD NSW

DESIGNED
M.W.

DRAWN
M.C.

DATE
07.08.12

CHECKED
SIZE
B1

SCALE
AS SHOWN

CAD REF:
Co9628.03-DA20

Costin Roe Consulting Pty Ltd.
Consulting Engineers 628 900 898 446
Level 1, 8 Windmill Street
Walsh Bay, Sydney NSW 2000
Tel: (02) 9251-7699 Fax: (02) 9241-3731
email: mail@costinroe.com.au @

Costin Roe Consulting
DRAWING TITLE
**EROSION AND SEDIMENT CONTROL
PLAN AND DETAILS**
DRAWING No
Co9628.03-DA20
ISSUE
E

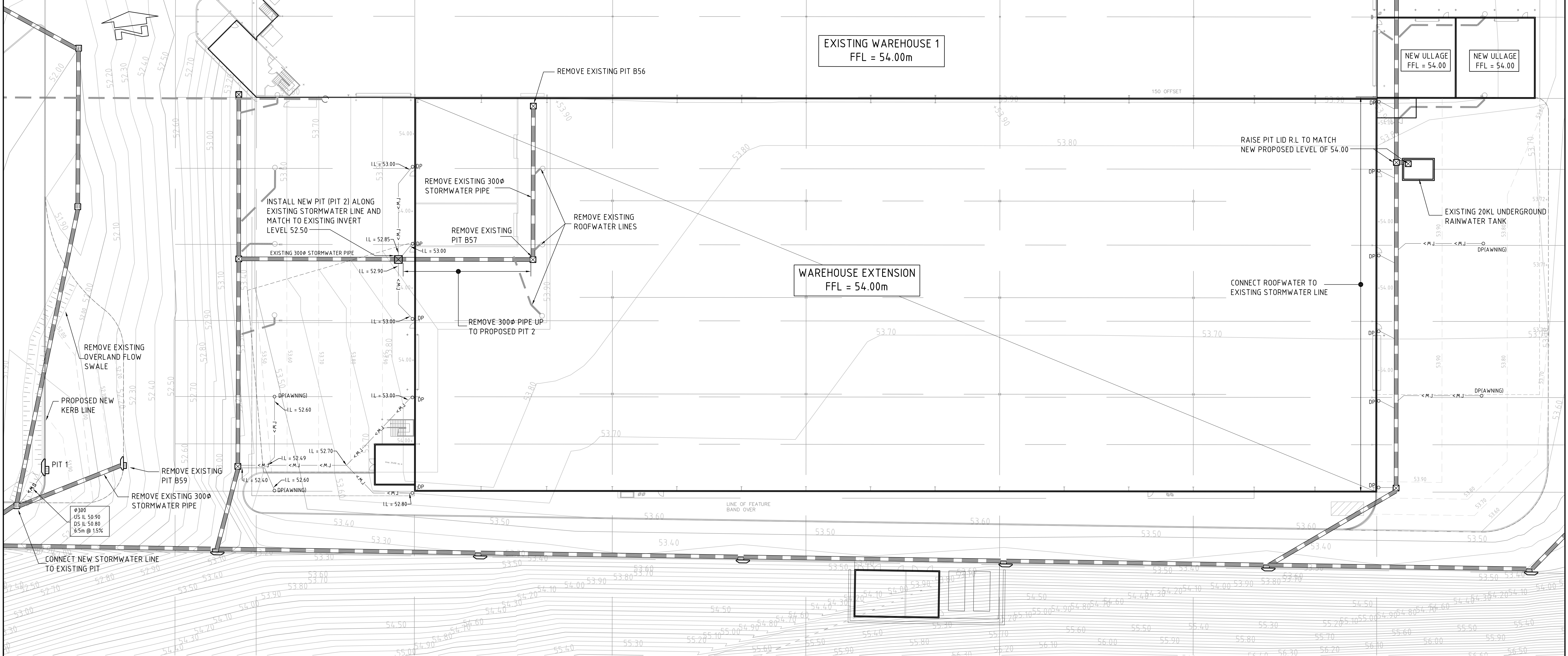

CONCEPT STORMWATER DRAINAGE PLAN - STAGE 5A/5B
1:250

LEGEND:

LEVELS DATUM IS AHD.

- SJP, SEALED JUNCTION PIT
- KIP, KERB INLET PIT
- DOWNPIPE. REFER TO HYDRAULIC ENGINEERS DRAWINGS
- EXISTING DRAINAGE LINE
- EXISTING ROOFWATER LINE
- DRAINAGE LINE
- ROOFWATER LINE
- FINISHED PAVEMENT CONTOUR (MAJOR) 0.5m INTERVALS
- FINISHED PAVEMENT CONTOUR (MINOR) 0.1m INTERVALS

PIT SCHEDULE

PIT No.	GRATE RL	DEPTH	TYPE	SIZE	COMMENT
PIT 1	51.82	920	KIP	900x600	
PIT 2	53.97	1475	SJP	900x900	MATCH TO EXISTING INVERT

STORMWATER DRAINAGE NOTES:

- ALL FINISHED PAVEMENT LEVELS SHALL BE AS INDICATED ON FINISHED LEVELS PLAN.
- PIT SIZES SHALL BE AS INDICATED IN THE SCHEDULE WHILE PIPE SIZES AND DETAILS ARE PROVIDED ON PLAN.
- EXISTING STORMWATER PIT LOCATIONS AND INVERT LEVELS TO BE CONFIRMED BY SURVEY PRIOR TO COMMENCING WORKS ON SITE.
- ALL PIPES UP TO AND INCLUDING 300mm TO BE uPVC GRADE SN8.
- ALL CONCRETE PITS GREATER THAN 1000mm DEEP SHALL BE REINFORCED USING N12-200 EACH WAY CENTRED IN WALL AND BASE. LAP MINIMUM 300mm WHERE REQUIRED. ALL CONCRETE FOR PITS SHALL BE F'c 25 MPA. PRECAST PITS MAY BE USED WITH THE APPROVAL OF THE ENGINEER.
- PIPES SHALL BE LAID AS PER PIPE LAYING DETAILS. PARTICULAR CARE SHALL BE TAKEN TO ENSURE THAT THE PIPE IS FULLY AND EVENLY SUPPORTED. RAM AND PACK FILLING AROUND AND UNDER BACK OF PIPES AND PIPE FAUCETS, WITH NARROW EDGED RAMMERS OR OTHER SUITABLE TAMPING DETAILS.
- WHERE PIPE LINES ENTER PITS, PROVIDE 2m LENGTH OF STOCKING WRAPPED SLOTTED 100mm uPVC TO EACH SIDE OF PIPE.
- ALL SUBSOIL DRAINAGE LINES SHALL BE 100mm SLOTTED uPVC WITH APPROVED FILTER WRAP LAID IN 300mm WIDE GRANULAR FILTER UNLESS NOTED OTHERWISE. LAY SUBSOIL LINES TO MATCH FALLS OF LAND AND/OR 1 IN 200 MINIMUM. PROVIDE CAPPED CLEANING EYE (RODDING POINT) AT UPSTREAM END OF LINE AND AT 30m MAX. CTS. PROVIDE SUBSOIL LINES TO ALL PAVEMENT / LANDSCAPED INTERFACES, TO REAR OF RETAINING WALLS (AS NOMINATED BY STRUCTURAL ENGINEER) AND AS SHOWN ON PLAN.
- ALL PIPE GRADES 1 IN 100 MINIMUM UNO.
- PROVIDE STEP IRONS IN PITS DEEPER THAN 1000mm.
- MIN. 600 COVER TO PIPE OBVERT BENEATH ROADS & MIN. 400 COVER BENEATH LANDSCAPED AND PEDESTRIAN AREAS.
- PIT COVERS IN TRAFFICABLE PAVEMENT SHALL BE CLASS D 'HEAVY DUTY', THOSE LOCATED IN NON-TRAFFICABLE AREAS SHALL BE CLASS B 'MEDIUM DUTY' UNO.
- PROVIDE CLEANING EYES (RODDING POINTS) TO PIPES AT ALL CORNERS AND T-JUNCTIONS WHERE NO PITS ARE PRESENT.
- DOWN PIPES TO BE AS PER HYDRAULIC ENGINEERS DETAILS WITH CONNECTOR TO MATCH DP SIZE UNO. ON PLAN. PROVIDE CLEANING EYE AT GROUND LEVEL.
- PIPE LENGTHS NOMINATED ON PLAN OR LONGSECTIONS ARE MEASURED FROM CENTER OF PITS TO THE NEAREST 0.5m AND DO NOT REPRESENT ACTUAL LENGTH. THE CONTRACTOR IS TO ALLOW FOR THIS.

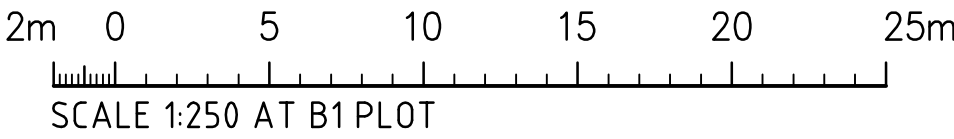

FOR DEVELOPMENT APPLICATION

FOR DEVELOPMENT APPLICATION	07.11.12	D		
FOR DEVELOPMENT APPLICATION	24.10.12	C		
FOR DEVELOPMENT APPLICATION	22.10.12	B		
FOR INFORMATION ONLY	14.08.12	A		
AMENDMENTS	DATE	ISSUE	AMENDMENTS	DATE

ARCHITECT
GILES TRIBE ARCHITECTS
LEVEL 8, 263 CLARENCE STREET
SYDNEY NSW 2000

CLIENT
Goodman
LEVEL 10,
60 Castlereagh Street
SYDNEY
NSW, 2000, Australia
Tel: (02) 9230 7400
Fax: (02) 9230 7444

PROJECT
METCASH DISTRIBUTION CENTRE
PROJECT MUSTANG
BUNGARRIBEE I.E., HUNTINGWOOD NSW

DESIGNED M.W.	DRAWN M.C.	DATE 07.08.12	CHECKED	SIZE B1	SCALE AS SHOWN	CAD REF: C09628.03-DA40
------------------	---------------	------------------	---------	------------	-------------------	----------------------------

Costin Roe Consulting Pty Ltd.
Consulting Engineers
Level 1, 8 Windmill Street
Walsh Bay, Sydney NSW 2000
Tel: (02) 9261-7809 Fax: (02) 9261-3731
email: mail@costinroe.com.au ©

DRAWING TITLE CONCEPT STORMWATER DRAINAGE PLAN - STAGE 5A/5B	
DRAWING No C09628.03-DA40	ISSUE C

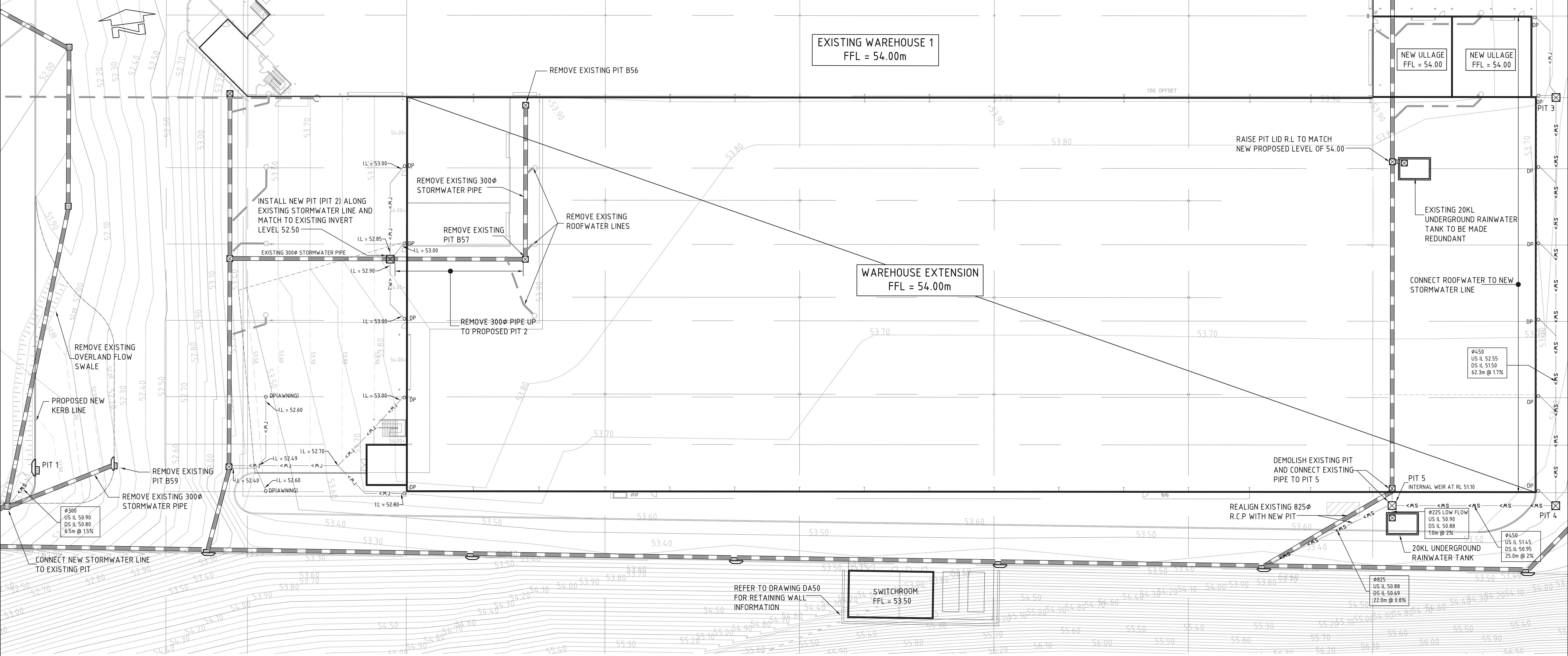

CONCEPT STORMWATER DRAINAGE PLAN - STAGE 5C
1:250

LEGEND:

LEVELS DATUM IS AHD.

☒ - SJP, SEALED JUNCTION PIT

⌋ - KIP, KERB INLET PIT

• DP - DOWNPIPE. REFER TO HYDRAULIC ENGINEERS DRAWINGS

— — — — — - EXISTING DRAINAGE LINE

— — — — — - EXISTING ROOFWATER LINE

— SW> — — — — — - DRAINAGE LINE

— RW> — — — — — - ROOFWATER LINE

— 50.00 — — — — — - FINISHED PAVEMENT CONTOUR (MAJOR) 0.5m INTERVALS

— 50.10 — — — — — - FINISHED PAVEMENT CONTOUR (MINOR) 0.1m INTERVALS

PIT SCHEDULE

PIT No.	GRATE RL	DEPTH	TYPE	SIZE	COMMENT
PIT 3	53.75	1200	SJP	900x900	
PIT 4	53.50	2050	SJP	900x900	
PIT 5	53.80	2920	SJP	1200x1200	

STORMWATER DRAINAGE NOTES:

- ALL FINISHED PAVEMENT LEVELS SHALL BE AS INDICATED ON FINISHED LEVELS PLAN.
- PIT SIZES SHALL BE AS INDICATED IN THE SCHEDULE WHILE PIPE SIZES AND DETAILS ARE PROVIDED ON PLAN.
- EXISTING STORMWATER PIT LOCATIONS AND INVERT LEVELS TO BE CONFIRMED BY SURVEY PRIOR TO COMMENCING WORKS ON SITE.
- ALL PIPES UP TO AND INCLUDING 300 ϕ TO BE uPVC GRADE SN8.
- ALL CONCRETE PITS GREATER THAN 1000mm DEEP SHALL BE REINFORCED USING N12-200 EACH WAY CENTRED IN WALL AND BASE. LAP MINIMUM 300mm WHERE REQUIRED. ALL CONCRETE FOR PITS SHALL BE F'c 25 MPA. PRECAST PITS MAY BE USED WITH THE APPROVAL OF THE ENGINEER.
- PIPES SHALL BE LAID AS PER PIPE LAYING DETAILS. PARTICULAR CARE SHALL BE TAKEN TO ENSURE THAT THE PIPE IS FULLY AND EVENLY SUPPORTED. RAM AND PACK FILLING AROUND AND UNDER BACK OF PIPES AND PIPE FAUCETS, WITH NARROW EDGED RAMMERS OR OTHER SUITABLE TAMPING DETAILS.
- WHERE PIPE LINES ENTER PITS, PROVIDE 2m LENGTH OF STOCKING WRAPPED SLOTTED ϕ 100 uPVC TO EACH SIDE OF PIPE.
- ALL SUBSOIL DRAINAGE LINES SHALL BE ϕ 100 SLOTTED uPVC WITH APPROVED FILTER WRAP LAID IN 300mm WIDE GRANULAR FILTER UNLESS NOTED OTHERWISE. LAY SUBSOIL LINES TO MATCH FALLS OF LAND AND/OR 1 IN 200 MINIMUM. PROVIDE CAPPED CLEANING EYE (RODDING POINT) AT UPSTREAM END OF LINE AND AT 30m MAX. CTS. PROVIDE SUBSOIL LINES TO ALL PAVEMENT/ LANDSCAPED INTERFACES, TO REAR OF RETAINING WALLS (AS NOMINATED BY STRUCTURAL ENGINEER) AND AS SHOWN ON PLAN.
- ALL PIPE GRADES 1 IN 100 MINIMUM UNO.
- PROVIDE STEP IRONS IN PITS DEEPER THAN 1000mm.
- MIN. 600 COVER TO PIPE OBVERT BENEATH ROADS & MIN. 400 COVER BENEATH LANDSCAPED AND PEDESTRIAN AREAS.
- PIT COVERS IN TRAFFICABLE PAVEMENT SHALL BE CLASS D 'HEAVY DUTY', THOSE LOCATED IN NON-TRAFFICABLE AREAS SHALL BE CLASS B 'MEDIUM DUTY' UNO.
- PROVIDE CLEANING EYES (RODDING POINTS) TO PIPES AT ALL CORNERS AND T-JUNCTIONS WHERE NO PITS ARE PRESENT.
- DOWN PIPES TO BE AS PER HYDRAULIC ENGINEERS DETAILS WITH CONNECTOR TO MATCH DP SIZE UNO. ON PLAN. PROVIDE CLEANING EYE AT GROUND LEVEL.
- PIPE LENGTHS NOMINATED ON PLAN OR LONGSECTIONS ARE MEASURED FROM CENTER OF PITS TO THE NEAREST 0.5m AND DO NOT REPRESENT ACTUAL LENGTH. THE CONTRACTOR IS TO ALLOW FOR THIS.

2m 0 5 10 15 20 25m
SCALE 1:250 AT B1 PLOT

FOR DEVELOPMENT APPLICATION

FOR DEVELOPMENT APPLICATION	07.11.12	B			
FOR DEVELOPMENT APPLICATION	24.10.12	A			
AMENDMENTS	DATE	ISSUE	AMENDMENTS	DATE	ISSUE

ARCHITECT
GILES TRIBE ARCHITECTS
LEVEL 8, 263 CLARENCE STREET
SYDNEY NSW 2000

CLIENT
Goodman
LEVEL 10,
60 Castlereagh Street
SYDNEY
NSW, 2000, Australia
Tel: (02) 9230 7400
Fax: (02) 9230 7444

PROJECT
**METCASH DISTRIBUTION CENTRE
PROJECT MUSTANG**
BUNGARRIBEE I.E., HUNTINGWOOD NSW

DESIGNED M.W.	DRAWN M.C.	DATE 07.08.12	CHECKED	SIZE B1	SCALE AS SHOWN	CAD REF: Co9628.03-DA41
------------------	---------------	------------------	---------	------------	-------------------	----------------------------

Costin Roe Consulting Pty Ltd.
Consulting Engineers
Level 1, 8 Windmill Street
Walsh Bay, Sydney NSW 2000
Tel: (02) 9261-7809 Fax: (02) 9261-3731
email: mail@costinroe.com.au @

Costin Roe Consulting
Value in Engineering and Management

DRAWING TITLE
**CONCEPT STORMWATER DRAINAGE
PLAN - STAGE 5C**
DRAWING No
Co9628.03-DA41
ISSUE
B



100 NOMINAL

200

10 ISOLATION JOINT

REBATE TO SUIT FRAME

PAVEMENT

250

NOMINATED LEVEL

R5

H

(SEE SCHEDULE)

50 COVER

N12 @ 200 EW
300 LAP TO SPLICE AND
AT CORNERS

2x100Φ AG. DRAINS
2000 LONG AT UPSTREAM
PIPES ONLY.

TYPICAL ALL PIT TYPES

150

150

L x B

L DIMENSION IN DIRECTION OF
DOWNSIDE PIPE

SECTION
SCALE 1:20

SEALED PIT - SJP

PIT NOTES:

1. WHERE GULLY PIT IS LOCATED ON KERB RETURNS OR BULB OF CUL-DE-SACS PROVIDE CURVED PRECAST CONCRETE LINTELS.
2. SAG PITS SHALL HAVE LINTEL PLACED CENTRALLY ABOUT THE GRATE.
3. ALL REINFORCING TO HAVE 30 MIN. CLEAR CONCRETE COVER.
4. FOR PITS DEEPER THAN 1000mm CLIMB RAILS SHALL BE PROVIDED.

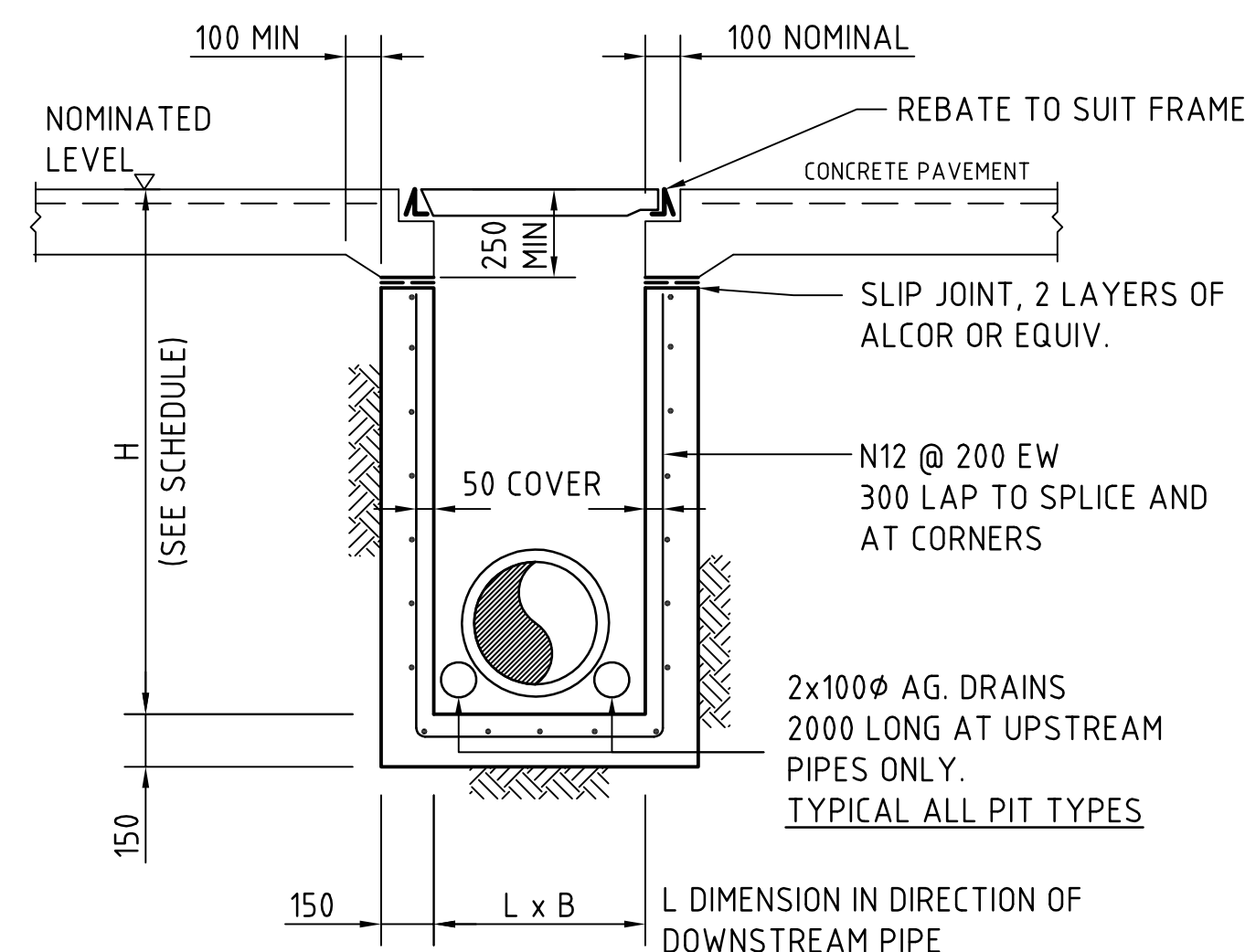

SECTION
SCALE 1:20

ALTERNATIVE PIT DETAIL
GRATE/COVER SUPPORT
CAST-INTO PAVEMENT SLAB
(ADOPT AS REQUIRED FOR SGGP's & SJP's)

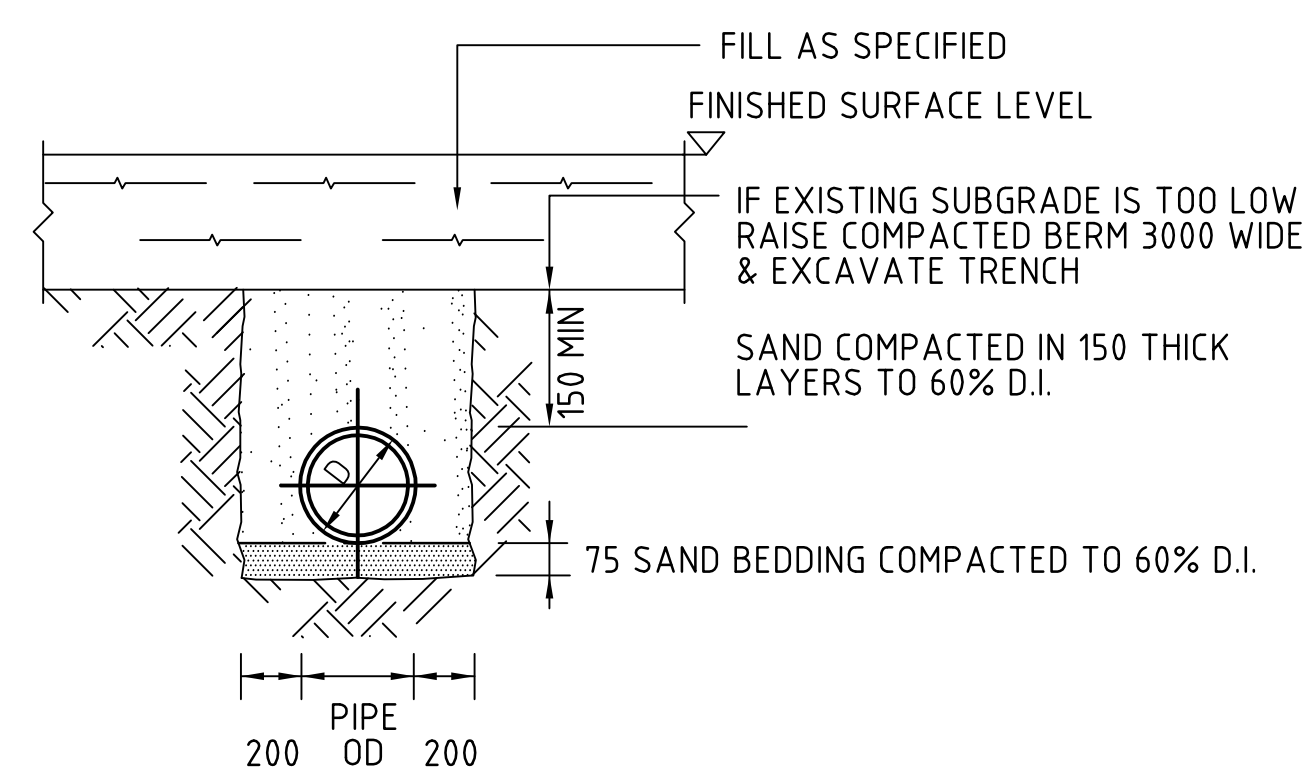

SUPPORT TO uPVC PIPES

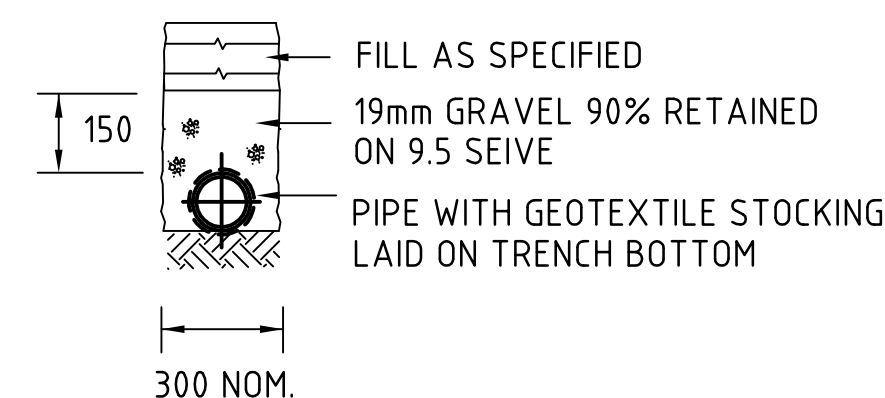

SUPPORT TO AG. DRAIN

BEDDING & HAUNCH MATERIAL GRADING	
SIEVE SIZE	WEIGHT PASSING(%)
19	100
2.36	100 TO 50
0.60	90 TO 20
0.30	60 TO 10
0.15	25 TO 0
0.075	10 TO 0

SIDE ZONE MATERIAL GRADING	
SIEVE SIZE	WEIGHT PASSING(%)
75	100
9.5	100 TO 50
2.36	100 TO 30
0.60	50 TO 15
0.075	25 TO 0

SELECT FILL MATERIAL IN ACCORDANCE WITH
TABLE 1 AS 3725

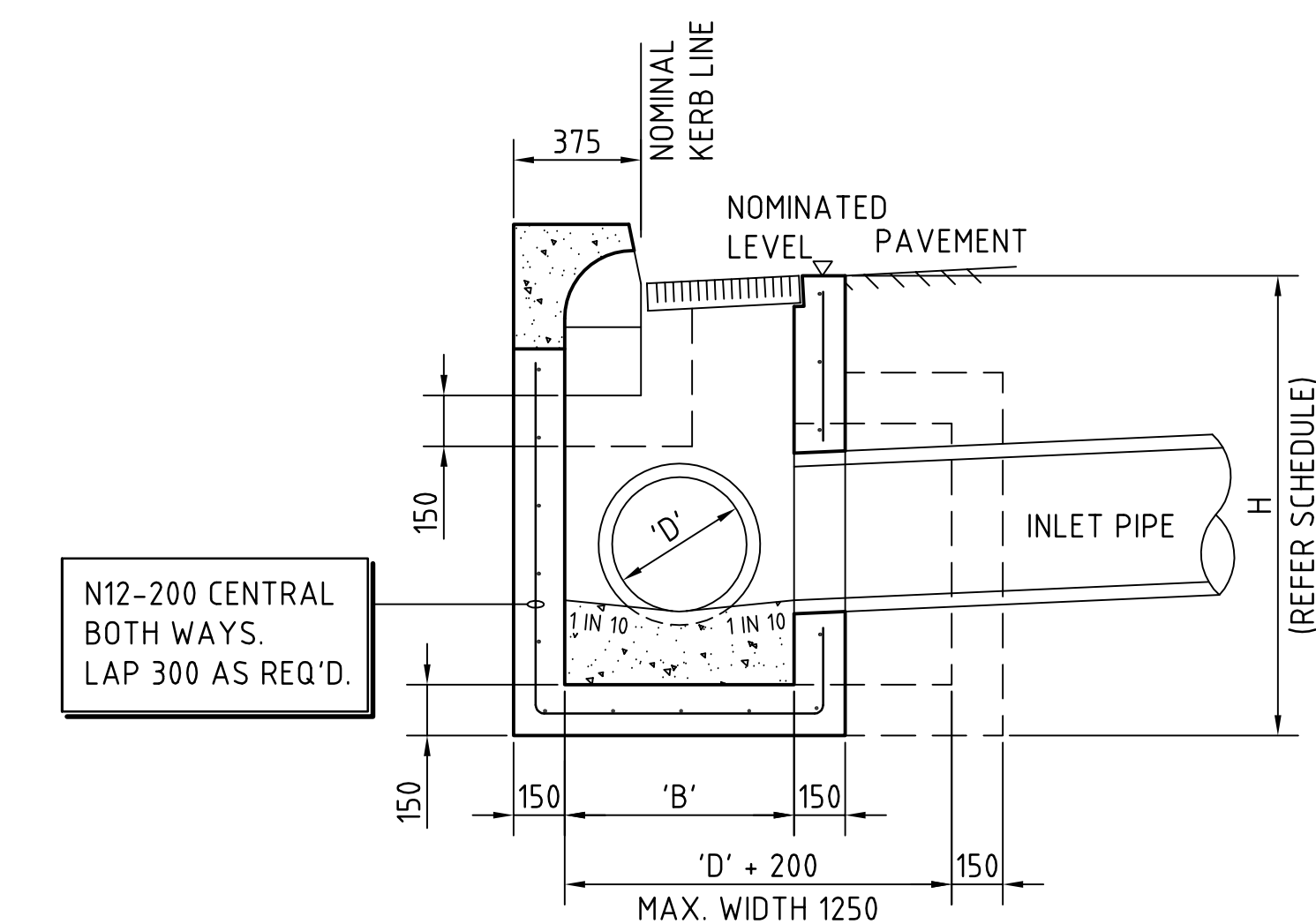

CROSS SECTION.
SCALE 1:20

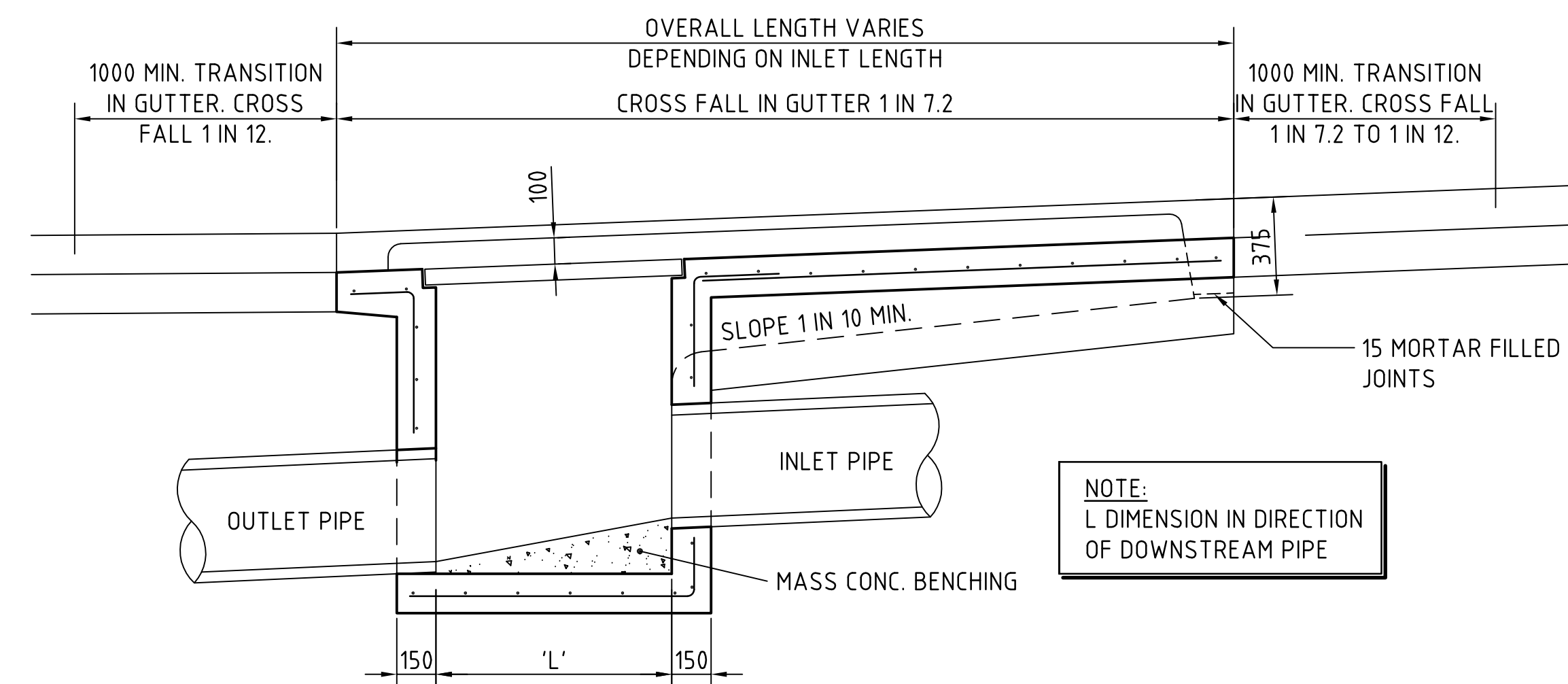

LONGITUDINAL SECTION
SCALE 1:20

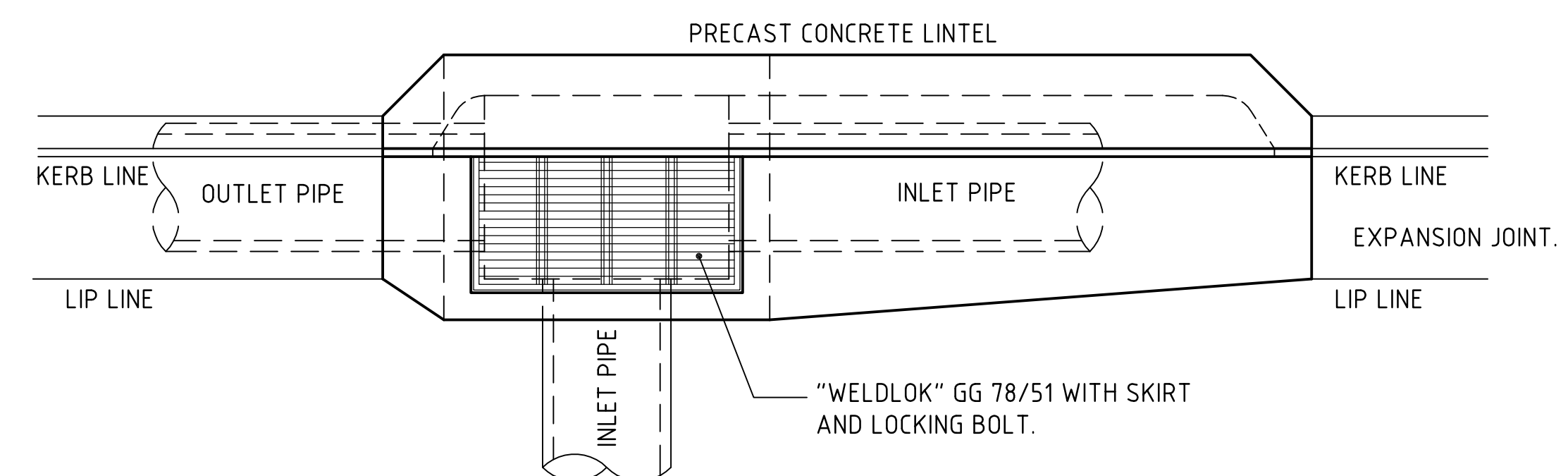

PLAN
SCALE 1:20

KERB INLET PIT - KIP



1:20

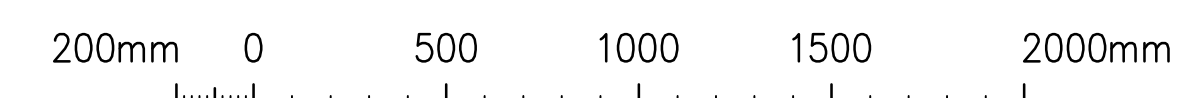

SCALE 1:20 AT B1 SIZE PLOT

FOR DEVELOPMENT APPLICATION

[illegible]

ARCHITECT
GILES TRIBE ARCHITECTS
LEVEL 8, 263 CLARENCE STREET
SYDNEY NSW 2000

CLIENT

 LEVEL 10,
60 Castlereagh Street
SYDNEY
NSW, 2000, Australia

Tel (02) 9230 7400
Fax (02) 9230 7444

PROJECT
METCASH DISTRIBUTION CENTRE
PROJECT MUSTANG
BUNGARRIBEE I.E., HUNTINGWOOD NSW

DESIGNED M W	DRAWN M C	DATE 07 08 12	CHECKED	SIZE B1	SCALE AS SHOWN	CAD REF: C09628.03-DA45
-----------------	--------------	------------------	---------	------------	-------------------	----------------------------

 <p>The Association of Consulting Engineers Australia</p>	<p>Costin Roe Consulting Pty Ltd. Consulting Engineers Level 1, 8 Windmill Street Walsh Bay, Sydney NSW 2000 Tel: (02) 9251-7699 Fax: (02) 9241-3731 Email: mail@costinroe.com.au ©</p>	<p>ACE 003 696 446</p>
--	---	------------------------

Tel: (02) 9251-7699 Fax: (02) 9241-3731
email: mail@costinroe.com.au ©

Value in Engineering and Management

Costin Roe Consulting

DRAWING TITLE
CONCEPT STORMWATER DRAINAGE
DETAILS

DRAWING No	C09628.03-DA45	ISSUE	D
------------	----------------	-------	---

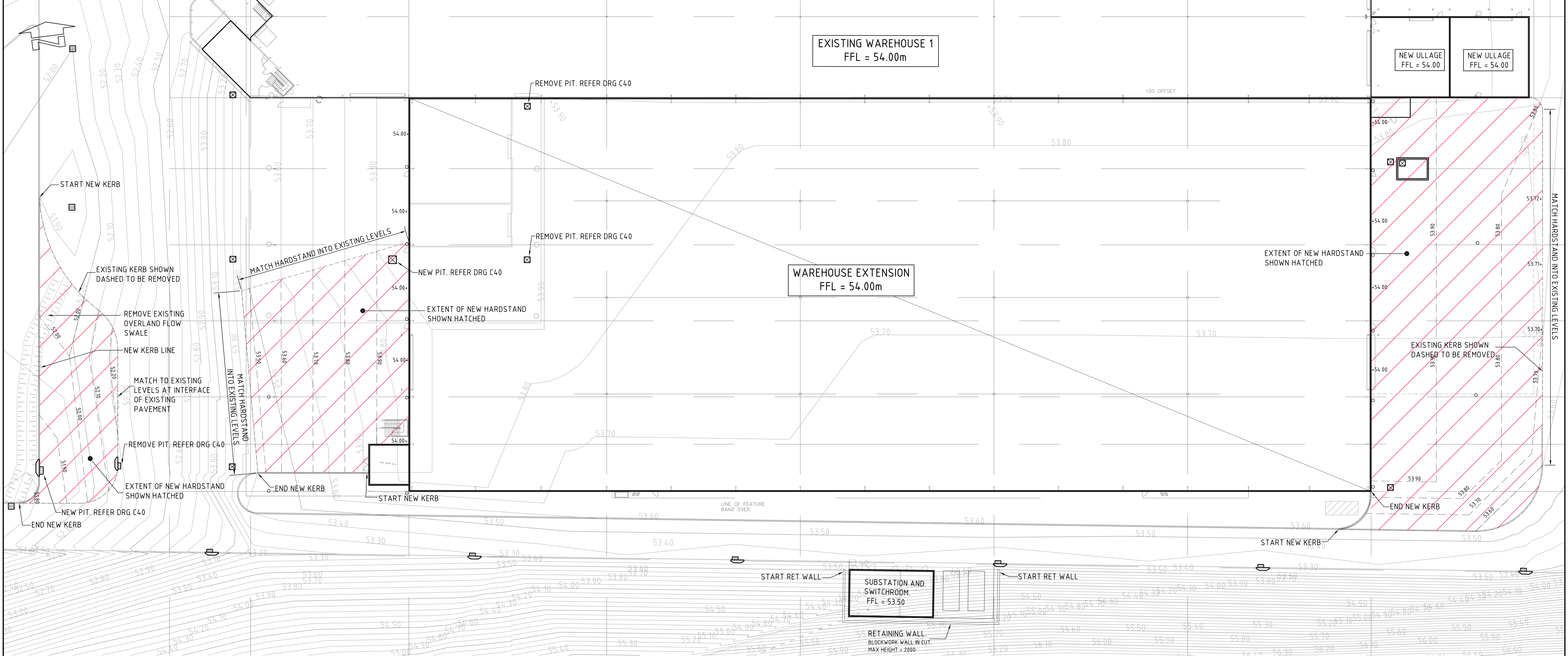

FINISHED LEVELS PLAN - WAREHOUSE 1 EXTENSION - STAGE 5A/5B
1:250

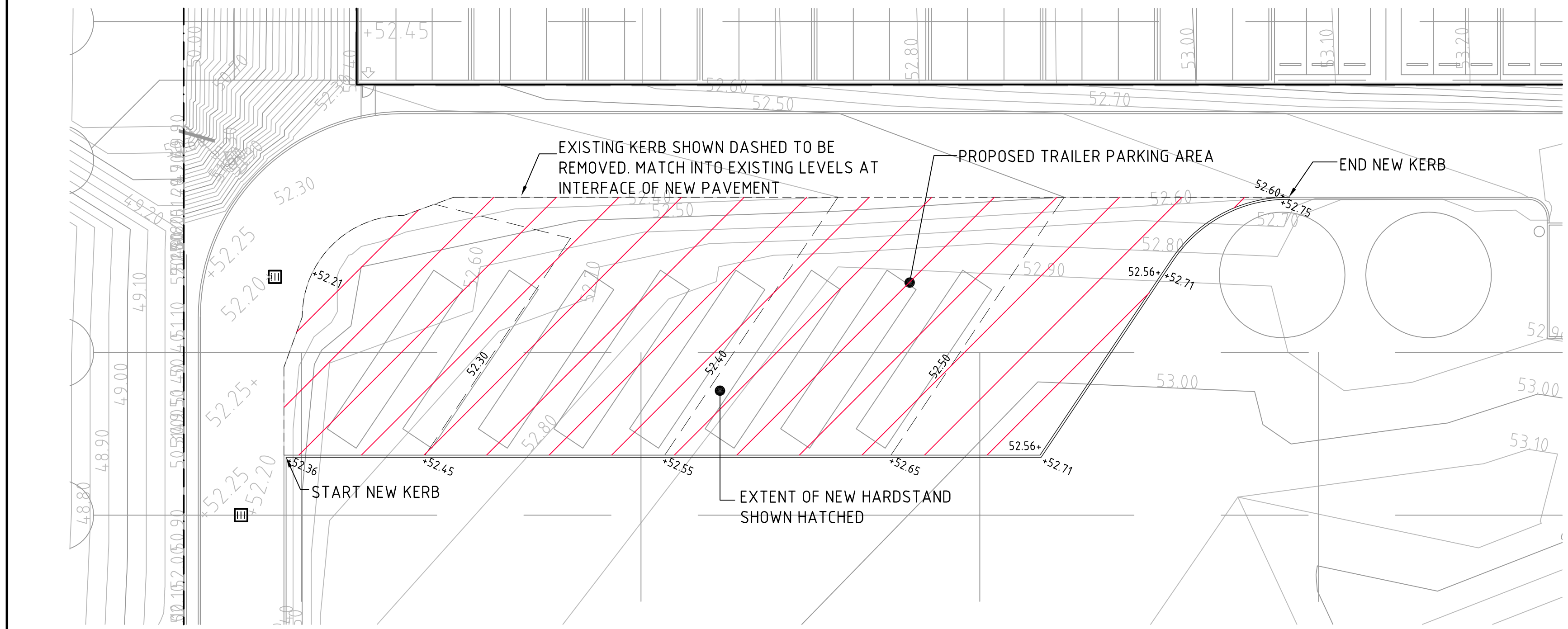

FINISHED LEVELS PLAN - TRAILER PARKING AREA
1:250

FINISHED LEVELS PLAN NOTES:

- LEVELS DATUM IS A.H.D.
- ALL CONTOUR LINES & SPOT LEVELS INDICATE FINISHED PAVEMENT LEVELS U.N.O. ON PLAN.
- THE MAJOR CONTOUR INTERVAL IS 0.5m
- THE MINOR CONTOUR INTERVAL IS 0.1m.
- MINIMUM PAVEMENT GRADE IS TO BE 1:100 (1%).
- MAXIMUM PAVEMENT GRADE IS TO BE 1:20 (5%) IN CARPARKING AREAS AND 1:25 (4%) ELSEWHERE.
- MAXIMUM RAMP GRADES ARE TO BE 1:12 (8.3%) U.N.O. ON PLAN
- PROVIDE MINIMUM 3.0m LONG TRANSITION WHERE CHANGES GRADE EXCEED 1:20 (5%).
- PERMANENT BATTER SLOPES ARE TO HAVE A MAXIMUM GRADE OF 1V:3H.
- ALL BATTER SLOPE WITH GRADES AT OR EXCEEDING 1V:6H ARE TO BE TURFED
- IMMEDIATELY OR APPROPRIATE EROSION CONTROL IS TO BE PROVIDED TO THE SATISFACTION OF THE ENGINEER.
- THE ACCESS ROAD TO THE HARDSTAND AREA IS TO HAVE A CROSSFALL OF 2% AS INDICATED ON PLAN.
- ALL FOOTPATHS ARE TO FALL AWAY FROM THE BUILDING AT 2.5% NOMINAL GRADE.
- ALL PAVEMENTS ARE TO BE SET AT 50mm BELOW THE FINISHED FLOOR LEVEL OF THE WAREHOUSE AND OFFICE AREAS.

LEGEND

LEVELS DATUM IS AHD.

- SJP - SEALED JUNCTION PIT
- KIP - KERB INLET PIT
- FINISHED PAVEMENT CONTOUR (MAJOR, 0.5m)
- FINISHED PAVEMENT CONTOUR (MINOR, 0.1m)
- FINISHED PAVEMENT SPOT HEIGHT
- EXISTING CONTOUR
- EXISTING SPOT HEIGHT

2m 0 5 10 15 20 25m
SCALE 1:250 AT B1 PLOT

FOR DEVELOPMENT APPLICATION

FOR DEVELOPMENT APPLICATION	07.11.12	F		
FOR DEVELOPMENT APPLICATION	24.10.12	E		
FOR DEVELOPMENT APPLICATION	22.10.12	D		
REVISION AS CLOUDED	19.09.12	C		
REVISION AS CLOUDED	24.08.12	B		
FOR INFORMATION ONLY	14.08.12	A		
AMENDMENTS	DATE	ISSUE	AMENDMENTS	DATE

ARCHITECT
GILES TRIBE ARCHITECTS
LEVEL 8, 263 CLARENCE STREET
SYDNEY NSW 2000

CLIENT
Goodman
LEVEL 10,
60 Castlereagh Street
SYDNEY
NSW, 2000, Australia
Tel: (02) 9230 7400
Fax: (02) 9230 7444

PROJECT
METCASH DISTRIBUTION CENTRE
PROJECT MUSTANG
BUNGARRIBEE I.E., HUNTINGWOOD NSW

DESIGNED M.W. DRAWN M.C. DATE 07.08.12 CHECKED SIZE B1 SCALE AS SHOWN CAD REF: Co9628.03-DA50

Costin Roe Consulting Pty Ltd.
Consulting Engineers
Level 1, 8 Windmill Street
Walsh Bay, Sydney NSW 2000
Tel: (02) 9251-7699 Fax: (02) 9251-3731
email: mail@costinroe.com.au @

Value in Engineering and Management

DRAWING TITLE
FINISHED LEVELS PLAN
STAGE 5A/5B
DRAWING No
Co9628.03-DA50
ISSUE
F

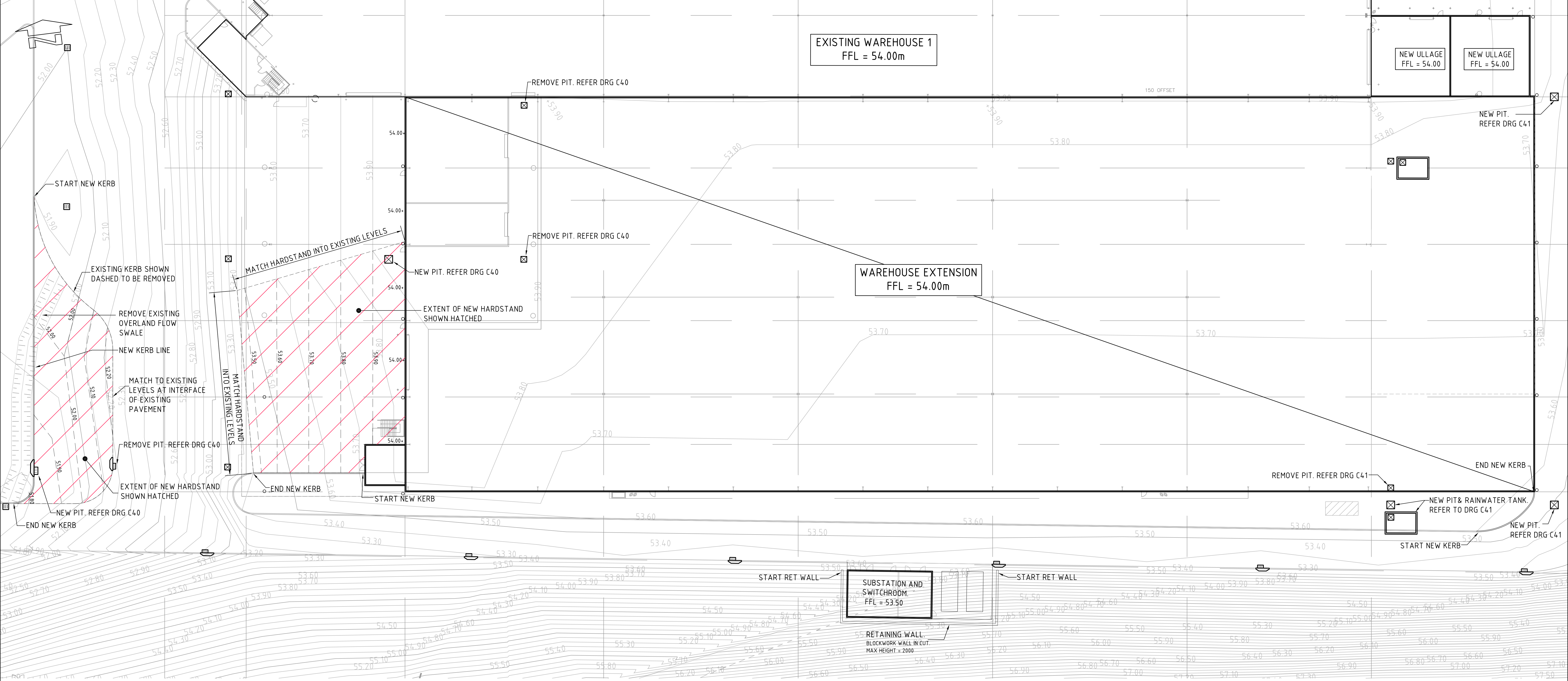

FINISHED LEVELS PLAN - WAREHOUSE 1 EXTENSION - STAGE 5C
1:250

FINISHED LEVELS PLAN NOTES:

1. LEVELS DATUM IS A.H.D.
2. ALL CONTOUR LINES & SPOT LEVELS INDICATE FINISHED PAVEMENT LEVELS U.N.O. ON PLAN.
3. THE MAJOR CONTOUR INTERVAL IS 0.5m
4. THE MINOR CONTOUR INTERVAL IS 0.1m.
5. MINIMUM PAVEMENT GRADE IS TO BE 1:100 (1%).
6. MAXIMUM PAVEMENT GRADE IS TO BE 1:20 (5%) IN CARPARKING AREAS AND 1:25 (4%) ELSEWHERE.
7. MAXIMUM RAMP GRADES ARE TO BE 1:12 (8.3%) U.N.O. ON PLAN
8. PROVIDE MINIMUM 3.0m LONG TRANSITION WHERE CHANGES GRADE EXCEED 1:20 (5%).
9. PERMANENT BATTER SLOPES ARE TO HAVE A MAXIMUM GRADE OF 1V:3H.
10. ALL BATTER SLOPE WITH GRADES AT OR EXCEEDING 1V:6H ARE TO BE TURFED IMMEDIATELY OR
11. APPROPRIATE EROSION CONTROL IS TO BE PROVIDED TO THE SATISFACTION OF THE ENGINEER.
12. THE ACCESS ROAD TO THE HARDSTAND AREA IS TO HAVE A CROSSFALL OF 2% AS INDICATED ON PLAN.
13. ALL FOOTPATHS ARE TO FALL AWAY FROM THE BUILDING AT 2.5% NOMINAL GRADE.
14. ALL PAVEMENTS ARE TO BE SET AT 50mm BELOW THE FINISHED FLOOR LEVEL OF THE WAREHOUSE AND OFFICE AREAS.

LEGEND

LEVELS DATUM IS A.H.D.

☒ - SJP - SEALED JUNCTION PIT

⌒ - KIP - KERB INLET PIT

— 52.00 — - FINISHED PAVEMENT CONTOUR (MAJOR, 0.5m)

— 52.60 — - FINISHED PAVEMENT CONTOUR (MINOR, 0.1m)

+65.30 - FINISHED PAVEMENT SPOT HEIGHT

— 57.60 — - EXISTING CONTOUR

+65.30 - EXISTING SPOT HEIGHT

2m 0 5 10 15 20 25m
SCALE 1:250 AT B1 PLOT

FOR DEVELOPMENT APPLICATION

FOR DEVELOPMENT APPLICATION	07.11.12	B			
FOR DEVELOPMENT APPLICATION	24.10.12	A			
AMENDMENTS	DATE	ISSUE	AMENDMENTS	DATE	ISSUE

ARCHITECT
GILES TRIBE ARCHITECTS
LEVEL 8, 263 CLARENCE STREET
SYDNEY NSW 2000

CLIENT
Goodman
LEVEL 10,
60 Castlereagh Street
SYDNEY
NSW, 2000, Australia
Tel (02) 9230 7400
Fax (02) 9230 7444

PROJECT
METCASH DISTRIBUTION CENTRE
PROJECT MUSTANG
BUNGARRIBEE I.E, HUNTINGWOOD NSW

DESIGNED	DRAWN	DATE	CHECKED	SIZE	SCALE	CAD REF:
M.W.	M.C.	07.08.12		B1	AS SHOWN	Co9628.03-DA51



Costin Roe Consulting Pty Ltd.
Consulting Engineers
Level 1, 8 Windmill Street
Wahsh Bay, Sydney NSW 2000
Tel: (02) 9251-7699 Fax: (02) 9251-3701
email: mail@costinroe.com.au @

Value in Engineering and Management

Costin Roe Consulting

DRAWING TITLE
FINISHED LEVELS PLAN - STAGE 5C

DRAWING No
Co9628.03-DA51

ISSUE
B