

Summer 900

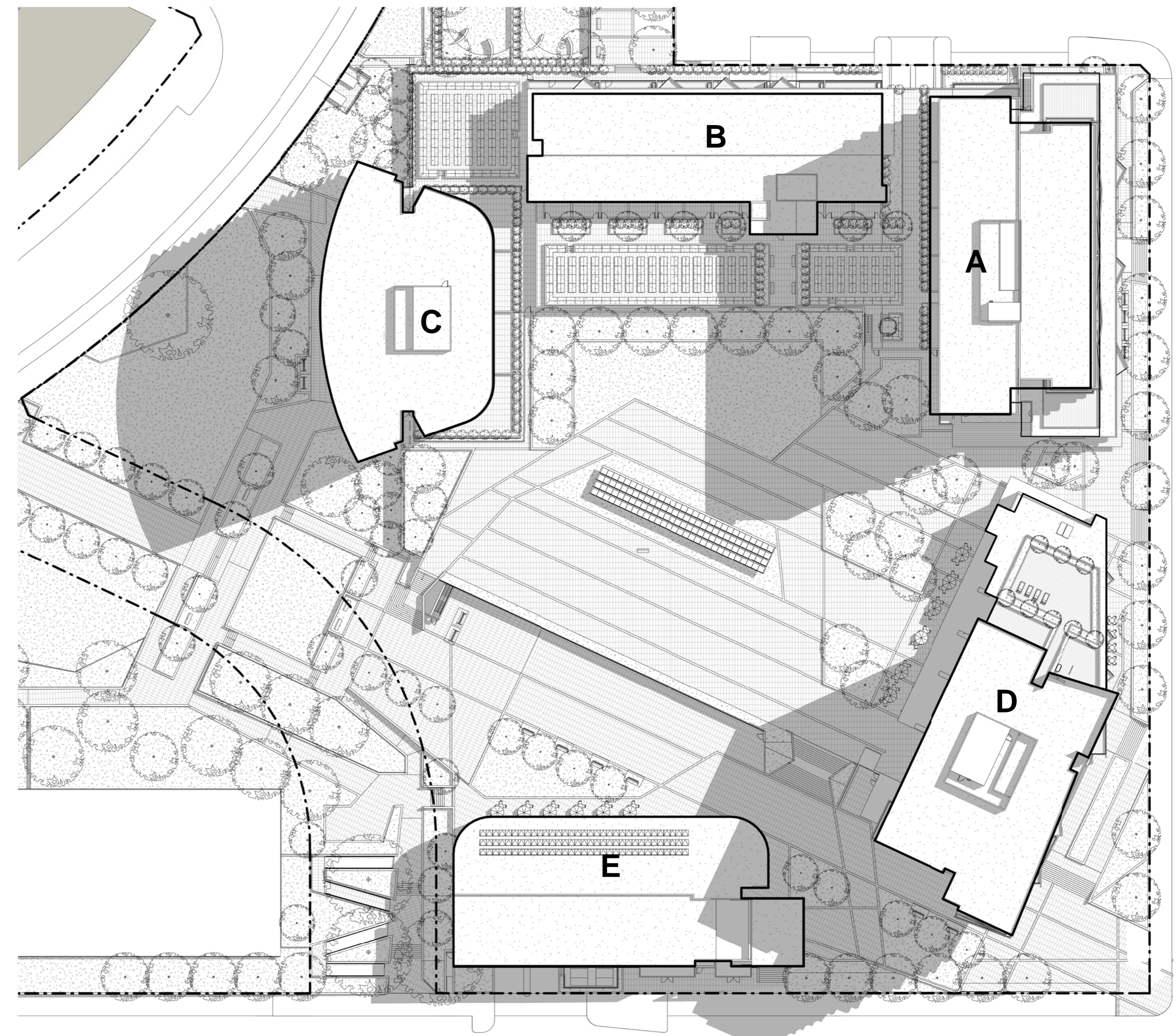

Summer 1000

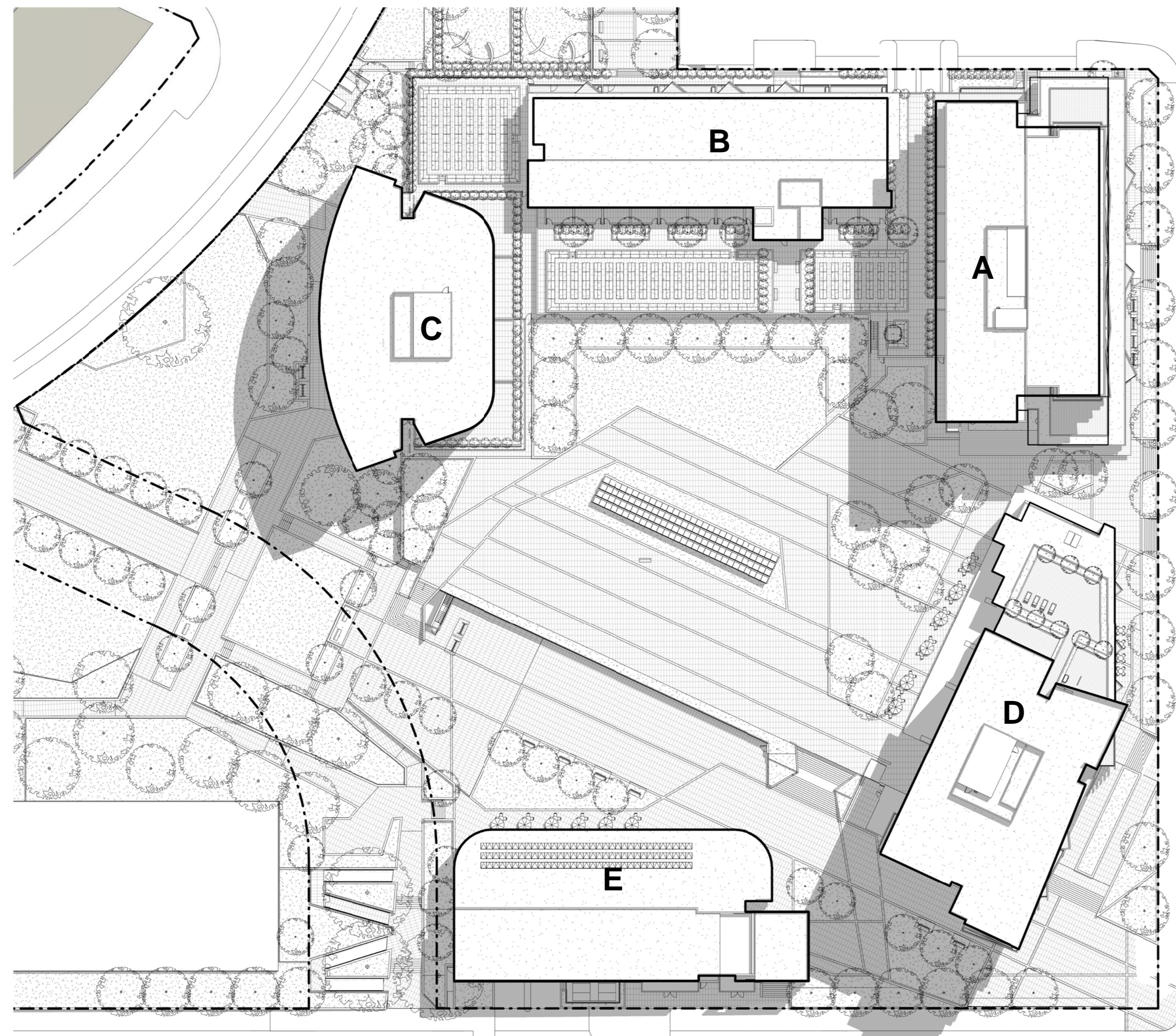

Summer 1100

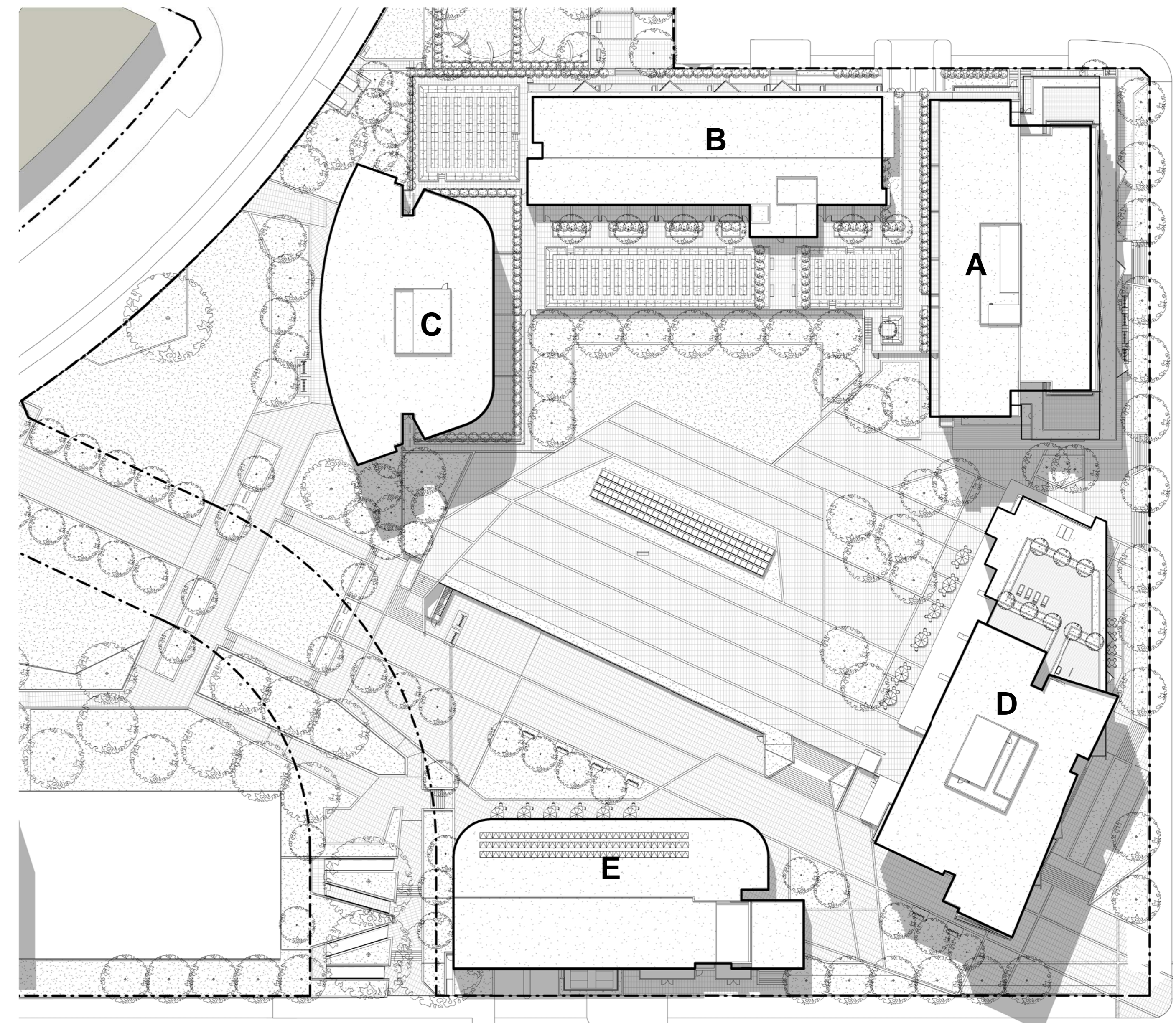

Summer 1200

In accepting and utilizing this document the recipient agrees that SJB Architects (NSW) Pty. Ltd. ACN 081 094 724 (SJB Architects) retain all common law, statutory law and other rights including copyright and intellectual property rights. The recipient agrees not to use this document for any purpose other than its intended use, to waive all claims against SJB Architects resulting from unauthorised changes, or to reuse the document on other projects without the prior written consent of SJB Architects. Under no circumstances shall transfer of this document be deemed a sale. SJB Architects makes no warranties of fitness for any purpose.

The Builder/Contractor shall verify job dimensions prior to any work commencing. Figured dimensions shall take precedence over scaled work.

| Rev. | Date | Revision |
|------|------------|---------------------|
| A | 12/11/2010 | DA Test of Adequacy |
| A-1 | 22/02/2011 | Preferred Project |

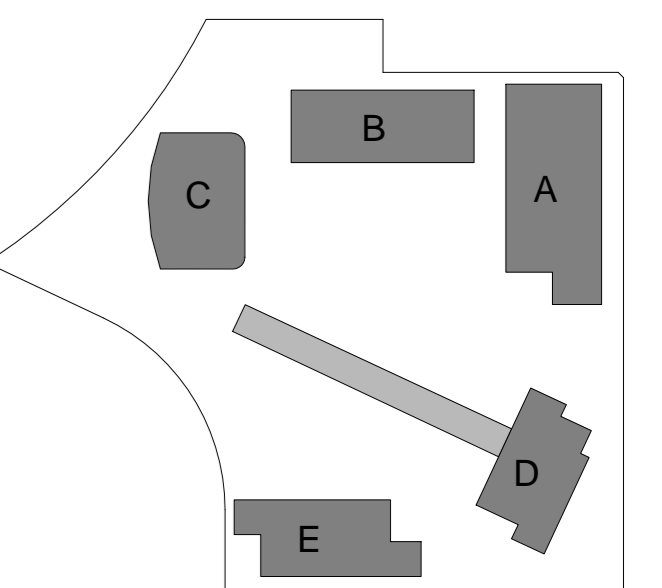

Client

Billbergia
creating communities

Project
STAGE 2A + 3A
WALKER ST.
RHODES
 for
Billbergia Developments

Drawing Name
Shadows - Summer
December 21st
9am-12pm

| Date | Scale | Sheet Size |
|-------------|---------------|------------|
| 08/12/10 | 1 : 500 | @ B1 |
| Reg No. | Drawn | Chk. |
| | DP/NH | JP |
| Job No. | Drawing No. | Revision |
| 4410 | A-0253 | A-1 |

SJB Architects
 Level 2, 490 Crown St
 Surry Hills NSW
 2010 Australia
 T 61 2 9380 9811
 F 61 2 9380 9822
 www.sjb.com.au
 Norman Architects
 Adam Haddock 7188
 John Pradel 7004

