

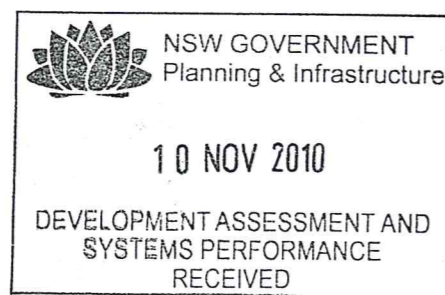



West Circular Quay Public Domain Revitalisation

Project Plans prepared for Environmental Assessment Project Application
June 2010



	NSW GOVERNMENT Planning
Issued under the <i>Environmental Planning and Assessment Act 1979</i>	
Approved Application No... <u>10-0104</u>	
granted on the... <u>27/6/11</u>	
Signed... <u>Roy Wong</u>	
Sheet No... <u>1</u> of... <u>38</u>	

Public Works
Government Architect's Office

PRINCIPLES

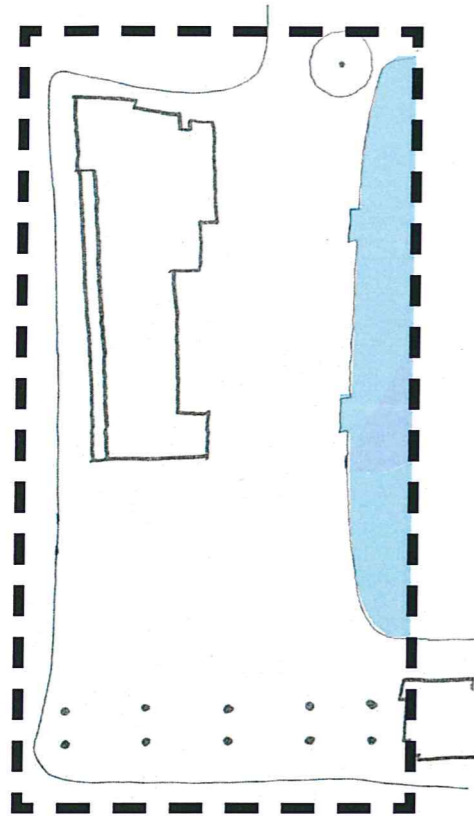

1# a unified space rather than series of separate parts

- Create a solution that unifies disparate spaces and elements to create a cohesive whole.
- Recognise the significance of the space within the wider context of Circular Quay, the redevelopment of the MCA and the future public urban square on Alfred Street.

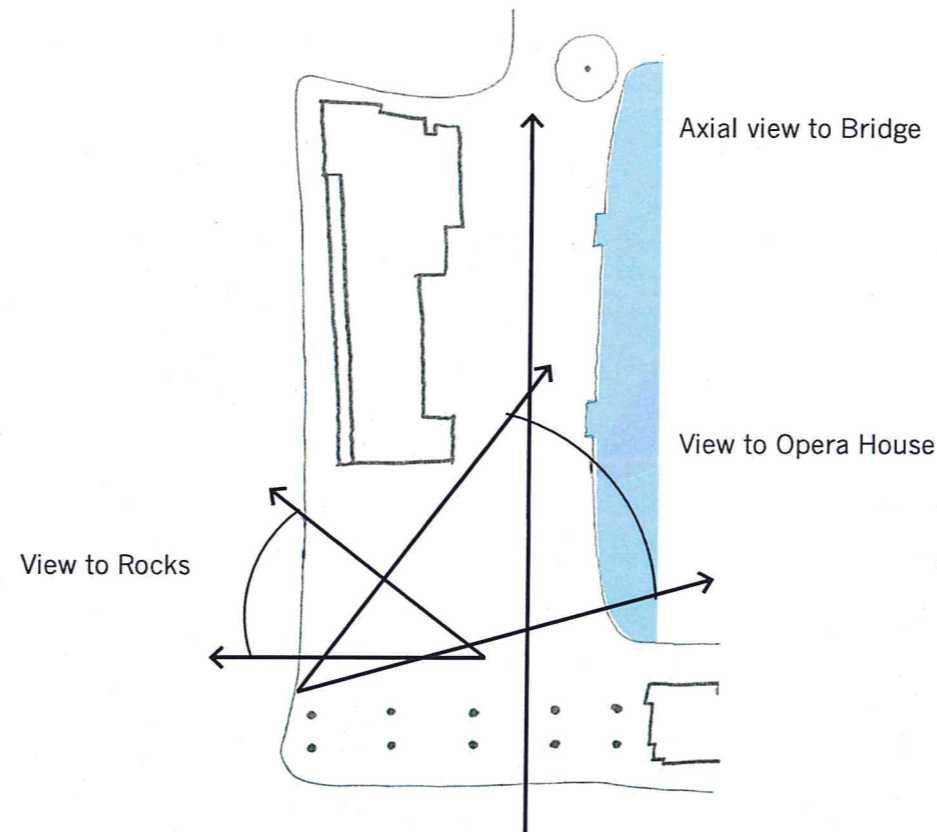
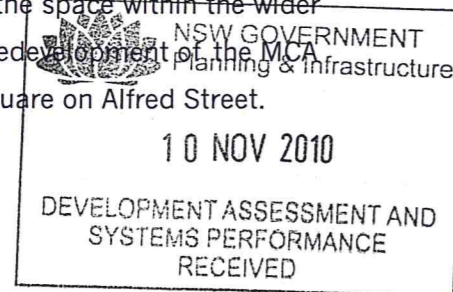

2# the broad view

- Open views to and from George Street, and along the waterfront.
- Remove planting to allow for unobstructed prospect of the harbour and the Opera House.

NSW GOVERNMENT
Planning

Issued under the Environmental Planning and Assessment Act 1979

Approved Application No. 10-0104

granted on the 27/6/11

Signed Rug Woy.

Sheet No. 2 of 30

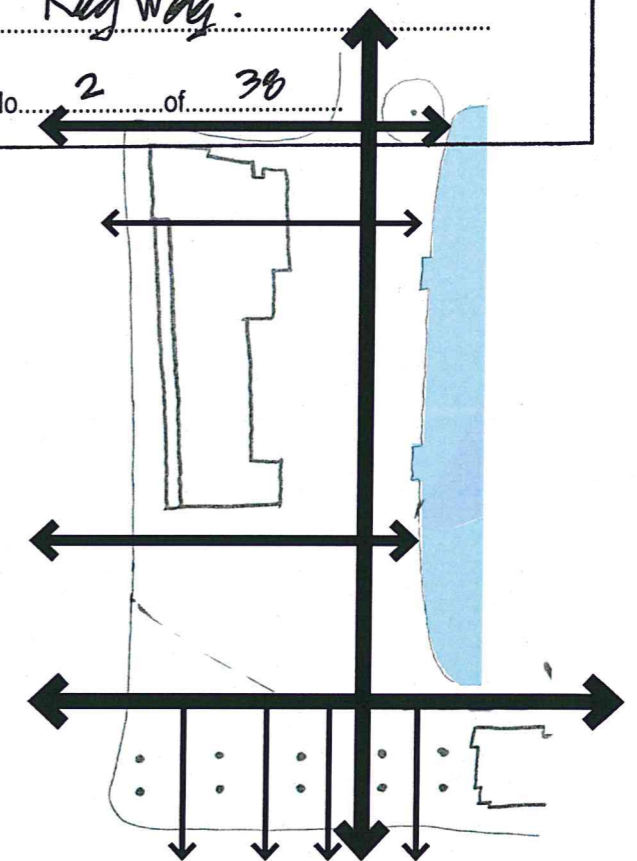



3# connections + permeability

- Improve access from First Fleet Park and Circular Quay West to the Rocks.
- Create unimpeded access from Alfred Street to First Fleet park and beyond.
- Create a structure that works in tandem with the network of streets and lanes in the rocks.
- Remove barriers, edges and clutter to allow for unimpeded access.

PRINCIPLES DIAGRAM

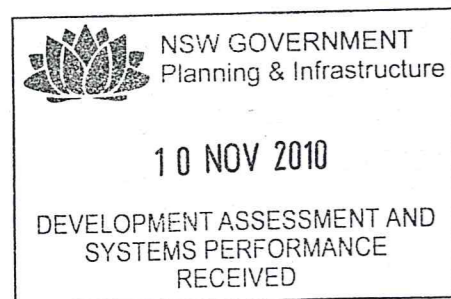
1. Create a simplified and unified space
2. Create clear and generous links to the Rocks and George Street and Alfred Street.
3. Reinforce the promenade and create informal and formal seating for viewing.
4. Create a square at the MCA for outdoor exhibitions
5. Locate landmark trees to preserve views and provide shade.



 **NSW GOVERNMENT**
Planning

Issued under the Environmental Planning and Assessment Act 1979

Approved Application No. 10-0104

granted on the 27/6/11

Signed R. Wang

Sheet No. 3 of 38

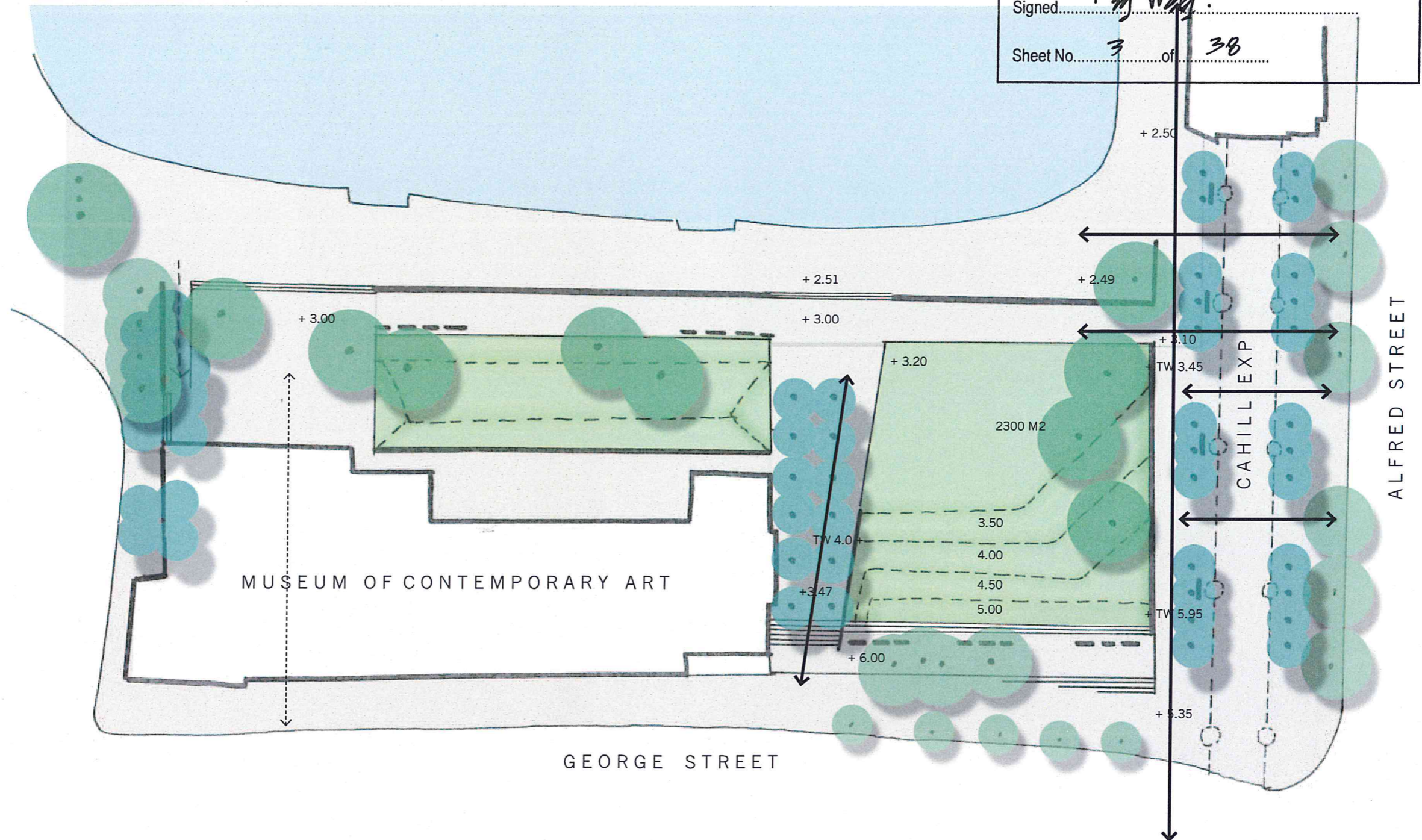

SCALE 1:750

0 10 25 50

NORTH



WEST CIRCULAR QUAY - PUBLIC DOMAIN REVITALISATION

Public Works
Government Architect's Office



utilise the topography

Create a lawn 'stage', an amphitheater that connects George Street and The Rocks to Circular Quay.

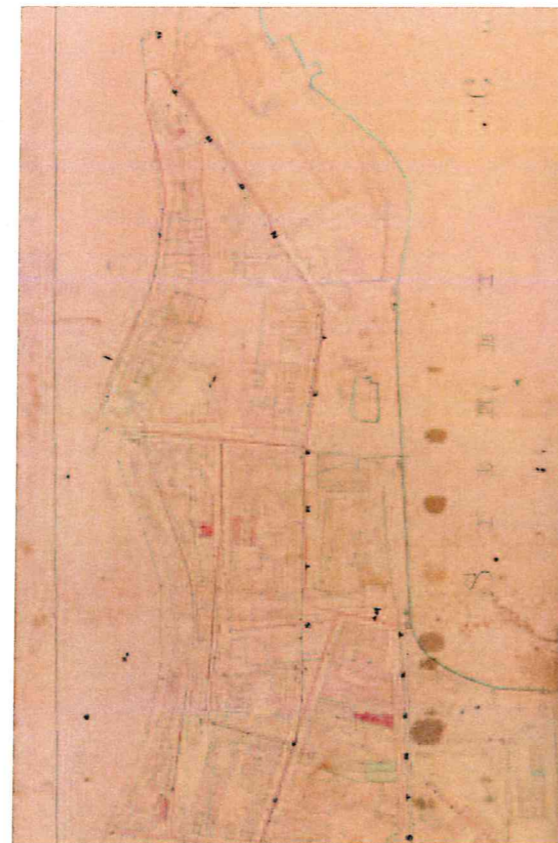

a tangible history

Create a structure that is informed by the history of the site. This may include the former historic alignments.

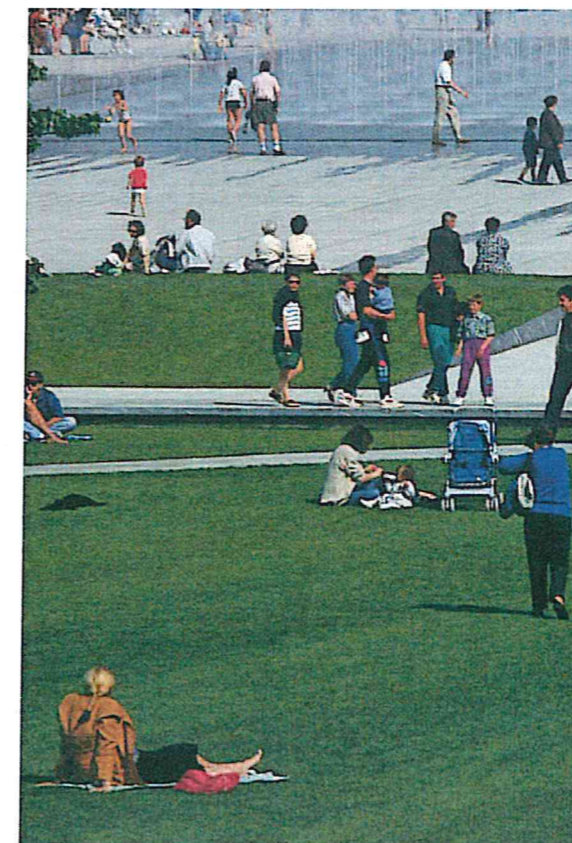

a place of respite

Create a place of respite, an oasis from the activity of the Quay. Create opportunities for informal and formal seating, places to watch, recline and picnic.

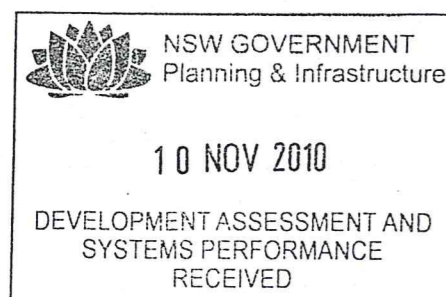

 NSW GOVERNMENT Planning	
<i>Issued under the Environmental Planning and Assessment Act 1979</i>	
Approved Application No. <u>10-0104</u>	
granted on the <u>27/6/11</u>	
Signed <u>Ram Wong.</u>	
Sheet No. <u>4</u>	of <u>38</u>



NSW GOVERNMENT
Planning

Issued under the Environmental Planning and Assessment Act 1979

Approved Application No. 10-0104

granted on the 27/6/11

Signed Ray Wray

Sheet No. 5 of 38

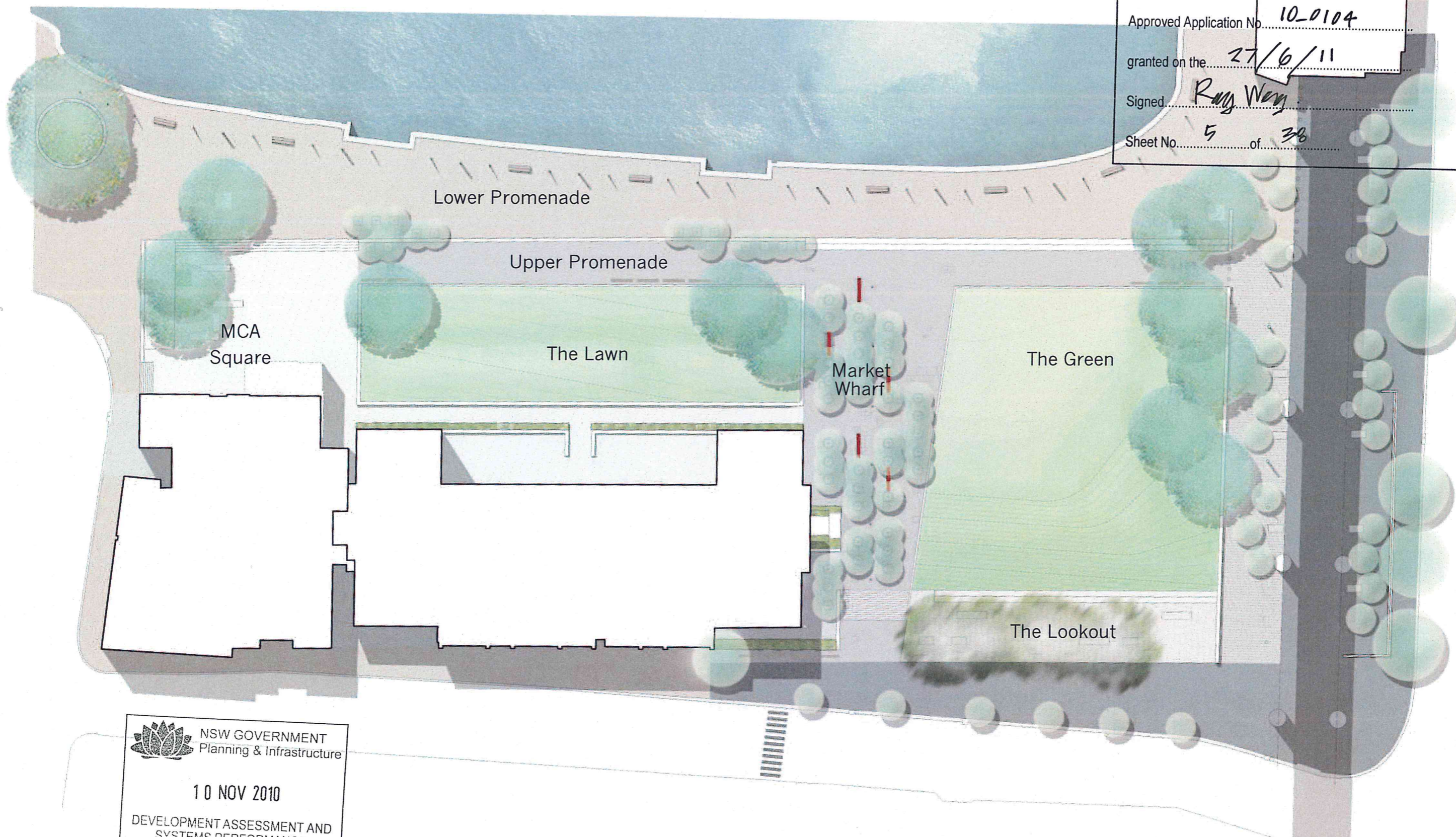

NSW GOVERNMENT
Planning & Infrastructure

10 NOV 2010

DEVELOPMENT ASSESSMENT AND
SYSTEMS PERFORMANCE
RECEIVED



NORTH

PRINCIPLES

1. Create a simplified and unified space

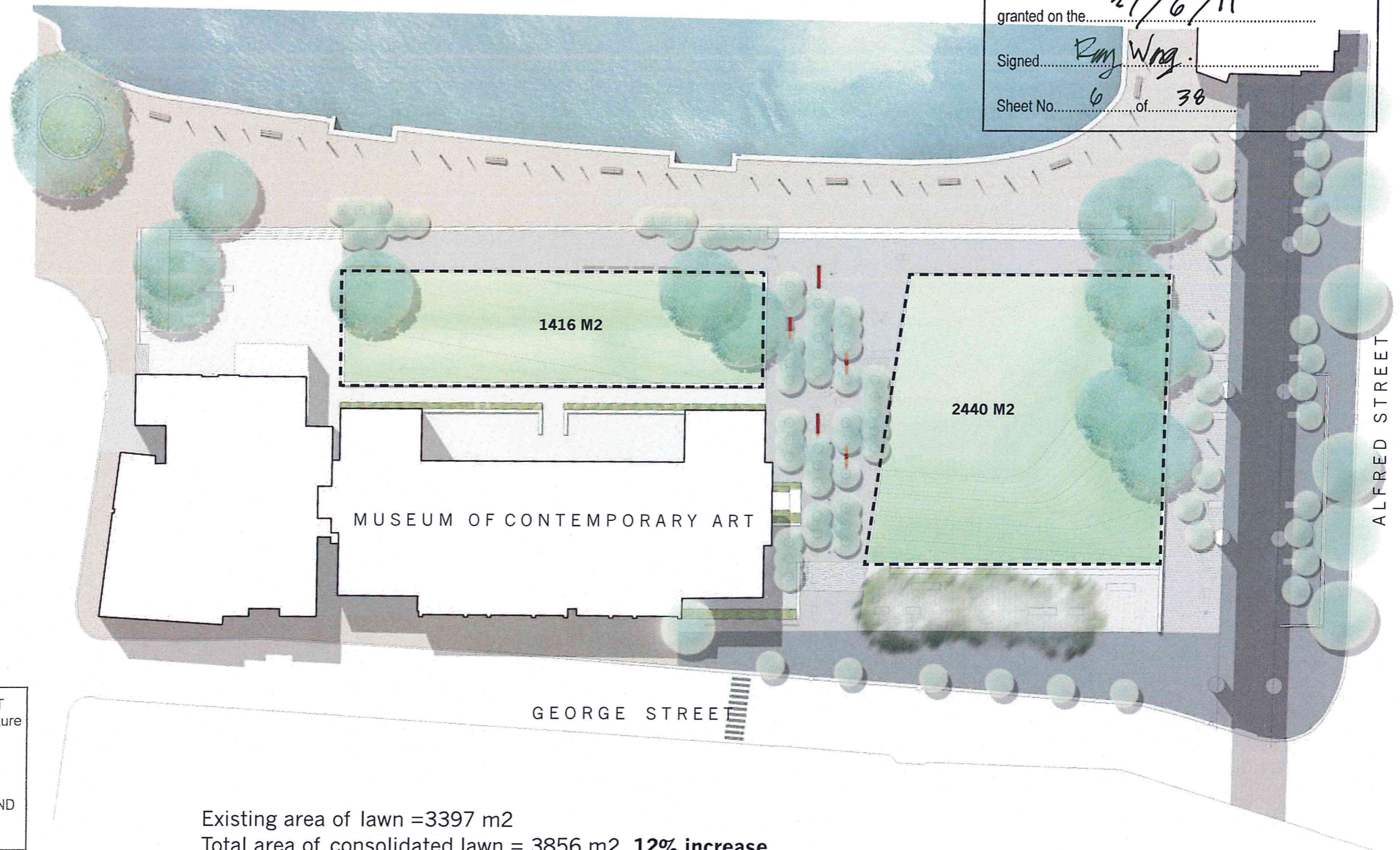

NSW GOVERNMENT
Planning

Issued under the Environmental Planning and Assessment Act 1979

Approved Application No. 10-0104

granted on the 27/6/11

Signed Rmy Wng.

Sheet No. 6 of 38



NSW GOVERNMENT
Planning & Infrastructure

10 NOV 2010

DEVELOPMENT ASSESSMENT AND
SYSTEMS PERFORMANCE
RECEIVED



PRINCIPLES

1. Create a simplified and unified space

Integration with existing surrounding levels to create

- seamless lawn space that grades down to the foreshore
- accessible route to George Street

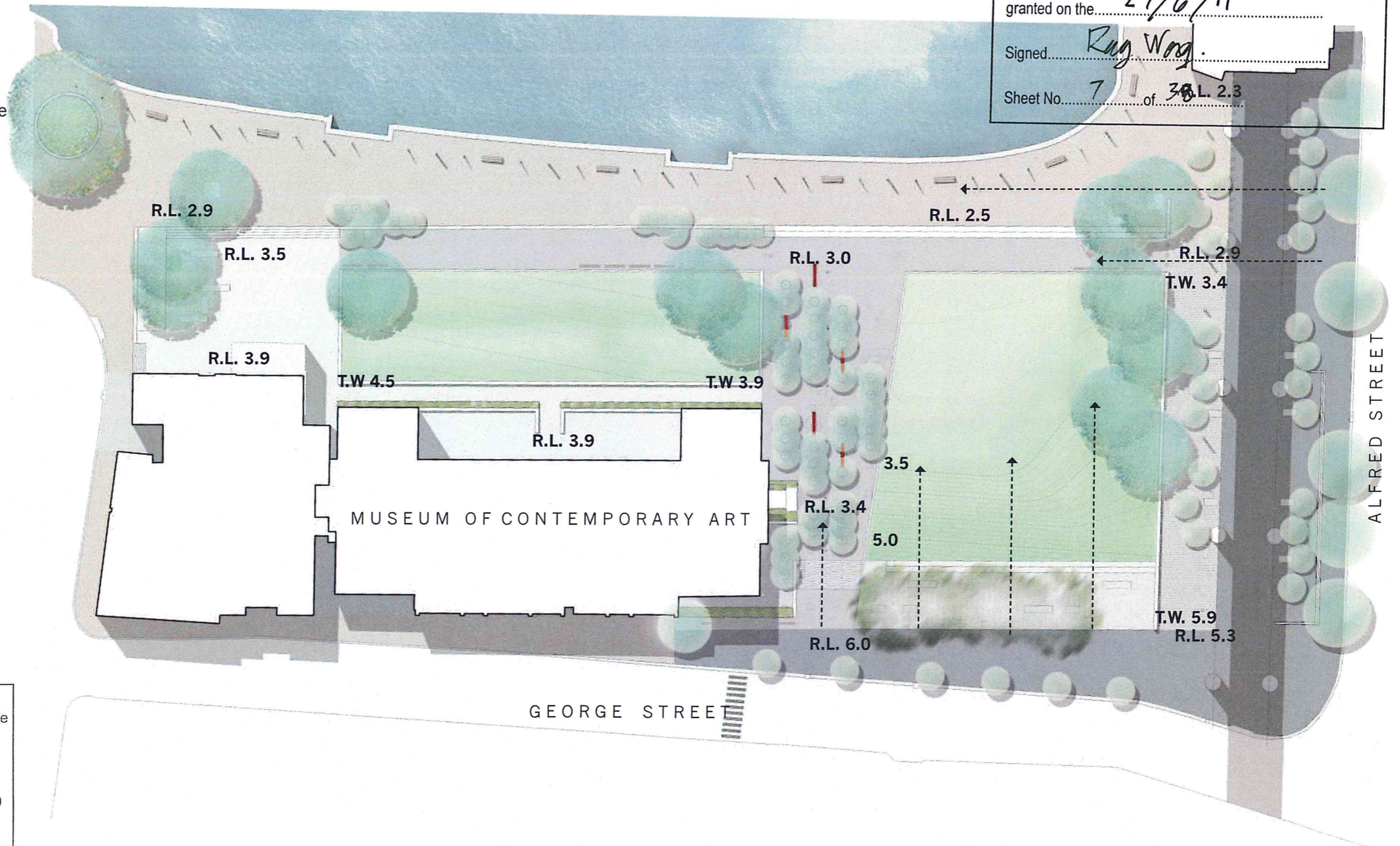

NSW GOVERNMENT
Planning

Issued under the Environmental Planning and Assessment Act 1979

Approved Application No. 10.0104

granted on the 27/6/11

Signed Ray Wong.

Sheet No. 7 of 30 L. 2.3



NSW GOVERNMENT
Planning & Infrastructure

10 NOV 2010

DEVELOPMENT ASSESSMENT AND
SYSTEMS PERFORMANCE
RECEIVED



PRINCIPLES

1. Create a simplified and unified space
2. Create clear and generous pedestrian links to the Rocks, George St and Alfred Street

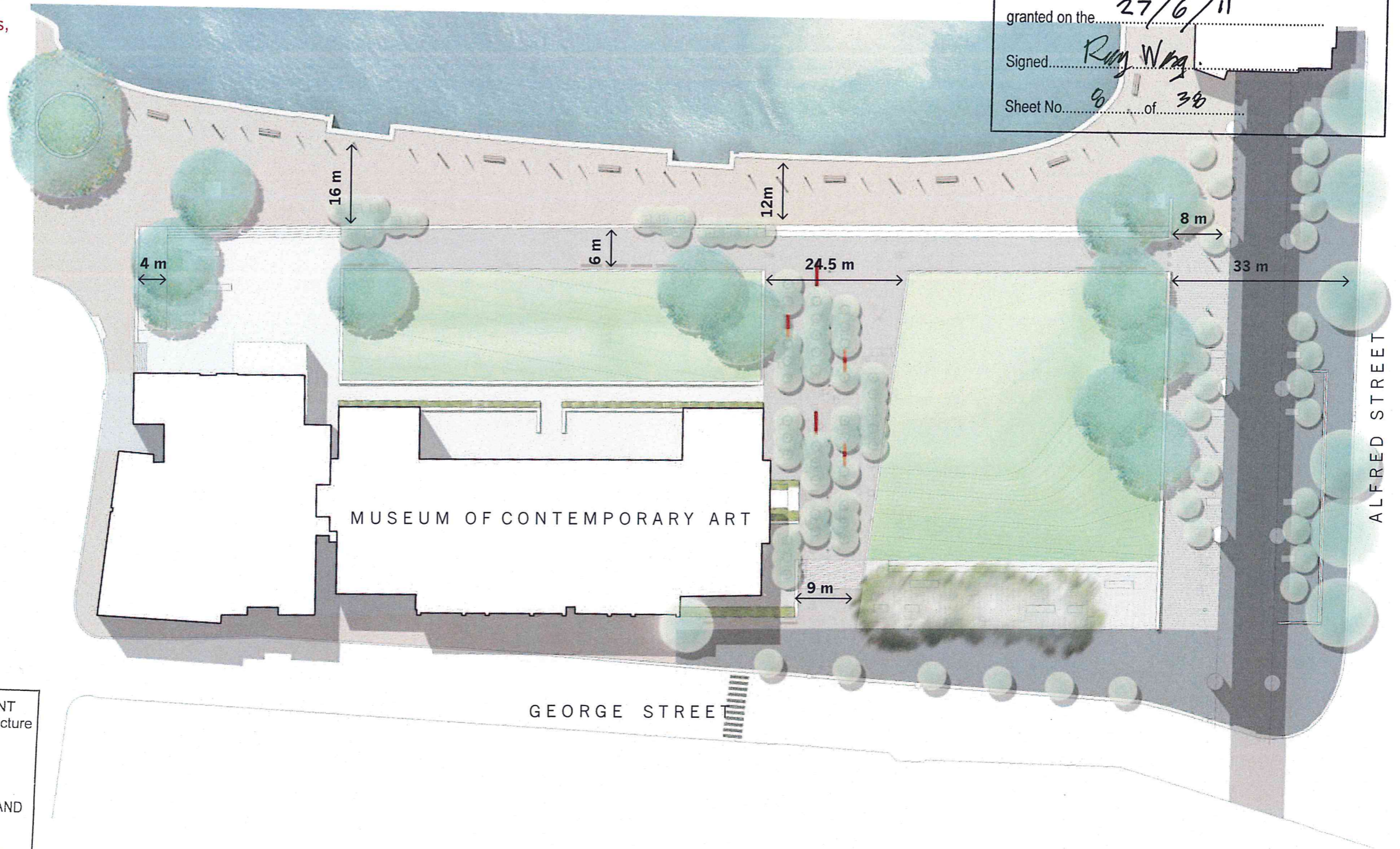

NSW GOVERNMENT
Planning

Issued under the Environmental Planning and Assessment Act 1979

Approved Application No. **10-0104**

granted on the **27/6/11**

Signed **Roy Wray**

Sheet No. **8** of **38**



NSW GOVERNMENT
Planning & Infrastructure

10 NOV 2010

DEVELOPMENT ASSESSMENT AND
SYSTEMS PERFORMANCE
RECEIVED

GEORGE STREET

ALFRED STREET



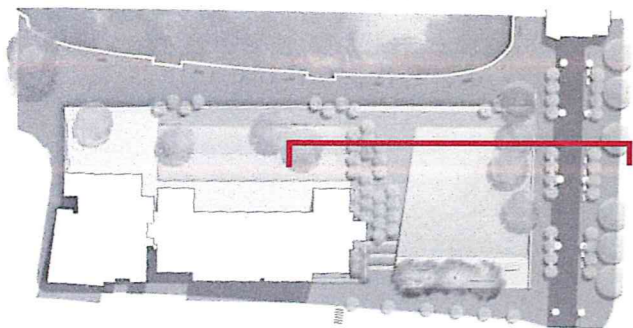

NSW GOVERNMENT
Planning

Issued under the Environmental Planning and Assessment Act 1979

Approved Application No. 10-0104

granted on the 27/6/11

Signed Romy Wong

Sheet No. 9 of 38

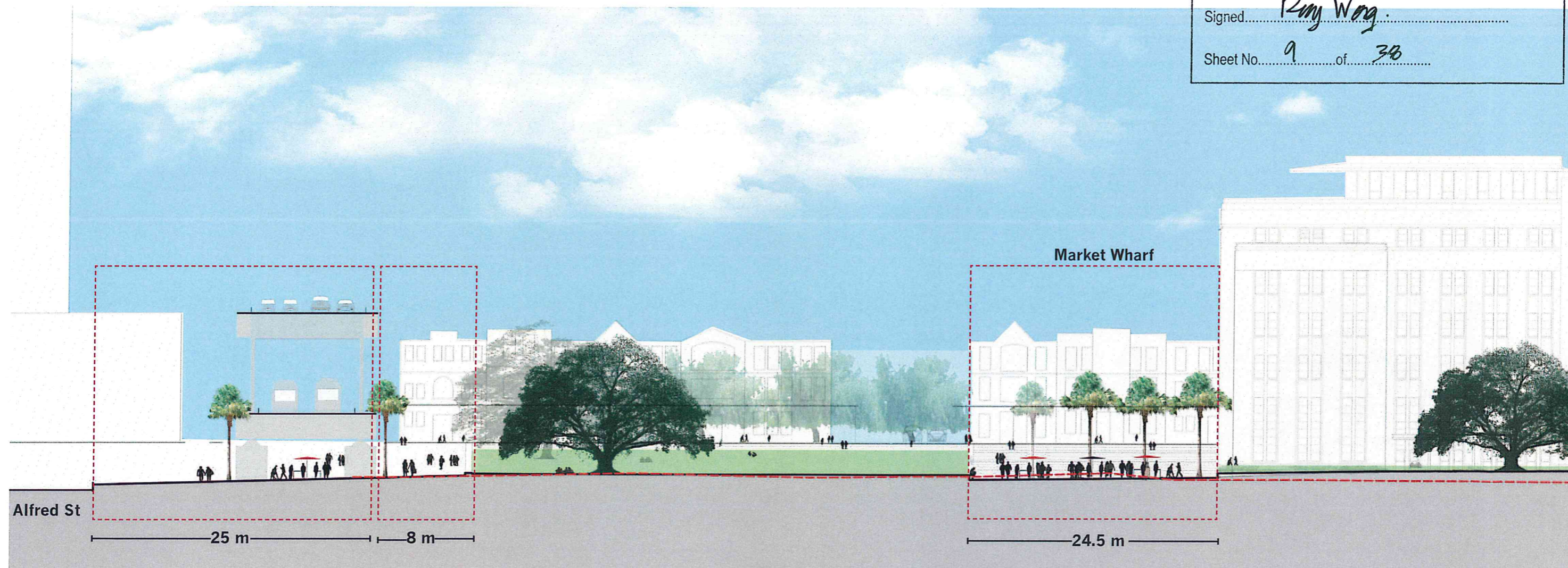

NSW GOVERNMENT
Planning & Infrastructure

10 NOV 2010

DEVELOPMENT ASSESSMENT AND
SYSTEMS PERFORMANCE
RECEIVED

CIRCULATION



1 **Signage location:**
Incorporate way finding
signage into paving at key
junctions

Primary entries/uses

**Existing entry to MCA
building : not for public
access**

Primary access path
equal access route

Primary access path
With stairs

Secondary access path

 **NSW GOVERNMENT
Planning**

Issued under the Environmental Planning and Assessment Act 1979

Approved Application No. 120104

granted on the 27/6/11

Signed Rmy Wong

Sheet No. 10 of 38

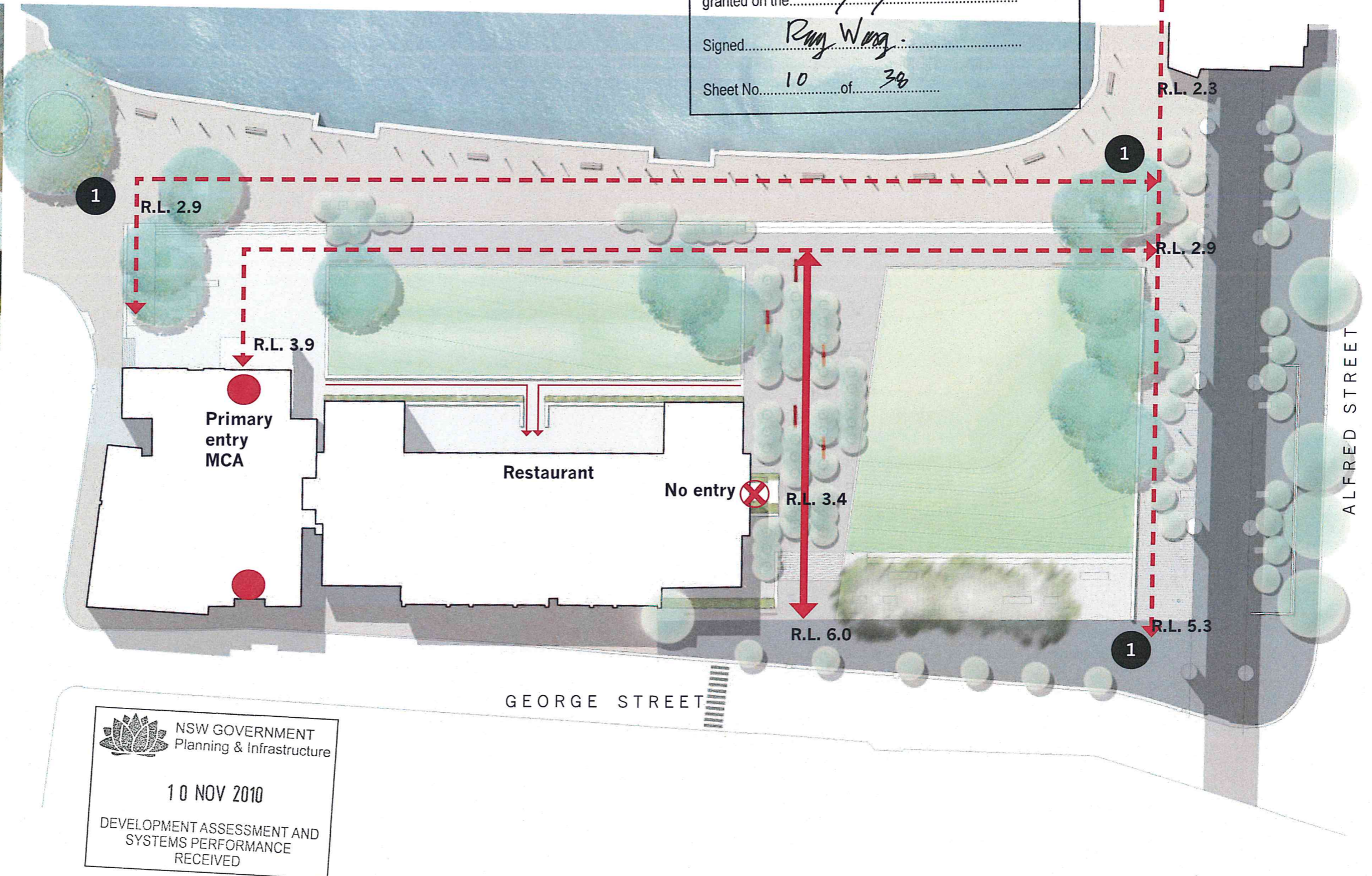

 **NSW GOVERNMENT
Planning & Infrastructure**



10 NOV 2010

DEVELOPMENT ASSESSMENT AND
SYSTEMS PERFORMANCE
RECEIVED

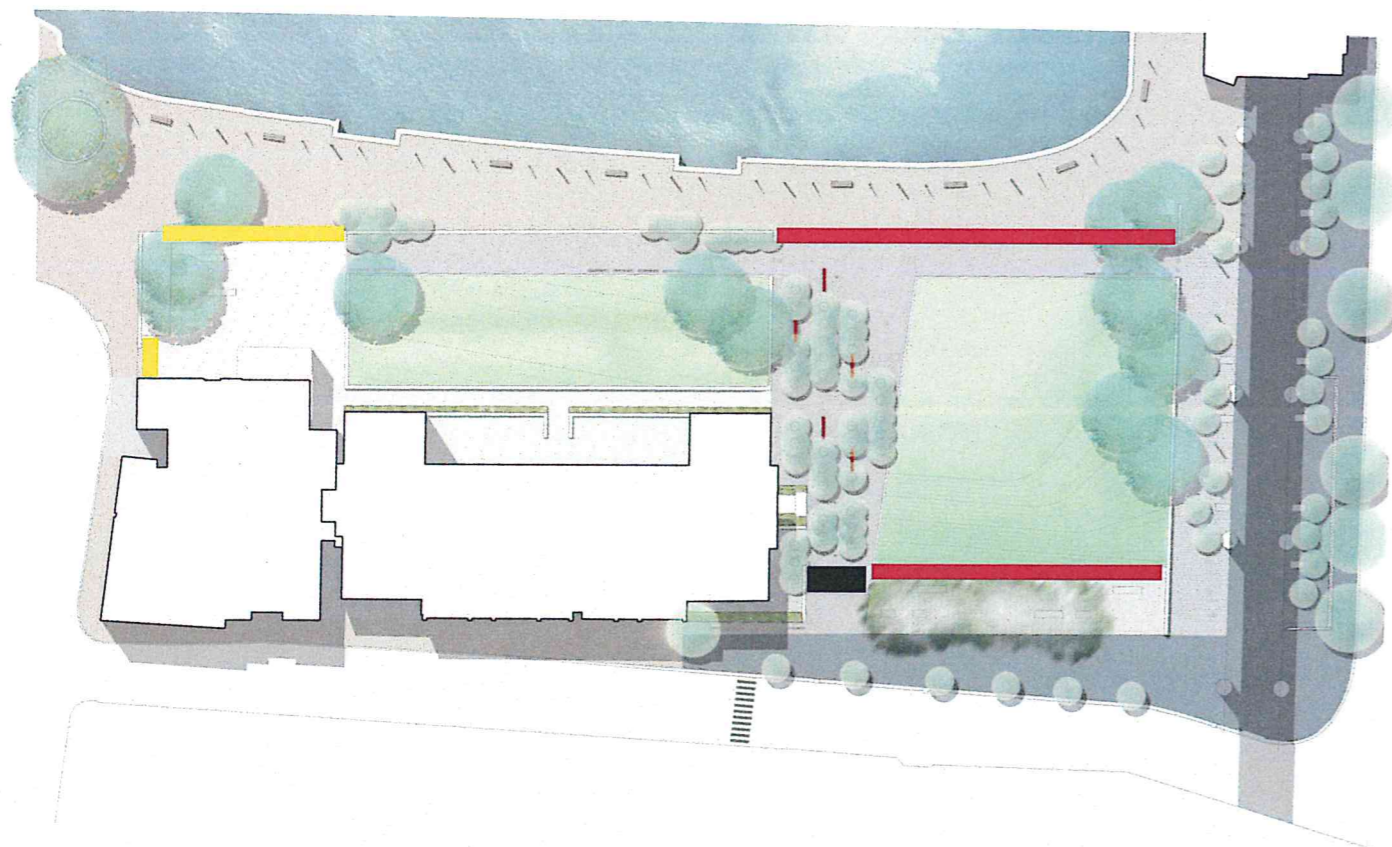



2 . Access: steps

-  **Step Type 1:** Access stair 310mm wide x 155mm high treads granite
-  **Step Type 2:** Seat/ access steps 600 mm wide x 155 mm high treads concrete
-  **Step Type 3:** Access steps 310 mm wide x 155 mm high treads concrete

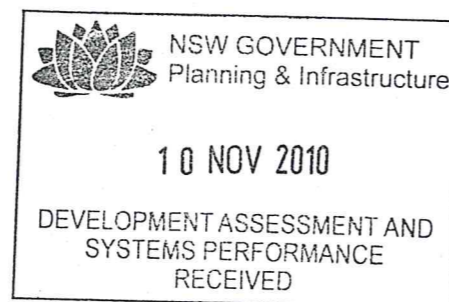

Step Type 1: Access stair 310mm wide x 155mm high treads granite to match paving

Step Type 2: Seat/ access steps 600 mm wide x 155 mm high treads precast concrete

NSW GOVERNMENT
 Planning

Issued under the Environmental Planning and Assessment Act 1979

Approved Application No. 10-0104

granted on the 27/6/11

Signed Ray Wang

Sheet No. 11 of 38

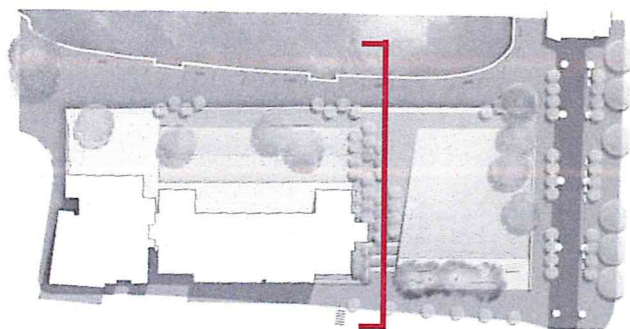

NSW GOVERNMENT
Planning

Issued under the Environmental Planning and Assessment Act 1979

Approved Application No. 10-0104

granted on the 27/6/11

Signed Rug Wrag

Sheet No. 12 of 38

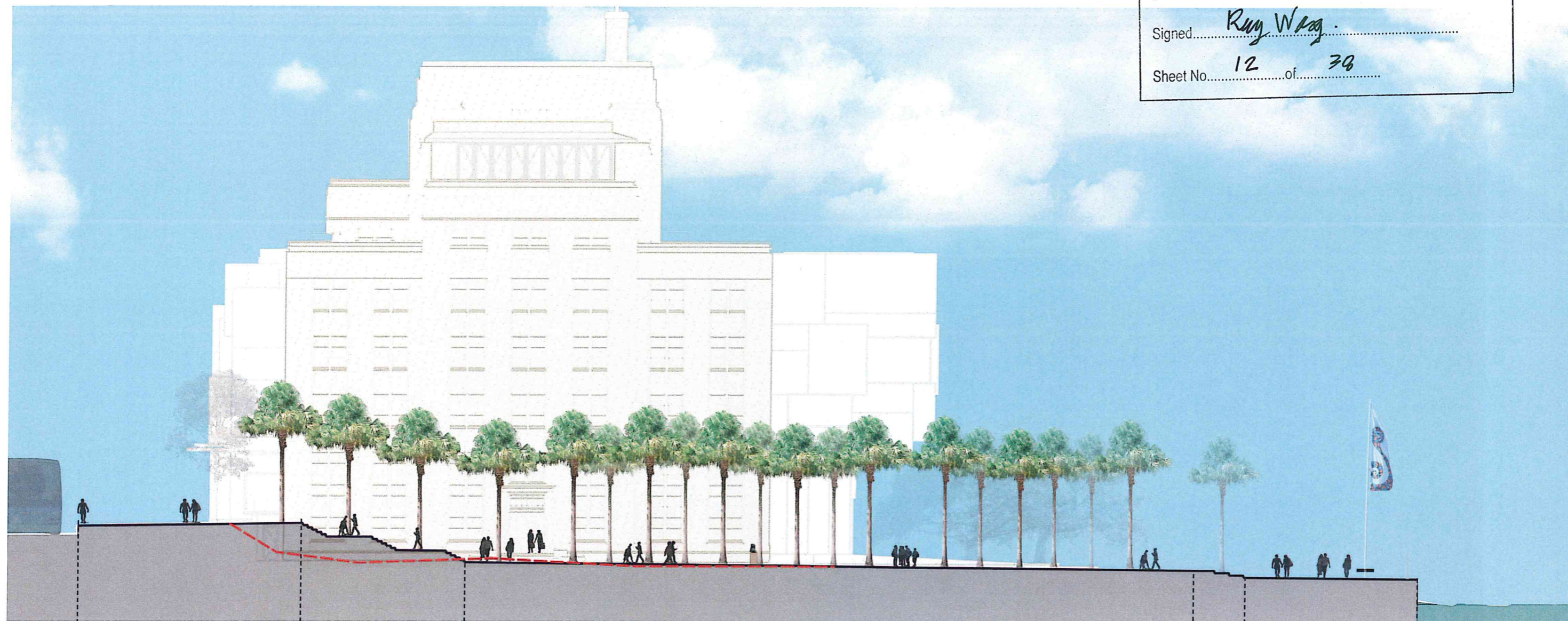

George Street Footpath

Access stair
Step Type 1

Market Wharf

Step
type 2 Lower Promenade



NSW GOVERNMENT
Planning & Infrastructure

10 NOV 2010

DEVELOPMENT ASSESSMENT AND
SYSTEMS PERFORMANCE
RECEIVED



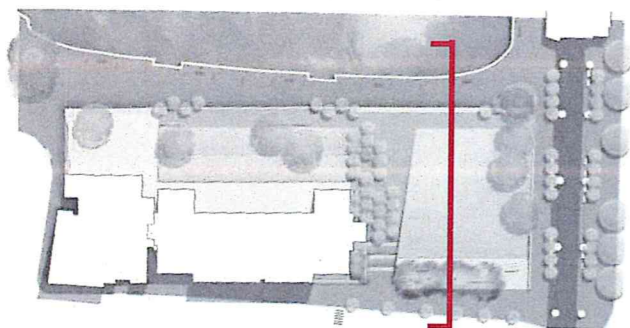

NSW GOVERNMENT
Planning

Issued under the Environmental Planning and Assessment Act 1979

Approved Application No. 10-0104

granted on the 27/6/11

Signed Rug Wagg

Sheet No. 13 of 38

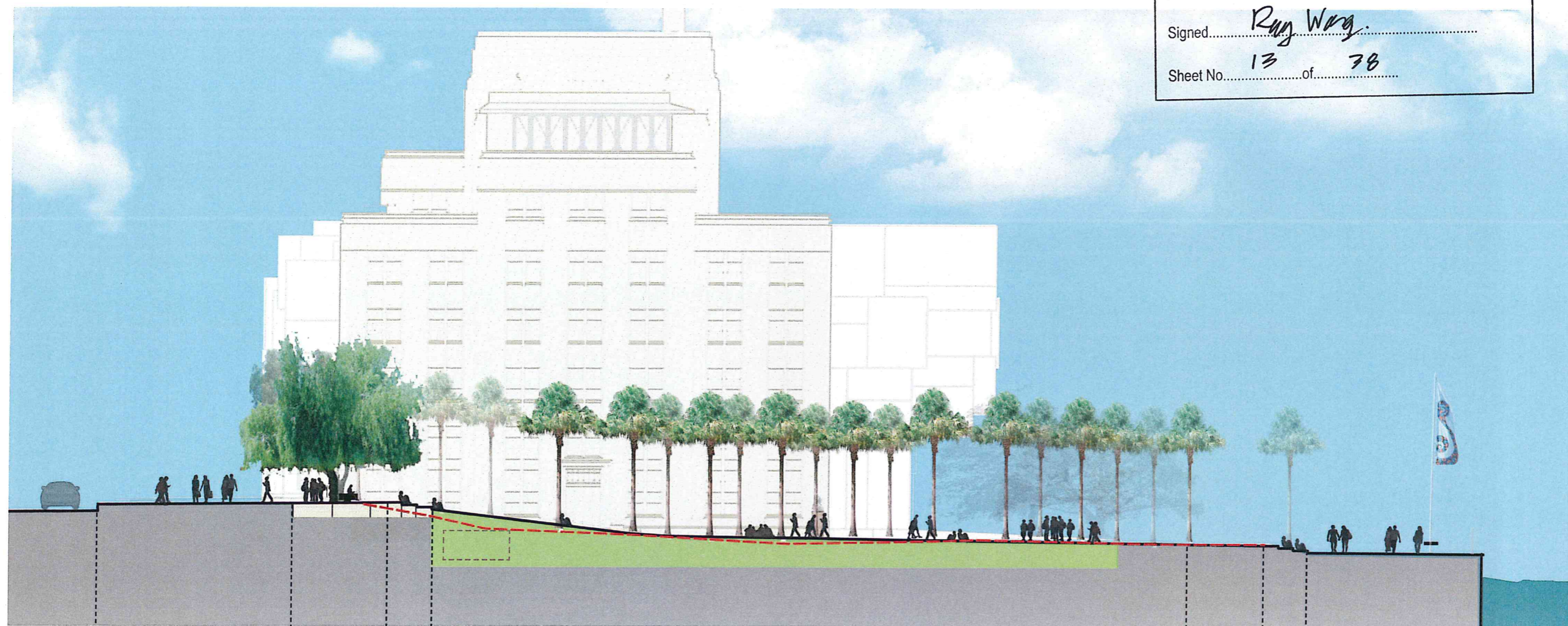

George Street
Footpath

The
Lookout

Step 2
Type 2 Tank



NSW GOVERNMENT
Planning & Infrastructure

10 NOV 2010

DEVELOPMENT ASSESSMENT AND
SYSTEMS PERFORMANCE
RECEIVED

The Green

Upper
Promenade type 2



Step

Lower Promenade



PRINCIPLES

1. Create a simplified and unified park space
2. Create clear and generous pedestrian links to the rocks, George St and Alfred Street
3. Create a square at the MCA entry

-  Interpretation zone
-  MCA square extent
-  MCA entry

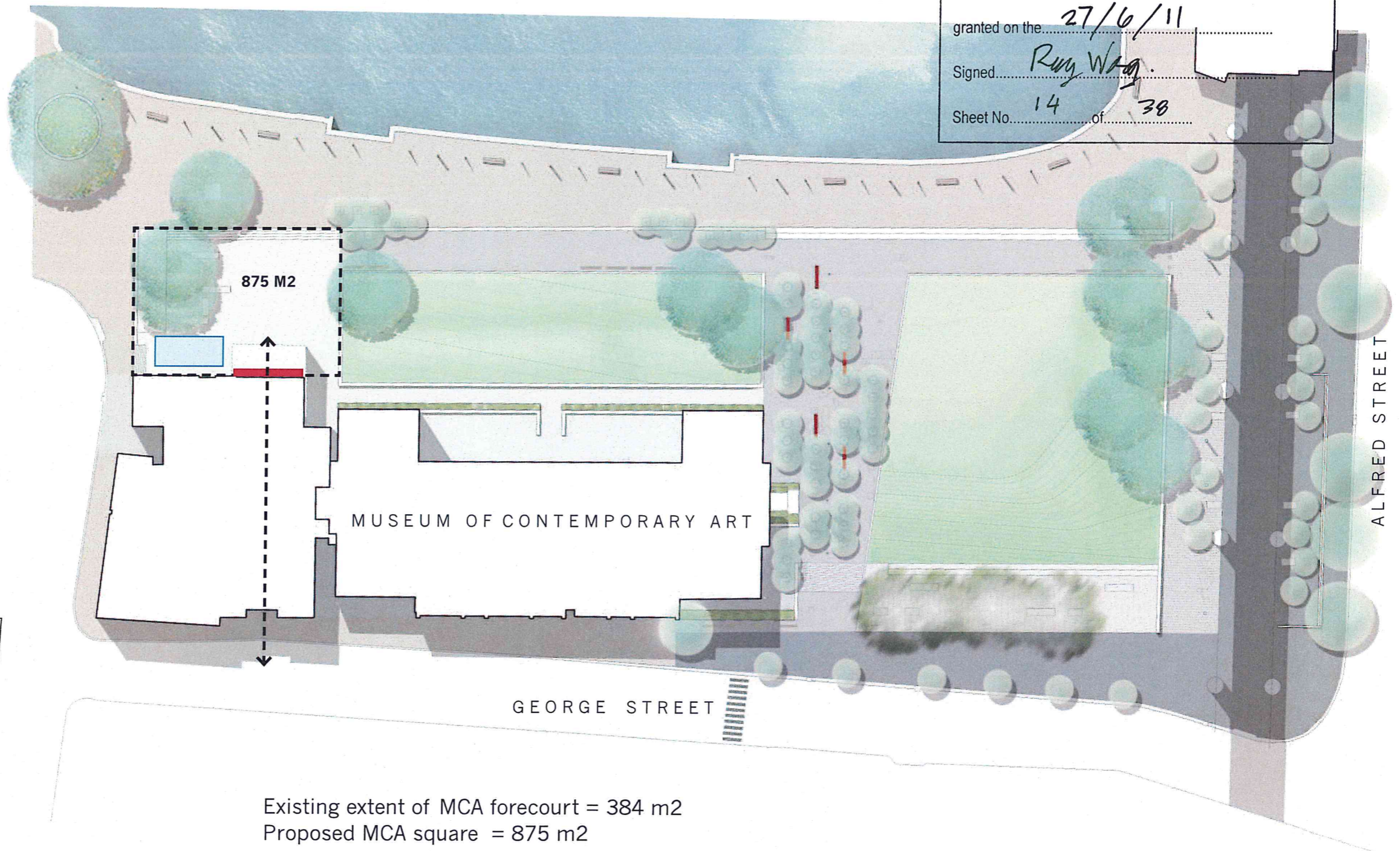

NSW GOVERNMENT
Planning

Issued under the Environmental Planning and Assessment Act 1979

Approved Application No. 10-0104

granted on the 27/6/11

Signed Rug Wagg

Sheet No. 14 of 38

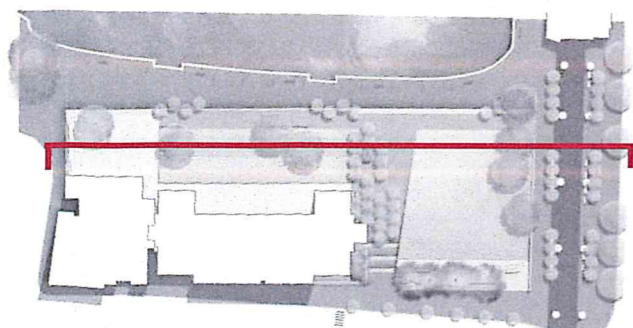

NSW GOVERNMENT
 Planning

Issued under the Environmental Planning and Assessment Act 1979

Approved Application No. 10-0104

granted on the 27/6/11

Signed R. Wang

Sheet No. 15 of 38

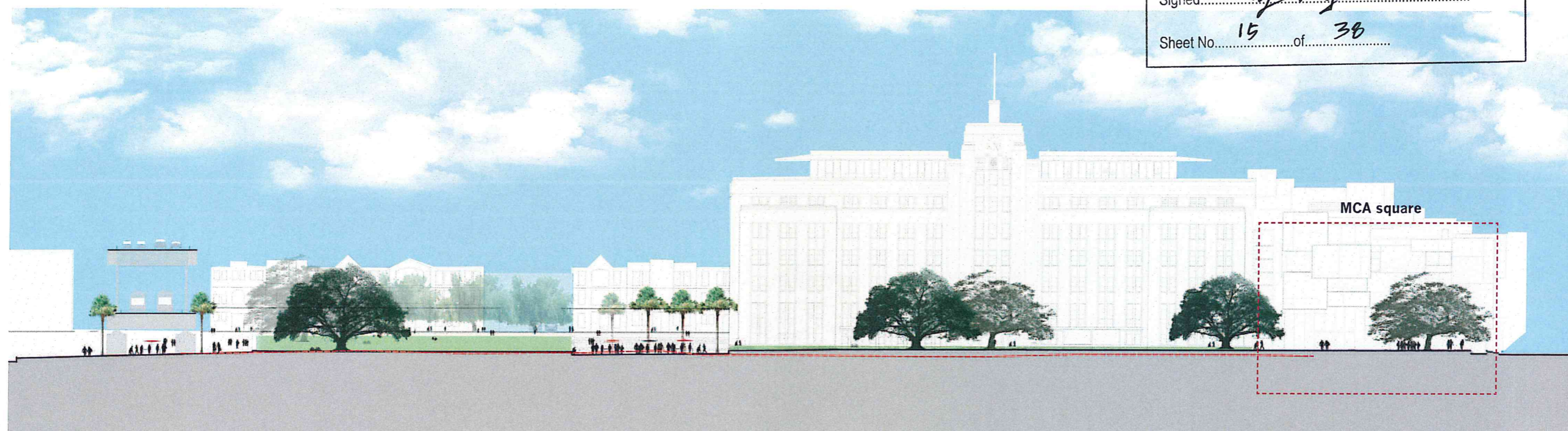

The Green

Market Wharf

The Lawn

36 m

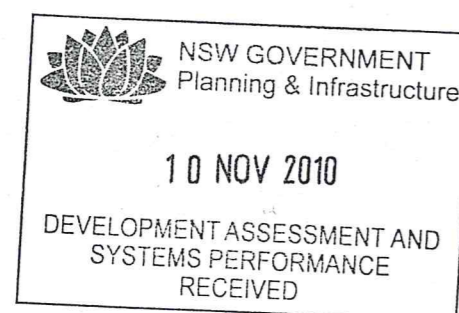

PRINCIPLES

1. Create a simplified and unified park space
2. Create clear and generous pedestrian links to the rocks, George St and Alfred Street
3. Create a square/ forecourt at the MCA
4. Retain and locate landmark trees to preserve views and to provide shade

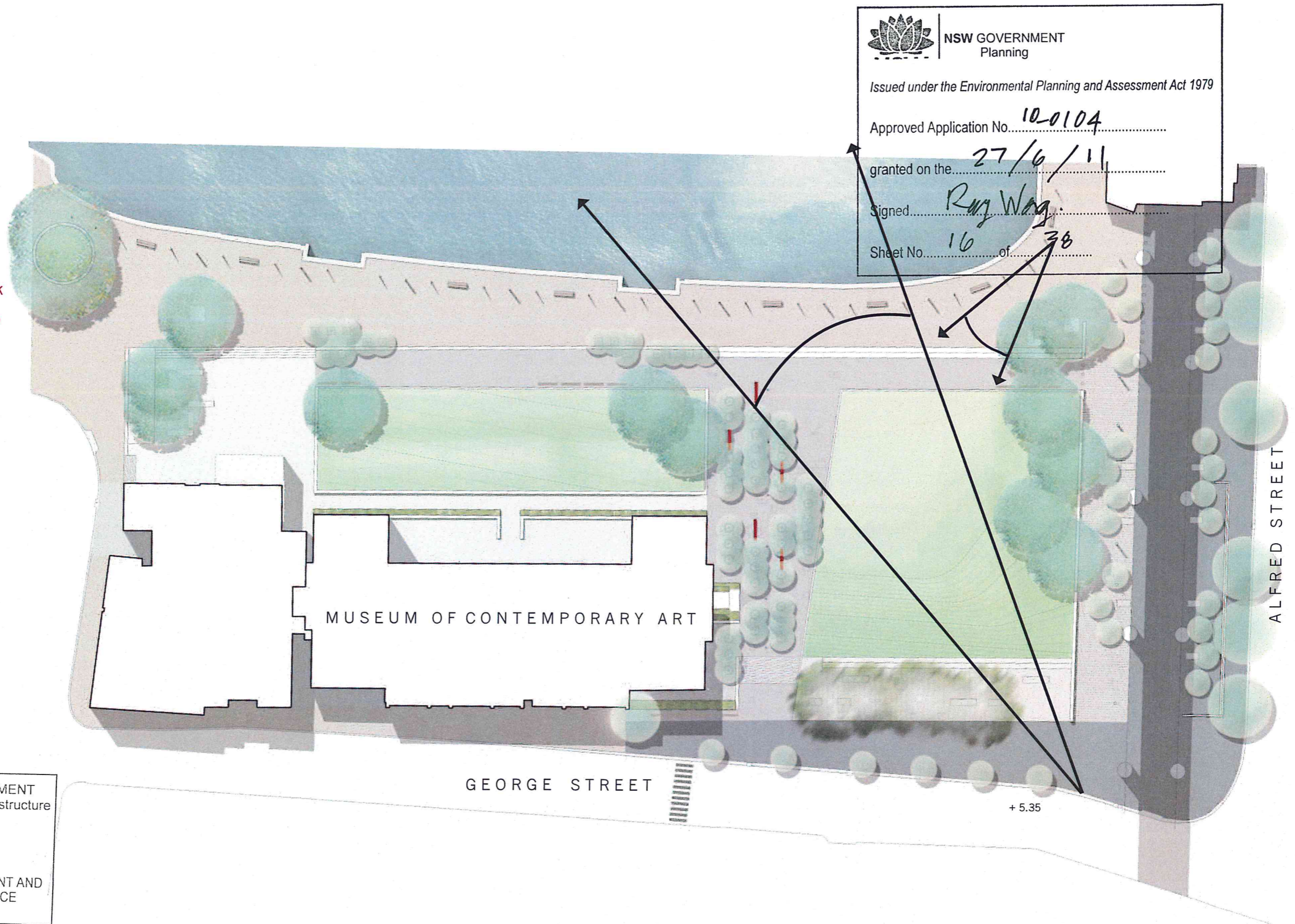

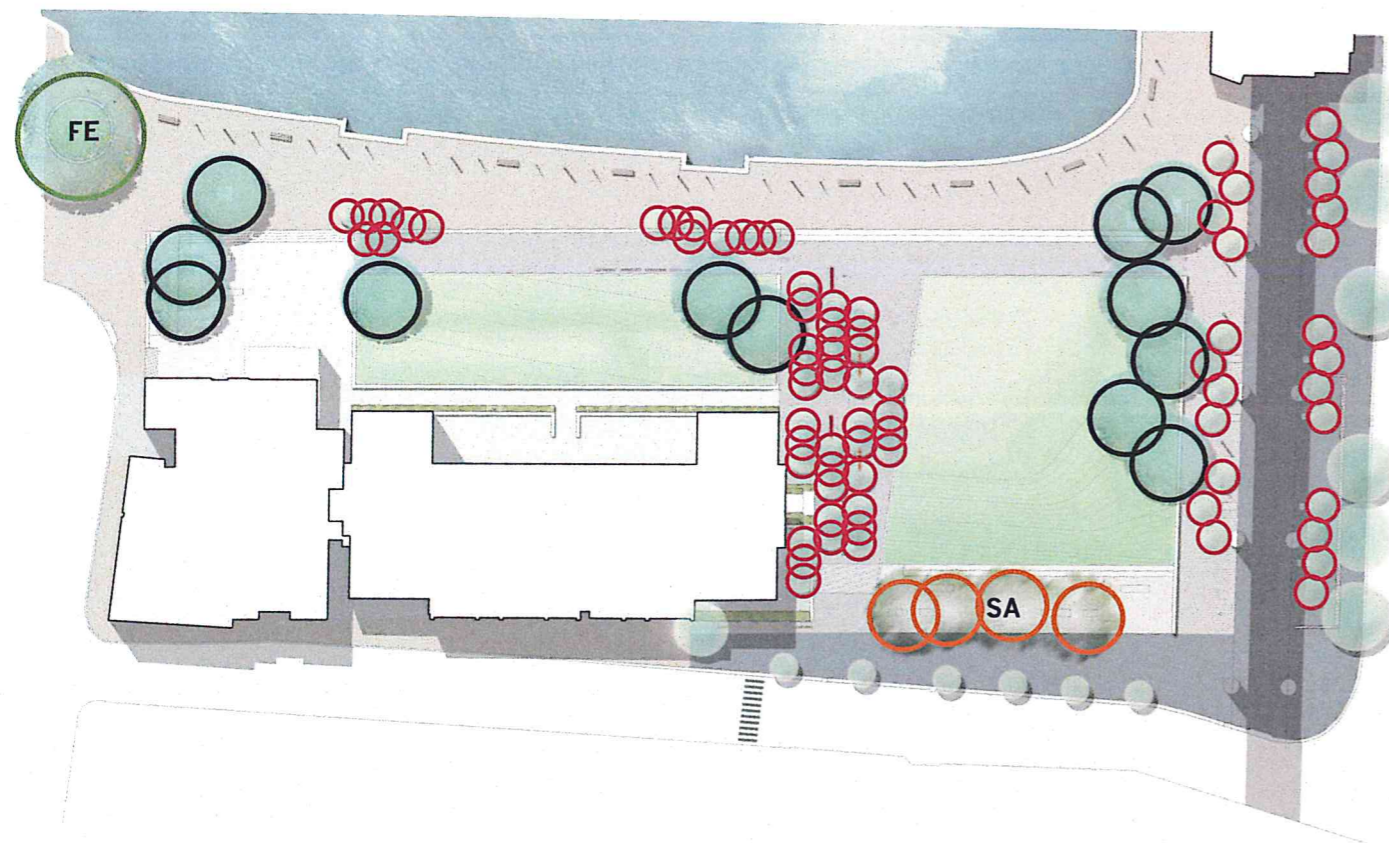

4 . Shade and trees

- FE** **Ficus elastica:** Rubber tree - Retain and address health
- SA** **Schinus areira:** Peppercorn Tree Retain 4 and remove 4
- **Livistona australis:** Cabbage Tree Palms: Total no. 63
(comprising approx 20 relocated from site).
- **Ficus rubiginosa:** Port Jackson Fig: Total no. 12

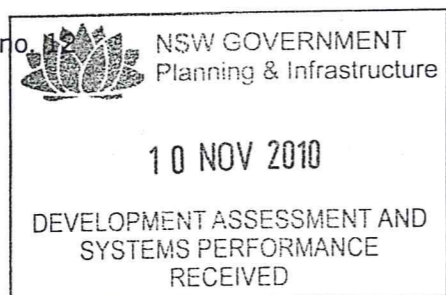

NSW GOVERNMENT
Planning

Issued under the Environmental Planning and Assessment Act 1979

Approved Application No. 10-0104

granted on the 27/6/11

By Ray Wong

No. 17 of 38

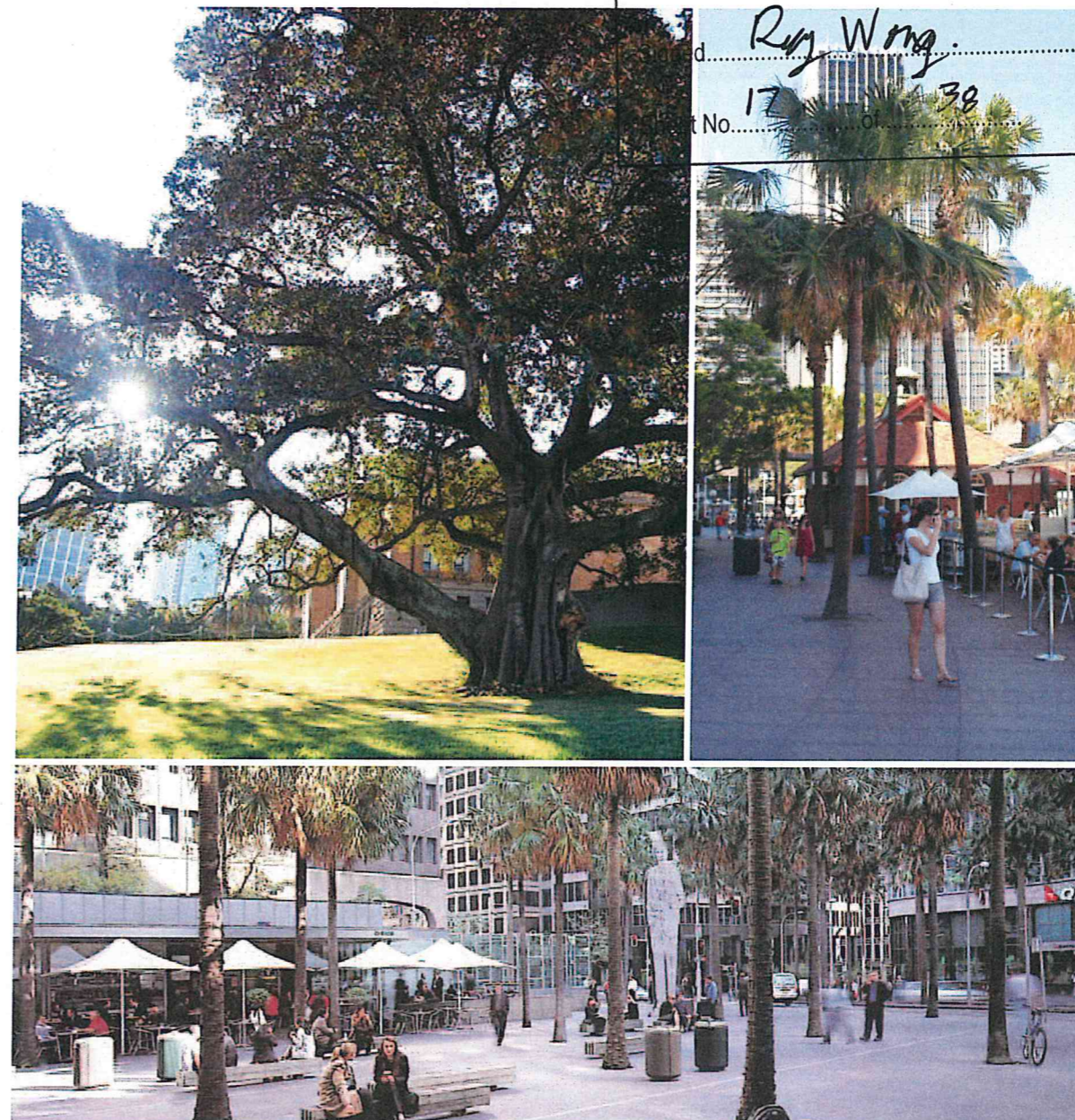

PRINCIPLES

1. Create a simplified and unified park space
2. Create clear and generous pedestrian links to the rocks, George St and Alfred Street
3. Create a square/ forecourt at the MCA
4. Retain and locate landmark trees to preserve views and to provide shade
5. Create generous provision of informal seating (steps, walls) and formal shaded seating

- Informal seating
- Formal seating
- Custom seating

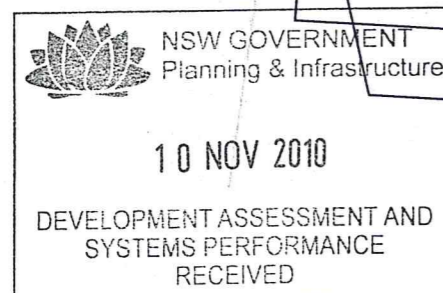

NSW GOVERNMENT
Planning

Issued under the Environmental Planning and Assessment Act 1979

Approved Application No. 10-0104

granted on the 27/6/11

Signed R. Wong

Sheet No. 10 of 38

