



West Circular Quay Public Domain Revitalisation

Analysis Plans prepared for Environmental Assessment Project Application
January 2010



CONTEXT: PROXIMITY TO CBD

First Fleet Park is a primary parkland in the Sydney CBD. From Circular Quay and Wynyard Station, First Fleet Park is a shorter walking distance than the Botanic Gardens or the Domain.



① View from George Street over First Fleet Park towards Opera House

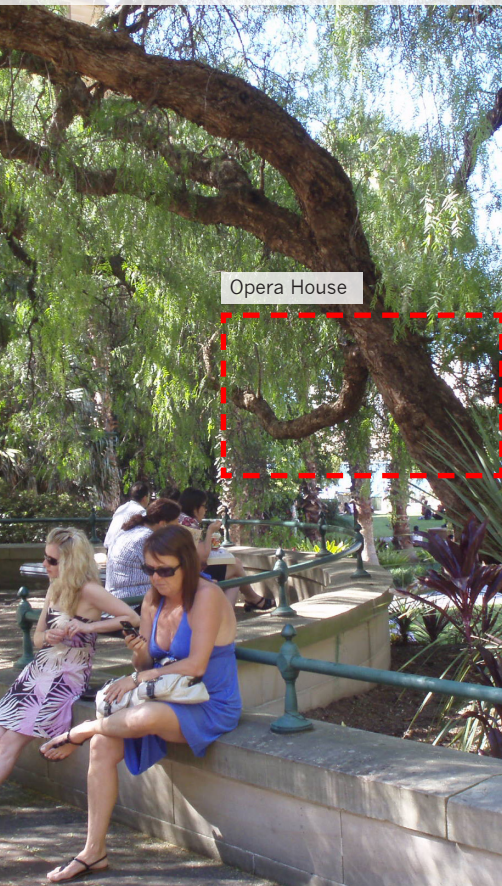

② View north from Pitt Street towards First Fleet Park







CONTEXT: PAVING + SURFACE MATERIALS

The First Fleet Park upgrade offers an opportunity to unify paving materials to create a coherent public domain in Circular Quay.

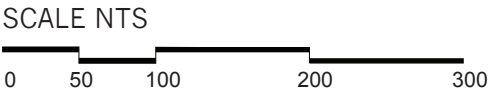

CONTEXT: SEATING

An opportunity exists to develop a integrated seating strategy incorporating site specific and standard seating elements.



CONTEXT: BARRIERS & BOLLARDS

Heritage balustrading is a consistent element in Circular Quay. The security requirements for First Fleet Park are to be determined.

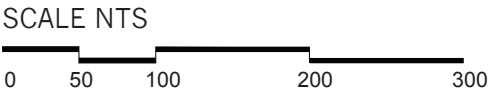
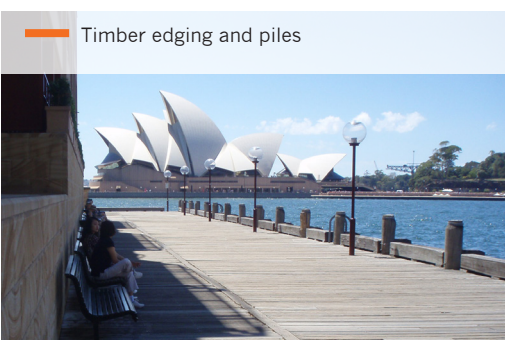
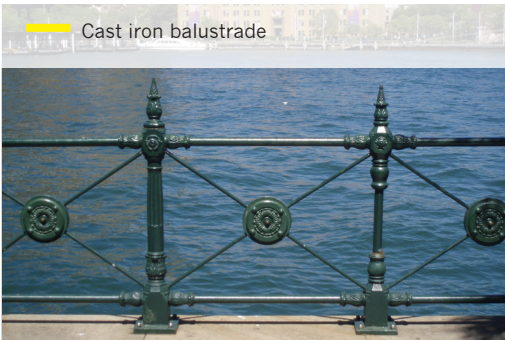
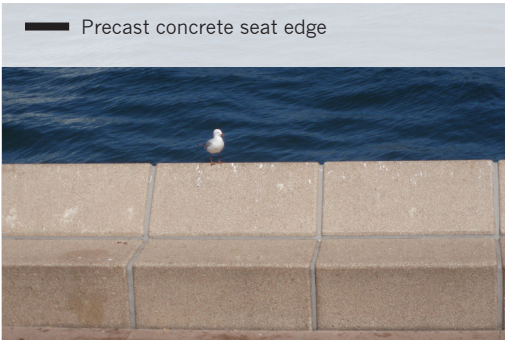
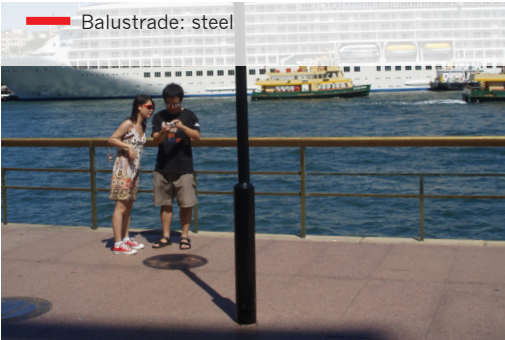

CONTEXT: LIGHTING

Existing light columns clutter the park. An opportunity exists to improve sight lines at night and to explore alternative lighting strategies.

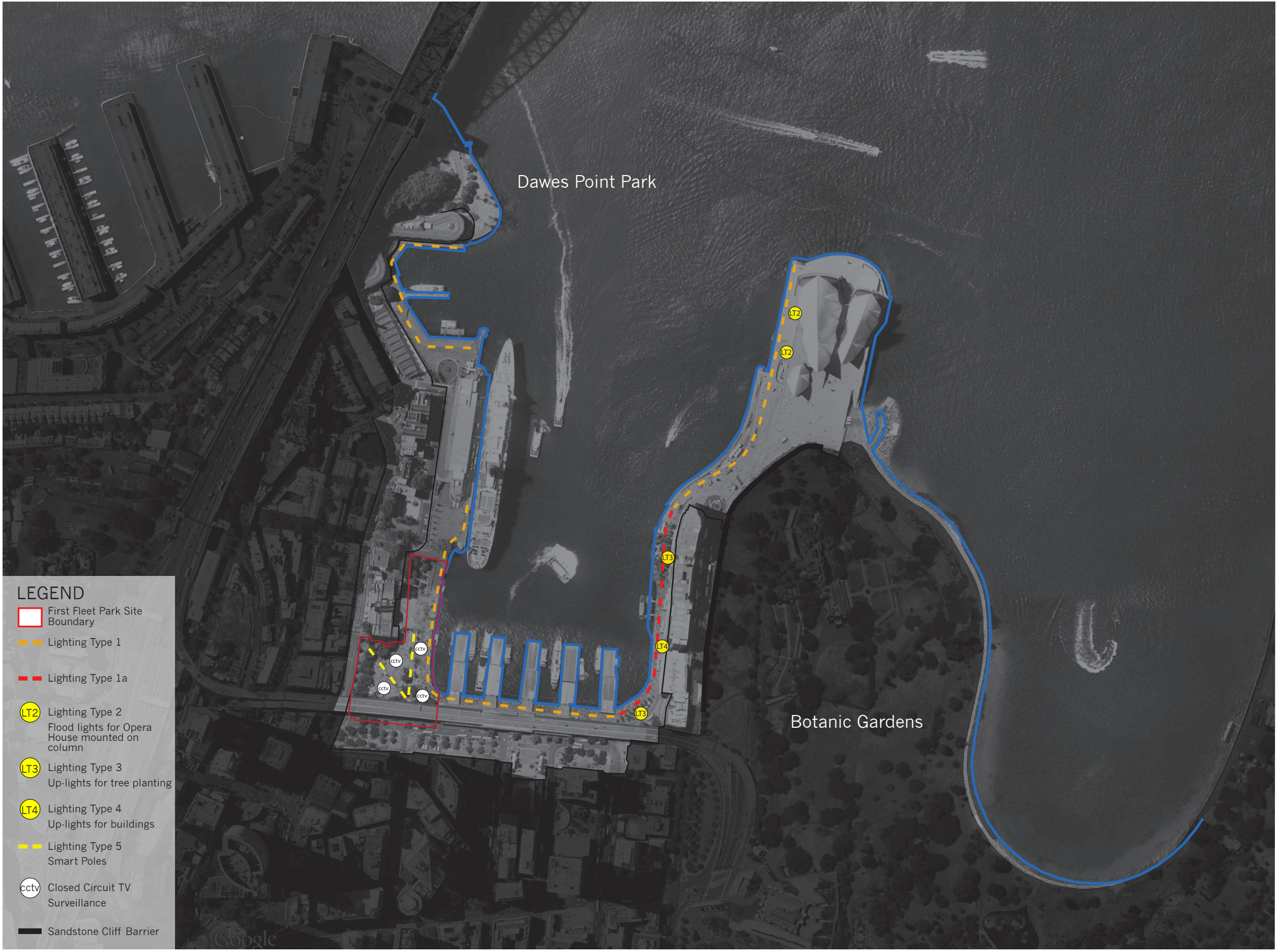
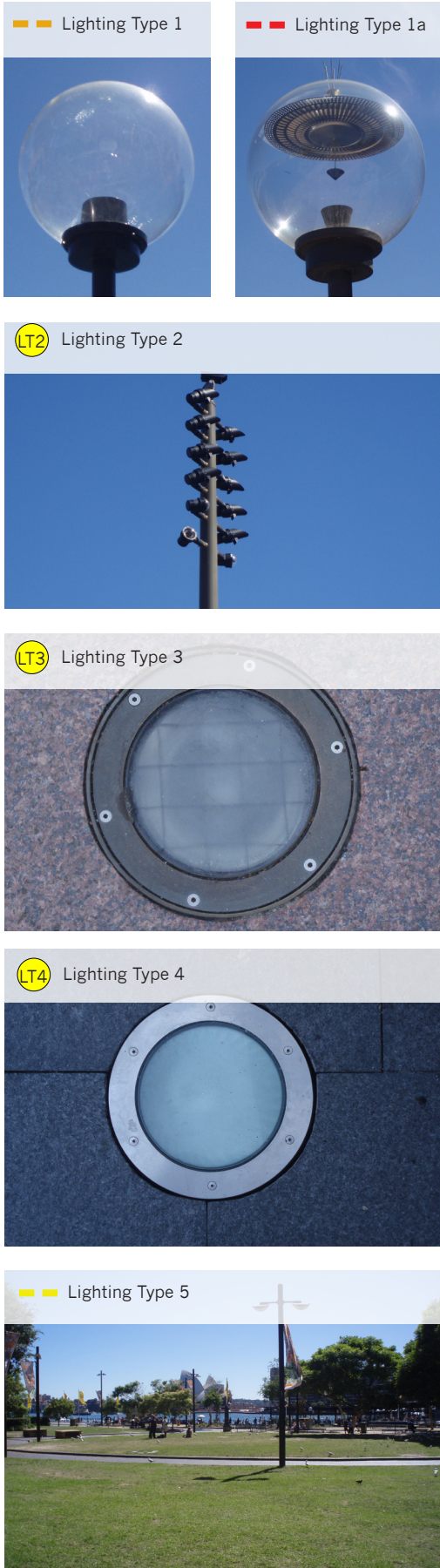

CONTEXT: TREE PLANTING

Figs and Cabbage Tree Palms are the most successful plantings used at Circular Quay and surrounds.



SOLAR ACCESS



The south- western edges of First Fleet Park are in sun year round.

First Fleet Park has year round use.

Gehl report for the city of Sydney found that First Fleet Park had almost equal usage on summer and winter weekdays. (753 activities in summer and 703 activities in winter). Wynyard Park by comparision has significantly different usage rates in summer and winter (876 activities summer and 171 activities in winter).

LEGEND

June Shadows - 9 am, 12 pm, 3pm

December Shadows 9 am, 12 pm, 3pm

March Shadows 9 am, 12 pm, 3pm

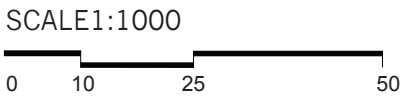

PERMEABILITY +
CONNECTIONS

An opportunity exists to improve permeability
between Alfred St, George Street and Circular
Quay.

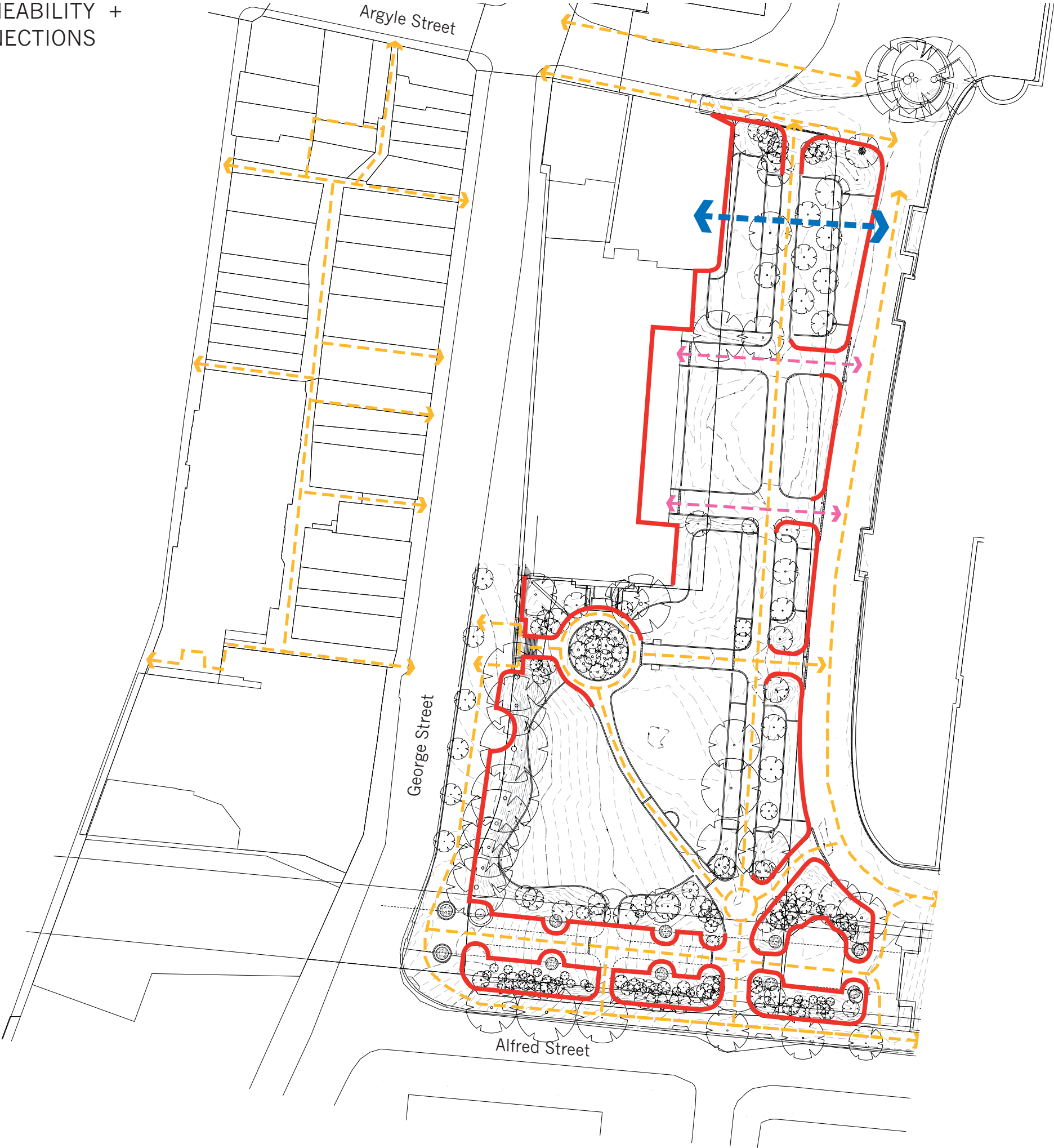

- LEGEND
- Existing Pedestrian Connections
 - Existing Pedestrian Connections to be removed
 - Barriers
 - Future Pedestrian Connections

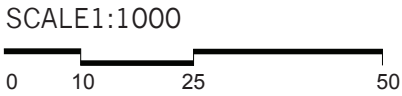

LEVELS

An opportunity exists to create a seamless transition between the surrounding streets and First Fleet Park.

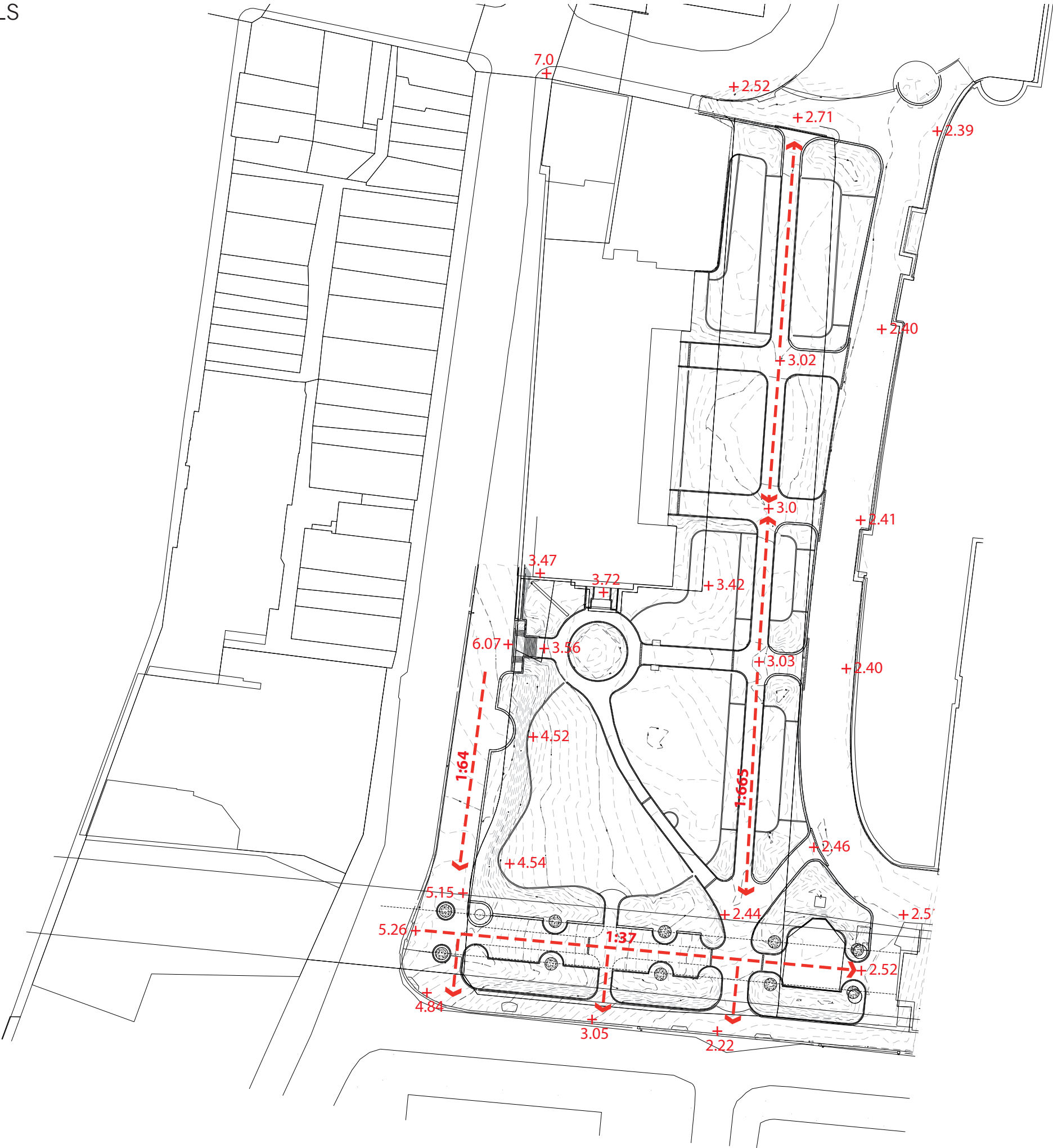

LEGEND
-> Crossfall/Gradient
+ Existing Levels

SCALE 1:1000
0 10 25 50

NORTH
⊕

Critical Sydney Water infrastructure needs to be retained and the park structure needs to work with these constraints

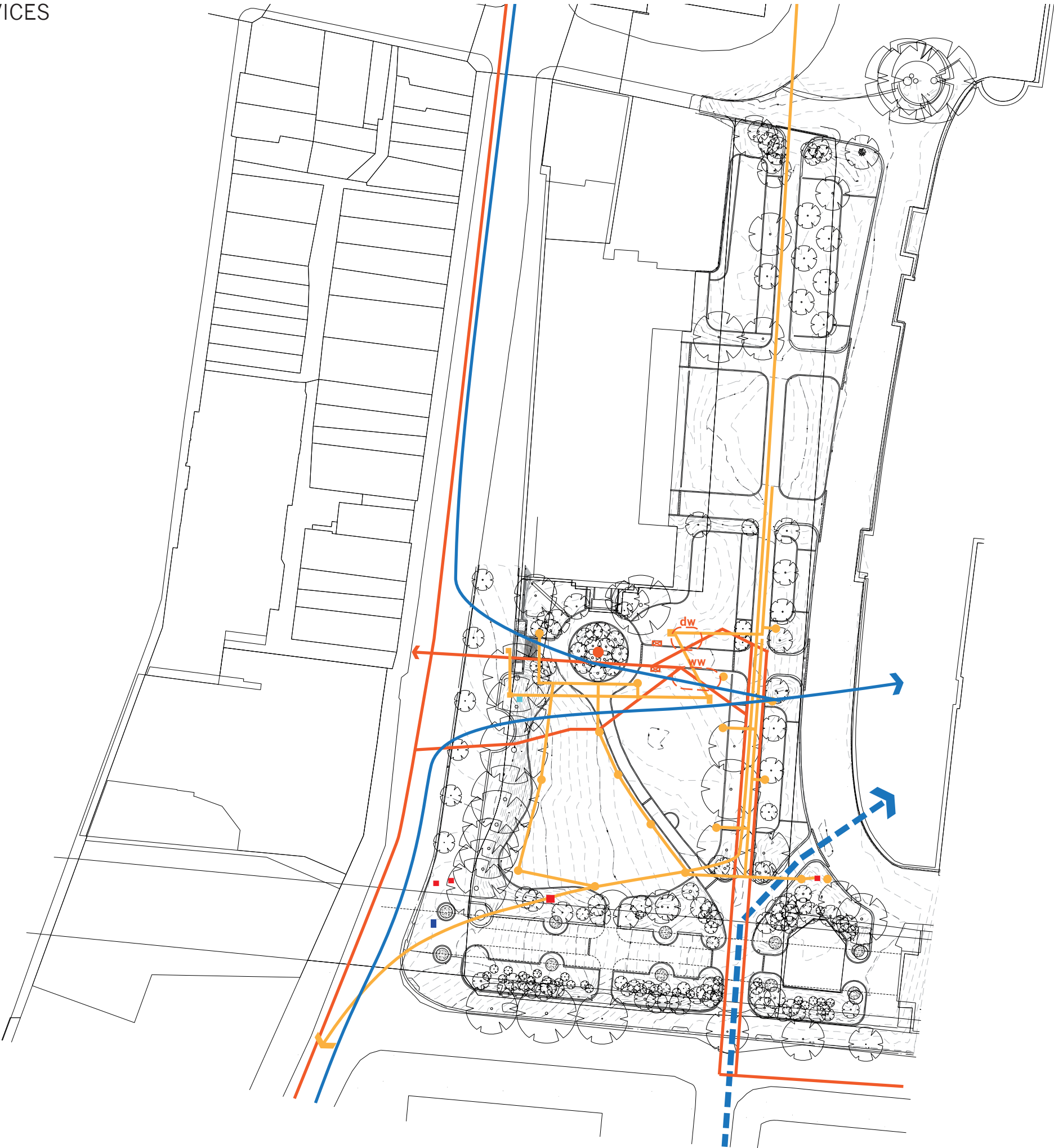

- LEGEND
- Sewer pipe
 - ⊠ Sewer induct vents
 - Sewer educt vent
 - ww Stormwater sewage wet well
 - dw Stormwater dry well sewage collection
 - Tank stream stormwater discharge point
 - Electricity conduit
 - Light columns/Fixtures
 - Electricity pit/Switch board
 - Pit
 - Stormwater pipe
 - Hydrant
 - Irrigation cover

SCALE 1:1000

0 10 25 50



TREES

A judicious planting strategy is required to balance the competing needs of shade and views.



LEGEND

- Ivory Curl Tree Planting**
Buckinghamia celsissima
- Celtis Planting**
Celtis australis
- Spotted Gum Planting**
Corymbia maculata
- Swamp Mahogany Planting**
Eucalyptus robusta
- Sydney Blue Gum Planting**
Eucalyptus saligna
- Evergreen Ash Planting**
Fraxinus griffithii
- Fig Tree Planting**
Ficus microcarpa var *hillii*
- Jacaranda Planting**
Jacaranda mimosifolia
- Cabbage Tree Palm Planting**
Livistona australis
- Brush Box Planting**
Lophostemon confertus
- Macrozamia Planting**
Macrozamia
- Plane Tree Planting**
Platanus x hybrida
- Pepper Tree Planting**
Schinus areira
- Washington Palm Planting**
Washingtonia robusta
- Register of Significant Trees (City of Sydney, 2005)**
- Fig Tree Planting**
Ficus elastica
(Scheduled Item 1 Cultural Planting)
- Pepper Tree Planting**
Shinus areira
(Scheduled Item 2 Cultural Planting)

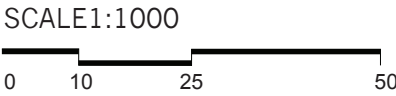

HISTORY

Timeline - Primary focus
1788 - 1812

- 1789

Hospital wharf, the first public wharf constructed; A market place began operating to the western side of the wharf in George Street.
- 1791

Third fleet arrive at Hospital wharf. Established as a primary loading zone for goods.
- 1797

A naval dockyard is established (series of dry docks and quays to the north of the current MCA building).
- 1798

Isaac Nichols builds a small house on his grant immediately south of Hospital Wharf, the first of a number of domestic and commercial buildings.
- 1808

Isaac Nichols builds a large warehouse immediately south of his house.
- 1809

The easternmost Commissariat building is constructed immediately to the west of Hospital Wharf.
- 1812

The westernmost Commissariat building (also munitions store) is constructed between the first commissariat and George Street. Hospital wharf upgraded and stone steps built from George Street. Wharf renamed 'the Kings Wharf' by Governor Macquarie 1813.

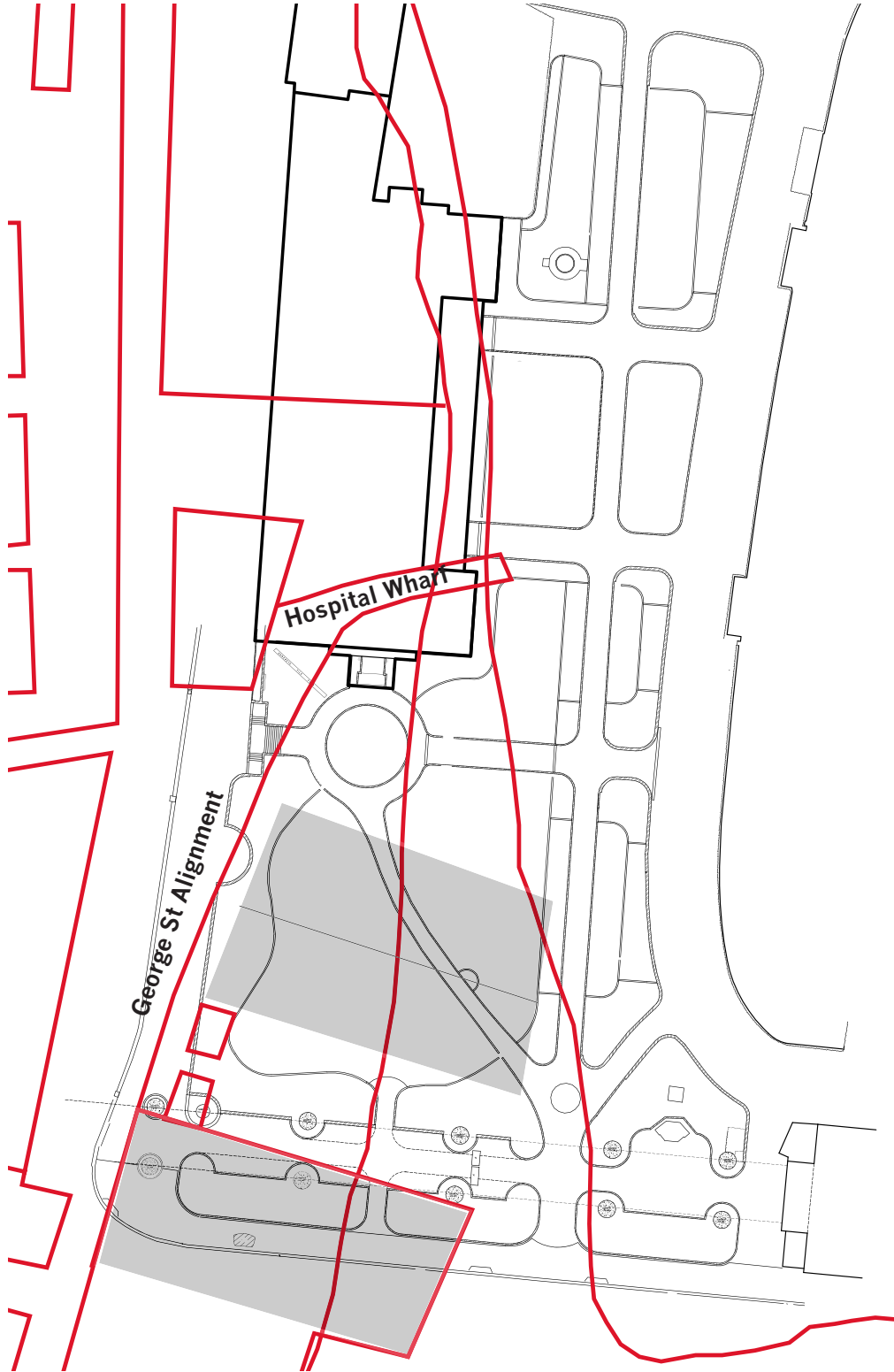

Above: Map overlay based on Meehan plan dated 1807 indicating hospital wharf and Isaac Nichols Building

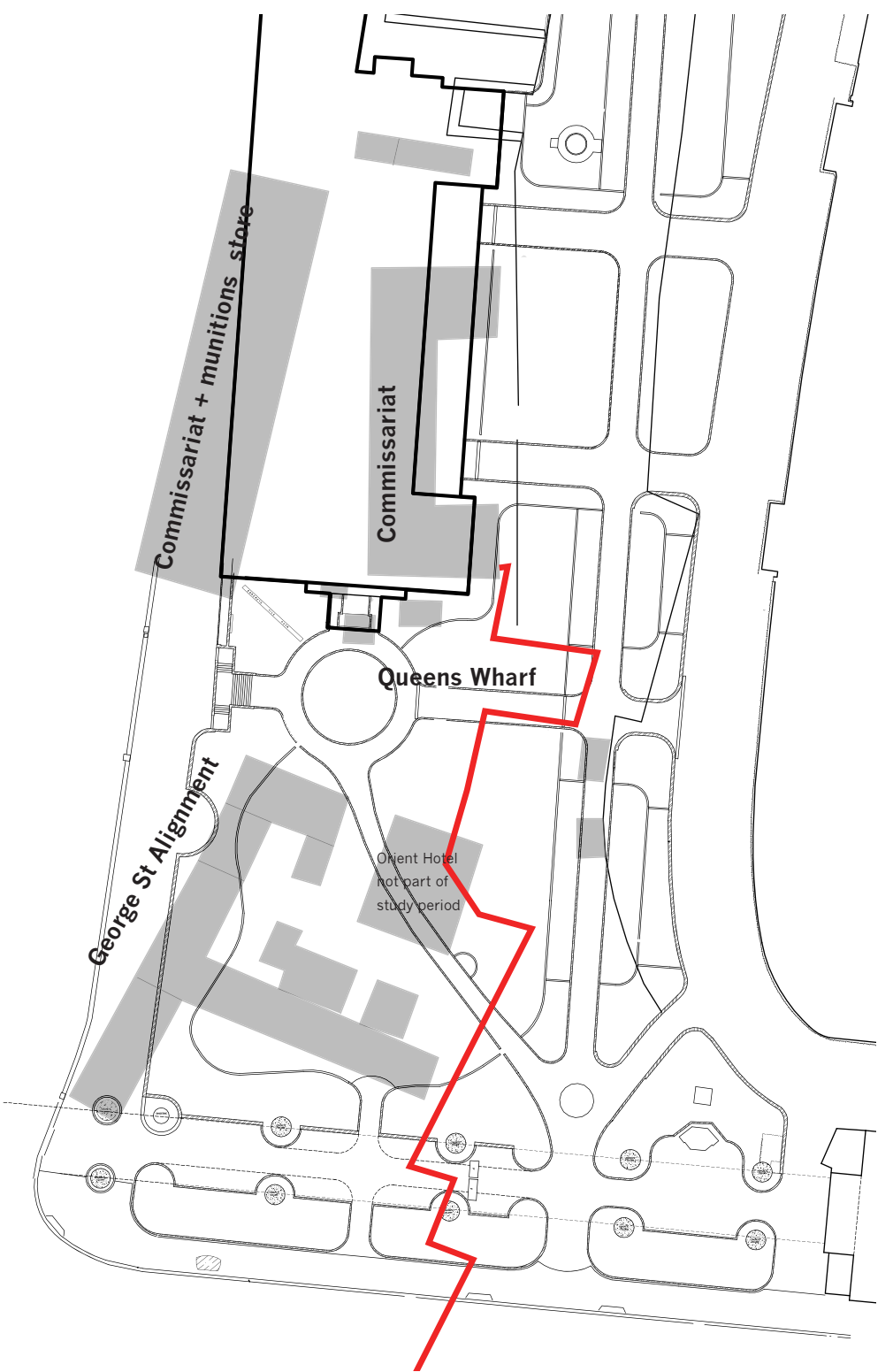

Above: Map overlay based on Casey and Lowe plan dated from approx 1830 indicating Queens wharf, the commissariat buildings + Isaac Nichols compound



PRINCIPLES

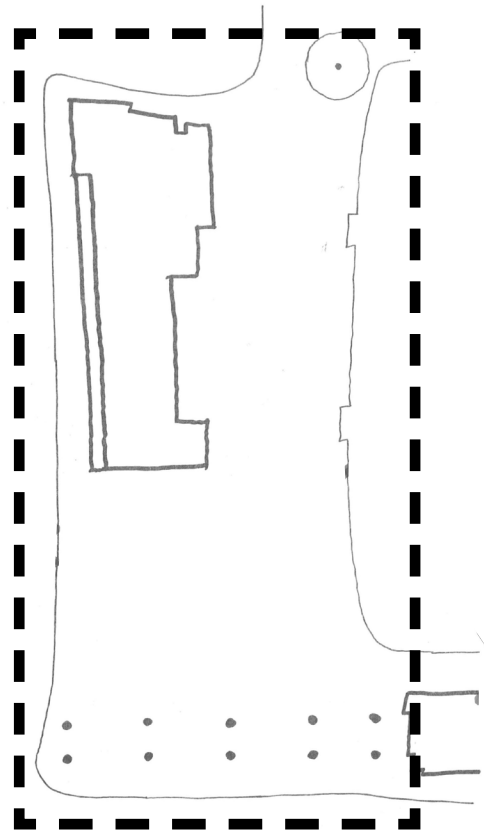

1 # A unified space rather than series of separate parts

Create a solution that unifies disparate spaces and elements to create a cohesive whole. Recognise the significance of the park within the wider context of Circular Quay, the redevelopment of the MCA and the future public urban square on Alfred Street.

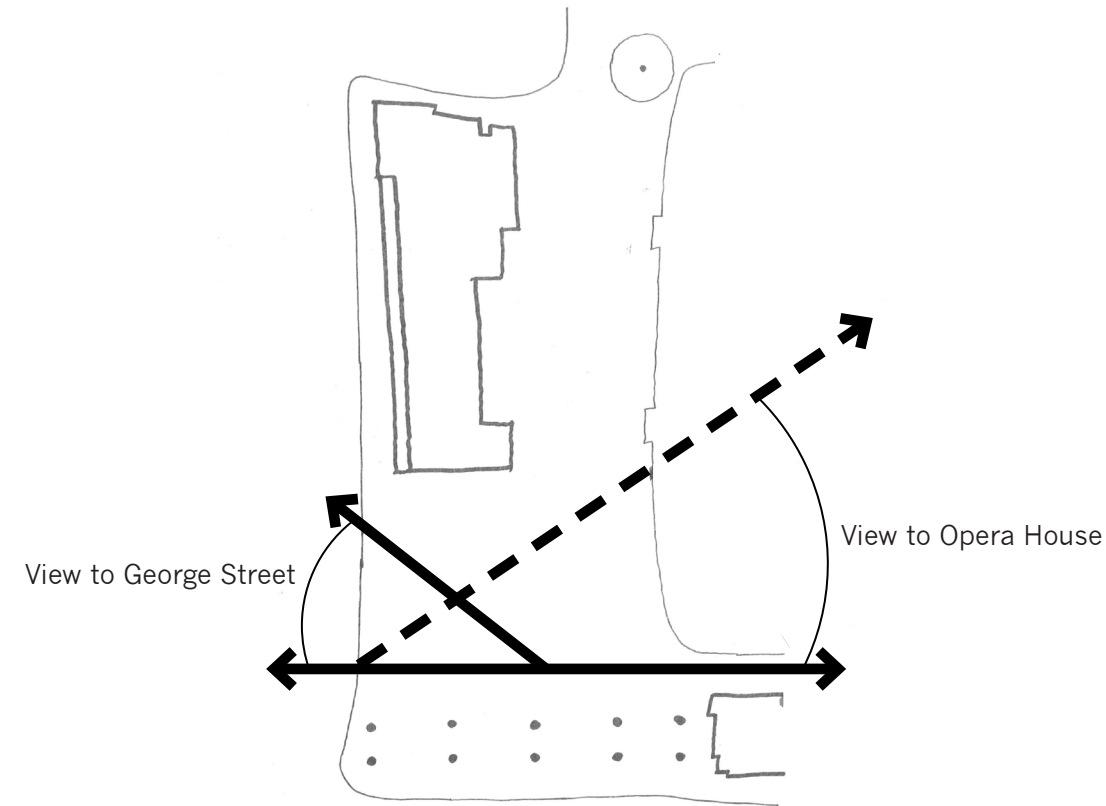

2# the broad view

Open views to and from George Street, and along the waterfront. Remove planting to allow for prospect to the east of the harbour and the Opera House.

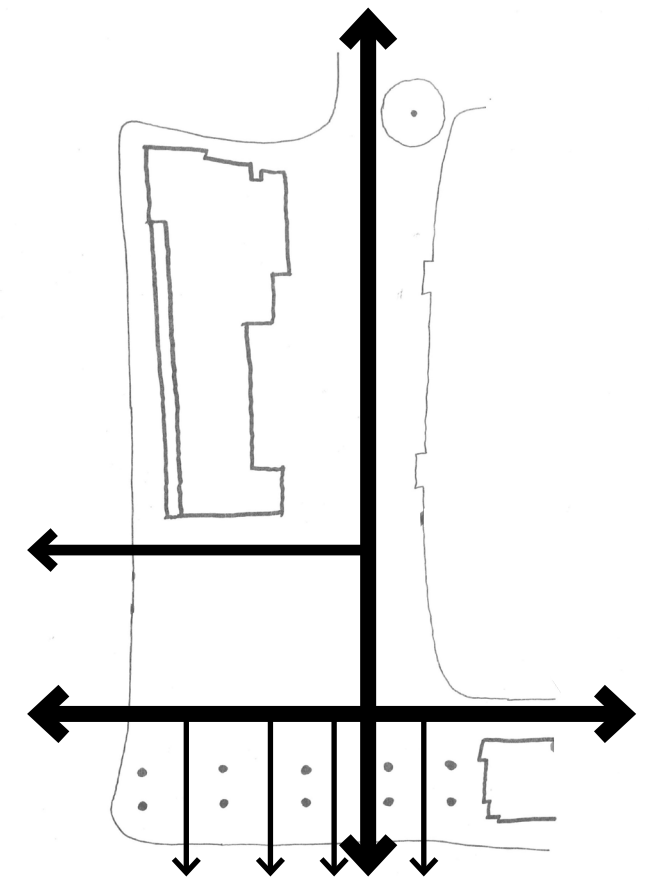

3# connections + permeability

Improve access from First Fleet Park and Circular Quay West to the rocks. Create unimpeded access from Alfred Street to First Fleet park and beyond. Create a structure that works in tandem with the network of streets and lanes in the rocks. Remove barriers, edges and clutter to allow for unimpeded access.