

Tree Strategy Stage 1A

Stage 1A

This Schedule of site trees has been prepared in conjunction with Mr David Ford, principal of Treescan P/L, consultant Arborists for the project. This plan generally indicates trees to be retained / protected, or removed to allow for Stage 1A of the proposed site work.

We note the detail of specific tree information, and also the information available to assess likely impacts, will in due course be improved with progression of design development documentation. Proposed new tree planting is generally indicated for these respective works, so that this can be seen alongside tree removal information to provide knowledge of extent of replacement planting.

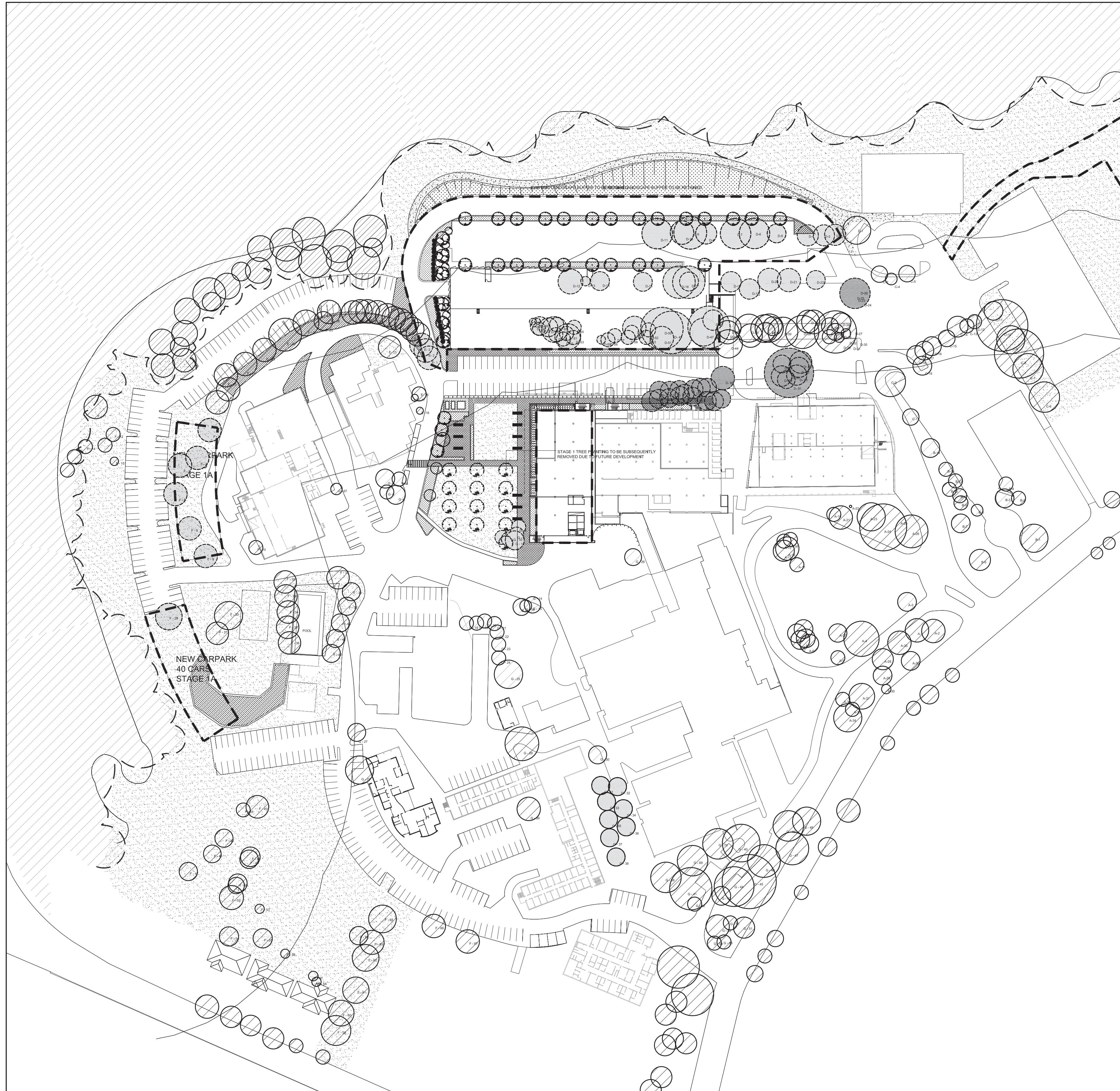

Stage 1A Tree Strategy
Scale 1:1000 @ A1

© 2010 Site Image (NSW) Pty Ltd ABN 44 801 262 380 All rights reserved. This drawing is copyright and shall not be reproduced or copied in any form or by any means (graphic, electronic or mechanical including photocopy) without the written permission of Site Image Pty Ltd. Any license, expressed or implied, to use this document for any purpose what so ever is restricted to the terms of the written agreement between Site Image (NSW) Pty Ltd and the instructing party.

The contractor shall check and verify all work on site (including work by others) before commencing the landscape installation. Any discrepancies are to be reported to the Project Manager or Landscape Architect prior to commencing work. Do not scale this drawing. Any required dimensions not shown shall be referred to the Landscape Architect for confirmation.

A	FOR REVIEW AND COMMENT	DB	RS	12.07.10
Issue	Revision Description	Drawn	Check	Date

LEGEND

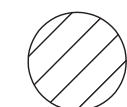

TREES TO BE RETAINED



TREES TO BE REMOVED
STAGE 1A



TREES TO BE REMOVED
STAGE 1B

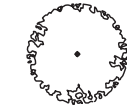

PROPOSED TREES



STAGE 1A TREE PLANTING TO BE
SUBSEQUENTLY REMOVED DUE TO
STAGE 2 DEVELOPMENT



EXISTING FOREST VEGETATION

NOTE: REFER TO DRAWING 054 FOR
EXISTING TREE SCHEDULE

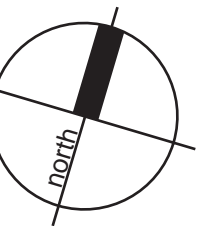

Client: **SYDNEY ADVENTIST HOSPITAL**

Project:
SYDNEY ADVENTIST HOSPITAL
185 FOX VALLEY ROAD
WAHROONGA NSW

28 Bowden Street
Alexandria NSW 2015
Australia
T +61 2 9698 2899
F +61 2 9698 2877
W www.siteimage.com.au
Site Image Pty Ltd
ABN 19 076 561 067

SITE IMAGE



Landscape Architects

PART 3A APPLICATION

Drawing Name:

TREE STRATEGY
STAGE 1A

Scale: 1:1000 @ A1

Date: 12.07.2010

Drawn:	DB	Approved:	RS
--------	----	-----------	----

Job Number:	Drawing Number:	Issue:
SS09-1859	006	A