

GOULBURN STREET

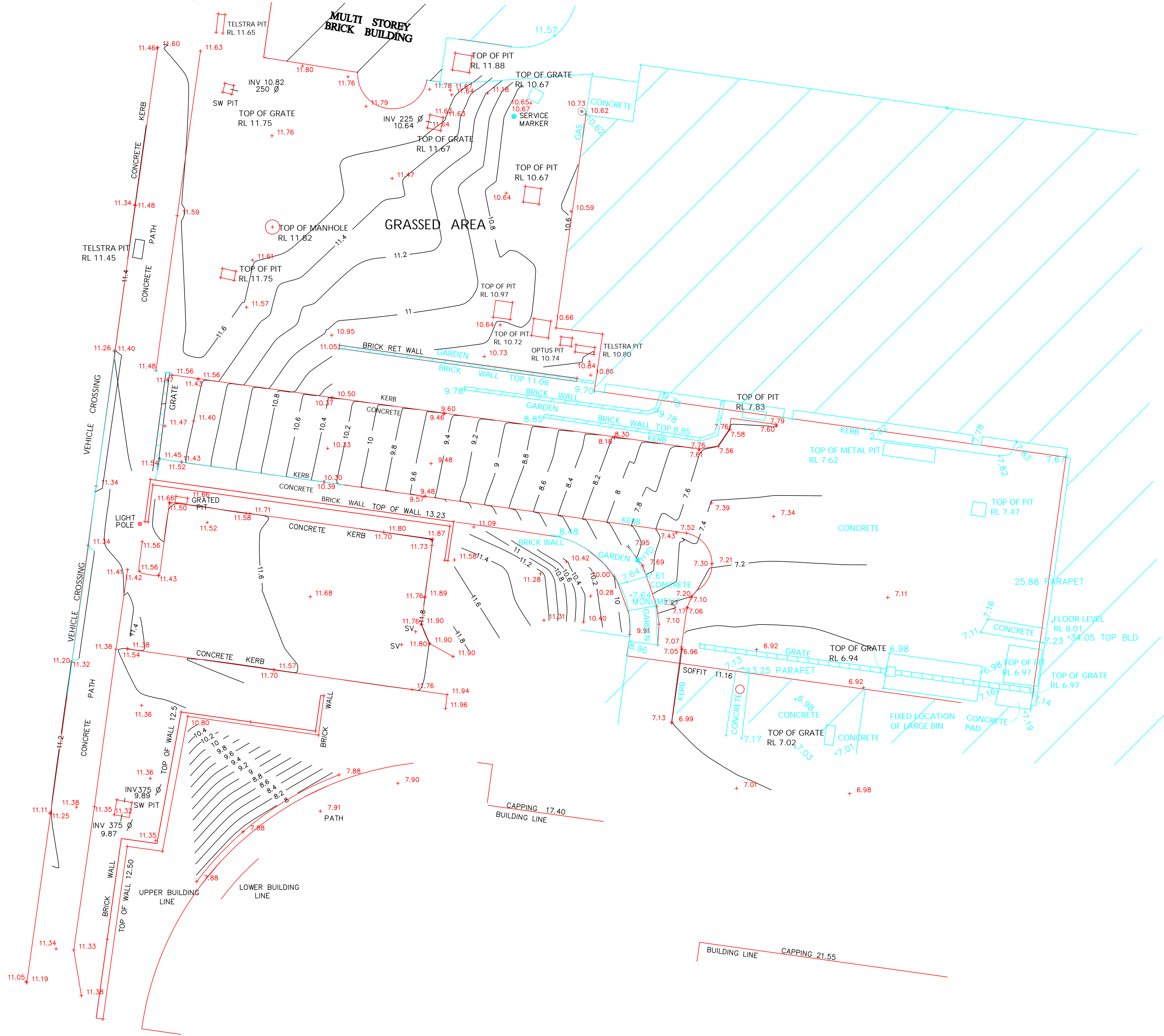

Note : Survey information shown Coloured Cyan Was Provided by Others.

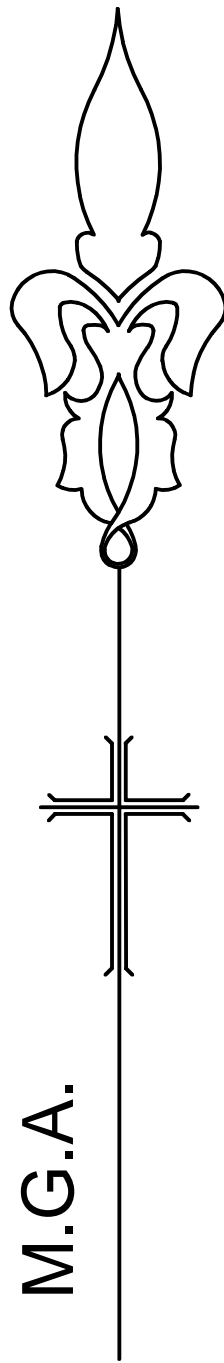

Engineering and Construction Surveyors
Director Kyle Power PO Box 1298 Penrith 2751
Ph/Fax 0247 544144 Mob 0417 435533
email power_survey@bigpond.com

A	21-7-10	ORIGINAL ISSUE	KP
REVISION	DATE	DESCRIPTION	APPROVED

SCALE	1:150	DRAWN	KP	DATUM	AHD
DATE	21-7-10	SURVEYED	KP/BL	BM ADOPTED	SS 38841 RL 11.642
Co-ordinate System.	MGA	Contour Interval.	0.2		
PLAN	SHOWING CONTOUR AND DETAIL OVER SELECTED AREA ON GOULBURN STREET, LIVERPOOL HOSPITAL REDEVELOPMENT.				

CLIENT : BOVIS LEND LEASE PTY LTD No.30 THE BOND, 30 HICKSON ROAD, MILLERS POINT PROJECT: LIVERPOOL HOSPITAL REDEVELOPMENT.	DRAWING NUMBER 851-Det-ab5
--	-------------------------------

SHEET SIZE. ISO A1 @ 841mmX594mm SCALE 1:150	SHEET 1 OF 2 SHEETS
Rev.	A