

~~ISSUE F - 12/02/14 - ISEC 75W0~~



LOT DESCRIPTION

PROPOSED LOT	DESCRIPTION - LOTS	B.M.C. MEMBER
600	CO-OPERATIVE LOT - SOUTH (ROAD & PARK)	NO
601	RESIDENTIAL STAGE 1 BUILDING (126 UNITS)	YES
602	FUTURE BUILDING 2	NO
603	RESIDUAL LOT (BUILDING 3 & 5) - RESIDUE LOT	NO
604	BUILDING 4	YES
605	BUILDING 14 - RESIDUE LOT	YES
606	RETAIL 1C SUPERMARKET & B0 PARKING	YES
607	CO-OP LOT WATER FACTORY	YES

EASEMENT

(JA) EASEMENT FOR ACCESS VARIABLE WIDTH  
(JJ) EASEMENT FOR ENCROACHING STRUCTURE 0.05 WIDE

STRATUM NOTES

(X) DENOTES UNLIMITED IN HEIGHT AND DEPTH.

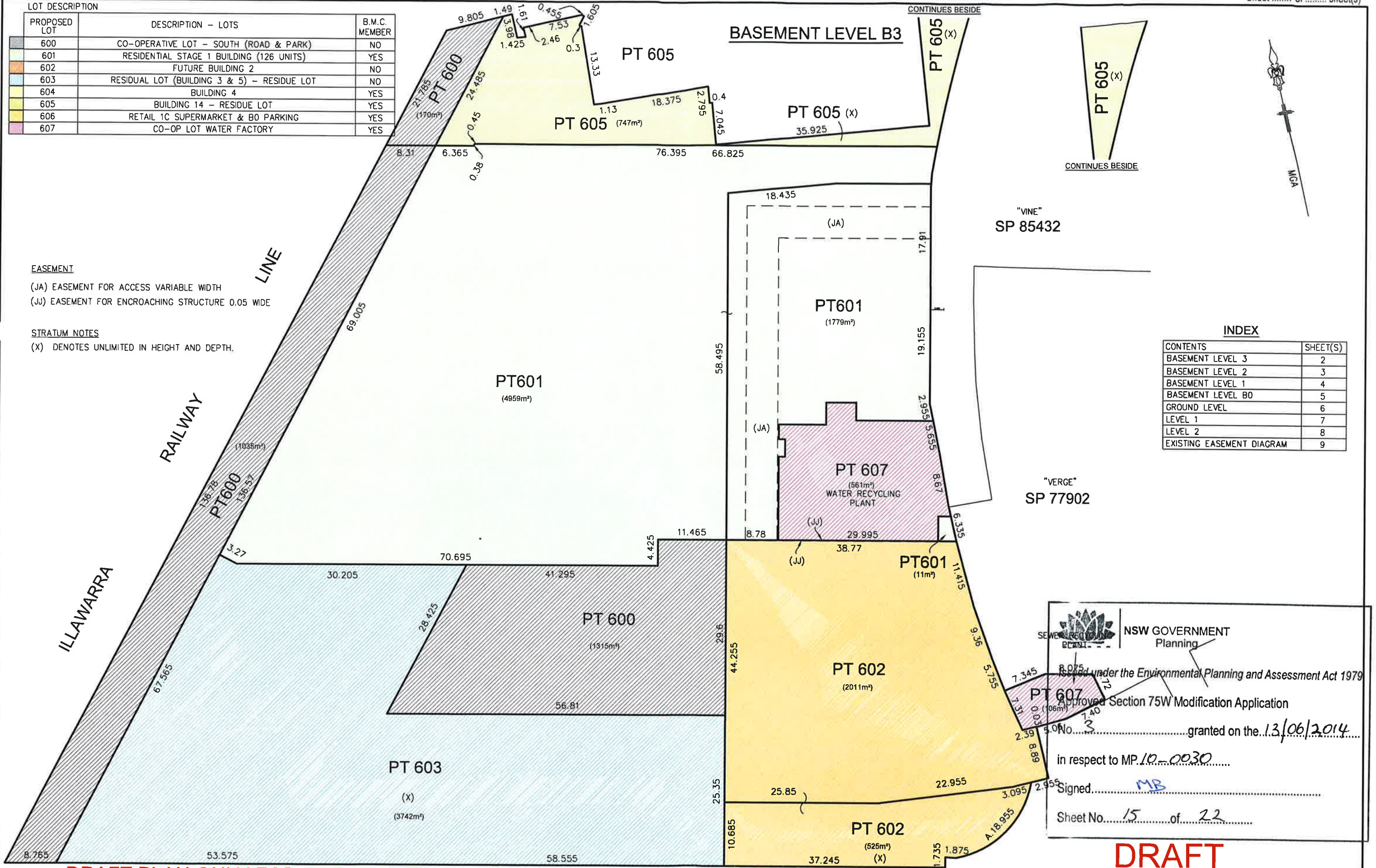

INDEX

CONTENTS	SHEET(S)
BASEMENT LEVEL 3	2
BASEMENT LEVEL 2	3
BASEMENT LEVEL 1	4
BASEMENT LEVEL B0	5
GROUND LEVEL	6
LEVEL 1	7
LEVEL 2	8
EXISTING EASEMENT DIAGRAM	9

NSW GOVERNMENT Planning

SEWER REGULATION PLAN

Approved under the Environmental Planning and Assessment Act 1979

Approved Section 75W Modification Application

No. 3 granted on the 13/06/2014

in respect to MP.10-0030

Signed MB

Sheet No. 15 of 22

DRAFT

ISSUE F - 12/02/14 - (SEC.75W)

DRAFT PLAN ONLY FOR DA/PA PURPOSES. ALL STATED AREAS AND DIMENSIONS ARE SUBJECT TO FINAL SURVEY.

Surveyor: JOSEPH MONARDO  
Date of Survey: DRAFT  
Surveyor's Reference: 27000/34267DP

PLAN OF SUBDIVISION OF Lots 500, 501, 502, 503, 505, 508 & 509

LGA: ROCKDALE  
Locality: WOLLI CREEK  
Subdivision No:  
Lengths are in metres. Reduction Ratio 1: 400

Registered

DP



EASEMENT

(JA) EASEMENT FOR ACCESS VARIABLE WIDTH

(JJ) EASEMENT FOR ENCROACHING STRUCTURE 0.05 WIDE



ISSUE F - 12/02/14 - (SEC.75W)

PT203  
DP1103650

FUTURE  
SEWER RECYCLING  
PLANT

PT203  
DP1103650



EASEMENT  
(JA) EASEMENT FOR ACCESS VARIABLE WIDTH  
(JJ) EASEMENT FOR ENCROACHING STRUCTURE 0.05 WIDE

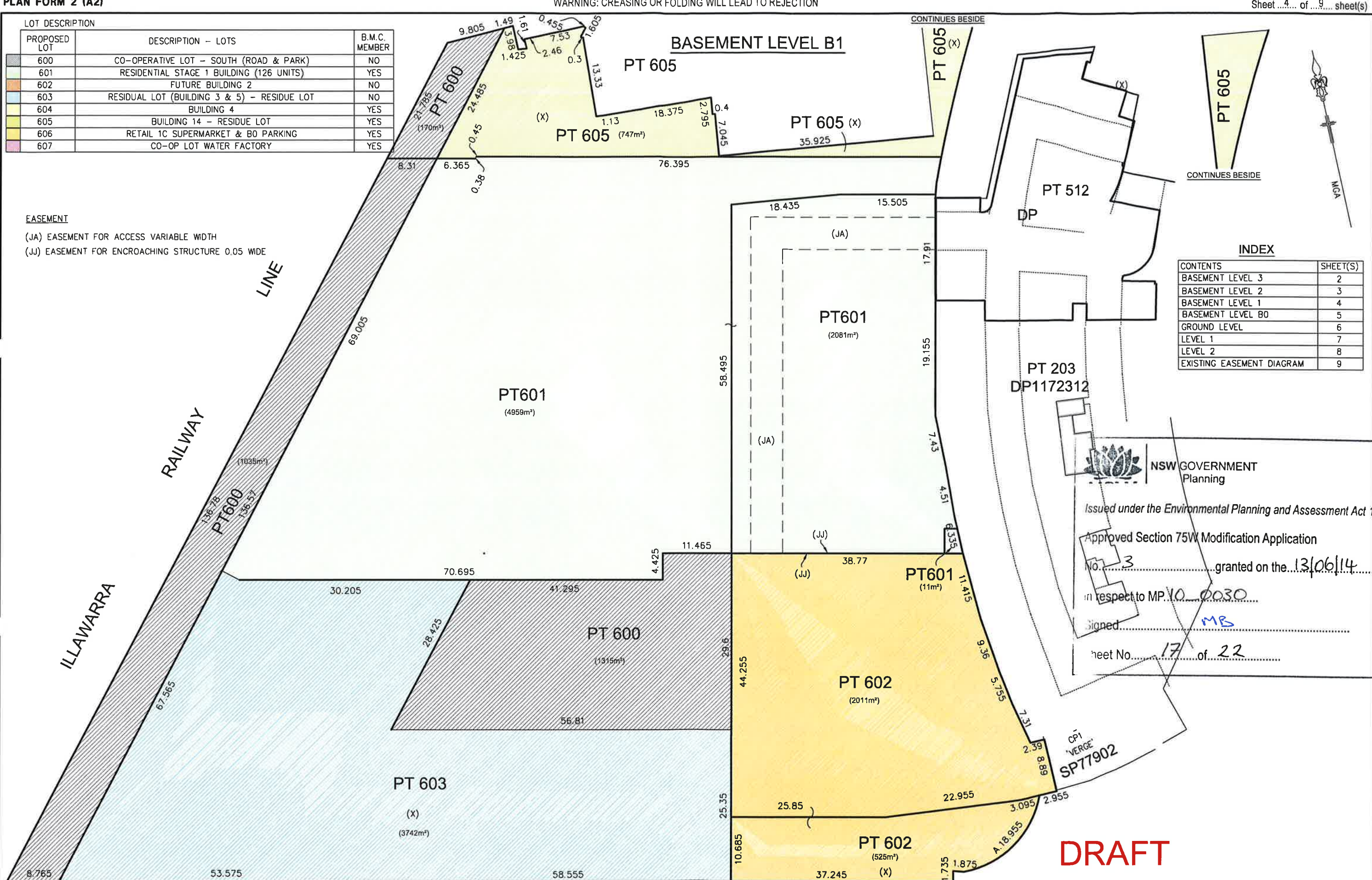

DRAFT PLAN ONLY FOR DA/PA  
PURPOSES. ALL STATED AREAS  
AND DIMENSIONS ARE SUBJECT  
TO FINAL SURVEY.

Surveyor: JOSEPH MONARDO  
Date of Survey: DRAFT  
Surveyor's Reference: 27000/34267DP

**PLAN OF SUBDIVISION OF Lots 500, 501,  
502, 503, 505, 508 & 509**

LGA: ROCKDALE  
Locality : WOLLI CREEK  
Subdivision No:  
Lengths are in metres. Reduction Ratio 1: 400

Registered

DP

ISSUE F - 12/02/14 - (SEC.75W)



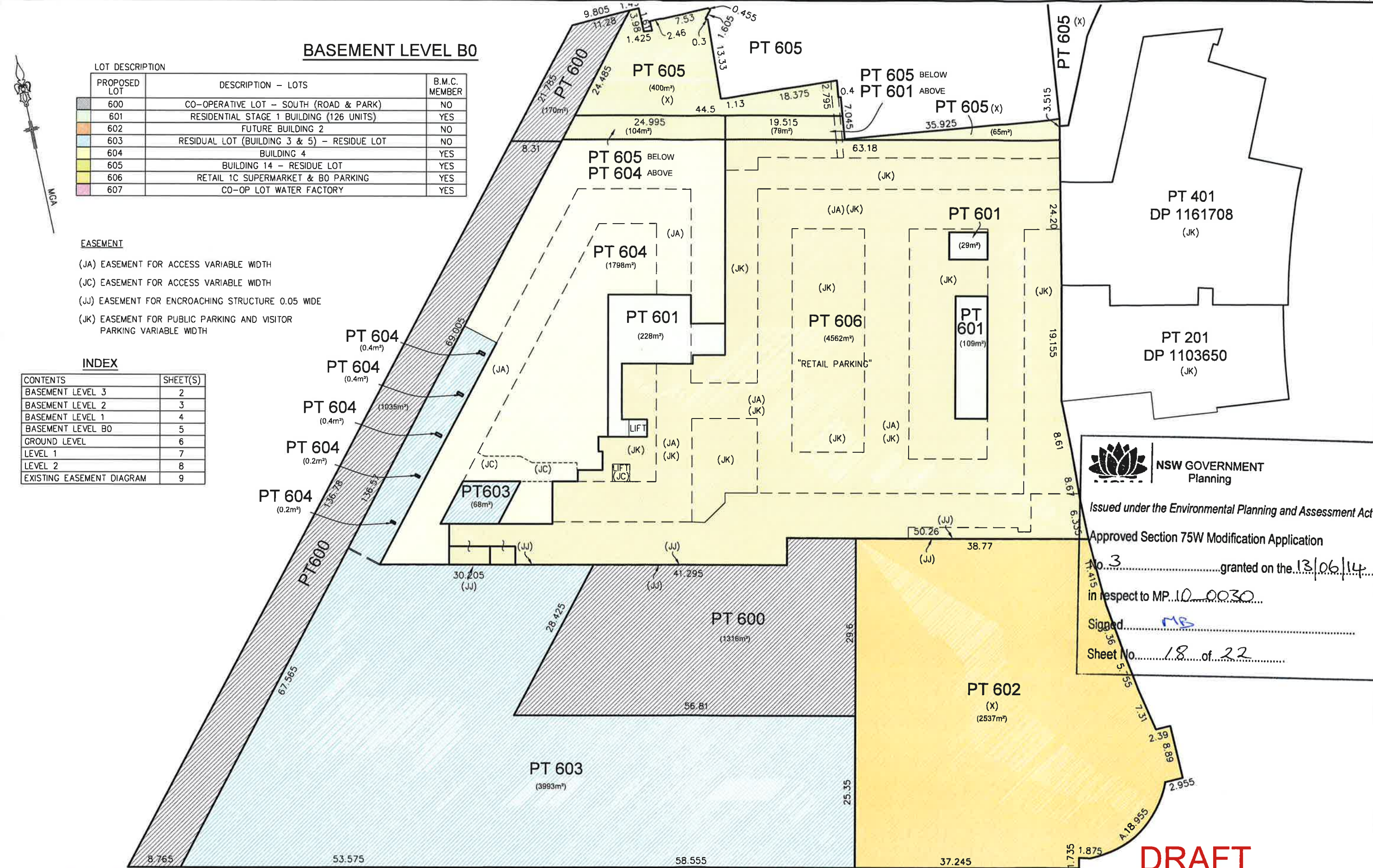

BASEMENT LEVEL B0

PROPOSED LOT	DESCRIPTION - LOTS	B.M.C. MEMBER
600	CO-OPERATIVE LOT - SOUTH (ROAD & PARK)	NO
601	RESIDENTIAL STAGE 1 BUILDING (126 UNITS)	YES
602	FUTURE BUILDING 2	NO
603	RESIDUAL LOT (BUILDING 3 & 5) - RESIDUE LOT	NO
604	BUILDING 4	YES
605	BUILDING 14 - RESIDUE LOT	YES
606	RETAIL 1C SUPERMARKET & B0 PARKING	YES
607	CO-OP LOT WATER FACTORY	YES

EASEMENT

(JA) EASEMENT FOR ACCESS VARIABLE WIDTH

(JC) EASEMENT FOR ACCESS VARIABLE WIDTH

(JJ) EASEMENT FOR ENCROACHING STRUCTURE 0.05 WIDE

(JK) EASEMENT FOR PUBLIC PARKING AND VISITOR PARKING VARIABLE WIDTH

INDEX

CONTENTS	SHEET(S)
BASEMENT LEVEL 3	2
BASEMENT LEVEL 2	3
BASEMENT LEVEL 1	4
BASEMENT LEVEL B0	5
GROUND LEVEL	6
LEVEL 1	7
LEVEL 2	8
EXISTING EASEMENT DIAGRAM	9

NSW GOVERNMENT  
Planning

Issued under the Environmental Planning and Assessment Act 1979

Approved Section 75W Modification Application

No. 3 granted on the 13/06/14

in respect to MP 10 0030

Signed MB

Sheet No 18 of 22

DRAFT PLAN ONLY FOR DA/PA PURPOSES. ALL STATED AREAS AND DIMENSIONS ARE SUBJECT TO FINAL SURVEY.

Surveyor: JOSEPH MONARDO

Date of Survey: DRAFT

Surveyor's Reference: 27000/33818DP

PLAN OF SUBDIVISION OF Lots 500, 501, 502, 503, 505, 508 & 509

LGA: ROCKDALE

Locality : WOLLI CREEK

Subdivision No:

Lengths are in metres. Reduction Ratio 1: 400

Registered

DP

ISSUE F - 12/02/14 - (SEC.75W)



## GROUND LEVEL

## LOT DESCRIPTION

PROPOSED LOT	DESCRIPTION - LOTS	B.M.C. MEMBER
600	CO-OPERATIVE LOT - SOUTH (ROAD & PARK)	NO
601	RESIDENTIAL STAGE 1 BUILDING (126 UNITS)	YES
602	FUTURE BUILDING 2	NO
603	RESIDUAL LOT (BUILDING 3 & 5) - RESIDUE LOT	NO
604	BUILDING 4	YES
605	BUILDING 14 - RESIDUE LOT	YES
606	RETAIL 1C SUPERMARKET & B0 PARKING	YES
607	CO-OP LOT WATER FACTORY	YES

## EASEMENT

- (JA) EASEMENT FOR ACCESS  
(JB) EASEMENT FOR ACCESS & SERVICES  
(JC) EASEMENT FOR ACCESS VARIABLE WIDTH  
(JG) EASEMENT ELECTRICITY AND OTHER PURPOSES  
(JH) EASEMENT FOR OVERHANG

**DRAFT PLAN ONLY FOR DA/PA PURPOSES. ALL STATED AREAS AND DIMENSIONS ARE SUBJECT TO FINAL SURVEY.**

## INDEX

CONTENTS	SHEET(S)
BASEMENT LEVEL 3	2
BASEMENT LEVEL 2	3
BASEMENT LEVEL 1	4
BASEMENT LEVEL B0	5
GROUND LEVEL	6
LEVEL 1	7
LEVEL 2	8
EXISTING EASEMENT DIAGRAM	9

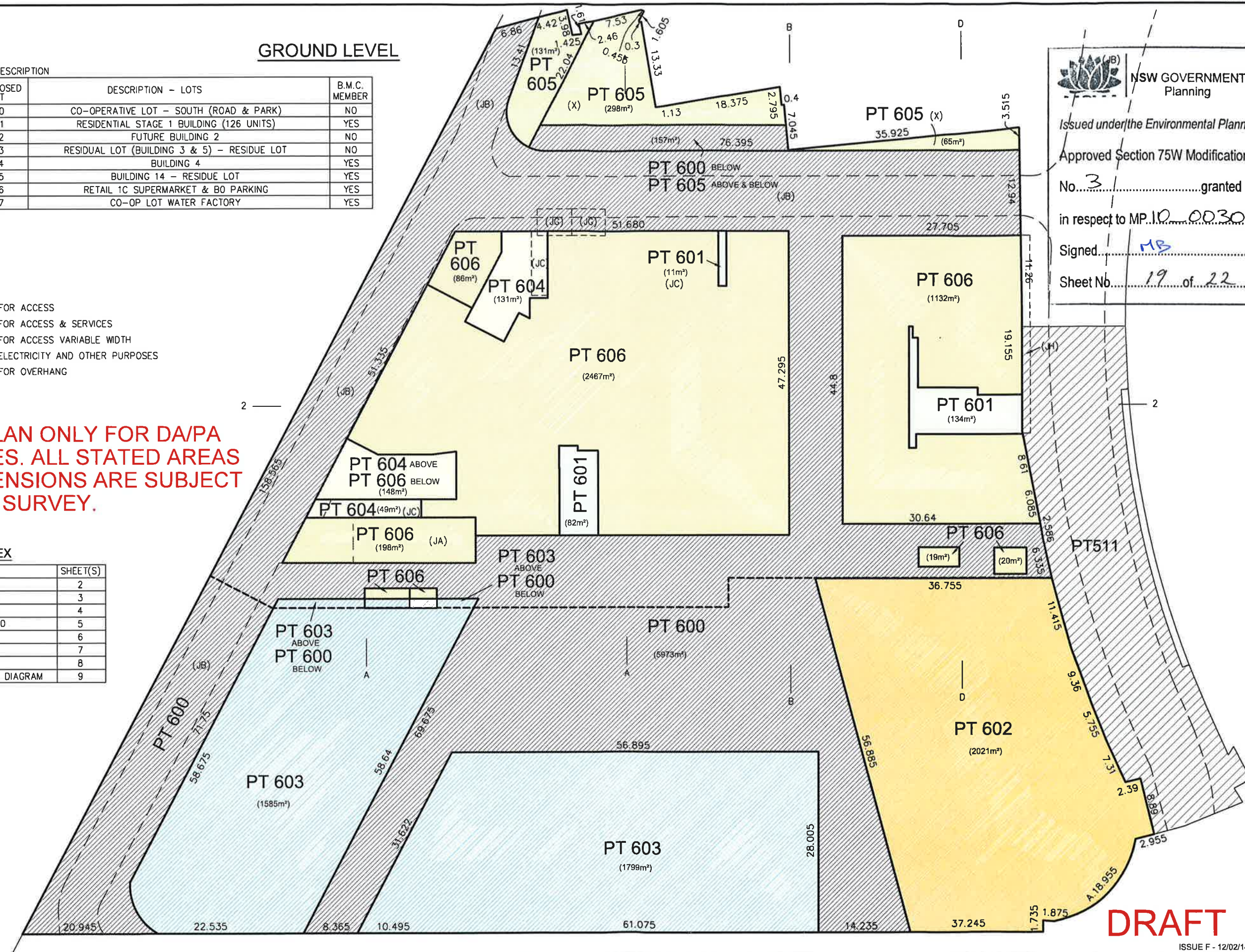
NSW GOVERNMENT  
Planning

Issued under the Environmental Planning and Assessment Act 1979

Approved Section 75W Modification Application

No. 3 granted on the 13/06/14

in respect to MP.10.0030

Signed MB

Sheet No. 19 of 22

**DRAFT**

ISSUE F - 12/02/14 - (SEC.75W)

MAGDALENE TERRACE

Surveyor: JOSEPH MONARDO  
Date of Survey: DRAFT  
Surveyor's Reference: 27000/34267DP

**PLAN OF SUBDIVISION OF Lots 500, 501,  
502, 503, 505, 508 & 509**

LGA: ROCKDALE  
Locality: WOLLI CREEK  
Subdivision No:  
Lengths are in metres. Reduction Ratio 1: 400

Registered

DP



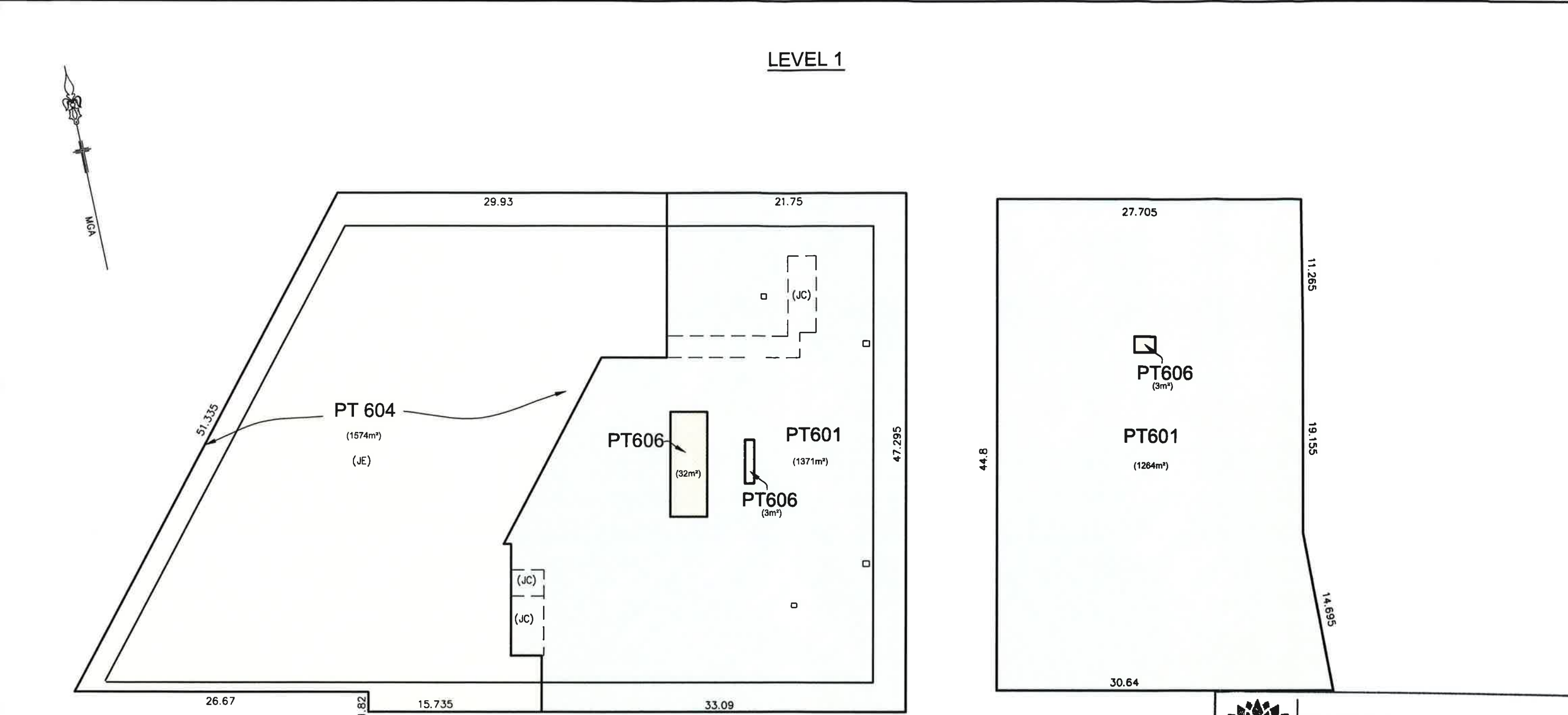

EASEMENTS

(JC) EASEMENT FOR ACCESS VARIABLE WIDTH

(JE) EASEMENT FOR FUTURE SUPPORT AND SHELTER

LOT DESCRIPTION		
PROPOSED LOT	DESCRIPTION - LOTS	B.M.C. MEMBER
600	CO-OPERATIVE LOT - SOUTH (ROAD & PARK)	NO
601	RESIDENTIAL STAGE 1 BUILDING (126 UNITS)	YES
602	FUTURE BUILDING 2	NO
603	RESIDUAL LOT (BUILDING 3 & 5) - RESIDUE LOT	NO
604	BUILDING 4	YES
605	BUILDING 14 - RESIDUE LOT	YES
606	RETAIL 1C SUPERMARKET & B0 PARKING	YES
607	CO-OP LOT WATER FACTORY	YES

DRAFT PLAN ONLY FOR DA/PA PURPOSES. ALL STATED AREAS AND DIMENSIONS ARE SUBJECT TO FINAL SURVEY.

INDEX	
CONTENTS	SHEET(S)
BASEMENT LEVEL 3	2
BASEMENT LEVEL 2	3
BASEMENT LEVEL 1	4
BASEMENT LEVEL B0	5
GROUND LEVEL	6
LEVEL 1	7
LEVEL 2	8
EXISTING EASEMENT DIAGRAM	9



NSW GOVERNMENT  
Planning

Issued under the Environmental Planning and Assessment Act 1979

Approved Section 75W Modification Application

No. 3 granted on the 13/06/14

in respect to MP 10-0030

Signed MB

Sheet No. 20 of 22

DRAFT

ISSUE F - 12/02/14 - (SEC.75W)

Surveyor: JOSEPH MONARDO  
Date of Survey: DRAFT  
Surveyor's Reference: 27000/34267DP

PLAN OF SUBDIVISION OF Lots 500, 501, 502, 503, 505, 508 & 509

LGA: ROCKDALE  
Locality: WOLLI CREEK  
Subdivision No:  
Lengths are in metres. Reduction Ratio 1: 250

Registered

DP



LEVEL 2 AND ABOVE

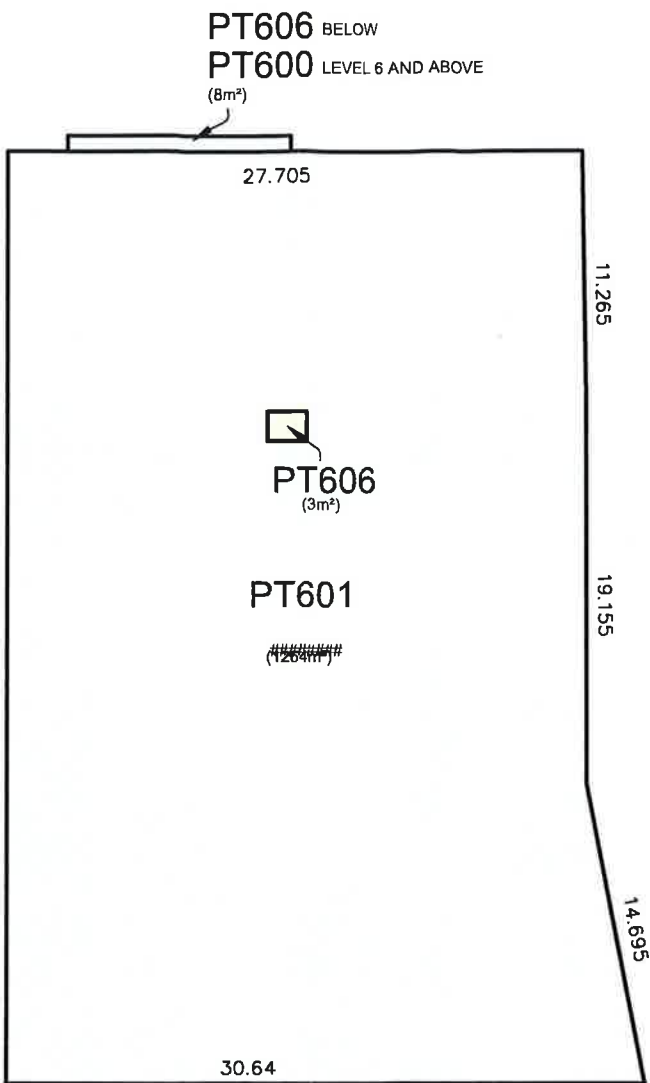
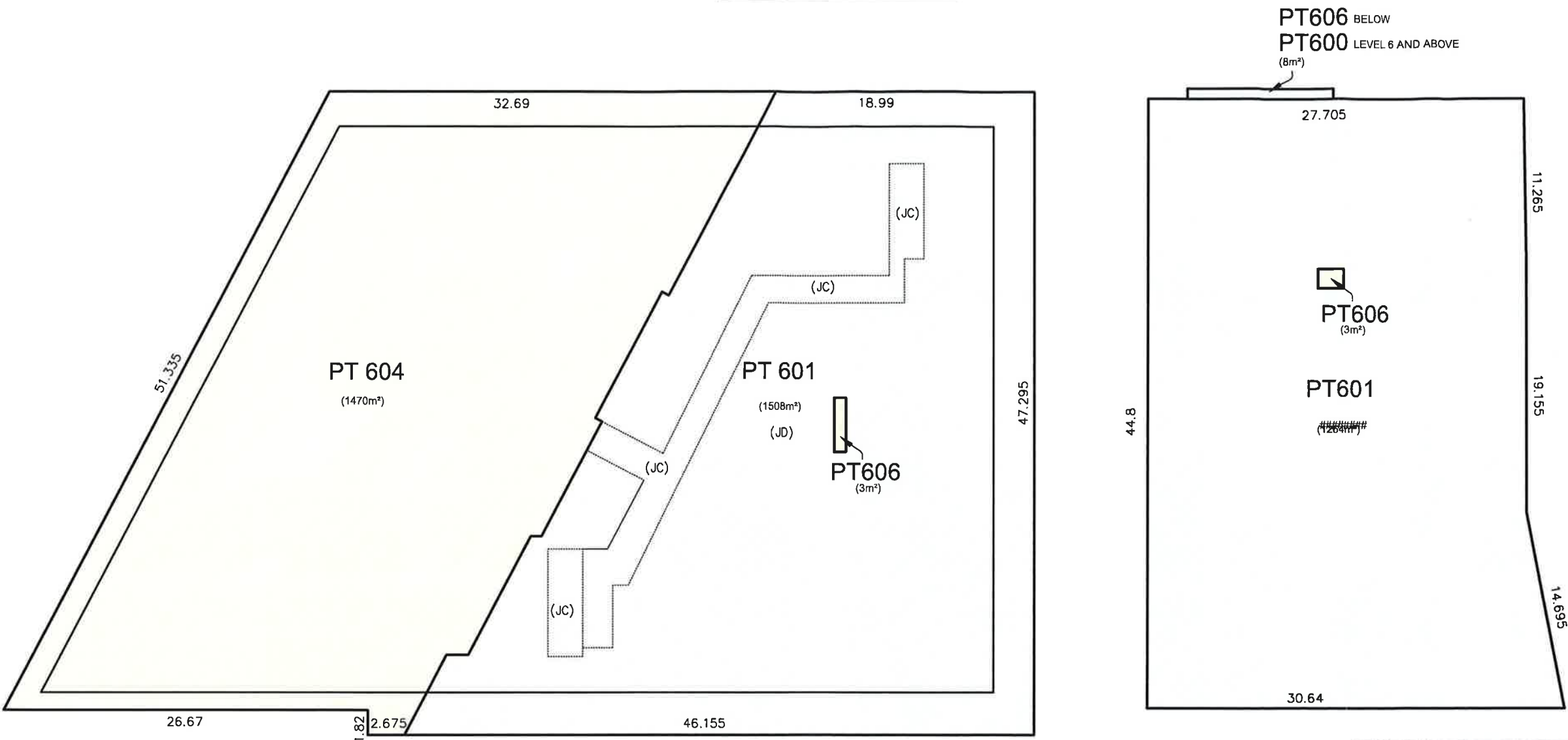

EASEMENTS

- (JC) EASEMENT FOR ACCESS VARIABLE WIDTH  
(JD) EASEMENT FOR ACCESS AND USE OF THE SWIMMING POOL, GYM AND COMMUNITY ROOM (JD)

LOT DESCRIPTION

PROPOSED LOT	DESCRIPTION - LOTS	B.M.C. MEMBER
600	CO-OPERATIVE LOT - SOUTH (ROAD & PARK)	NO
601	RESIDENTIAL STAGE 1 BUILDING (126 UNITS)	YES
602	FUTURE BUILDING 2	NO
603	RESIDUAL LOT (BUILDING 3 & 5) - RESIDUE LOT	NO
604	BUILDING 4	YES
605	BUILDING 14 - RESIDUE LOT	YES
606	RETAIL 1C SUPERMARKET & B0 PARKING	YES
607	CO-OP LOT WATER FACTORY	YES

DRAFT PLAN ONLY FOR DAP/A PURPOSES. ALL STATED AREAS AND DIMENSIONS ARE SUBJECT TO FINAL SURVEY.

INDEX

CONTENTS	SHEET(S)
BASEMENT LEVEL 3	2
BASEMENT LEVEL 2	3
BASEMENT LEVEL 1	4
BASEMENT LEVEL B0	5
GROUND LEVEL	6
LEVEL 1	7
LEVEL 2	8
EXISTING EASEMENT DIAGRAM	9



NSW GOVERNMENT  
Planning

Issued under the Environmental Planning and Assessment Act 1979

Approved Section 75W Modification Application

No. 3 granted on the 13/06/14

in respect to MP 10-0030

Signed M.B.

Sheet No. 21 of 22

DRAFT

ISSUE F - 12/02/14 - (SEC.75W)

Surveyor: JOSEPH MONARDO  
Date of Survey: DRAFT  
Surveyor's Reference: 27000/34267DP

PLAN OF SUBDIVISION OF Lots 500, 501, 502, 503, 505, 508 & 509

LGA: ROCKDALE  
Locality: WOLLI CREEK  
Subdivision No:  
Lengths are in metres. Reduction Ratio 1: 250

Registered

DP



