

Spark Lane Screening Species Selection

Variation Description	<p>Elaeocarpus reticulatus proposed to building side of Spark Lane as small indigenous street tree. Climbing plants and native grasses are proposed to railway corridor side of street to screen railway fence / wall.</p> <p>Species: Elaeocarpus reticulatus (100Lt) Dianella caerulea (150mm) Lomandra longifolia (150mm) Hibbertia scandens (150mm)</p>
PDP Reference	Rockdale City Council, Draft Wolli Creek and Bonar Street Precinct PDP May 2011, pp33-34
Variation Reason	Evergreen native tree selection preferred as buffer planting to railway corridor
Variation Justification	<p>Indigenous tree species</p> <p>Evergreen species selected to shade west facing building facades, reducing impact of radiant heat.</p> <p>Evergreen species selected to screen building ground floor services to lane.</p> <p>Trees to be planted to building side of lane in accordance with railway corridor offset.</p> <p>Street trees to be planted within continuous soil trench to street verge (0.9m width). Minimum of 1.2m soil depth is to be provided, with structural soil below adjacent footpaths to support ongoing tree growth and health.</p> <p>Street verge to be under-planted with Dianella caerulea to delineate pedestrian footpath from lane.</p> <p>Drip irrigation to be provided to street tree and verge planting in addition to passive irrigation from storm water runoffs to planter areas.</p>



Lomandra longifolia



Dianella caerulea



Planted street verge precedent



Elaeocarpus reticulatus



Hibbertia scandens

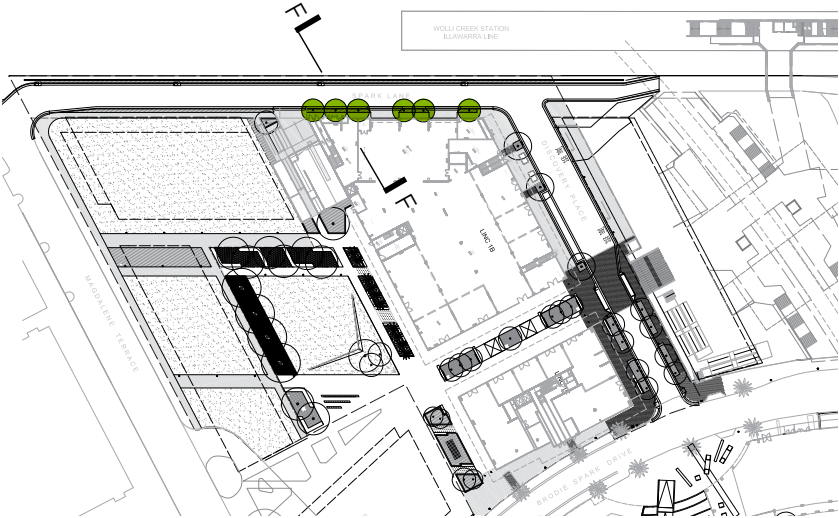

Key Plan - Spark Lane

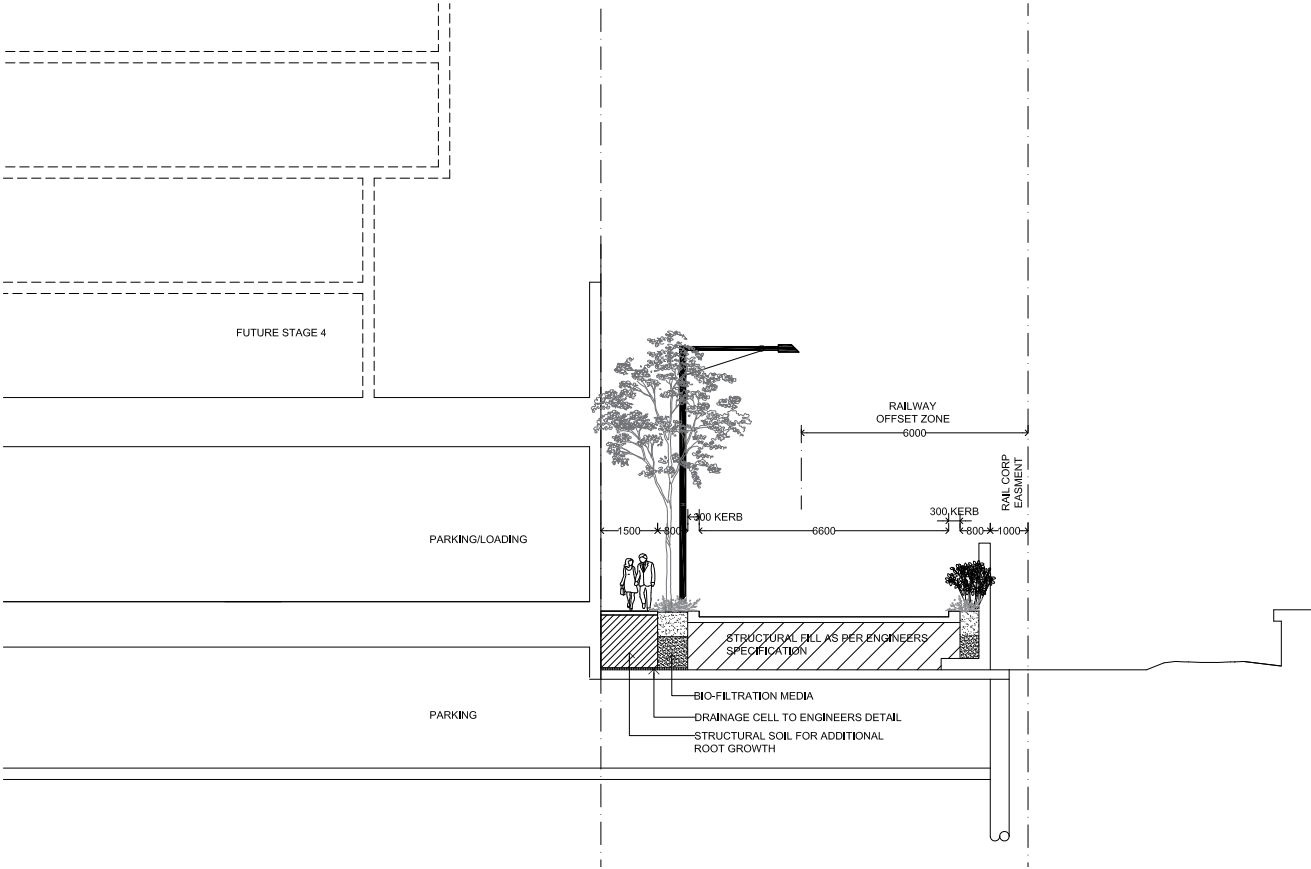

Section FF - Supermarket loading dock / Railway Corridor