

FOR MAJOR PROJECT APPLICATION ONLY

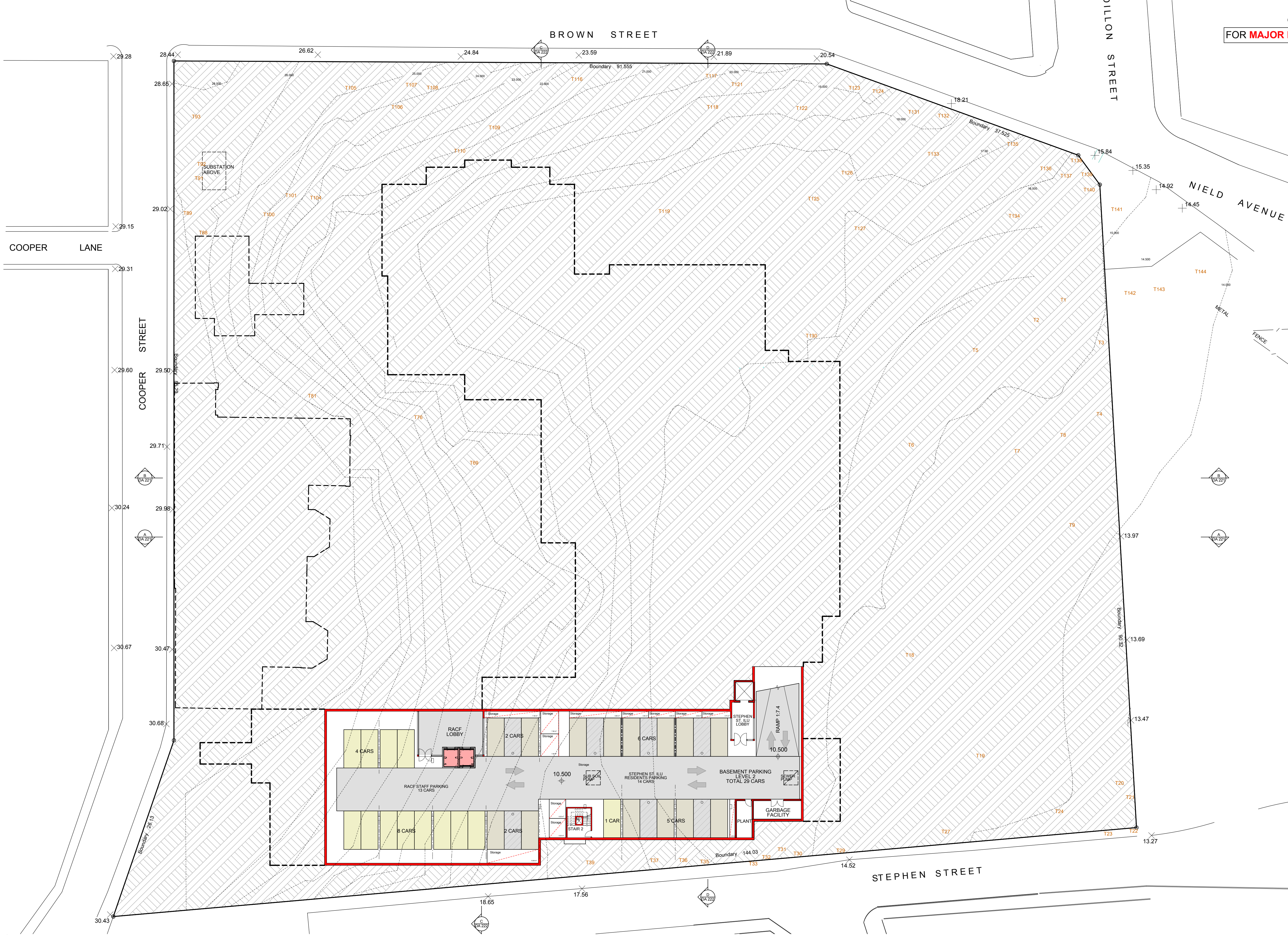

GENERAL LEGEND

- 00.000 EXISTING RELATIVE LEVEL
- 00.000 NEW RELATIVE LEVEL
- EXISTING BUILDING TO BE DEMOLISHED

TREE LEGEND

- EXISTING TREE CANOPY- HERITAGE LISTED TREE
- EXISTING TREE CANOPY
- EXISTING TREE TO BE REMOVED
- PROPOSED TREE CANOPY

BUILDING LEGEND

- HB HERITAGE BUILDING ILU
- RACF RACF BUILDING
- B BROWN STREET BUILDING ILU
- S STEPHEN STREET BUILDING ILU
- GKL GATE KEEPERS LODGE BUILDING ILU

KEY PLAN

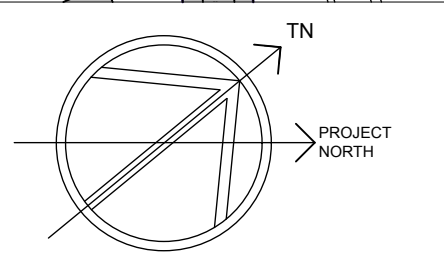
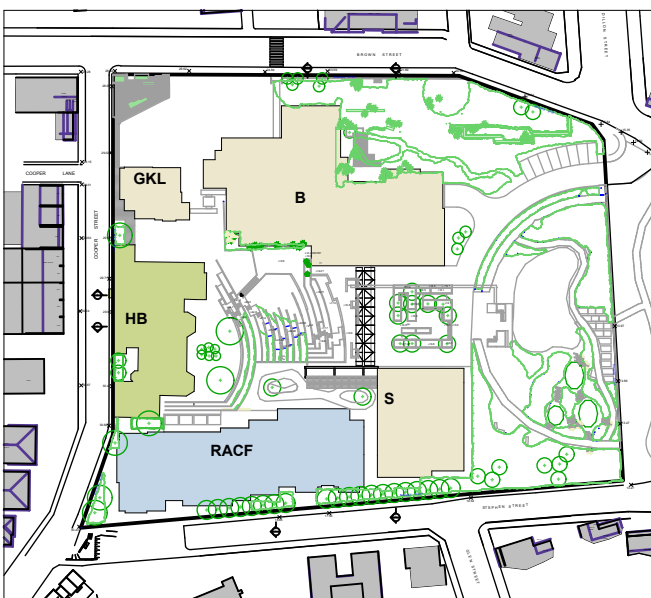

0 5 10m

"Copyright JPR Architects Pty Ltd.
Reproduction of the whole or part of this documents constitutes an infringement of copyright. The information, ideas and concepts contained in this document are confidential and the recipient of this document is prohibited from disclosing such information, ideas and concepts to any person without the prior written consent of JPR Architects Pty Ltd."

CAUTION: Drawings which have been scanned, saved in PDF format, and/or reprinted, other than by JPR, may not be to scale and should not be scaled or relied on for area calculations.
This design has had no input from relevant planning and services or BCA consultants and should not be construed as final

"THE TERRACES"
SCOTTISH HOSPITAL - 2 COOPER ST. PADDINGTON

PRINCIPAL ARCHITECT
jpr architects pty limited
20/50 Stanley Street East Sydney NSW 2010 tel +61 2 9366 1133 fax +61 2 9366 1166 email jpr@jpra.com.au

CONSULTING ARCHITECT: URBAN DESIGN
GMU GM Urban Design + Architecture Pty Ltd

CONSULTING ARCHITECT: AGED CARE
Flower and Samios
ARCHITECTS

CONSULTING ARCHITECT: HERITAGE
CM+ Conybeare Morrison International Pty Ltd
Architecture Interiors Heritage Urban Design Masterplanning
T 61 2 6244 8888 F 61 2 6244 8877 E mail@cmplus.com.au
© CM+ 2010

SCALE AT A1
1:250
REVISION
A

DATE
07/06/2010
DRAWN
RM / YS/ RK

PROJECT No
2006067
ITEM No
37550

PROJECT ADDRESS
2 COOPER ST. PADDINGTON
CLIENT
Presbyterian Aged Care PADDINGTON

DRAWING TITLE
Lower Basement
DRAWING No
DA 200