

DATE PLOTTED: 13 December 2011 2:50 PM BY: DAVID PRESTON-THOMSON (SYDNEY)
XREF: X-GRP-A1-SHT; X-SYD-A1-Logo; X-Arch Ground Floor; X-Design
CAD FILE: \\Urban\6000 - 6095\600283 - Shepherds Bay Meadow Bank\3 Drafting\Drawings\600283-1201.dwg

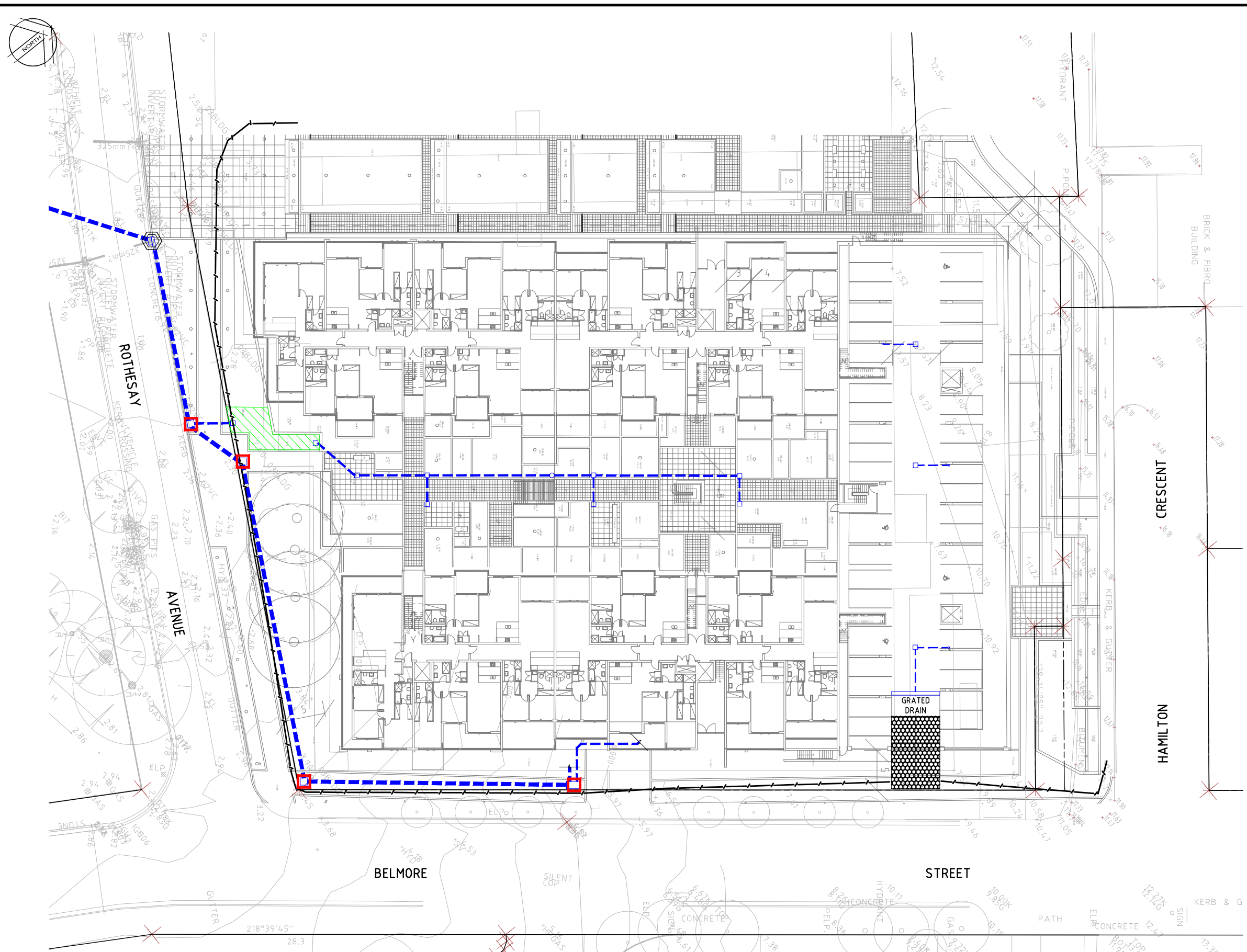

- NOTES:**
1. LOCATION OF TEMPORARY CONSTRUCTION VEHICLE ACCESS TO BE DETERMINED ON SITE TO SUIT CONSTRUCTION STAGING.
 2. STOCKPILE LOCATION TO BE CONFIRMED ON SITE AND PROTECTED WITH A DIVERSION BUND UPSTREAM AND SILT FENCE DOWNSTREAM.
 3. THE CONTROL MEASURES SHOWN ON THIS DRAWING ARE INDICATIVE ONLY. IT IS THE CONTRACTORS RESPONSIBILITY TO ENSURE THAT ALL NECESSARY CONTROL MEASURES ARE INSTALLED AND MAINTAINED IN ACCORDANCE WITH RYDE CITY COUNCIL STANDARDS.

LEGEND

REFER DRAWING 120 FOR DETAILS

- KERB INLET GROSS POLLUTANT TRAP
- TEMPORARY SURFACE INLET SEDIMENT TRAP
- PROPRIETARY SILT FENCE
- TEMPORARY CONSTRUCTION VEHICLE EXIT

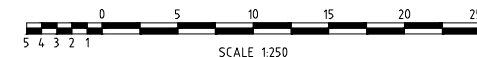

SCALE 1:250

NOT CONSTRUCTION ISSUE

Rev	Date	Description	Drawn	Appr.
2	13/12/2011	CONCEPT DRAINAGE AMENDED	DPT	GJN
1	8/10/2010	PRELIMINARY	DH	AB

© Cardno Ltd 2011
All Rights Reserved.
This document is produced by Cardno Ltd solely for the benefit of and use by the client in accordance with the terms of the retainer. Cardno Ltd does not and shall not assume any responsibility or liability whatsoever to any third party arising out of any use or reliance by third party on the content of this document.

ABN: 95 001 145 035
910 Pacific Highway, Gordon, NSW Australia 2072
Phone (+61 2) 9496 7781 Fax (+61 2) 9499 3912
Email: Sydney@cardno.com.au Web: www.cardno.com.au

Quality Endorsed Company
AS 9001 Lic. 990
Standard Australia

Drawn	DH	Date	7/10/2010
Checked	GN	Date	8/10/2010
Designed	AB	Date	7/10/2010
Verified		Date	
Approved	GN	Date	8/10/2010

ROBERTSON MARKS ARCHITECTS

STORMWATER CONCEPT DESIGN
ROTHERSAY AVENUE
MEADOWBANK

EROSION & SEDIMENT CONTROL PLAN

Status			
NOT FOR CONSTRUCTION			
Date	Datum	Scale	Size
7/10/2010	AHD	1:250	A1
Drawing Number			Revision
600283-120			2

ON A1 ORIGINAL