

- | LEGEND |                        |
|--------|------------------------|
| AC     | AIR CONDITIONER        |
| BOX    | POWER BOX              |
| EL     | ELECTRICITY PLEX       |
| FP     | FLOOR CROSSING         |
| FL     | FLOOR LEVEL            |
| GP     | GULLY PIT              |
| HW     | HOT WATER HEATER       |
| HVD    | HOT WATER              |
| HC     | HOBASIT                |
| IC     | INSPECTION COVER       |
| LH     | LAMP HOLE              |
| LP     | LIGHT POLE             |
| MP     | MANHOLE                |
| PB     | POWER BOX              |
| PC     | PRAMI CROSSING         |
| PE     | POWER PILE             |
| SMH    | SEWER MANHOLE          |
| SV     | SEWER OULET            |
| SV     | STOP VALVE             |
| S/W    | STORMWATER             |
| TEL    | TELECOMMUNICATIONS PIT |
| VC     | VEHICLE CROSSING       |
| WM     | WATER METER            |
| WS     | WATER SERVICE          |

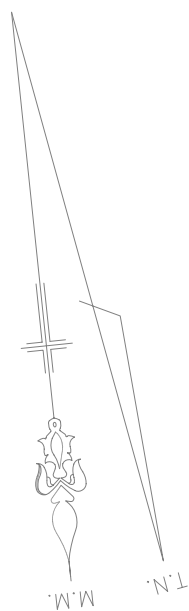
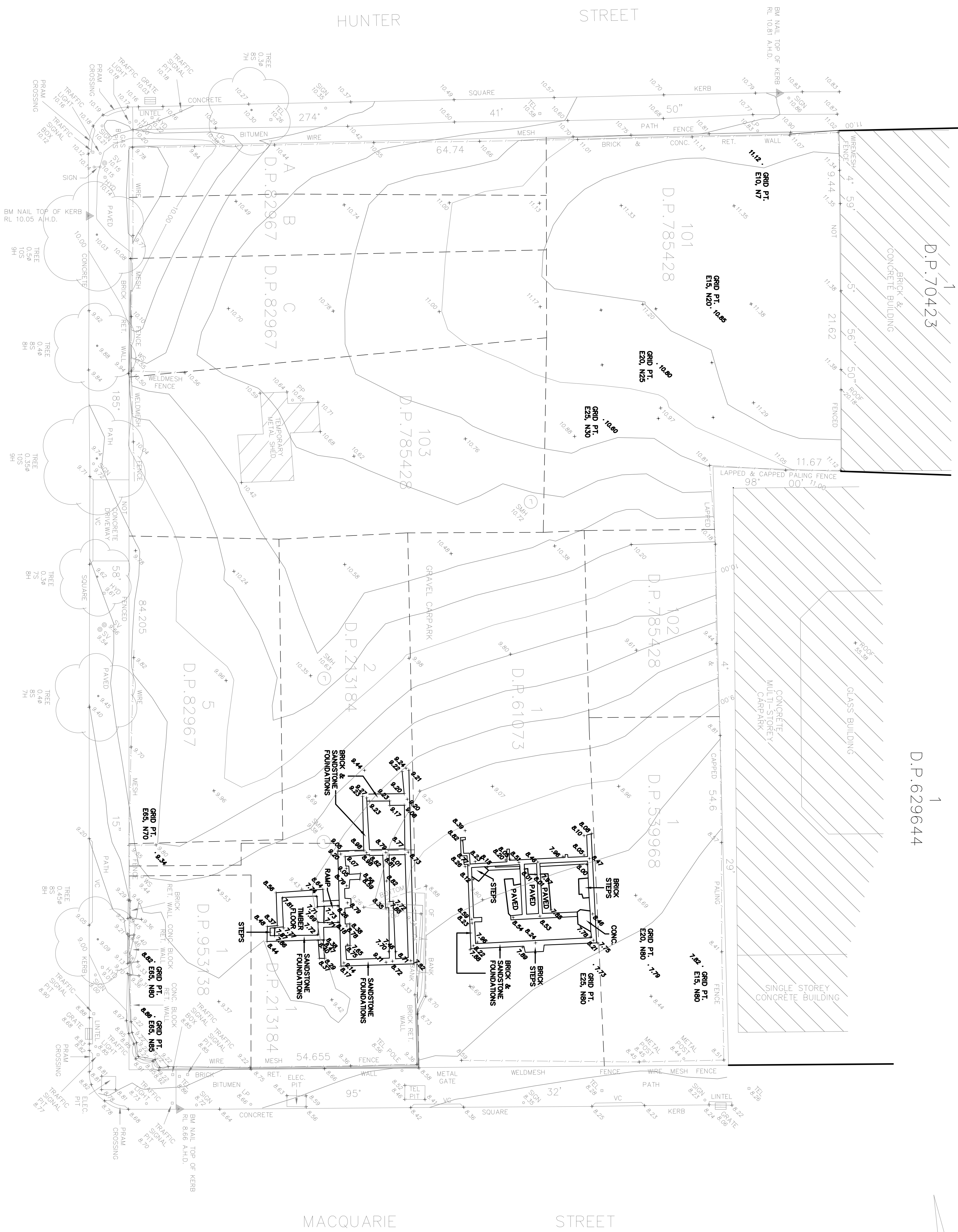

THIS SURVEY HAS BEEN PREPARED TO SHOW DETAILS OF THE AREA OF EXCAVATION, SHOWN IN RED, CHANGES IN LEVELS AND SITE CONDITIONS OVER THE WHOLE SITE SUBSEQUENT TO OUR ORIGINAL SURVEY DATED 27/06/03. HAVE NOT BEEN DETERMINED.

A LOCAL GRID SYSTEM HAS BEEN ESTABLISHED ON SITE BY OTHERS. THE LOCATION OF GRID POINTS SHOWN ARE FOR INFORMATION PURPOSES ONLY, AND THE INTEGRITY OF THE GRID SYSTEM HAS NOT BEEN DETERMINED.

NOTES:

1. THE POSITION OF IMPROVEMENTS TO BOUNDARIES ARE DIAGNOSTIC ONLY
2. POSITION OF RIDE LINES ARE DIAGNOSTIC ONLY (NOT TO SCALE)
3. NO INVESTIGATION OF UNDERGROUND SERVICES HAS BEEN MADE
4. ALL DIMENSIONS ARE BY D.P.78:2428 & SUBJECT TO FINAL SURVEY
5. CONTOURS ARE INDICATIVE OF GROUND ONLY, ONLY SPOT LEVELS SHOULD BE USED FOR CALCULATIONS OF QUANTITIES WITH CAUTION
6. NO INVESTIGATIONS HAVE BEEN MADE OF BUILDING RESTRICTIONS WHICH MAY APPLY TO THIS LAND

3. ORIGIN OF LEVELS: SSM 45935 RL 10.507 A.H.D.

REFERENCE:	DATE: 27/06/03	CLIENT: ESTATE PROPERTIES OF AUSTRALIA
4801/03	SCALE: 1:200	PROJECT: DETAIL & LEVEL SURVEY
	DATE: A.H.D.	NO. 140 MARSDEN STREET,
	SITE AREA: 4899m <sup>2</sup>	PARRAMATTA
REG'D SURVEYOR	SHEET 1 OF 1 SHEETS	LDA: PARRAMATTA
	STUTCHBURY JAQUES PTY LTD LAND SURVEYING CONSULTANTS P.O. BOX W249, BROOKVALE NSW 2100 PH: 8976 1600 FAX: 8976 1655 E-MAIL: jaques@higpond.net.au	

AMENDMENT: DETAIL OF EXCAVATED FOUNDATIONS SHOWN IN RED ADDED, DATED 4/7/05