

# 61 HALL STREET BONDI

## Landscape Design / Public Domain Plan

December 2010

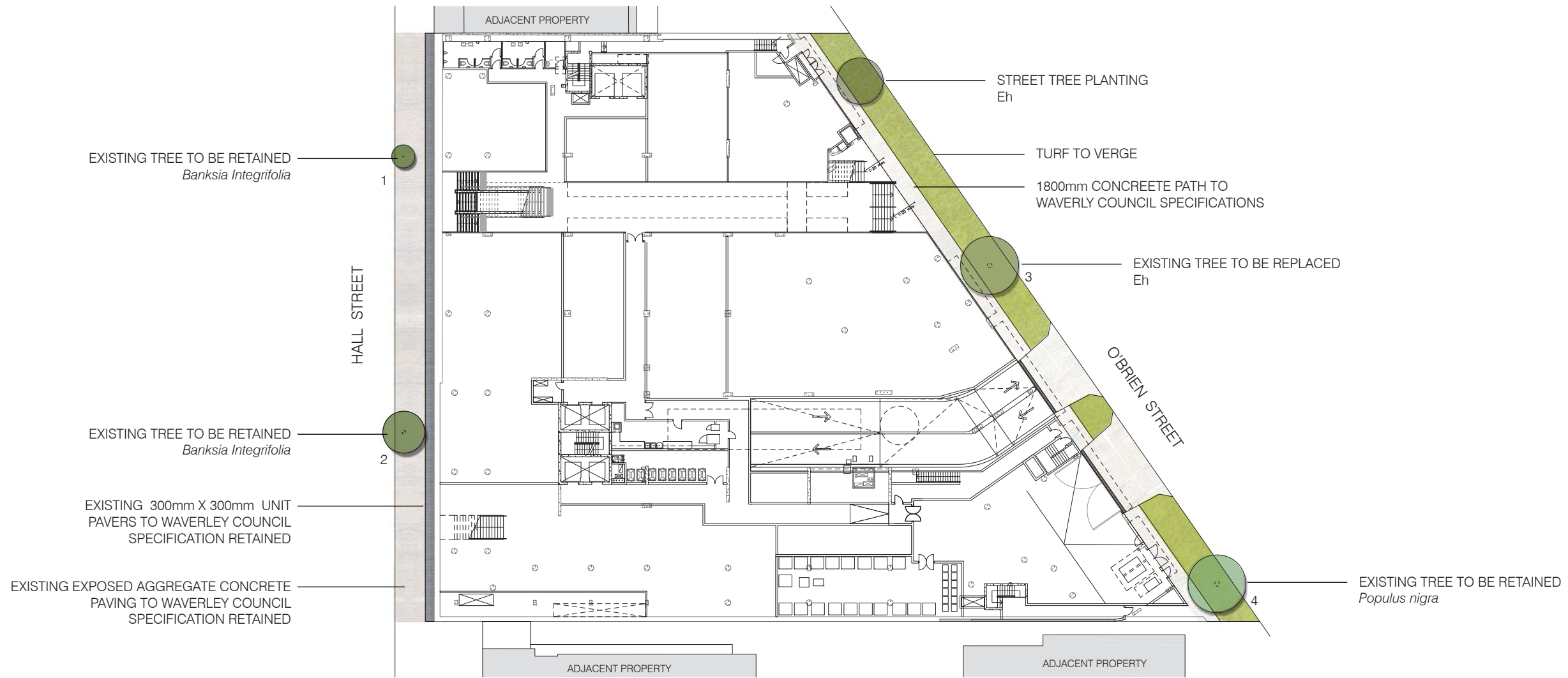



PROPOSED LANDSCAPE



PROPOSED TREE: *Eucalyptus haemastona*

DESIGN INTENT  
Low use residential street with large sized evergreen tree. Evergreen tree will provide year round canopy and reflect the adjacent existing planting.

PLANTING SCHEDULE

TREES					
SYMBOL	BOTANICAL NAME	COMMON NAME	MATURE HEIGHT	POT SIZE	NUMBER
Eh	Eucalyptus haemastona	Scribbly gum	20m	400L	2

EXISTING LANDSCAPE

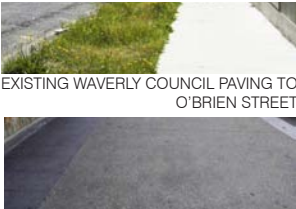

EXISTING WAYERLY COUNCIL PAVING TO  
HALL STREET



EXISTING TREE 1 *Banksia Integrifolia*



EXISTING TREE 2 *Banksia Integrifolia*



EXISTING TREE 3 *Casuarina equisetifolia*



EXISTING TREE 4 *Populus nigra*



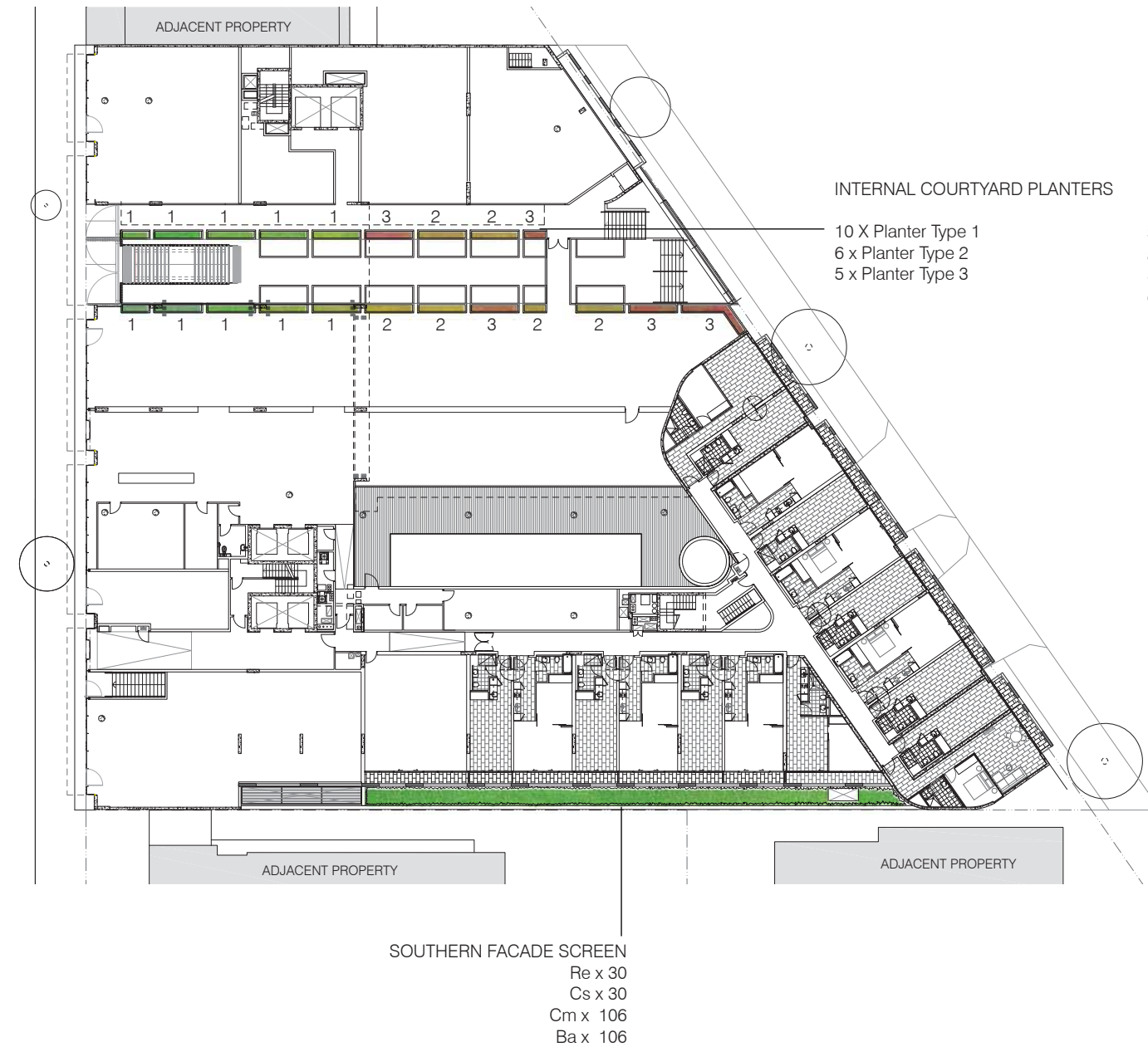

DESIGN INTENT - INTERNAL COURTYARD PLANTERS

Species overhang planters creating lush & delicate greenery amongst a highly used civic space. Sun tolerant species add colour & texture to the open courtyard while lush green foliage cascades over planters in enclosed spaces.

DESIGN INTENT - SOUTHERN FACADE SCREEN

Lush Raphis & Bamboo palms screen the south western facade. A colourful mix of clivia & bromeliads provide colour & detail to the under storey.

SYMBOL	BOTANICAL NAME	COMMON NAME	MATURE HEIGHT	POT SIZE	NUMBER
Re	Raphis excelsa	Raphis palm	2.5 - 3m	5L	30
Cs	Chamaedorea sefrizii	Bamboo Palm	2.5 - 3m	5L	30
Cm	Clivia miniata	Clivia	0.5m	200mm	106
Ba	Alcantarea imperialis 'Rubra'	Imperial Bromeliad	1m	200mm	106



Raphis excelsa



Chamaedorea sefrizii



Clivia miniata



Alcantarea imperialis 'Rubra'

