

1:1000@A3

0 10 20 30m

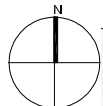

## METRO DELIVERY PLAN (Upper level)

*This plan identifies the scope of works of the Metro project, including new station buildings, public domain works and other elements*



**SydneyMetro**

MASTER PLANNING & URBAN DESIGN

**CENTRAL**



1:1000@A3

0 10 20 30m

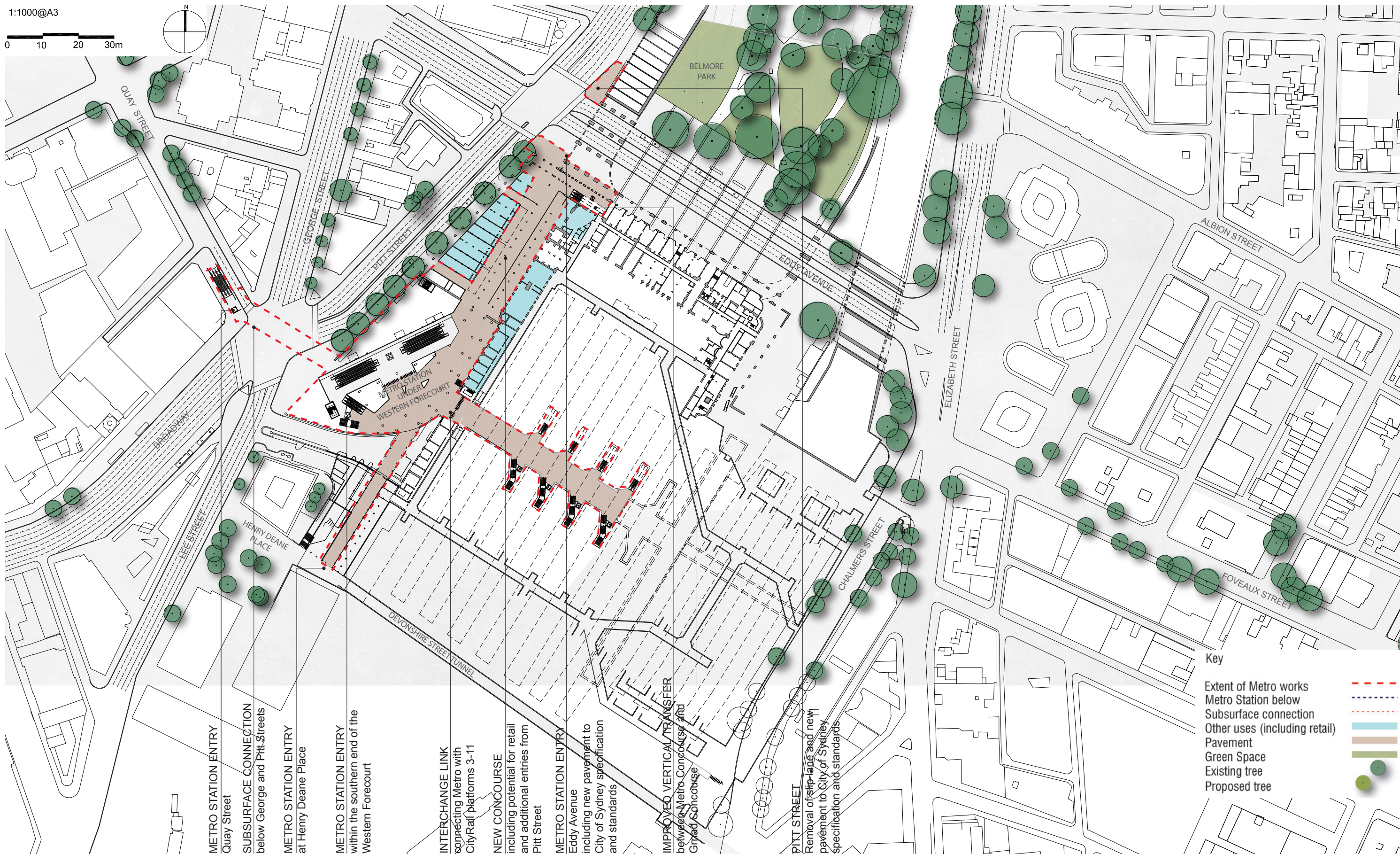
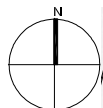

## METRO DELIVERY PLAN (Lower level)

This plan identifies the scope of works of the Metro project, including new station buildings, public domain works and other elements



**SydneyMetro**

MASTER PLANNING & URBAN DESIGN

**CENTRAL**

Issued for public exhibition (Revision A)



1:1000@A3

0 10 20 30m

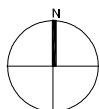

Key

Extent of Metro works  
Metro Station below  
Subsurface connection  
Other uses (including retail)  
Pavement  
Green Space  
Existing tree  
Proposed tree



## METRO DELIVERY PLAN

*This plan identifies the scope of works of the Metro project, including new station buildings, public domain works and other elements*



1:1000@A3  
0 10 20 30m

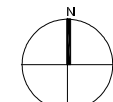

## METRO DELIVERY PLAN

*This plan identifies the scope of works of the Metro project, including new station buildings, public domain works and other elements*



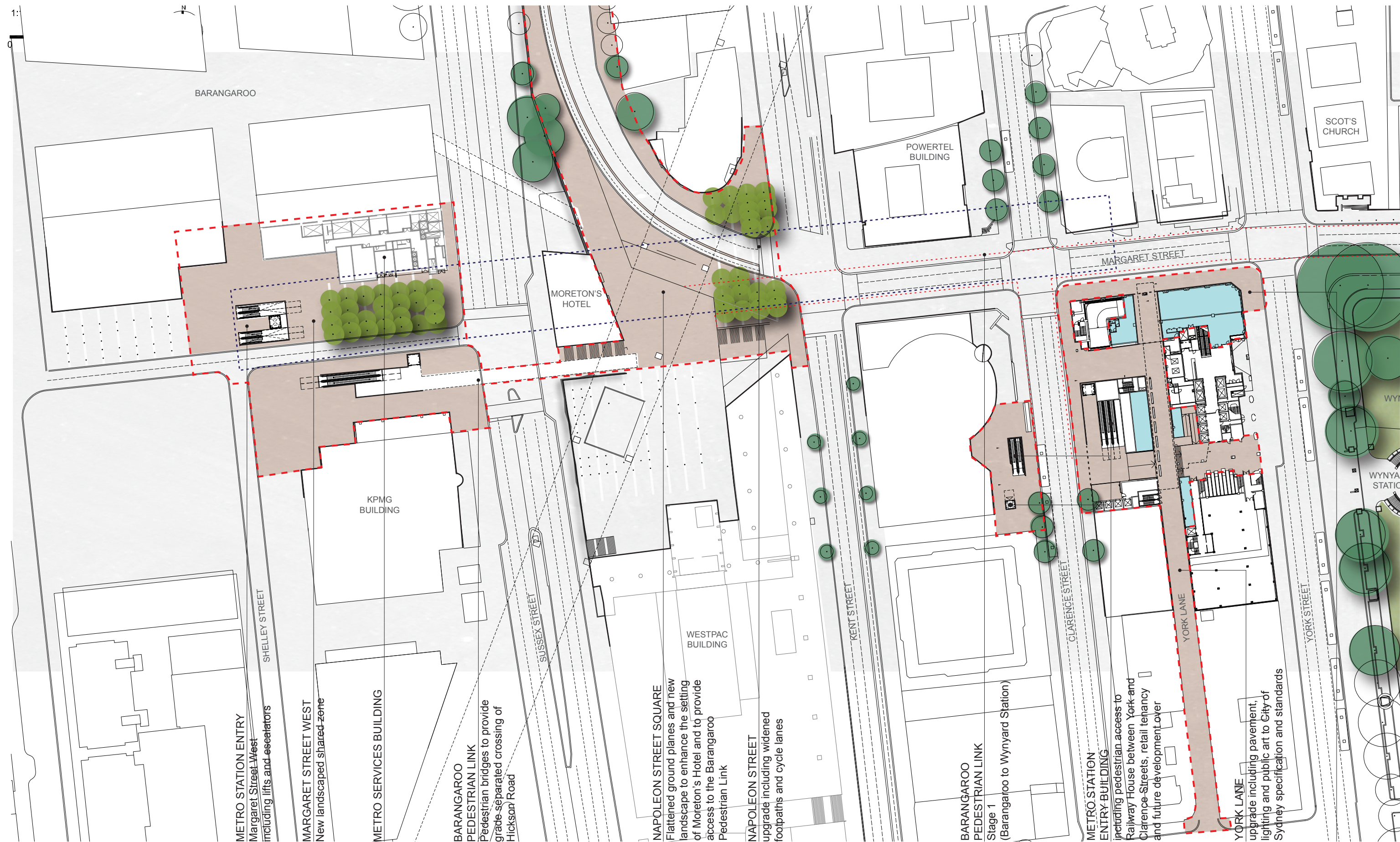

## METRO DELIVERY PLAN

*This plan identifies the scope of works of the Metro project, including new station buildings, public domain works and other elements*



1:1000@A3  
0 10 20 30m

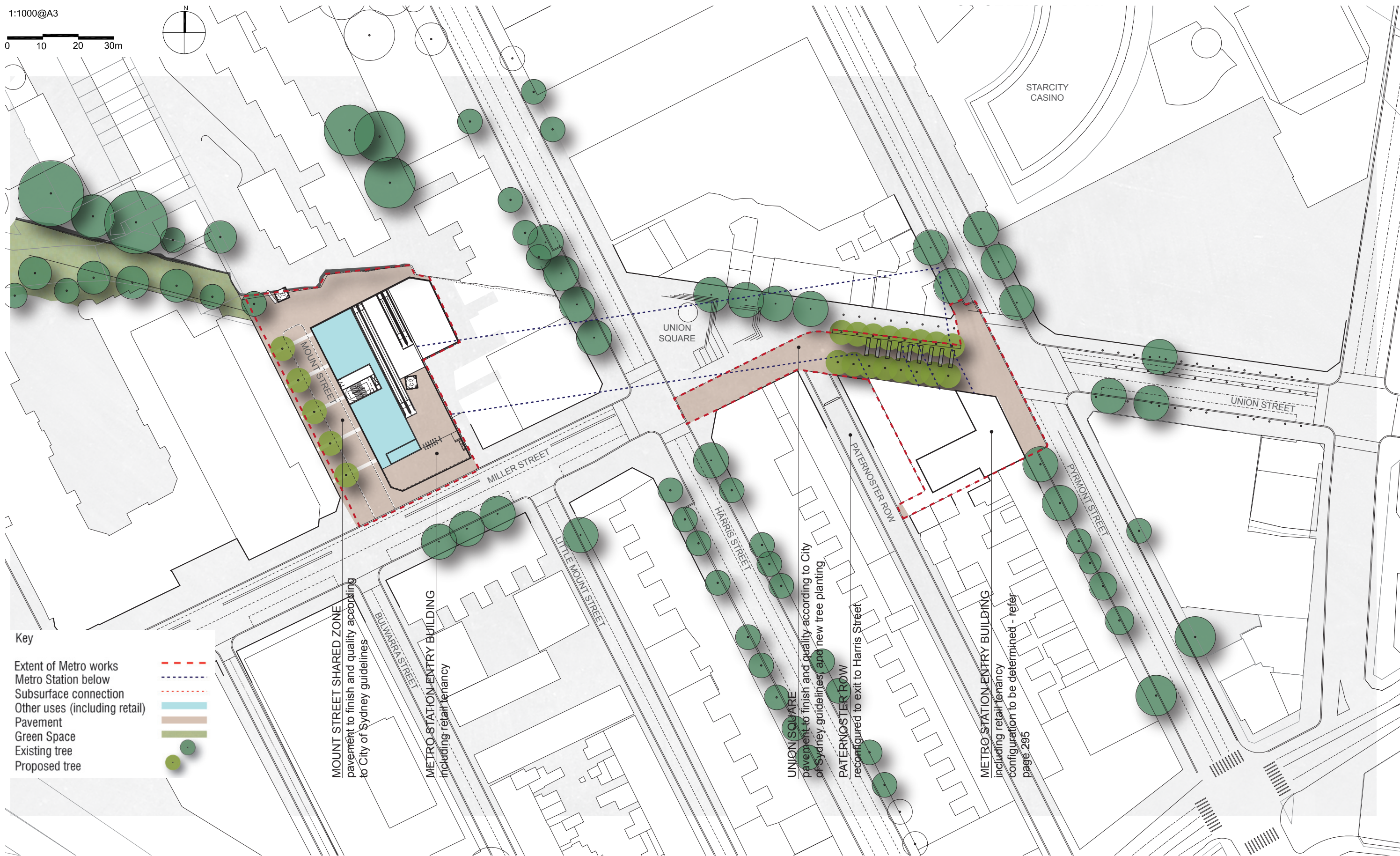
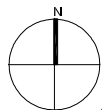

## METRO DELIVERY PLAN

*This plan identifies the scope of works of the Metro project, including new station buildings, public domain works and other elements*



1:1000@A3  
0 10 20 30m

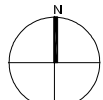

## METRO DELIVERY PLAN

*This plan identifies the scope of works of the Metro project, including new station buildings, public domain works and other elements*





## \_02 MASTERPLAN

- extent of works
- buildings/structures
- existing vegetation retained & protected
- mass native tree planting
- advanced street tree planting - *locally occurring species*
- bioswales - *native grass & tree planting*
- mass planting - *low height native shrubs & grasses*
- turf
- semi-permeable paving - *all paved areas on site except roads & track foundations*
- viewing platforms/seating courts - *select locations along Lilyfield Road*
- 3.6m (min.) wide pedestrian/bicycle bridge - *grade connections to Lilyfield Road, Annandale LRT & new open space area*
- asphalt paved and broken concrete kerbs - *all site roads*
- concrete paving strips - *track foundations*
- 1.2m high public domain fence & gates - *painted steel palisade*
- public domain external fence & gates - *painted steel palisade*
- internal site security fence & gates
- acoustic barrier - *adjacent to portal*
- 2.5m wide asphalt pathway - *Lilyfield Road & new open space in south-east of site*
- future potential vehicle access to White Bay

### Notes:

1. Refer to Indicative Plans/Sections & design quality images in Design Concept Report for additional requirements
2. Lighting, signage retaining walls & other elements also included but not indicated on this drawing - refer to Design Concept Report and specifications

Refer to 'Detail Areas and Design Guidelines' section of report for detailed concept plans and sections and design quality requirements.

