

EXISTING WINTER 9:00 AM

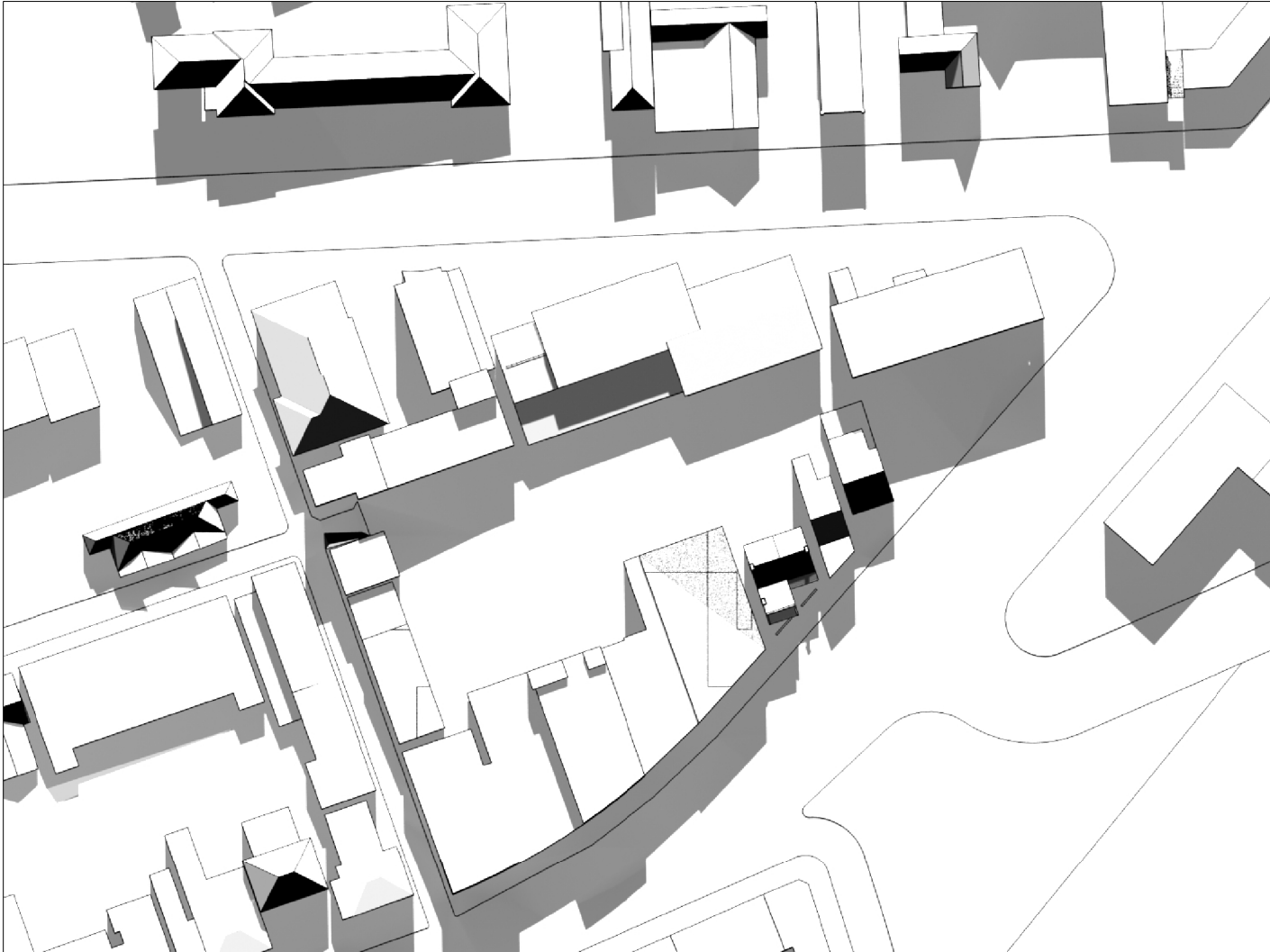

EXISTING WINTER 12:00 NOON

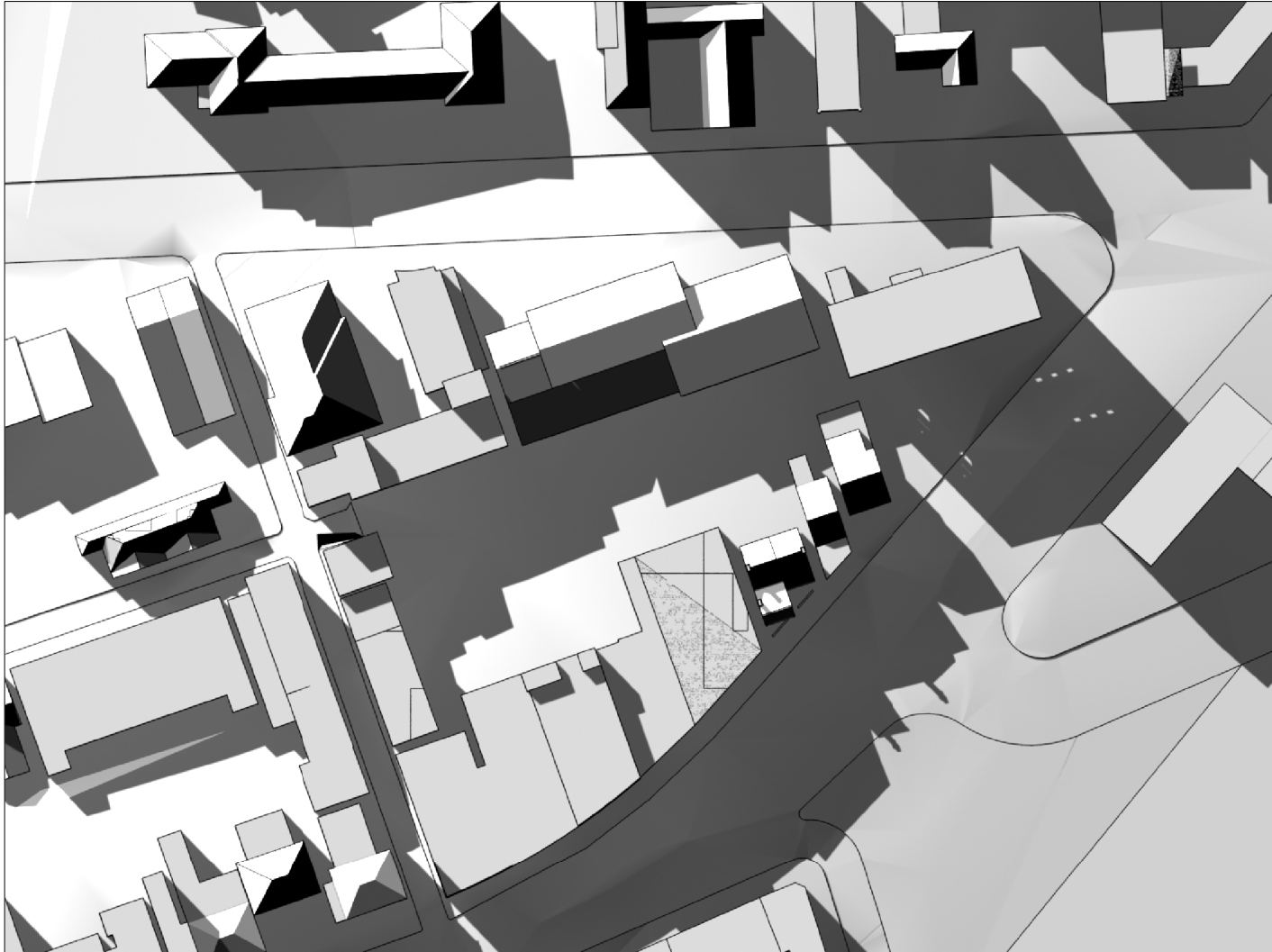

EXISTING WINTER 3:00 PM

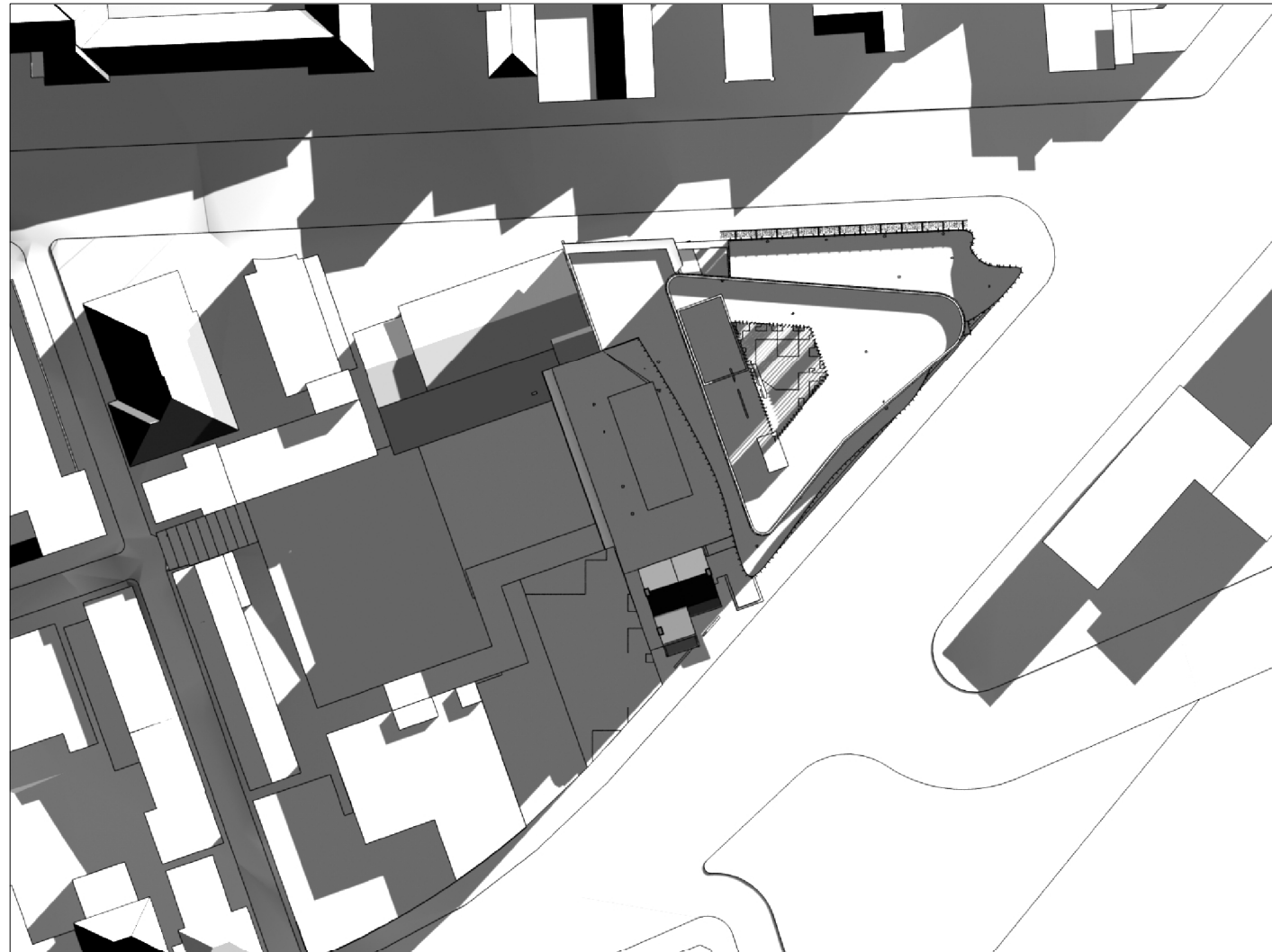

PROPOSED WINTER 9:00 AM

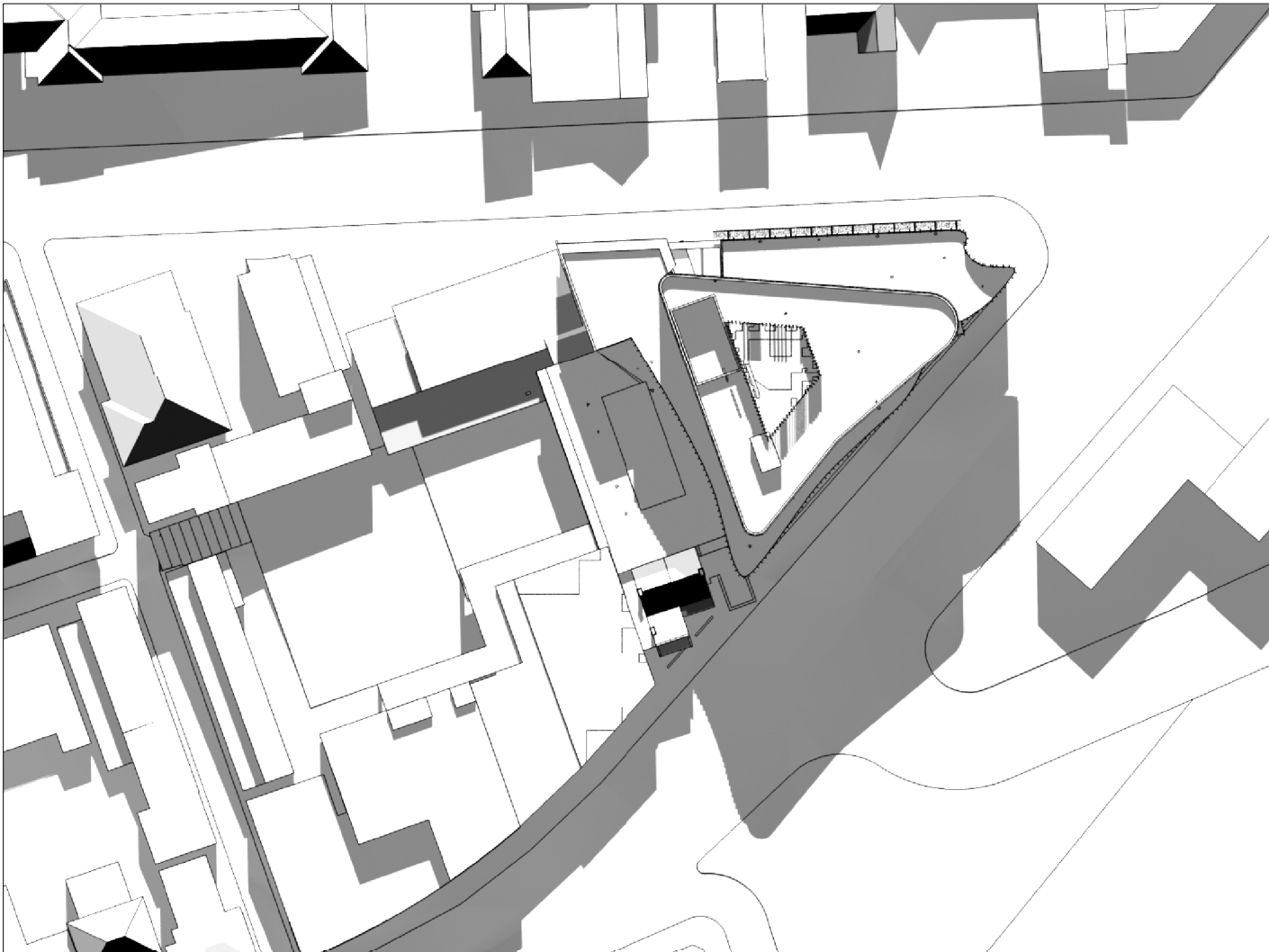

PROPOSED WINTER 12:00 NOON

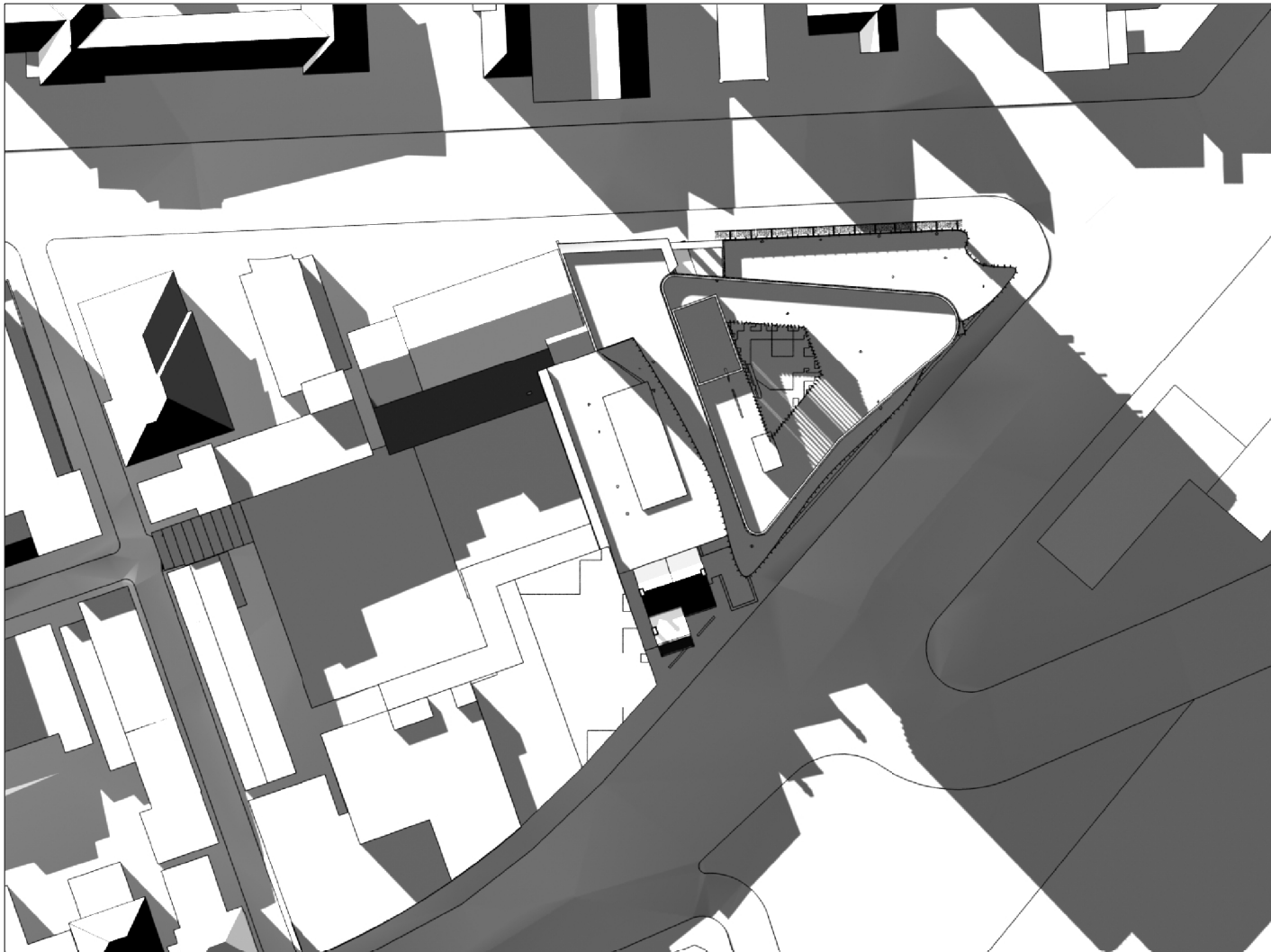

PROPOSED WINTER 3:00 PM

Revisions			
No	Date	Description	Ver App'd
A	09/10/09	PROJECT APPLICATION ISSUE	JG ML
Do not scale drawings. Use figured dimensions only. Check & verify levels and dimensions on site prior to the commencement of any work, the preparation of shop drawings or the fabrication of components.			
This drawing is the copyright of Allen Jack + Cottier Architects and is protected under the Copyright Act 1968. Do not alter, reproduce or transmit in any form, or by any means without the express permission of Allen Jack + Cottier Architects.			
Nominated Architects: Keith Cottier AM 2264, Glynn N Evans 2839, Michael Heenan 5264, Peter Ireland 6661, Reginald Smith 3312, Peter Stronach 3312.			

Site Location Plan

Client  
MOORE THEOLOGICAL COLLEGE

Architect  
**ALLEN JACK+COTTIER**  
79 Myrtle Street Chippendale NSW 2008 AUSTRALIA  
ph +61 2 9311 8222 fx +61 2 9311 8200 ABN 53 003 762 250

Project  
MOORE COLLEGE RESOURCE  
AND RESEARCH CENTRE  
1 KING STREET NEWTOWN

Proj No. 09027

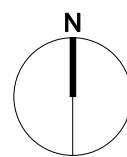

Drawing Title  
SHADOW DIAGRAM 3

Drawing Status  
PROJECT APPLICATION

Scale  
N.T.S

Drawing No  
PA 3802

Issue  
A

0 10 20 50 80mm